

USER MANUAL

Outdoor Spotlights

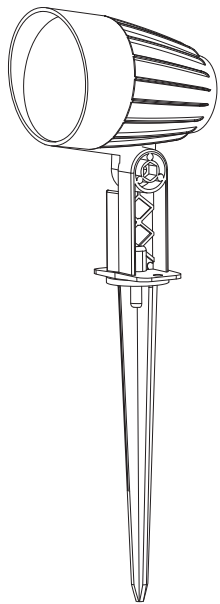

B04-25DSTA-WW-SZ-B

EN

Thank you for purchasing our products. Please read the terms and instructions carefully before using.

Any problem with the product, please contact us immediately. Our after-sales support team will contact you in the first time and solve every problem about the product.

Precautions before Installation

1. The luminaire should be positioned at suggested installation height, please do not prolonged stare into the luminaire for more than 3 seconds within 2 meters.
2. The light source is not replaceable, when it reaches the end of its life, the whole luminaire needs to be replaced.
3. Please check the product carefully if there is any damage before installation.
4. Please prepare the output DC 12-24V or AC 12-24V switching power supply before installation.
5. Please prepare an IP65 or above wiring device before installation to connect the switching power supply output cable with the lamp body input power cable.
6. It is forbidden to decompose or modify this lamp during the warranty period.
7. In order to ensure that the lamp can work properly, please use the voltage indicated on the package to supply power.

1

Warning

This is a low-voltage power product. It cannot be directly connected to live use high-voltage power!!!!

Product Structure and Size

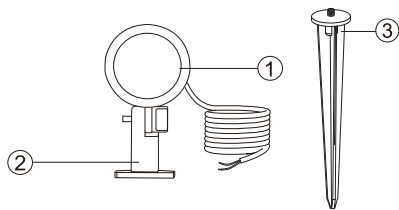

- ① Lamp
- ② Base
- ③ Spike

Parameter

Model	Power	Distance	CRI	Color Temperature	Angle	Rating	Input Voltage	Ta
DSTA07	7W	2-3M	>80	2700K	45°	IP66	AC/DC 12-24V	-25°C~40°C
DSTA09	9W	2-3M	>80	2700K	45°	IP66	AC/DC 12-24V	-25°C~40°C
DSTA12	12W	3-4M	>80	2700K	45°	IP66	AC/DC 12-24V	-25°C~40°C
DSTA15	15W	3-4M	>80	2700K	45°	IP66	AC/DC 12-24V	-25°C~40°C

2

Installation Method



Use the spike: Fix the lamp bracket and the spike with screw, then insert on lawn or unhardened ground.

Use the base: After fix the lamp bracket to the base with screws, the lamp can be fixed on the hardened floor or wall with screws.

3

Product parts

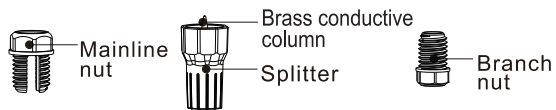

Installation

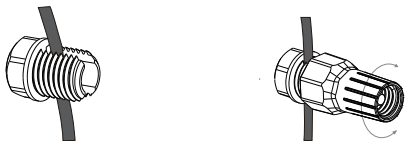

- ③ Remove the insulation rubber of the landscape light
- ④ Put the light wire through the branch nut

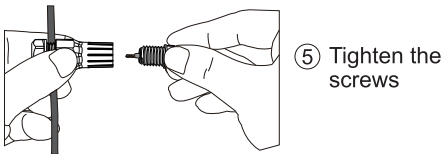

4

Correct installation diagram

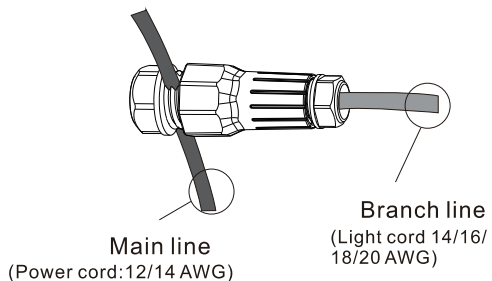

General Troubleshooting

If it is not installed improperly, please confirm whether it is due to the following reasons. If you cannot solve the problem after using the following methods, stop using it immediately and contact a professional or retailer for help.

1. If the lamp fails to work after power access disconnect the power supply and check the lamp power cable connection is good or not.

5

2. If the connection is correct, please check whether the supply voltage meets the rated voltage required by this lamp or other line faults.



IP66



Manufacturer: Shenzhen Oumeike Lighting Technology Co., Ltd.
Address: No. 19-20, Anye Road, Yuanshan Street, Longgang District,
Shenzhen, Guangdong, China

E-mail: info@163.com

6