

3-Light Seedy Glass Flush Mount Ceiling Fixture

Caution: Please turn off power before installation and read the manual carefully, we advise you contact professional electricians to install for safety purpose.

Product Features

Style: Modern/Farmhouse

Material: Metal, Glass

Color: Black

Base Type: E12 Base

Light Source Included: NO

Voltage: 120VAC

Wattage: 60W

Package includes

1 x Ceiling Light

1 x Accessories Kit

1 x User's Manual

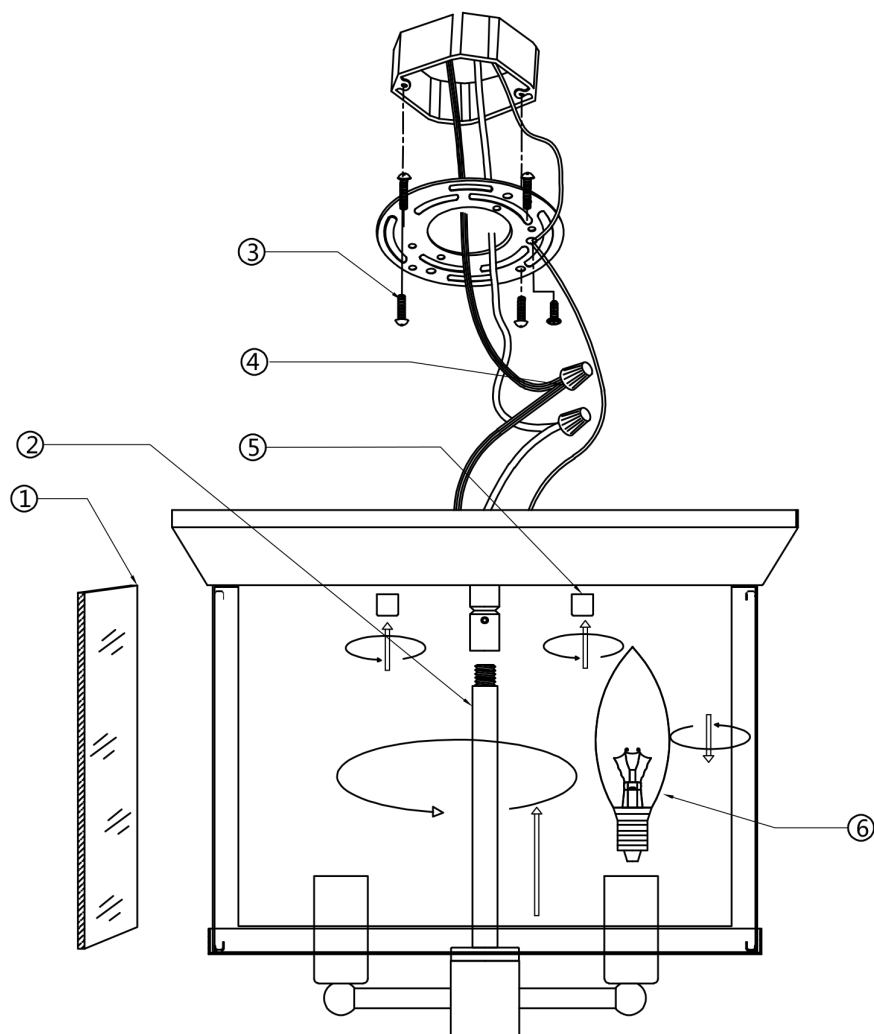

Installation Instructions

1. Position the glass panel on the inside of the fixture frame and bend the four metal clips to securely hold the panel in place.
2. Screw the lamp sockets section onto the ceiling adaptor.
3. Attach the mounting plate on the junction box using provided screws.
4. Connect the fixture wires to the corresponding wires reserved in the junction box using wire nuts. Secure the ground wire both from the fixture and the junction box to the mounting plate with a green screw to ensure proper grounding.
5. Align the canopy over the mounting plate, ensuring the mounting screws are exposed, and tighten the flat nuts to secure the canopy firmly.
6. Assemble the bulbs (not included).

Note: please use this product accordingly to its intended purpose, do not retrofit or remodeling the product. The warranty does not cover if the failure is caused by the third party product, or natural disasters.