

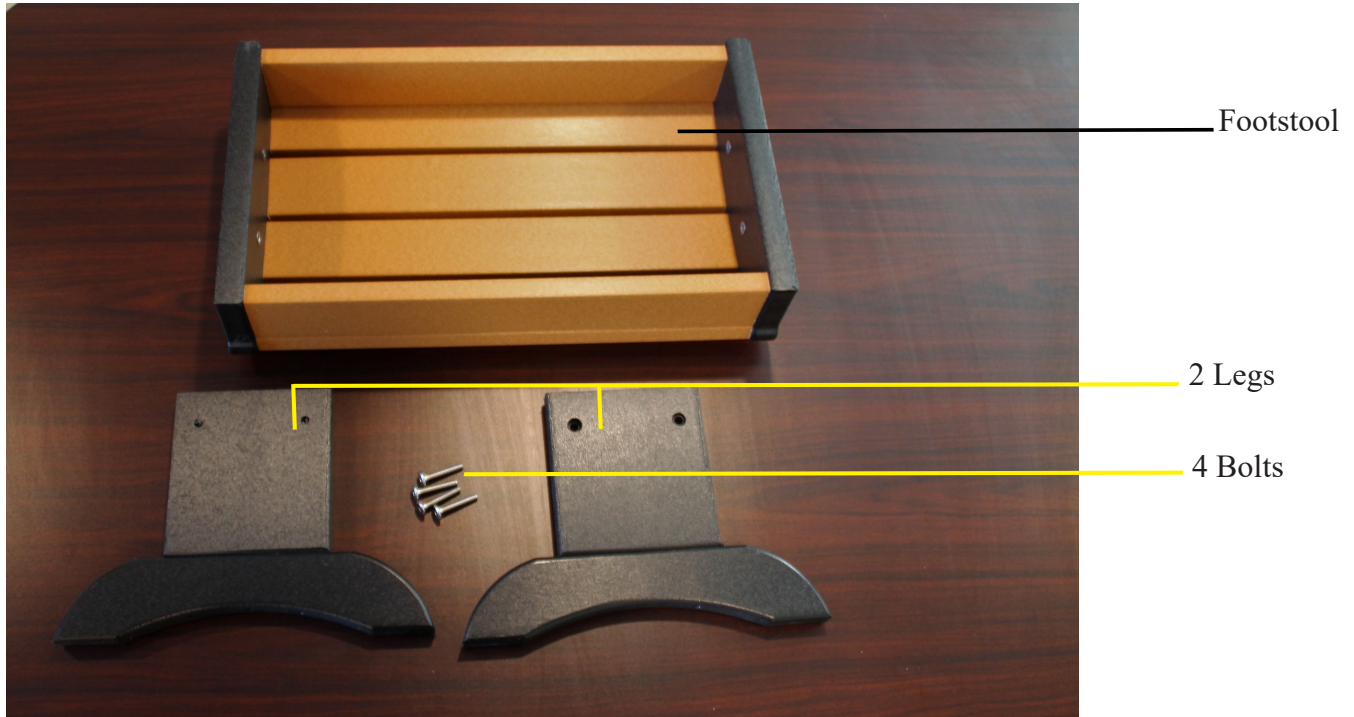

# POLY FOOTSTOOL ASSEMBLY MANUAL

# Parts List



## Tools Required For The Job (Included)



5/32" Hex Key

\*NOTE: This Hex Key is used to tighten all the screws used in the assembly process.

Step:1

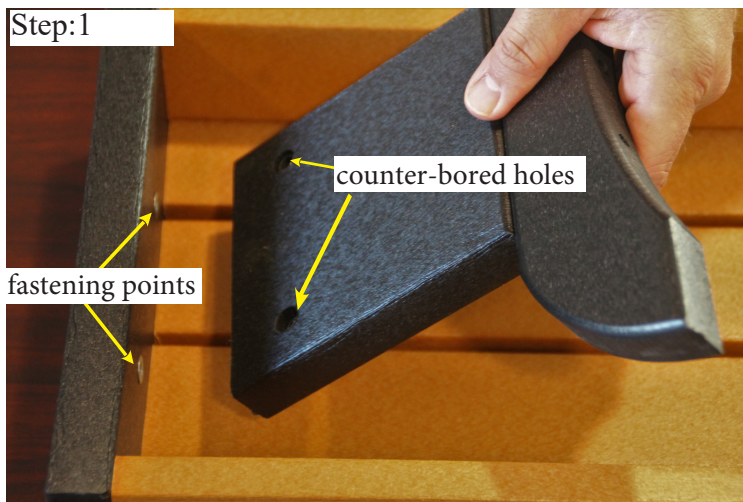

Place footstool top down on a clean, smooth surface. Be sure counter-bored holes are placed towards the fastening point.

Step:2



Fasten leg to footrest using bolts provided. Repeat this step at all four fastening points.

Step:3



Your assembly is now complete! Be sure four bolts are properly tightened.



This footrest is designed so it can easily slide under the chair for convenient storage.

