



WARNING:

CHOKING HAZARD/SHARP POINTS- Assembly hardware contains small parts and components with sharp points. Adult assembly required. Attention: This unit must be attached to a wall to prevent tipping over!!

Tools Required:

-4mm Hex Wrench, (Provided)
-Medium Phillips Screwdriver

Instructions for: 7107YT Stackable Locker

Hardware Package HCKC

Qty.	Description
(8)	XAPS Mounting Plate with screws
(8)	XAPT 110° Half Overlay Hinge
(20)	XAMT Camlock Bolt
(1)	XAUS 4mm Hex Wrench
(16)	XBDP #6 X 5/8" Flathead Screw
(4)	XALW Black Plastic Handle
(8)	XAUN #6 X 1-1/4" Trusshead Screw
(3)	XAUF 3" Drywall Screw
(3)	XCPT #8 X 0-7/8" Washerhead Screw
(3)	XAED 1-5/8" Drywall Screw
(4)	XAAD 1" Drywall Screw

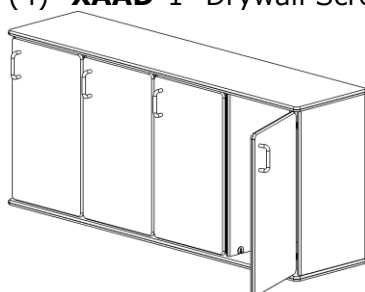

Parts:

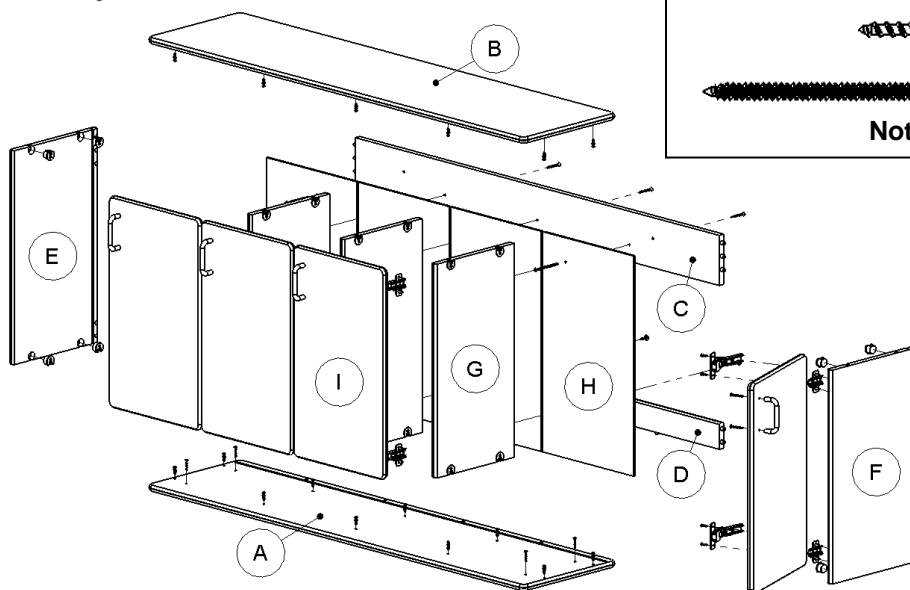

Hardware Illustrations

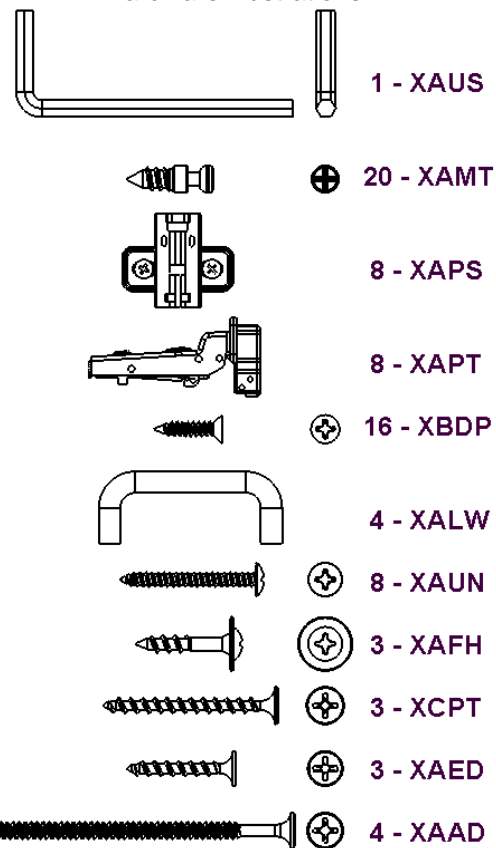

Not Actual Size

Pre-Assembly Instructions:

1. Place Bottom-A and Top-B on flat surface and install 20-**XAMT** Camlock Bolts using Phillips Screwdriver. Note: DO NOT install in thru holes on Bottom. Set aside for installation later.

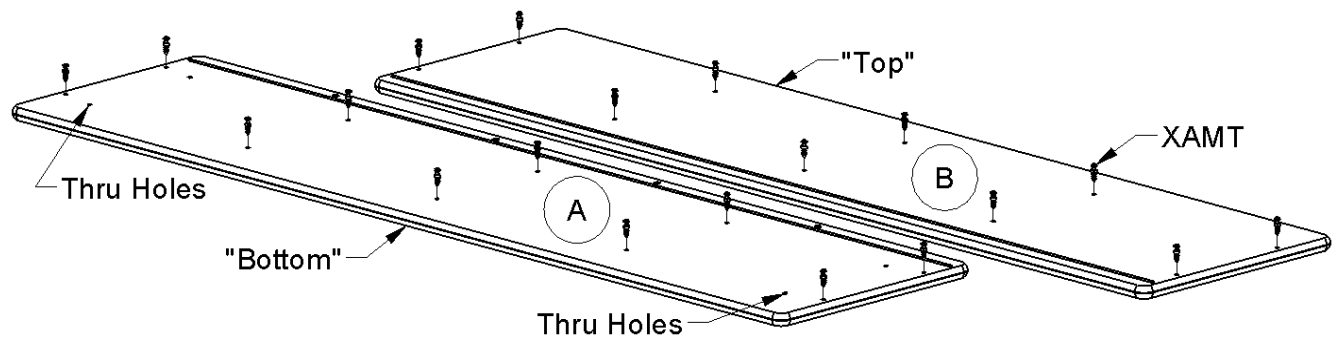

2. Place RH Side-F and Dividers-G on flat surface and install 8-**XAPS** Hinge Mounting Plates into 5mm predrilled holes using Phillips Screwdriver. Note location of raised bridge in Hinge Mounting Plate. Set aside for installation later.
3. Place Doors-I on flat surface and install 8-**XAPT** 110 Degree Hinges into predrilled holes using **XBDP** #6 X 0-5/8" Flathead Screws using a Phillips Screwdriver. Install 4-**XALW** Door Handles using 8-**XAUN** #6 x 1-1/4" Trusshead Screws using a Phillips Screwdriver. Set aside for installation later.

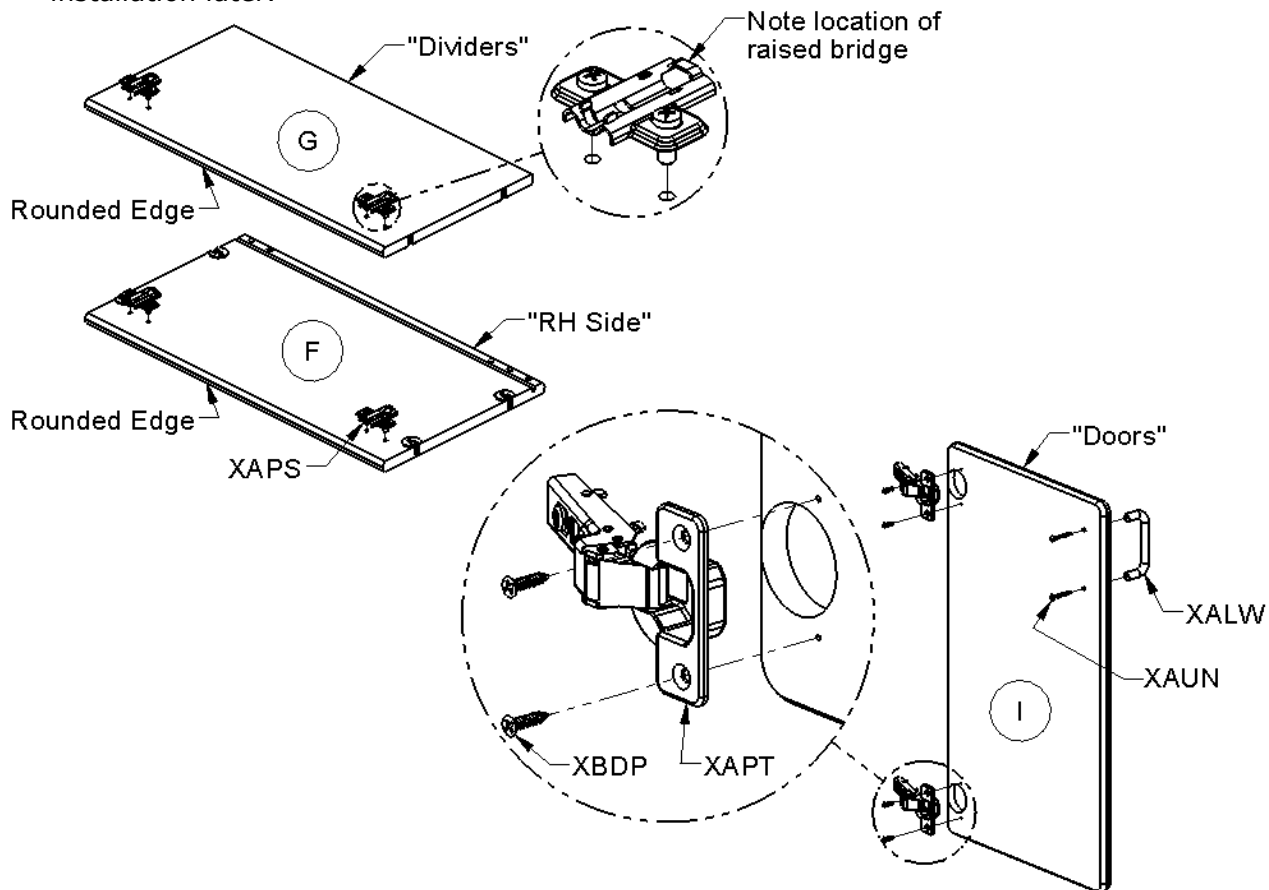

Assembly Instructions:

4. Begin assembly by aligning dowels in Rail-D with holes next to back groove in Bottom-A. Position LH Side-E with Bottom-A by aligning Back grooves and cam-locks with cam-lock bolts previously installed in Bottom. Secure LH Side by turning cam-lock's metal center with a Phillips Screwdriver ¼ turn clockwise.

Repeat this procedure with RH Side-F.

Place Hanging Brace-C between Sides and align dowels. Note orientation of Hanging Brace in image below, Hanging Brace should be flush with top of Sides. Ensure the Hanging Brace and Rail dowels are fully inserted into each Side.

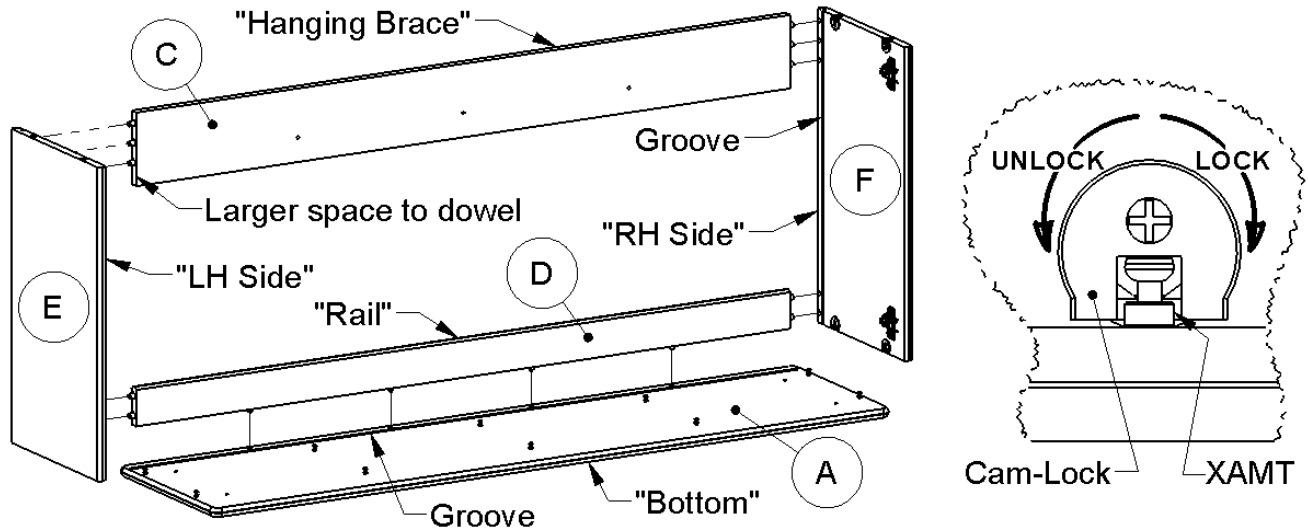

5. Drop in Backs-H into grooves on the Sides and Bottom.

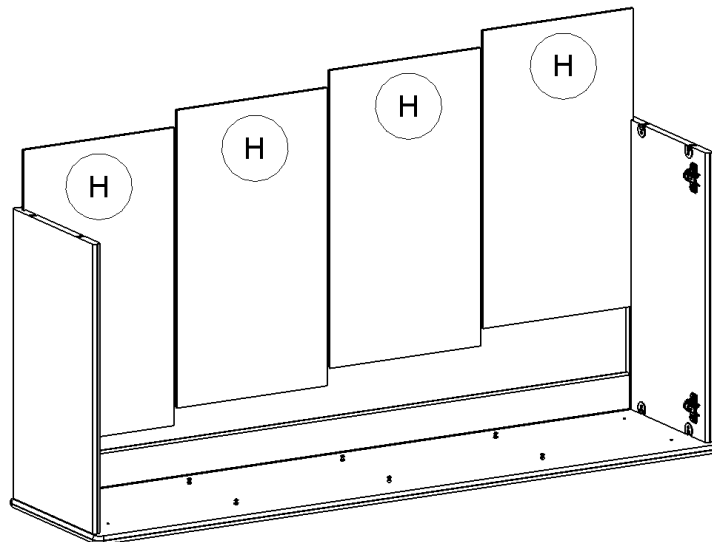

6. Install **Top-B** by aligning cam-locks with cam-lock bolts previously installed in Top and Backs resting in Top groove. Secure by turning cam-lock's metal center with a Phillips Screwdriver ¼ turn clockwise.

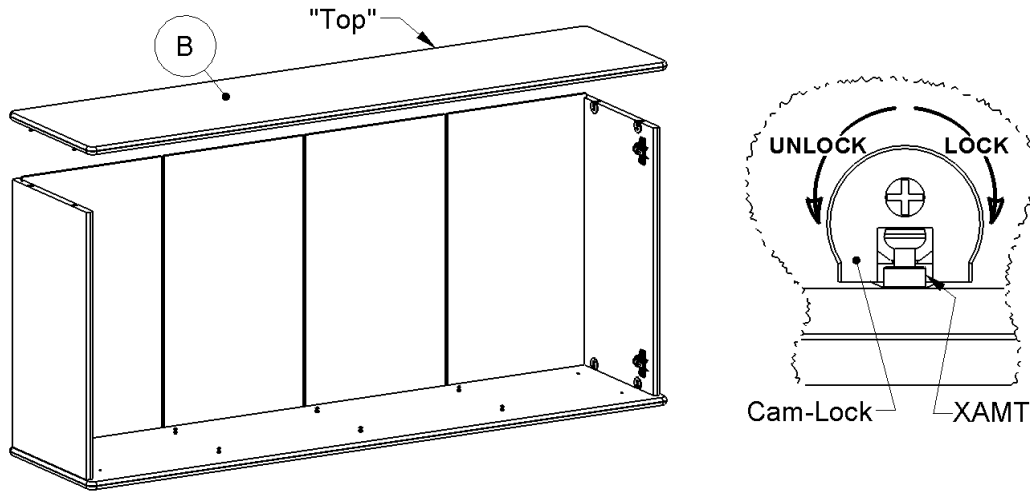

7. Place each **Divider-G** to the LH side of cam-lock bolts and slide into position. Secure by turning cam-lock's metal center with a Phillips Screwdriver ¼ turn clockwise.

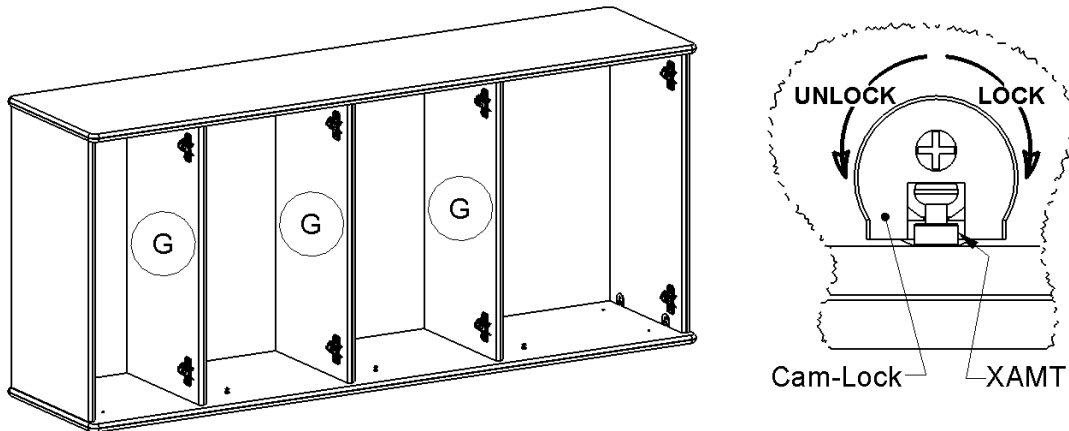

8. Evenly gap hardboard backs with each other and locate pre-drilled holes in the back edge of each Divider. Secure by installing 3-**XAED** 1-5/8" Drywall Screw through Hanging Brace and 3-**XCPT** Washer head Screws between Backs with a Phillips Screwdriver.

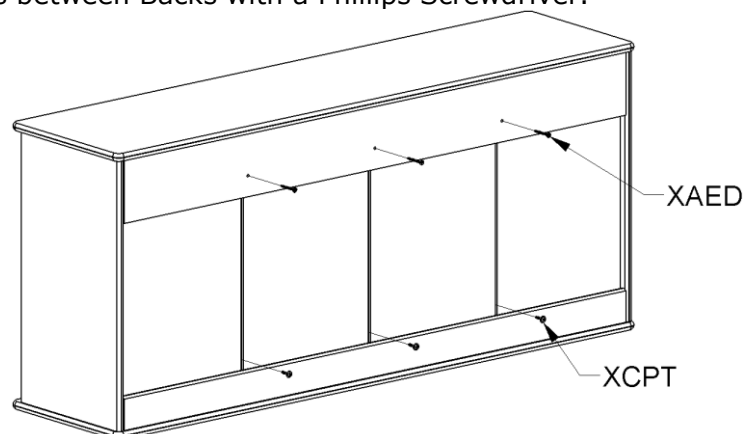

9. Install doors by hooking each hinge on the mounting plate and snapping hinge into place. Hinge can be removed by pushing button on hinge to release.

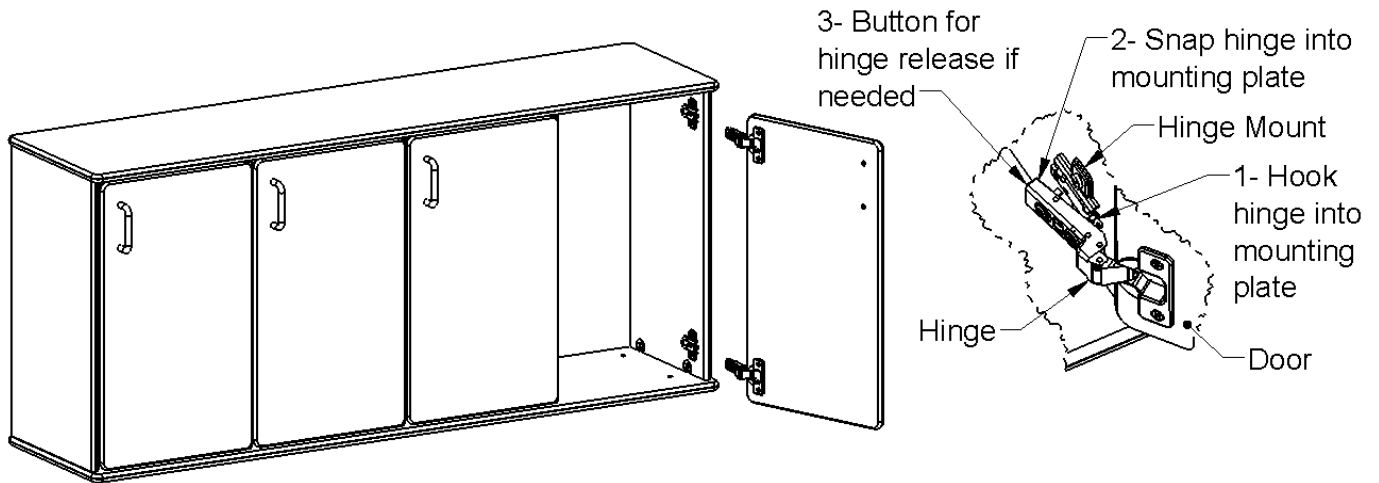

10. Instructions for stacking 2-3 Units and Wall Mounting:

Note: Wall attachment is required when stacking two or three units and is only required on the top unit in the stack.

- Stacking: Stack the units, align, and secure to each other with 4-**XAAD** 1" Drywall Screws through pre-drilled holes in the Bottom and into lower units Top.
- Locate wall studs and secure top unit by installing 2-**XAFH** 3" Drywall Screws through back and into wall.

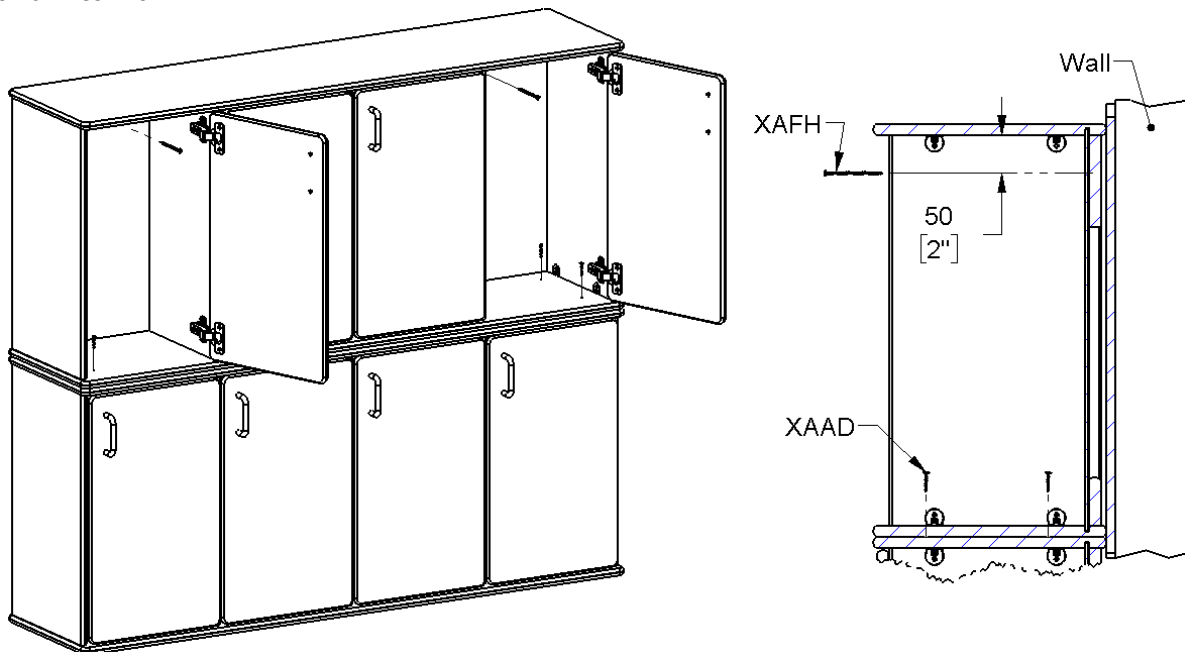

11. If you experience any difficulties when assembling this product, please contact the Jonti-Craft Customer Relations Team at (800) 543-4149 or sales@jonti-craft.com. All other requests for assistance must be directed to your Jonti-Craft Dealer.

General Care & Maintenance Guidelines: www.jonti-craft.com/generalcare