

Thank you for choosing our products. We stand behind our brand and the quality of the items we sell. Replacement parts or products will be sent at our discretion within the 1-year warranty period. Proof of purchase, with the date of purchase as well as photos of the merchandise defect, must be provided. Photos are used to determine the cause of defects and for future quality control. If you have any questions, comments or concerns, feel free to contact us.

# INDOOR/OUTDOOR FOLDABLE TABLE

Read all assembly and care instructions carefully before using this product. Save this manual for future reference.

**Assemble components on a soft, clean surface to avoid damaging the finish.**

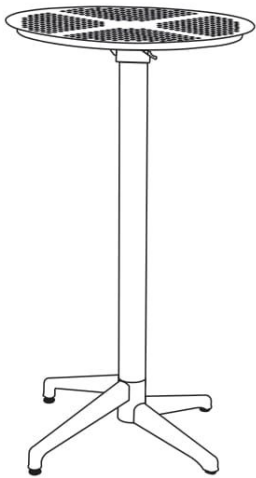

**BAR TABLE**

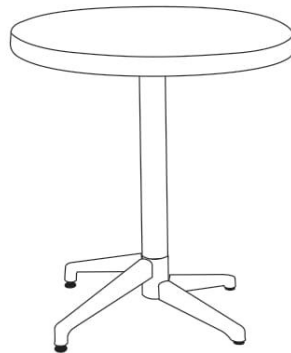

**ROUND TABLE**



**SQUARE TABLE**

PARTS	QTY.
Tabletop	1
Metal Tube	1
Weight-Mounted Threaded Rod	1
Leg Base	1
M10 Nut	2
M10 Lock Nut	1
Washer	1



Inspect packaging to ensure all parts are accounted for before disposing of packing materials.

## TOOLS REQUIRED (NOT INCLUDED)



17mm Combination Wrench

## ⚠️ WARNING ⚠️

**CHOKING HAZARD** — This item contains small parts that can be swallowed by children. Keep children away during assembly.

# ASSEMBLY

*Read carefully and understand assembly before beginning.*

*Images may vary from actual product - assembly is the same for all table styles.*

*Include washers and fasten hardware equally and tightly - failure to do so may cause table to crack and break.*

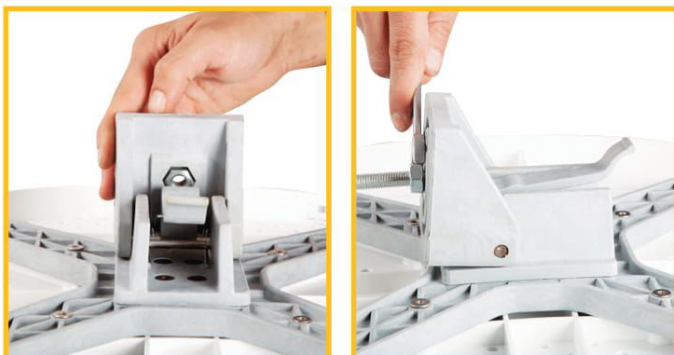

## STEP 1

Lay the tabletop face-down on a smooth, clean surface. Remove the pin and open the folding mechanism. Remove the outside M10 nut from the longer side of the threaded rod. Place the nut inside the folding mechanism on the tabletop, as shown. Screw the threaded rod into the nut in the folding mechanism. Secure the threaded rod by tightening the M10 nut, as shown.



## STEP 2

Flip the folding mechanism upright. Remove the lock nut and washer from the threaded rod.

Slide the metal tube over the weight-mounted threaded rod, ensuring the notch in the tube is aligned with the backside of the folding mechanism.

Place the leg base onto the metal tube, ensuring the notches align, as shown.

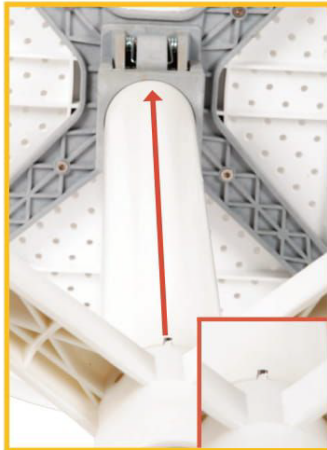

## STEP 3

Ensure the notch in the metal tube and leg base are aligned with the folding mechanism, as shown.

On the underside of the leg base, place the washer over the threaded rod.

With the flat side down, screw the M10 lock nut onto the threaded rod. Securely fasten the lock nut with a wrench.

**NOTE:** The lock nut must be tightened with a wrench to ensure functionality and stability of the table.

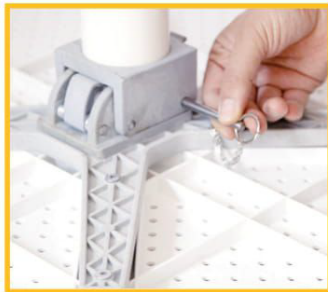

## STEP 4

Secure the tabletop by inserting the pin into the folding mechanism, as shown.

## Care & Maintenance

**SAFE USE:** Never sit or stand on the table.

**INSPECT:** Periodically check assembly points and tighten fittings as necessary.

**COVER:** When not in use, covering the table with a breathable cover will help protect it from the harmful effects of sunlight, dust build-up, and collecting debris.

**WINTER CARE & STORAGE:** Protect this item from inclement weather, especially ice and snow. Move the table to a cool, dry indoor location. Covering the table while in storage is recommended to help prevent dust build-up.

## Cleaning

 DO NOT USE BLEACH

 DO NOT USE A PRESSURE WASHER

Mix mild soap with warm of warm water, then wash the table frame using a soft cloth. Thoroughly rinse soap residue off the table. Dry with a soft cloth. Do not use harsh chemicals or abrasive materials to clean the table.

Any modification or failure to follow the recommended care will void the product warranty.

## WARNING:

Manufacturer and seller expressly disclaim any and all liability from personal injury, property damage or loss, whether direct or indirect, or incidental, resulting from the incorrect attachment, improper use, inadequate maintenance, or neglect of this product.