

Assembly Instructions

⚠ Before you throw the carton, please ensure that you have all the parts needed for the assembly.

⚠ **Hardware Note:**

1. For each step please don't fully tighten all the screws at first, when they all align to the holes you can fully tighten them.

2. All the bolts should be assembled **vertically** to the holes.

⚠ Back can be found in the **bottom** of the seat. We attached velcro on the black fabric.

⚠ **Spare parts** can be found in the hardware box if you do not have enough bolts for assembly.

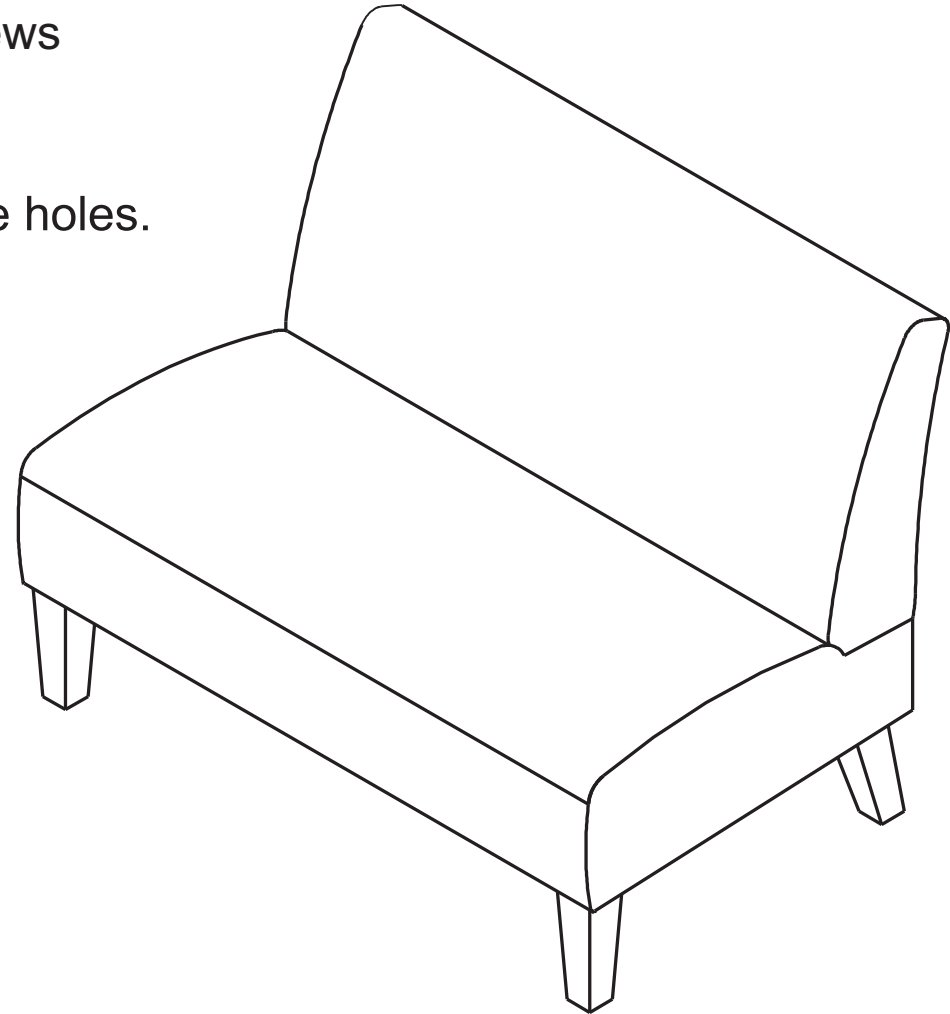
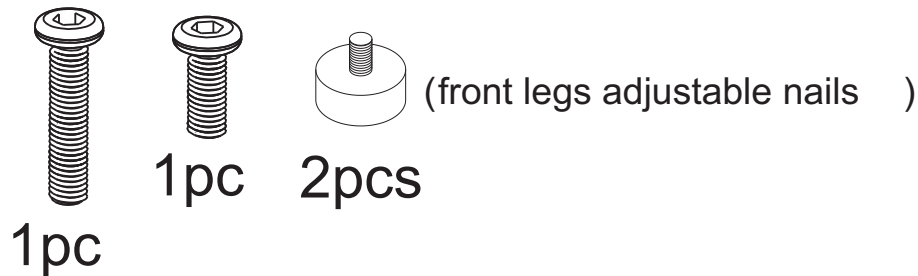

⚠ THIS INSTRUCTION BOOKLET CONTAINS IMPORTANT SAFETY INFORMATION. PLEASE READ AND KEEP FOR FUTURE REFERENCE.

Assembly Instructions

Parts and Hardware

Please check to make sure you have all parts and hardware before starting assembly process.

①

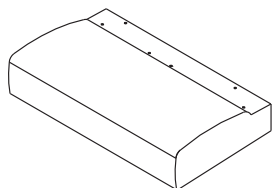

Seat 1pc

②

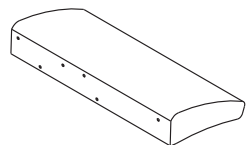

Back 1pc

③

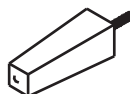

Front leg 2pcs

④

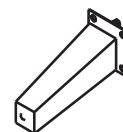

Left back leg 1pc

⑤

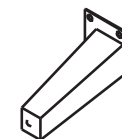

Right back leg 1pc

A

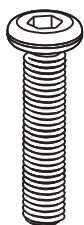

5/16in dia
2-1/2in length
6pcs

B



Spring washer
6pcs

C



Flat washer
8pcs

D



1/4in dia
3/4in length
6pcs

E



Wrench
1pc

F



Plastic washer
4pcs

G

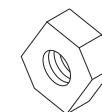

Nut
2pcs

H

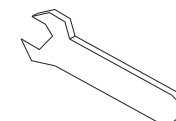

Wrench
1pc

Assembly Instructions

Assembly Instruction

Step 1: Take the back from the bottom of the seat.

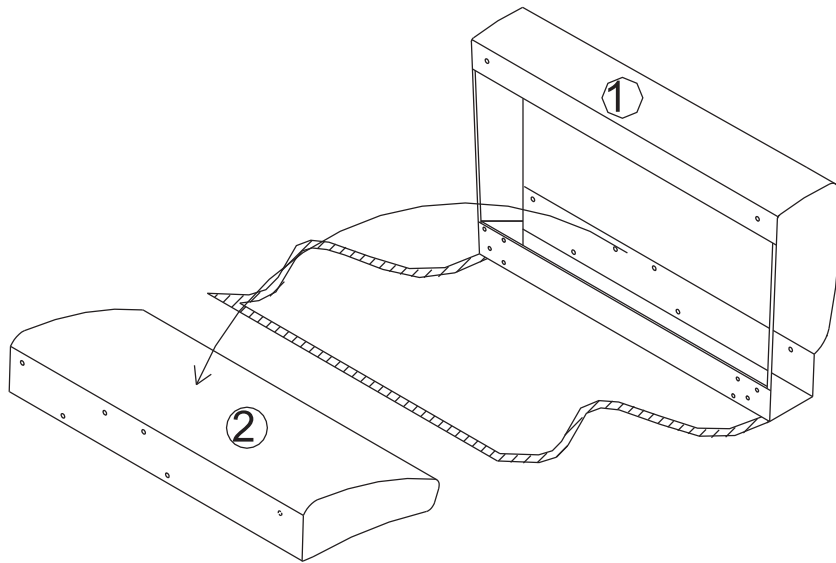

Step 2: Put back on seat as below diagram show. Use long bolts to connect the back and seat. Turn all 6 bolts **50%** by hand one by one, then fully tighten all the 6 bolts by the short side of wrench (E).

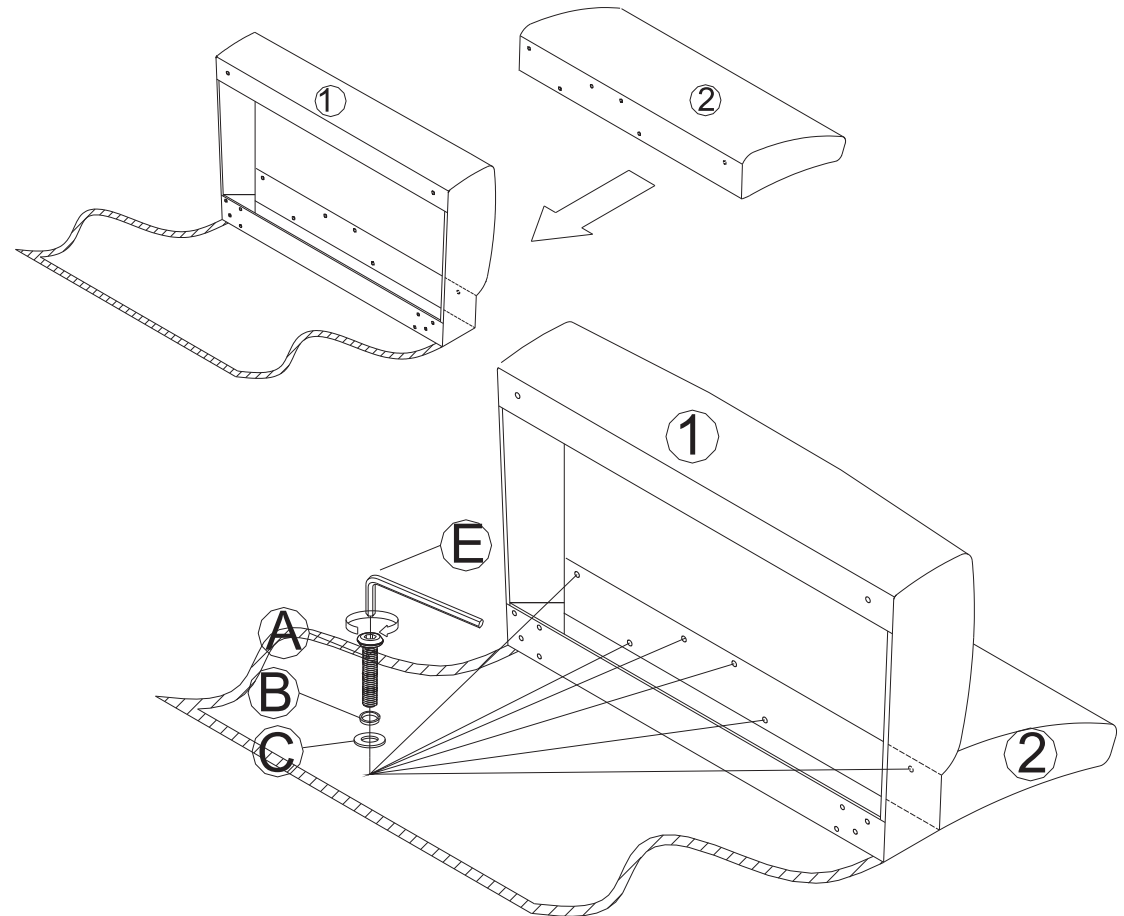

Assembly Instructions

Assembly Instruction

Step 3: Assemble the back legs to seat as below diagram show. Turn in the legs until 3 holes on metal plate align to the holes on seat. Use **G** & **C** to fix legs, tighten by wrench **H**.

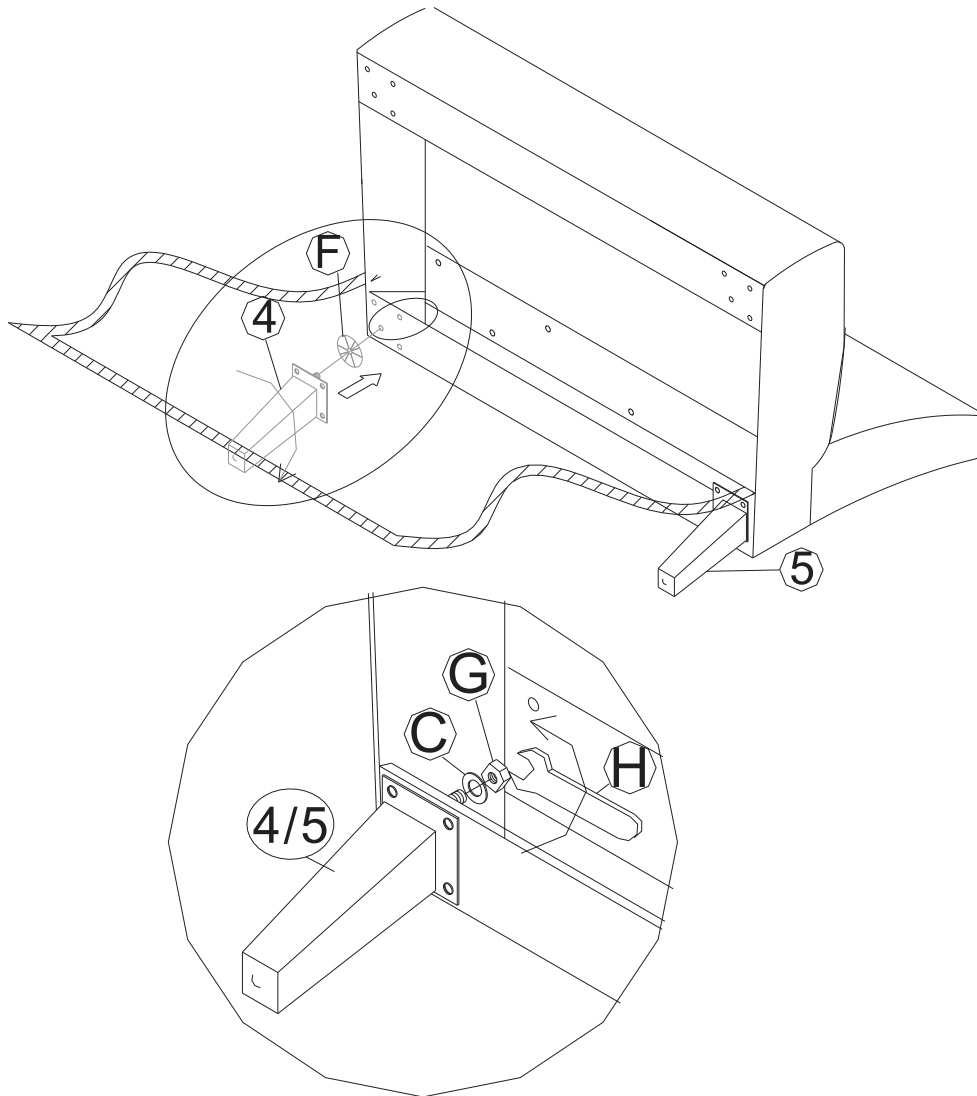

Step 4: Close the fabric of the seat by velcro. Use bolts **D** to fix back legs. Turn the bolts about 3 turns by hand (one back leg need 3 bolts), after all 6 bolts were assembled about 3 turns tighten them by the short side of wrench.

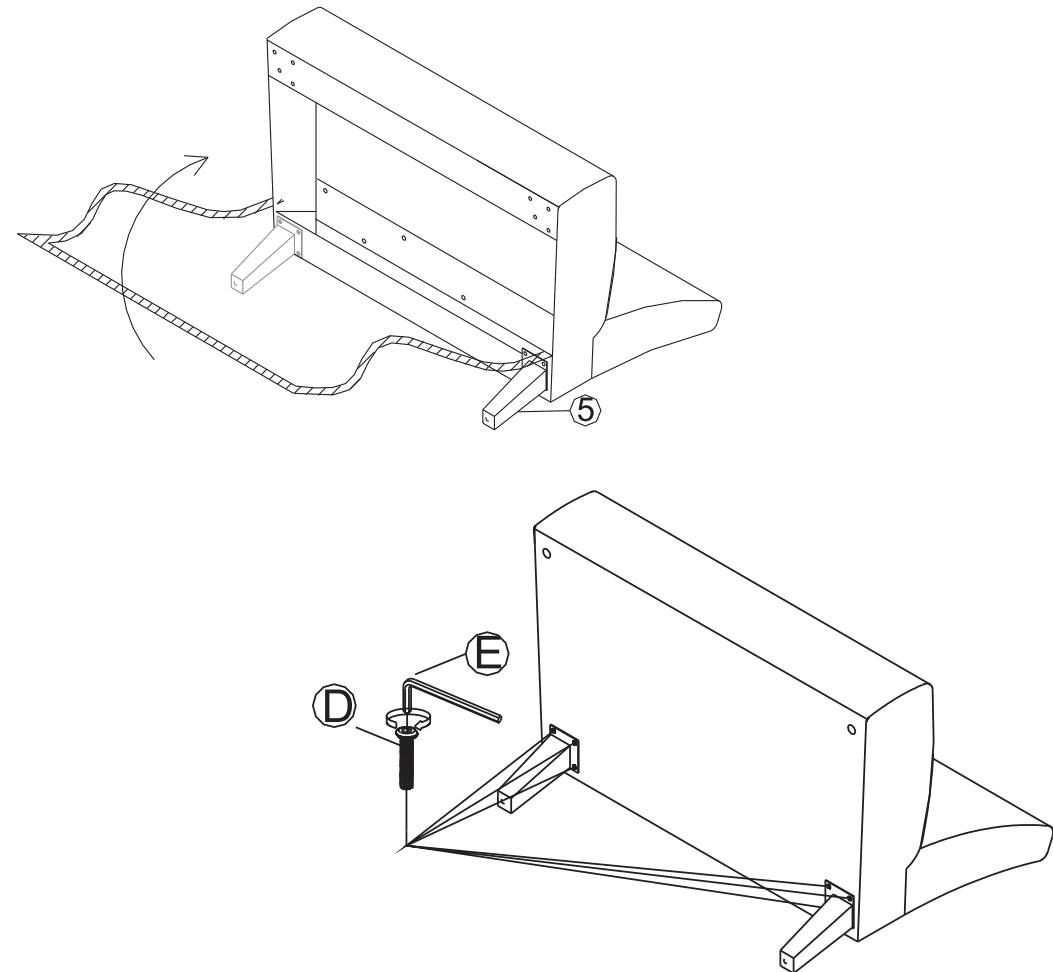

Assembly Instructions

Assembly Instruction

Step 5: Turn front legs by hand(see below diagram).

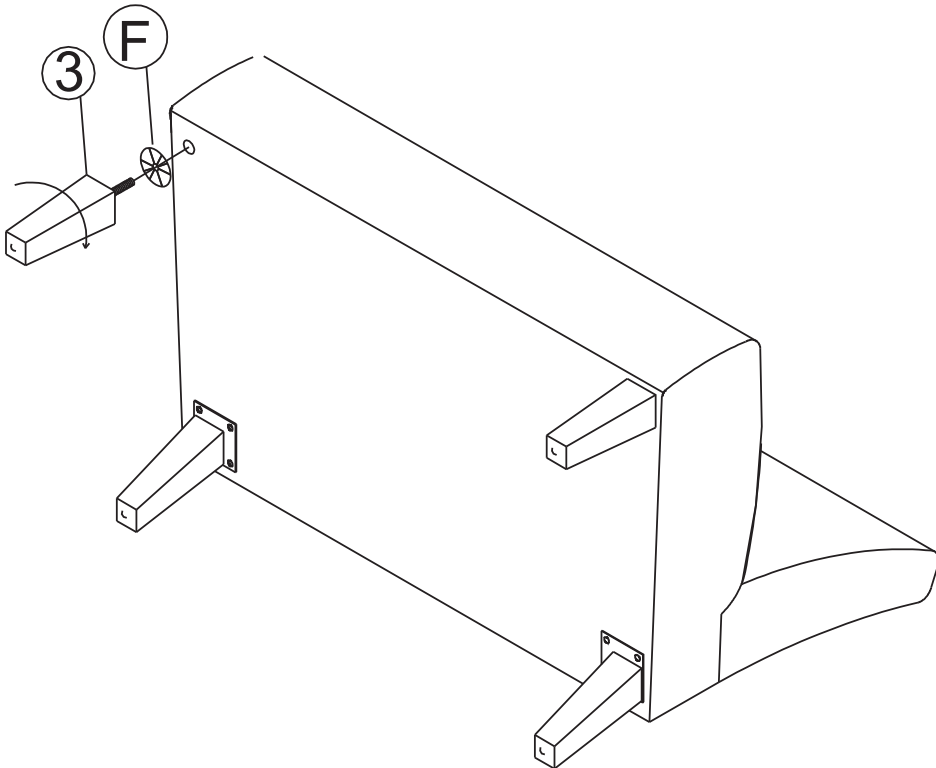

Step 6: If the loveseat is not steady, please adjust the front legs until the 4 legs are on the same level.

