

1. Loosen the nuts at the ends of the flat bar

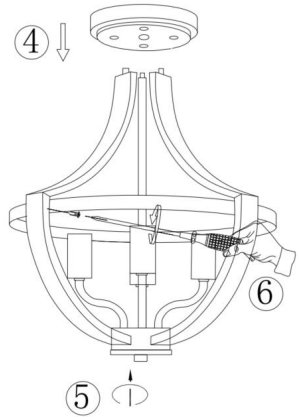

4. Align the hole on the disc with the flat bar, then clip it in and lock it with a nut.

5. Tighten the flat bar and ball nut under the lamp body.

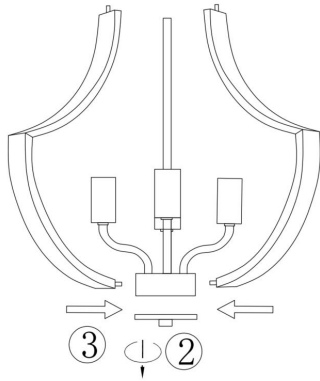

2. Loosen the ball nut under the lamp body.

3. Insert the flat bar into the lamp body and screw on the nut. **Be careful not to tighten.**

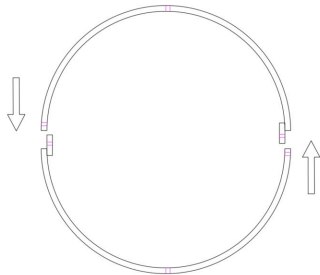

6. Put the iron ring into the lamp body and lock them with screws.

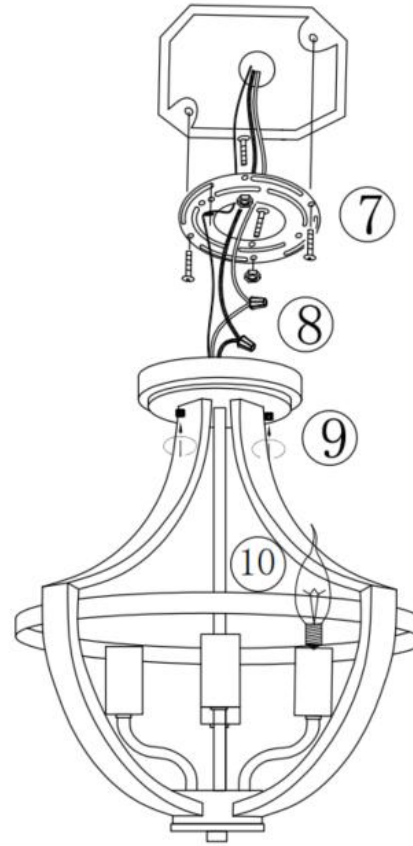

7. Attach the cross bar to the outlet box by using two mounting Screw.

8. Pull out the source wires from the outlet box. Making wire connection using wire nuts.

9. Attach the fixture body to the cross bar by inserting headless screws into holes on the back plate, and then screw it with two ball nuts.

10. Install E12 bulbs(not included).

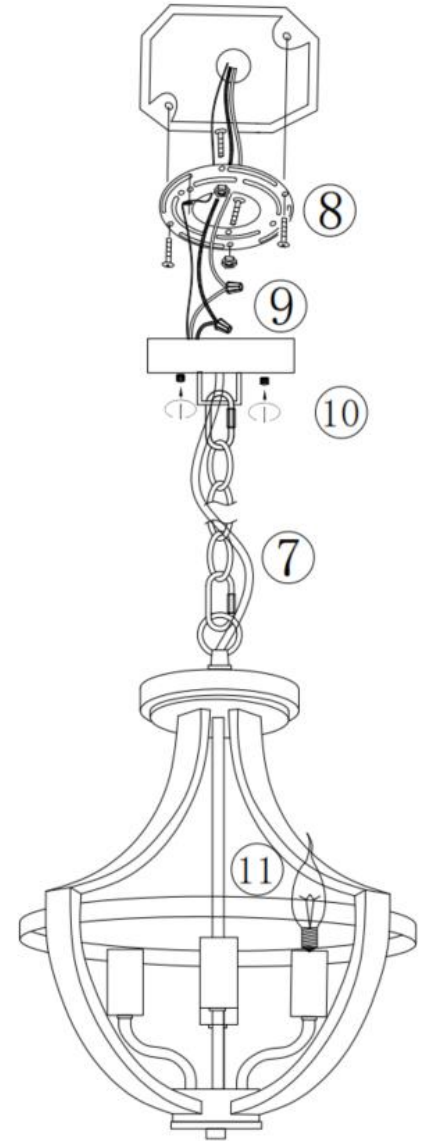

If you use it as a chandelier, you need to install a hanging chain .