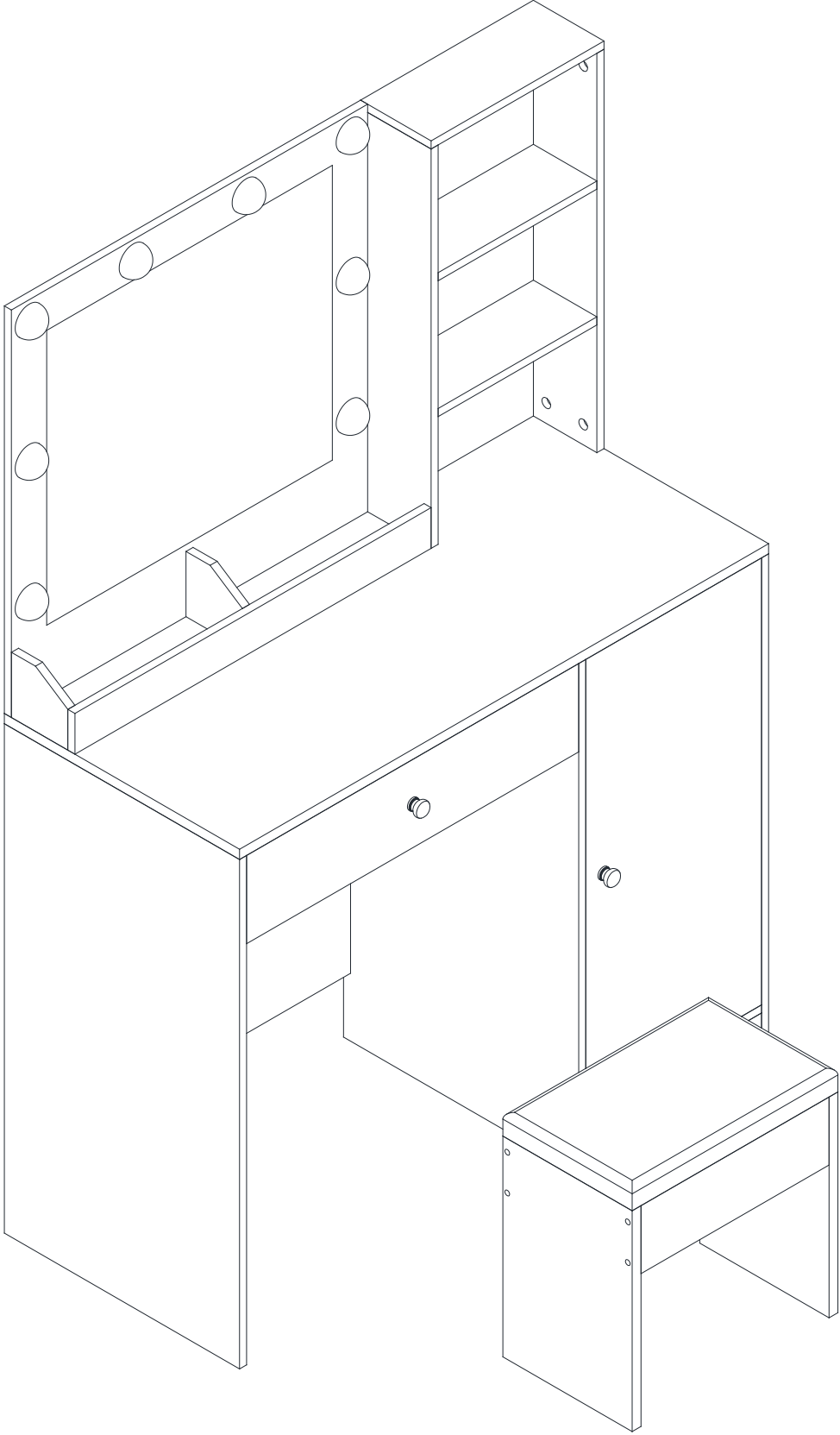

ASSEMBLY INSTRUCTION

An icon depicting two stylized human figures in overalls, representing the number of people required for assembly. Below them is a circular clock face with numbers 3, 6, 9, and 12, and a hand pointing to the 2 o'clock position. To the right of the clock, the text "120 min" is displayed, indicating the estimated assembly time.

120 min

! SAFETY WARNINGS !

1. Please read the instructions fully before assembly. These instructions include important information which could ensure correct assembly. We have been working on providing high quality products for you. However, in the rare instance that your product is defective, missing parts or there are some issues, please don't hesitate to contact our customer service to submit parts requirements, assembly suggestion, or warranty claims, and we will give the best solution as soon as possible. If necessary, we need you to provide some more clear pictures of the issue.
2. Insert the screws in holes and tighten the screws, but not too tight, 70% is ok, finally tighten all the screws. If some issues happened that some screws can not target to the hole or some parts are difficult to install, please adjust the tightness of the screws.
3. 2 people are recommended to finish.



Ax61



Bx61

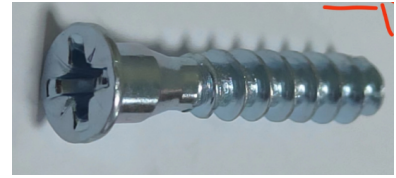

Cx12



Dx24



Ex2



Fx2



Gx1



Hx2

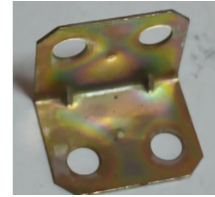

Lx2



Mx1

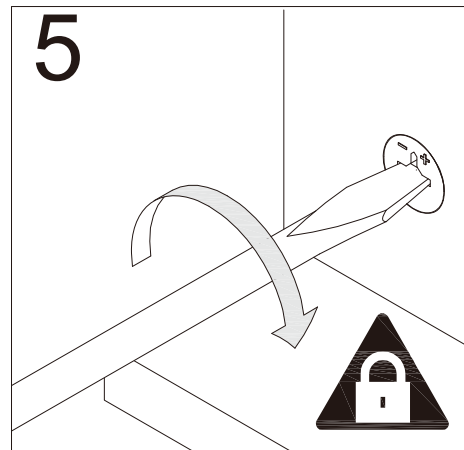
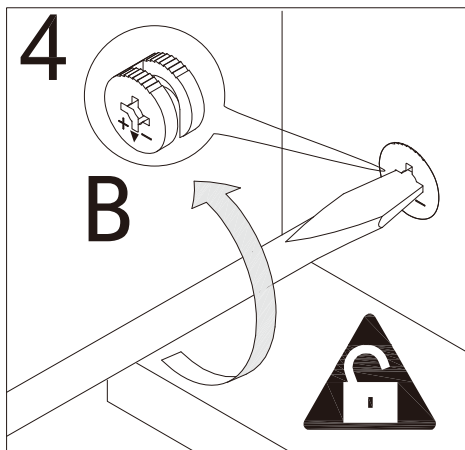
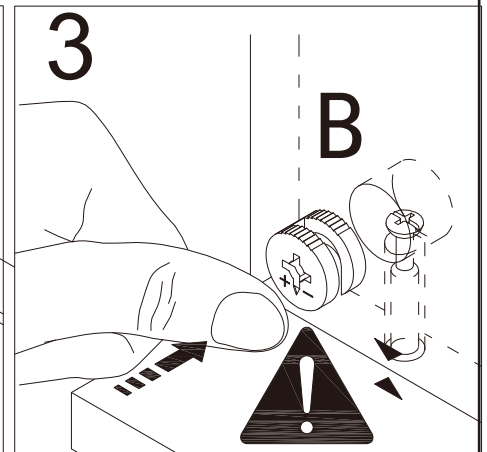
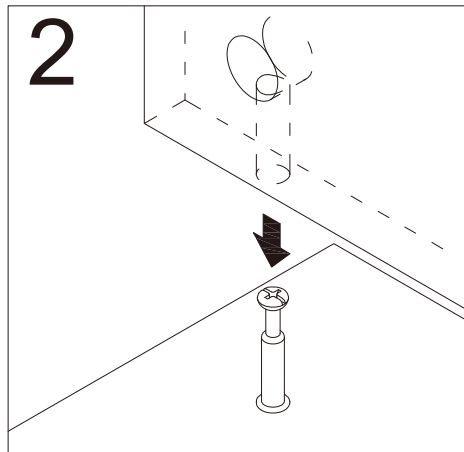
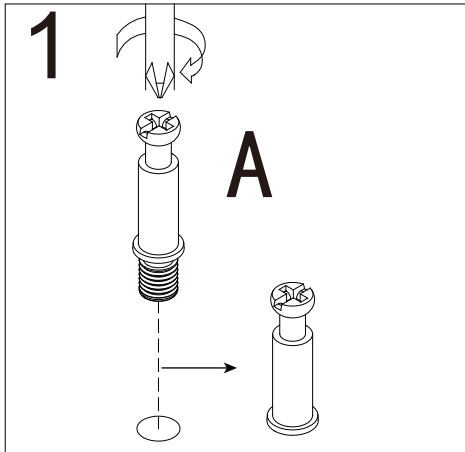

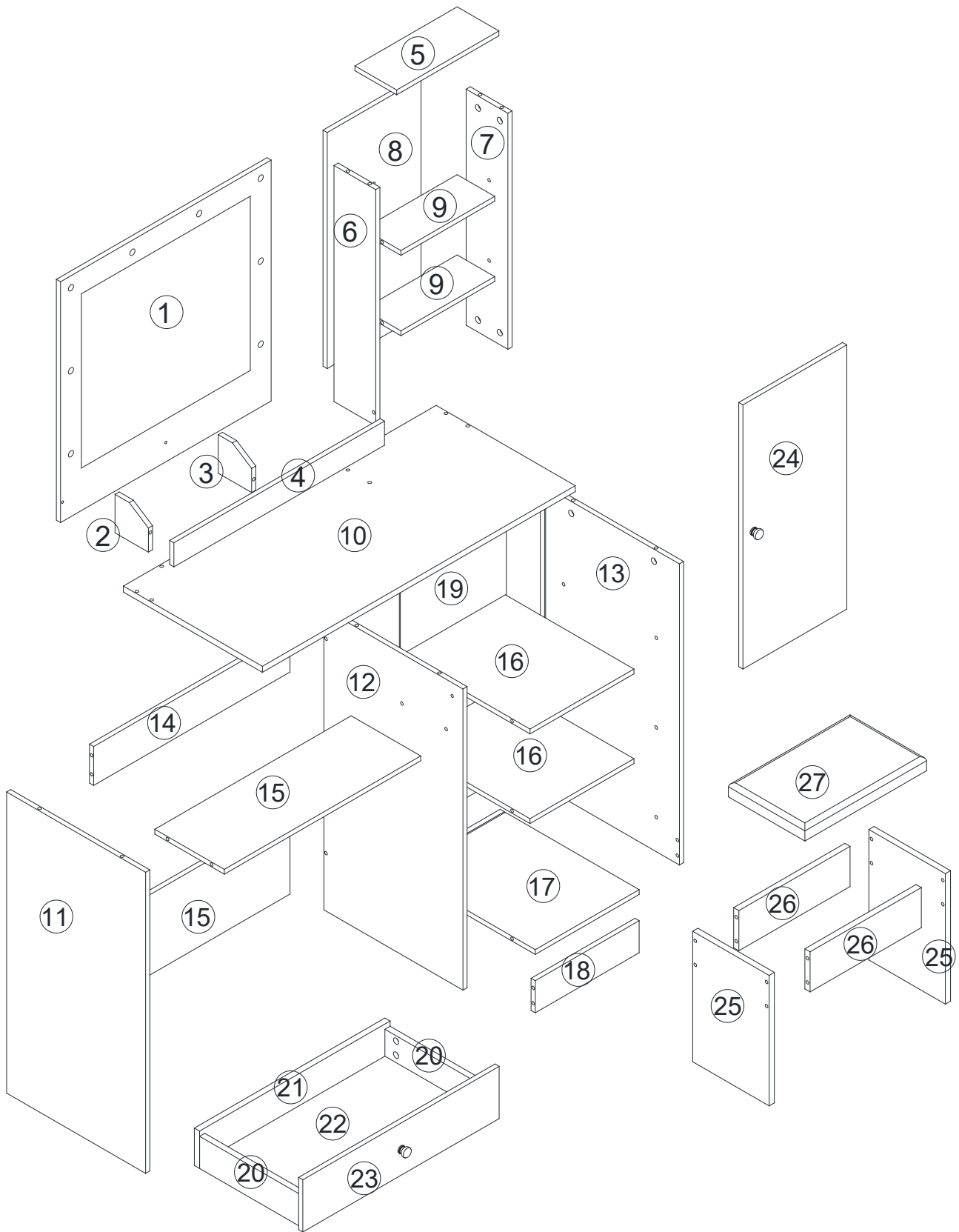

1 - xl	6 - xl	11 - xl	16 - x2	21 - xl	26 - x2
2 - xl	7 - xl	12 - xl	17 - xl	22 - xl	27 - xl
3 - xl	8 - xl	13 - xl	18 - xl	23 - xl	
4 - xl	9 - x2	14 - xl	19 - xl	24 - xl	
5 - xl	10 - xl	15 - x2	20 - x2	25 - x2	

STEP 1

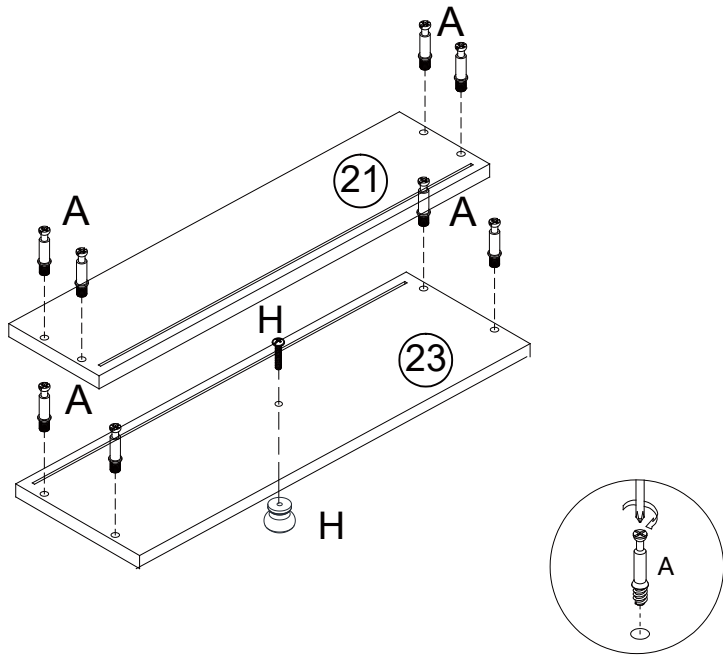

STEP 2

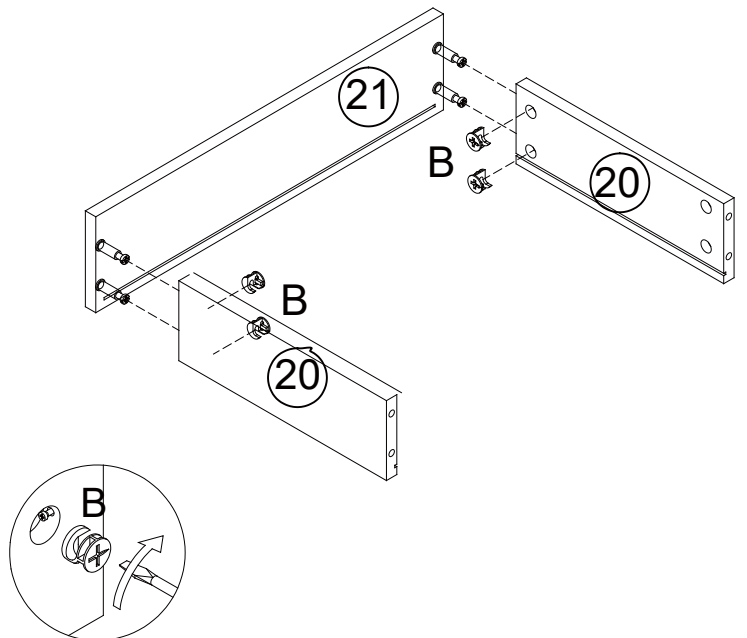

STEP 3

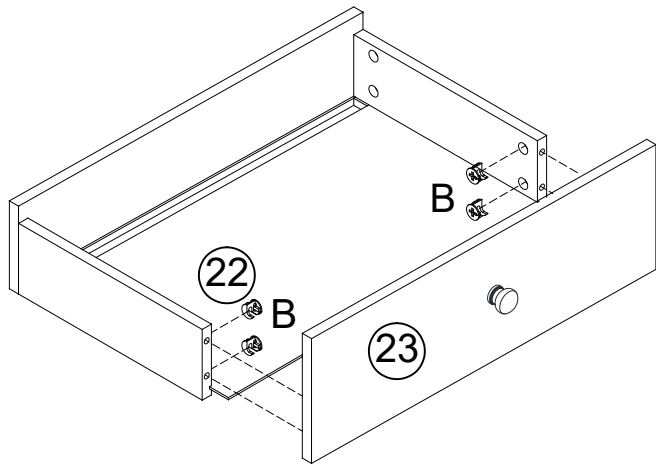

STEP 4

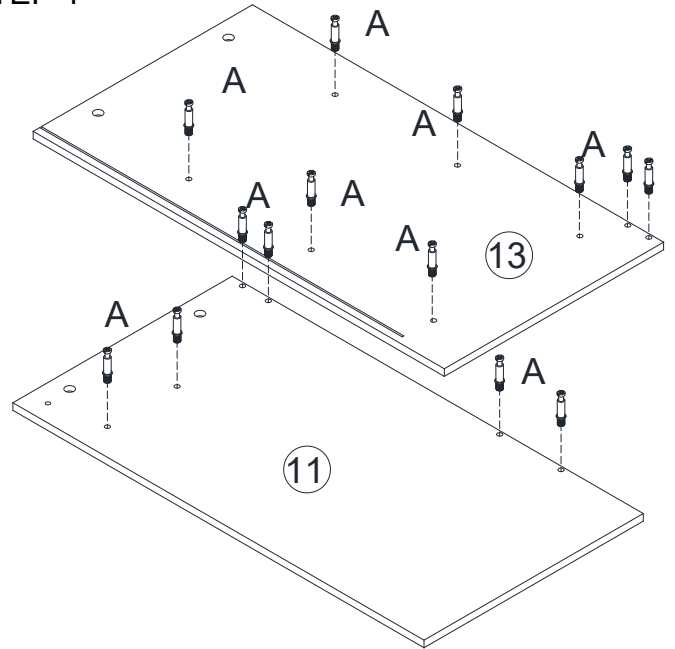

STEP 5

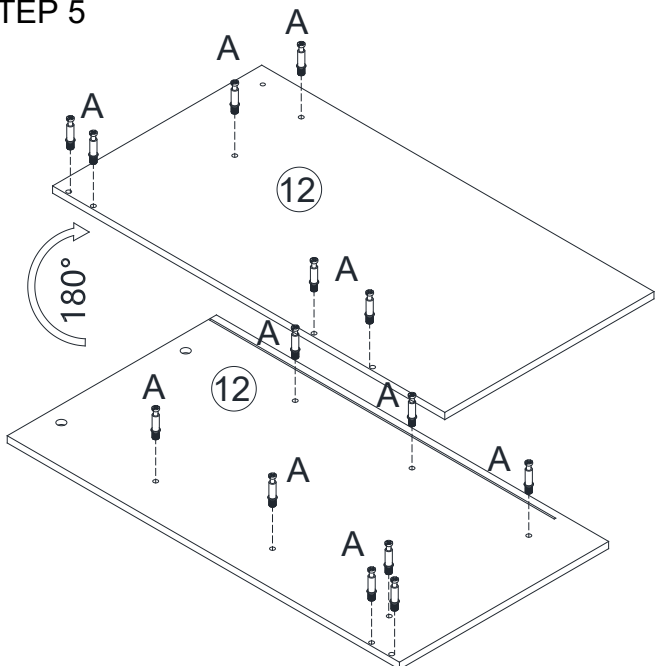

STEP 6

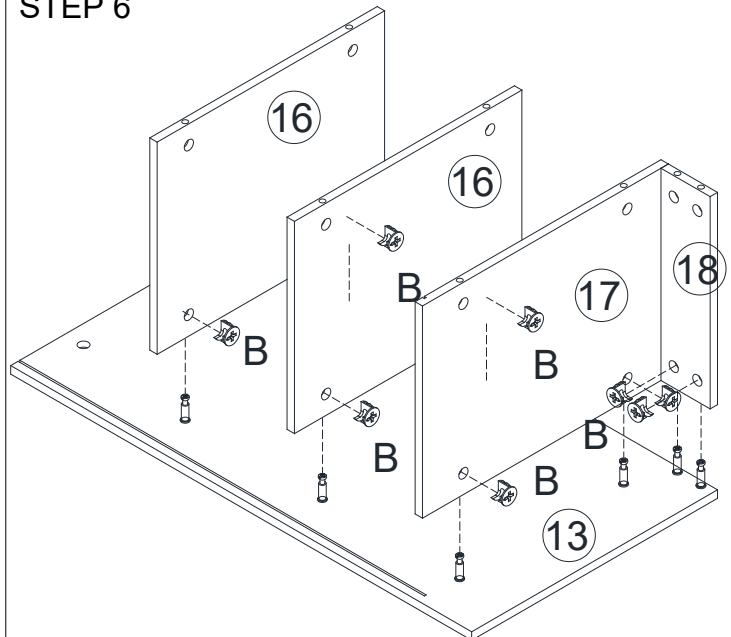

STEP 7

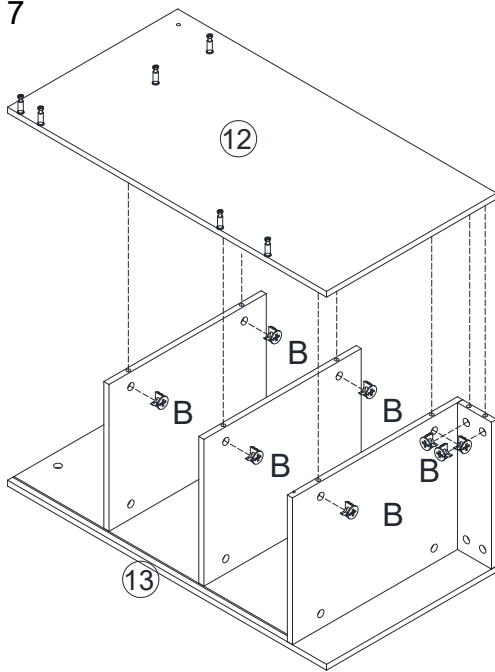

STEP 8

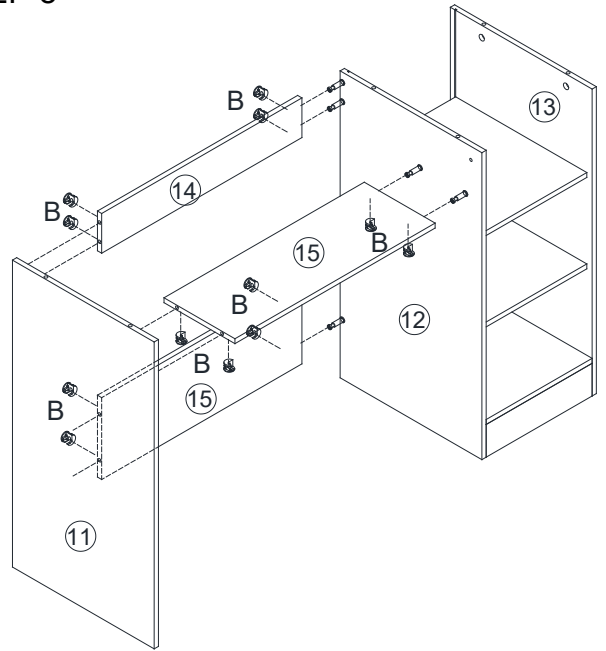

STEP 9

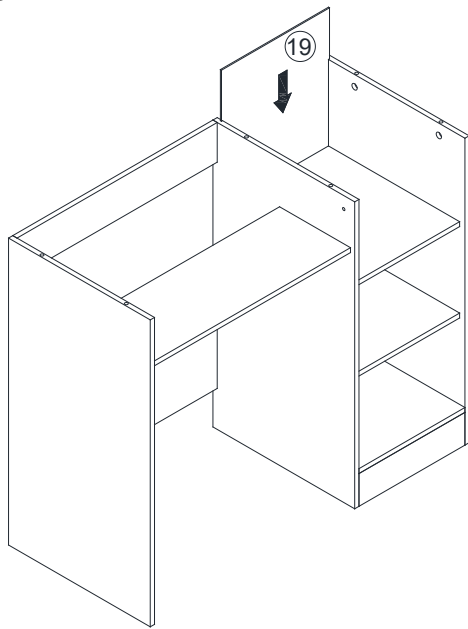

STEP 10

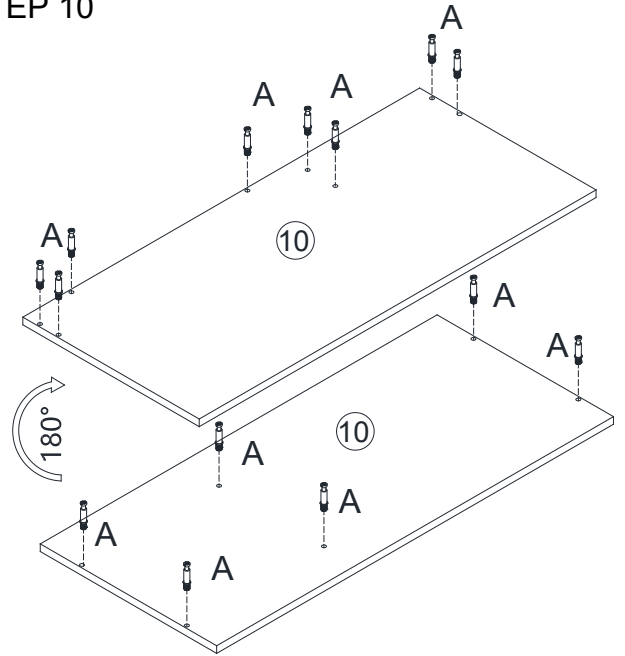

STEP 11

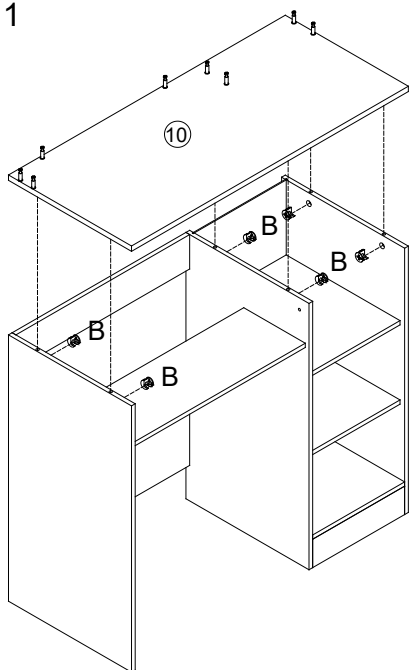

STEP 12

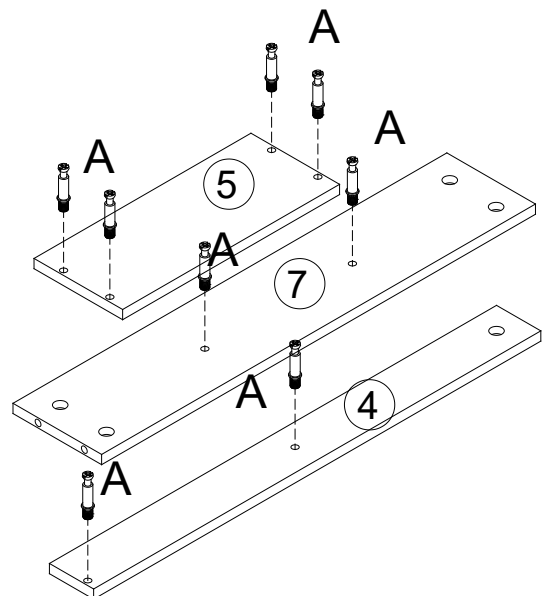

STEP 13

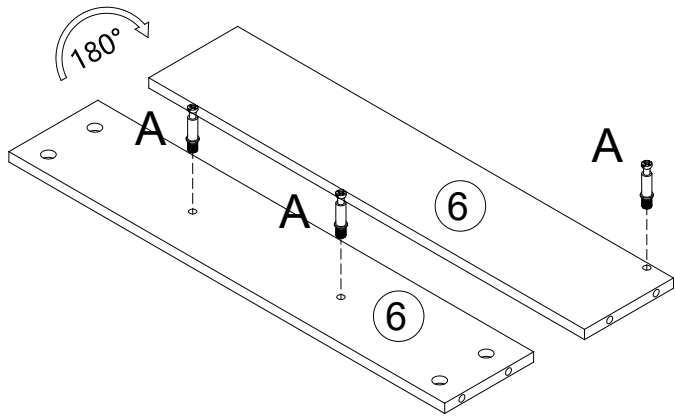

STEP 14

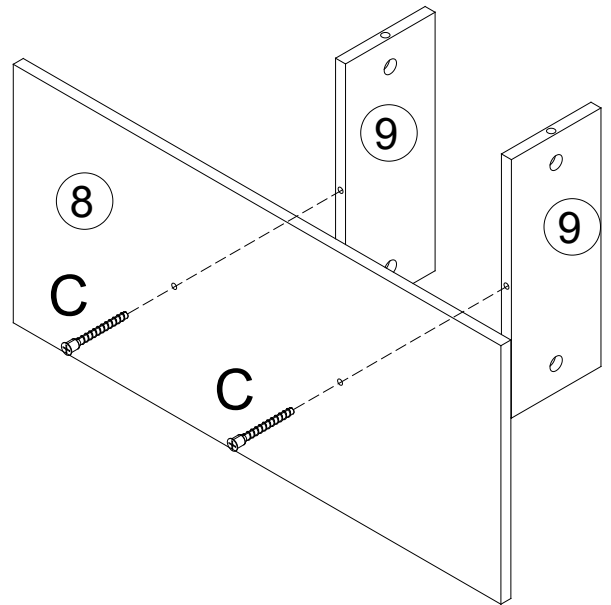

STEP 15

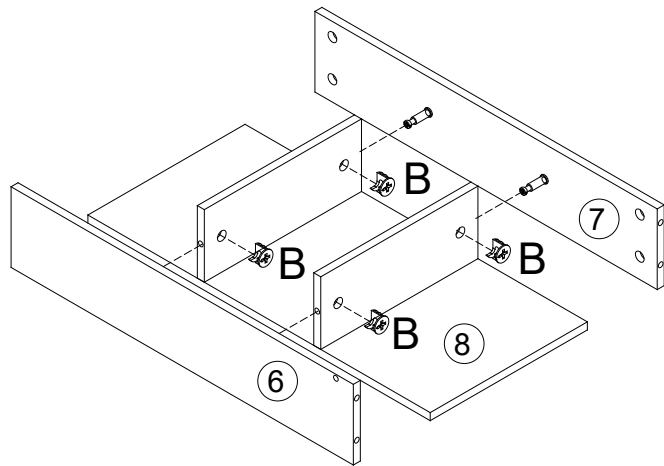

STEP 16

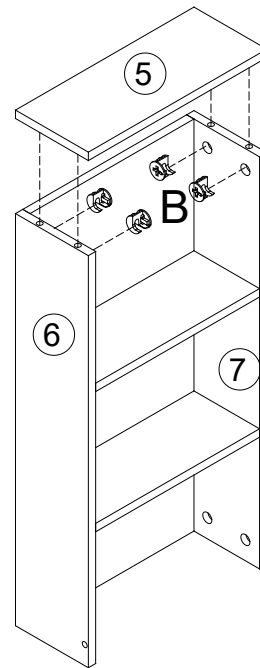

STEP 17

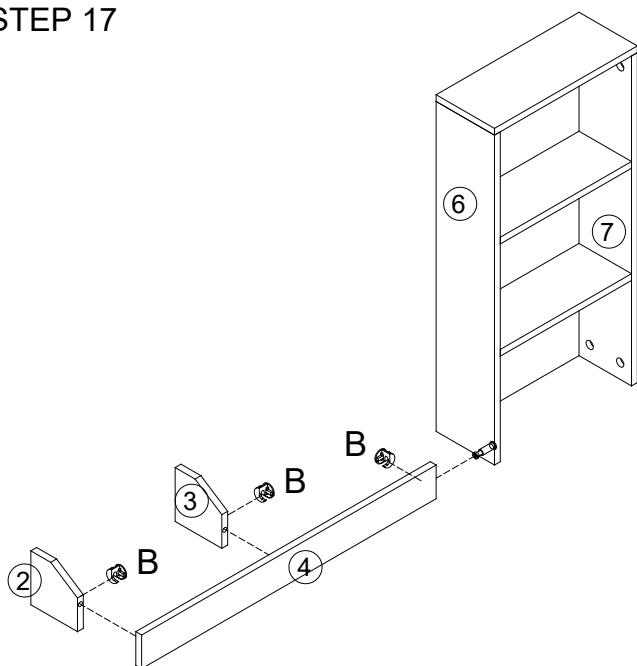

STEP 18

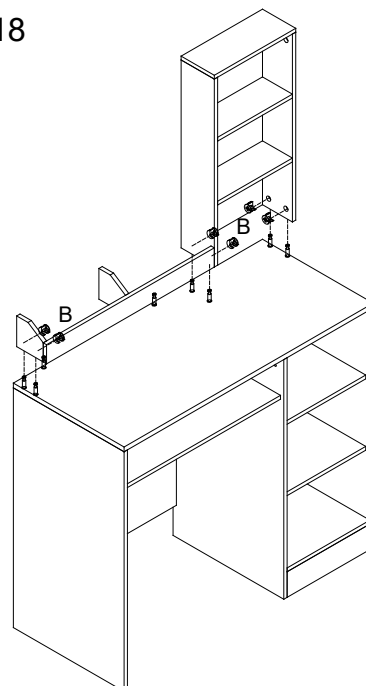

STEP 19

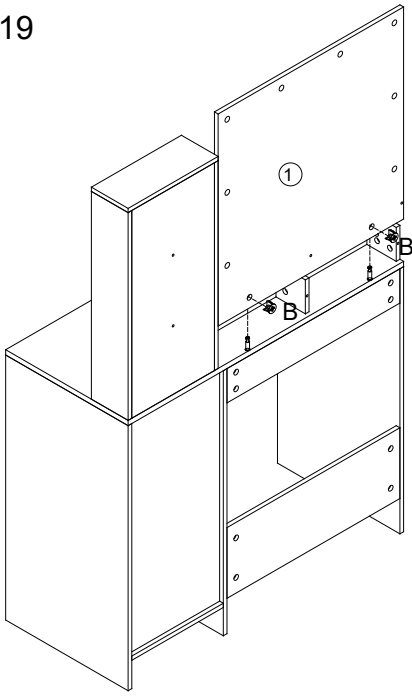

STEP 20

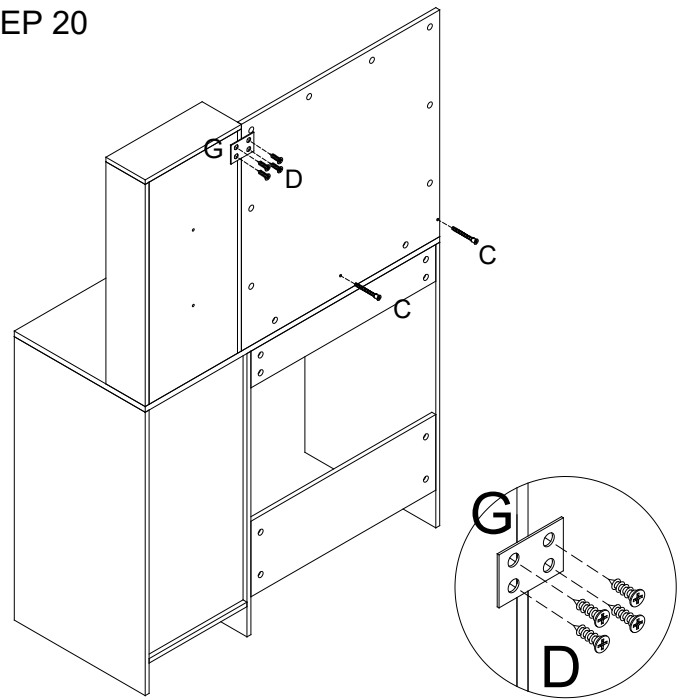

STEP 21

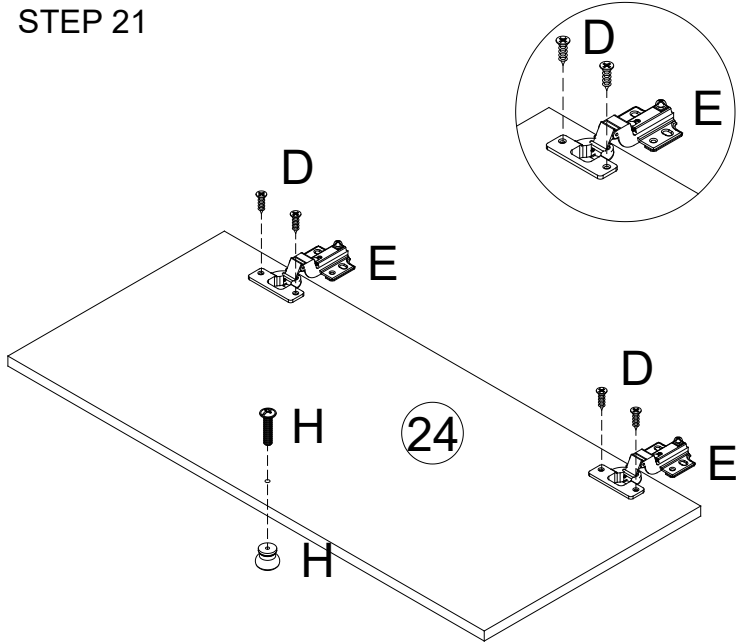

STEP 22

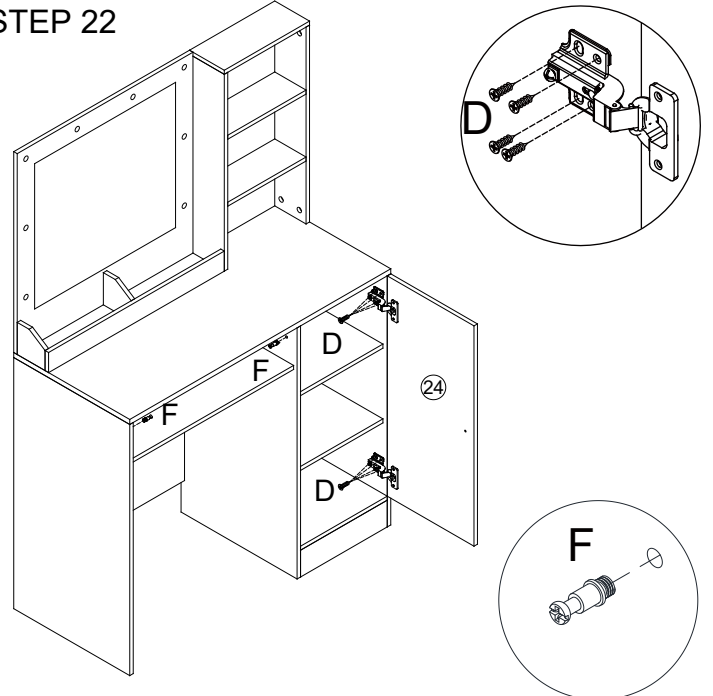

STEP 23

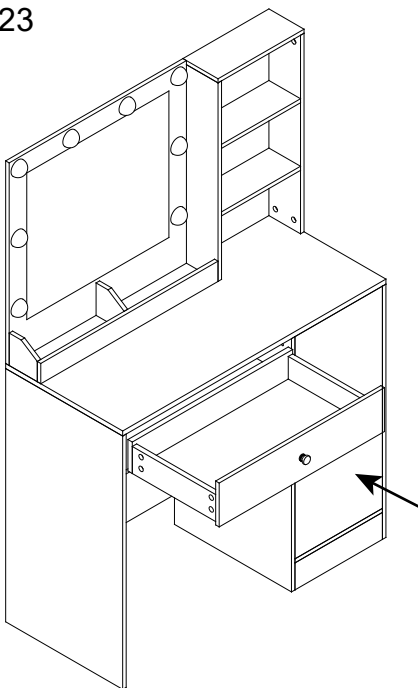

STEP 24

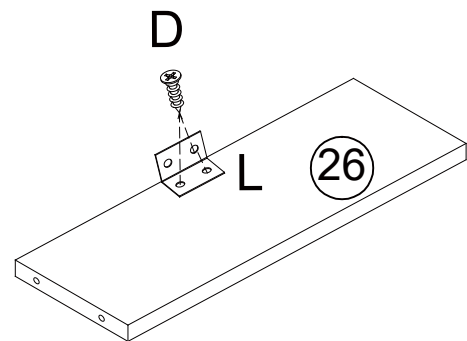

STEP 25

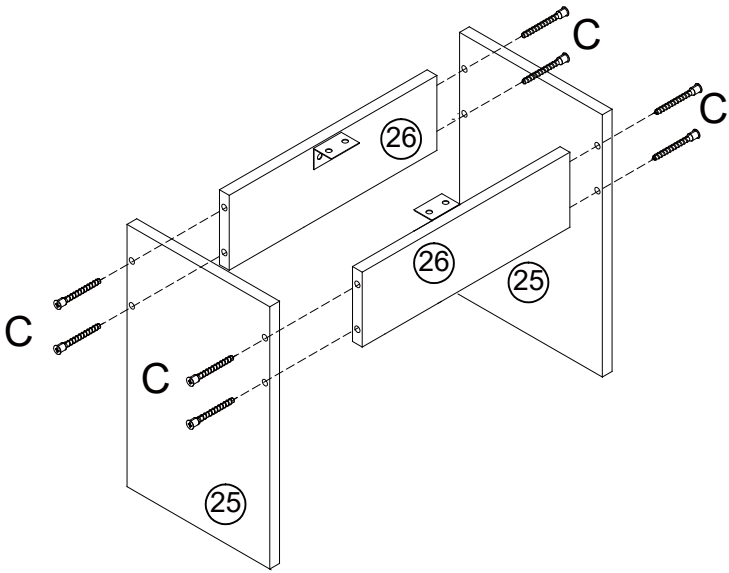

STEP 26

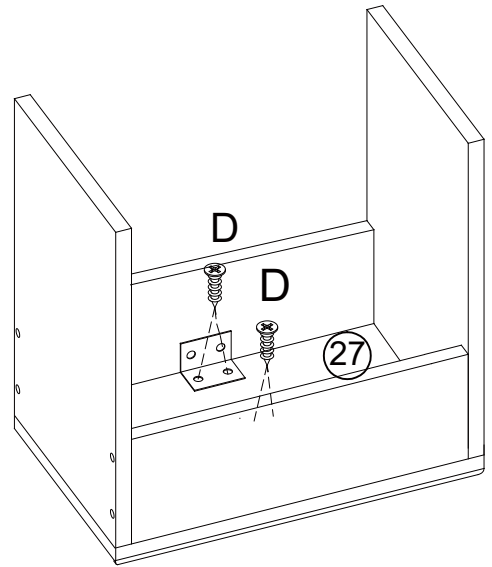

STEP 27

