

Queen Poster Headboard

IMPORTANT

Carefully remove all the parts from the carton and place them individually on a soft cloth to prevent scratches or other damage.

Carefully and strictly follow these assembly instructions to ensure a completed product as designed.

Do not use power tools above 8 volts to assemble.

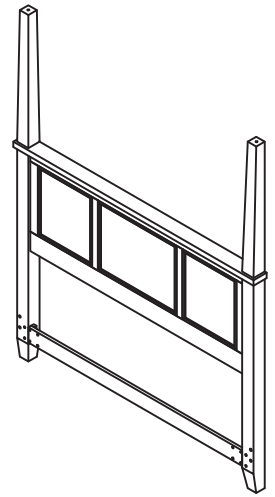

Part List

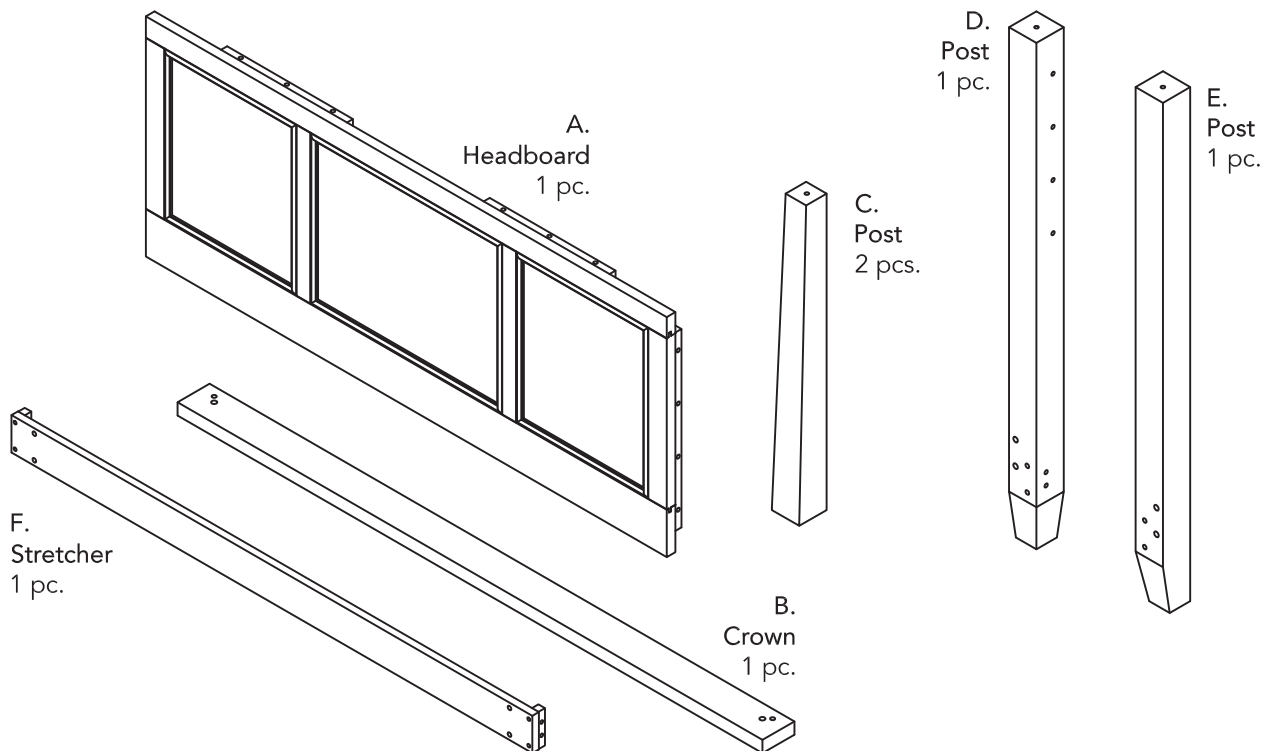

Hardware List



M6x40
Head Cap Bolt
18 pcs. (+1 extra)



Flat Washer
18 pcs. (+1 extra)



Hex Wrench
1 pc.



Small Hex Wrench
1 pc.



Bolt (5/16"x4")
2 pcs. (+1 extra)



Square Washer
2 pcs. (+1 extra)



Nut
2 pcs. (+1 extra)



Wrench
1 pc.



Wooden Dowel
2 pcs. (+1 extra)

Assembly Instructions 2/3

IMPORTANT

- Use a soft cloth between these parts and the floor.
- Do not use power tools above 8 volts to assemble.
- Do not tighten up all the bolts until each part is properly assembled.
- Keep Wrench and Hex Wrench as the bolts and nuts may need to be tightened in the future.

STEP 1

Attach Posts (D) and (E) to Headboard (A) with Head Cap Bolts and Flat Washers.

Attach Stretcher (F) to unit with Head Cap Bolts and Flat Washers.

Tighten Head Cap Bolts with Hex Wrench.
(See Figure 1)

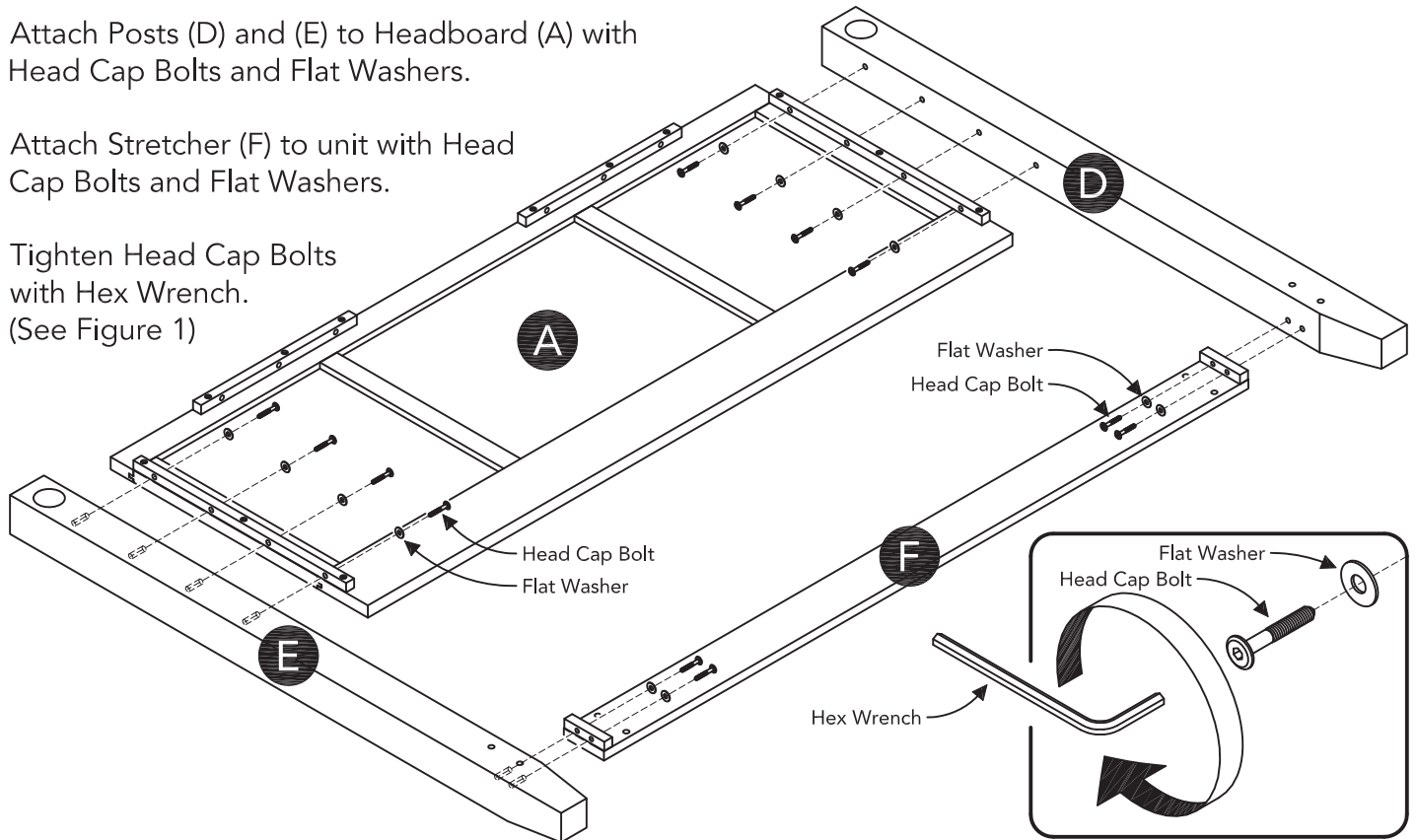
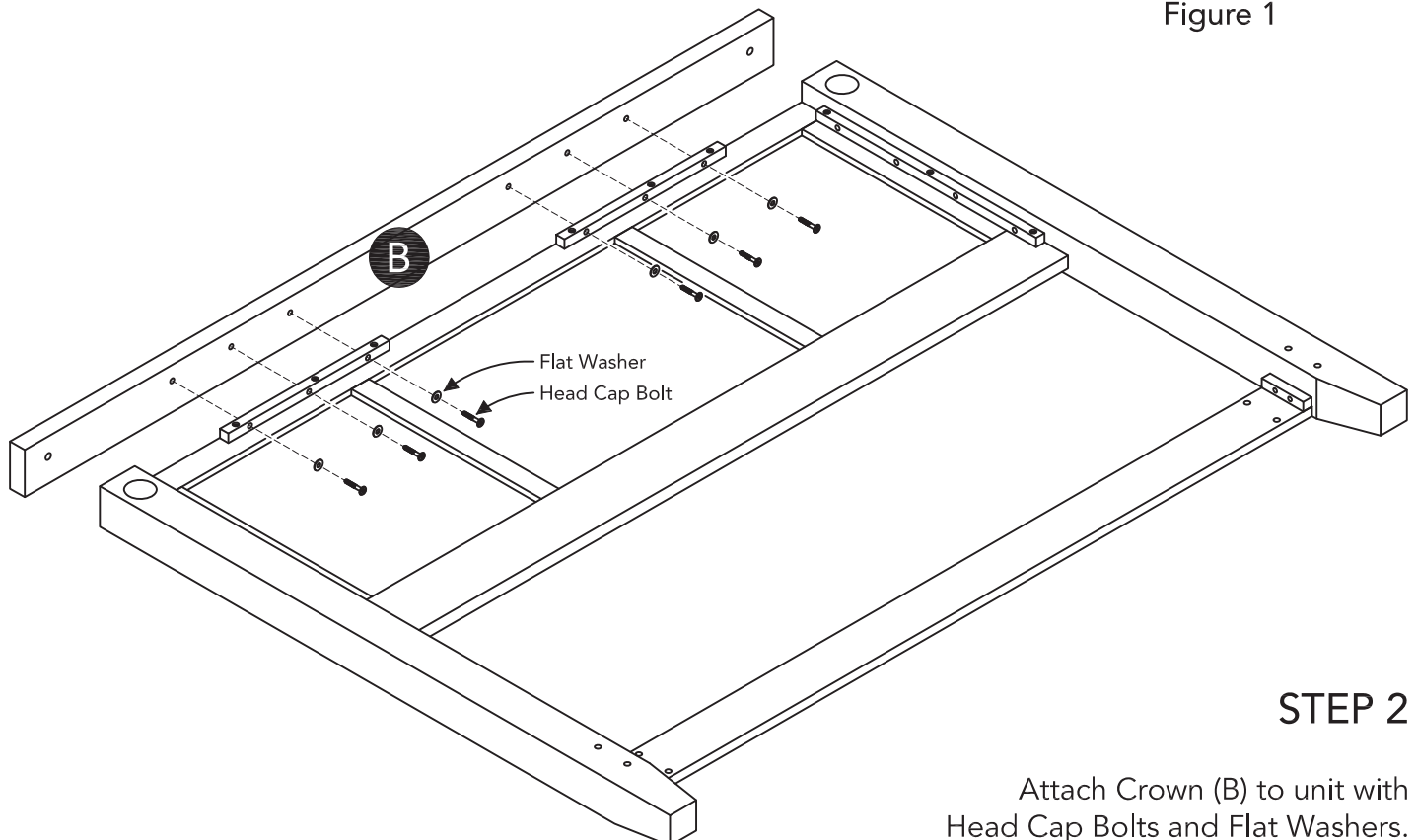

Figure 1



STEP 2

Attach Crown (B) to unit with Head Cap Bolts and Flat Washers.

STEP 3

Insert Bolts into Posts (C), then tighten.

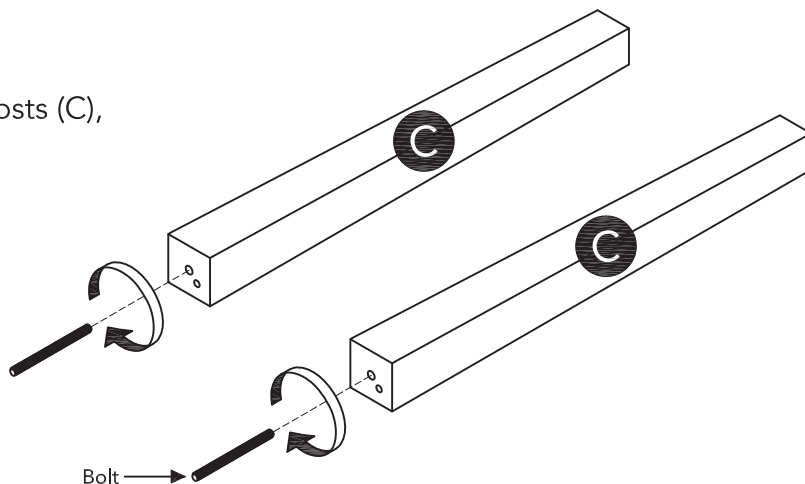

STEP 4

Attach Posts (C) to unit with Square Washers, Nuts and Wooden Dowels.

Tighten Nuts with Wrench.
(See Figure 2)

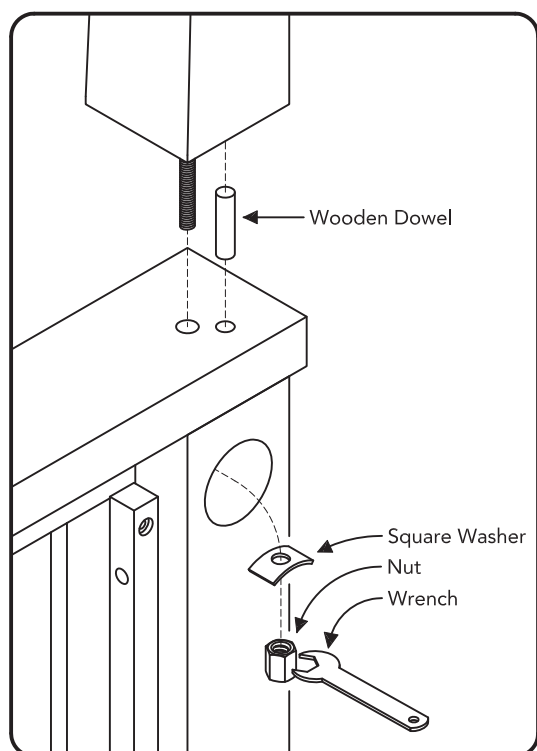
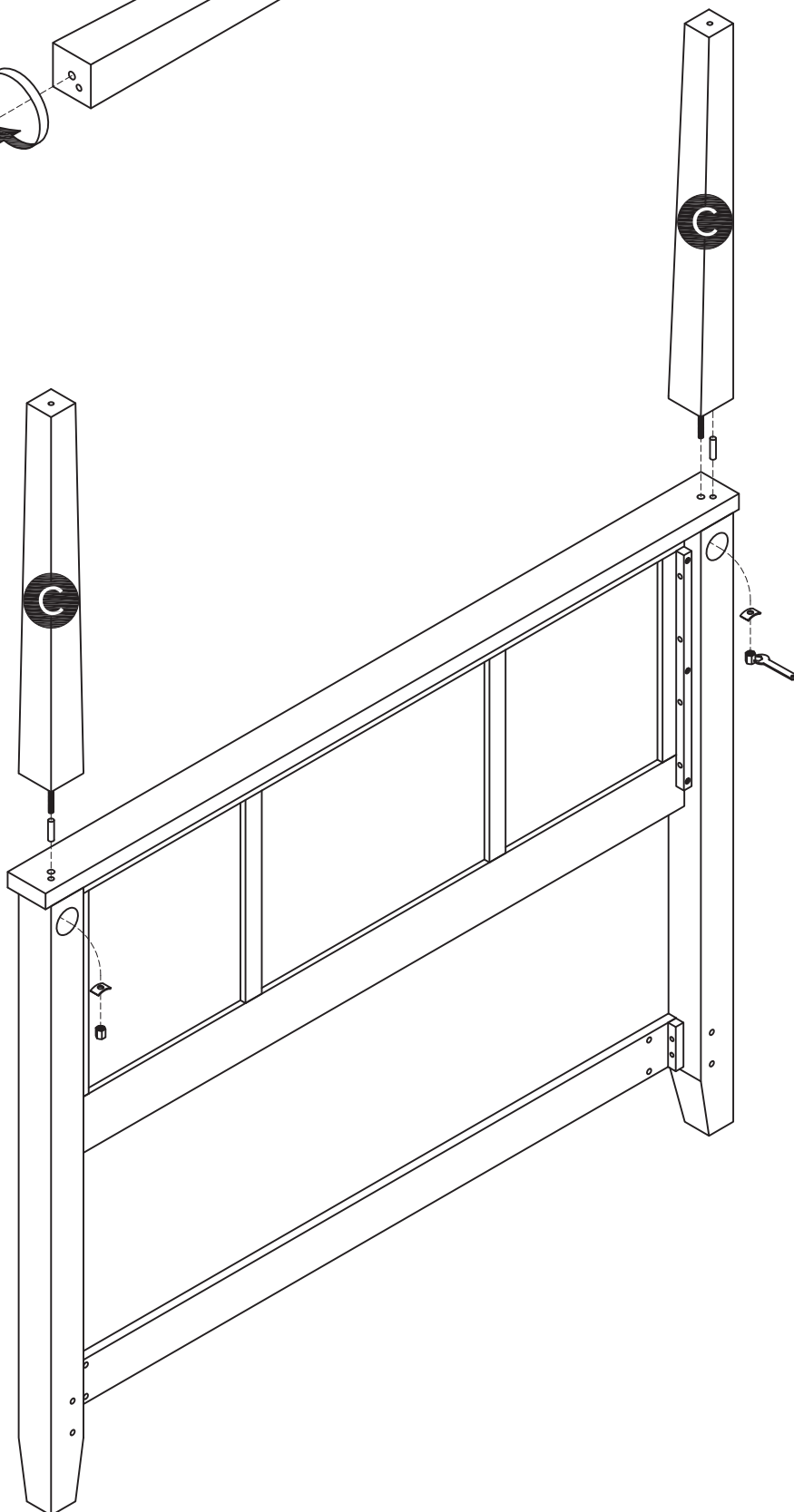

Figure 2



CARE INSTRUCTIONS

NEVER

allow liquids to remain on furniture.
Absorption causes parts to warp
and split and finishes to delaminate.

NEVER

use glass cleaners on
finished furniture. Ammonia
chemically attacks the finish.



Do not use power tools
above 8 volts to assemble.

**PREVENT
CRACKING**



Do not place
in direct sunlight.

**PREVENT
FADING**



Do not write
directly on surface.

**PREVENT
MARKING**



Do not place hot
objects on surface.

**PREVENT
FINISH DAMAGE**



Do not use rubber
based placemats.

**PREVENT
DISCOLORING**



Do not use commercial
waxes and polishes.

**PREVENT
YELLOWING**

CLEAN

with a soft cloth moistened
in lukewarm soap and water.
Buff with a dry clean cloth.



We will provide replacements free of charge for missing or damaged hardware or parts within 30 days of purchase. Digital images of the defective parts may be required. If the product was not purchased from an authorized retail affiliate, affiliate, we are under no obligation to provide replacement parts. Parts are not available for fully assembled items nor are parts available for sale. Replacements for missing or damaged hardware or parts may be requested.