



MILK GLASS BUBBLE CHANDELIERS

Product User Manual

DIRECTORY

- 1. Product Overview 1
- 2. Product Parameters 2
- 3. Product Installation 3
- 4. After-sale Service 5

Dear Customer,

Thank you for your order. We want to remind you to check the package. If you find anything damaged, don't panic right away because we included about 10% glass spare parts in the carton just in case.

Please follow our assembly instructions carefully or the video on this page to complete the partial assembly. If you're still confused, please send us a message on Wayfair Messages, and we'll explain how to install.

If there is any problem, we will always be here to help you!

Hope you will enjoy!

Best Regards,
Customer Service Team

1. PRODUCT OVERVIEW



This ceiling fan with reversible motor, it is composed of high quality iron, glass globe and acrylic, it can provide cooling air, air circulation and lighting. A remote is included to control the LED light and fan. An opulent fusion of classic Sputnik and elegant bubble design, this 8/12-light semi-flush fandelier features gracefully curved arms cascading from the back of a medal-like base to support alluring milky white glass globes, like a beautiful blossom firework. Warm cozy lighting sweeps down to your space when we turn on this glass globe sputnik fandelier, flowing through frosted glass bubbles and the luxe gold frame with elegance. Perfect to add artful charm and sophisticated beauty to your home decor, this 8/12-light opal glass bubble funky fandelier is the best enhancement to a living room, dining room, entryway, bedroom, or lobby.

1.1 USE CASE

Color your space and mesmerize yourself and your guests with this stunning handmade conversation piece, recommend to decor your bedroom, living room, dining room, foyer, entryway, staircase, lobby, hallway, bathroom, office, bar, hotel, farmhouse etc. It can be installed on sloped, vaulted and flat ceilings. Instructions for all hardware and mounting components included in package.

2. PRODUCT PARAMETERS

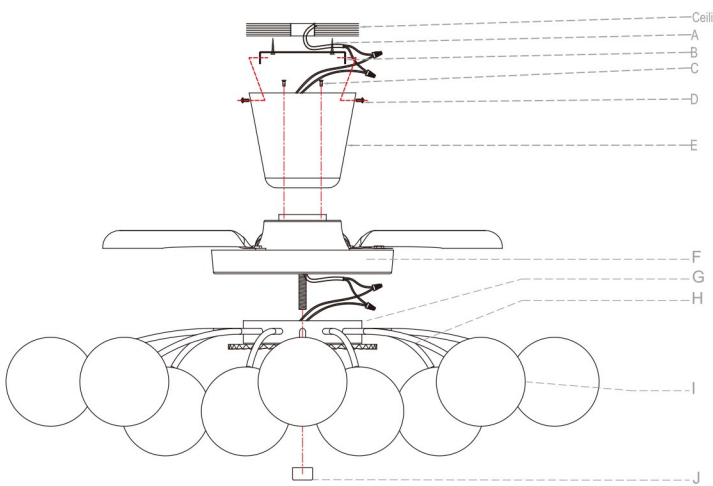

Important Safety Instructions
BEFORE INSTALLING FIXTURE, MAKE SURE THE POWER TO THE CIRCUIT IS TURNED OFF AT THE MAIN FUSE BOX/ CIRCUIT BREAKER UTILITY BOX.

These instructions are provided for your safety. It is very important that they are read carefully and completely before beginning the assembly and installation of this lighting fixture. We strongly recommend that a professional electrician install all direct wire fixtures. The lighting fixture is meant for indoor use. DRY LOCATION ONLY.

1. Check whether the parts and accessories are all there. (The specific type and quantity of accessories are subject to the actual product) Specifications:
Rated Voltage: 90–240V (wide voltage compatible)
Light Source Type: LED
When replacing bulbs, use 40-watt MAX for G9 bulb.
Main Materials: Metal body, glass lampshade
Note: If you are unsure about any installation step, consult a professional electrician.

Material	Glass, Metal
Room Type	Bedroom, Living Room, Dining Room, Foyer, Entryway, Staircase, Farmhouse, Hallway, Bathroom
Color Temperature	3000K
Light Source Type	LED
Power Source	AC/DC
Color Rendering Index (CRI)	80
Color	Gold / Black

PRODUCT SIZE

MODEL	SIZE	BULBS (not included)	Color: ● ●
LR1676	32.9inch*8inch	G9*8	
	38.1inch*8inch	G9*12	

3. PRODUCT INSTALLATION

3.1 PRE-INSTALLATION PREPARATION TOOLS



For safer and more efficient installation of chandeliers, you can use additional tools to assist. Please confirm that the power supply is turned off before installation.

3.2 INSTALLATION STEPS

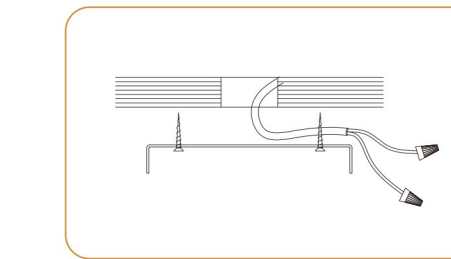

Step 1: Mount the Load-Bearing Bracket
Firstly, mark the desired position on the ceiling. Drill holes and Securely mount the load-bearing bracket (Part B) to the cement ceiling or wooden ceiling by using the positioning expansion bolts or screws (Part A) provided.

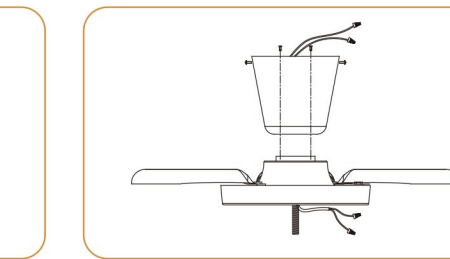

Step 2: Assemble the Fan Housing
Attach the mounting plate (Part E) to the main fan body (Part F) by using positioning screws (Part C).

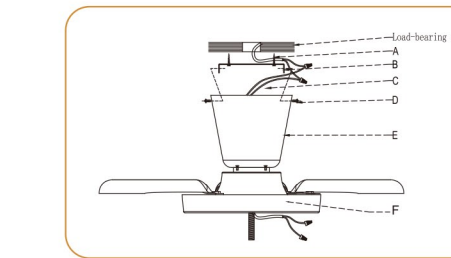

Step 3: Electrical Connection and Mounting
Connect the power wires according to local electrical codes. Use the positioning screws (Part D) to secure the assembled fan section (Part E) to the load-bearing bracket (Part B).

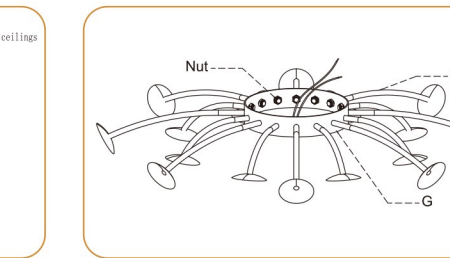

Step 4: Assemble the Light Kit
Attach the light body (Part H) to the fixture base (Part G) using the provided nuts.

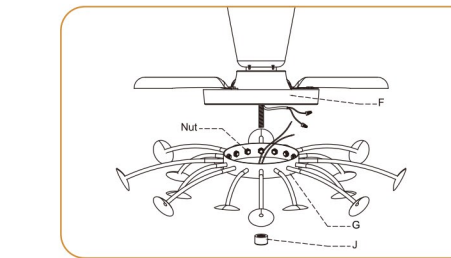

Step 6: Install Light Source and Glass Shade, Test.
Install the specified light source (Bulb not included). Attach the lampshade (Part I) to the light body. After all steps are complete, restore power and test the fan and light functions.

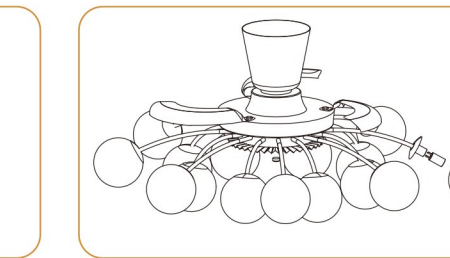

Step 5: Connect the power wires to the corresponding wires from the fan base. Secure the fixture base (Part G) to the fan body (Part F) by using components (Part J).

4. AFTER-SALE SERVICE

Thank you for purchasing our company's products. We highly value your trust and support in us, and are also delighted to provide you with high-quality products and services. We sincerely thank you again!

Here is some information about chandeliers:

ABOUT DELIVERY	The chandeliers you ordered comes in one or more packages. For the chandeliers with multiple packages, its light frame and glass rod are packaged and shipped separately. Sometimes due to different express batches, multiple packages cannot be shipped at the same time, so please stay patient. The rest of the packages will usually arrive within a few days of receiving your first package. If you still haven't received the shipment within 5 days, you can contact our customer service to check.
ABOUT COLOR DIFFERENCE	Product pictures are all taken in kind. However, due to factors such as photography technology, light, and display parameters of electronic equipment, the color of the actual product you receive will be slightly different from the photos. Please refer to the actual product.
ABOUT AFTER-SALES SERVICE	If you have any questions during receipt or installation, please feel free to contact us on the order details (click "problem with order"). We can provide professional guidance and reshipment of damaged parts due to logistics at any time.

⚠️ If you have any questions, please feel free to contact us, our customer service team is standby to help you with 24H/7D, we will be offering best solutions regarding any assemble and accessories issues at the very first time.

