

END OF BED STORAGE BENCH

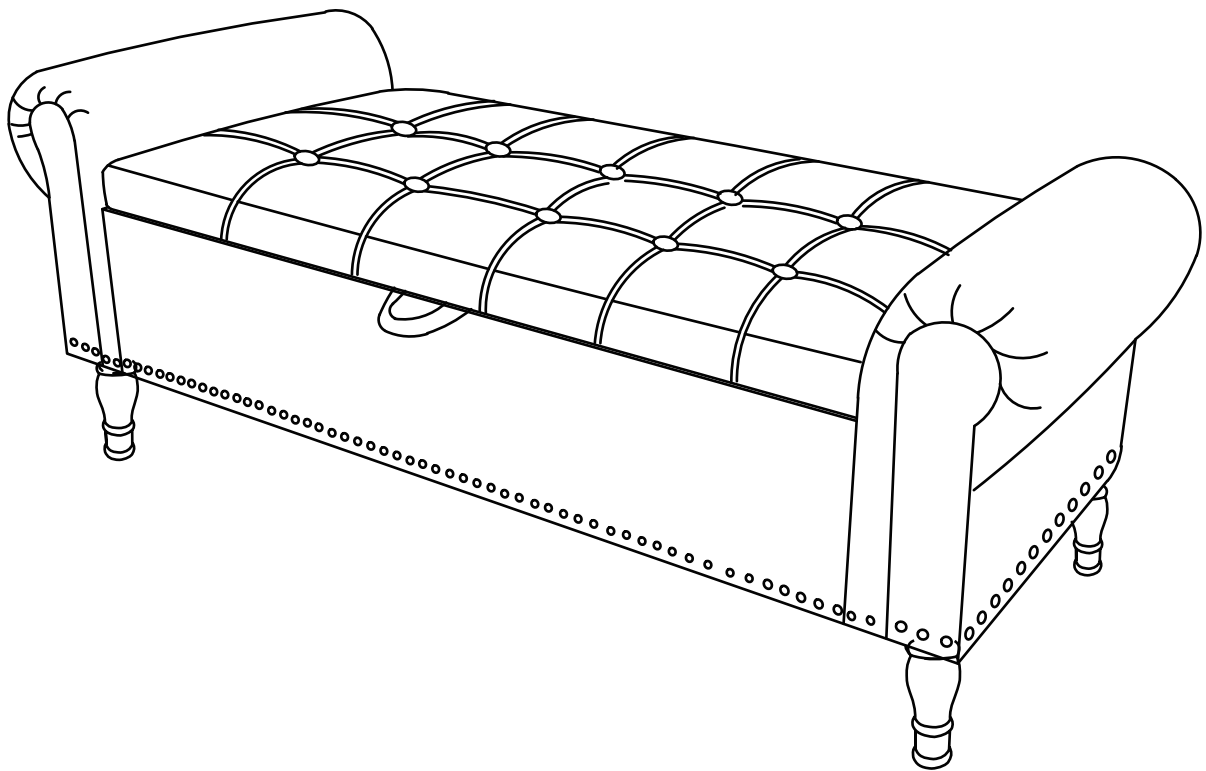

After-sales mailbox:
Homefurniture Serviceteam@outlook.com

NOTICE



Please keep these instructions for future reference.

Dear Customer

- Thank you for your purchase. When you receive the product, please make sure that all the parts are intact. Then follow the entire installation instructions to install!
- When installing, please be careful not to tighten the screws immediately! You need to make sure that all the screws are secured to 80%, then tighten them!

If problem occur unsatisfactorily as follows

- A** . The outer box is damaged
- B** . The product is damaged / bent / cracked while you open the box
- C** . The parts / accessories / assembly tools are missing
- D** . The instructions are not clear and can not be referred
- E** . The product has functional problems
- F** . Other aspects that you are not satisfied with

Please feel free to contact us for help. Our after-sales team service (**Homefurniture-serviceteam@outlook.com**) will reply within 24 hours and will do our best to resolve the problem for you.

AFTER-SALE

Guaranteed Customer Service

Your shopping experience is very important to us!

Feel unsatisfied? Contact us!

Have any questions? Contact us!

Wanna Share how wonderful our smart promakes your home?

Share your pictures with us.

Any suggestions?Contact us!



Homefurniture-serviceteam@outlook.com



Ax1

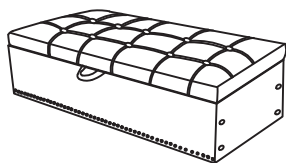

Bx2

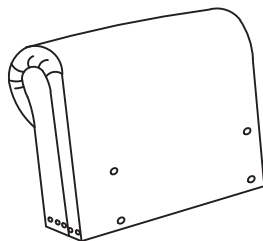

Cx4



Dx4+1PCS



Ex8+1PCS

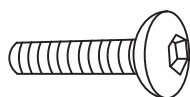

M6*50

Fx8+1PCS



Gx1PC



1

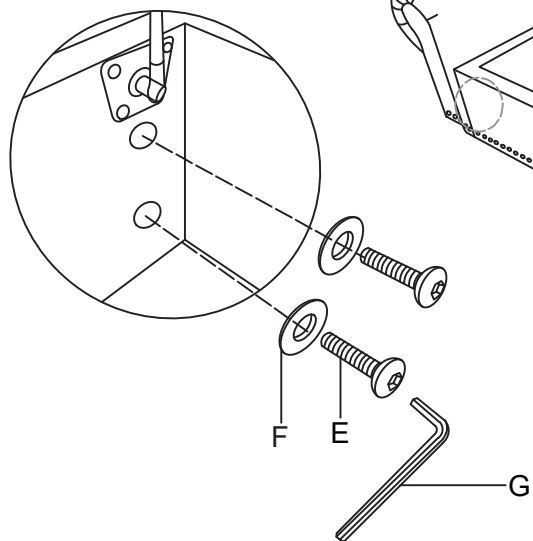
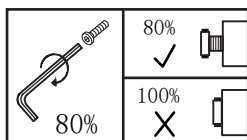

2

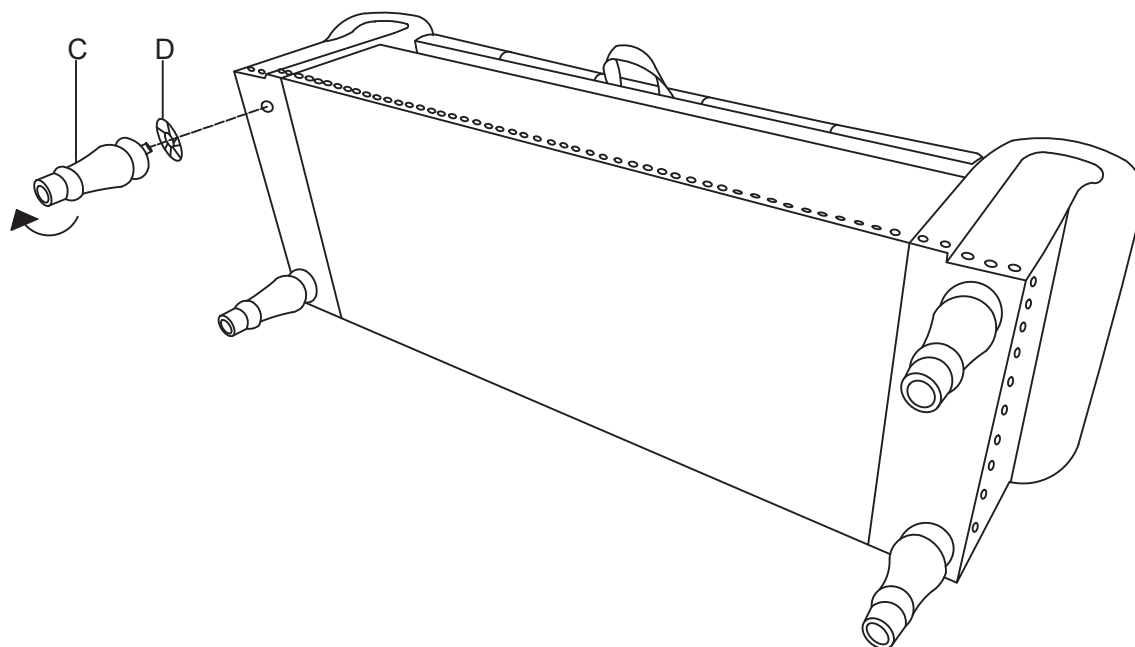

- 3 After Step 2, place the product on a horizontal floor. Ensure that the feet of the product on the same level. Open the ottoman and proceed to Step 4.

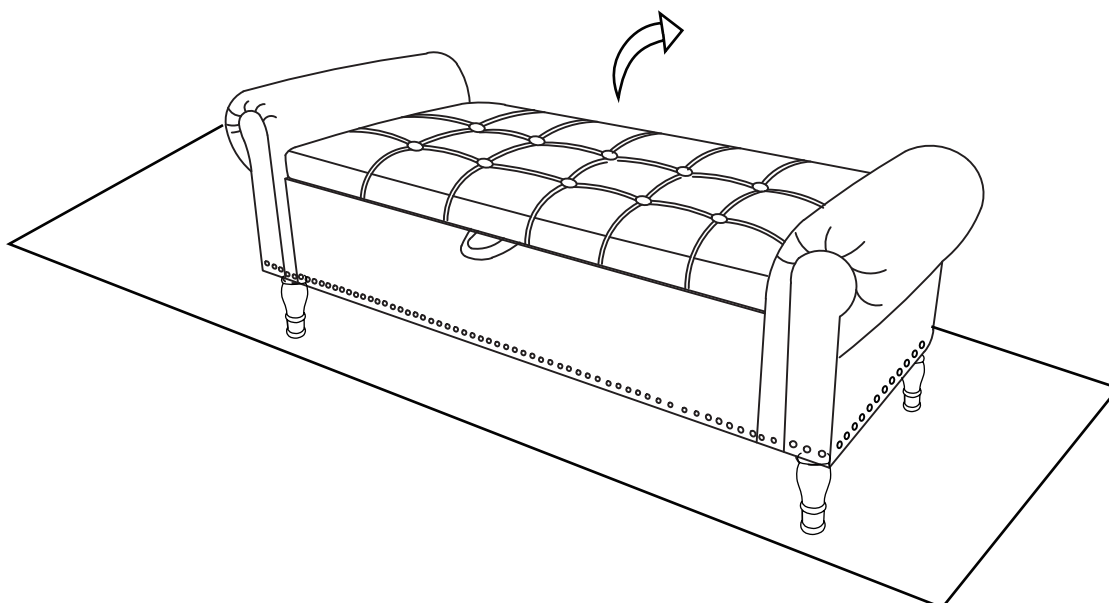

4

