

# INSTALLATION INSTRUCTIONS

# ASSEMBLY

## Please Note:

- Review and abide by all building and plumbing codes.
- Use the actual sink for any cutouts.
- Mounting ring not required.
- Novatto sinks need to be installed by a professional.
- Some counters require different cutting methods; seek the details of your chosen countertop material.
- Check to make sure the sink is sealed watertight.

## Steps to Complete Your Project

- **Layout and place** the sink and faucet of your choice in the desired location. Using a pencil, mark the bottom of the sink hole and faucet base. Consider the flow of the faucet when making the location.
- **Drill the countertop** for sink drain opening with a 1 1/2-inch drill bit.  
**Note:** If you wish to have the sink completely flush on the countertop, use a 2 1/2 - inch drill bit. This will allow the whole drain flange to sit into the counter. You will also need an extra wide washer when installing the drain fastener under the counter.

- **Place the vessel** on top of the counter and make sure the drain fits down inside the countertop.
- **Use a level** to ensure the vessel is level in every direction and install the drain.
- **Use a bead** of clear silicone to seal between the outside edge of vessel where it is mounted to the counter.
- **The nut on the drain pipe** will secure the vessel to the countertop.
- **When cleaning** do not use abrasive cleaners.

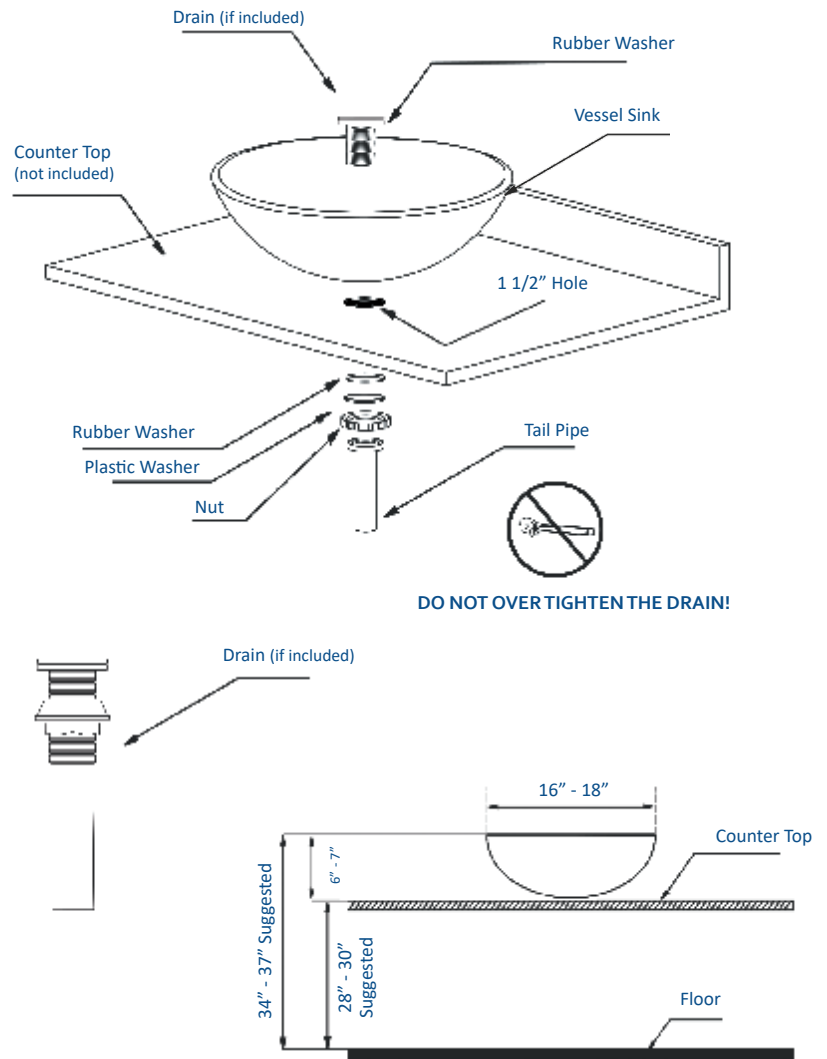

## TOOLS NEEDED FOR ASSEMBLY (not included)

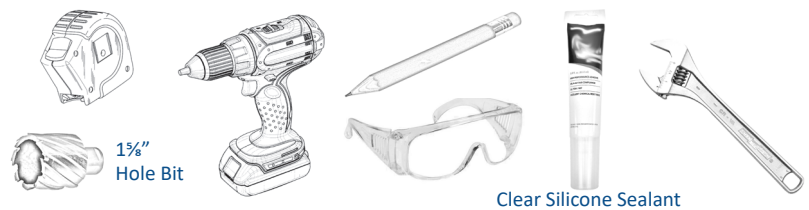

Questions, problems, missing parts? Before returning, call our customer service department at 844.404.4242, 8:00 a.m. - 5 p.m., MST Monday - Friday or e-mail us at: [support@novattoinc.com](mailto:support@novattoinc.com)

## TROUBLESHOOTING TIPS

<u>Issue</u>	<u>Reason</u>	<u>Solution</u>
Sink wobbles or is loose	Drain is loose	Use silicone, tighten drain
Does not completely drain	Drain is too high, wrong seal used	Make sure correct seal is used and is below bevel
Leakage under sink	Drain has come loose	Tighten the fastener under the counter