

## Power Recliner with Power Headrest

### IMPORTANT NOTE

Read these instructions carefully, and familiarize yourself with each procedure before assembling the furniture. Check that you have all the component parts, and familiarize yourself with each part before proceeding.

Take all the fittings out of the plastic bag and separate them into groups. Ensure you have enough space to lay out all the parts before assembly. To prevent damage to the parts, we recommend that you assemble the unit on a soft, level surface.

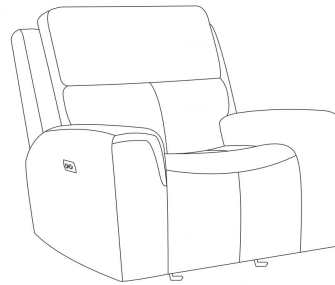

### Part List

A. Back  
1 piece

B. Seat  
1 piece

C. Wing  
2 pieces

D. Transformer  
1 piece

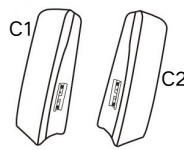
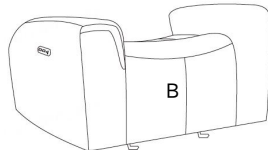
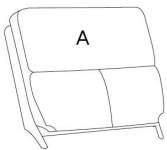

### Assembly Instructions

#### STEP 1

Detach the Transformer (D) from the bottom of the Seat (B) and the Wings (C1/C2) from the bottom of the armrests (See Figure 1.)

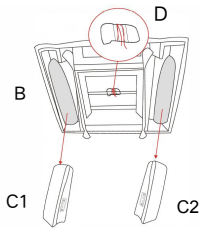

Figure 1

#### STEP 2

Attach the Back (A) to the Seat (B). Then attach the Wings (C1/C2) to Back (A). Ensure the latches fit well. (See Figure 2.)

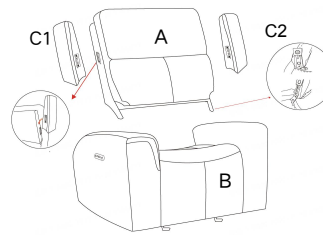

Figure 2

### Assembly Instructions

#### STEP 3

Flip up the back flap, connect the headrest cable to the power button control cable and place them behind the flap. (See Figure 3.)

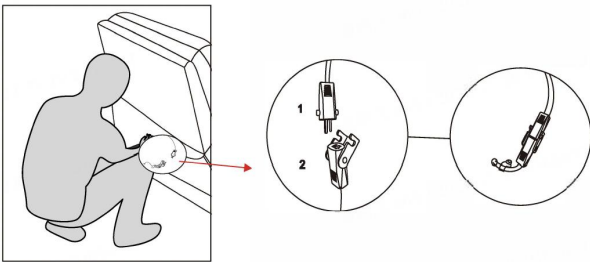

Figure 3

#### STEP 4

Plug the transformer (D) into a nearby outlet, still making sure it is clear of the metal base. (See Figure 4.)

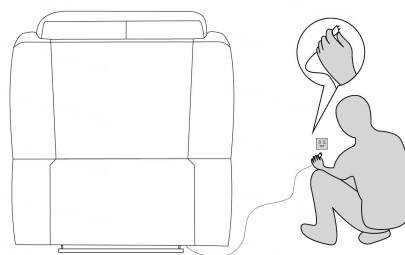

Figure 4

#### STEP 5

Fasten the back flaps to the bottom of the furniture. (See Figure 5.)

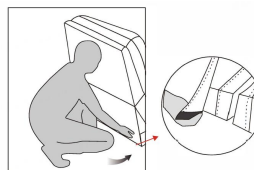

Figure 5

### IMPORTANT NOTE

- To avoid any risk of suffocation to children or pets, dispose of all plastic bags immediately.
- To ensure proper performance, occasionally check for loose screws and tighten as needed.
- If the reclining functions are not working properly, check for loose cable connections before contacting the retailer.

## Power Reclining Sofa with Power Headrests

### IMPORTANT NOTE

Read these instructions carefully, and familiarize yourself with each procedure before assembling the furniture. Check that you have all the component parts, and familiarize yourself with each part before proceeding.

Take all the fittings out of the plastic bag and separate them into groups. Ensure you have enough space to lay out all the parts before assembly. To prevent damage to the parts, we recommend that you assemble the unit on a soft, level surface.

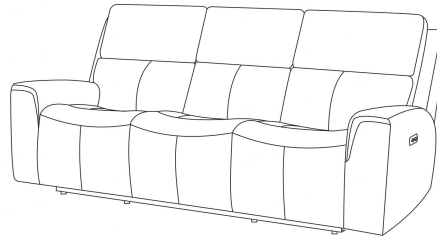

### Part List

A. Back  
3 pieces

B. Seat  
1 piece

C. Wing  
2 pieces

D. Transformer  
1 piece

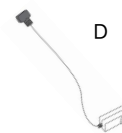
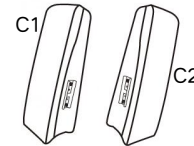
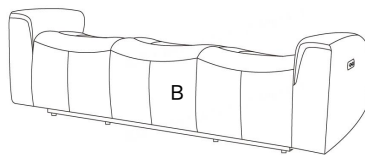
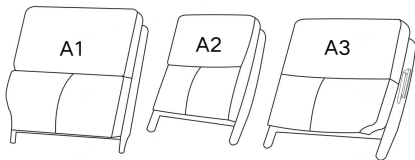

### Assembly Instructions

#### STEP 1

Detach the Transformer (D) from the bottom of the Seat (B) and the Wings (C1/C2) from the bottom of the armrests (See Figure 1.)

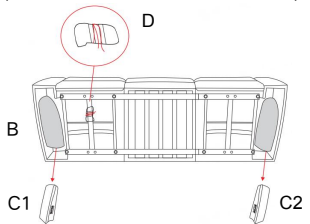

Figure 1

#### STEP 2

Attach the Back (A1/A2/A3) to the Seat (B). Then attach the Wings (C1/C2) to Back (A1/A3). Ensure the latches fit well. (See Figure 2.)

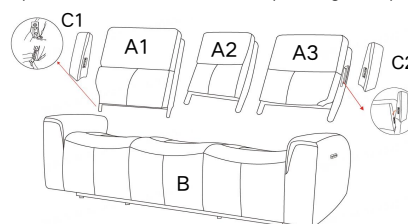

Figure 2

### Assembly Instructions

#### STEP 3

Flip up the back flap, connect the headrest cable to the power button control cable and place them behind the flap. (See Figure 3.)

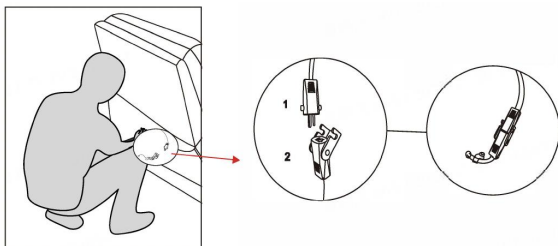

Figure 3

#### STEP 4

Plug the transformer (D) into a nearby outlet, still making sure it is clear of the metal base. (See Figure 4.)

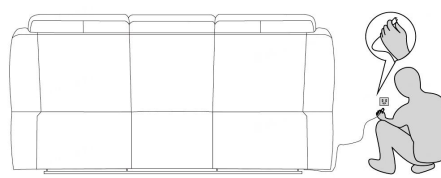

Figure 4

#### STEP 5

Fasten the back flaps to the bottom of the furniture. (See Figure 5.)

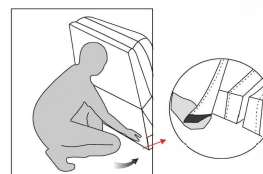

Figure 5

### IMPORTANT NOTE

- To avoid any risk of suffocation to children or pets, dispose of all plastic bags immediately.
- To ensure proper performance, occasionally check for loose screws and tighten as needed.
- If the reclining functions are not working properly, check for loose cable connections before contacting the retailer.

## Power Reclining Loveseat with Power Headrests

### IMPORTANT NOTE

Read these instructions carefully, and familiarize yourself with each procedure before assembling the furniture. Check that you have all the component parts, and familiarize yourself with each part before proceeding.

Take all the fittings out of the plastic bag and separate them into groups. Ensure you have enough space to lay out all the parts before assembly. To prevent damage to the parts, we recommend that you assemble the unit on a soft, level surface.

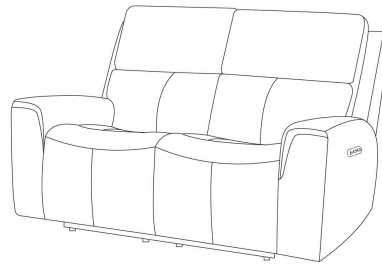

### Part List

A. Back  
2 pieces

B. Seat  
1 piece

C. Wing  
2 pieces

D. Transformer  
1 piece

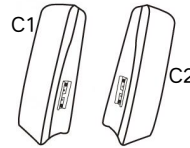
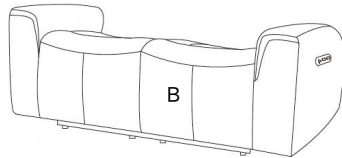
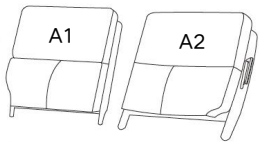

### Assembly Instructions

#### STEP 1

Detach the Transformer (D) from the bottom of the Seat (B) and the Wings (C1/C2) from the bottom of the armrests (See Figure 1.)

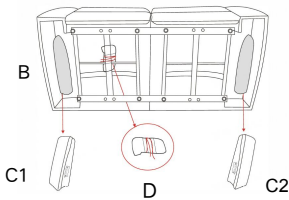

Figure 1

#### STEP 2

Attach the Back (A1/A2) to the Seat (B). Then attach the Wings (C1/C2) to Back (A1/A2). Ensure the latches fit well. (See Figure 2.)

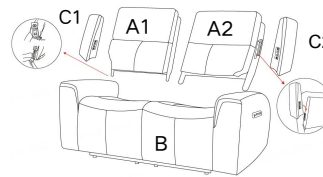

Figure 2

### Assembly Instructions

#### STEP 3

Flip up the back flap, connect the headrest cable to the power button control cable and place them behind the flap. (See Figure 3.)

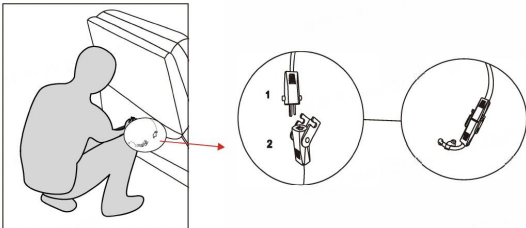

Figure 3

#### STEP 4

Plug the transformer (D) into a nearby outlet, still making sure it is clear of the metal base. (See Figure 4.)

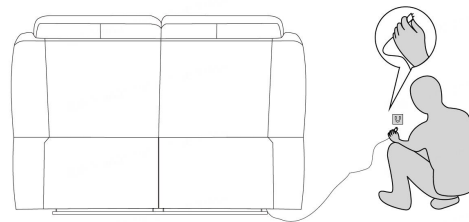

Figure 4

#### STEP 5

Fasten the back flaps to the bottom of the furniture. (See Figure 5.)

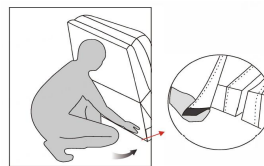

Figure 5

### IMPORTANT NOTE

- To avoid any risk of suffocation to children or pets, dispose of all plastic bags immediately.
- To ensure proper performance, occasionally check for loose screws and tighten as needed.
- If the reclining functions are not working properly, check for loose cable connections before contacting the retailer.