

ASSEMBLY INSTRUCTIONS

SKU/ITEM# -785-T/786-T

meridian.
furniture

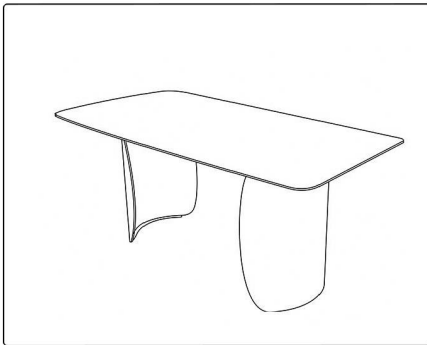

+ Do Not Use Power Tools



+ Suggested Adults



NOTE: For questions about parts or assembly please email support@meridianfurnitureusa.com or call us at 718-758-4455.

- 1 Read instructions cover to cover.
- 2 Save all packaging until assembly is completed.

1 IMPORTANT SAFETY INFORMATION

Do not assemble the product if any of the following parts arrived damaged:

- Part #① - Table Top 1PC
Part #② - Legs 2PCS

2 IMPORTANT ASSEMBLY INFORMATION

Assembly Step Use Bolt B, C, D, to connect Part 1 to Part 2

***Warning:** Do not over tighten screws, or it could damage the Table Top.

+ Parts Included

① Table Top 1PC

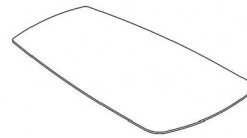

② Legs 2PCS

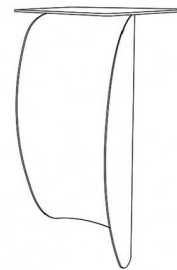

+ Hardware Included

A Allen wrench (5mm) 1PC



B Bolt (M8*15) 12PCS



C Flat Washer (φ 18*φ 8) 12PCS



D Spring Washer (φ 18*φ 8) 12PCS



ASSEMBLY INSTRUCTIONS
SKU/ITEM# - 785-T/786-T

meridian.
furniture

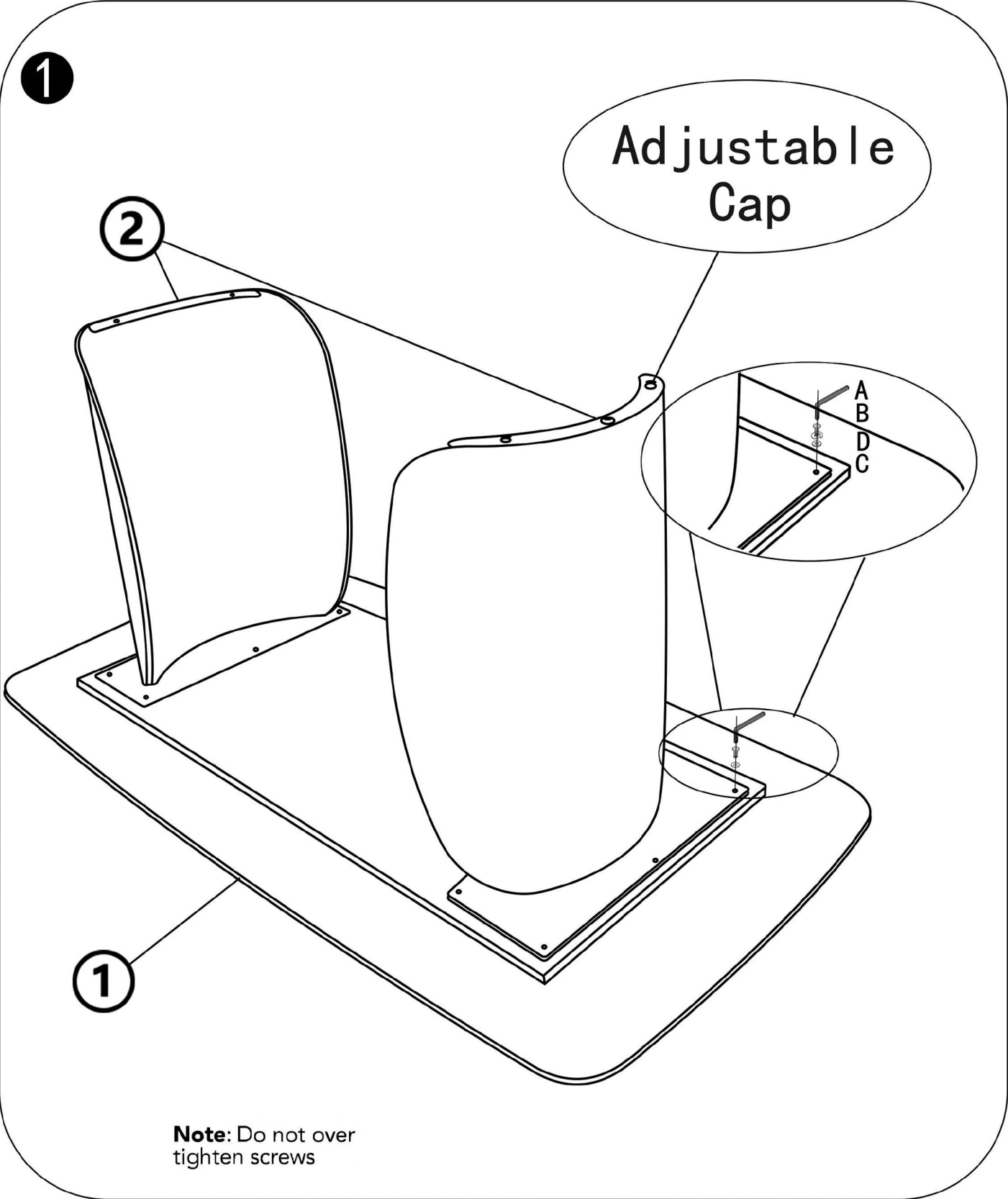

Note: Do not over tighten screws

NOTE: For questions about parts or assembly please email support@meridianfurnitureusa.com or call us at 718-758-4455.

www.MeridianFurnitureUSA.com | support@meridianfurnitureusa.com