

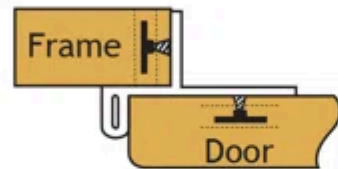

## P5311-BI

### Double Demountable Hinges

Used with Face Frame Cabinets • Semi-Concealed • Self-Closing



This hinge allows the door and hinge to be removed completely. Hinge is mounted without screws, using incisions into both the door and cabinet face frame.

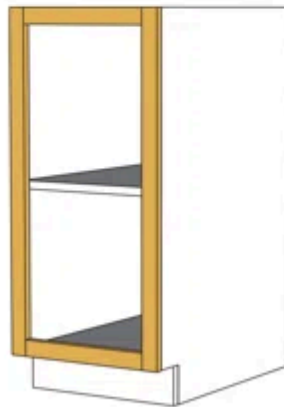

Face Frame means the cabinet face is constructed of vertical "stiles" and horizontal "rails" that reinforce the cabinet structure and provide mounting support for doors and drawers.