

**POSTER HEADBOARD  
 POSTER WOVEN HEADBOARD  
 POSTER FOOTBOARD  
 POSTER WOVEN FOOTBOARD  
 RAILS**

## Assembly Instruction

### A. Components :

	<b>Qty</b>
1. Headboard	: 1 Pc
2. Footboard	: 1 Pc
3. HB Legs	: 2 Pcs
4. HB Finial	: 2 Pcs
5. FB Finial	: 2 Pcs
6. Stretcher	: 1 Pc
7. Bed Rails	: 2 Pcs
8. Slats	: 4 Pcs
9. Slats Support	: 4 Pcs



**a**



**b**



**c**



**d**

### B. Hardware :

	<b>Qty</b>
a. Bolt M6 x 50mm	: 10 Pcs
b. Flat Washer	: 10 Pcs
c. Lock Washer	: 10 Pcs
d. Allen Key	: 1 Pc
e. Bolt M8 x 100mm	: 8 Pcs
f. Halfmoon Washer	: 8 Pcs
g. Hexa Nut	: 8 Pcs
h. Screw	: 8 Pcs
i. Hexa Wrench	: 1 Pc



**e**

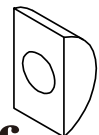

**f**



**g**

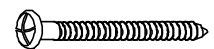

**h**



**i**

### C. Tool Required

1. Screw Driver = ( not included )



**STEP - 1 Option 1**

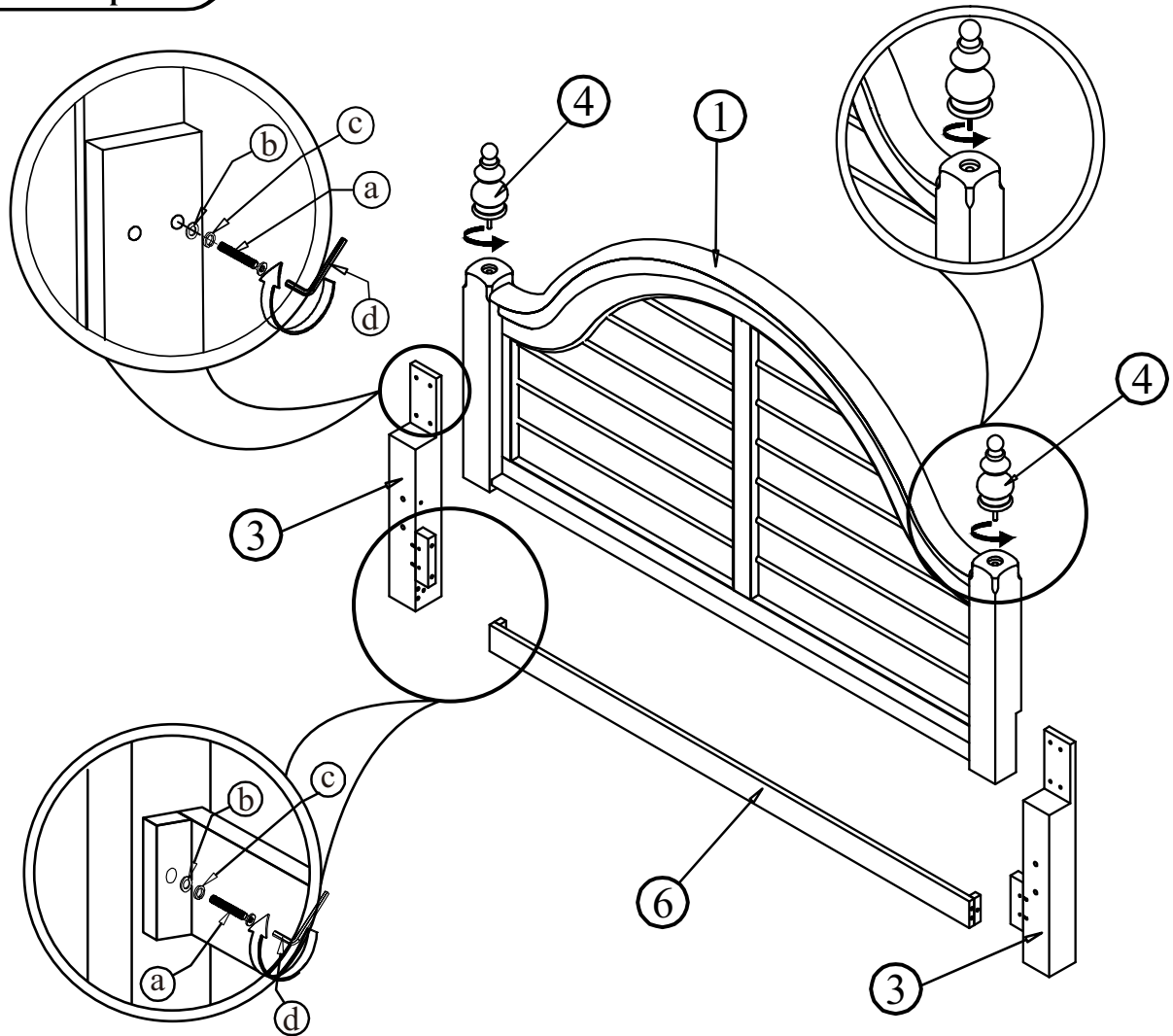

**STEP - 1 Option 2**

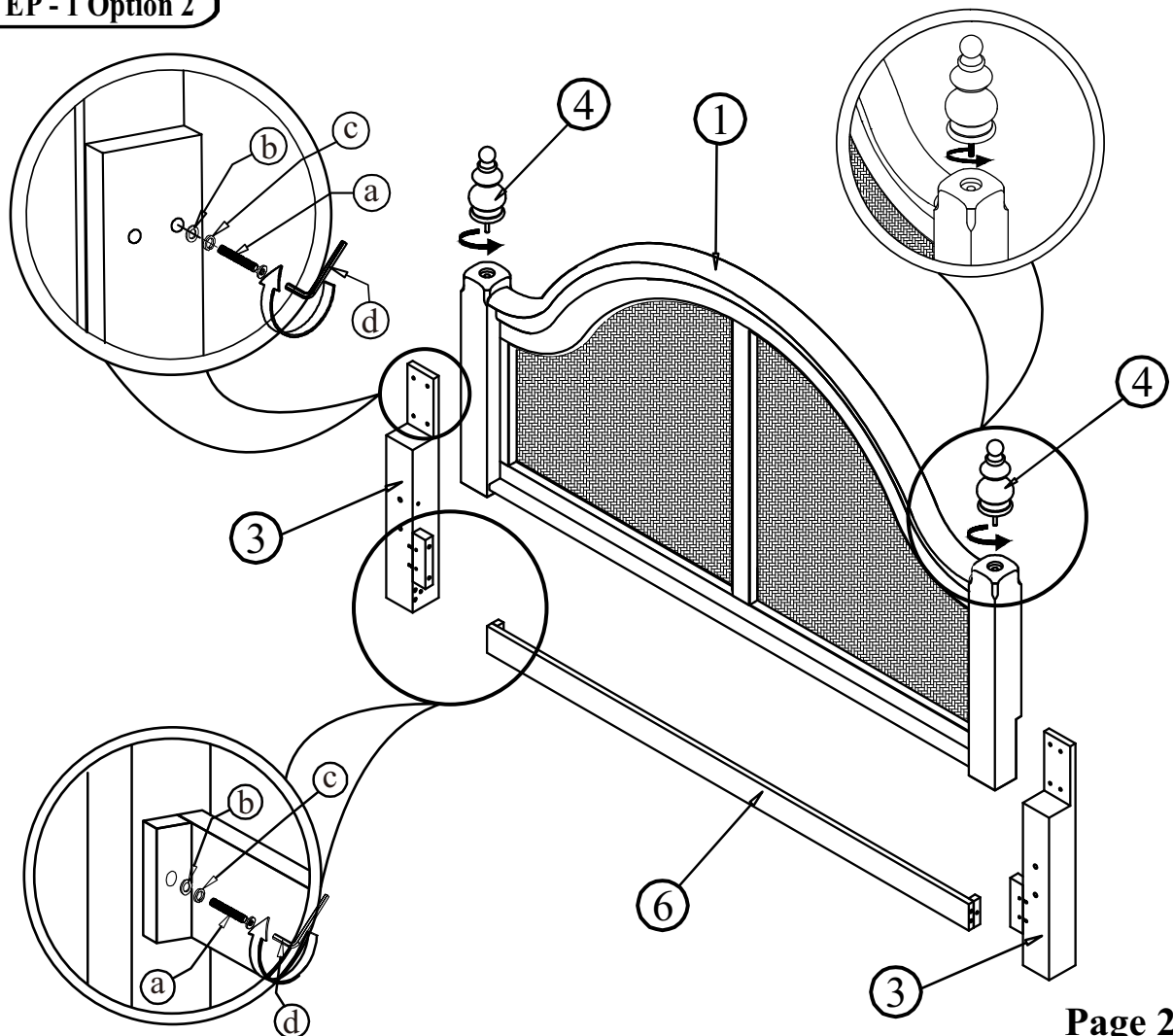

STEP - 2 Option 1

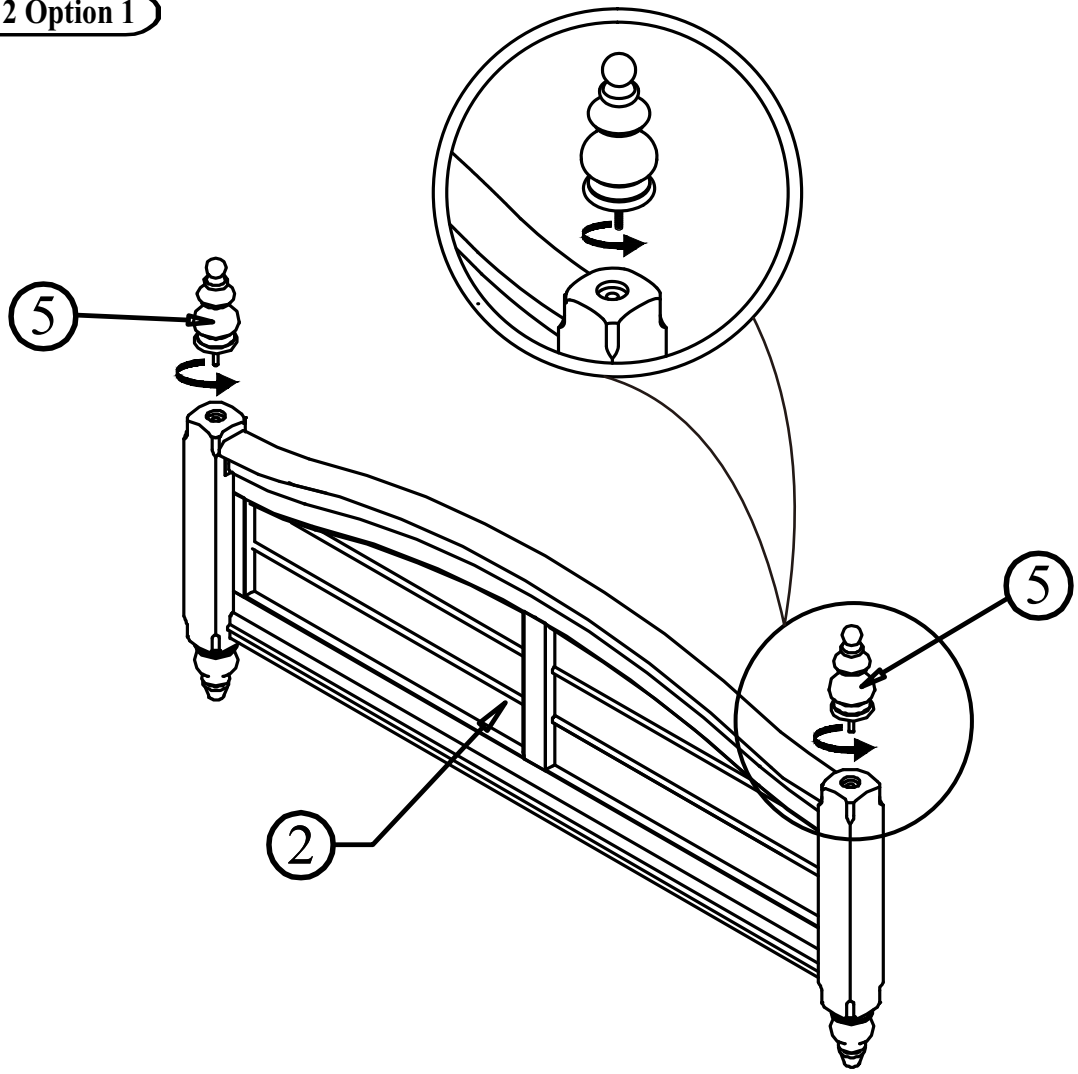

STEP - 2 Option 2

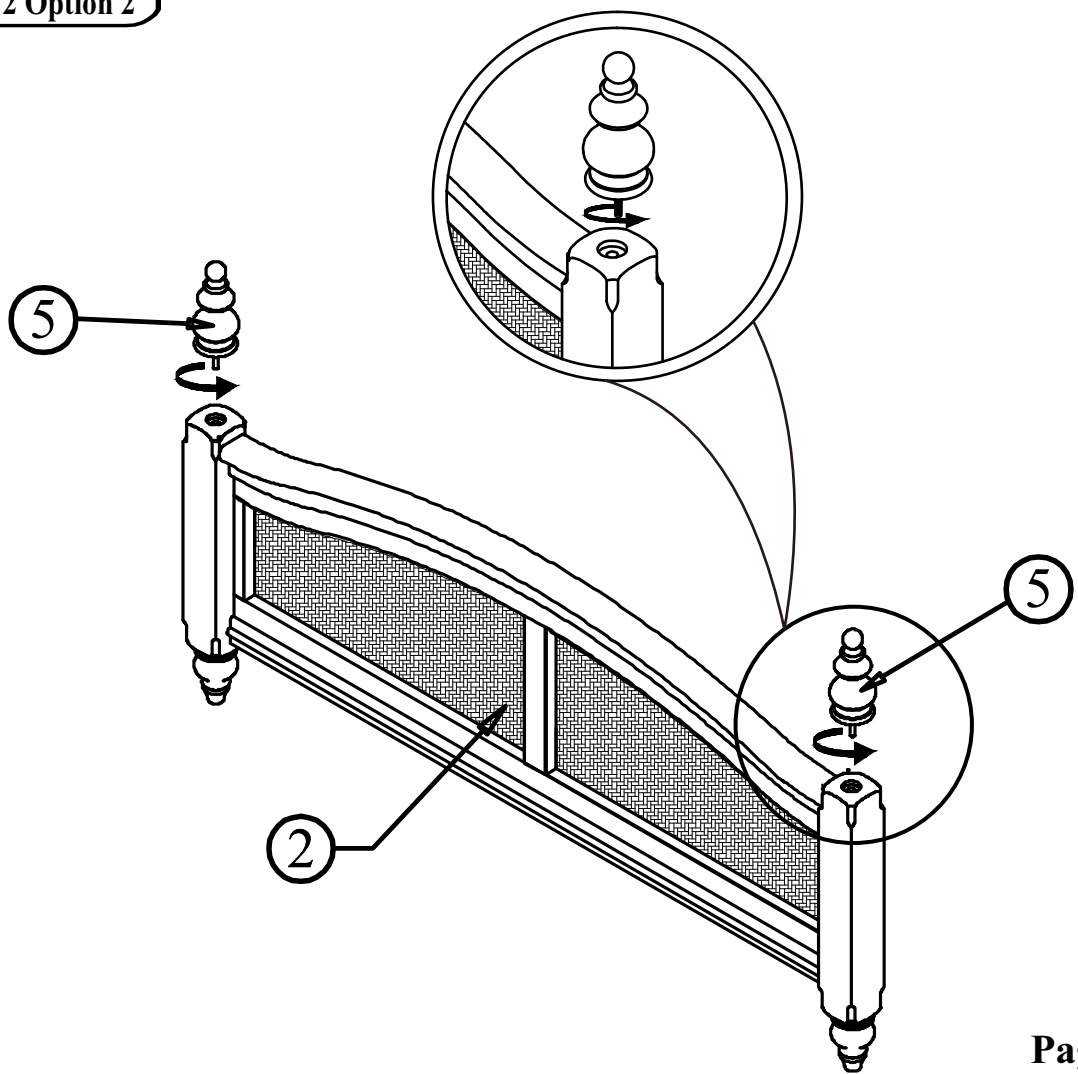

STEP - 3 Option 1

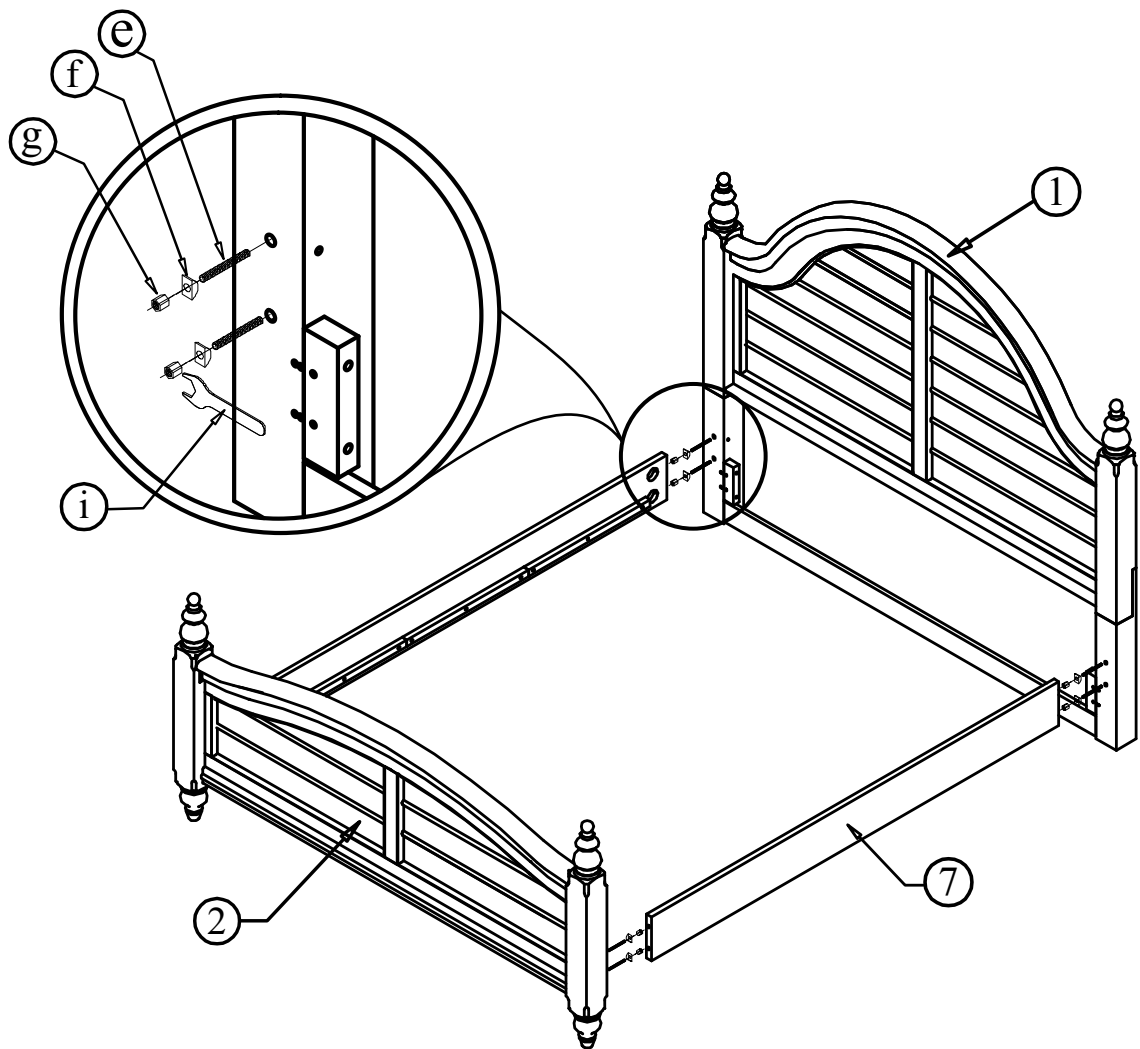

STEP - 3 Option 2

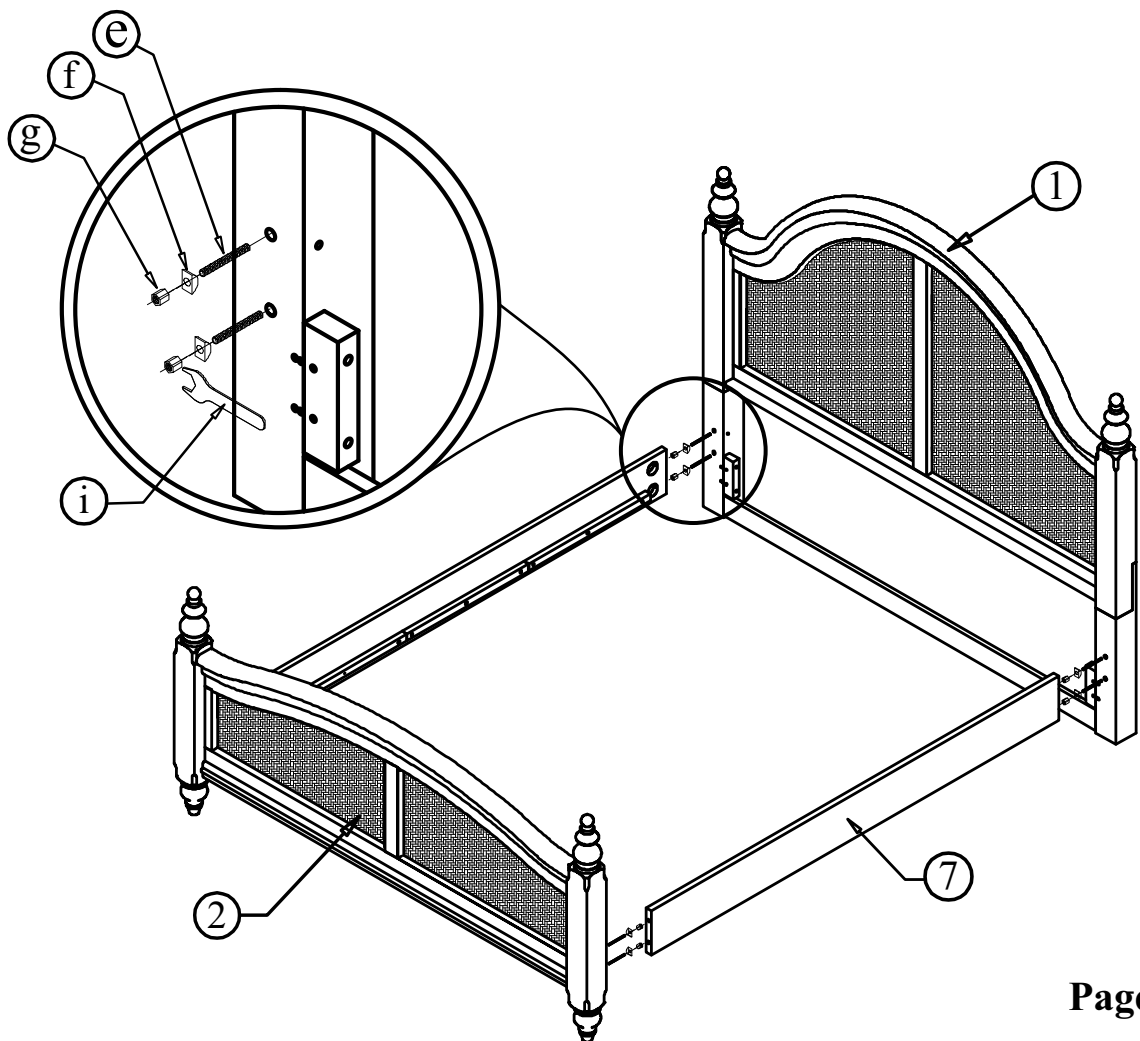

STEP - 4 Option 1

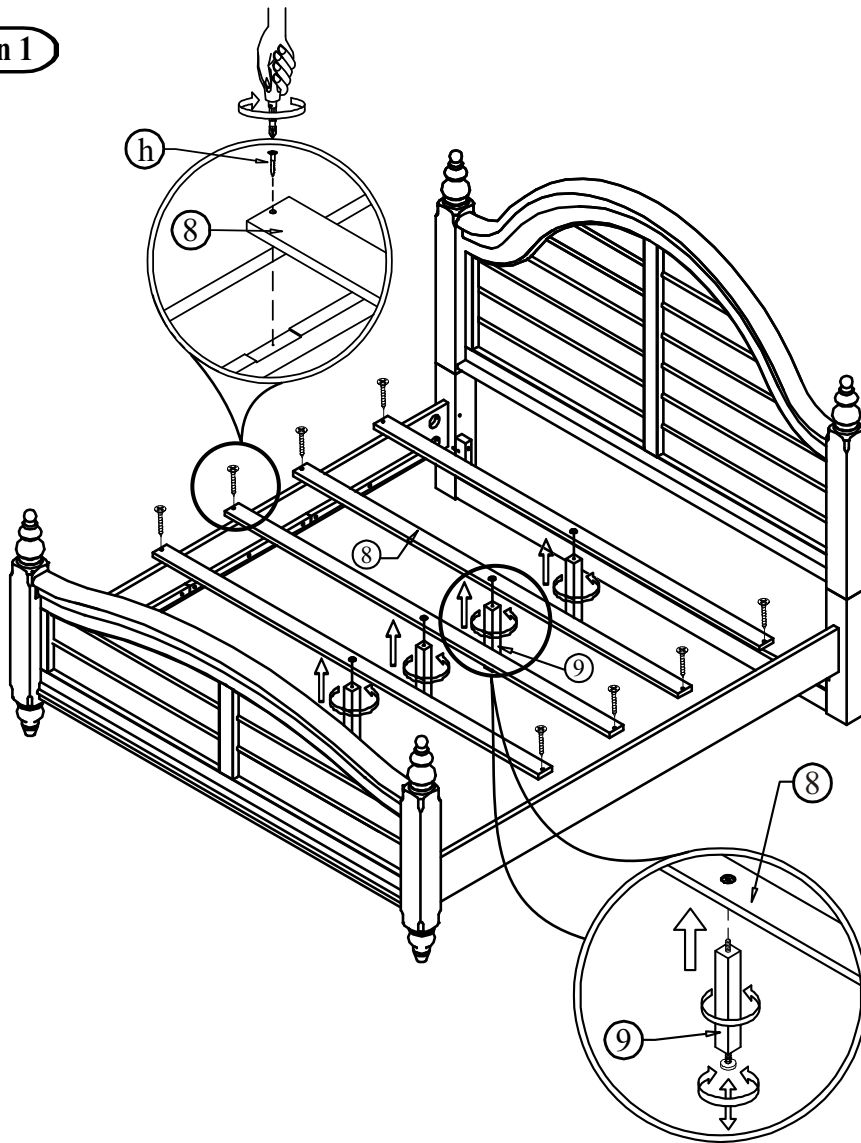

STEP - 4 Option 2

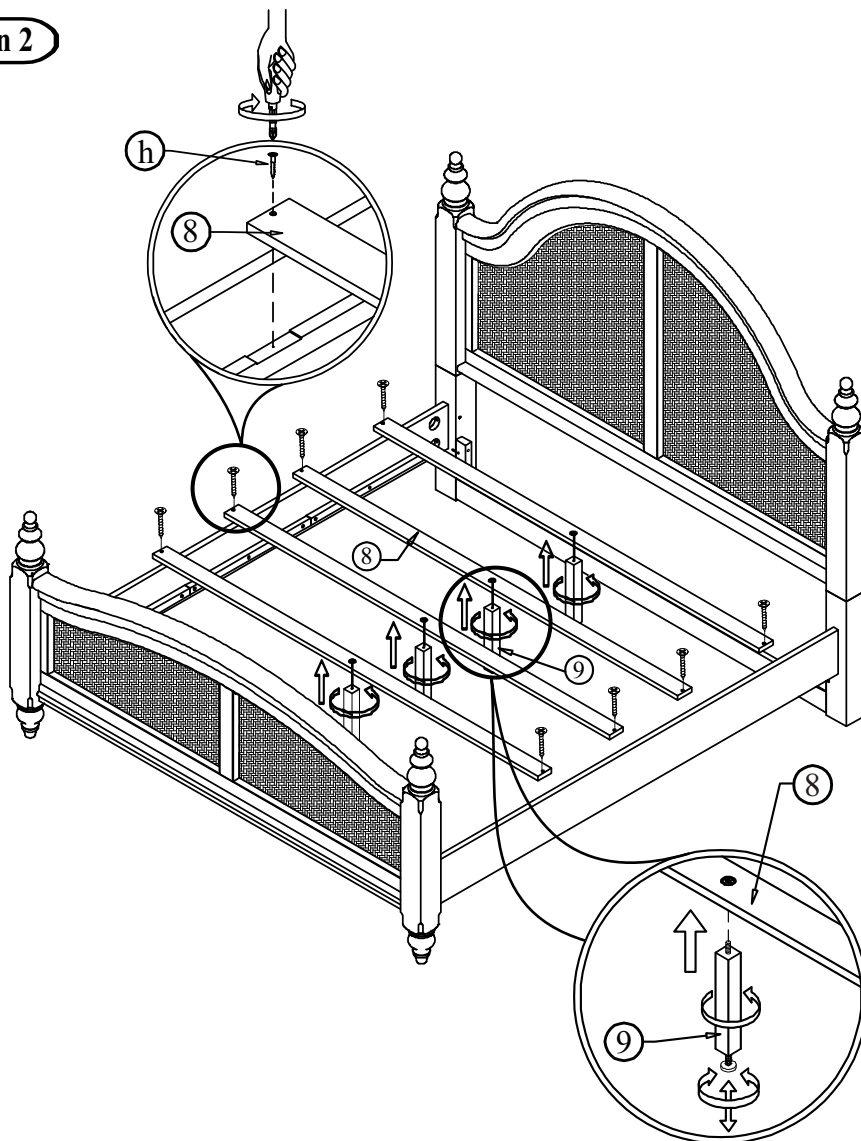

CARTON 1

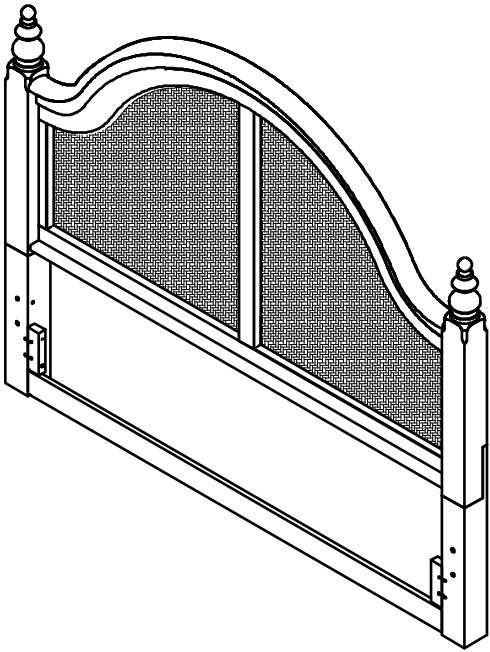

6/6 Poster Woven Headboard.....1 Pc

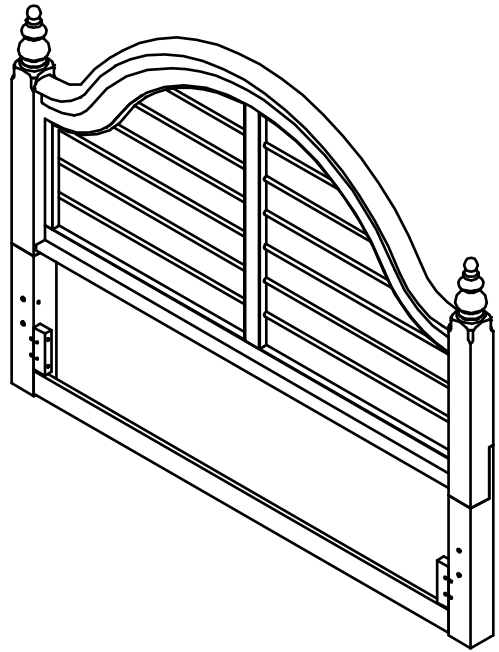

6/6 Poster Headboard.....1 Pc

CARTON 2

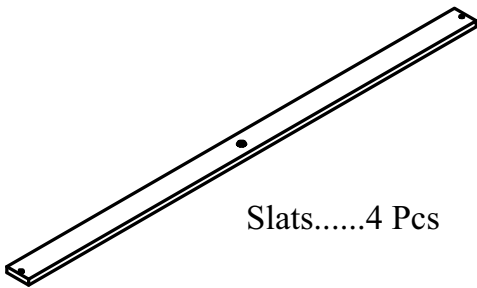

Slats.....4 Pcs

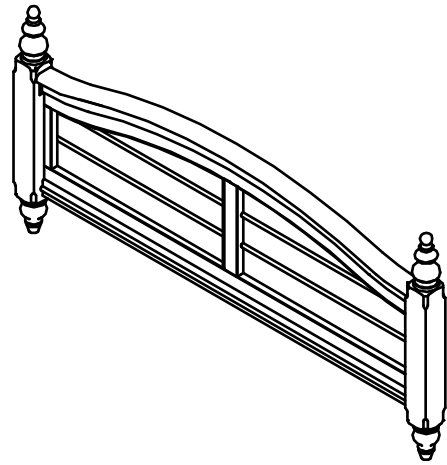

6/6 Poster Footboard.....1 Pc

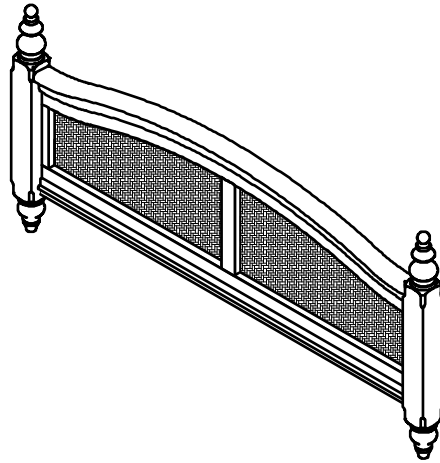

6/6 Poster Woven Footboard.....1 Pc



Slats Support.....4 Pcs

CARTON 3

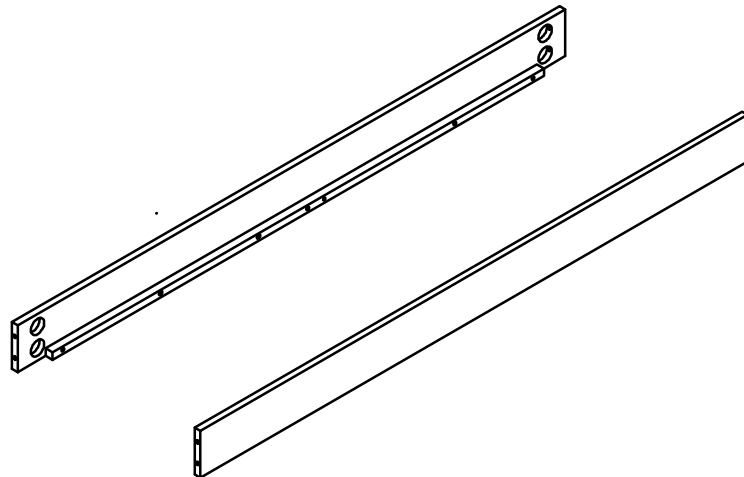

5/0 6/6 Rails.....2 Pcs