

# 4040FL

# Box List

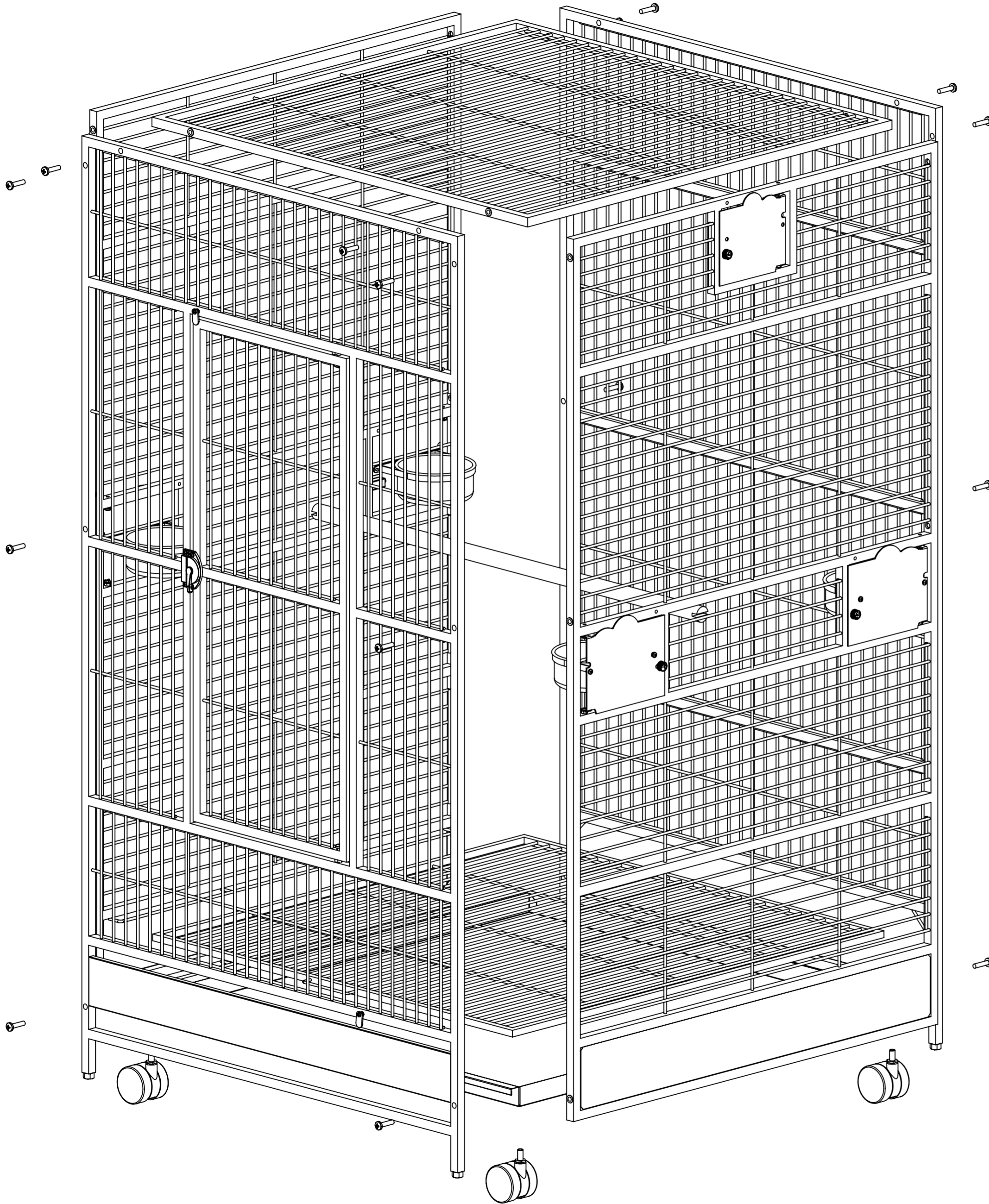

Item No: 4040FL				
Box 1/2		Worker	Q C	ganger
Part name	Quantity			
Front wire(前网)	1pcs			
Back wire(后网)	1pcs			
Left wire(左网)	1pcs			
Right wire(右网)	1pcs			
Assembly Instructions(包装图)	1pcs			
Box 2/2		Worker	Q C	ganger
Top wire(盖网)	1pcs			
Grill(密网)	1pcs			
Tray(铁盆)	1pcs			
Bottom perch(下木棍)	1pcs			
Feeders(6寸杯)	4pcs			
Holder(6寸合圈)	4pcs			
Wheels(3寸12厘脚轮)	4pcs			
Screw bag(螺丝包)	1pcs			

1. Screw wheels onto bottom of front wire、back wire.
2. Attach front 、back、 left、 right wire together with M8X35 screws.
3. Assembly top wire on top of the body with M8X35 screws.
4. Slide grill in space underneath the front door.
5. Slide tray in space underneath front seed guard .
6. Screw 4 x door feeders on inside of 4 x doors.
7. Open the front door and put perch from left to right inside the body.