



A KOHLER COMPANY

ROCKTON™

Features

- Vitreous china
- One flush cleansing performance
- Elongated bowl
- Standard elongated seat - not supplied
- 5-year limited warranty
- Two-bolt installation system
- 1.6 gallons (6 L) of water per flush for solid waste and .8 gallons (3 L) of water per flush for liquid waste
- 12" (305 mm) rough-in
- Dual Force flushing system
- 2-1/2" (64 mm) glazed trapway
- 31" (787 mm) x 13-5/8" (346 mm) x 29-7/8" (759 mm) rough-in

Codes/Standards Applicable

Specified model meets or exceeds the following:

- ASME A112.19.2/CSA B45.1
- ASME A112.19.14
- EPA WaterSense®

DUAL FORCE® HET-HIGH EFFICIENCY TOILET 402027

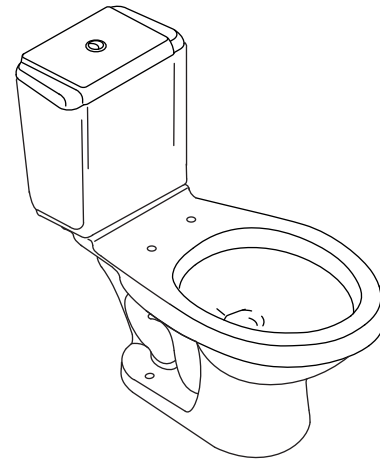

Colors/Finishes

- 0: White
- Other: Refer to Price Book for additional colors/finishes

Accessories

- NA: None applicable

Specified Model

| Model | Description | Included tank | Included bowl | Colors/Finishes | |
|--------|---|---------------|---------------|----------------------------|-------------------------------------|
| 402027 | Dual Force HET-High Efficiency Toilet, elongated bowl | 402022 | 402026 | <input type="checkbox"/> 0 | <input type="checkbox"/> Other_____ |

Technical Information

| | |
|------------------------|--------------------------------------|
| Fixture: | |
| Configuration | two-piece |
| Water per full flush | 1.6 gal (6 L) |
| Water per half flush | .8 gal (3 L) |
| Passageway | 2" (51 mm) |
| Water area | 4-1/2" (114 mm) x 5-3/4" (146 mm) |
| Seat post hole centers | 5-1/2" (140 mm) |

| | |
|----------------------|---------|
| Included Components: | |
| Tank accessory pack | 1035430 |
| Tank lid | 1045794 |

Installation Notes

One flush cleansing of the bowl per ASME A112.19.2/CSA B45.1 and Dual Force[®] toilets per ASME A112.19.14-2006 performance requirements, when installed and operated per instructions packed with the product.

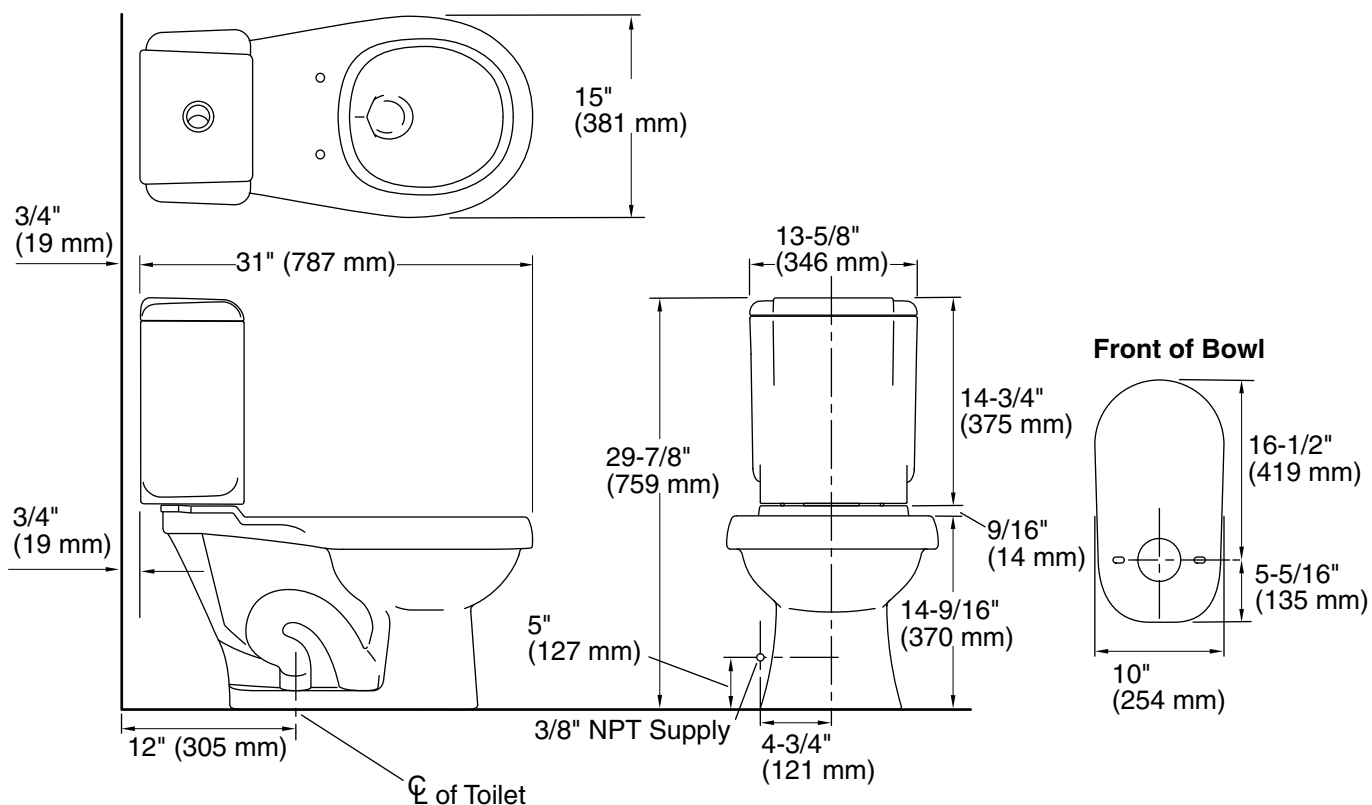

Product Diagram