

LIGHTING

1. Remove old ash or coals before continuing.
2. Place dry kindling or a natural fire starter in the center of the fire pit.
3. Stack dry and seasoned hardwood around and over the kindling. (Avoid hardwood longer than 18 inches.)
4. Light the kindling or fire starter using a long match.

TENDING THE FIRE

Do NOT use gasoline, kerosene, diesel fuel, lighter fluid or alcohol.

Do NOT place hot tools onto combustible surfaces, such as grass or wooden furniture.

Wear heat-resistant gloves when tending the fire or fire pit. Avoid touching hot surfaces.

Use a long-handled fireplace tool (tongs or poker) to shift logs as needed for complete burning.

Do NOT add additional wood until embers have developed.

To add wood, gently place it onto the embers.

EXTINGUISHING THE FIRE

Allow the fire to burn out. Spread wood/coals/embers apart to help it burn out quicker.

Do NOT leave the fire unattended.

DO NOT use water to extinguish a fire. Doing so could result in injury or damage to the fire pit.

GRILLING OVER THE FIRE

To grill using the swing-away grid, build a suitable bed of embers/coals inside the fire pit.

Position the grid at the desired height.

Pivot the grid so it is centered inside the fire pit and over the heat.

GRILLING TIPS

Build a good bed of hot embers prior to cooking. You can create smoke to add flavor by adding a small amount of wood to the embers.

Adjust the cooking grate as needed to achieve the desired cooking temperature. The grate can be placed in different positions. In addition, the grate swivels, allowing the easy ability to position it over or away from the heat or fire.

Clean the grate after each use. Use vegetable oil to coat the grid after each use to help prevent corrosion.

FOOD SAFETY

To avoid sickness, practice food safety while preparing and cooking any food.

Do NOT mix any raw meats with any cooked food.

Do NOT reuse pans, serving dishes or utensils after touching raw meats.

Do NOT leave meats at room temperature to thaw. Allow them to thaw over time inside a refrigerator.

Keep all grilling tools, dishes and your hands clean, especially after handling raw meats.

Do NOT eat or serve food that is undercooked.

Note: Do NOT bake food directly on the cooking grate, please use the cooking pan or food-grade aluminum foil to grill indirectly.



WARNING: FUELS USED IN WOOD OR CHARCOAL BURNING APPLIANCES, AND THE PRODUCTS COMBUSTION OF SUCH FUELS, CAN EXPOSE YOU TO CHEMICALS INCLUDING CARBON BLACK, WHICH IS KNOWN TO THE STATE OF CALIFORNIA TO CAUSE CANCER, AND CARBON MONOXIDE, WHICH IS KNOWN TO THE STATE OF CALIFORNIA TO CAUSE BIRTH DEFECTS OR OTHER REPRODUCTIVE HARM.

Assembly Instructions

Product Name: Fire pit

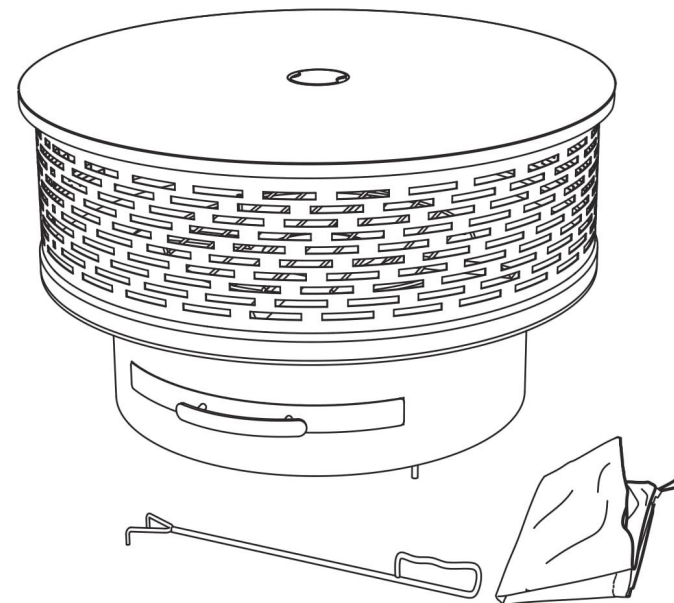

WARNING:

- This fire bowl is intended for outdoor use only.
- Not for use on wood deck or flammable surface.
- This fire bowl is intended for burning wood logs only. Do not burn coal, leaves, or other combustible materials in the bowl.
- Not for use by children. Keep children and pets away from this fire bowl.
- When in use, the handle on the mesh cover can reach extremely high temperatures that can cause serious injury to an unprotected hand. Protective gloves and long-handled tools are recommended for use with this fire bowl.
- Never leave the burning fire bowl unattended, and always extinguish the fire completely before leaving the fire bowl.
- Do not use fire bowl on heat-sensitive or combustible structures.
- Check local fire regulations and municipal by-laws for information regarding the safe use of this product.
- Read all safety guidelines, warnings, instructions, and operating rules carefully before assembling and using this product.
- Some parts may contain sharp edges. Wear protective gloves if necessary during assembly and use.

PARTS LIST

No.	PARTS	Qty
A	Lid	1
B	Grill	1
C	Fire Bowl	1
D	Base	1
E	Log Grate	1

No.	PARTS	Qty
F	Poker	1
G	Cover	1
H	Ash Pan	1
I	Handle	1

HARDWARE LIST

No.	Hardware	Qty
AA	M5*8 mm Bolt	2
BB	M6*10mm Bolt	4

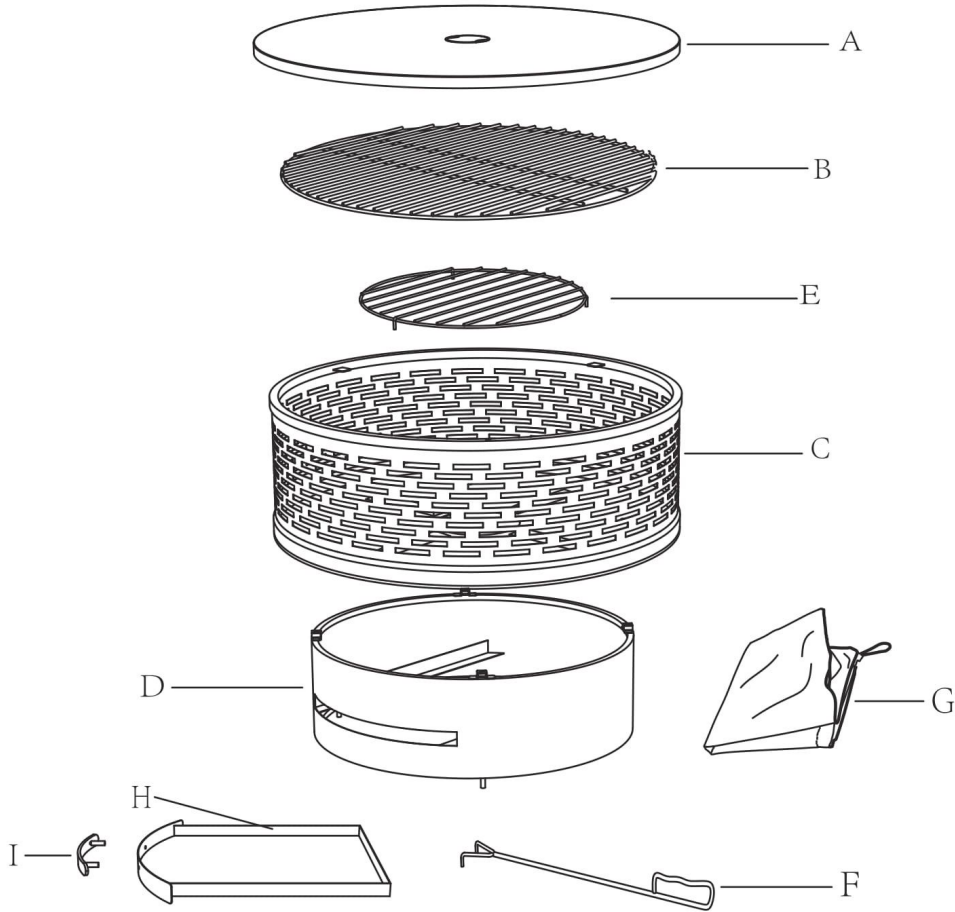

Note: You will need a screwdriver to complete the assembly.

Step 1: Attach Handle (I) to Ash Pan (H) using M5 x 8mm Bolts (AA)×2. Tighten all the hardware. Put Ash Pan into the base (D).

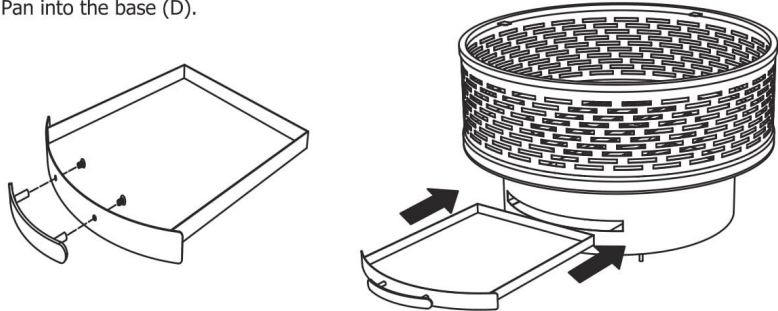

Step 2: Attach Fire Bowl (C) to Base (D) using M6 x 10mm Bolts (BB)×4. Tighten all the hardware.

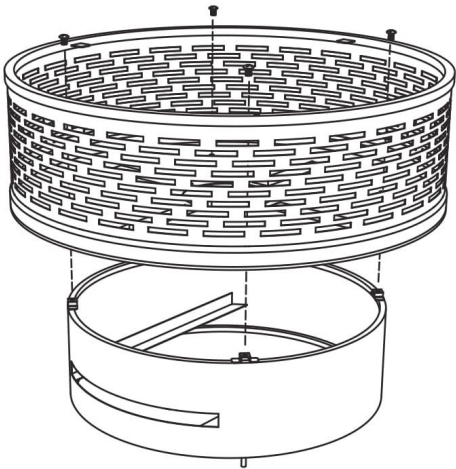

Step 3: Put Log Grate (E), Grill (B), Lid (A) on the Fire Bowl (C) Put the Metal Lid (A) on the fire bowl to use as a table. Cover it after the fire pit has completely cooled .

