

①

Step One: Open the package first, embed the washers in the wheels(A*4), then use the wrench to fix the wheels(A*4).

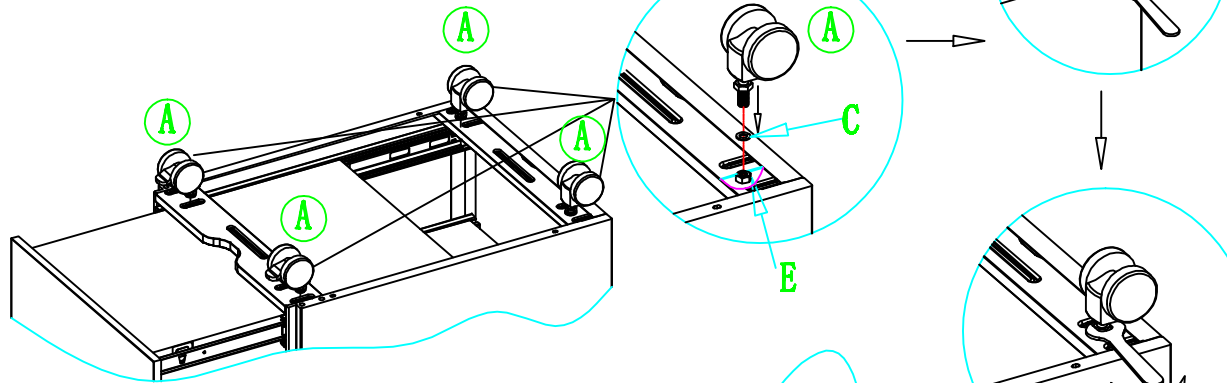

②

Step Two: Take out the small front wheel(B*1), embed the washers in the small wheel, then use the wrench to fix the wheels(B*1).

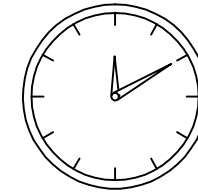
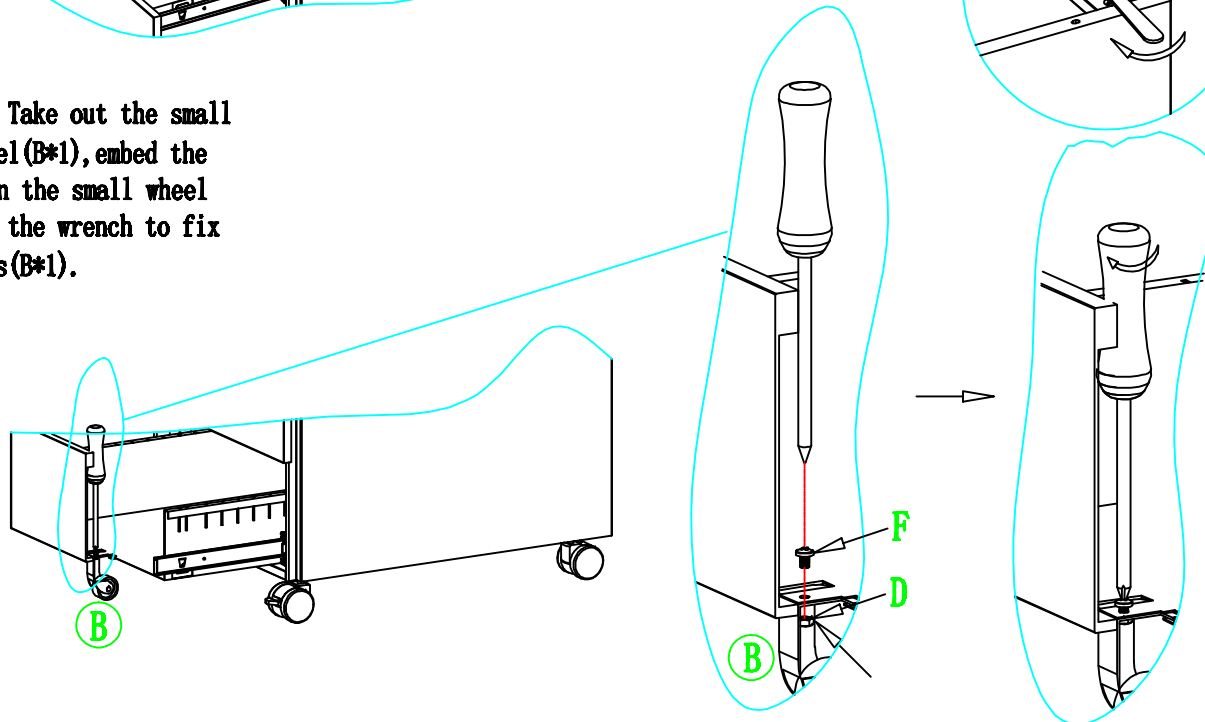

×1

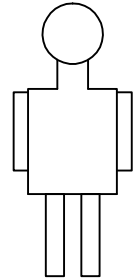

C

×4

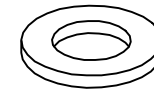

D

×1



E

×4

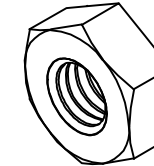

F

×1

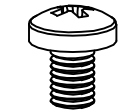

Tool
(Not included)

×1

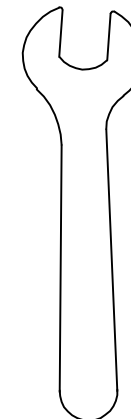

Tool
(Not included)

×1

