

Installation & Assembly

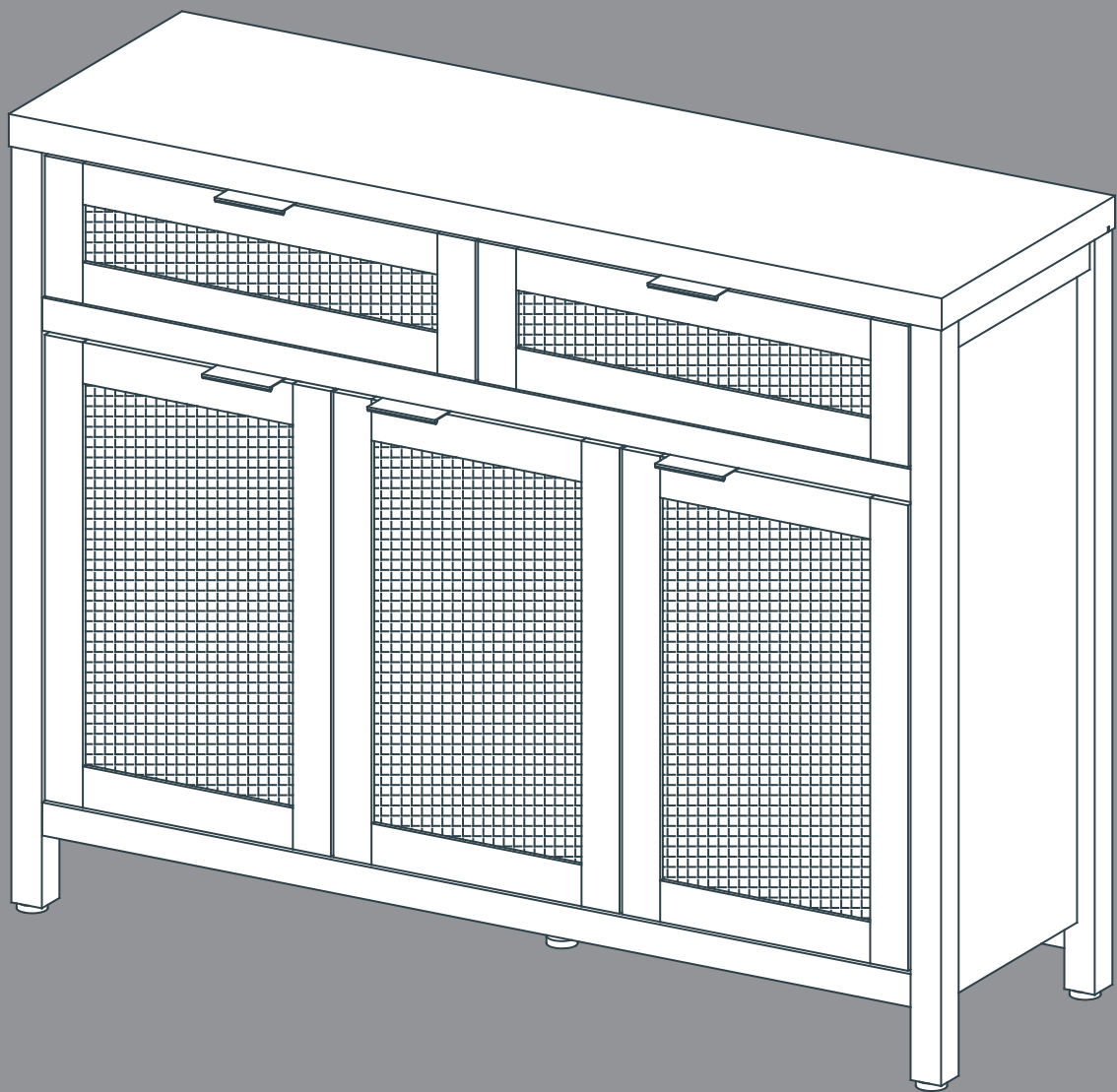

Assembly Instructions

Before beginning the assembly process, please read and save these instructions for reference.

Following these guidelines will ensure a smooth and successful assembly of your product.

1. Part Identification:

Carefully separate and identify all the parts included in your package. Confirm that you have all the components listed in the instruction manual. This step will help you avoid any missing or misplaced parts during assembly.

2. Work Surface:

To prevent any scratches or damage to the product, assemble it on a soft mat or a similar protective surface. This will provide a cushioned area for the components and protect the surfaces from unwanted marks.

3. Step-by-Step Assembly:

Follow the assembly instructions provided, proceeding one step at a time. Take care to understand each step properly before proceeding to the next one. This sequential approach ensures that the assembly is done correctly and minimizes the chance of errors.

4. Proper Screw Seating:

When attaching screws and nuts, it is essential not to fully tighten them until all screws are correctly seated. By partially tightening each screw and nut initially, you can ensure that they are aligned properly and fit securely before final tightening.

5. Avoid Over-Tightening:

While each screw and nut should be tightened correctly, it is crucial not to over-tighten them. Over-tightening can cause damage to the product or compromise its structural integrity. Use the appropriate amount of force to secure the components without excessive tightening.

Customer help center:

If you encounter any questions or problems during the assembly process, please do not hesitate to contact us.

We strive to provide excellent customer support and will respond to your inquiries within 24 hours. Our team will offer you a suitable solution to address any concerns you may have.

Parts List

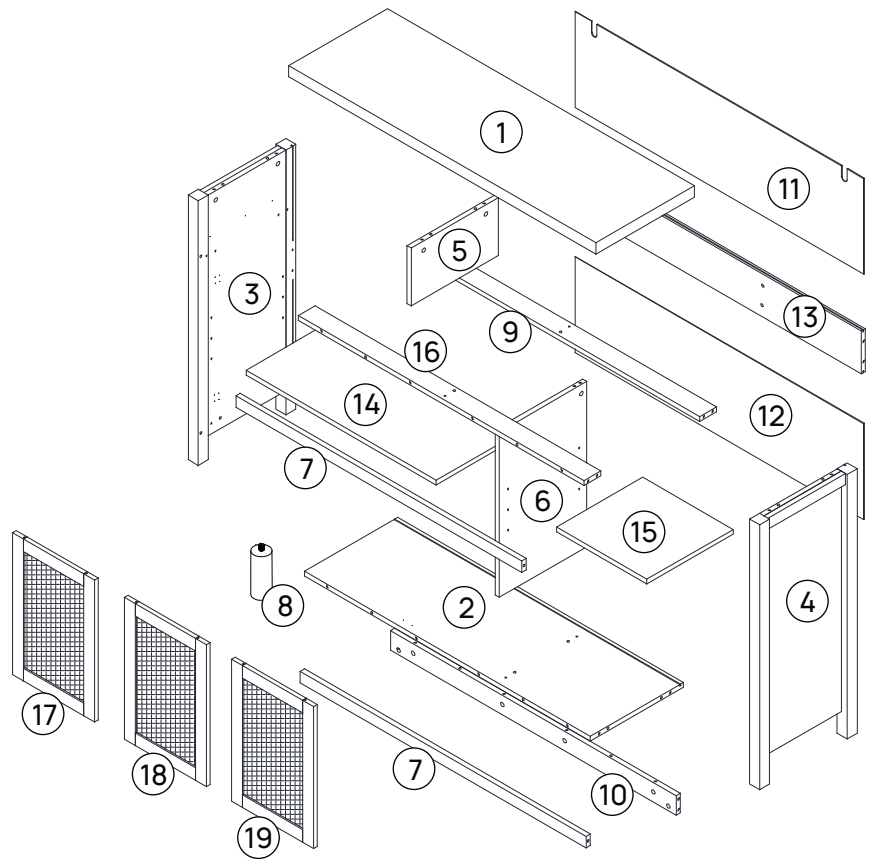
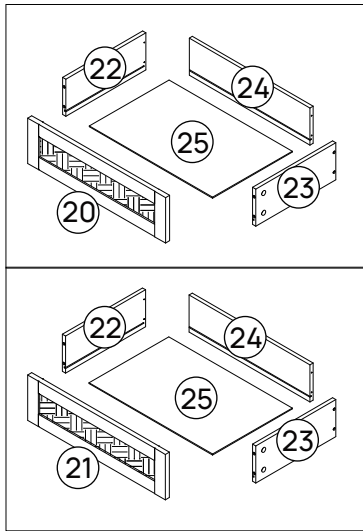

Hardware List



Code	Description	Quantity	Code	Description	Quantity
A	Ø6*35mm Cam bolt	46+2	M	Lock wall accessories	2
B	Ø15x10mm Cam lock	46+2	N	Magnet	2
C	Ø8x30mm Wood dowel	28+2	O	Magnet plate	4
D	M4x35mm Screw	16+2	P	Shelf support	8+1
E	M3x12mm Screw	36+2	Q	Handle	5
F	Backboard clip	12+2	R	Adjusting the footrest	5
G	M3x16mm Screw	16+2	CL	300mm Drawer runner set	2
H	Hinges	6	CR	300mm Drawer runner set	2
I	M3.5x14mm Screw	36+2	DL	300mm Drawer runner set	2
J	Anti falling iron sheet	2	DR	300mm Drawer runner set	2
K	M4x12mm Screw	2			

Step 1

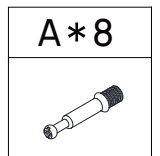
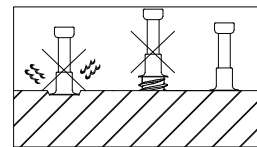
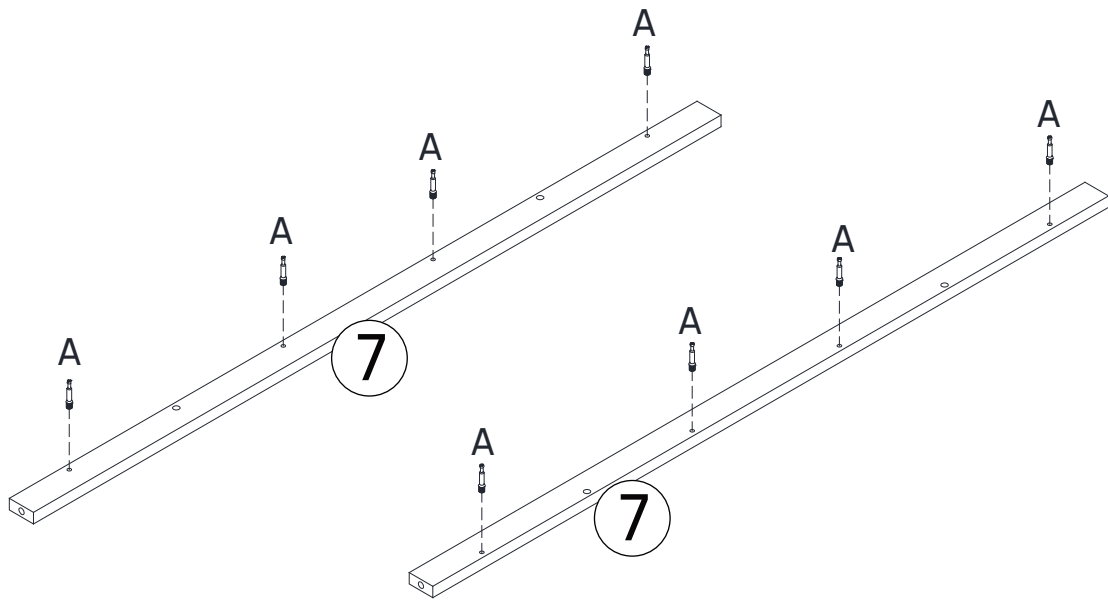

Step 2

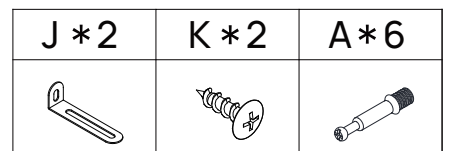
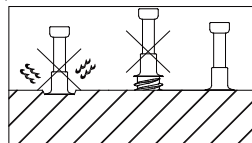
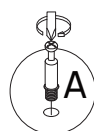
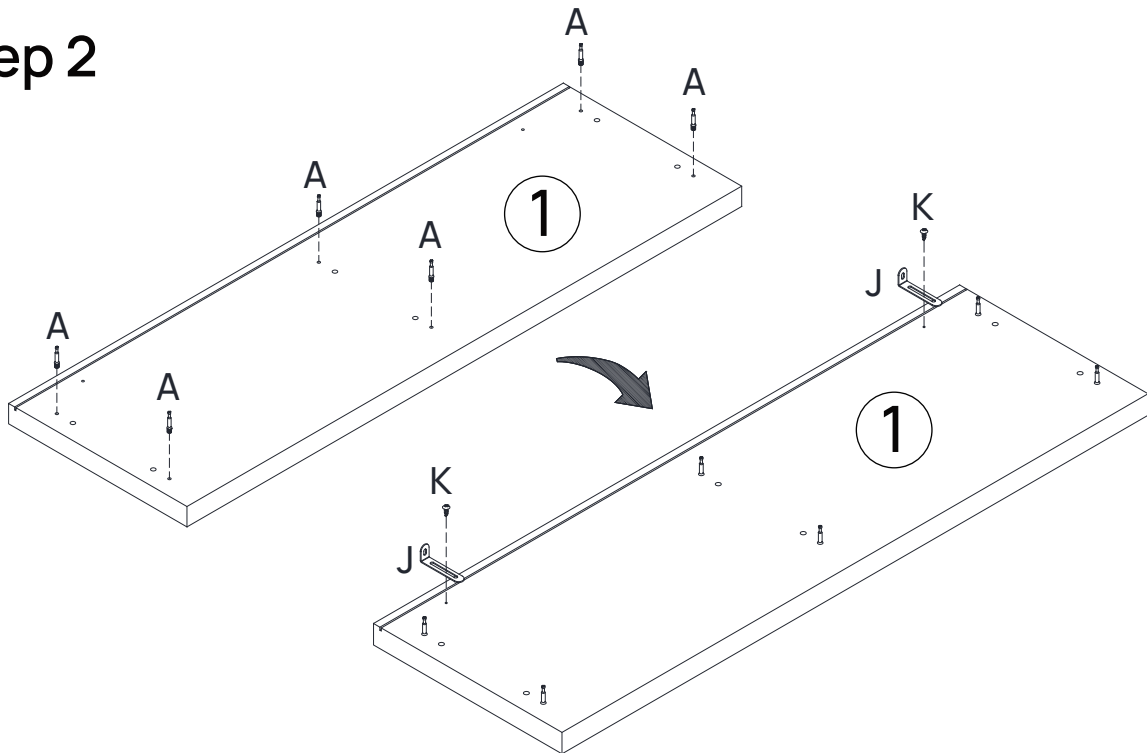

Step 3

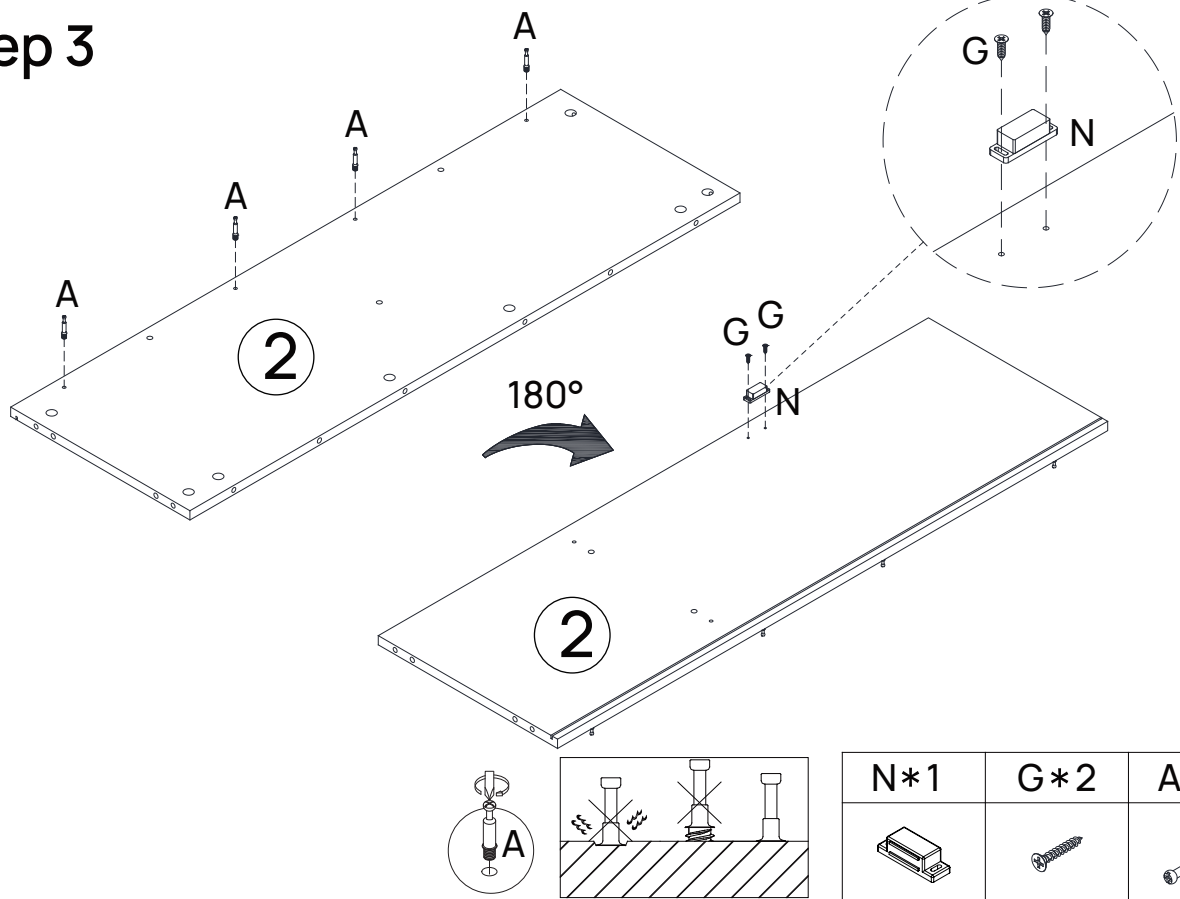

Step 4

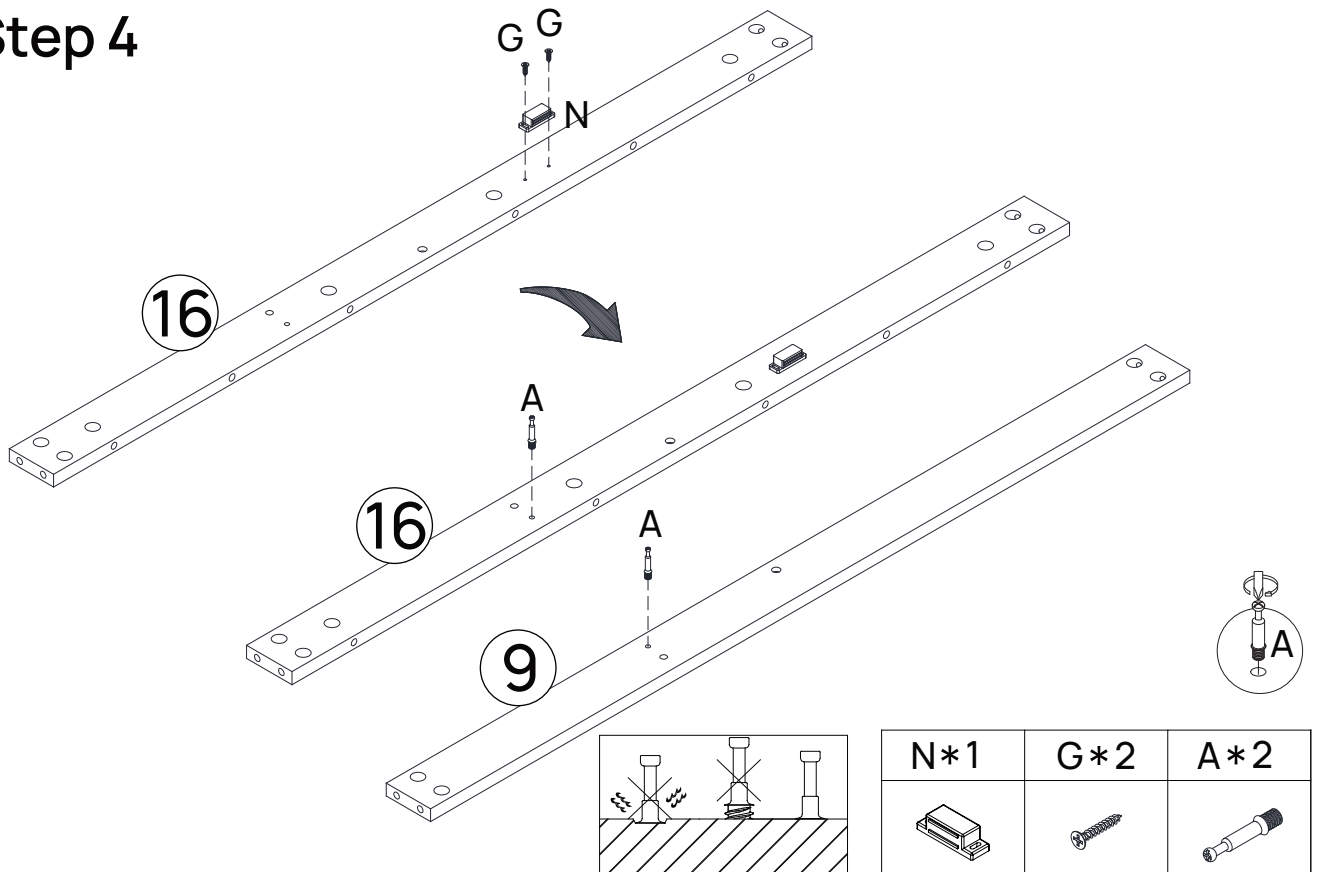

Step 5

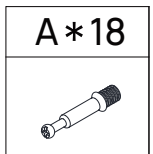
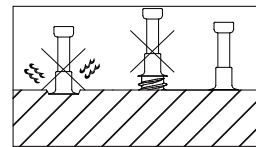
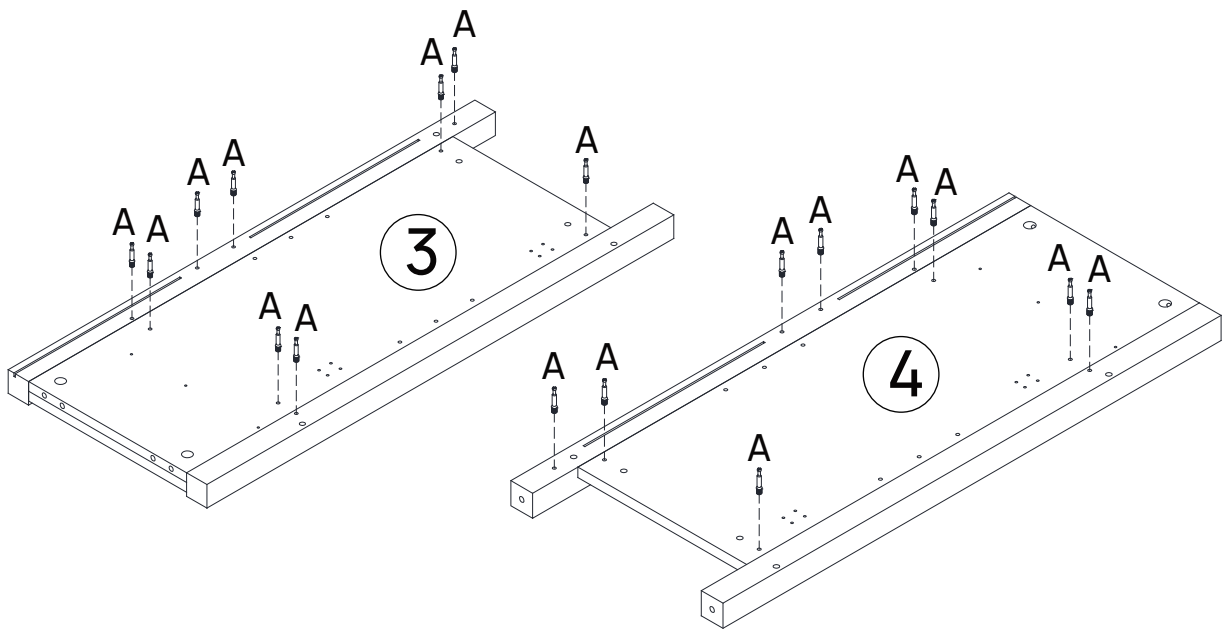

Step 6

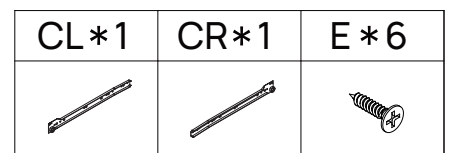
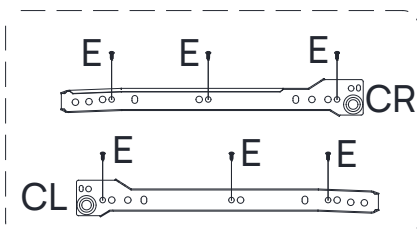
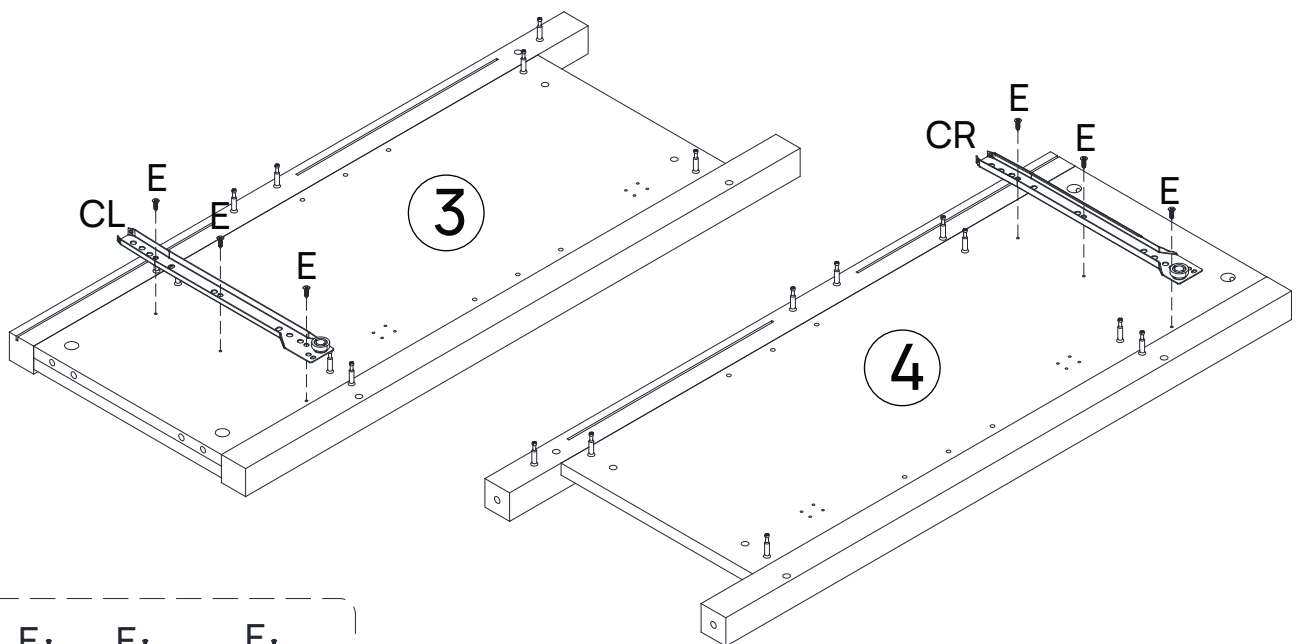

Step 7

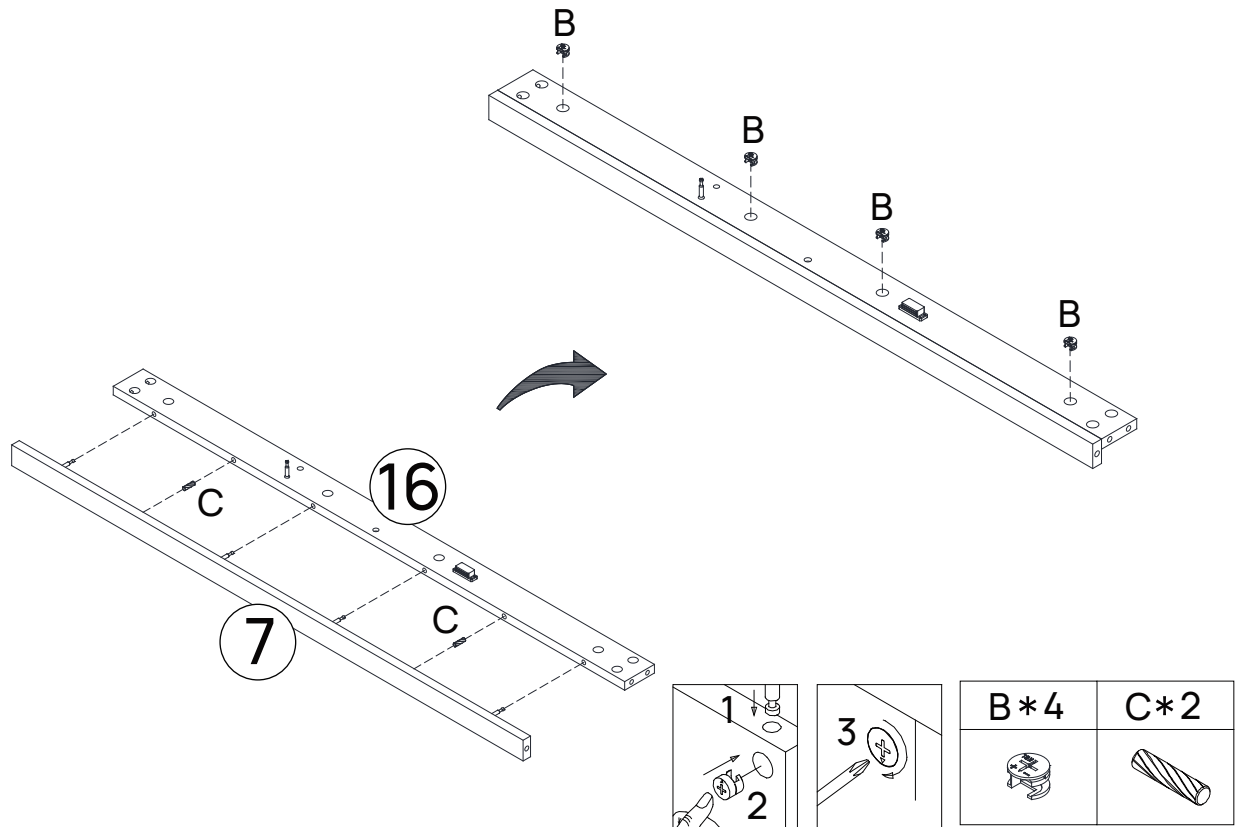

Step 8

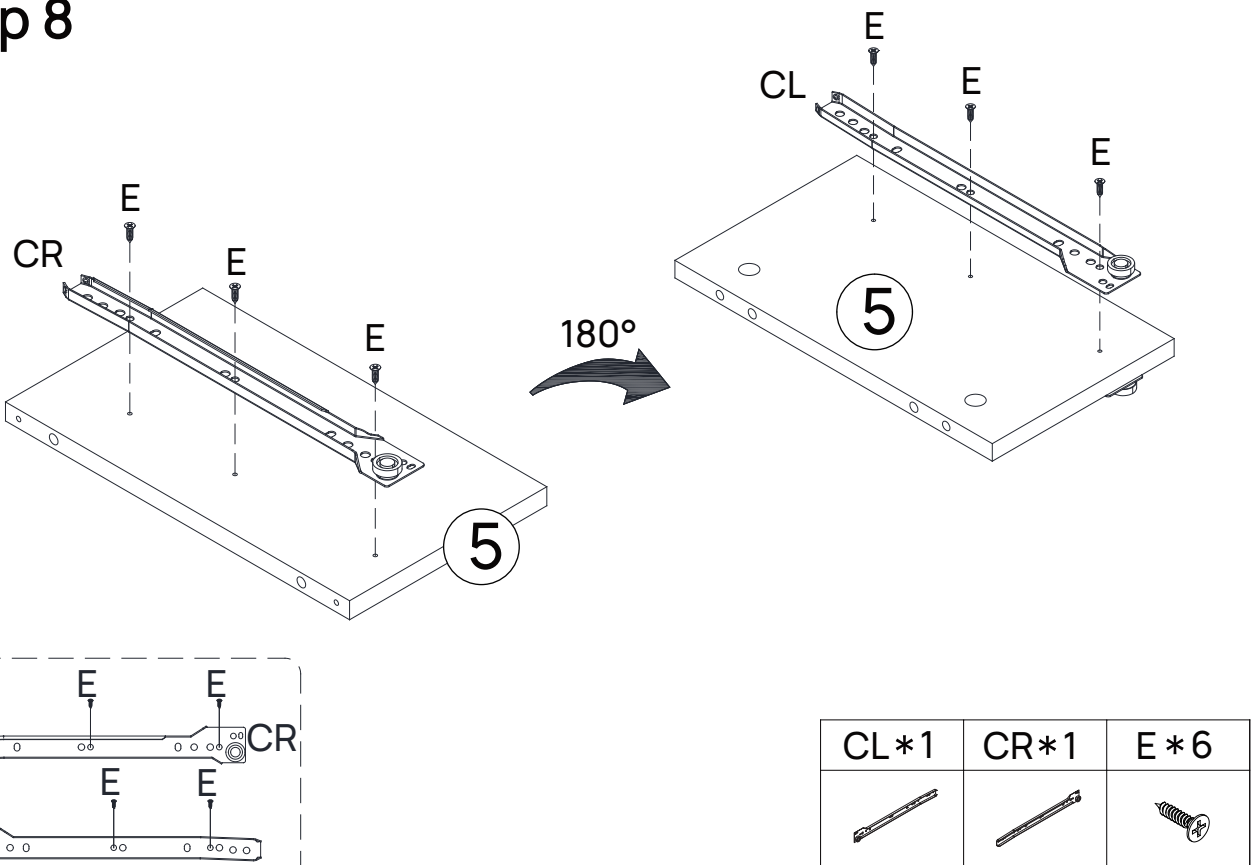

Step 9

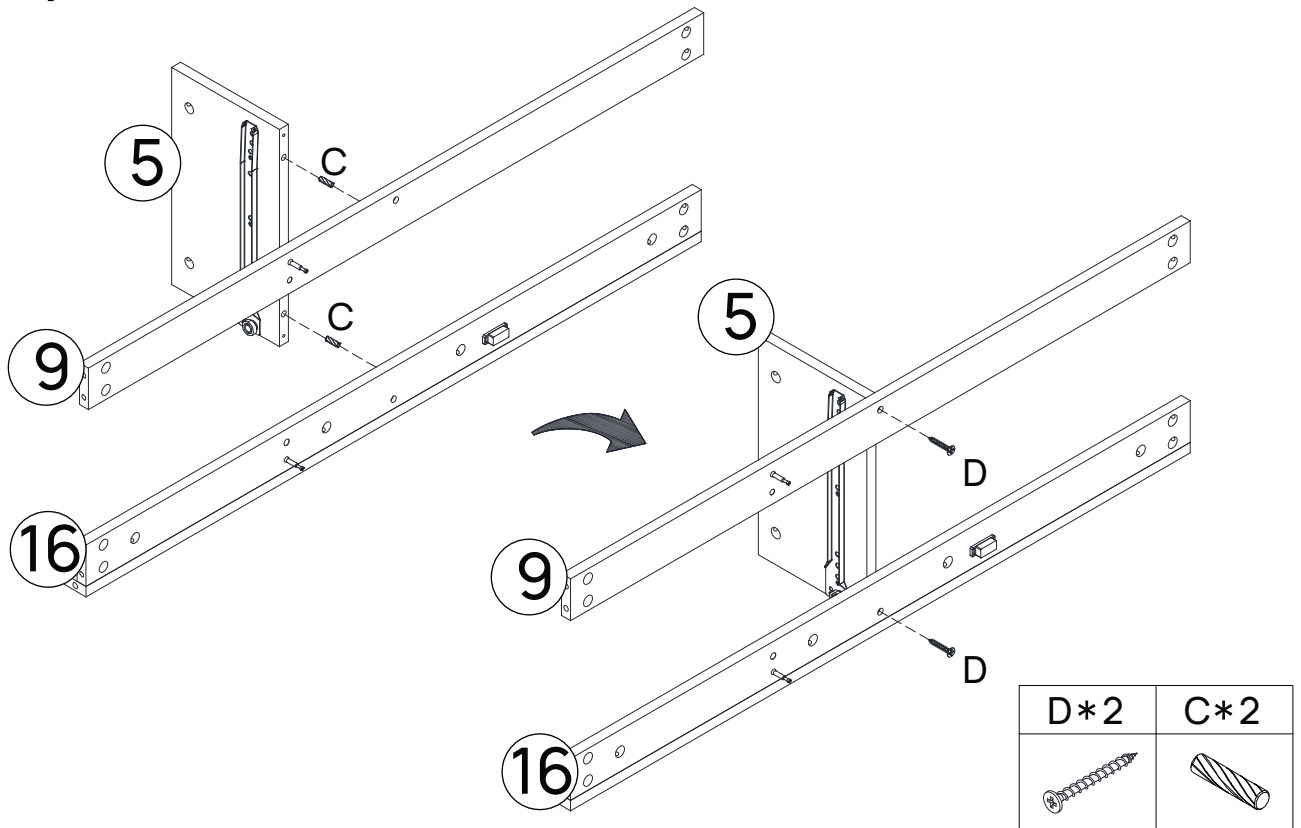

Step 10

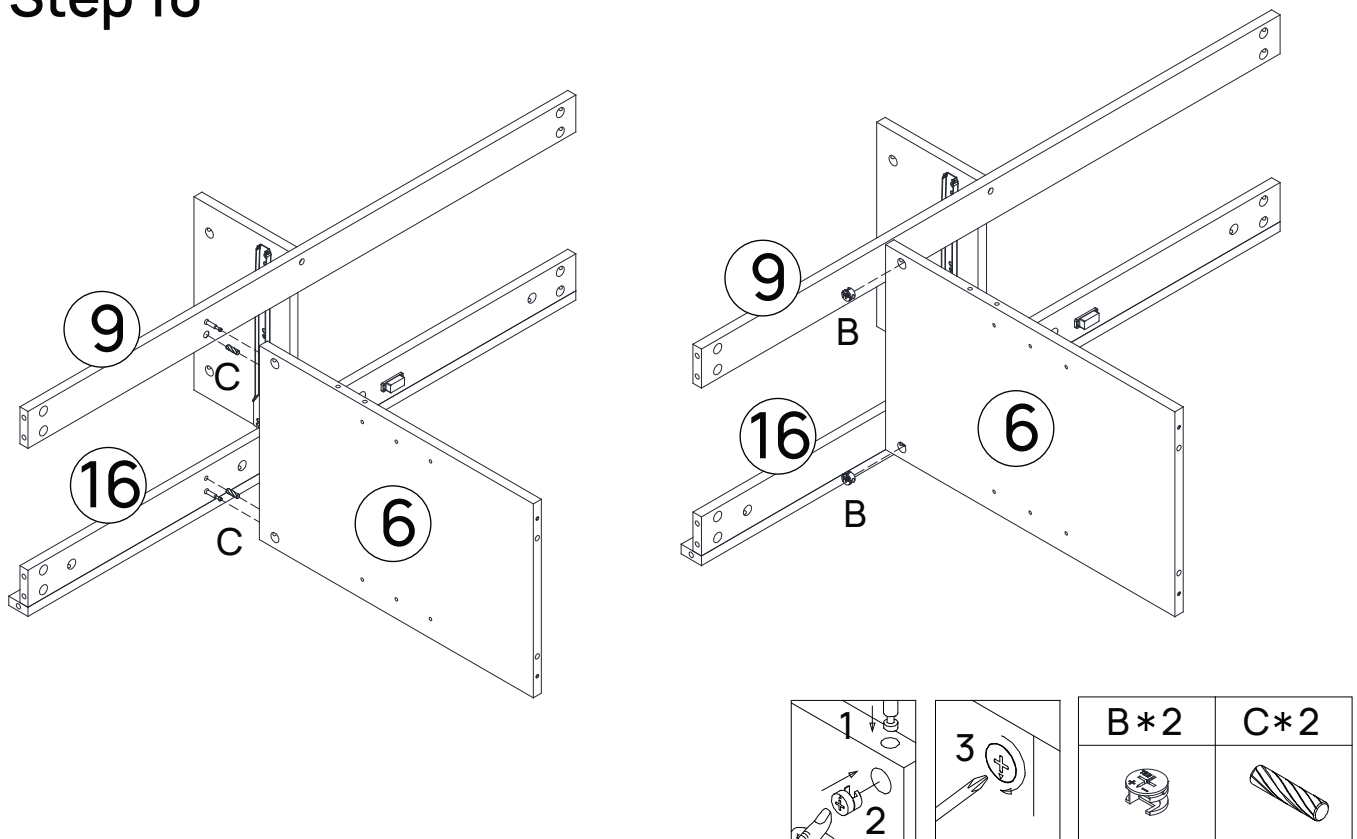

Step 11

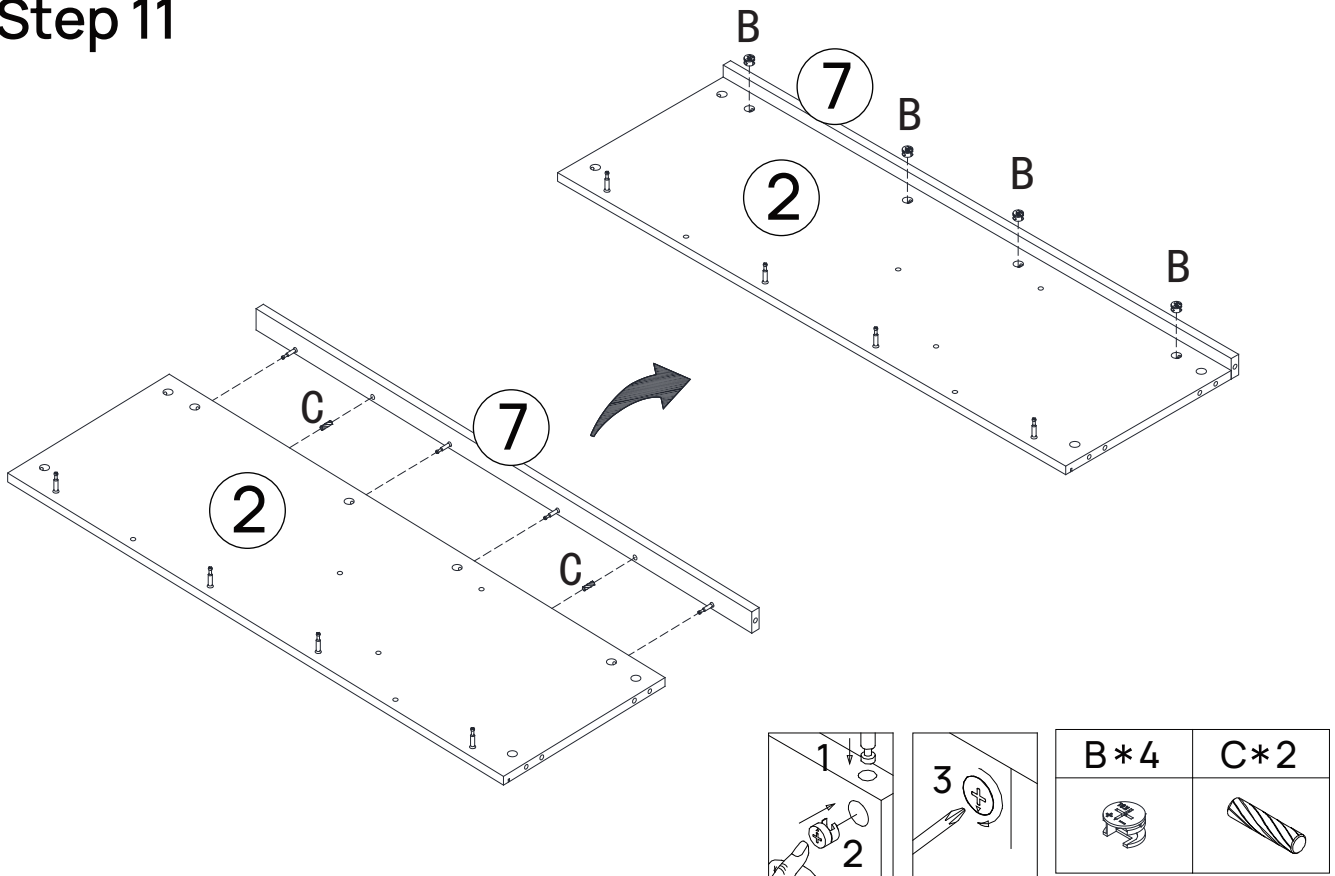

Step 12

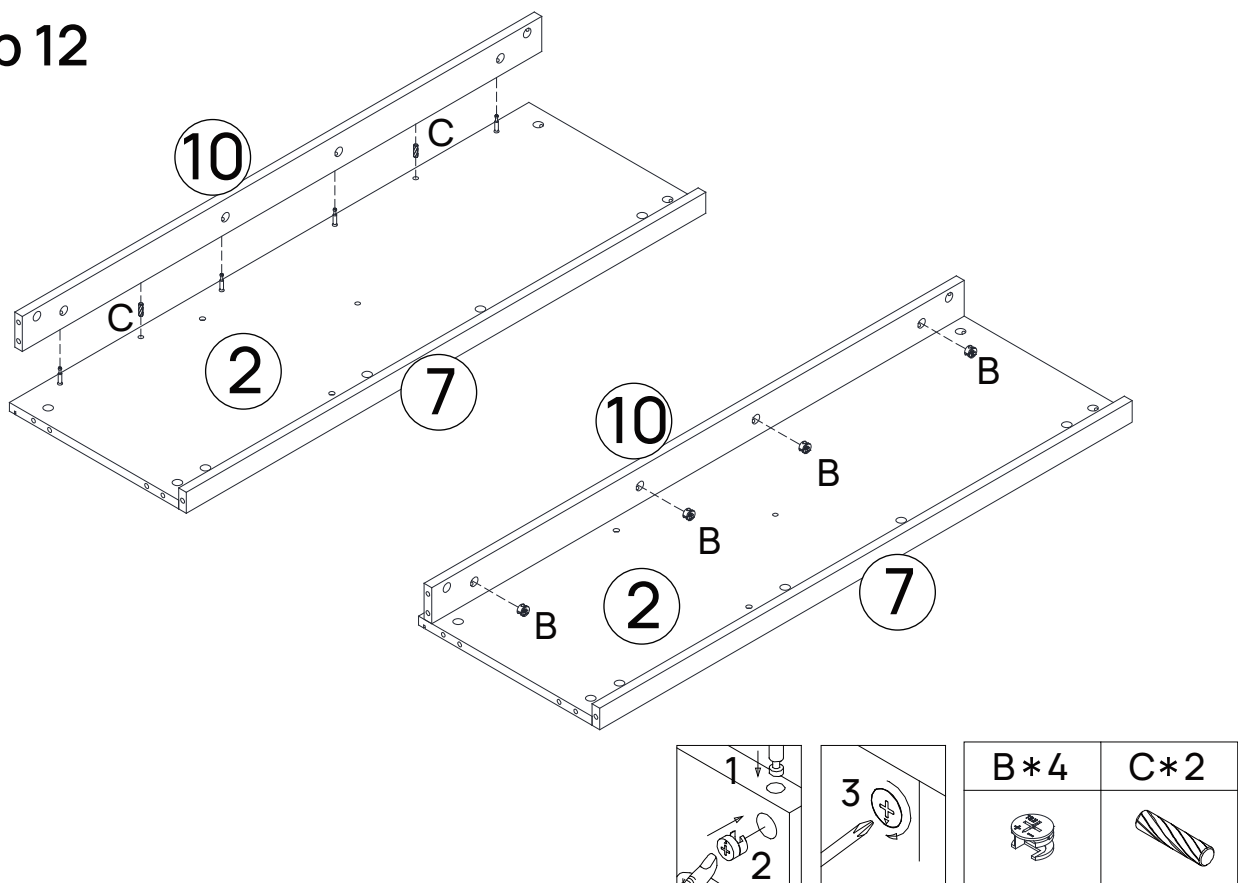

Step 13

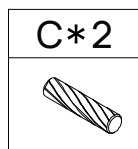
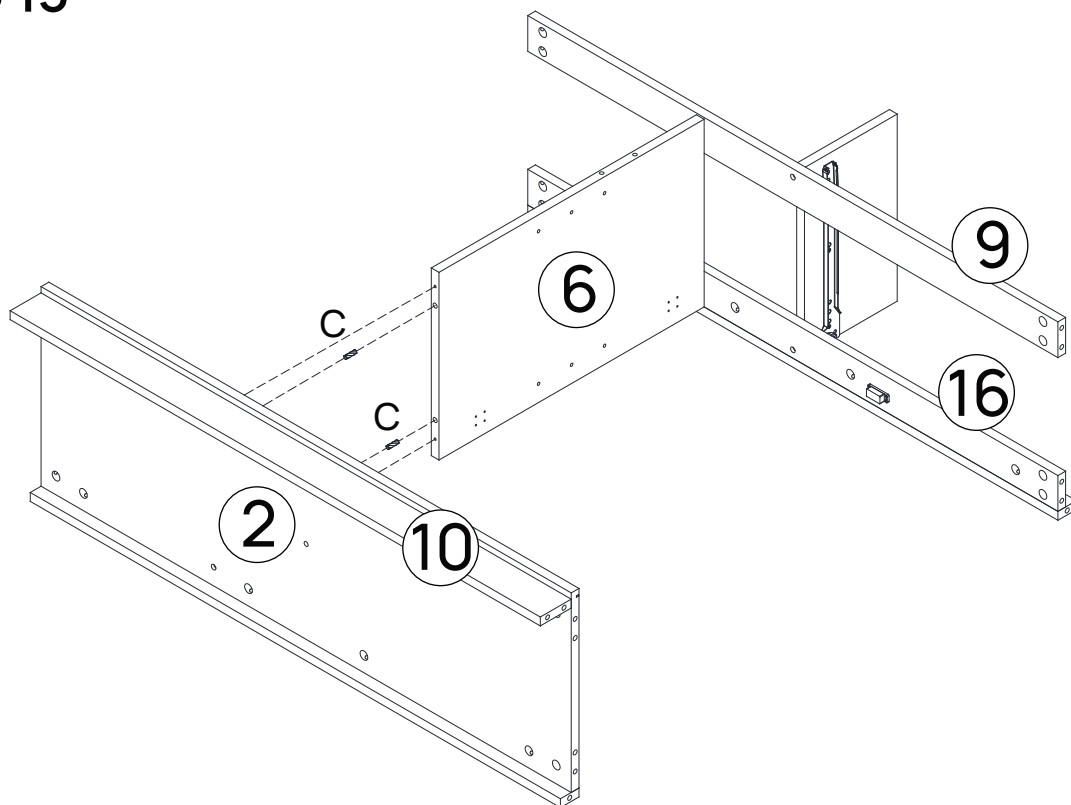

Step 14

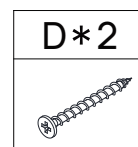
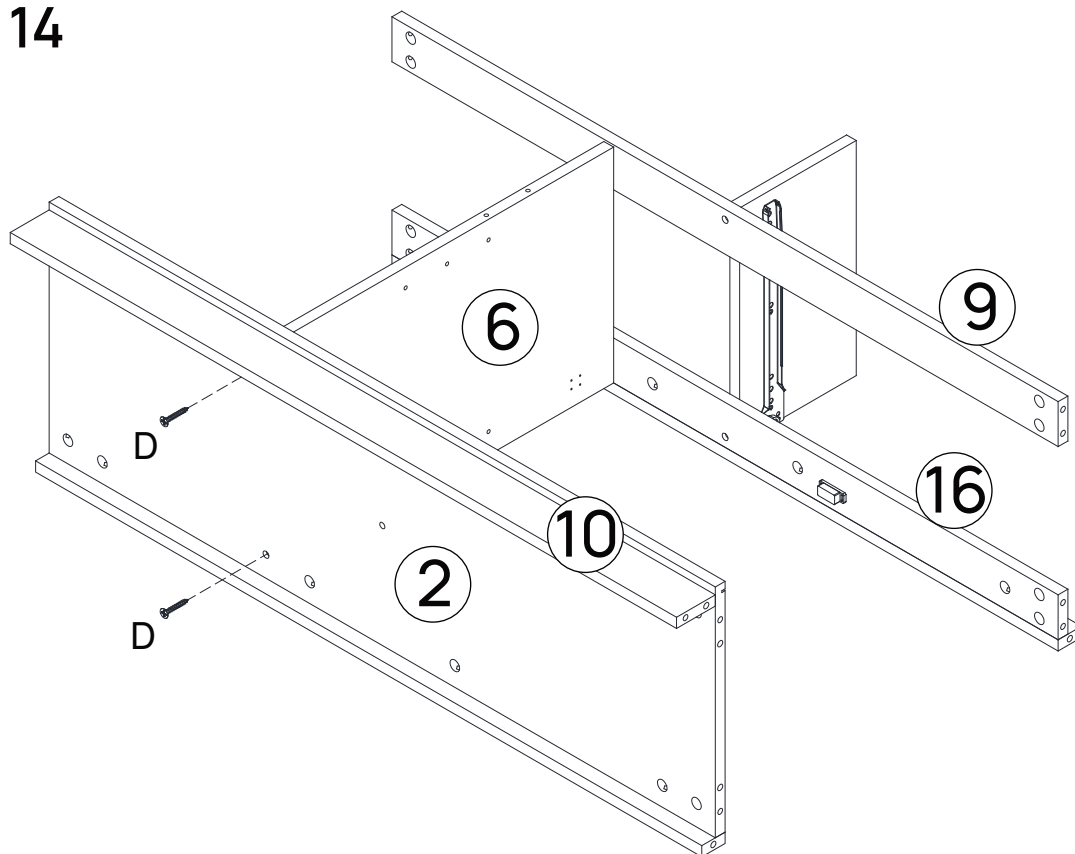

Step 15

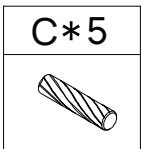
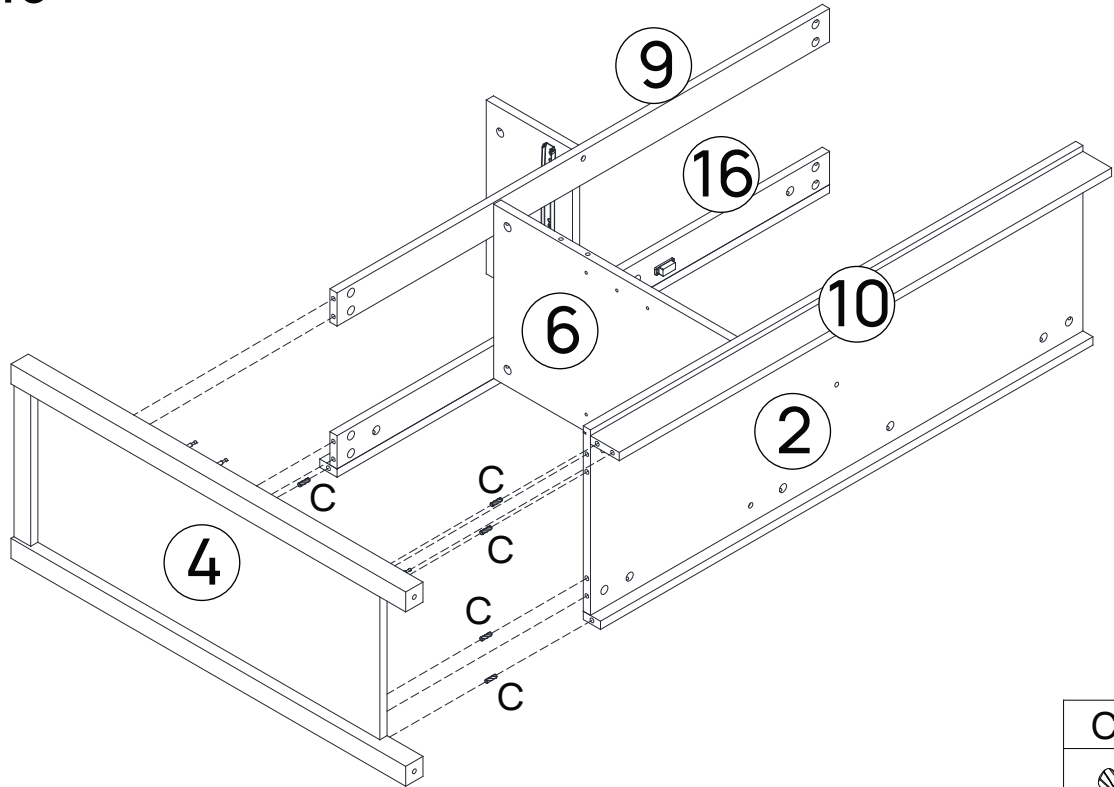

Step 16

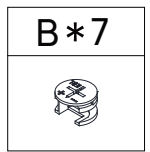
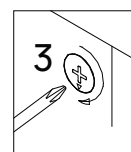
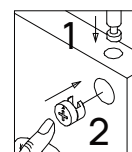
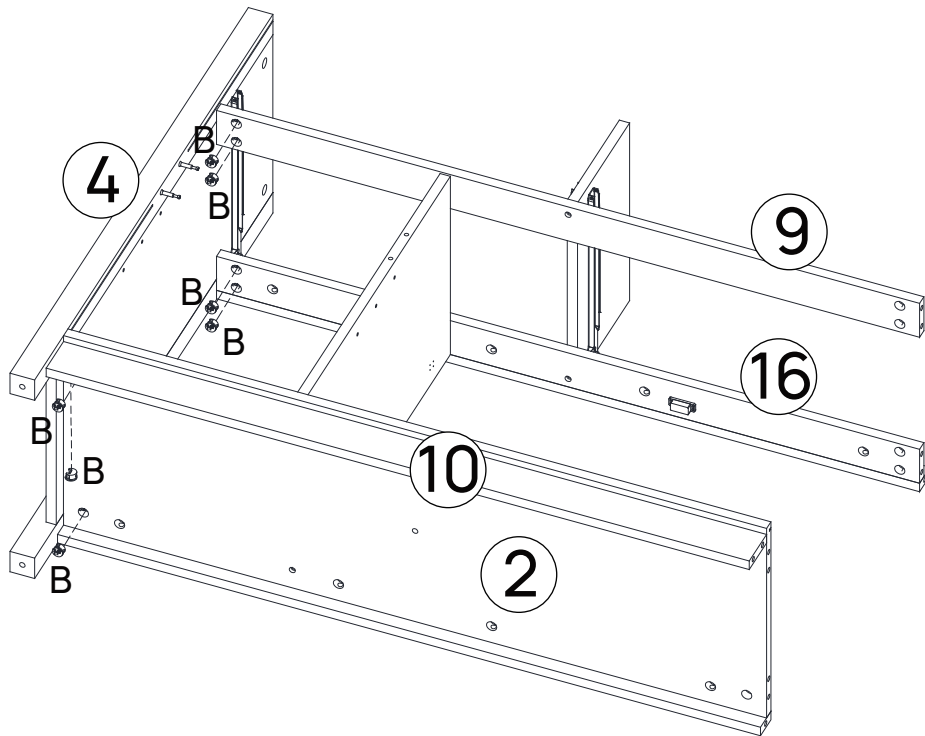

Step 17

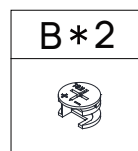
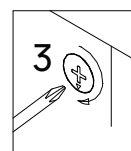
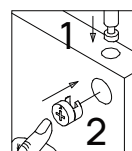
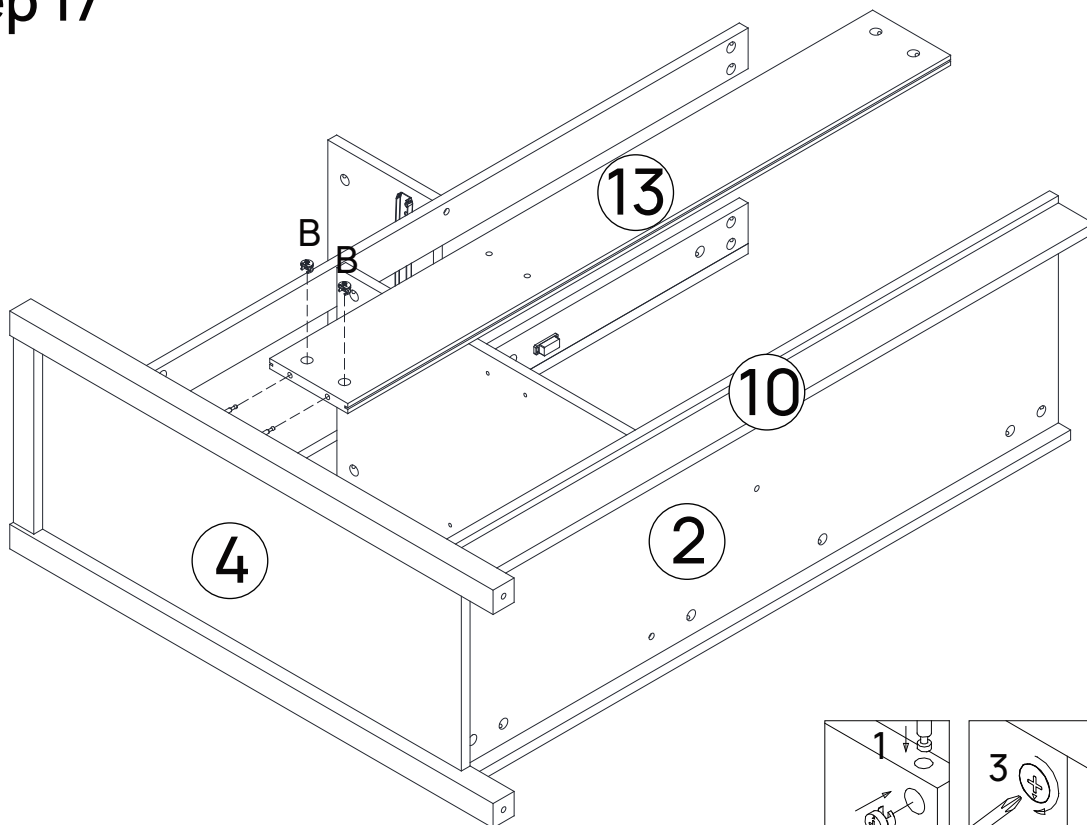

Step 18

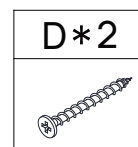
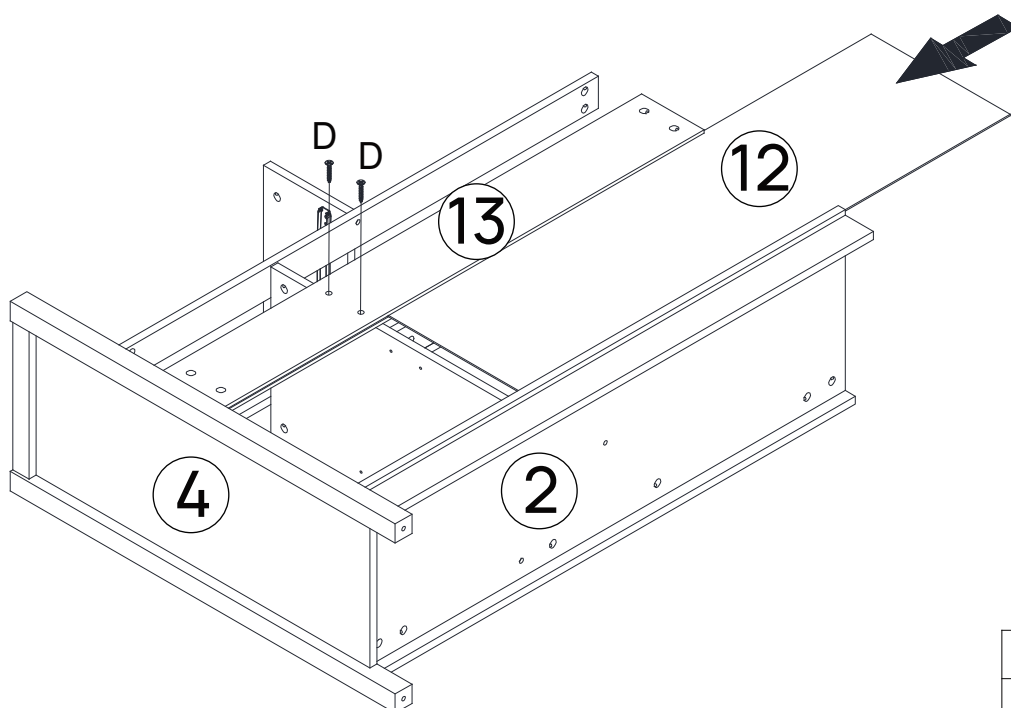

Step 19

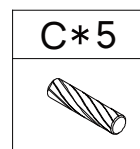
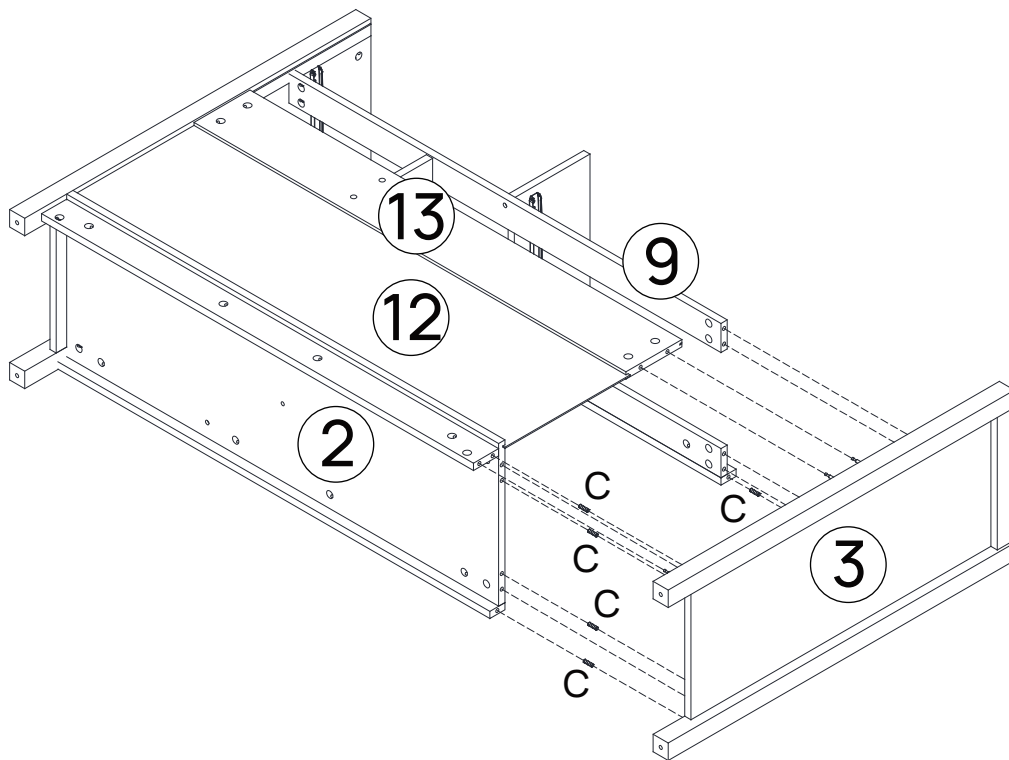

Step 20

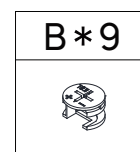
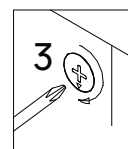
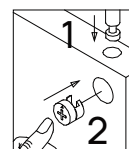
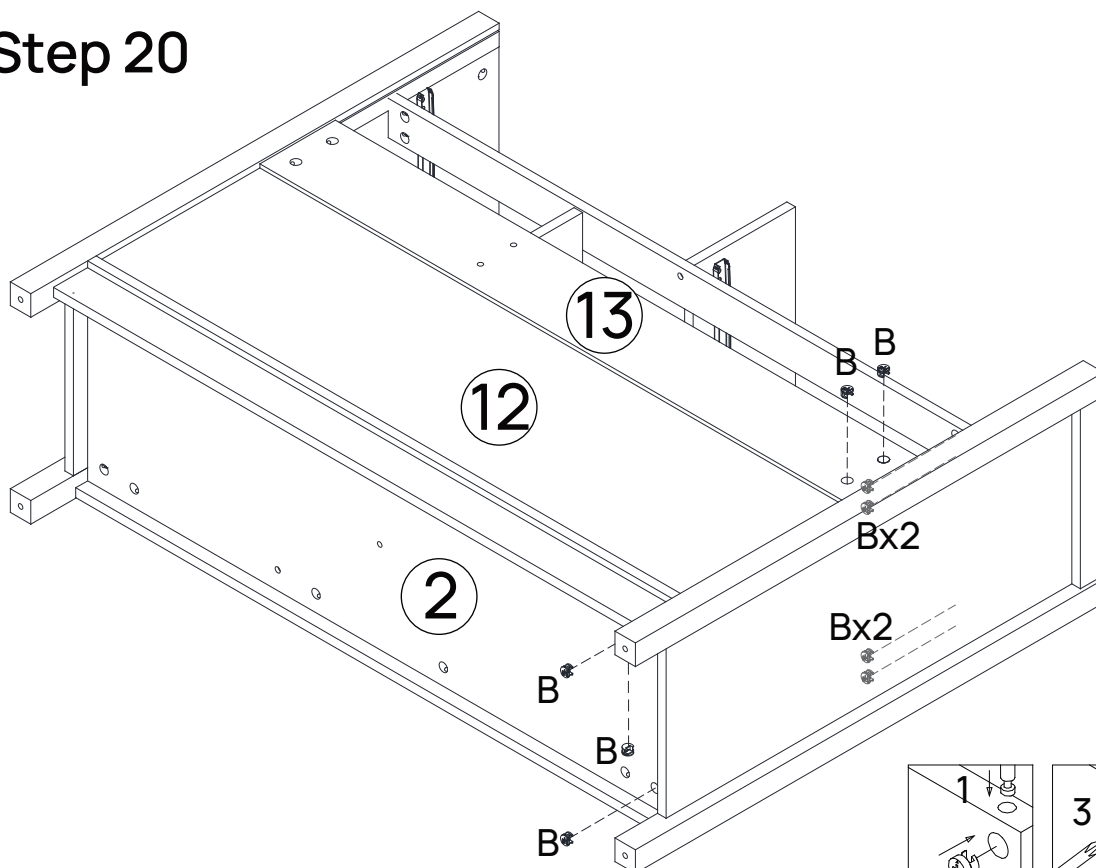

Step 21

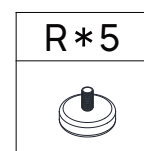
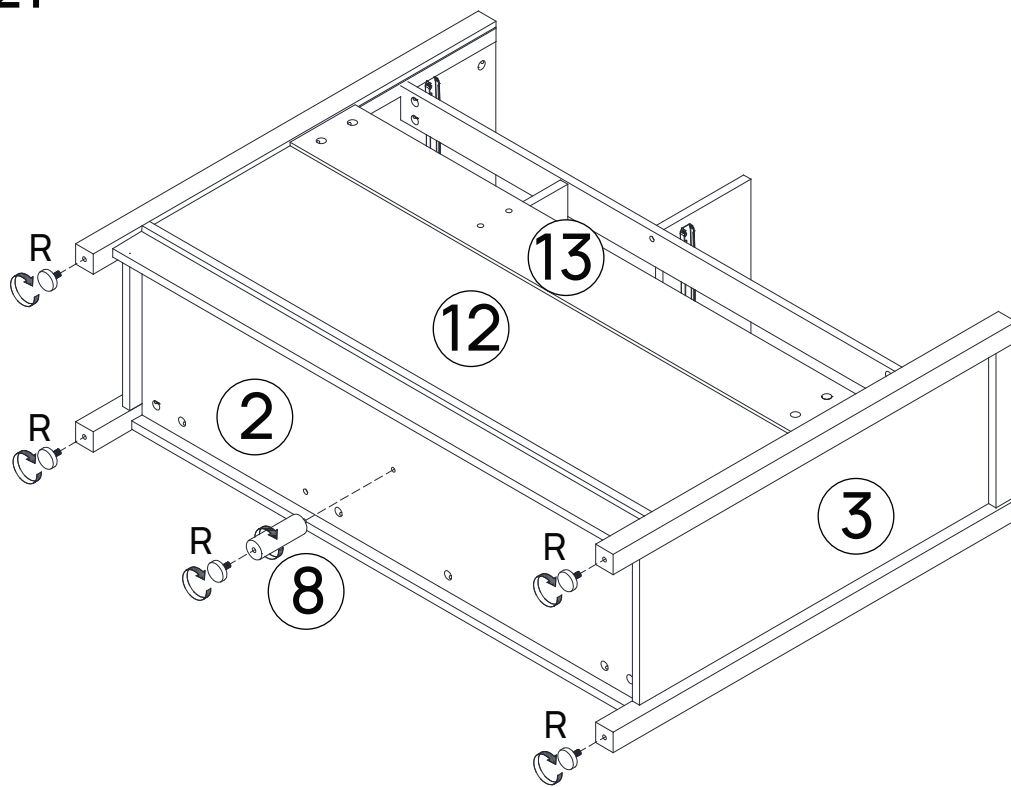

Step 22

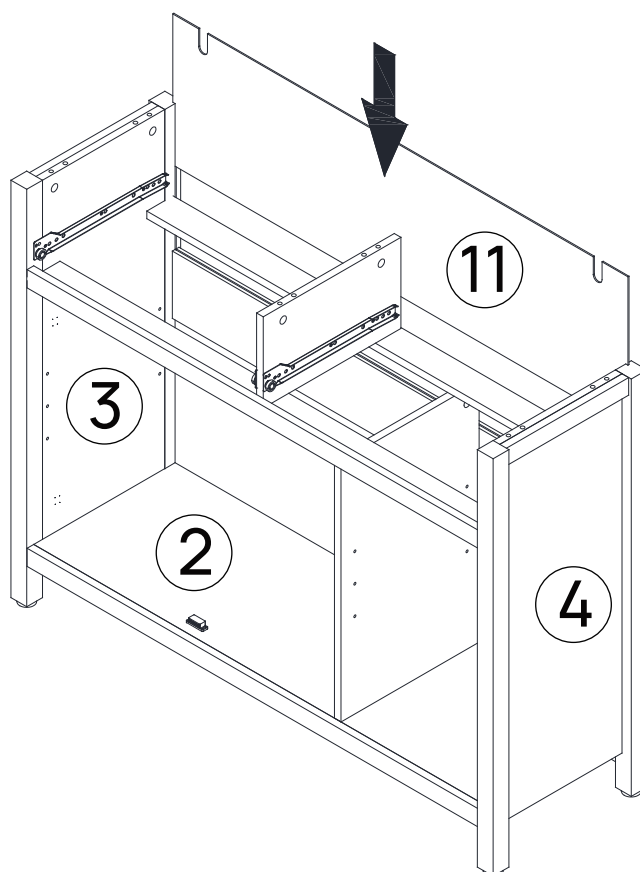

Step 23

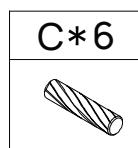
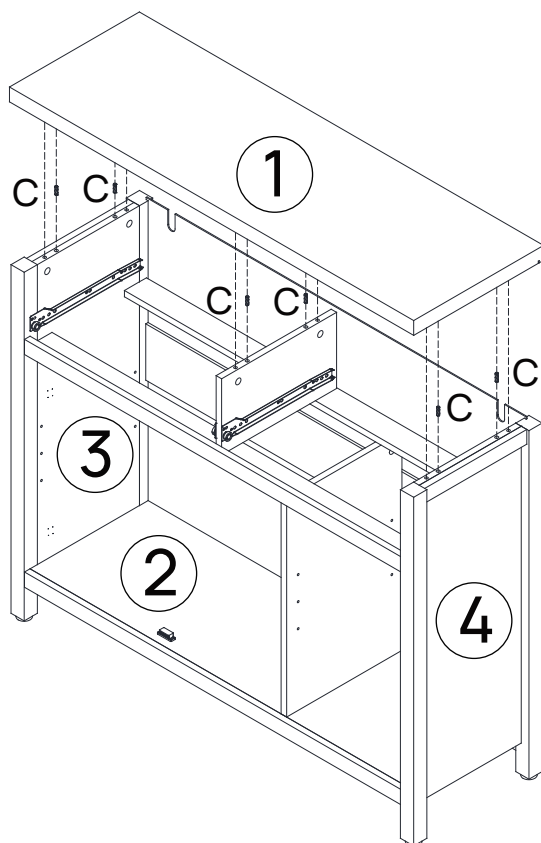

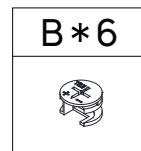
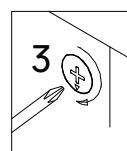
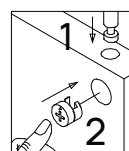
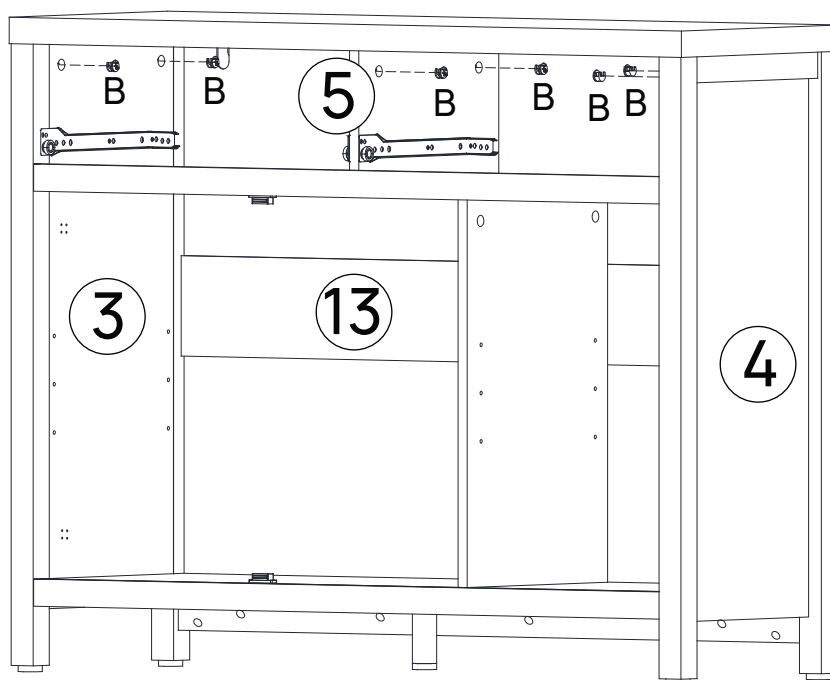

Step 24

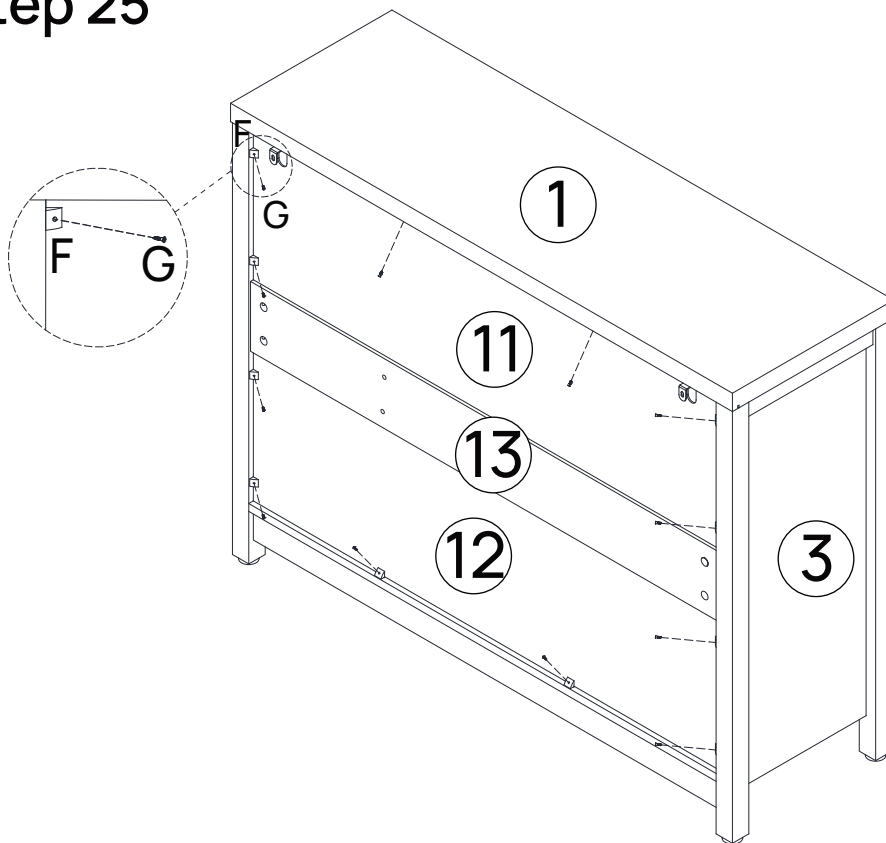

Step 25



Must Be Installed

F *12	G *12
	

Step 26

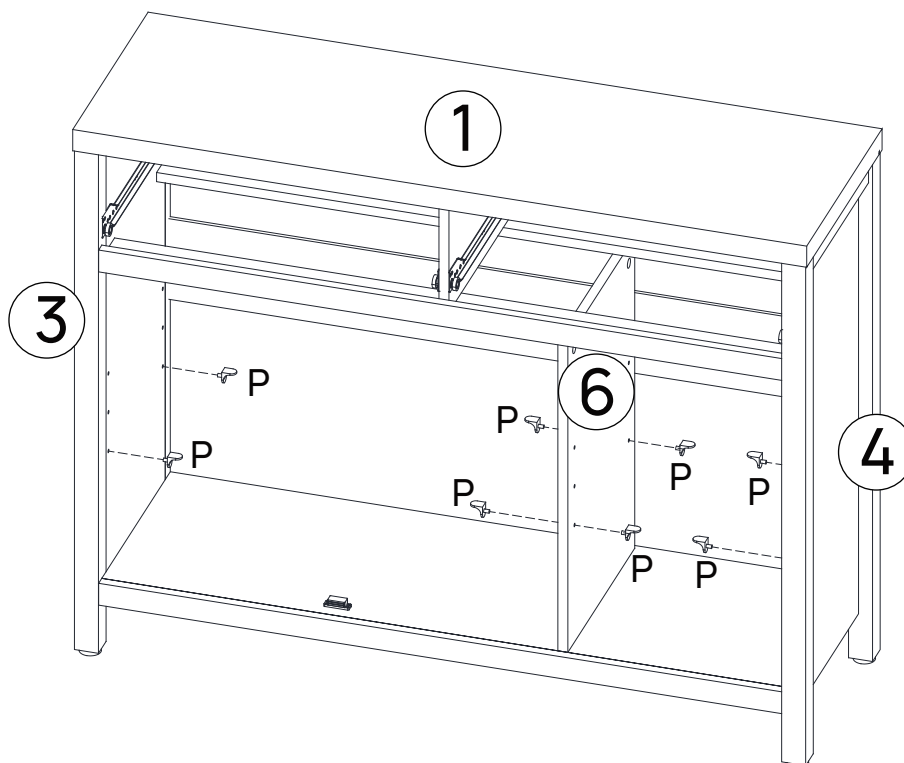

P *8

Step 27

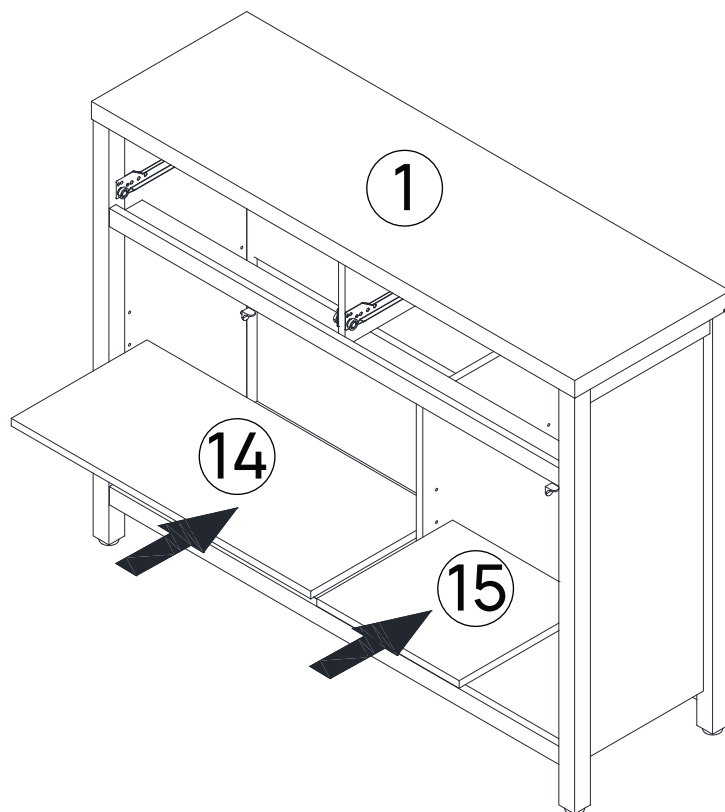

Step 28

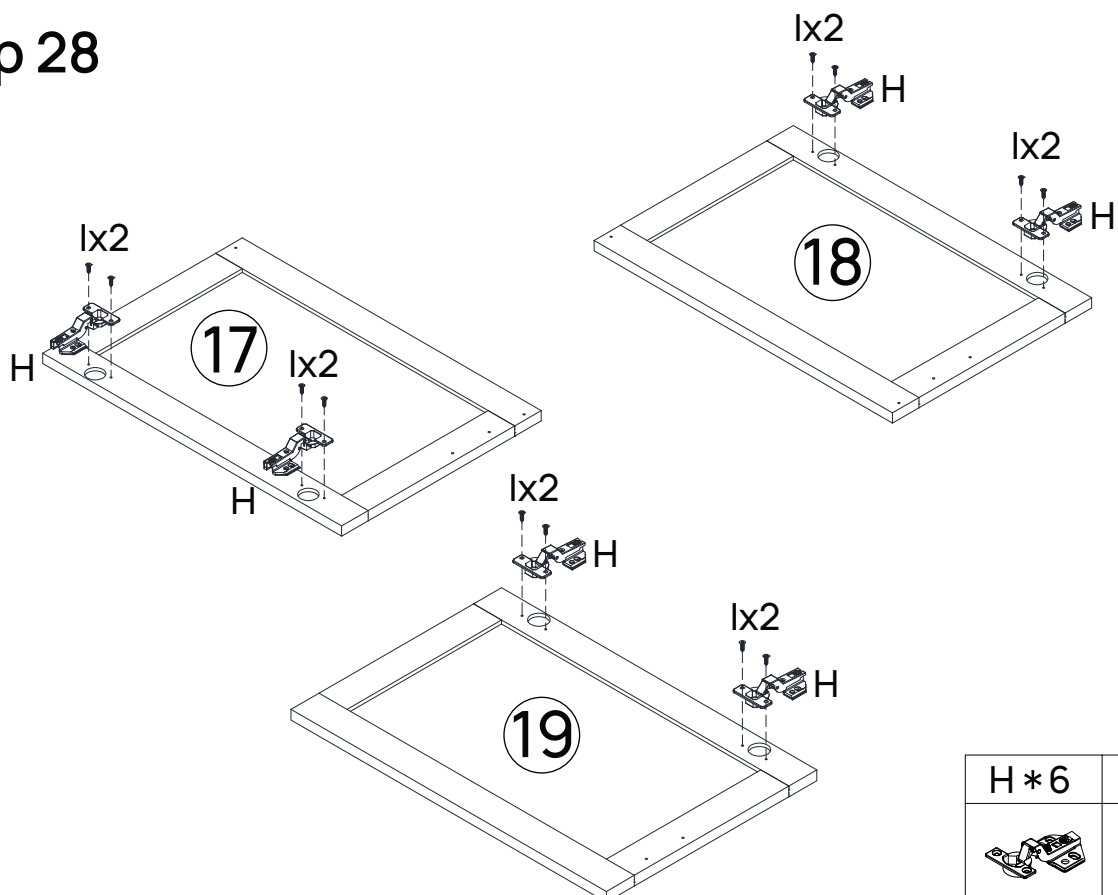

Step 29

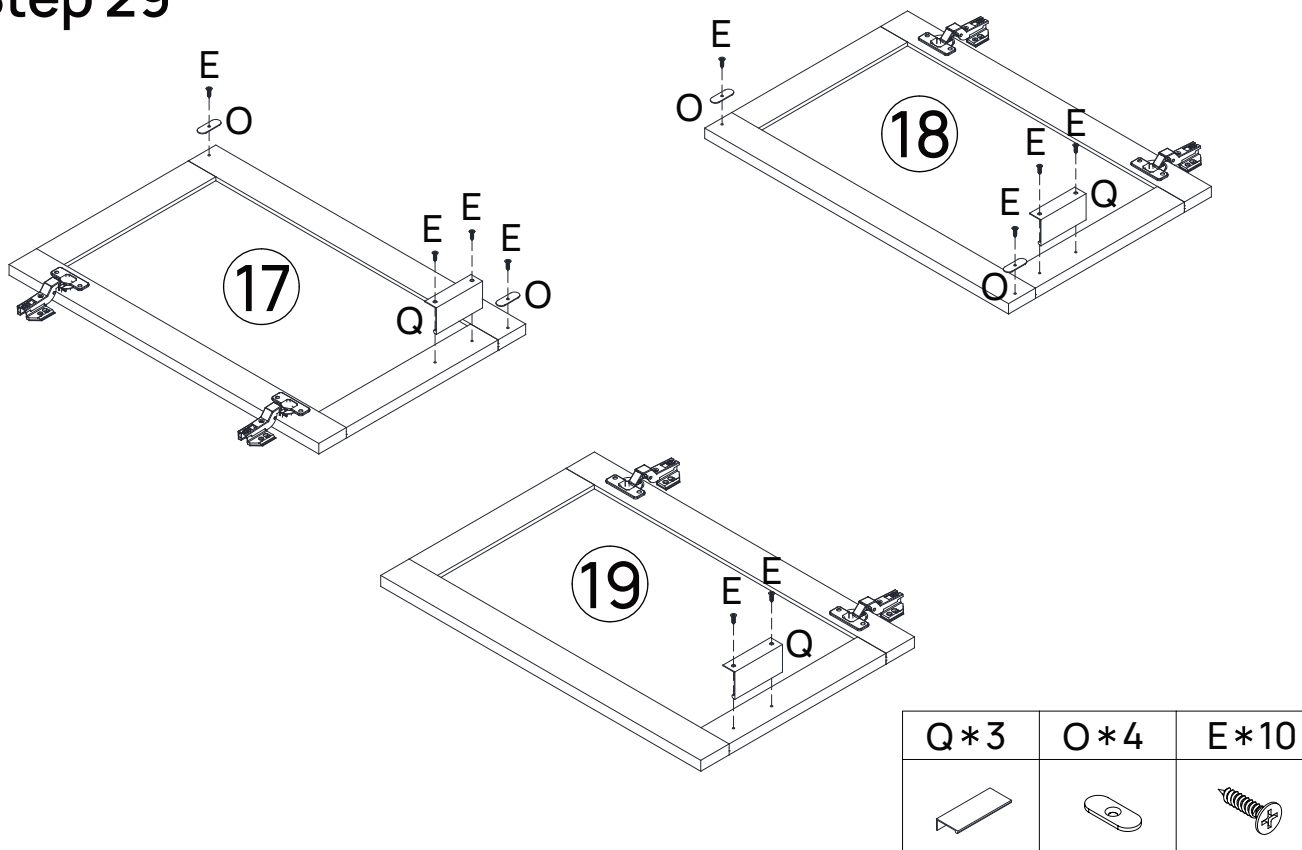

Step 30

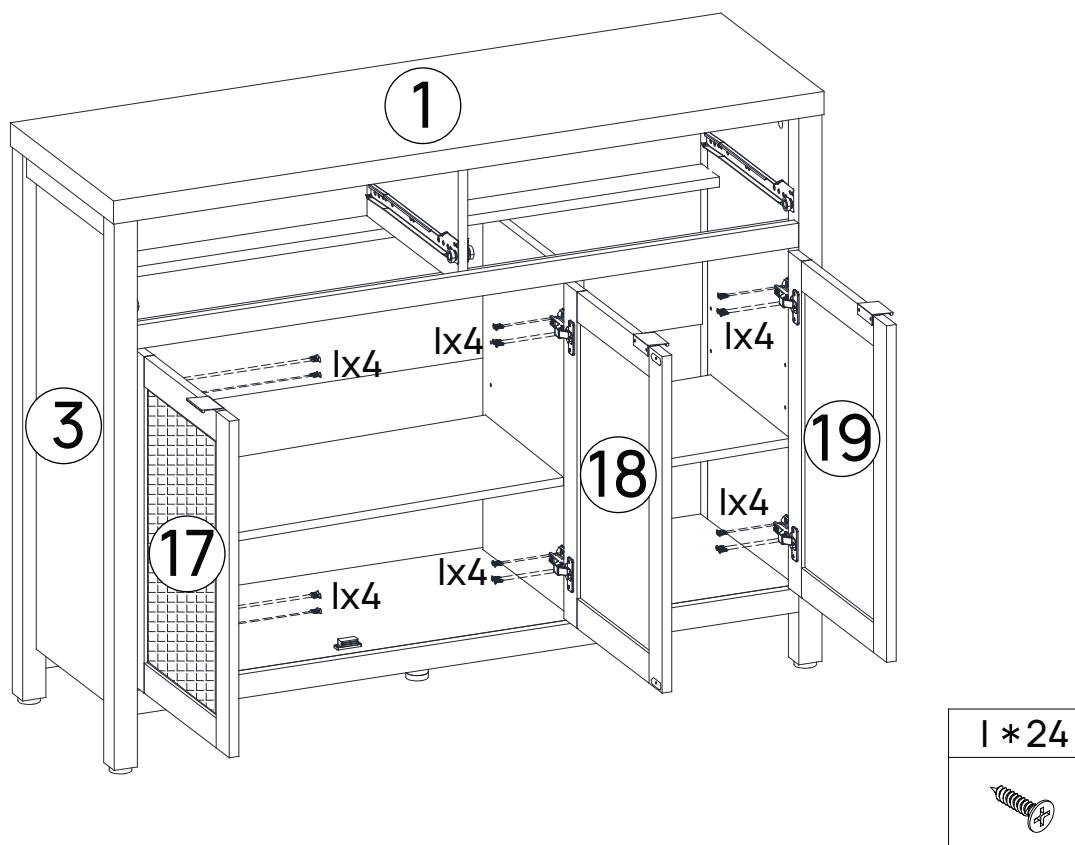

Step 31

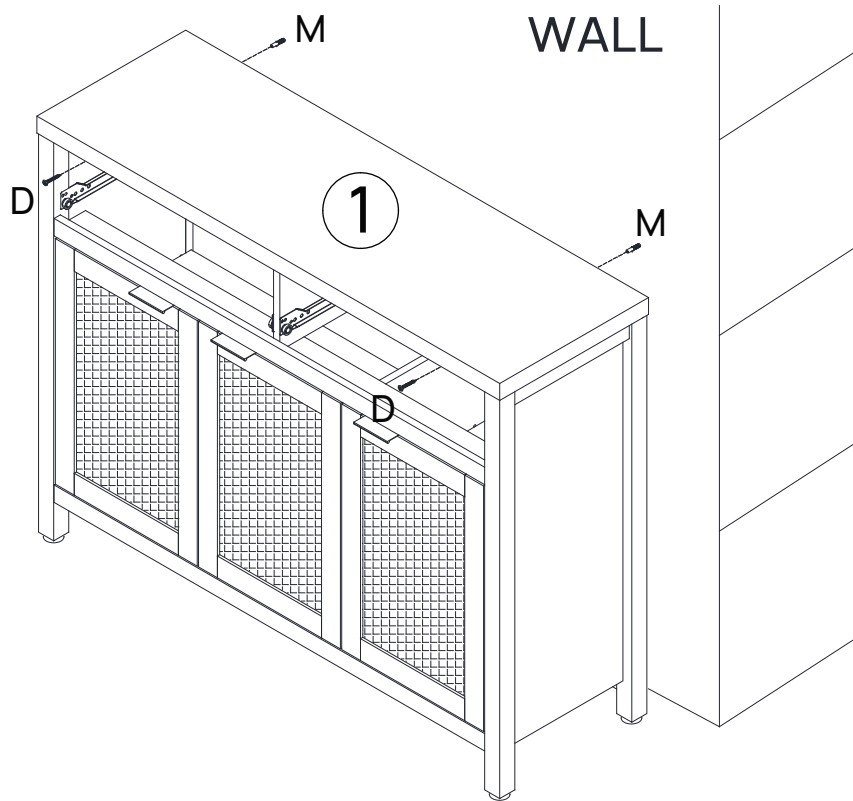

- 1:
- 2:
- 3:
- 4:

D*2	M*2

Step 32

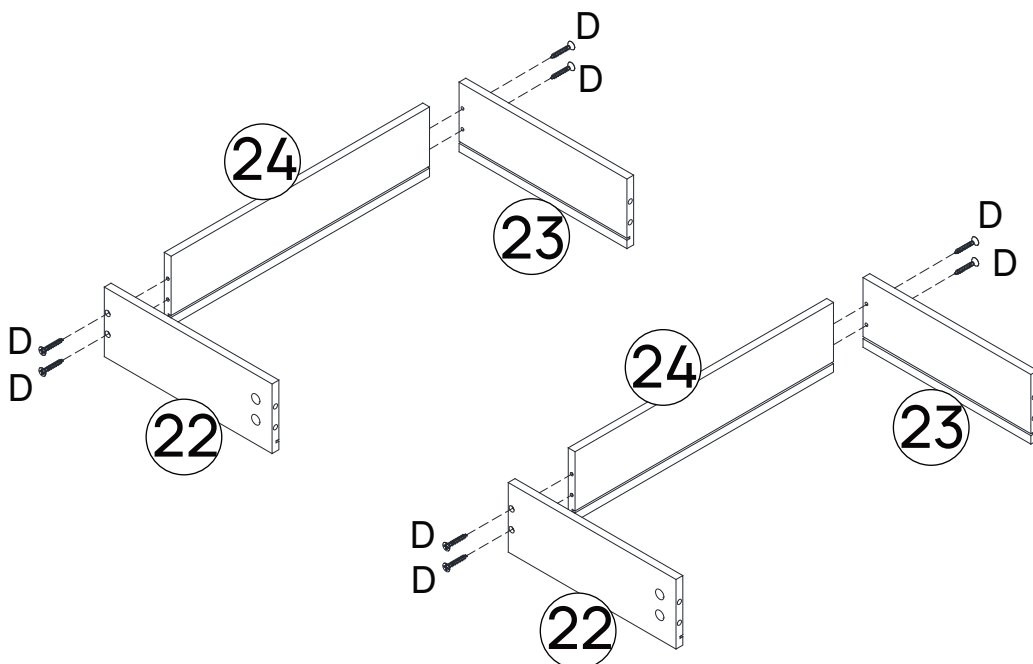

D*8

Step 33

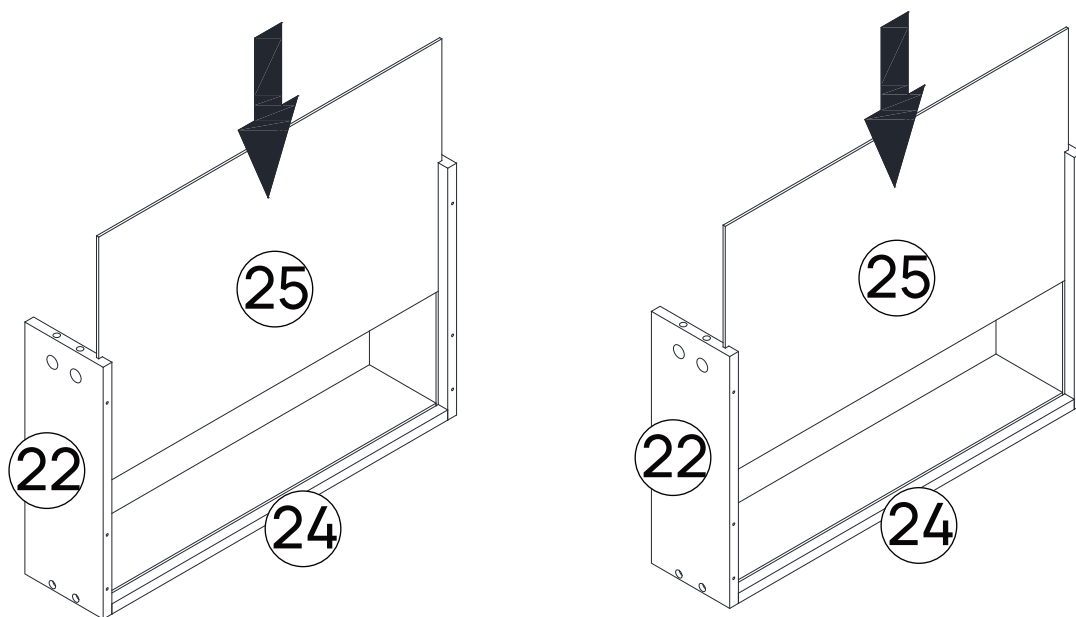

Step 34

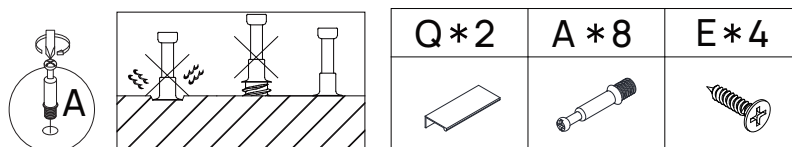
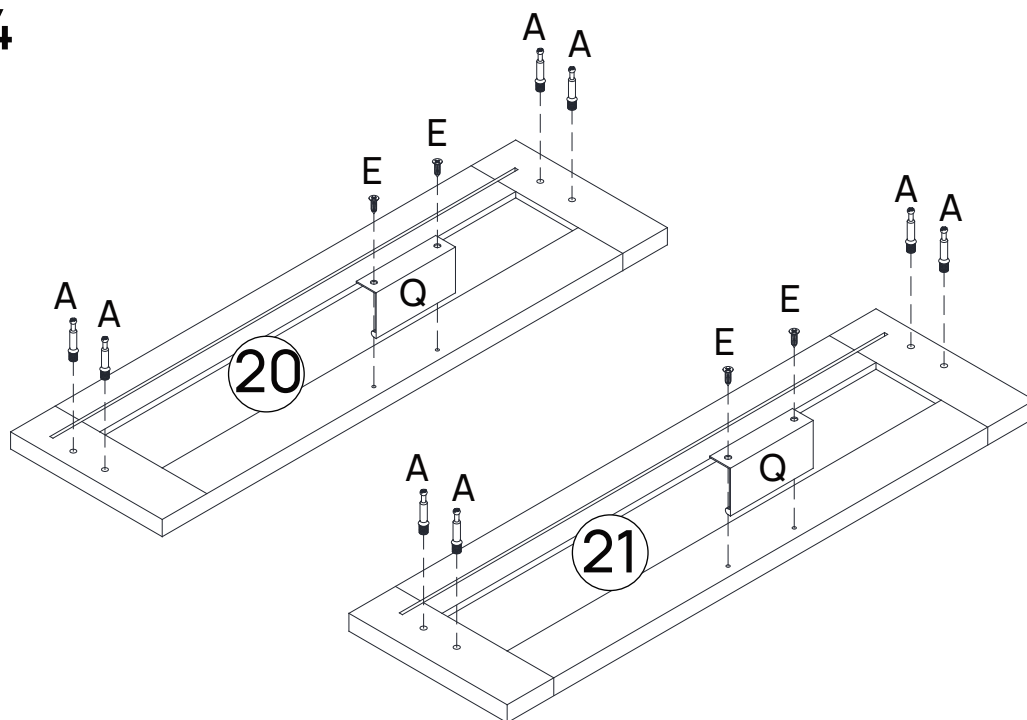

Step 35

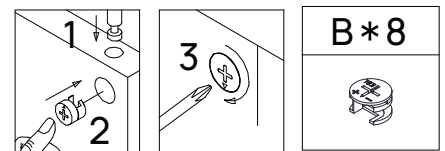
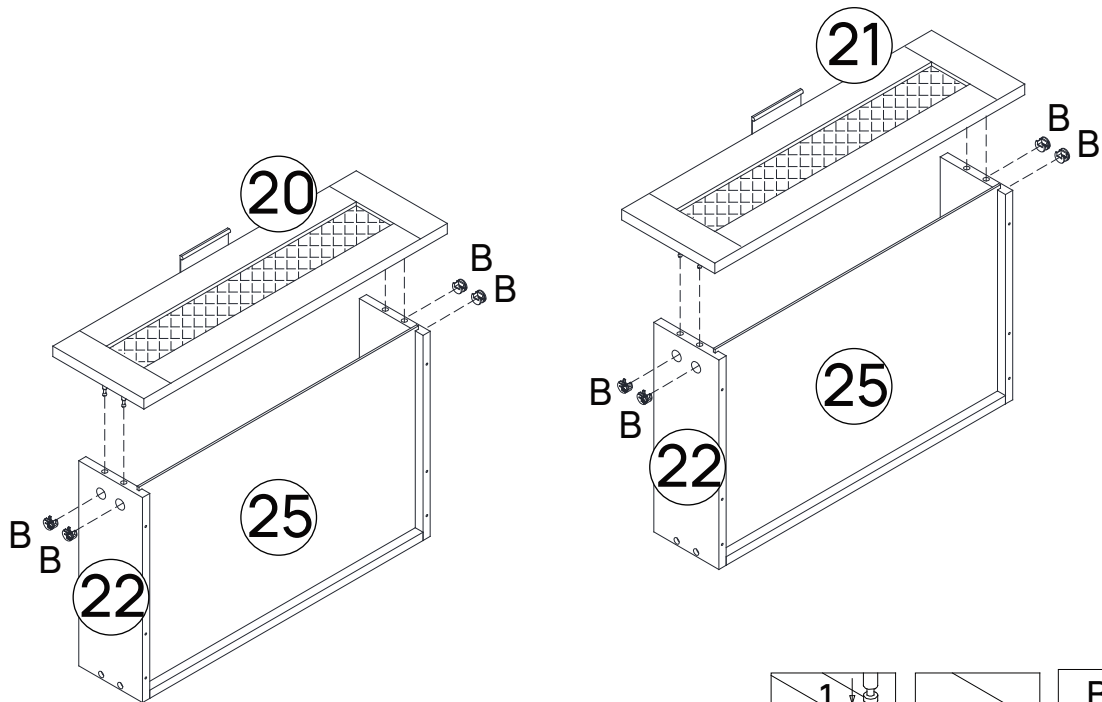

Step 36

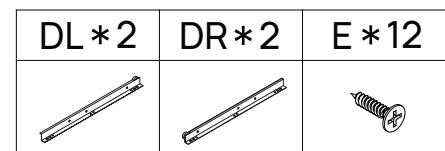
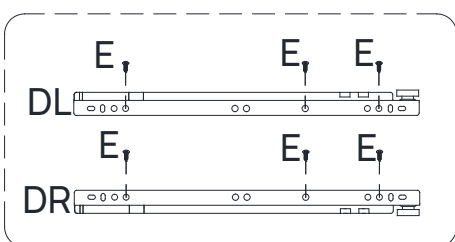
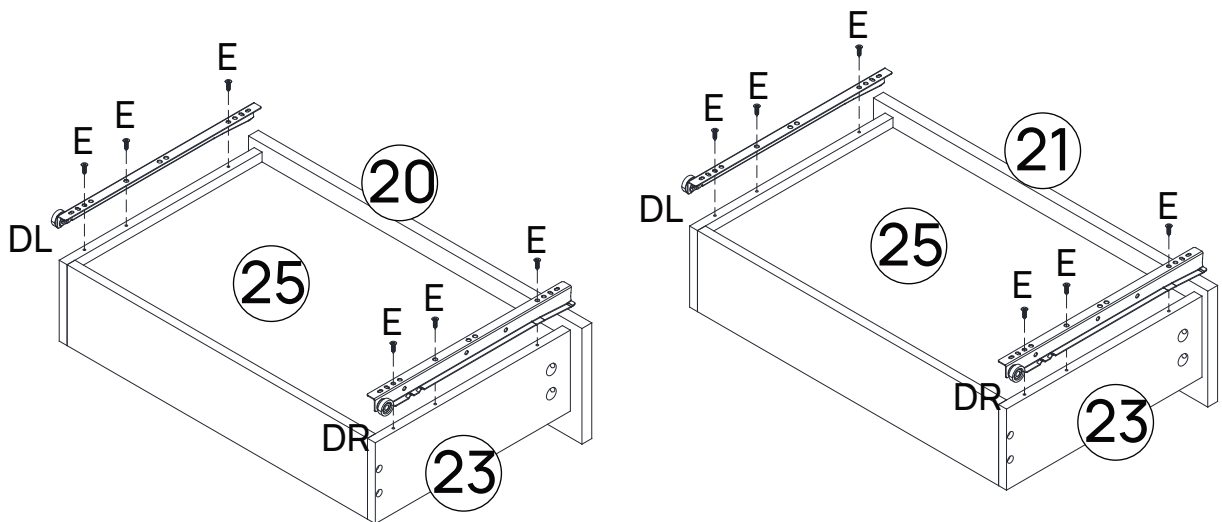

Step 37

Please note that the drawers must be installed as indicated by the arrows.

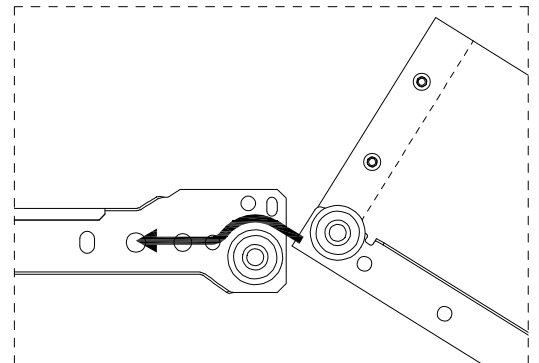
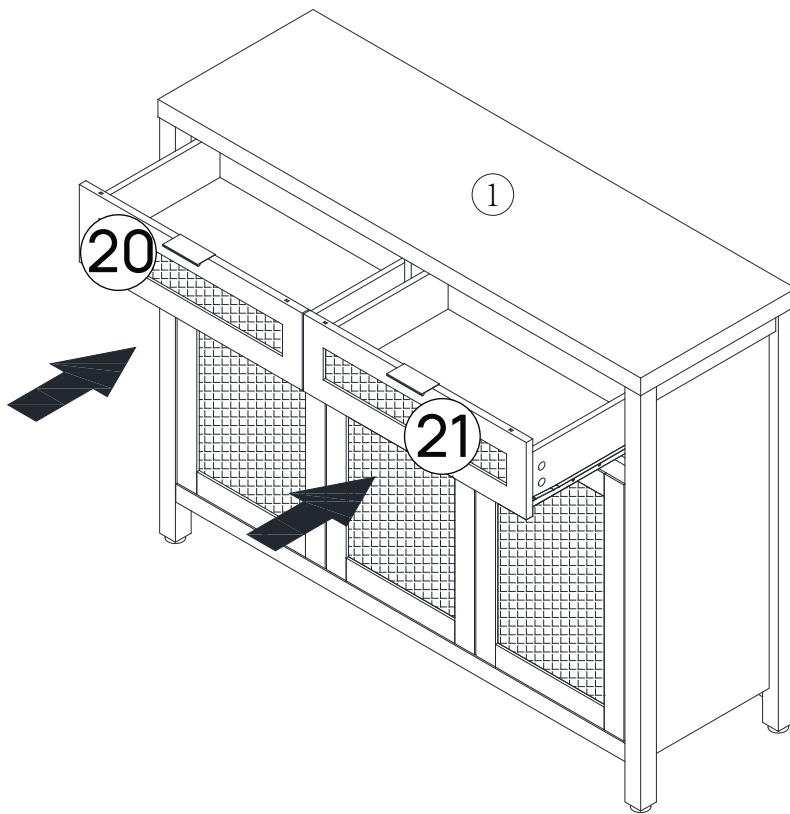

Step 38

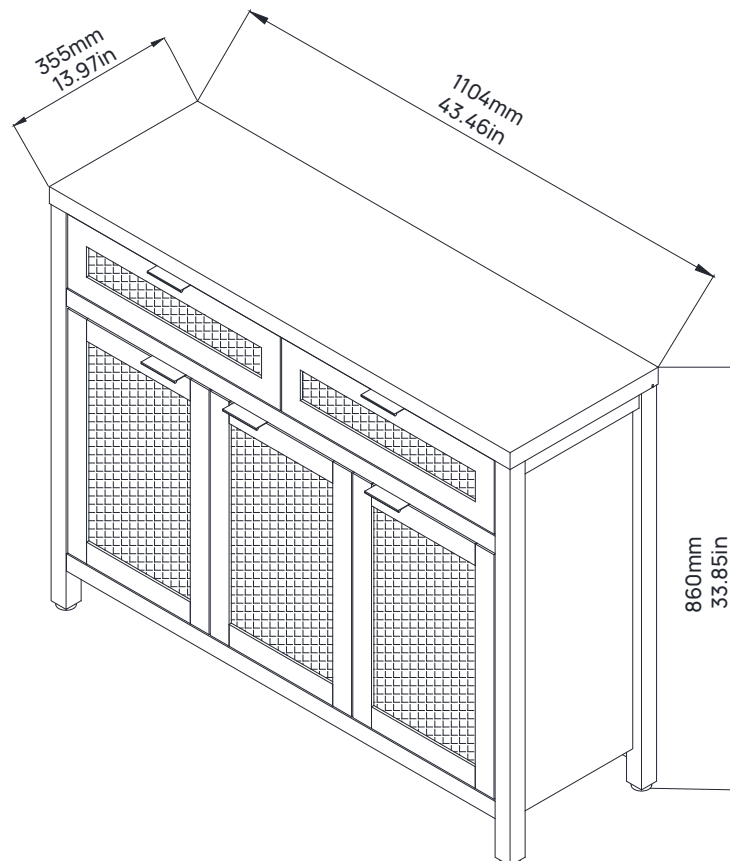

Cabinet Door Adjustment Instructions

Height adjustment:

- Locate the height adjustment screws on the hinge.
- Use the Phillips screwdriver to either tighten or loosen the screws to raise or lower the cabinet door as desired.

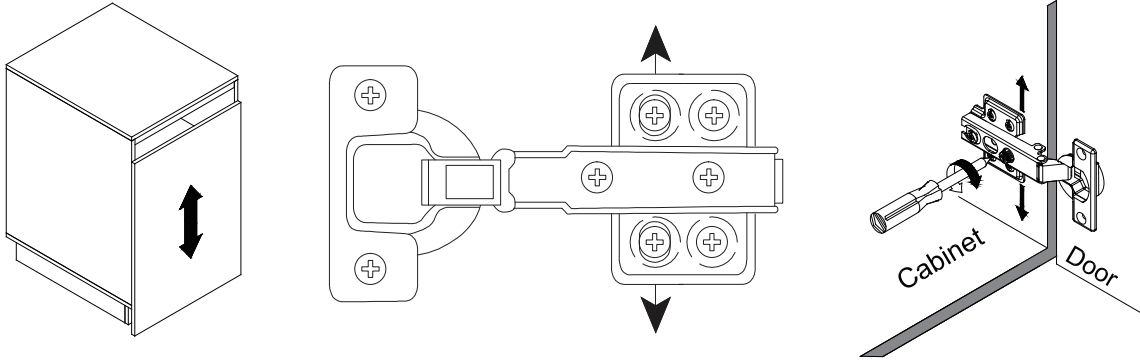

Side-to-side adjustment:

- If the cabinet door needs to be moved closer to or away from the cabinet frame, locate the side-to-side adjustment screws on the hinge.
- Use the Phillips screwdriver to adjust these screws and gradually move the door in the desired direction.

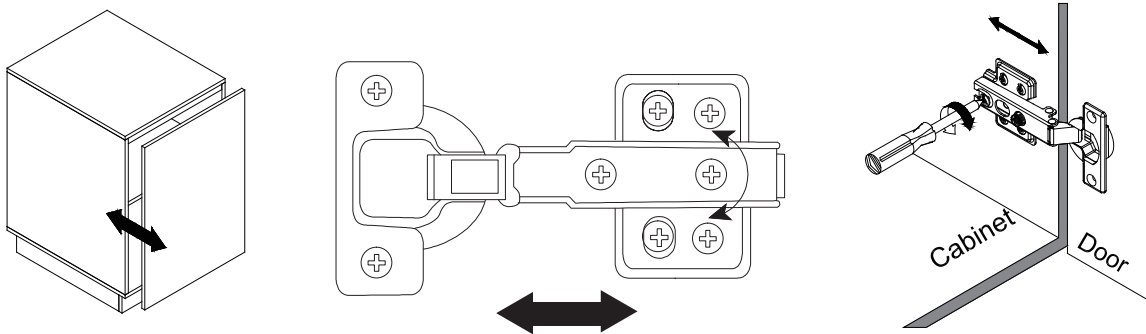

Depth adjustment (if applicable):

