

**Assembly Instructions**  
**Instructions de montage**  
**Instrucciones de armado**

**Two Drawer Tall Nightstand**  
**Table de chevet haute à deux tiroirs**  
**Mesilla de noche con 2 cajones y estante**

|            |  |
|------------|--|
| DATE STAMP |  |
|------------|--|

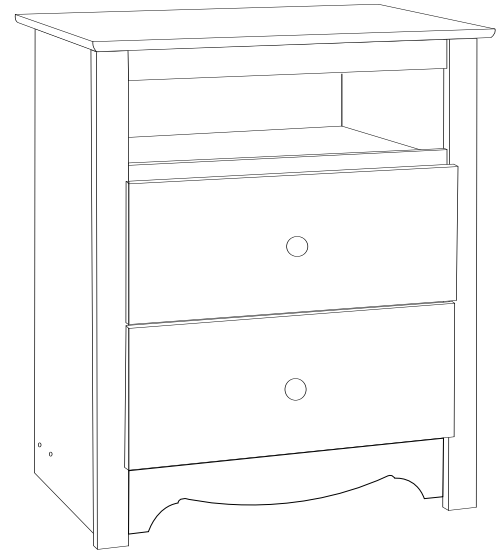
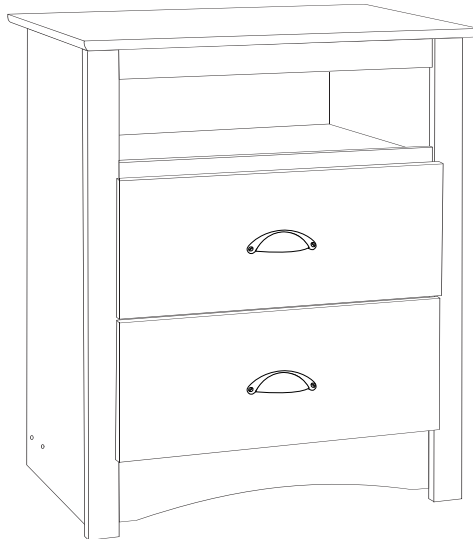
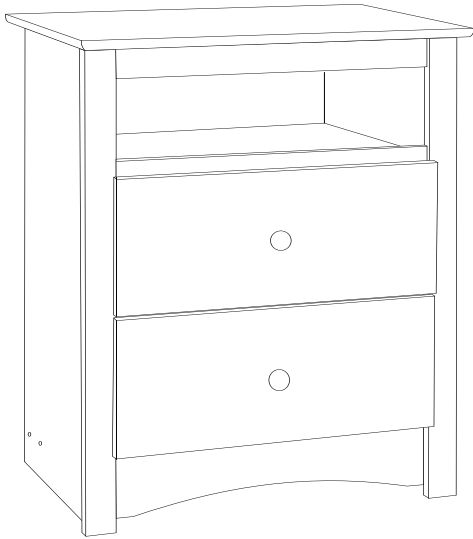

- If you have received a damaged or defective part
- If you are missing hardware or parts
- For help with assembly

Replacement parts will leave our facility within two business days via UPS ground or mail. Please note: shipping times will vary depending on location.

Before you call please:

- 1) Record the following information from the shipping label on the outside of the box. You will need it for warranty purposes:
  - Ship To Name
  - Sales Order Number
- 2) Note the product model number.
- 3) Review the contents of your shipment to determine what you are missing.

**Option de service en ligne**

Complétez le formulaire *Commande de Pièces de Rechange* disponible dans la section *Soutien à la clientèle* de notre site

- Si vous avez reçu une pièce endommagée ou défectueuse
- Si vous manquez la quincaillerie ou les pièces

Les pièces de rechange quitteront notre installation dans deux jours ouvrables via UPS par terre ou le courrier. Notez s'il vous plaît que les temps d'expédition varieront selon l'emplacement.

**Pour parler avec quelqu'un en français, s'il vous plaît contacter votre détaillant.**

**Opción de servicio en línea**

- Si usted ha recibido una parte dañada o defectuosa, o
- Si falta alguna parte o componente

**Para solicitar ayuda en español por favor contacte su distribuidor.**

Las piezas de recambio dejarán nuestras instalaciones dentro de dos días hábiles vía UPS correo terrestre. Por favor note que el tiempo de transporte variara según la ubicación.

# Nightstand Hardware / Quincaillerie de la table de nuit / Piezas de la mesilla de noche

|                                                  |                                                                  |                                                |                        |
|--------------------------------------------------|------------------------------------------------------------------|------------------------------------------------|------------------------|
| black = noir / negro<br>cherry = cerise / cereza | drifted gray = gris vieilli / gris madera<br>espresso = espresso | washed black = noir vieilli / negro envejecido | white = blanc / blanco |
|--------------------------------------------------|------------------------------------------------------------------|------------------------------------------------|------------------------|

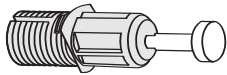

Blue Rapid Rod (16)  
*Tige rapide bleu*  
Clavija azul de ajuste rápido  
**RM-0583**



Large Zinc Cam (16)  
*Ferrure en zinc grand*  
Tuercas de fijación grande de zinc  
**RM-0103**



Wood Dowel (4)  
*Goujons de bois*  
Clavija de madera  
**RM-0069**

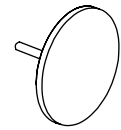

Cam Cover Cap (2)  
*Capuchons de cames*  
Cubierta de tuercas

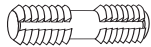

Plastic Dowel (4)  
*Goujon en plastique*  
Clavija de plástico  
**RM-0072**

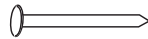

3/4" Nail (22)  
*Clou 3/4"*  
Clavo de 3/4 pulg.  
**RM-0022\***



Drawer Slide Screw (16)  
*Vis pour coulisse de tiroir*  
Tornillos para rieles de cajón  
**RM-0074**

**RM-0802-D**  
drifted gray  
**RM-0802-B**  
black  
washed black  
**RM-0802-E**  
cherry  
espresso  
**RM-0802-W**  
white

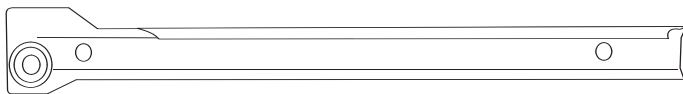

1 LEFT Cabinet Slide per Drawer (Total = 2)  
*Glissière GAUCHE De Cabinet (total = 2)*  
1 riel de gabinete izquierdo por cajón (total = 2)  
**RM-0469-G**

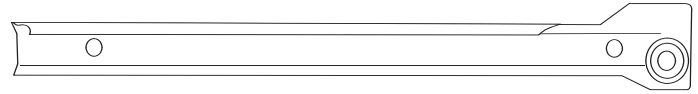

1 RIGHT Cabinet Slide per Drawer (Total = 2)  
*Glissière DROITE De Cabinet (total = 2)*  
1 riel de gabinete derecho por cajón (total = 2)  
**RM-0469-G**

## Drawer Hardware / Quincaillerie de tiroir / Piezas de los cajones

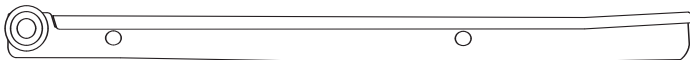

1 LEFT Drawer Slide per Drawer (Total = 2)  
*1 Glissière GAUCHE de tiroir par tiroir (total = 2)*  
1 riel de cajón IZQUIERDO por cajón (total = 2)  
**RM-0469-G**

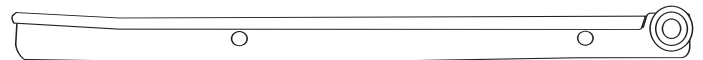

1 RIGHT Drawer Slide per Drawer (Total = 2)  
*1 Glissière DROITE de tiroir par tiroir (total = 2)*  
1 riel de cajón DERECHO por cajón (total = 2)  
**RM-0469-G**

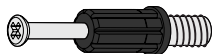

34mm Black  
Twister Dowel (8)  
*Goujon de torsion noir*  
Clavija negro giratoria  
**RM-0500**



Small Zinc Cam (8)  
*Petite ferrure en zinc*  
Tuercas de fijación pequeña de zinc  
**RM-0715**



#8 - 1 1/2" Screws (8)  
*Vis no.8 - 1 1/2 po.*  
Tornillo de 1 1/2"  
**RM-0504**

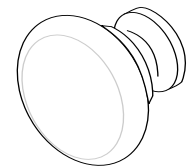

Knob (2)  
*Poignée*  
Perilla  
**RM-0464-E**  
for espresso & washed black

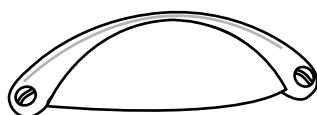

Hooded Cup Handle with Screws (2)  
*Poignée à capuchon avec vis*  
Manija de taza encapuchada con tornillos  
**RM-0847**  
for drifted gray



#8-32mm Machine Screw (2)  
*Vis de machne de 32mm*  
Tornillo para máquina de 32mm pulg.  
**RM-0465**

**RM-0464**  
for black  
**RM-0625**  
for cherry & white

# Nightstand Parts / Pièces de la table de nuit / Partes de la mesilla de noche

|                                                  |                                                                  |                                                                                                |                        |
|--------------------------------------------------|------------------------------------------------------------------|------------------------------------------------------------------------------------------------|------------------------|
| black = noir / negro<br>cherry = cerise / cereza | drifted gray = gris vieilli / gris madera<br>espresso = espresso | washed black = noir vieilli / negro envejecido<br>warm cherry = cerisier foncé / cereza oscuro | white = blanc / blanco |
|--------------------------------------------------|------------------------------------------------------------------|------------------------------------------------------------------------------------------------|------------------------|

- C1** Top (1)  
*Dessus*  
*Superior*  
TP-10083-B black  
TP-10088-CN cherry  
TP-10083-D drifted gray  
TP-10083-E espresso  
TP-10083-H washed black  
TP-10088-W white

- C2** Top Moulding (1)  
*Moulure supérieure*  
*Moldura superior*  
TR-10079-B black  
TR-10079-CN cherry  
TR-10079-D drifted gray  
TR-10079-E espresso  
TR-10079-H washed black  
TR-10079-W white

- C3** Left Side (1)  
*Côté gauche*  
*Lado izquierdo*  
SL-10090-B black  
SL-10090-CN cherry  
SL-10090-D drifted gray  
SL-10090-E espresso  
SL-10090-H washed black  
SL-10090-W white

- C4** Right Side (1)  
*Côté droit*  
*Lado derecho*  
SR-10090-B black  
SR-10090-CN cherry  
SR-10090-D drifted gray  
SR-10090-E espresso  
SR-10090-H washed black  
SR-10090-W white

- C5** Fixed Shelf  
*Tablette fixe*  
*Estante fijo*  
SH-10083-B black  
SH-10083-CN cherry  
SH-10083-D drifted gray  
SH-10083-E espresso  
SH-10083-H washed black  
SH-10083-W white

- C6** Fixed Shelf Molding  
*Moulure de tablette fixe*  
*Moldura estante fijo*  
TR-10080-B black  
TR-10080-CN cherry  
TR-10080-D drifted gray  
TR-10080-E espresso  
TR-10080-H washed black  
TR-10080-W white

- C7** Decorative Stabilizer A (1)  
*Stabilisateur décoratifs A*  
*Estabilizador decorativo A*  
KR-10057-B black  
KR-10057-CN cherry  
KR-10057-D drifted gray  
KR-10057-E espresso  
KR-10057-H washed black  
KR-10057-W white

- C8** Decorative Stabilizer B (1)  
*Stabilisateur décoratifs B*  
*Estabilizador decorativo B*  
KR-10056-B black  
KR-10063-CN cherry  
KR-10056-D drifted gray  
KR-10056-E espresso  
KR-10056-H washed black  
KR-10063-W white

- C9** Side Moulding (2)  
*Moulure latérale*  
*Moldura lateral*  
TR-10083-B black  
TR-10083-CN cherry  
TR-10083-D drifted gray  
TR-10083-E espresso  
TR-10083-H washed black  
TR-10083-W white

- C10** Backer (1)  
*Dos*  
*Respaldo*  
BB-10067-B black  
BB-10067-CN cherry  
BB-10067-D drifted gray  
BB-10067-E espresso  
BB-10067-H washed black  
BB-10067-W white

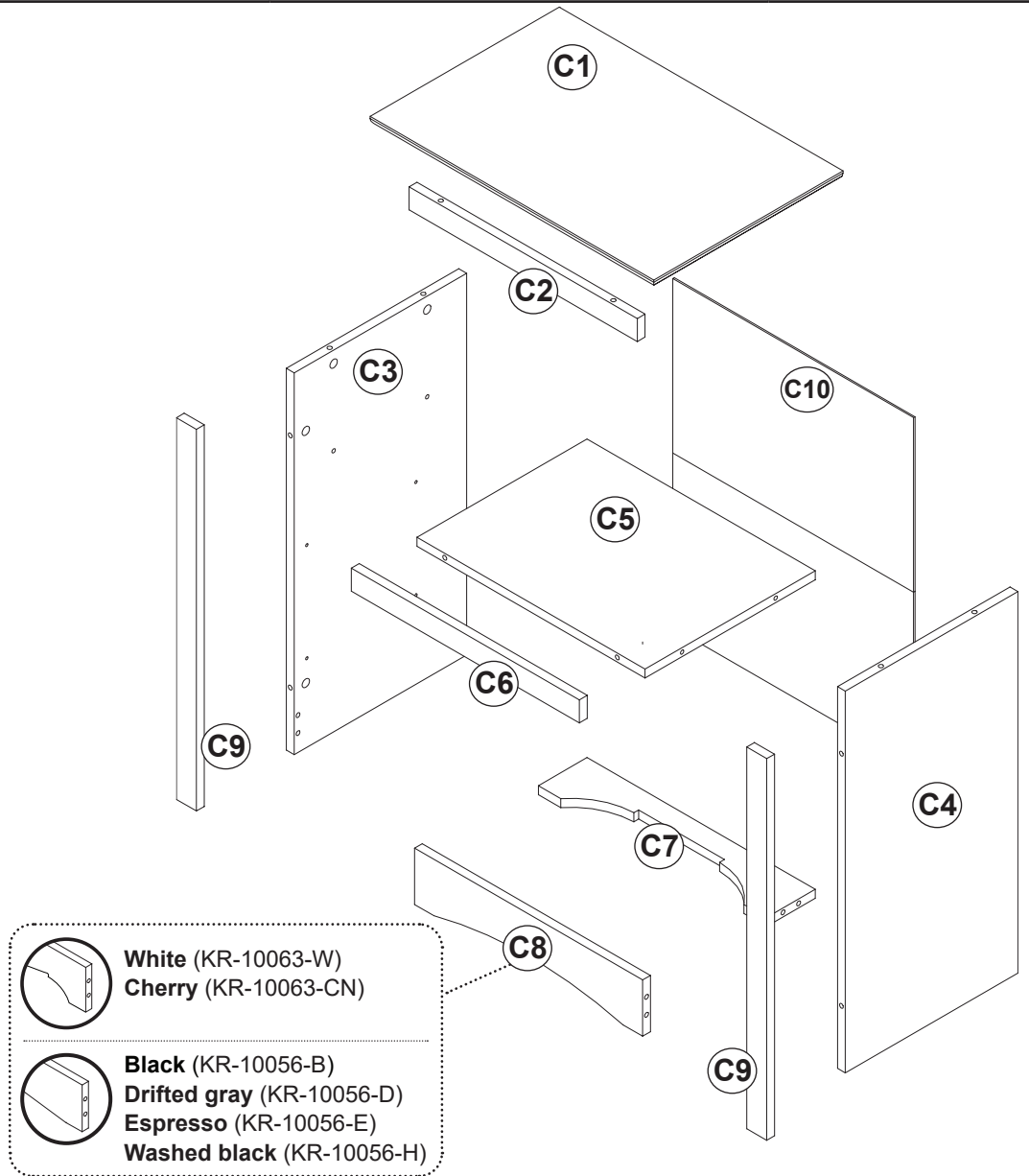

**Required Tools /  
Outils requis /  
Herramientas necesarias**

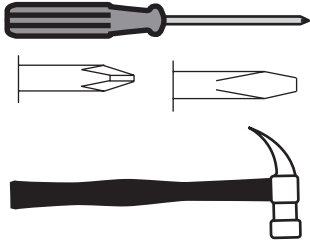

**Optional Tools:**  
Using a power screwdriver  
will speed up assembly.

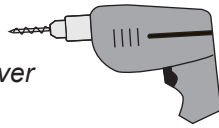

**Outils facultatifs**  
Utilisant la puissance un tournevis  
accélérera l'assemblée.

**Herramientas opcionales:**  
El montaje será más rápido con un  
destornillador eléctrico.

**Caution**

Do not over tighten any screw. The last few turns of each screw should be done very slowly or by hand.

**Attention**

Évitez de trop serrer les vis. Ralentissez la vitesse de la foreuse pour les derniers deux tours de vis ou vissez-les lentement à la main.

**Precaución**

No apriete los tornillos demasiado. Las últimas vueltas de cada tornillo deben hacerse muy lentamente o con la mano.

**BEFORE YOU BEGIN**  
Identify ALL parts and hardware to  
ensure everything is included.

**AVANT DE COMMENCER**  
Identifier toutes les pièces et le matériel  
afin de s'assurer que tout est inclus.

**ANTES DE COMENZAR**  
Identifique todos las partes y componentes  
para estar seguro que todo está incluido

**1**

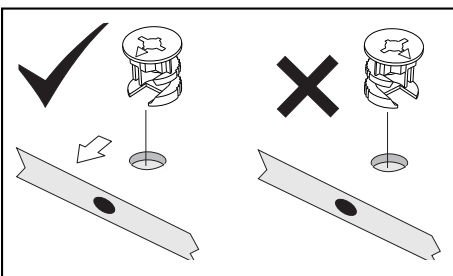
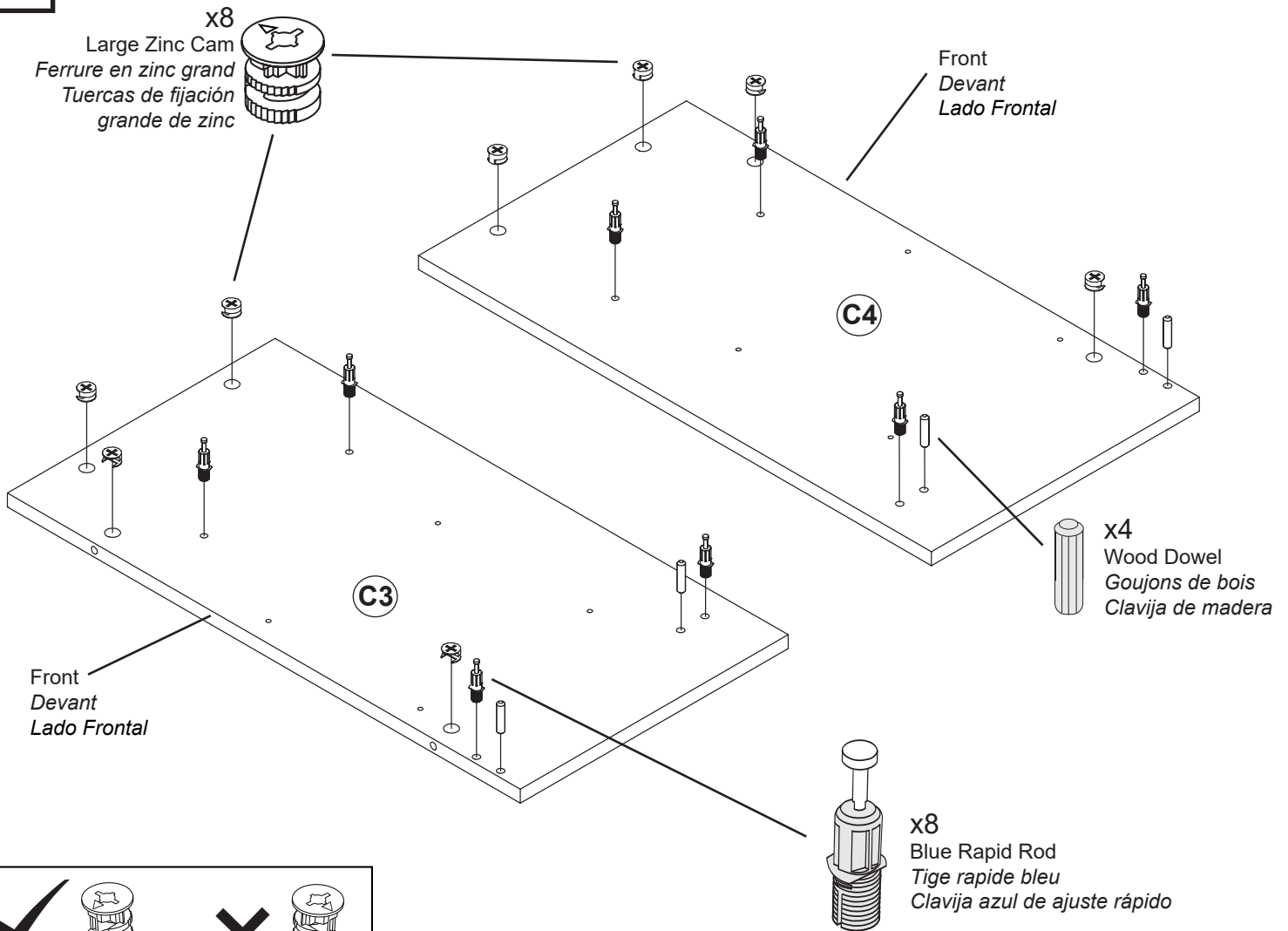

**2**

Top End  
Extrémité supérieure  
Lado superior

Front  
Devant  
Lado Frontal

x8  
Drawer Slide Screw  
Vis pour coulisse de tiroir  
Tornillos para rieles de cajón

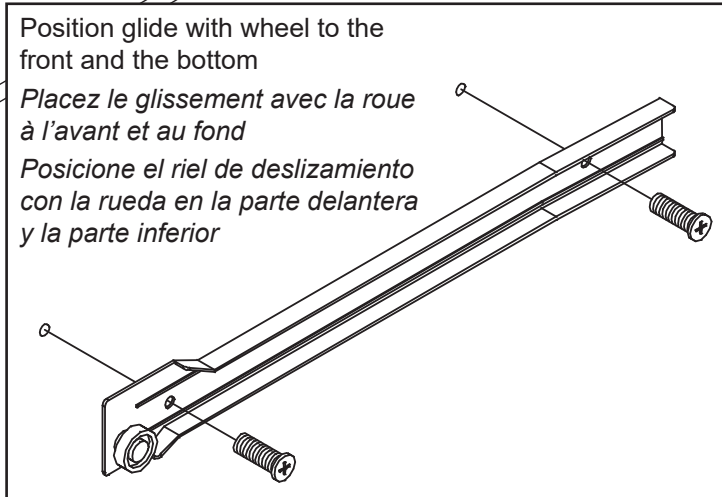
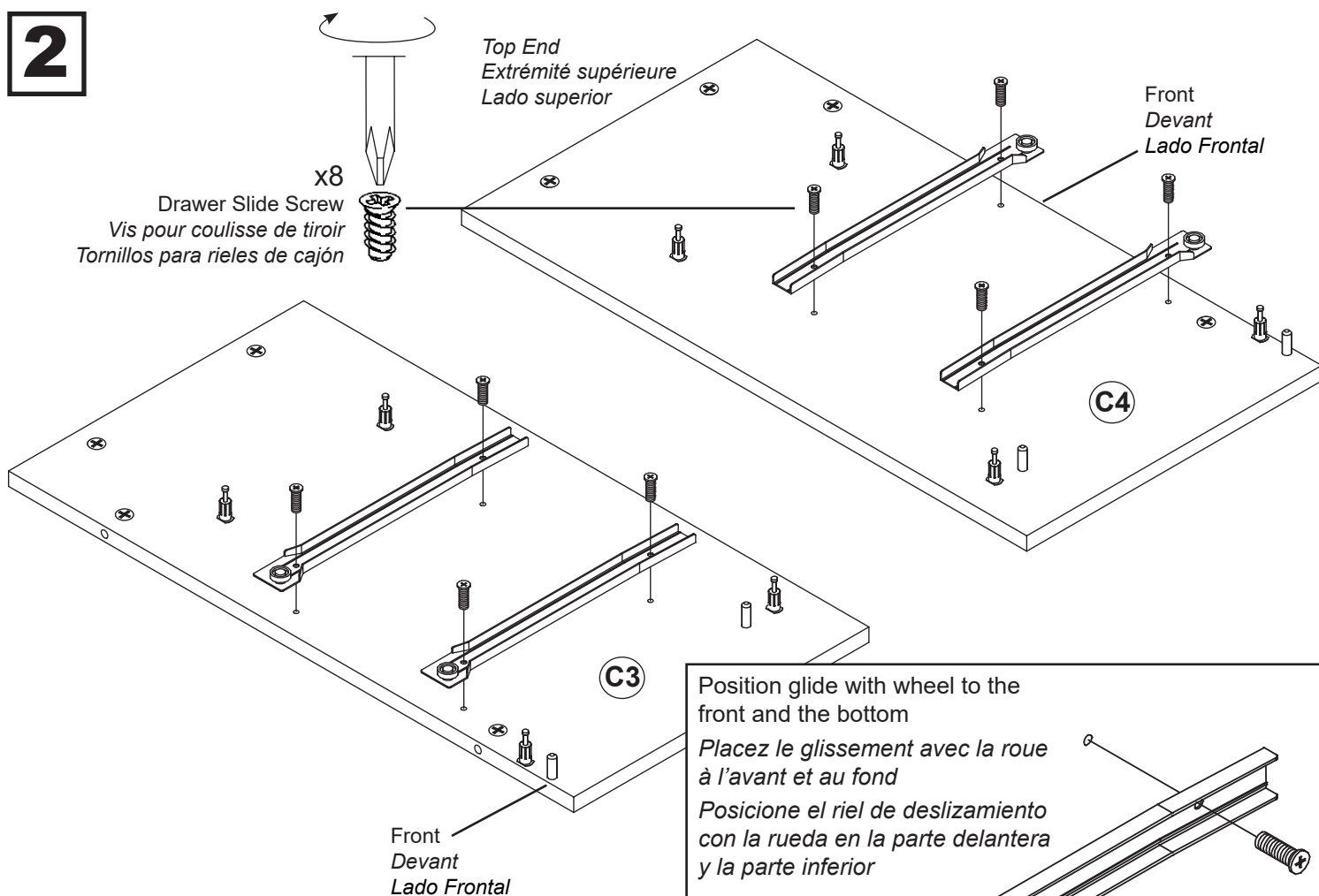

**3**

Front  
Devant  
Lado Frontal

For simplicity, these instructions will only show ONE style of Stabilizer B (C8)  
 Pour la simplicité, ces instructions montreront seulement UN style de Stabilisateur B (C8)  
 Por simplicidad, estas instrucciones solo muestran un estilo de estabilizador B (C8)

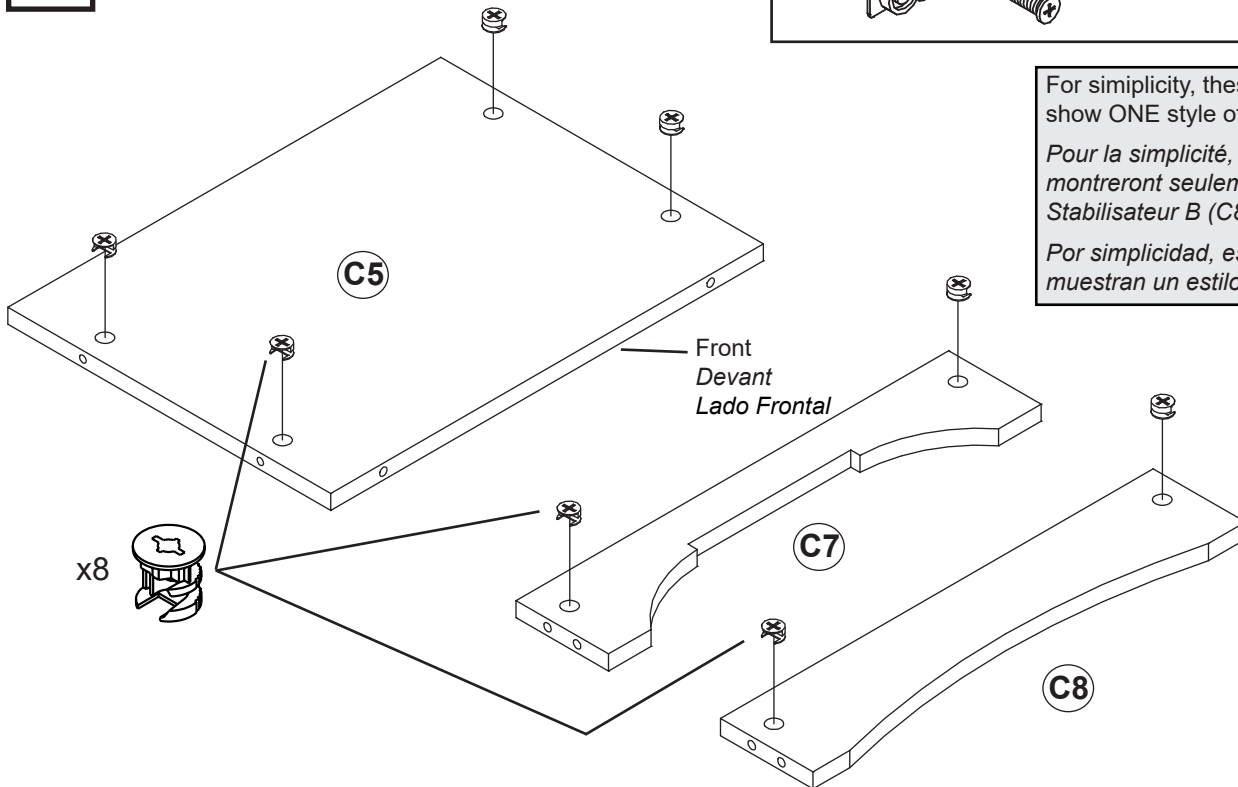

**4**

Decorative stabilizers A (C7) and B (C8) are interchangeable. Choose the style that you prefer and attach it to the front. Attach the remaining stabilizer at the rear.

*Stabilisateurs décoratifs A (C7) et B (C8) sont interchangeables. Choisissez le style que vous préférez et l'attachez à l'avant. Fixez le stabilisateur restant à l'arrière.*

*Los estabilizadores decorativos A (C7) y B (C8) son intercambiables. Elija el estilo que prefiera y fíjelo en la parte frontal. Fije el otro estabilizador en la parte posterior.*

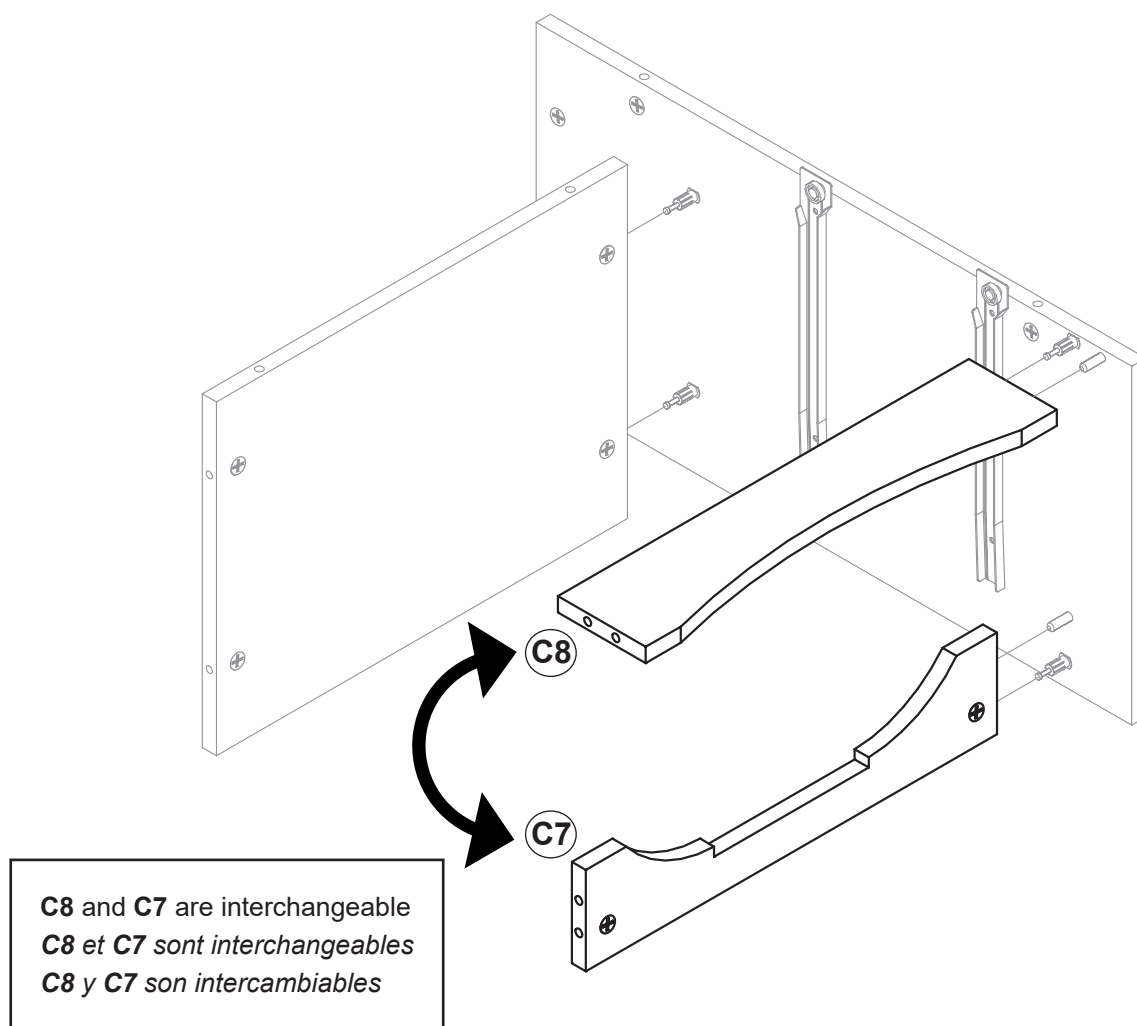

**5**

These instructions show Decorative Stabilizer B (C8) visible at the front  
*Ces instructions montrent le Stabilisateur Décoratif B (C8) visible à l'avant*  
*Estas instrucciones muestran el estabilizador decorativo B (C8) visible en la parte frontal*

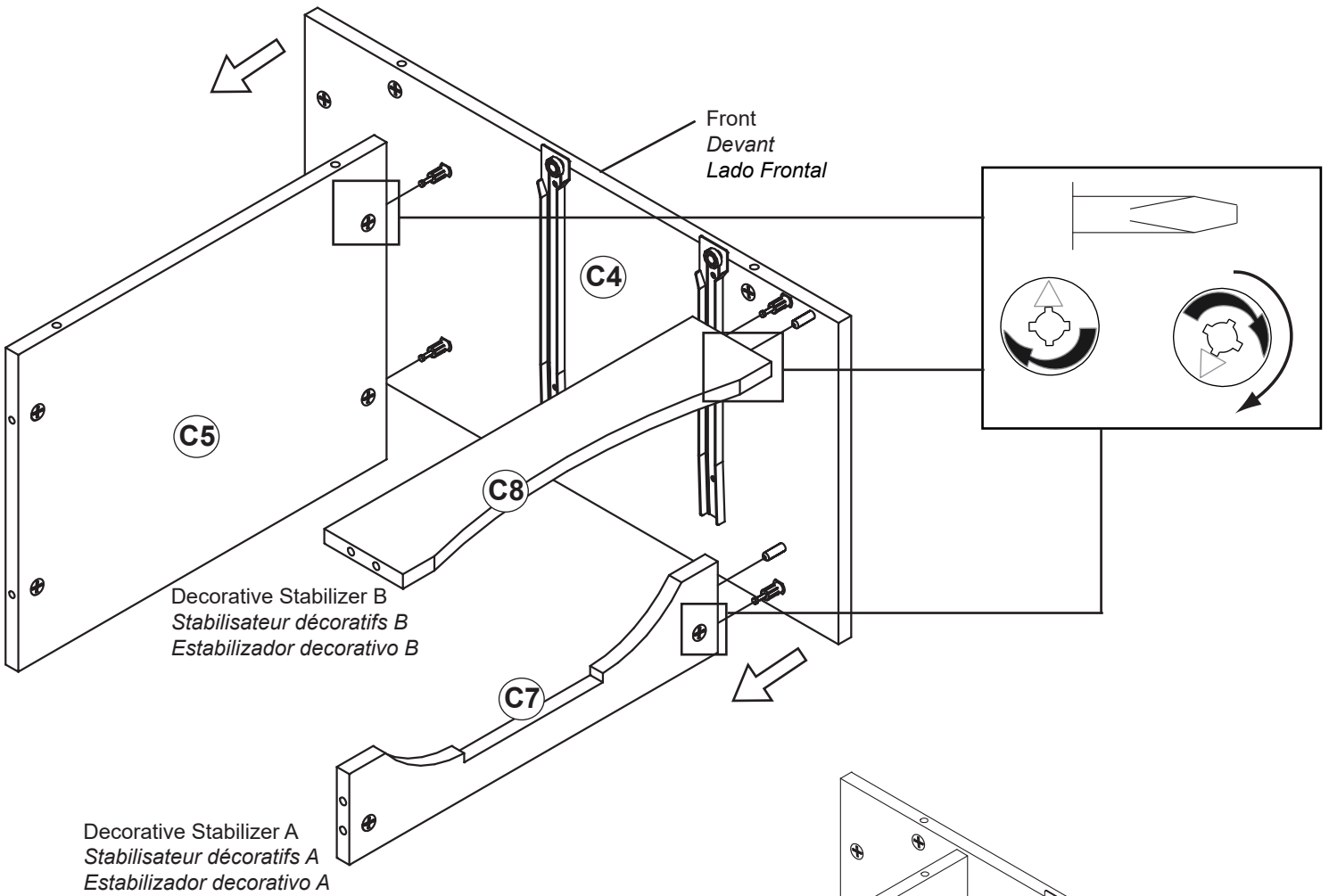

**6**

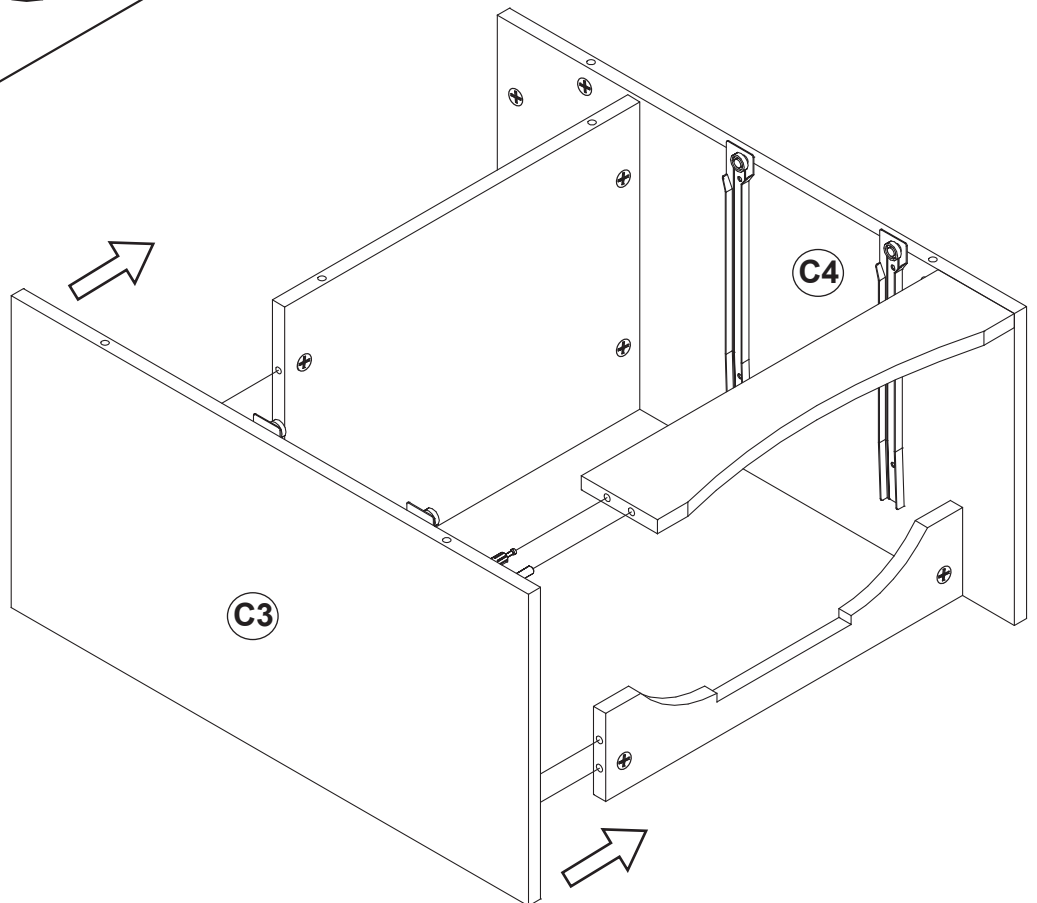
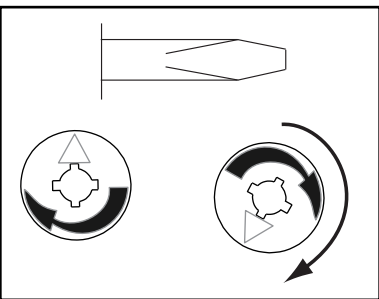

**7**

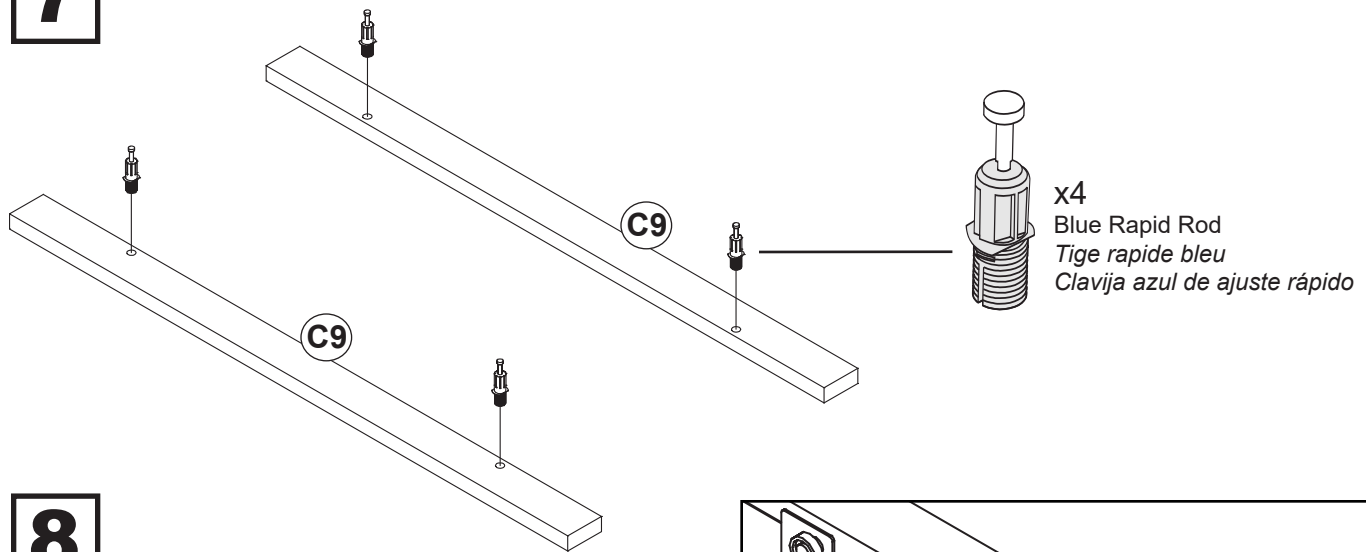

**8**

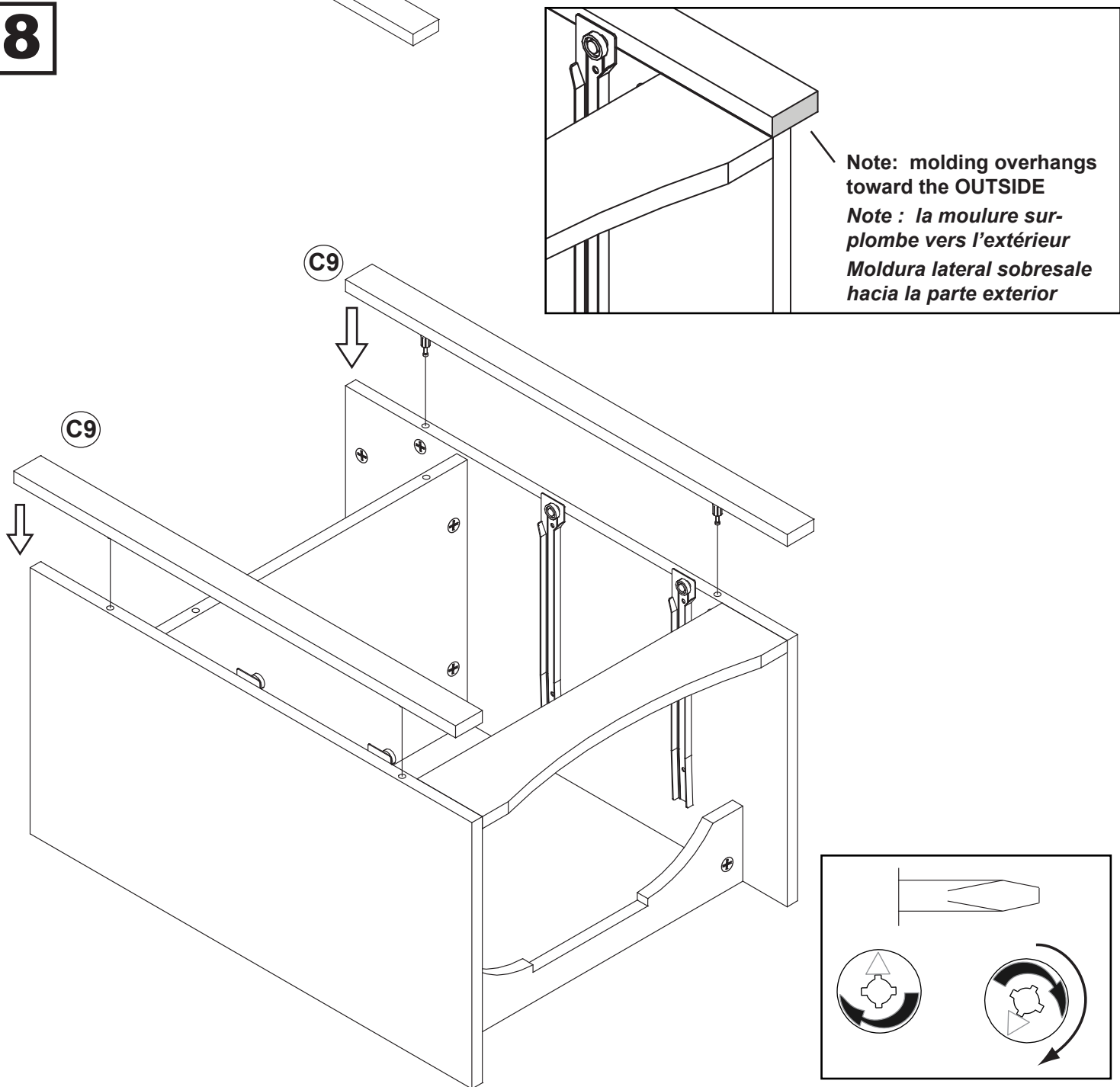

**9**

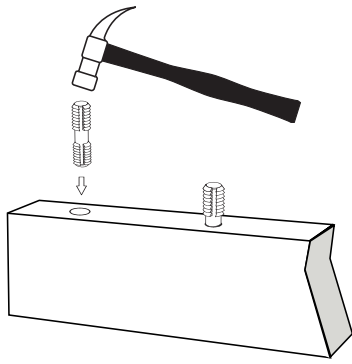

X2  
 Plastic Dowel  
 Goujon en plastique  
 Clavija de plastico



C2



x4  
 Blue Rapid Rod  
 Tige rapide bleu  
 Clavija azul de ajuste rápido

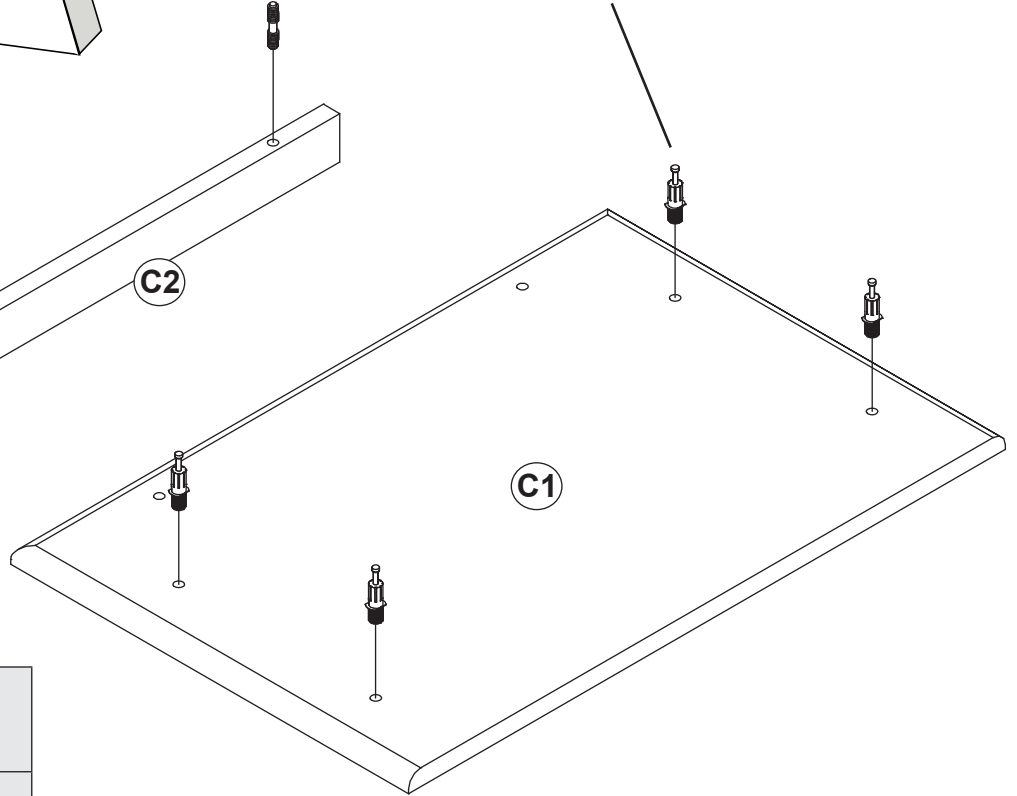

**To attach moldings:**

Use your hands and press firmly  
**DO NOT USE HAMMER**

**Pour fixer les moulures :**

Utilisez vos mains et appuyez fermement  
**NE PAS UTILISER DE MARTEAU**

**Para colocar las molduras:**

Use sus manos y presione firmemente  
**NO USE EL MARTILLO**

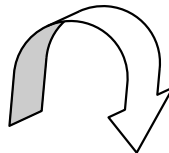

**10**

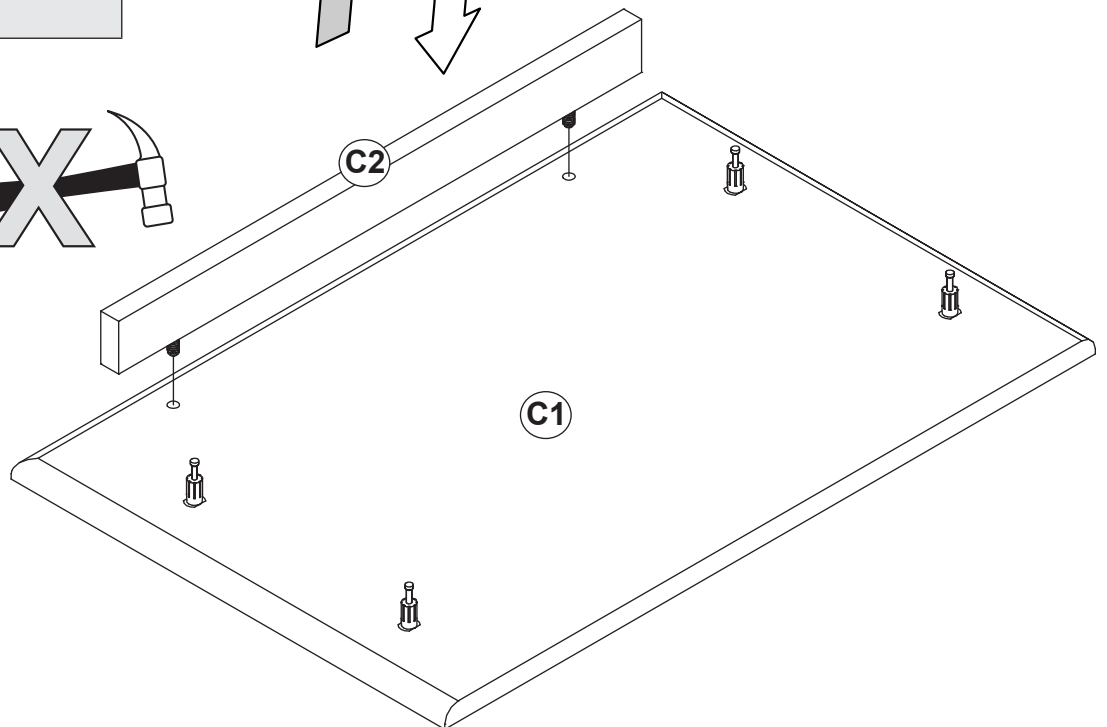

**11**

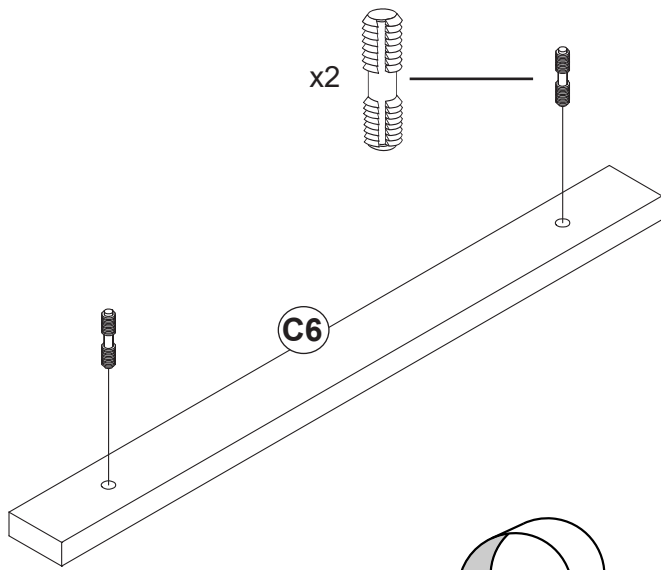

**12**

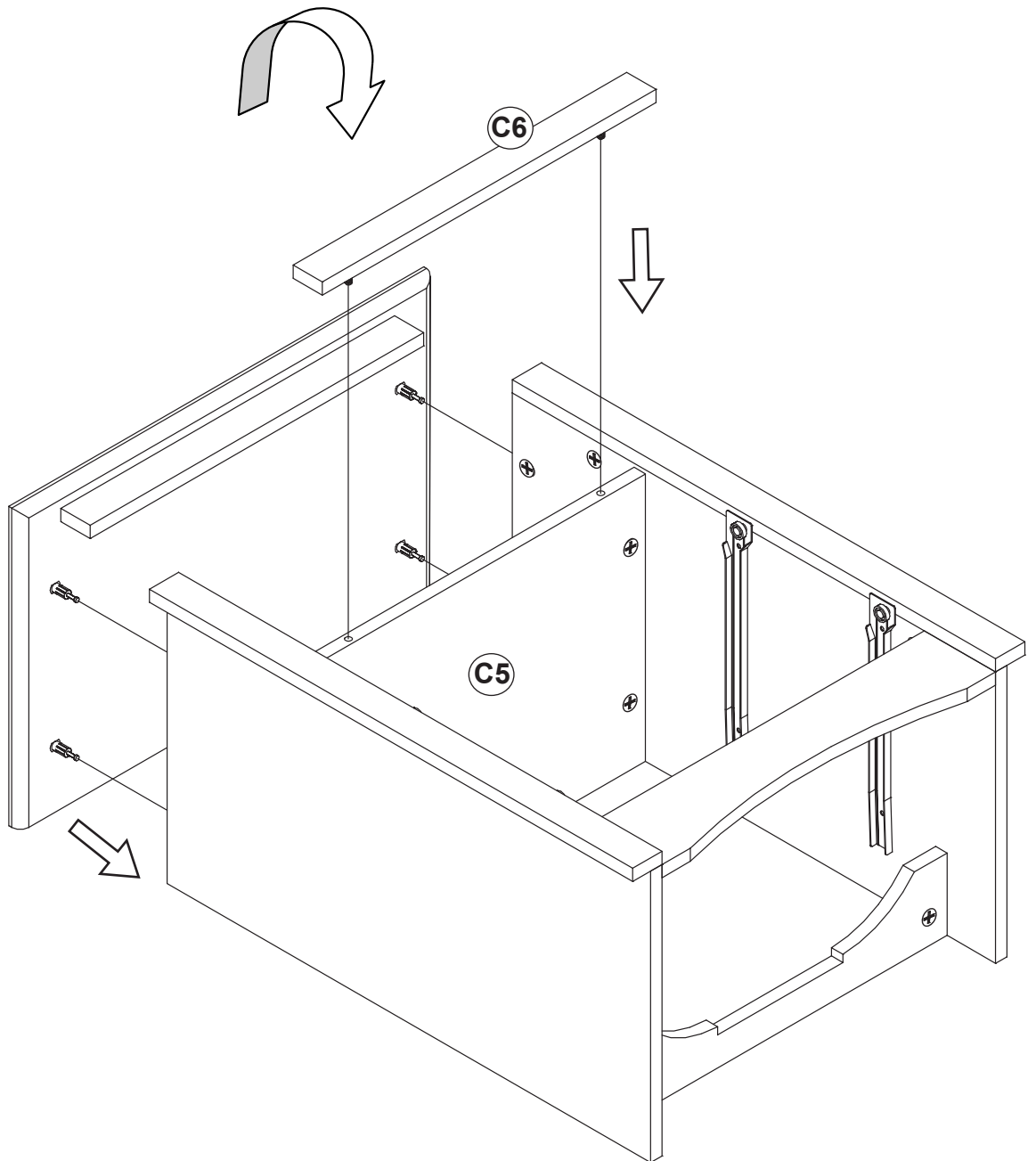

**13**

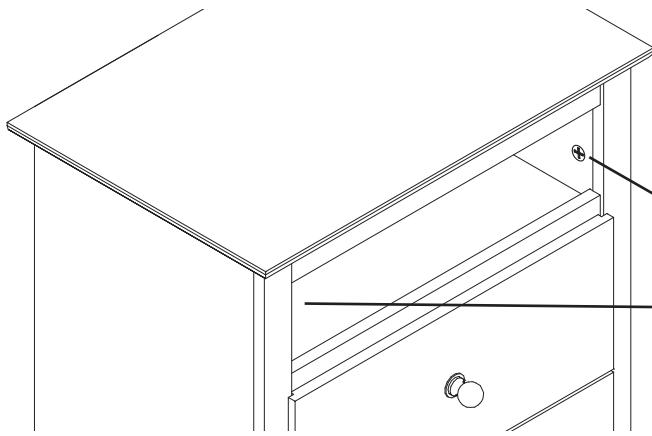

x2  
Cam Cover Cap  
Capuchons de cames  
Cubierta de tuercas



x20  
3/4" Nail  
Clou 3/4"  
Clavo de 3/4 pulg.

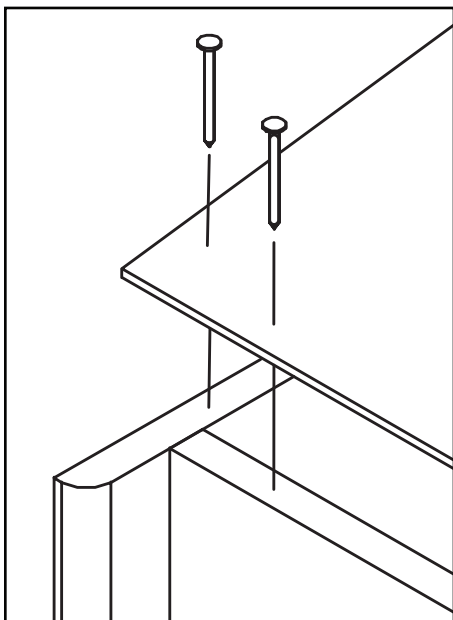
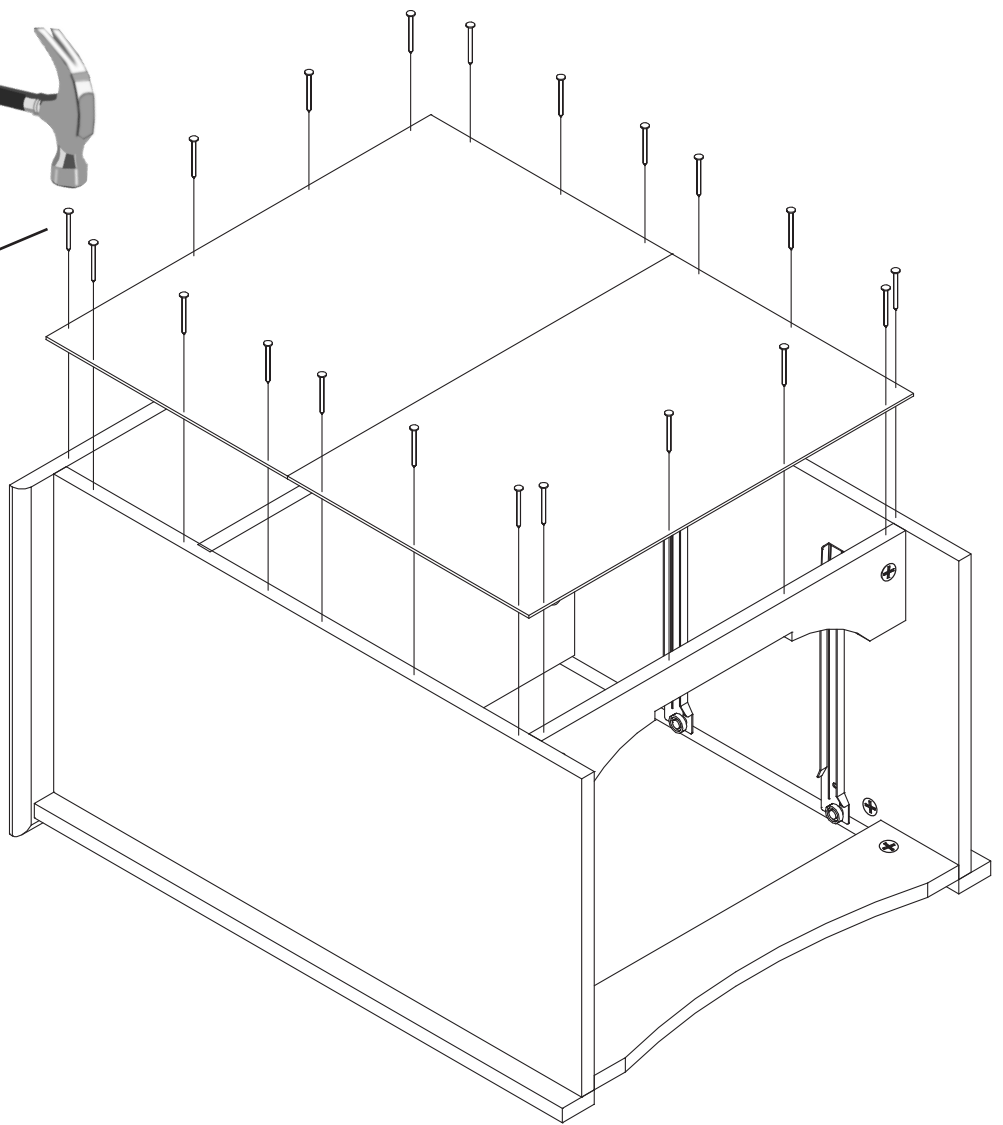

Center the nail in the middle of the panel. Avoid the corner of the backer  
*Centrez le clou au milieu sur le panneau. Évitez le coin du dos.*  
*Centre el clavo en el medio del panel. Evite la esquina del respaldo.*

# 14

## Assemble Drawers Montez les tiroir Ensamble los cajones

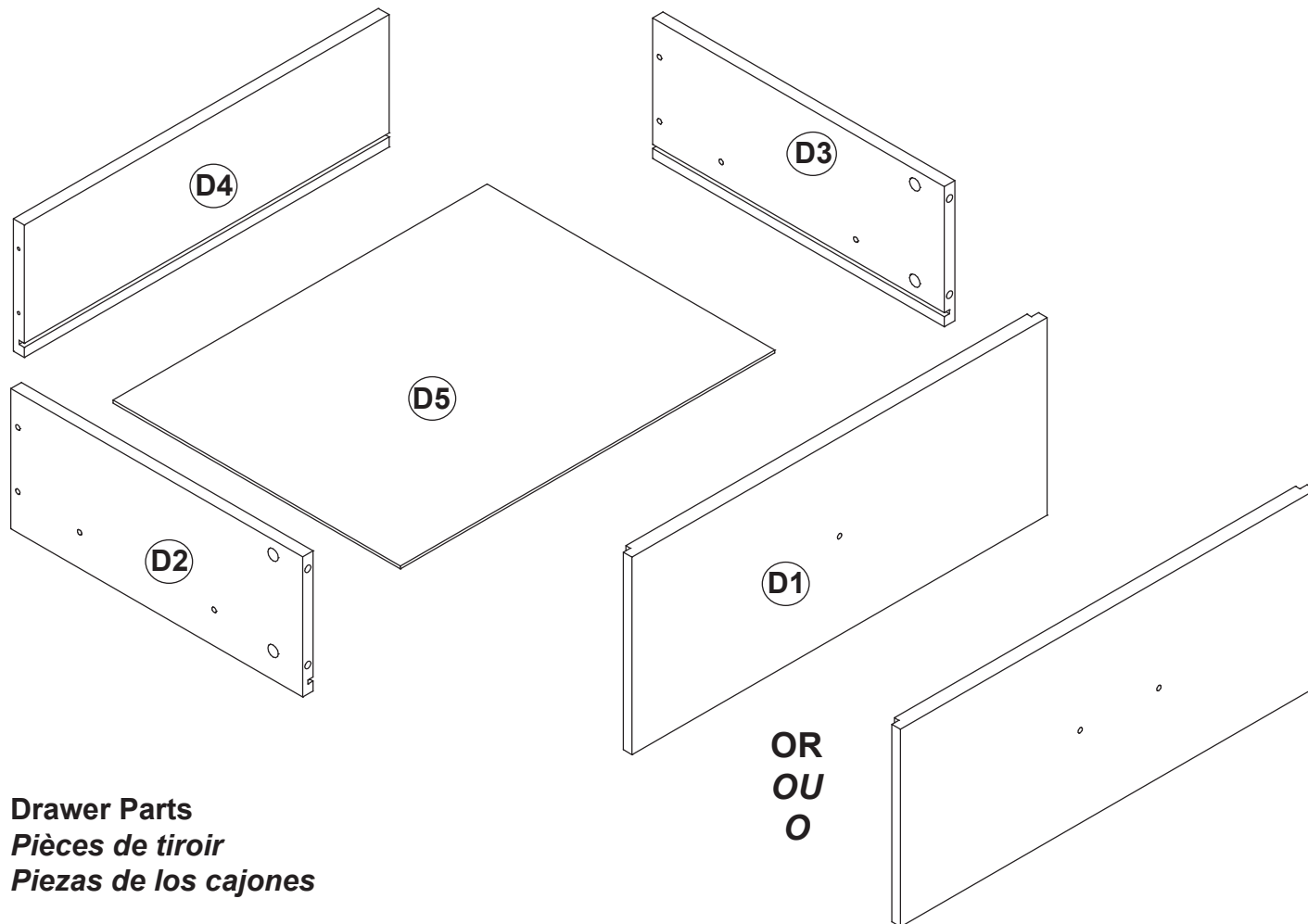

### Drawer Parts Pièces de tiroir Piezas de los cajones

**D1**

Drawer Front (2)  
Devant du tiroir  
Frente del cajón

**DF-10013-B**  
black

**DF-10013-CN**  
cherry

**DF-10027-D**  
drifted gray

**DF-10013-E**  
espresso

**DF-10013-H**  
washed black

**DF-10016-W**  
white

**D2**

Left Drawer Side (2)  
Côté gauche du tiroir  
Lado del cajón izquierdo

**DS-10001-L**  
Unfinished  
non-fini  
sin acabado

**D3**

Right Drawer Side (2)  
Côté droit du tiroir  
Lado del cajón derecho

**DS-10001-R**  
Unfinished  
non-fini  
sin acabado

**D4**

Drawer Back (2)  
Arrière du tiroir  
Parte posterior del cajón

**DK-10044**  
Unfinished  
non-fini  
sin acabado

**D5**

Drawer Bottom (2)  
Fond du tiroir  
Fondo del cajón

**DB-10044**  
Unfinished  
non-fini  
sin acabado

black = noir / negro  
cherry = cerise / cereza

drifted gray = gris vieilli / gris madera  
espresso = espresso

washed black = noir vieilli / negro envejecido

white = blanc / blanco

**a**

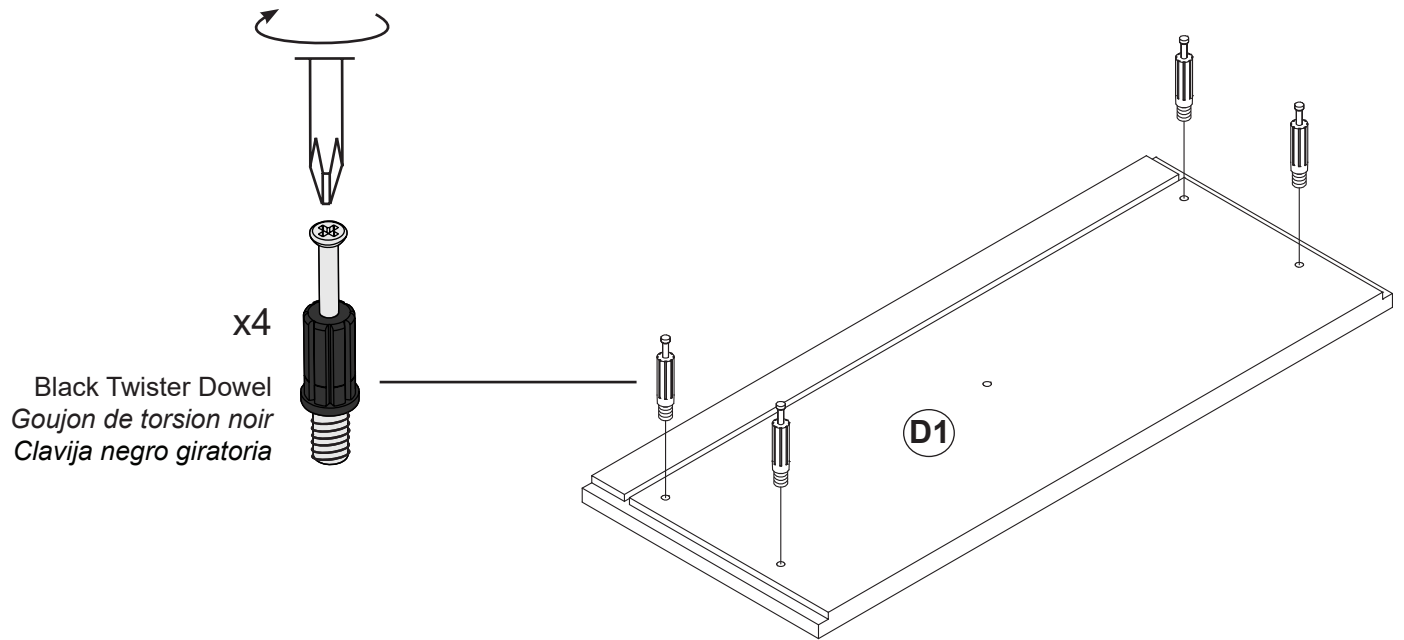

**b**

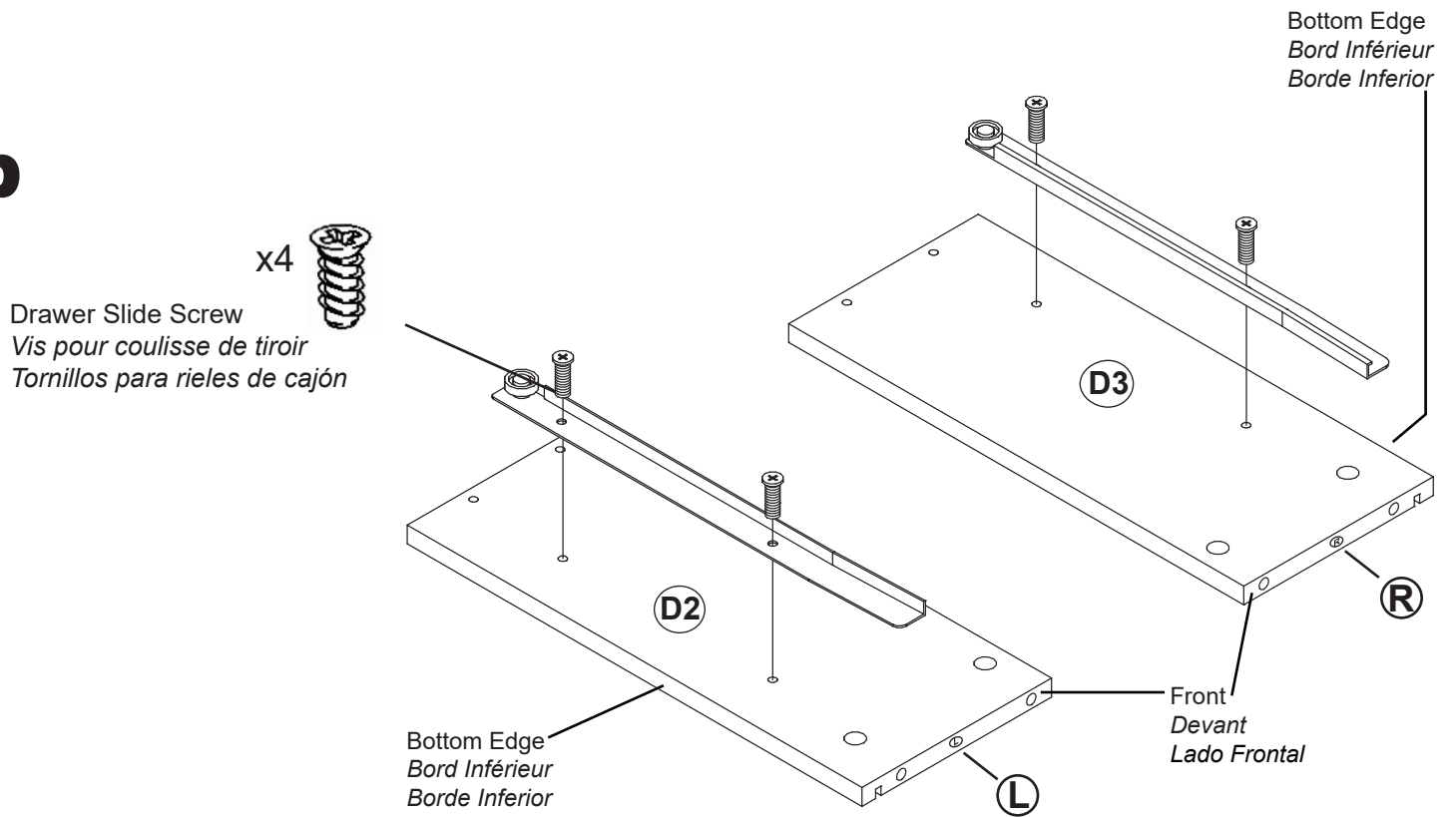

**c**

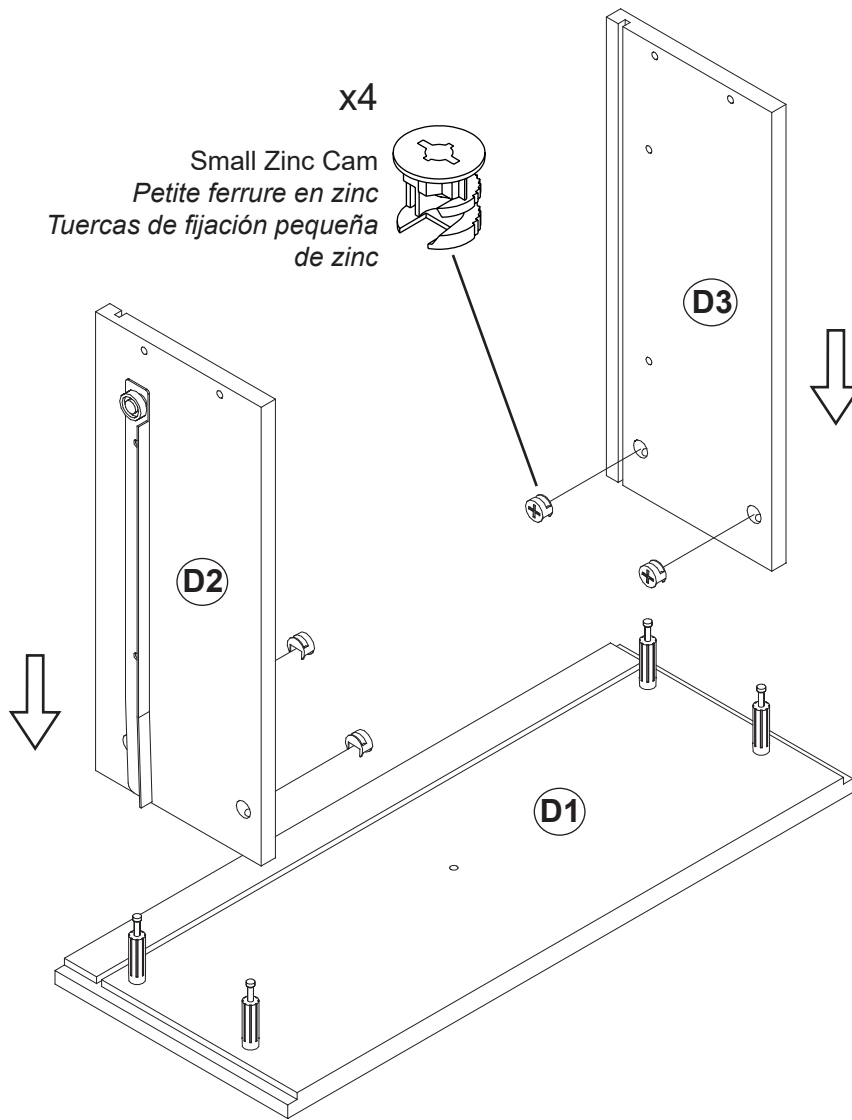

**d**

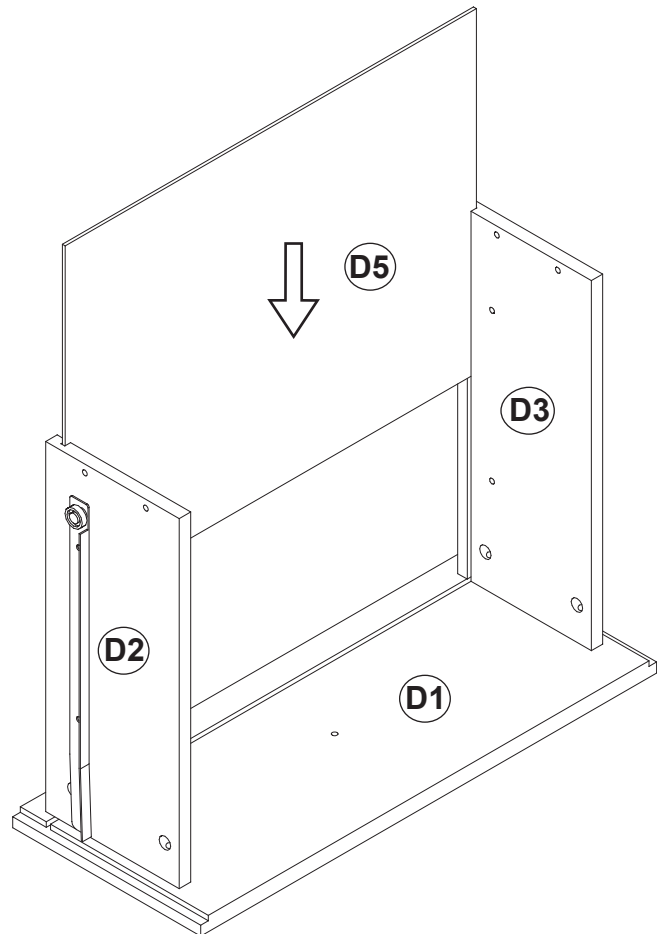

**e**

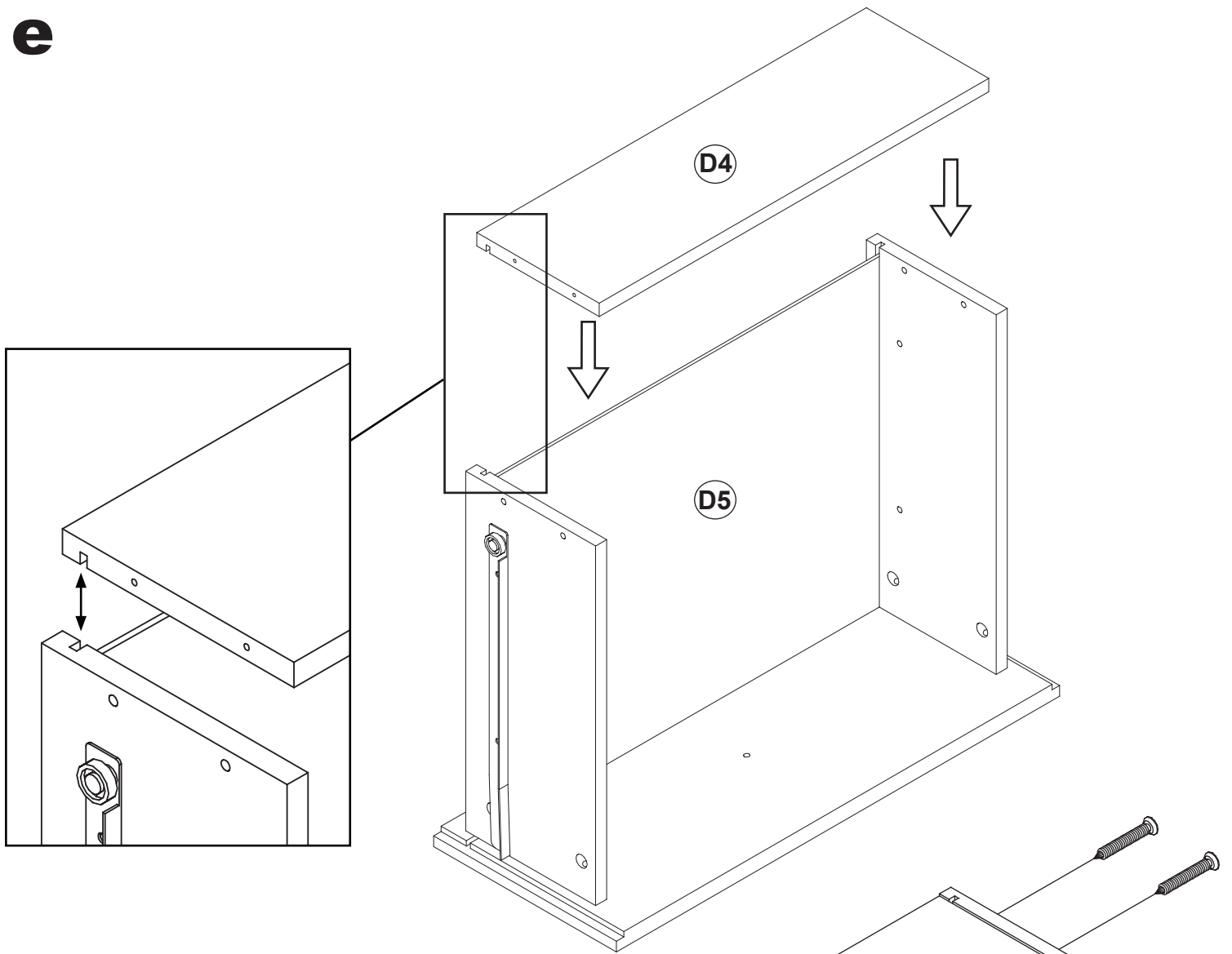

**f**

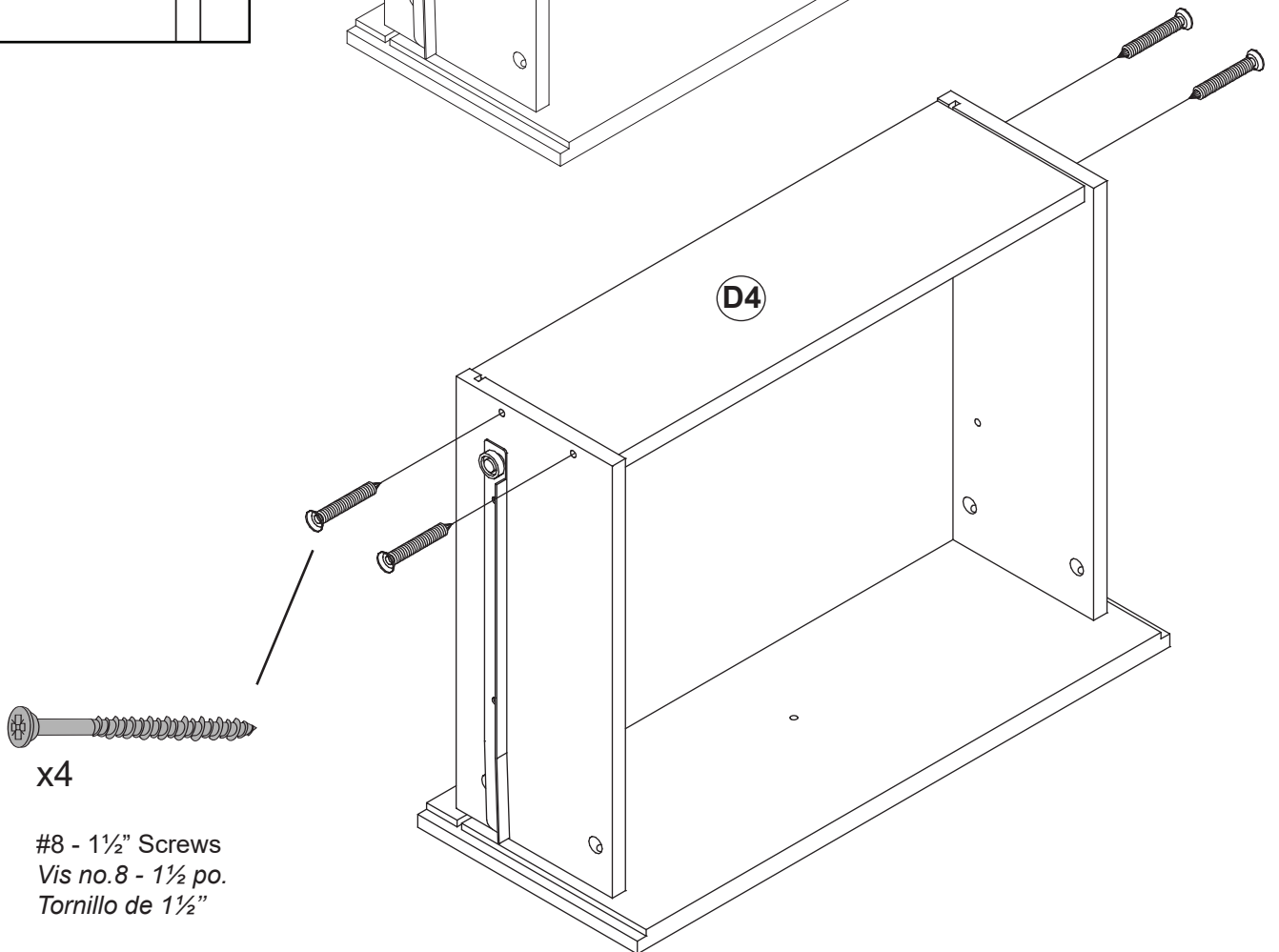

x4

#8 - 1½" Screws  
Vis no.8 - 1½ po.  
Tornillo de 1½"

**g**

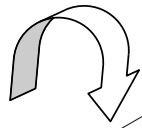

Machine Screw  
Vis de machine  
Tornillo para máquina

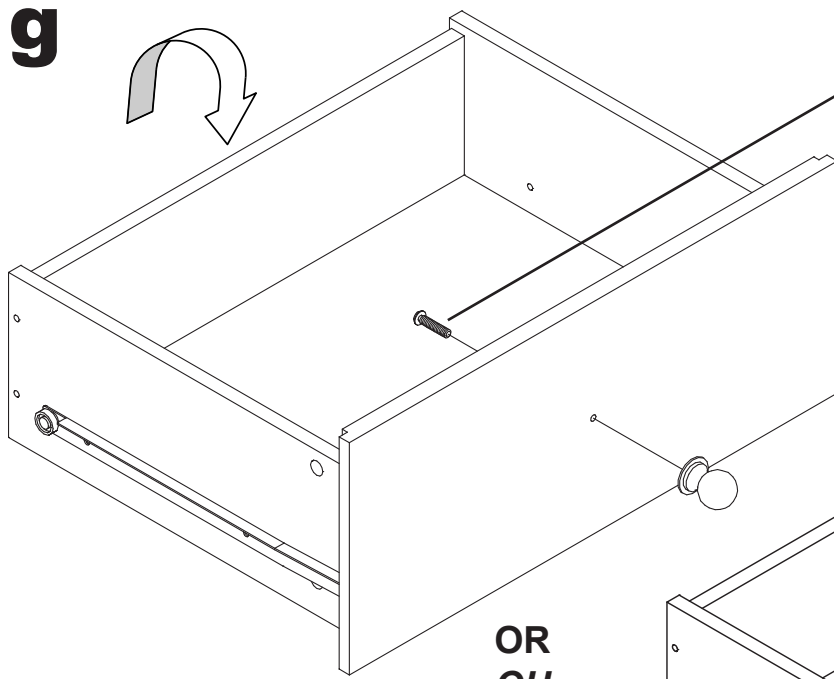

Included Screws  
Vis inclus  
Tornillos incluidos

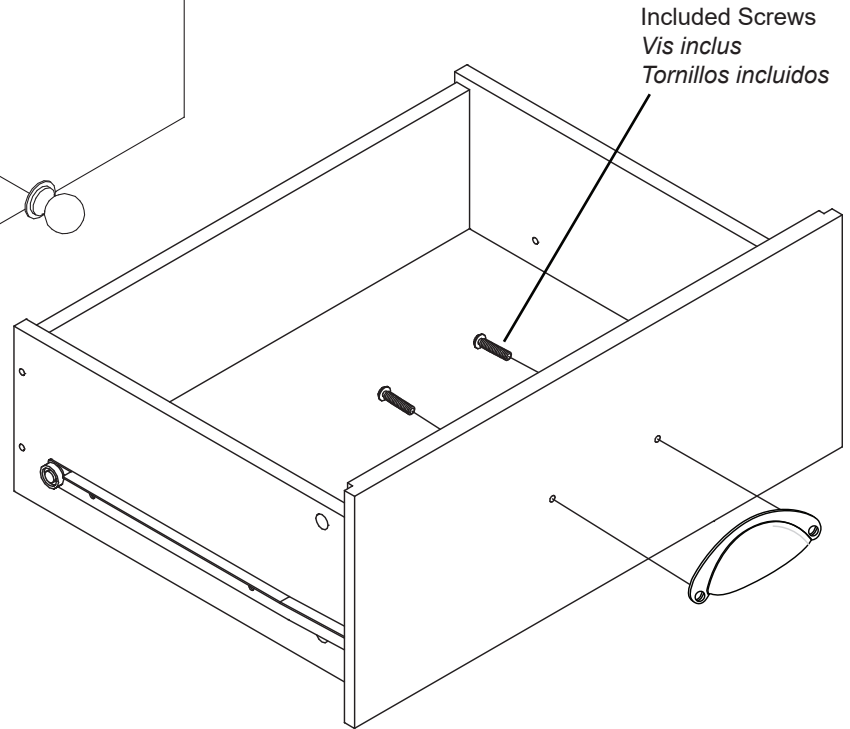

OR  
OU  
O

**h**

Insert drawers  
Insérez les tiroirs  
Inserte los cajones

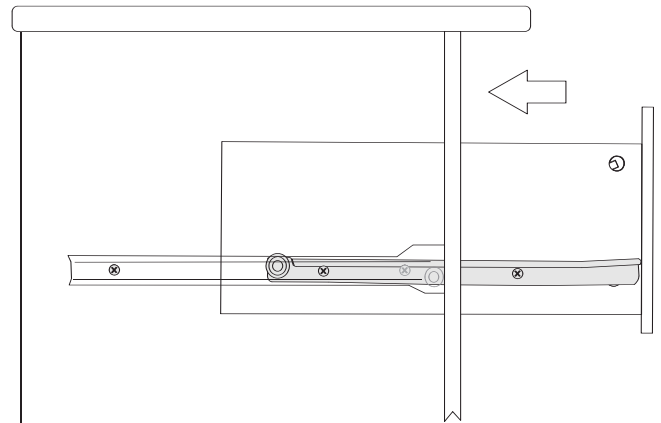
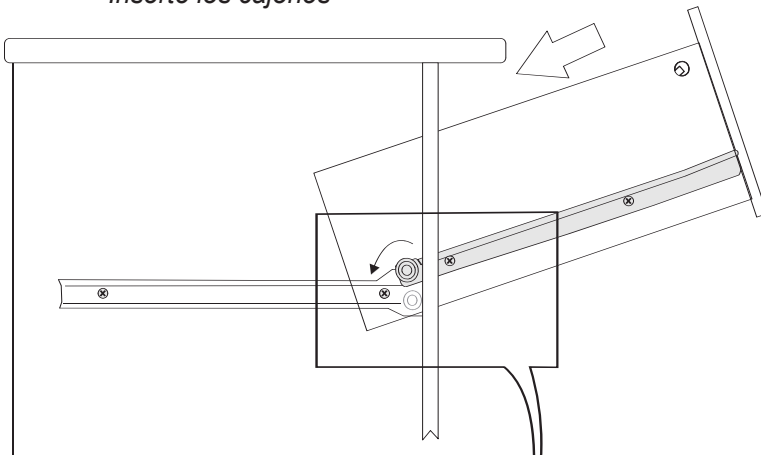

Cabinet / Cabinet / Gabinete

Drawer / Tiroirs / Cajones

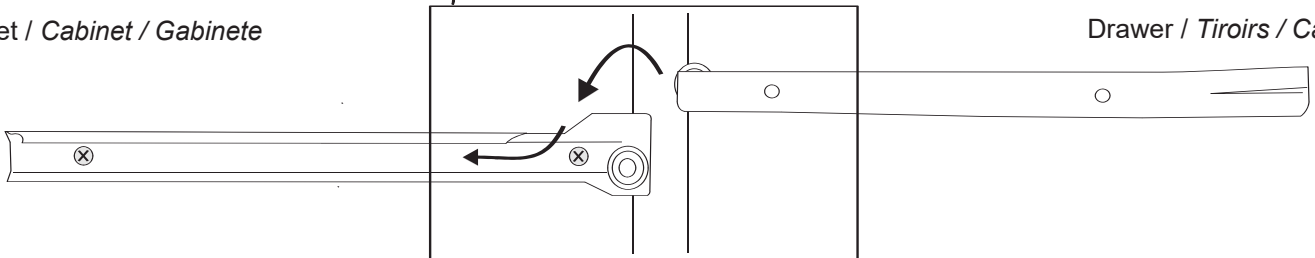

**Note:** When drawers are installed correctly, you will not be able to remove them without first lifting up the drawer front.

**Note:** Quand des tiroirs sont installés correctement, vous ne pourrez pas les enlever sans se soulever d'abord vers le haut de l'avant de tiroir.

**Aviso:** una vez que los cajones se hayan instalado correctamente, no podrá sacarlos sin antes levantar la parte frontal del cajón.