

# Installation Instructions

## 1. Mark the Center

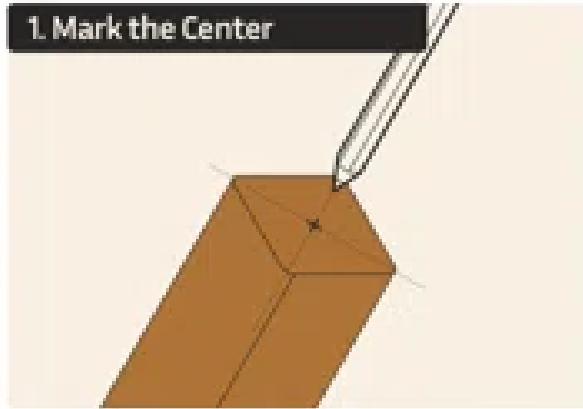

Mark the center point on the bottom of the furniture leg where the caster will be mounted.

## 2. Drill the Hole



Drill a pilot hole at the marked center. Then drill a 3/8" hole to a depth matching the stem length.

## 3. Install the Socket

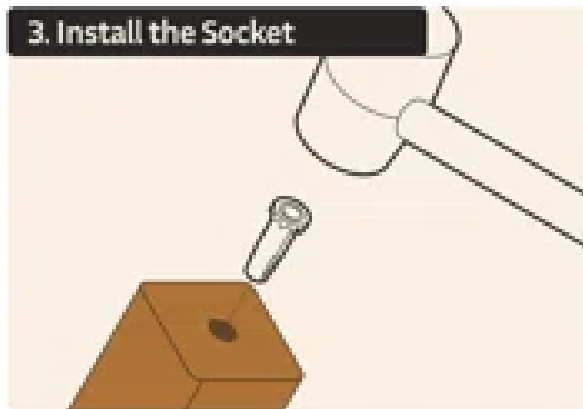

Insert the socket into the hole. Tap flush with a mallet until seated. Ensure the teeth grip the wood.

## 4. Insert the Caster



Press the caster stem into the socket until fully seated.