

10 : 00

estimated
installation time



1 or more

people required

Ok, let's
get started!



- Put on mood music!
- To prevent damage to product, use the clean side of package carton or rug as working surface.
- In the event of missing or damaged parts, delivery problems etc., please reach out to our team.
We will be happy to fix the problem!

care guide

- Clean regularly with a soft and dry cloth.
- To protect finish, avoid use of abrasive cleaners.
- Wipe up spills immediately. Please!



product parts



(A)
Shelf
x1

what's included

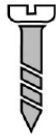

(B)- Screw
x4



(C) - Wall Plug
x4

installation instructions

Friendly Tip: Take a deep breath going on. This is easy even if you are not used to tools. Just follow these steps to the T, and the outcome will be worth it!



step 1:

Place the shelf (A) on the wall and put a spirit level on it to check its alignment. Adjust till the angle is straight.

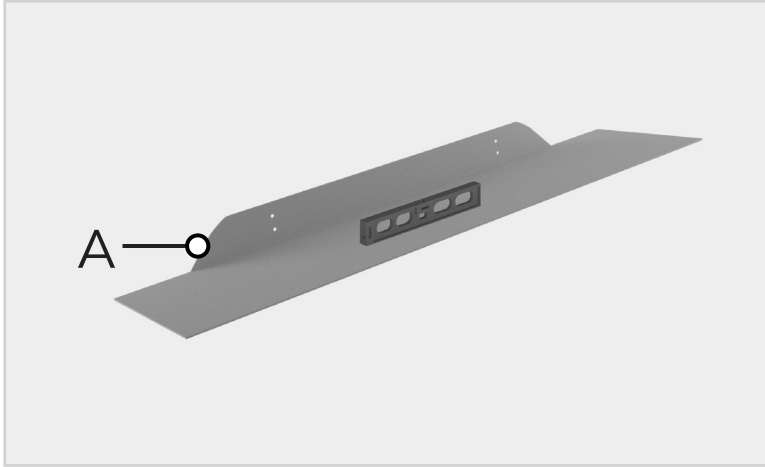

step 2:

Once the shelf is in a straight alignment, make marks on the wall through the predrilled holes on the shelf.

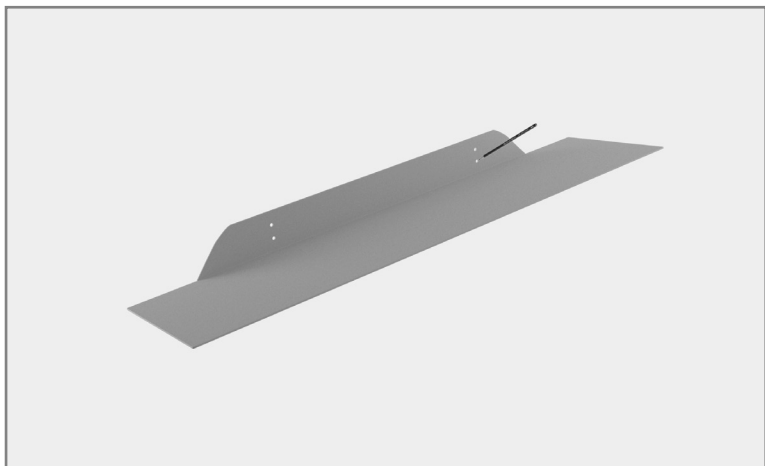

step 3:

Drill holes at the points you just marked.

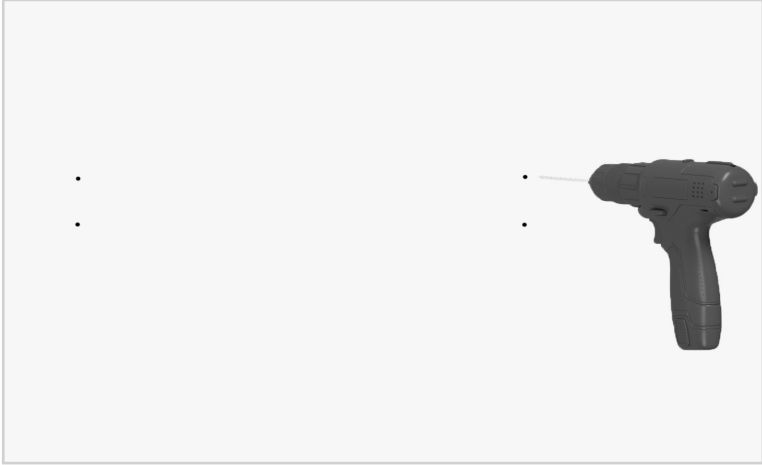

step 4:

Using a hammer, insert wall plugs (C) inside the hole.

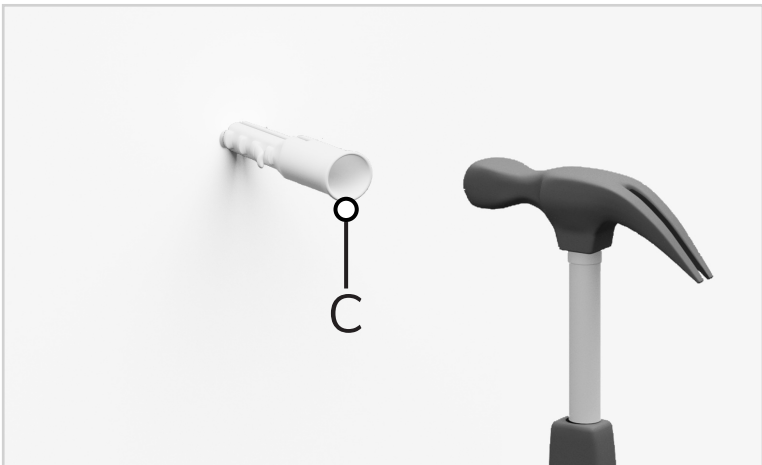

step 5:

Place the shelf (A) so that the predrilled holes on it are right above the wall plugs. Fix the screws (B) into the wall plugs over the shelf. Use a screwdriver to make sure they are secure.

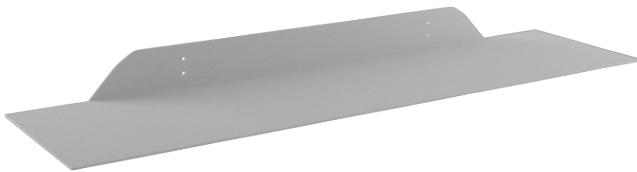
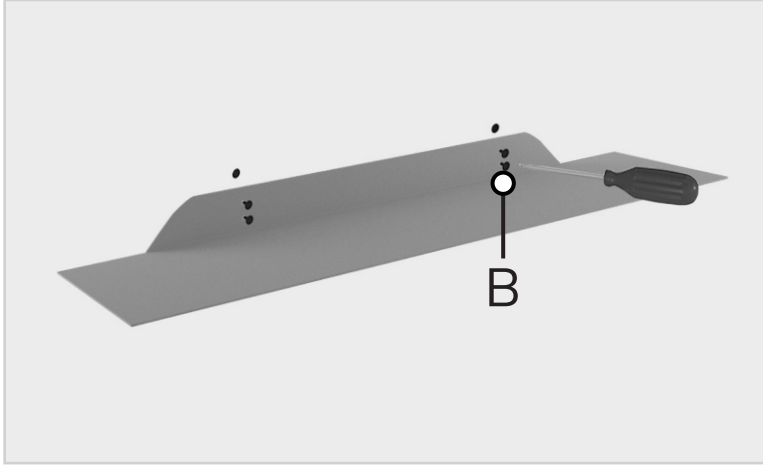

Voila! Your shelf is now installed and secure!