

VIVOHOME®

PORTABLE EVAPORATIVE
AIR COOLER

Normal Sleep Natural



VIVOHOME®

Indoor Series
HOUSEHOLD

AUTOMATIC
ROTATION

AUTO-
TIMER

WATER-
COOLING

ENVIRONMENTALLY
-FRIENDLY

SKU: VH654

Maintenance and care

If proper care is not taken, filters may be infested with fungus and moulds. For maintenance of the product, you **MUST** clean the filter and water tank in dry area before long term storage. It is always recommended to regularly clean the filter and the water tank for healthier usage. Make sure to clean the filter when you see signs with musty odor and mould build ups in the filter.

Preventing mould build ups in the Evaporative Cooler

Always check the Humidity level, as the Evaporative cooler is most effective on dry areas. Running evaporative cooler mode on humid days will prevent evaporation through the cooling pad causing higher chance of mould build ups.

Tips to Clean the filter?

Remove the filter (cooling Pad) from the unit and submerge the filter into a mixture of lemon Juice and water for 40 Seconds. Gently with soft brush remove the mould, then in clean running water, Rinse the filter. Leave the filter to be completely dry before usage.

NOTE:

Any questions regarding the usage or installation, please watch the video on the product page for reference. To continuously improve the products, VIVOHOME reserves the right to modify this information without prior notification. Please contact customer service via support@vivo-home.com with any questions, comments, or concerns. Thank you for choosing VIVOHOME products at your home!



AMAZON
VIVOHOME



INSTAGRAM
@VIVOHOME.OFFICIAL



FACEBOOK
@VIVOHOME.OFFICIAL

Thank You For Purchasing From
VIVOHOME

✉ support@vivo-home.com

READ AND SAVE THESE SAFETY INSTRUCTIONS BEFORE USING THIS APPLIANCE

IMPORTANT SAFETY INSTRUCTIONS

WARNING: When using electrical appliances, basic safety precautions should be followed to reduce the risk of fire, electrical shock and personal injury

1. Use this cooler only as described in this manual. Other uses are not recommended as they may cause electric shock or injury. This will also void your warranty
2. Always operate the product from a power source of the same voltage, frequency and rating as indicated on the rating label.
3. This product is intended for indoor, household use ONLY. Do not use outdoors or for commercial or industrial purposes.
4. To protect against electric shock: do not immerse unit, plug or cord in water or spray with liquid; do not place unit on windowsills or other places where it may be exposed to dripping or splashing water; do not place vases or similar objects filled with liquids near the unit.
5. Do not use this product in the immediate vicinity of water, such as bathtubs, washbowls, swimming pools etc. where the likelihood of immersion or splash could occur.
6. To reduce the risk of fire or electric shock, do not use this product with any solid-state speed control device.
7. This appliance is not intended for use by persons (including children) with reduced physical, sensory or mental capabilities, or lack of experience and knowledge, unless they have been given supervision or instruction concerning use of the appliance by a person responsible for their safety.
8. This product is not a toy! Children should be supervised to ensure that they do not play with the appliance.
9. Turn the unit OFF when unplugging from the outlet and not in use. When moving the unit from one location to another, fully assemble the unit before switching on again.
10. To disconnect the unit, first turn it OFF, grip the plug and pull it from the wall outlet. Never pull the plug by the cord.
11. Do not operate the cooler in the presence of explosive and/or flammable fumes.
12. Do not place the product or any parts near an open flame, cooking or other heating appliance.
13. Do not operate product with a damaged cord or plug, or if the product malfunctions, or is dropped or damaged in any manner.
14. Avoid contact with moving parts. Do not insert any body parts (e.g. finger) or objects through the grill while the unit is operating.
15. The use of attachments is not recommended by the manufacturer and may be hazardous.
16. Place the unit on a dry level surface to avoid overturning.
17. Do not operate if the product housing is damaged.
18. Do not cover the grill, or operate in close proximity to curtains, etc. Ensure adequate ventilation around the unit.
19. A loose fit between the AC outlet (receptacle) and plug may cause overheating and a distortion of the plug. Contact a qualified technician to replace loose or worn outlet.
20. If the supplied cord is damaged, it must be replaced by the manufacturer, its service agent or qualified person in order to avoid hazard.

21. If the product is not working properly, contact a qualified technician for examination and repair. Never attempt to dismantle the unit yourself.
22. Never install or store the unit where it could be subject to:
 - Heat sources such as radiators, heat registers, stoves or other products that produce heat
 - Direct sunlight
 - Mechanical vibration or shock
 - Excessive dust
 - Lack of ventilation, such as a cabinet or bookcase
 - Uneven surfaces
23. Do not leave the product running unattended.
24. The castor wheels must be attached before use.
25. Do not remove the water tank while the unit is plugged in.

OVERVIEW

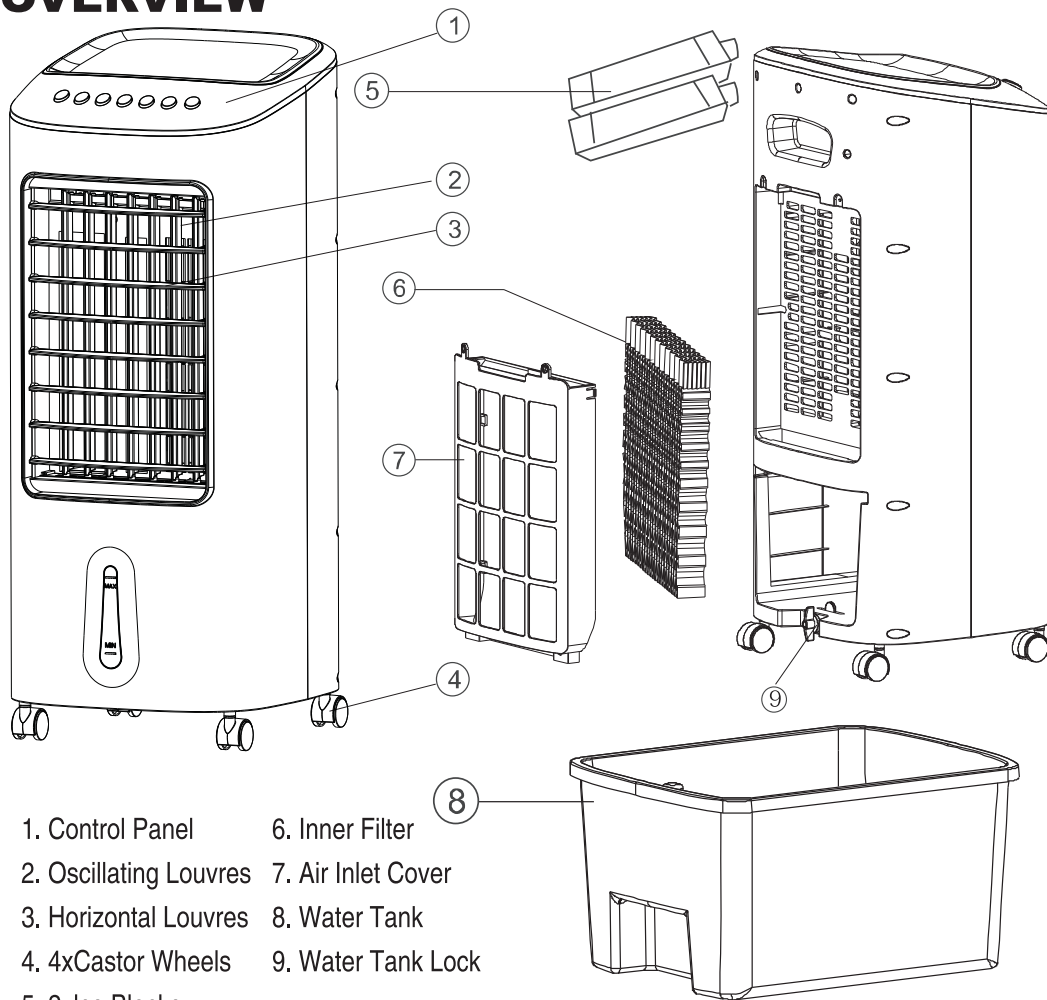

- | | |
|------------------------|--------------------|
| 1. Control Panel | 6. Inner Filter |
| 2. Oscillating Louvres | 7. Air Inlet Cover |
| 3. Horizontal Louvres | 8. Water Tank |
| 4. 4xCastor Wheels | 9. Water Tank Lock |
| 5. 2xIce Blocks | |

Note: The Ice Blocks are supplied empty; add water and freeze for few hours before use.

AIR INLET COVER AND INNER FILTER

1. Use a screwdriver to unscrew the two cover screws.
2. Remove the Air Inlet Cover and wipe clean, or clean using a vacuum cleaner.
3. Use a duster to gently by dusting off the Inner Filter.
4. Replace the Inner Filter and Air Inlet Cover and tighten the screws to fix in position.

WATER TANK

Warning: Unplug the unit from the main supply before removing the water tank (see pages 5 and 6 for instructions).

- When unit or the Cool function is not in use for period of time, empty the water from the tank.
- Use mild soap and water to clean the Water Tank.
- Allow it to air dry or wipe dry using a soft cloth. Make sure the Water Tank is completely dry before replacing. This helps prevent any mould or mildew inside the Water Tank.
- Empty the water and dry out the ice blocks before storage.

Make sure the Air Inlet Cover and Water Tank are replaced in position before switching on.

TECHNICAL SPECIFICATIONS

Rated Voltage: 110V-120V - 60Hz

Rated Power: 65W

Note: As a result of continuous improvements, the design and specifications of the product within may differ slightly from the unit illustrated on the packaging.

STORAGE AND DISPOSAL

If you do not plan to use the product for extended periods of time, it is recommended that it is cleaned and stored (preferably in its original packaging) in a cool, dry place.



Do not dispose electrical products with household waste. Please check with your local council for advice on disposal or recycling. If electrical appliances are disposed in landfills or dumps, hazardous substances can leak into the ground water and get into the food chain,

Do not put your used batteries in with your household rubbish. Take them to an appropriate disposal/collection site.

Opening the Battery Compartment

Note: Images in this section are for illustration only.

1. Lay the remote-control face-down on a table and hold it down with your left hand.

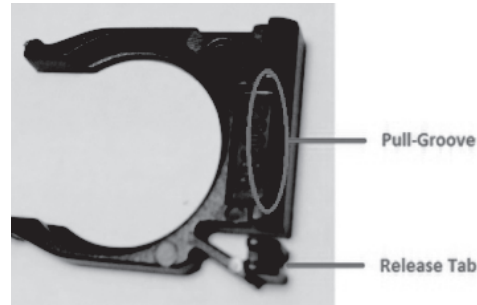

2. Insert the thumbnail of your right hand into the Release Tab, and your index fingernail into the Pull-G groove

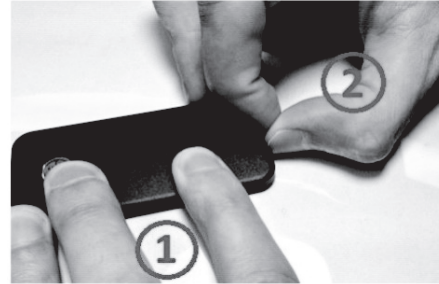

3. With your thumbnail, squeeze the Release Tab inwards whilst at the same time sliding the battery holder out with your index finger-nail.

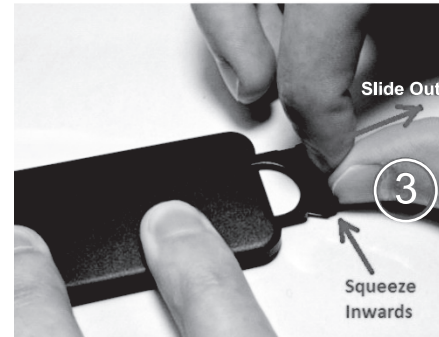

CLEANING AND MAINTENANCE

Note: Images in this section are for illustration only.

Caution:

- Always switch off and unplug the unit before removing the filters or performing any cleaning.
- Do not use harsh detergents, chemical cleaners or solvents as they may damage the surface finish of the plastic components.

MAIN BODY

1. Use a soft duster or a rag to dust off all the surfaces.
2. Clean the Air Inlet and Air Out let using a vacuum cleaner regularly.
3. Wipe all the parts with a soft damp (not wet) cloth dipped in mild soapy water.
Caution: Ensure that water doesn't get inside the unit.
4. Use a dry cloth to thoroughly dry the unit before turning on.

ASSEMBLY

Note: The 4 x Castor Wheels must be installed before using this Cooler.

1. Spread a soft cloth or mat on a level floor. Carefully place the unit upside down on the soft cloth or mat.
2. Insert each Castor Wheel into the hole on the bottom of the machine and thread it in clockwise. Tighten with the provided wrench to secure into position. Repeat for all four Castor Wheels.

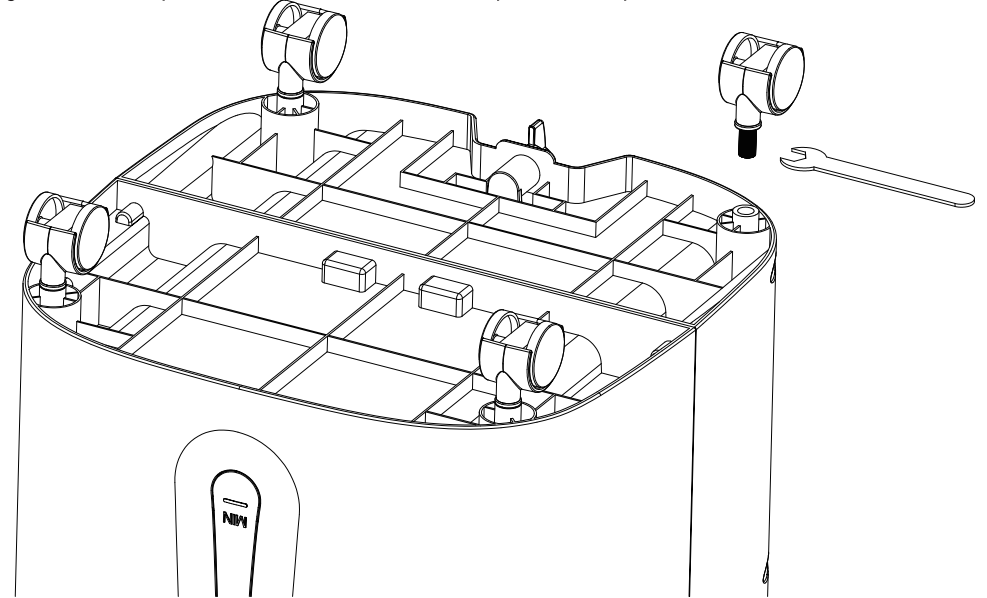

CONTROL PANEL

ON/STANDBY

- Press the ON/STANDBY button to turn on the unit. The unit starts working in medium speed and switches to low speed after 3 seconds.
- When the unit is working, press the ON/STANDBY button again to switch it back to standby mode.



SPEED:

- Press the SPEED button to adjust the speed. There are three positions - Low, Medium or High. The corresponding indicator turns on.

SWING

- Press this button to start or stop louvre oscillation from left to right. The corresponding indicator turns on.

TIMER:

- Press this button to set the timer for the unit.
- The turn-off time can be set in half-hour increments from 0.5 to 7.5 hours. There are 4 indicators - 0.5H, 1Hr, 2Hr and 4Hr

FILLING THE WATER TANK

Before use, follow the procedure explained below to fill the water tank with clean, cold water. Do not fill the water past the 'MAX' level indicate

WARNING: Unplug the unit from the main supply before removing the water tank

Important:

- Do not use water with any chemical additives. The water must be cold or cool, do not use hot water above 40°C.
- Do not fill water above the ' MAX ' line indicated on the Water Tank.

1. Switch the Water Tank Lock to the horizontal position to unlock and pull the Water Tank.

To unlock turn the knob counter-clockwise

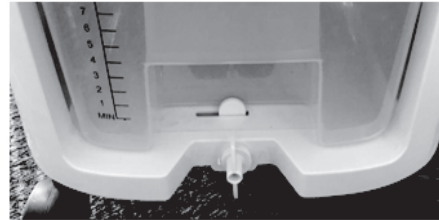

2. To remove the Water Tank completely, first remove the pump by pressing the two end tabs

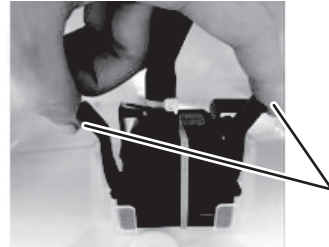

3. To replace the Water Tank, first detach the pump from slot by pressing the two side tabs. Carefully push the Water Tank into its position.

USING THE ICE BLOCKS (OPTIONAL)

There are two ice blocks included, to provide the extra cooling effect.

Important:

- Use only clean water to fill the ice blocks. Do not fill water above the maximum marking.
- The ice blocks are not food safe, do not use for storing food or beverages.
- Keep away from children.
- Empty the water and dry out the ice blocks before storage.

1. Open the cap, add clean water up to the maximum level marking, close and place in your freezer for a few hours.
2. Once frozen, the ice blocks can be added to the water tank.

Note: Make sure the water level in the tank does not go above the 'MAX' level indicated.

OPERATION

Warning:

- Make sure that the castor wheels are attached before switching on.
 - Once water is filled, take extra care to ensure that you don't tilt the unit.
 - Push the unit gently if you wish to move to a new position.
 - Do not remove the water tank while the unit is plugged in.
1. Keep the unit on a flat, stable ground without any obstacles near it.
 2. Connect the power plug to the suitable electrical outlet with the same specifications as mentioned in the unit's rating label (see Technical Specifications for details). When the supply is turned "ON", the unit receives power and stays standby mode. The Power indicator light turns on.
 3. You may now use the control panel buttons or the remote control to operate the cooler.

MODE:

There are three selectable modes, the corresponding indicator turns on.

- Normal mode: The fan operates in the constant speed set using the SPEED button.
- Natural mode: The unit simulates a natural breeze.
- Sleep mode: The unit simulates a gentle breeze suitable for night-time use.

COOL:

- Press this button for cool breeze after cool water has been added to the water tank. The corresponding indicator turns on.
- Press again to turn off the cool breeze.

REMOTE CONTROL



WARNING! Keep batteries out of reach of children. Swallowing may lead to serious injury or death within 2 hours due to internal burns. If swallowed, go straight to the hospital emergency room. Dispose of used batteries immediately.

- The remote control uses 1x CR 2025 button cell battery (included). Please remove the plastic tab before first use. Please see the following section on opening the battery compartment to replace the battery
- The remote-control buttons have the same functions as on the control panel.

