

Queen Headboard

IMPORTANT NOTE

Carefully remove all the parts from the carton and put them individually on a soft cloth to prevent scratches or other damages occuring to the parts.

We have taken great care in the design of this product and request that you carefully and strictly follow our assembly instructions to ensure a completed product as it was designed.

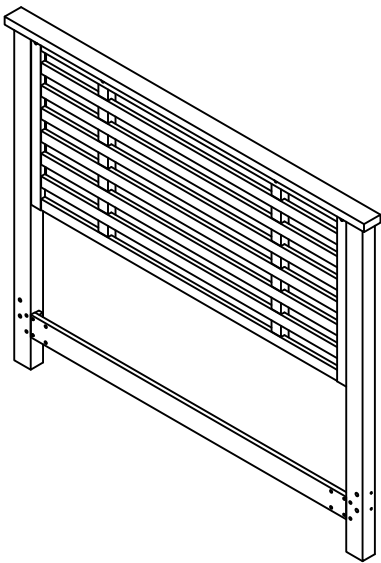

Part List

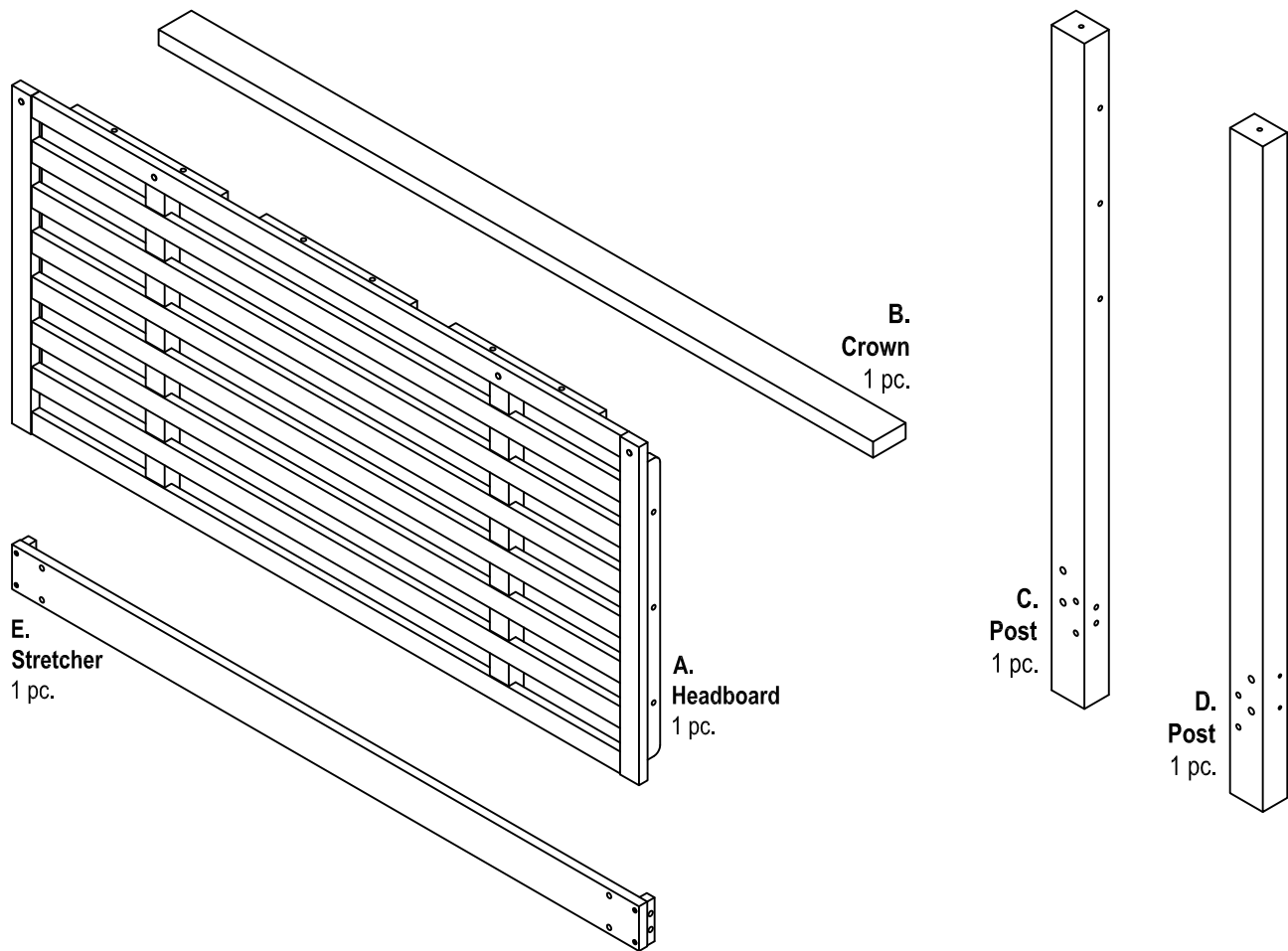

Hardware List



Tools Required For Assembly : Phillips screwdriver

Assembly Instructions 2/3

IMPORTANT

- * Do not tighten up all the bolts until each part is properly assembled.
- * You should keep Key Wrench in a safe place as you may need to tighten up the bolts in the future.
- * Use a soft cloth between these parts and the floor.

STEP 1

Insert Cam Lock Screws into the pre-drilled holes of Crown (B).

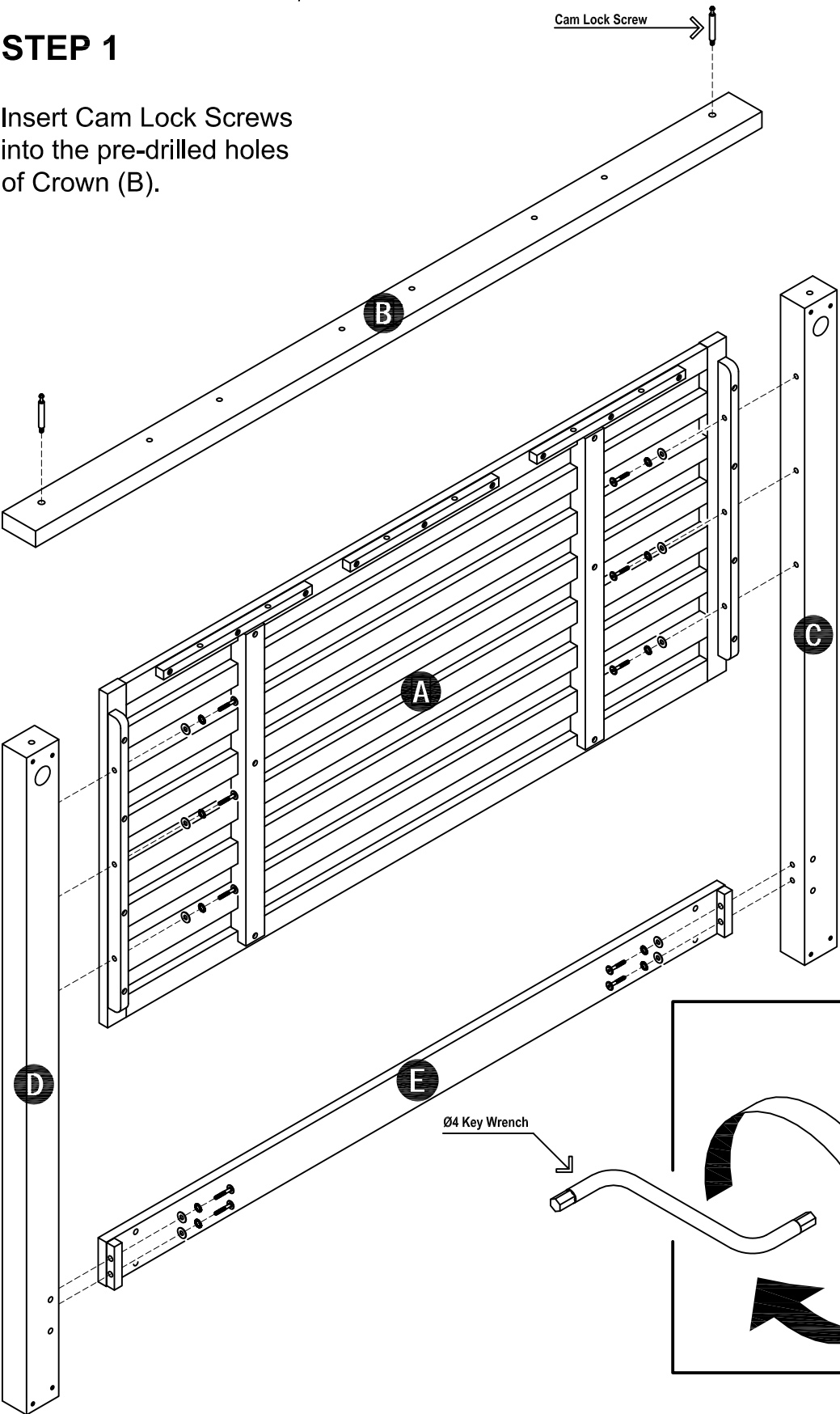

STEP 2

Attach Headboard (A) and Stretcher (E) to Posts (C) and (D) using Head Cap Bolts, Spring Washers and Flat Washers. Tighten all the Bolts with Ø4 Key Wrench. (See Figure 1)

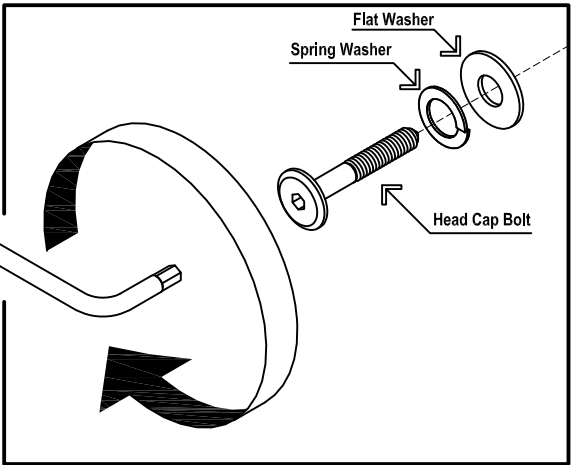

(Figure 1)

Assembly Instructions 3/3

STEP 3

Attach Crown (B) to unit using Cam Locks, Head Cap Bolts, Spring Washers and Flat Washers. Tighten all the Bolts with Ø4 Key Wrench.

(See Figure 1)

Tighten Cam Locks with Ø6 Key Wrench.

(See Figure 2)

Cover Cam Lock holes with Cam Lock Caps.

(See Figure 3)

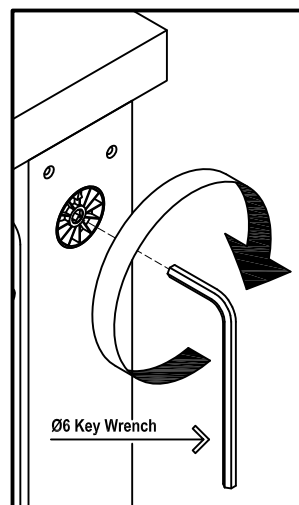
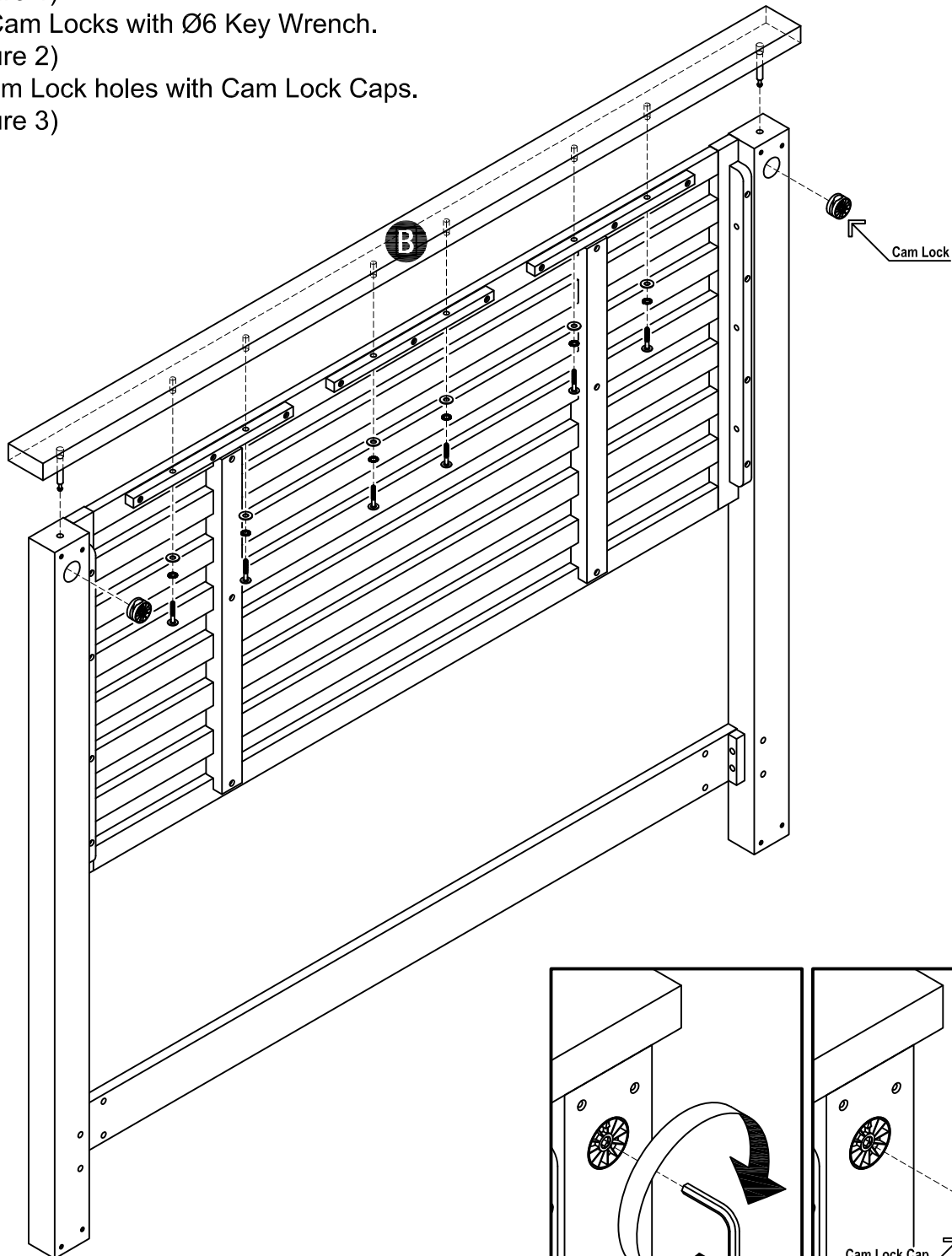

(Figure 2)

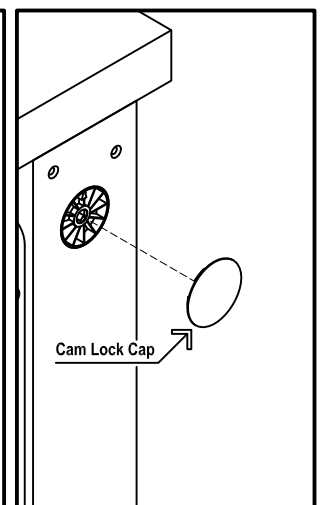

(Figure 3)

VERY IMPORTANT !!

CARE INSTRUCTIONS

NEVER

USE GLASS CLEANERS ON FINISHED FURNITURE. AMMONIA WILL CHEMICALLY ATTACK THE FINISH.

NEVER

ALLOW LIQUIDS OF ANY KIND TO REMAIN ON THE FURNITURE. ABSORPTION CAUSES PART TO WARP AND SPLIT AND FINISHES TO DELAMINATE.

DO NOT WRITE DIRECTLY ON SURFACE.



PREVENT MARKING

DO NOT PLACE IN DIRECT SUNLIGHT.



PREVENT FADING

DO NOT USE COMMERCIAL WAXES AND POLISHES.



PREVENT YELLOWING

DO NOT PLACE HOT OBJECTS ON SURFACE.



PREVENT FINISH DAMAGE

DO NOT USE RUBBER BASED PLACE MATS.



PREVENT DISCOLORING

TO CLEAN

USE A SOFT CLOTH MOISTENED IN LUKEWARM SOAP AND WATER, THEN BUFF WITH A DRY CLEAN CLOTH.

