

Product Data Specifications

Recessed Mount Medicine Cabinet

Mirror:	16-3/16"x 22-1/4" Double Strength(1/8") flat mirror with one pass polished edges bonded with double faced tape and special bonding adhesive to a white high impact polystyrene backer @ .060 Thickness
Overall Size:	16-3/16" x 22-1/4"x 4-1/2" Rough Opening: 14" x 18" x 3"
Storage Depth:	4" Projection from wall: 1-1/2"
Door Catch:	Magnetic catch with riveted striker plate
Shelves:	2 adjustable crystal polystyrene and 1 fixed white steel
Hinges:	1 17" piano hinge Tri-Brite galvanized
Hardware:	Parts zinc plated(magnetic catch, screws & hardware pack)
Mounting Hardware:	4 # 8 x 1-1/2" Steel Tapping Screws
Reversible:	Yes
Cabinet:	24 Gauge Steel-Tech Cabinet Body White Powder Coat Process

Steel Cabinet

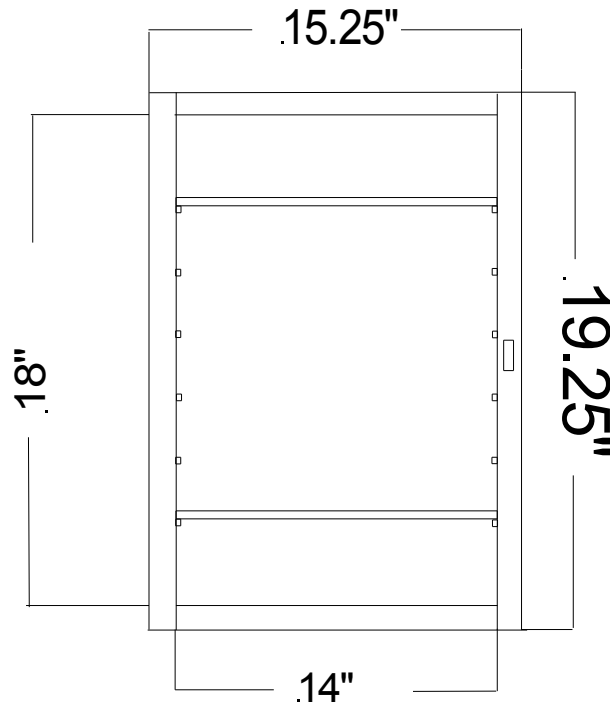

Steel Cabinet Powdercoated White
Storage Depth(4")
Covers up 15.25" x 19.25"
R.O.(14" x 18" x 3")