

ASSEMBLY INSTRUCTION

Size: 19 1/4" x 24" x 40 1/2"(H)

List of Part For 1 Set

| Code | Figure | Part | Qty. |
|------|--------|--------------------|------|
| ① | | Chair Back | 1 |
| ② | | Cushion Seat | 1 |
| ③ | | Front Leg (R) | 1 |
| ④ | | Front Leg (L) | 1 |
| ⑤ | | Front Stretcher | 1 |
| ⑥ | | Side Stretcher (R) | 1 |
| ⑦ | | Side Stretcher (L) | 1 |

List of hardware For 1 Set

| Code | Figure | Hardware | Qty. |
|------|--------|-----------------------------|------|
| (A) | | Hex.Bolt M6 x 80mm | 4 |
| (B) | | Hex.Bolt M6 x 60mm | 4 |
| (C) | | Hex.Bolt M6 x 40mm | 2 |
| (D) | | Flat Washer 1/4" x 18 mm | 10 |
| (E) | | Spring Washer 1/4" | 10 |
| (F) | | Spanner 10 mm | 1 |
| (G) | | PHRS Screw 8 x 1 1/2" | 6 |



Important Notes

- * Keep all hardware parts out of reach of children.
- * Must tighten screws periodically. With use screws will become loose. Check tightness of all screws every 6-8 weeks.
- * Don't attempt to repair or modify parts that are broken or defective. Please contact the store immediately.
- * Do not tighten all screw / bolt until all completely assembled.

Notes

- * Place all wooden parts on a clean and smooth surface such as a rug or carpet to avoid the parts from being scratched.
- * Check to be sure that you have all parts and hardware.
- * Remove all wrapping materials including staples & packing straps before you start to assemble.
- * Do not tighten all screws / bolts until all completely assembled.

Care And Maintenance

- * The Touch of a soft cloth is all the maintenance your wood pieces will ever need.
- * Never use harsh chemicals or abrasive cleaner as they could mark or destroy finish.

Step 1

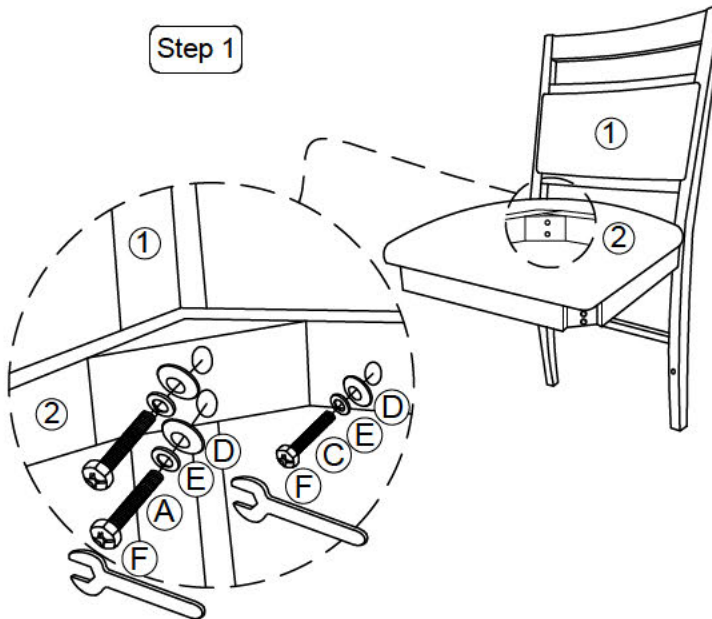

Step 2

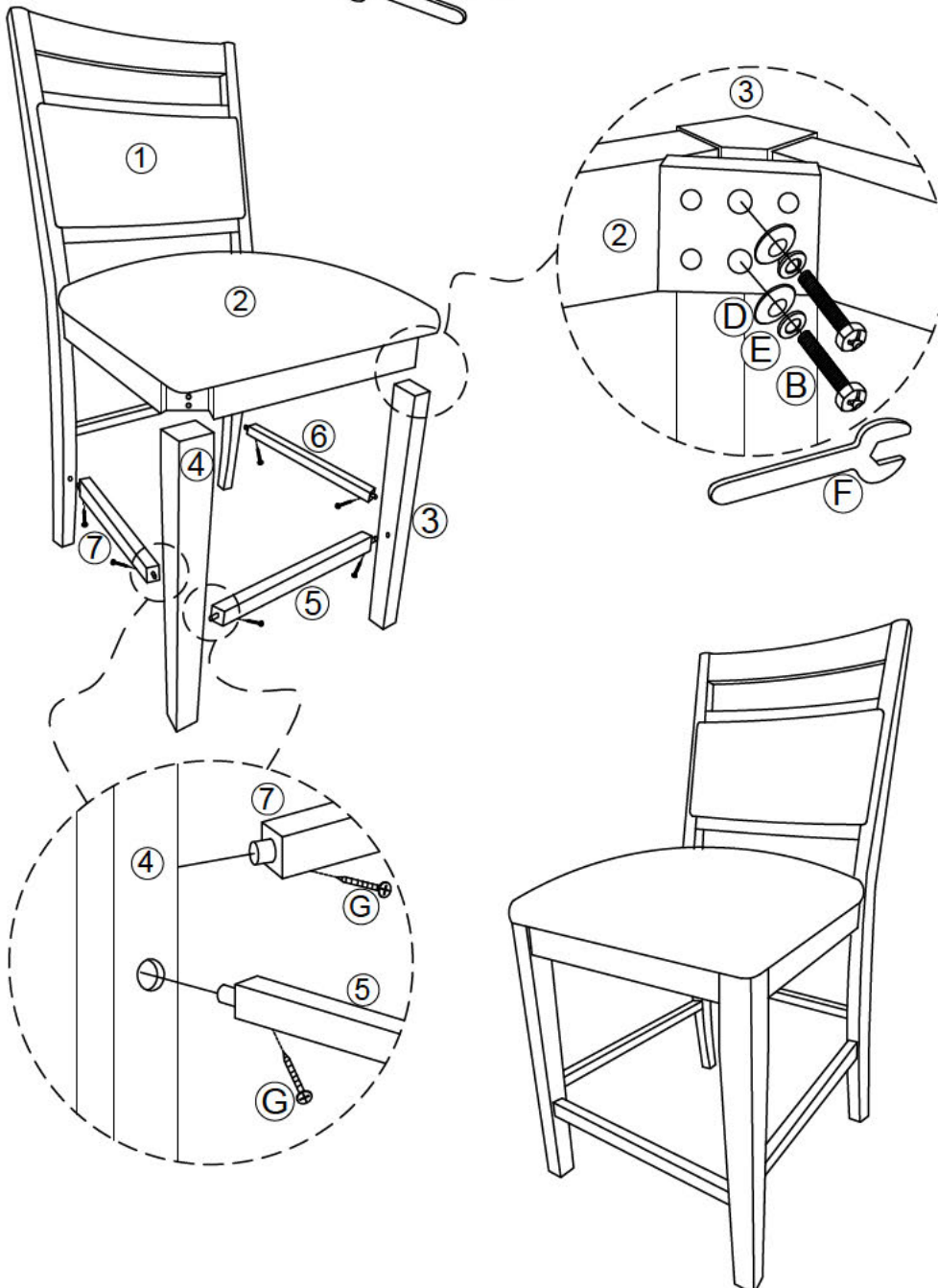

Assembly Completed !!