

ASSEMBLY INSTRUCTIONS

EEI-6158

V1.11.06.23

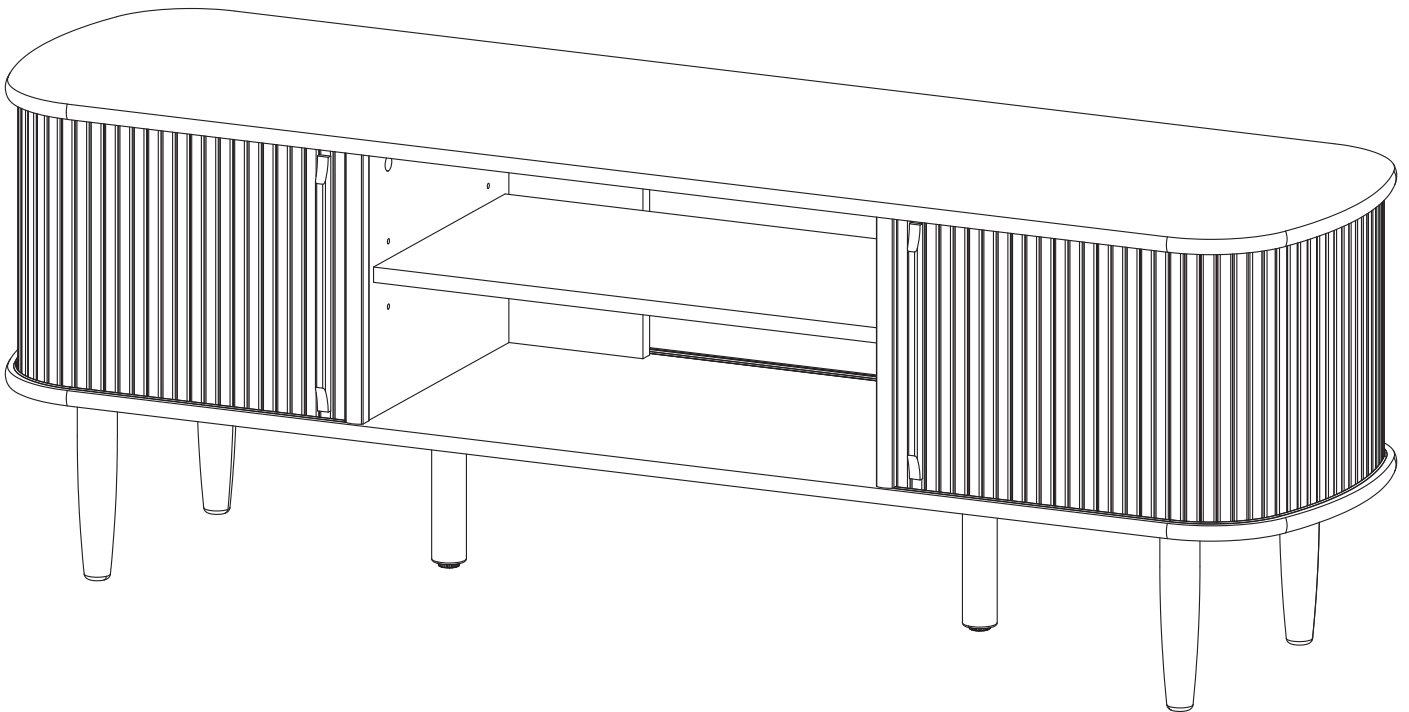

Questions? Contact us!

609.256.9000 • cs@modway.com
www.modway.com

*modway

Let's get started!

*modway



Read through all of the instructions before starting



Care instructions are listed in the last step of this manual



Approx. 60 minutes assembly time



Make sure you have all parts and components before discarding any packing materials



2 people recommended for assembly

Only use hand tools to assemble this item. Do not use power tools. Do not tighten bolts or screws completely until all hardware is lined up and inserted into the holes.

Do not over-tighten screws and bolts to avoid stripping the hardware or cracking the item.

Assemble your item on a flat, carpeted area, with plenty of space to work. This will prevent damage and scratches to your floors or the item while you're assembling the product.

Keep all components and packaging out of reach of children or animals to avoid risk of choking or suffocation.

Furniture components:

1	Top Board	x1
2	Bottom Board	x1
3	Center Board Left	x1
4	Center Board Right	x1
5	Adjustable Shelf	x1
6	Door Sliding	x2
7	Back Board	x2
8	Pillar	x4
LB18C1	Leg	x4
LC16A1	Center Leg	x2

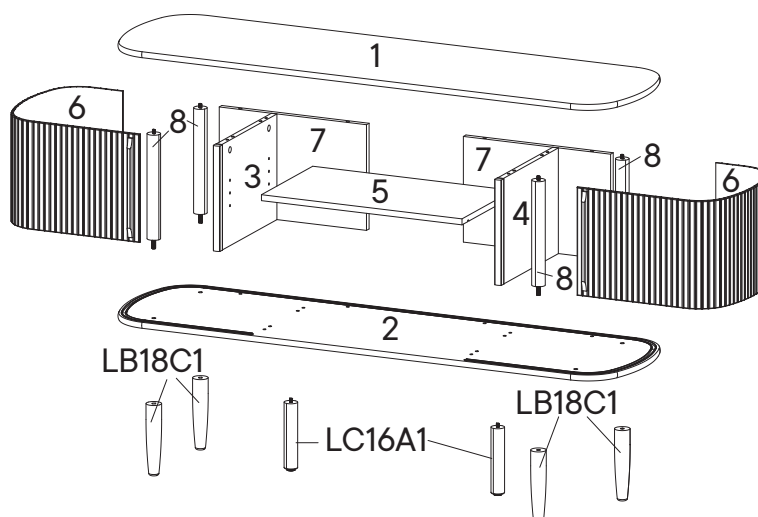

Provided hardware:

A		Cam Bolt Ø6 x 35 mm	x4
B		Cam Lock Ø15 mm	x4
C		Wood Dowel Ø8 x 30 mm	x16
D		Screw M 7 x 50 mm	x4
E		Allen Key	x2
F		Shelf Pin	x4
G		Screw M 4.5 x 12.5 mm	x24
H		Screw Cap Ø15 mm	x4
PM2		Mounting Plate	x2

PM3		Mounting Plate	x4
-----	--	----------------	----

What you need:

	Phillips Head Screwdriver
--	---------------------------

Wait!

Missing parts or hardware? Need assistance?
Contact us before returning your item. We're here to help!
609.256.9000 • cs@modway.com

Step 1

HARDWARE

A	Cam Bolt Ø6 x 35 mm	x4
C	Wood Dowel Ø8 x 30 mm	x16
G	Screw M 4.5 x 12.5 mm	x16
PM3	Mounting Plate	x4

COMPONENTS

1	Top Board	x1
3	Center Board Left	x1
4	Center Board Right	x1
7	Back Board	x2

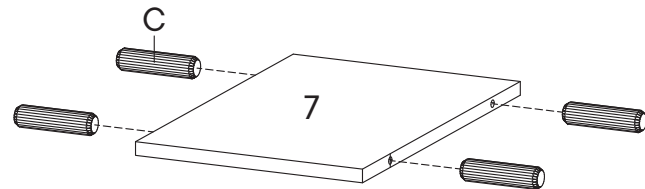
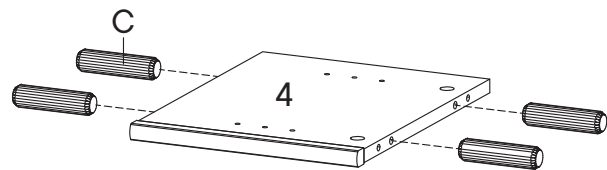
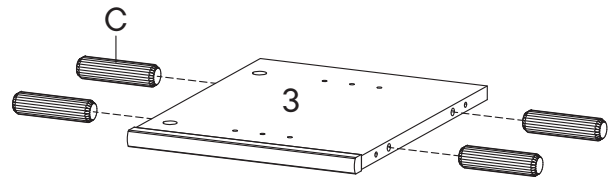

x 2

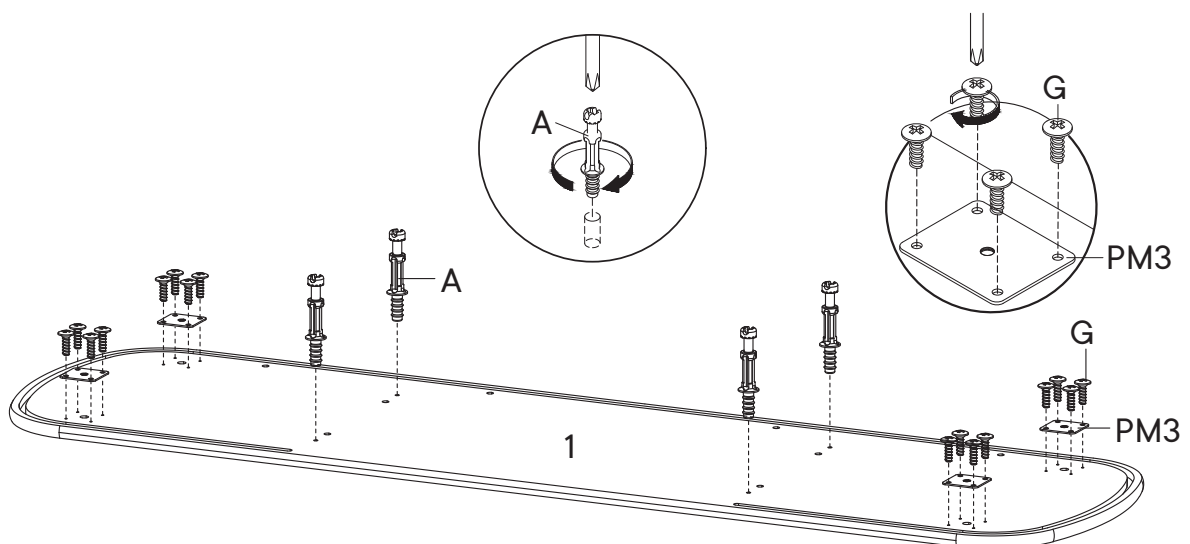

Step 2

HARDWARE

- B** Cam Lock Ø15 mm x4
- H** Screw Cap Ø15 mm x4

COMPONENTS

- 1** Top Board x1
- 3** Center Board Left x1
- 4** Center Board Right x1

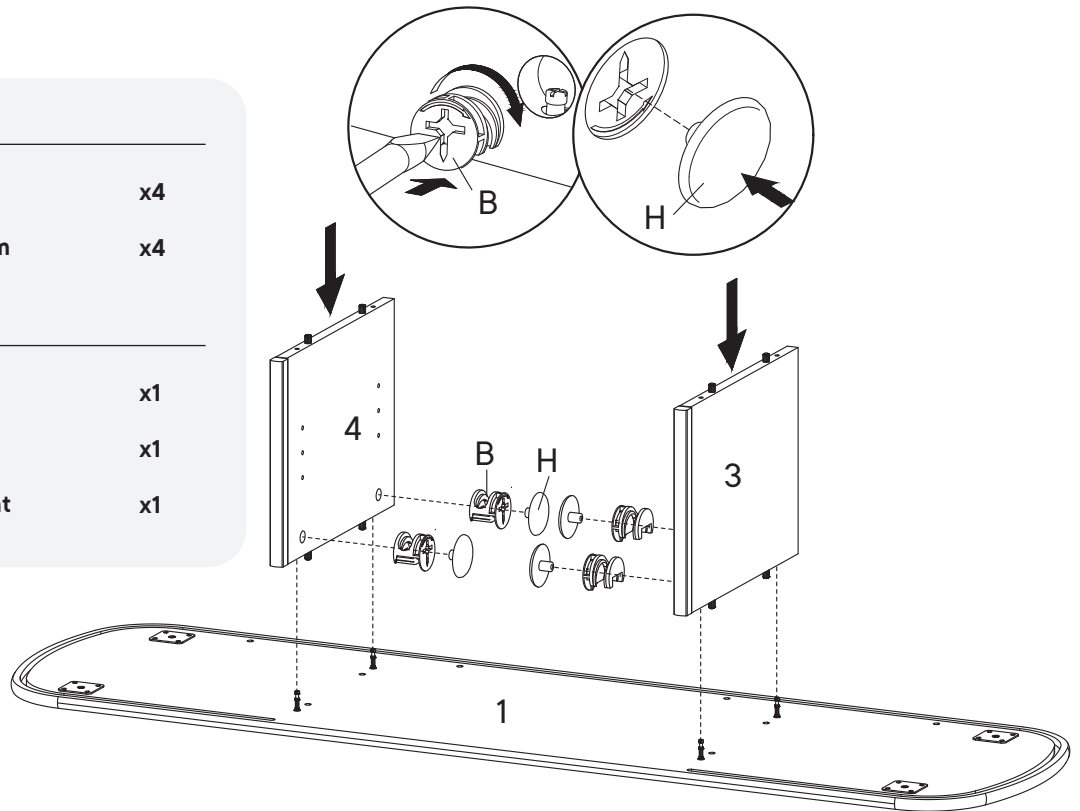

Step 3

COMPONENTS

- 7** Back Board x2

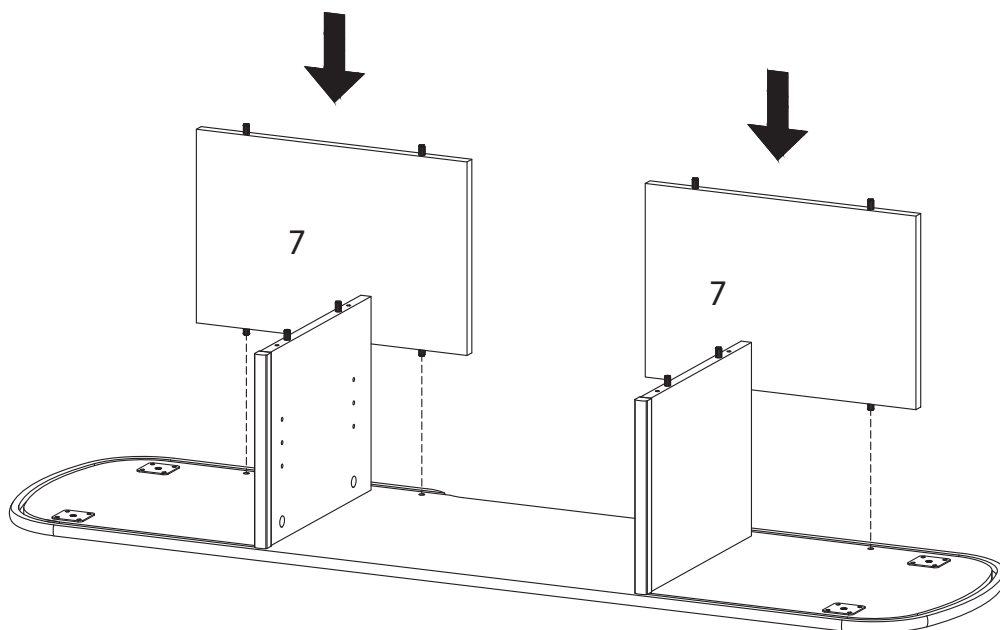

Step 4

COMPONENTS

8 Pilar x4

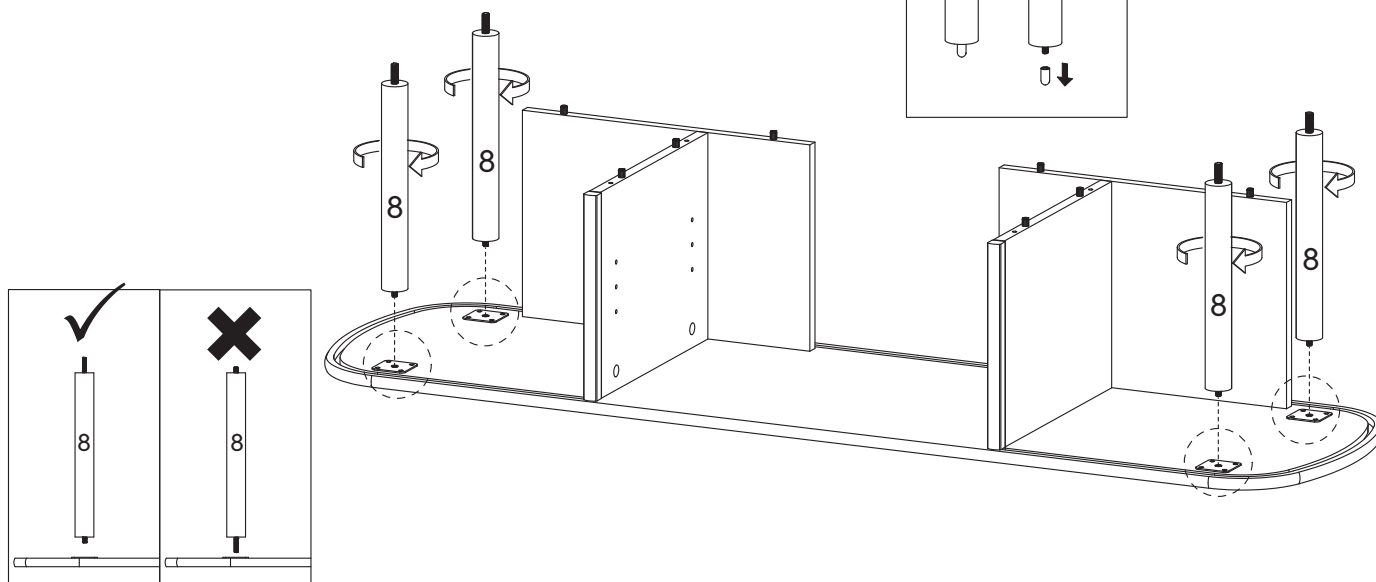

Step 5

HARDWARE

D Screw M 7 x 50 mm x4

E Allen Key x1

COMPONENTS

2 Bottom Board x1

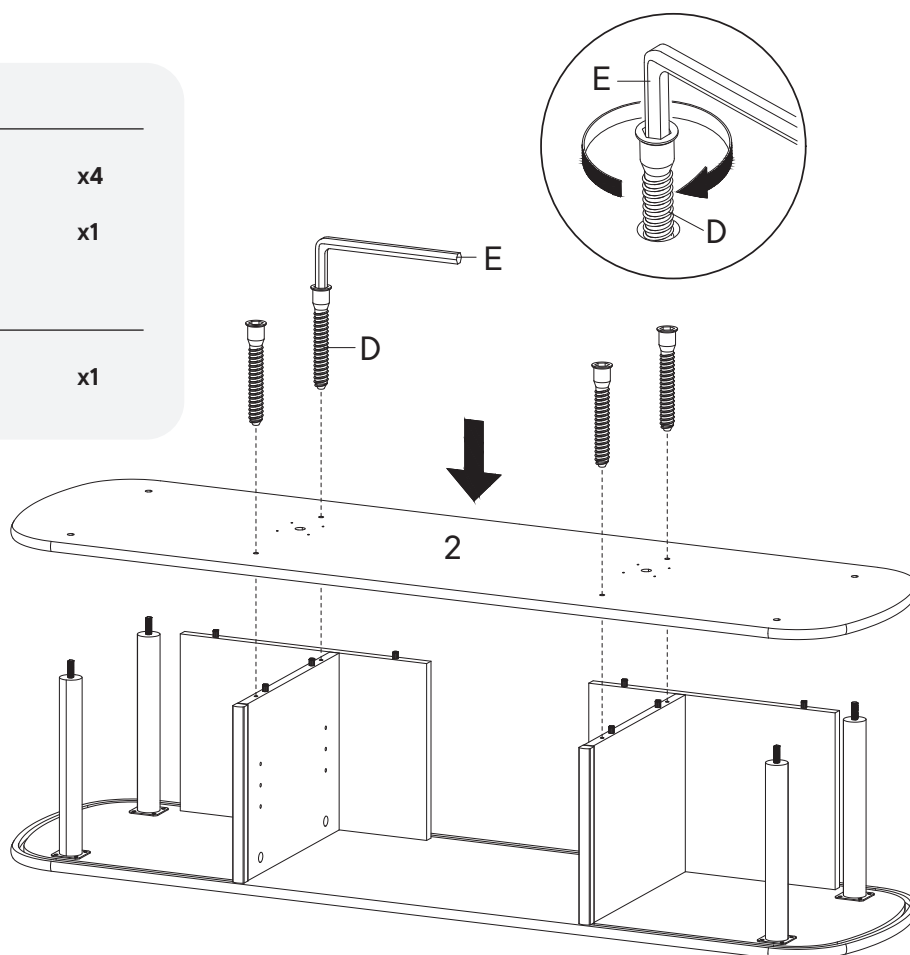

Step 6

HARDWARE

G Screw M 4.5 x 12.5 mm x8

PM2 Mounting Plate x2

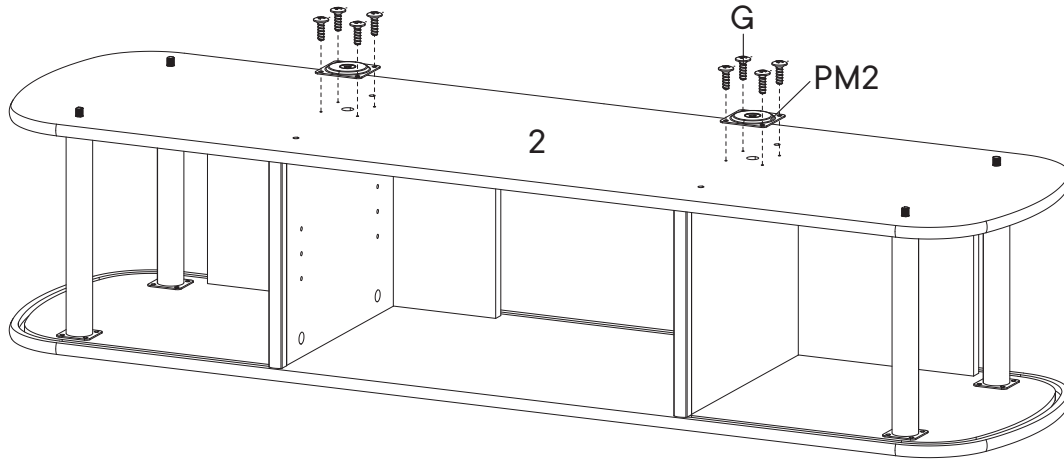
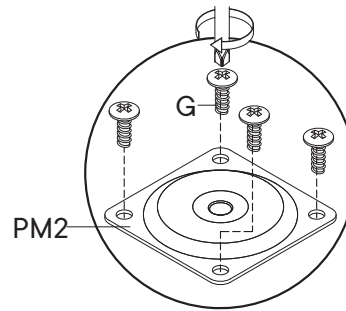

Step 7

COMPONENTS

LB18C1 Leg x4

LC16A1 Center Leg x2

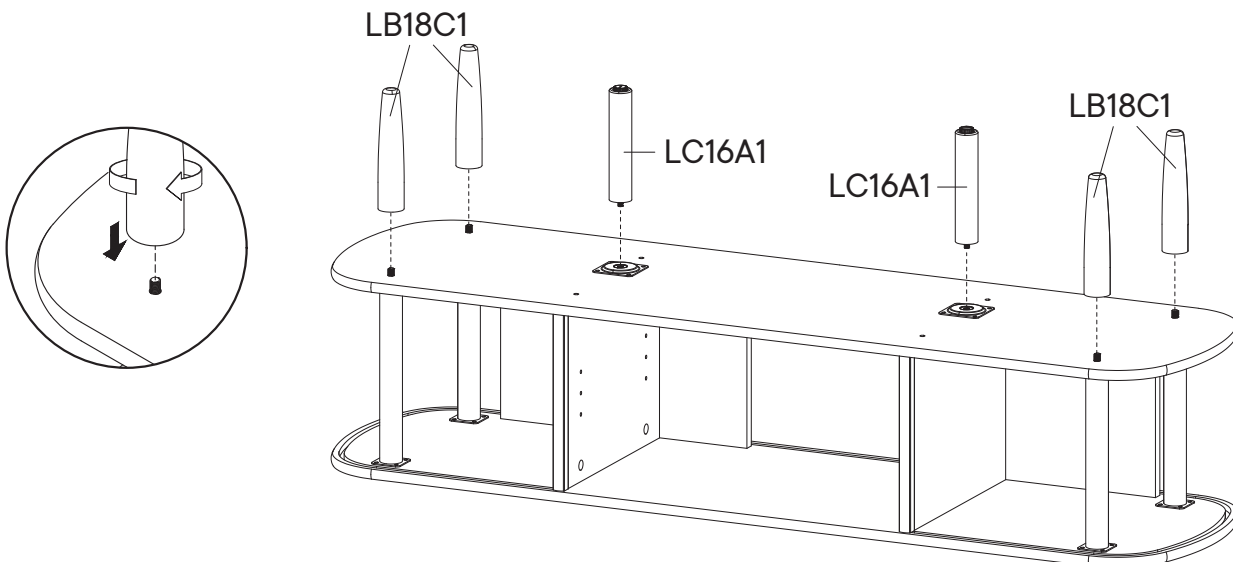
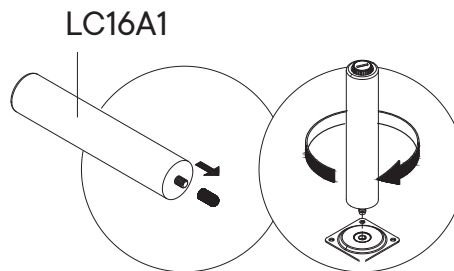

Step 8

COMPONENTS

6

Door Sliding

x1

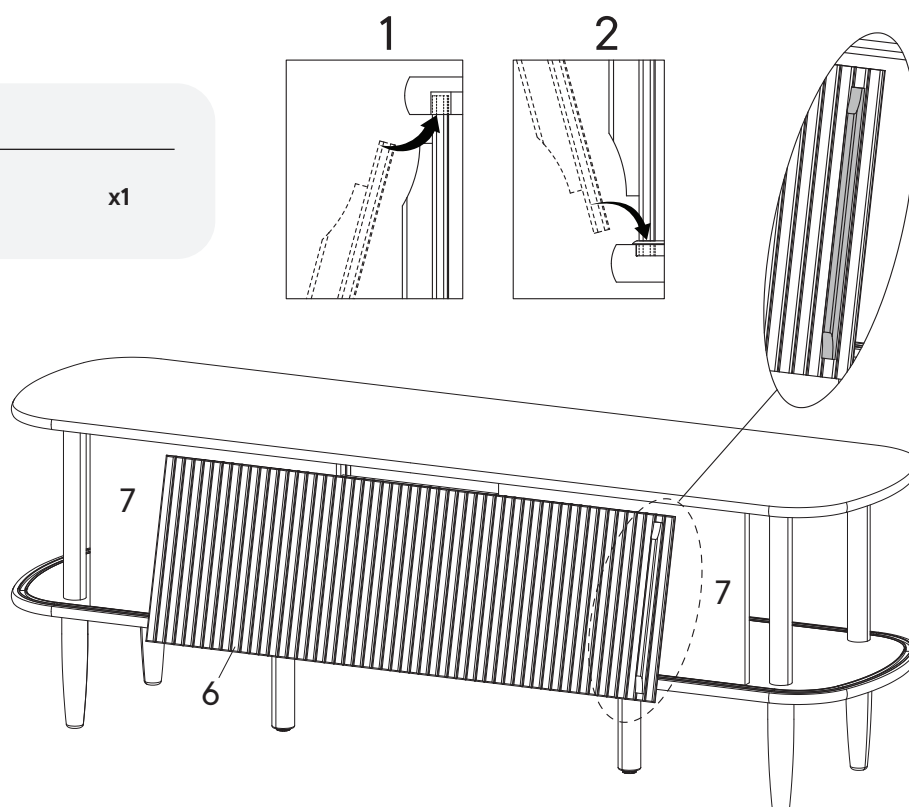

Step 9

COMPONENTS

6

Door Sliding

x1

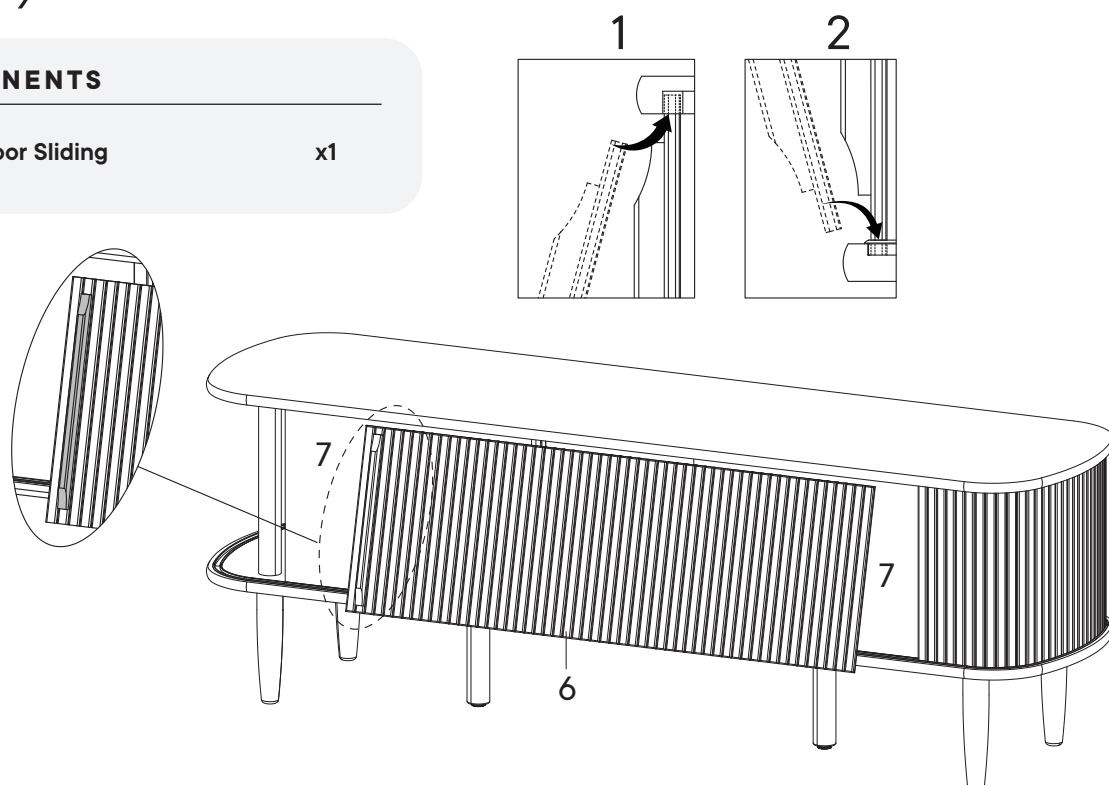

Step 10

HARDWARE

F Shelf Pin x4

COMPONENTS

5 Adjustable Shelf x1

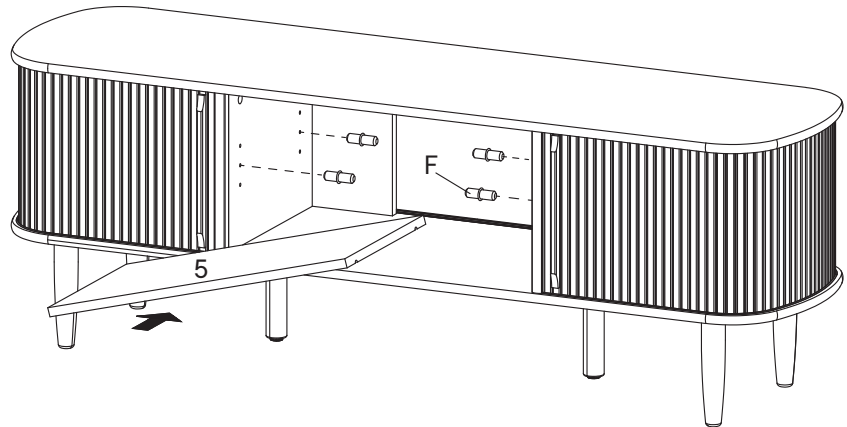
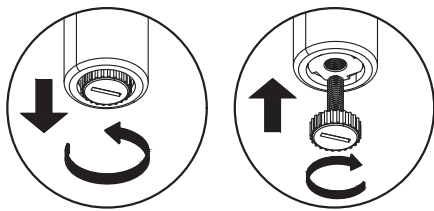
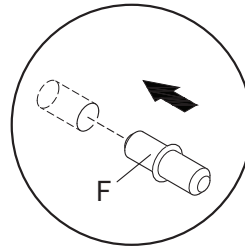

Great job!

TV Stand assembly is complete.

♥ CARING FOR YOUR ITEM

Indoor use only.

Not contract grade.

Clean using a non-abrasive cloth and a mild cleaner.

Never use harsh chemicals, as they could damage the finish or integrity of the item.

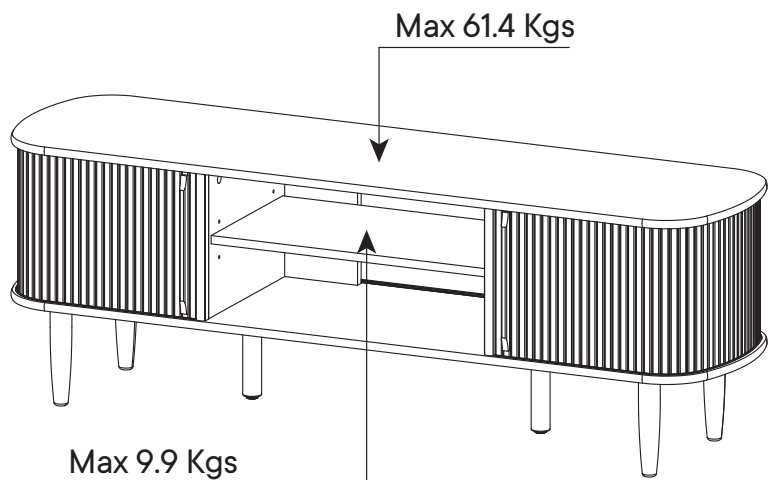

CONNECT WITH US!

Tag us @modway_furniture and #modway for a chance to be featured.