

ALTAIR

www.altairdesignusa.com

Installation Manual for Bathroom Mirror

(Suitable for the products installation by hanging bar or hardy hold)

773028-MIR-MB 773028-MIR-BG

Exploded view

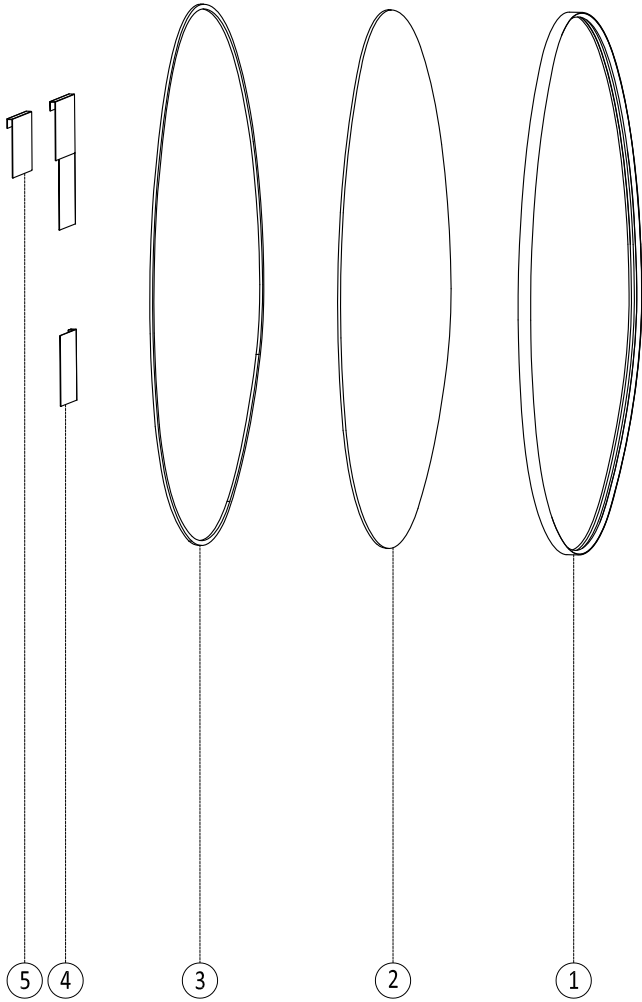

Part	Description
1	Aluminum Frame
2	Mirror
3	EVA
4	Hanging Bracket
5	Hanging Bracket

Hanging bar Installation Manual (Instruction for bathroom mirror)

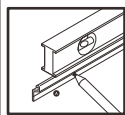

① Horizontal the hanging bar mark with a pen in the hanging bar hole

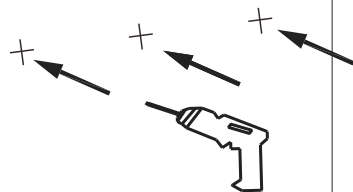
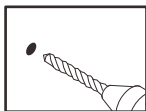

② To use the drill to have the holes

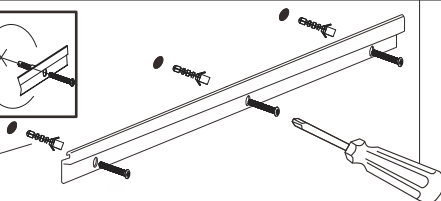
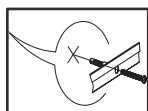

③ (A just apply to the solid wall)
Put the expansion plug into the wall hole both the wall holes and the hanging bar holes are match. To use the screwdriver to make the screw tightly

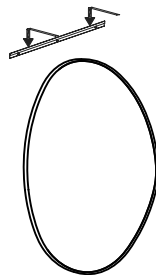

④ Hang up the mirror shake left and right to see if it is stable

Parts list

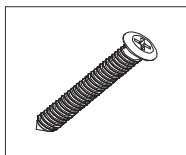

ST4.2 screw

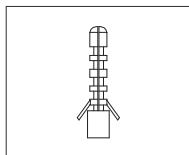

D8 expansion screw

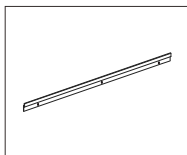

Aluminum hanging bar

Installation tools (as shown below)

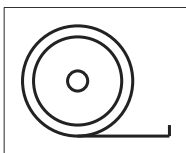

Flexible rule

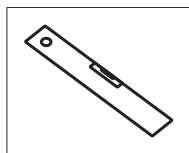

Leveling instrument

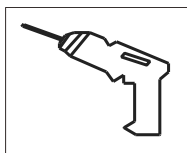

Churn drill

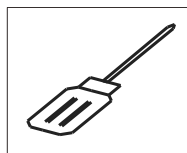

Screwdriver

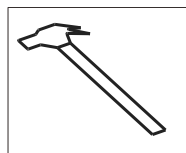

Hammer

Warm tips:

1. Please do not use, if the product have any broken.
2. During operation, never put hard and sharp materials directly against the mirror surface.