

ASSEMBLY INSTRUCTIONS FOR CHEST, DRESSER & NIGHT STAND

REVISION : A

COMPONENT LIST

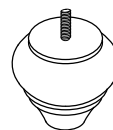

Bun Feet

4 pcs

Note: Take out assembly instructions sheet, hardware pack and feet packaging from the drawer which marked with the rope.

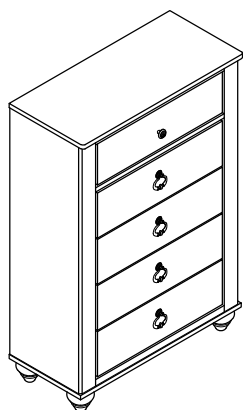

CHEST

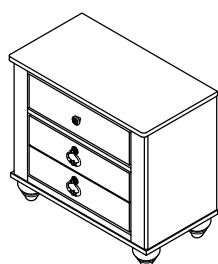

NIGHT STAND

ASSEMBLY COMPLETED

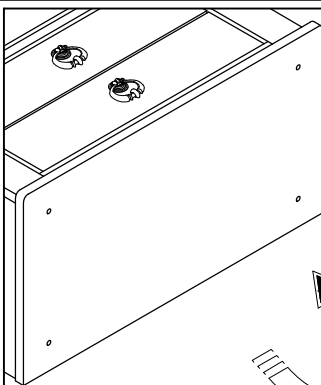

STEP 1

Please lay down the casegoods on the floor.

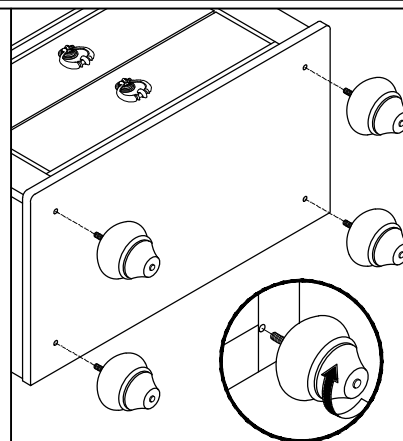

STEP 2

Fasten bun feet to casegoods according to the position with turning the bun feet clockwise until tightly.

REVISION : A

COMPONENT LIST



Bun Feet

4 pcs

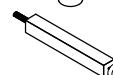

Center Support Leg

1 pc

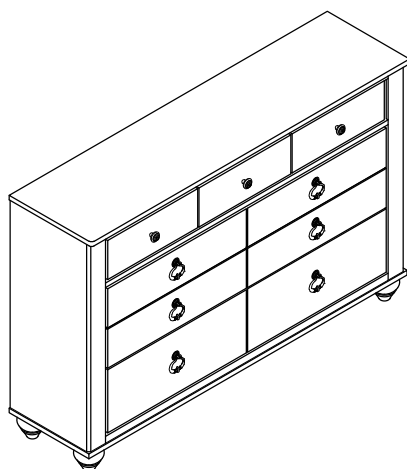

DRESSER

ASSEMBLY COMPLETED

STEP 1

Please lay down the dresser on the floor.

STEP 2

Fasten bun feet to dresser according to the position with turning the bun feet clockwise until tightly.

STEP 3

Align and tighten center support leg to bottom panel of dresser.

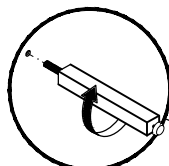

STEP 3

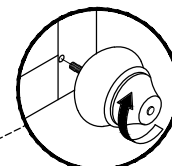
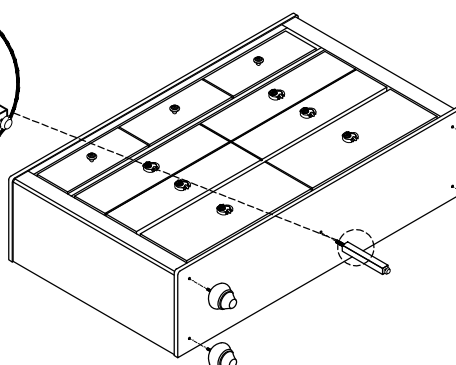

STEP 2

**NOTE : MUST TIGHTEN SCREWS PERIODICALLY WITH USE SCREW WILL BECOME LOOSE.
CHECK TIGHTNESS OF ALL SCREW EVERY 6-8 WEEKS.**