

## Instructions

### NOTE :

1. Please Check whether the accessories are missing in time after unpacking. ( Bulbs not included )
2. We offer 12 months guarantee. If you find any damaged or missing parts in transit, please feel free to contact us by email , we will solve it ASAP!

T1

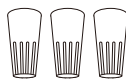

T2



T3



### Tips:

1. Hold the heat gun about 3~6 inches away from the tubing, and keep it moving back and forth.
2. Continue heating the tubing until it is tightly secured to the wire.

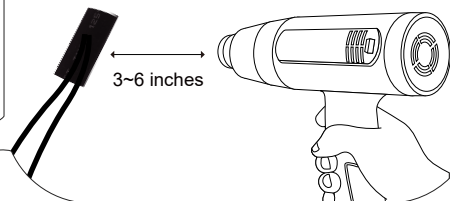

S3



Ground wire



T4

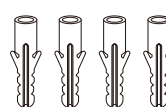

T5

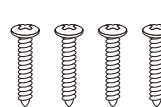

T6

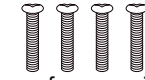

Screws for securing terminal box.

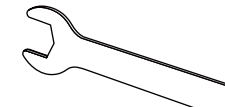

01

- 01 Unscrew the mounting bracket and tighten it inside first.

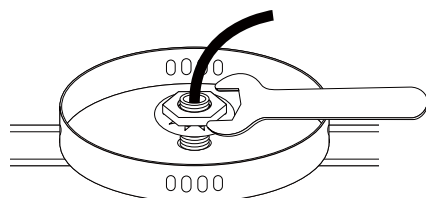

02

- 02 Use T4 & T5 to fix the mounting brackets on the wall. (Please note the direction of the brackets.)

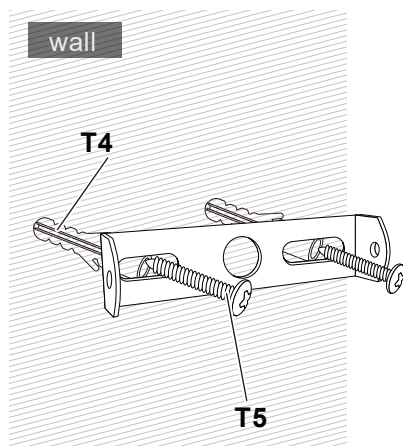

03

- 03 Fixture wires should be connected to wires by color. black wire to be attached to the L wire, white to N and ground wire to ground wire.

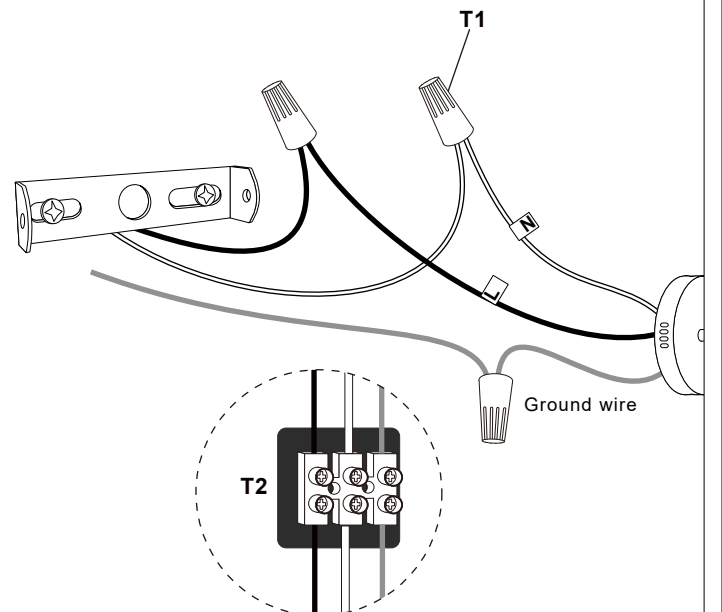

For your safety, you should use wire connector T1, T2 or T3 as you like. If you choose connector T1 you need to use electric tape for it.

04

- 04 Align the holes on the light with the screw holes on the bracket , use S3 to fix the fixture.

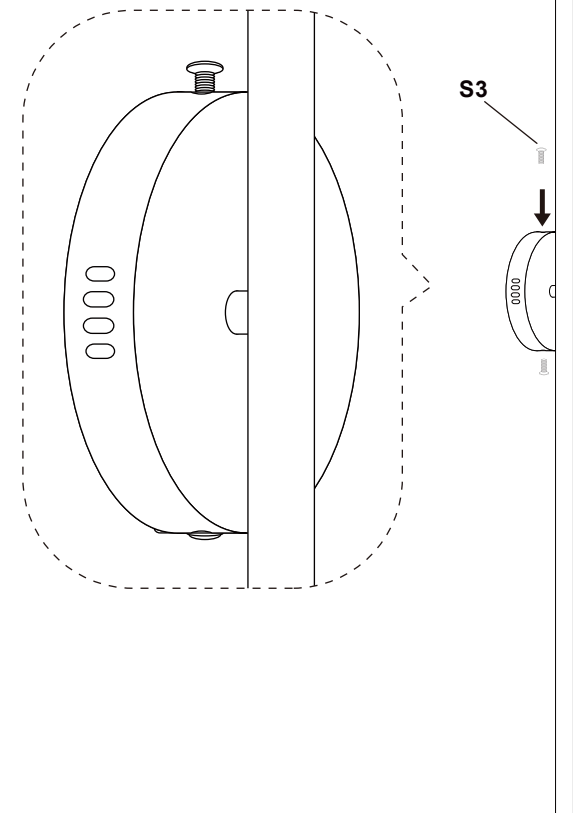

# Wiring Instruction

**T1**

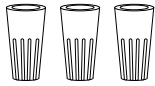

Wire nuts

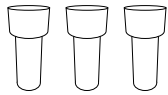

Crimp terminal

**T2**

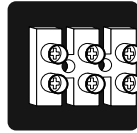

**T3**



**T1**

Wire nuts

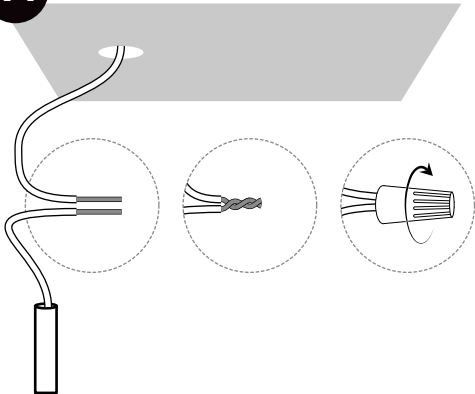

**Tips:**

Screw the twisted electric wire completely into the terminal until it does not loosen.

**T1**

Crimp terminal

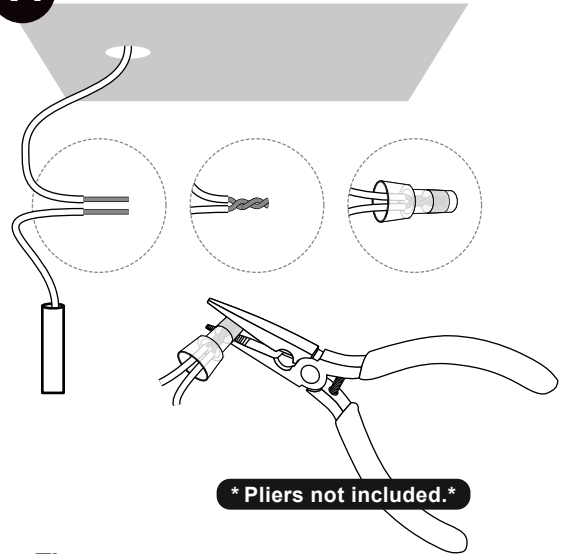

**\* Pliers not included.\***

**Tips:**

Use crimping pliers to ensure the wire are fastened to the terminal.

**T2**

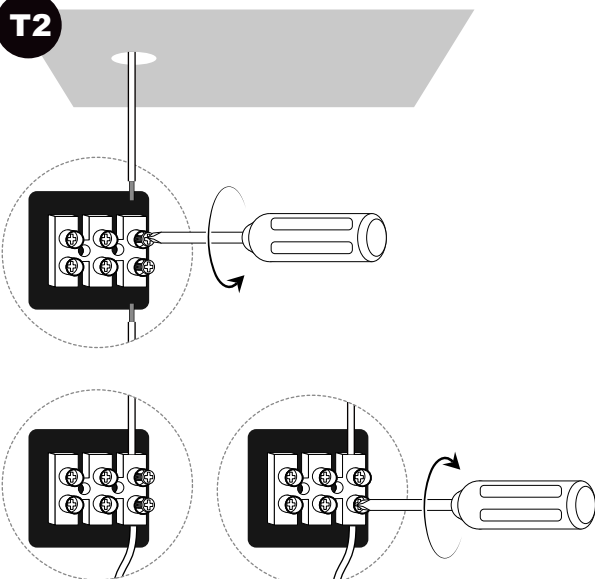

**\* Screwdriver not included.\***

**Tips:**

Loosen the small screw, insert the wire, and tighten the screw.

**T3**

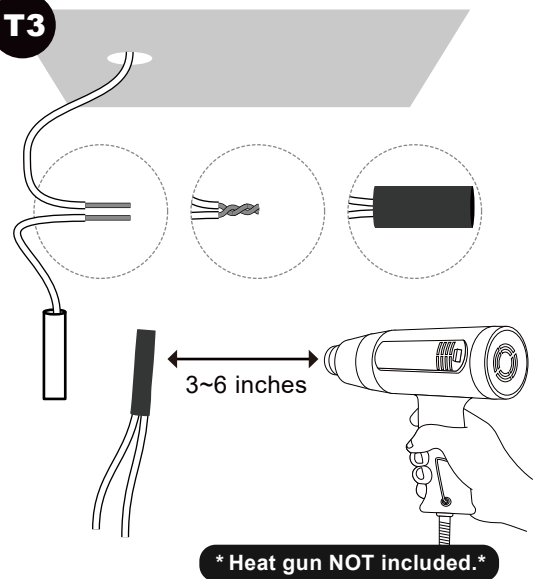

**\* Heat gun NOT included.\***

**Tips:**

1. Hold the heat gun about 3~6 inches away from the tubing, and keep it moving back and forth.
2. Continue heating the tubing until it is tightly secured to the wire.