

# ASSEMBLY INSTRUCTIONS

## bed - king

+ Do Not Use Power Tools

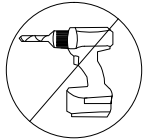

+ Suggested Adults

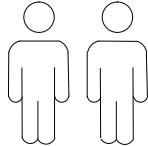

NOTE:

- 1 Read instructions cover to cover.
- 2 Save all packaging until assembly is completed.

### 1 IMPORTANT SAFETY INFORMATION

Do not assemble the product if any of the following parts arrived damaged:

- Part #③ -Side Rails
- Part #⑤ -Center Support Bar
- Part #⑥ -Support Legs
- Part #⑦ -Slats

### 2 IMPORTANT ASSEMBLY INFORMATION

Assembly Step ③ Ensure the side rail bracket is fully hooked onto bolt **A** loosely threaded with both washers on the **OUTSIDE** of the bracket first, then proceed to fully tightening all 4 corners.

Assembly Step ⑥ When installing slats, ensure that the curve is facing upwards. (↖) (↘)  
 \*Slats come packed in the bottom of headboard carton.

### + Parts Included

① Head Board (1pc)

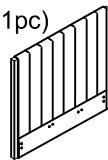

② Foot Board (1pc)

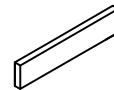

③ Side Rails (2pcs)



④ Double Plastic cap (30pcs)



⑤ Center Support Bar (2pcs)

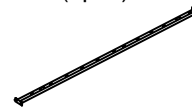

⑥ Support Legs (4pcs)

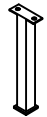

⑦ Slats (45pcs)

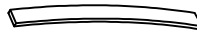

⑧ Single Plastic cap (30pcs)



⑨ Legs (4pcs)

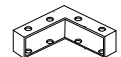

\*Slats come packed in the bottom of headboard carton.

### + Hardware Included

A Bolt M8\*30mm (24pcs)



B Bolt M6\*75mm (8pcs)



D Spring Washer (8pcs)



E Flat Washer  $\phi 20$  (24pcs)



F M8 Allen Key (1pc)



H M6 Allen Key 1pc



I Nut M8\*13mm (8pcs)



J Spanner (1pc)



# ASSEMBLY INSTRUCTIONS

## bed - king

