

Guidelines

FAILURE TO FOLLOW THESE WARNINGS
WHEN IN USE COULD RESULT IN INJURY

- Do not stand on the item or use as a step ladder
- Do not use this item unless all bolts and screws are firmly secured and fastened.
- Check all bolts and screws every 90 days. As necessary tighten if any are loose.
- Lift up then move. Pushing over or dragging this product can result in an injury or cause damage to the floor and piece.

WARNING:

DO NOT LET CHILDREN PLAY IN OR AROUND
THE UNIT DUE TO THE POSSIBLE RISK OF INJURY.

Pre-Assembly Preparation:

Please read through this instruction booklet before
beginning assembly of this item.

Two adults are recommended for assembly.

- Clear out the space for assembly and lay out all parts on Parts List, extra room will allow you to easily determine if all the pieces are present.
- Save all packing materials until assembly is complete to avoid accidentally discarding smaller parts or hardware.
- Keep small parts and pieces away from children and pets until fully assembled.
- Please check for any loose screws and tighten them before you use.

Parts List

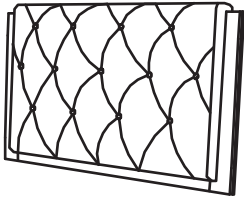

A Headboard (1)

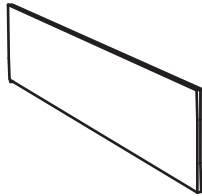

B Footboard (1)

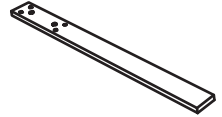

C Headboard Leg (2)



D Bed Slats (4)

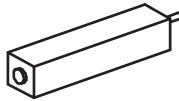

E Bed Slats Support (4)



F Side Rail (A) - Left (2)



G Side Rail (B) - Right (2)



H Bed Side Rail Leg (2)

Parts List



- 1 JCBC (12)
M6x35mm



- 2 Spring Washer (12)
1/4" Rbw



- 3 Flat Washer (12)
1/4"IDx13mmOD Blk



- 4 Allen Key (1)
m4x65mm Blk



- 5 Allen Key (1)
m5x65mm Blk



- 6 Flat Head Chipboard
Screw (16)
m4x32mm Rbw

Step 1

Attach the Headboard Leg (C) to the Headboard (A) with JCBC Bolts (1), Spring Washers (2) and Flat Washers (3). Use the Allen Key (4) to secure the bolts. Use Flat Head Chipboard Screws (6) to secure the headboard legs to the headboard.

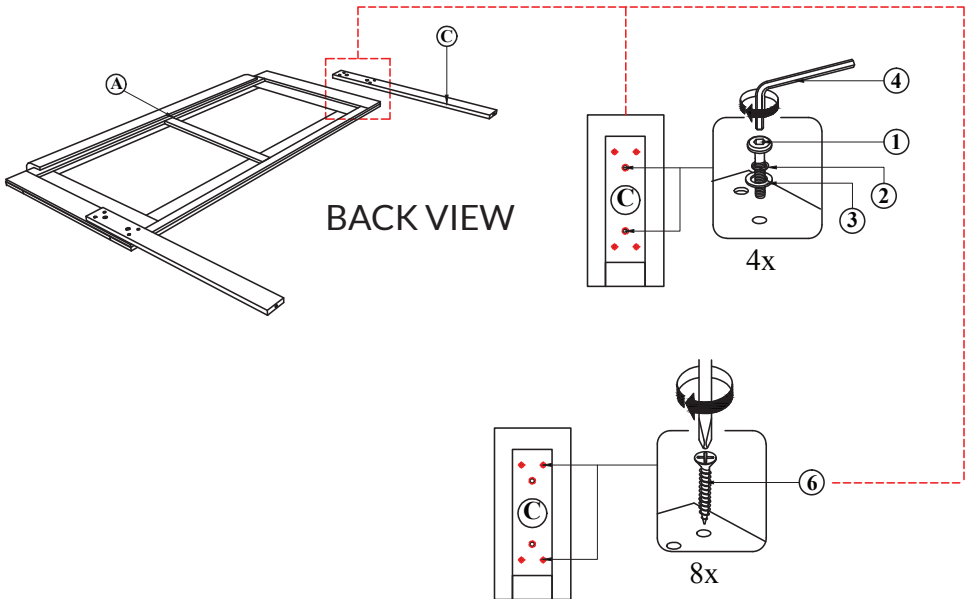

Step 2.1

Attach the Side Rails (F) and (G) to the Bed Side Rail Leg (H) as shown using JCBC Bolts (1), Spring Washers (2) and Flat Washers (3). Use the Allen Key (4) to secure the bolts.

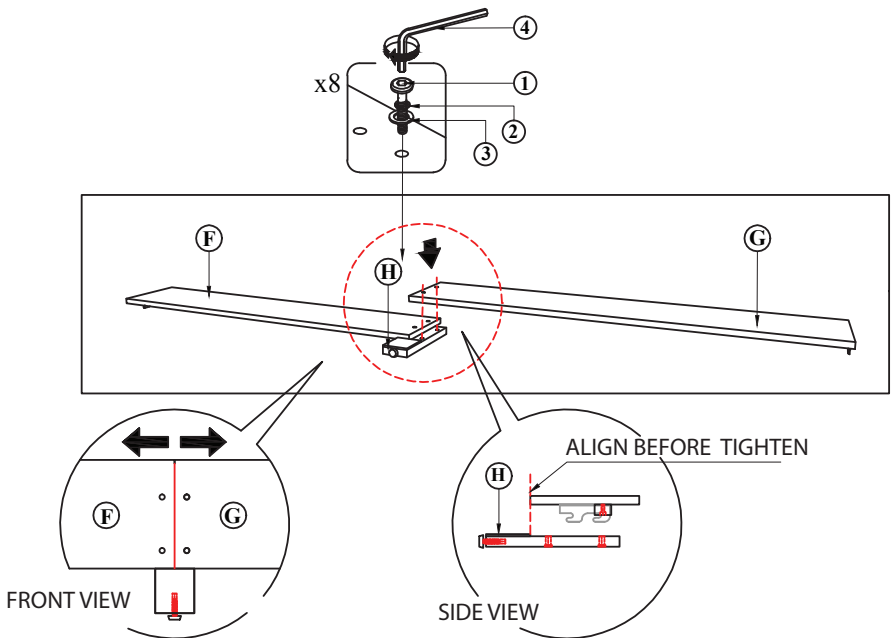

DO NOT FULLY TIGHTEN SCREW
IN THIS STEP BEFORE ALIGN
THE SIDE RAIL AS SHOWN.

Step 2.2

Hook the Side Rails to the headboard and push down to fit into place.
Repeat this step to attach the side rails to the Footboard (B).

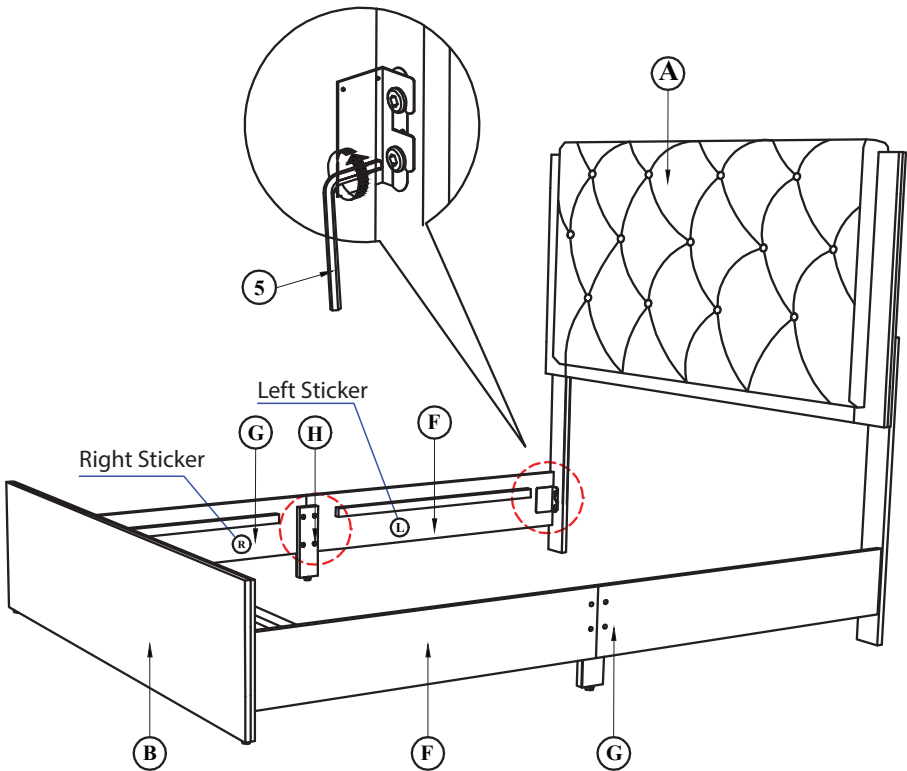

Step 3

Tighten the four corners of the bed by using the Allen Key (5). Attach the Bed Slat Support Leg (E) to the Bed Slat (D) as shown. Install the bed slat into the Side Rails (F) and (G) and tighten with Flathead Chipboard Screws (6) as shown in the diagram. (NOTE: THE BED MUST BE ASSEMBLED AS SHOWN TO ACHIEVE PERFECT STABILITY).

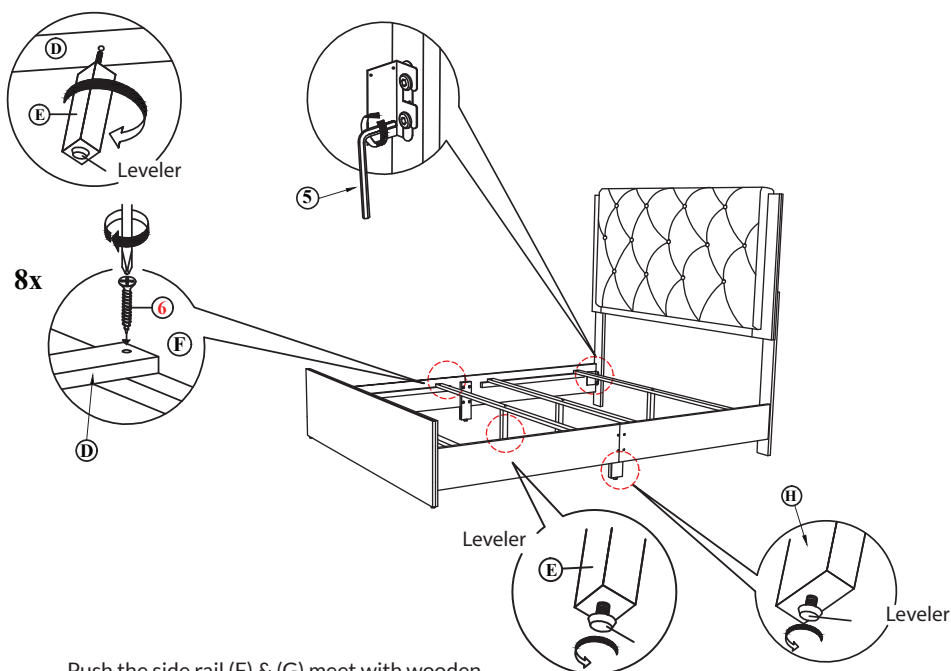

Push the side rail (F) & (G) meet with wooden slat (D) and fix the CSK screw (6) by using the Screw Driver.

Note : Must tighten screws periodically. With use, screws will become loose.
Check tightness of all screws every 6-8 weeks.

Product Dimension

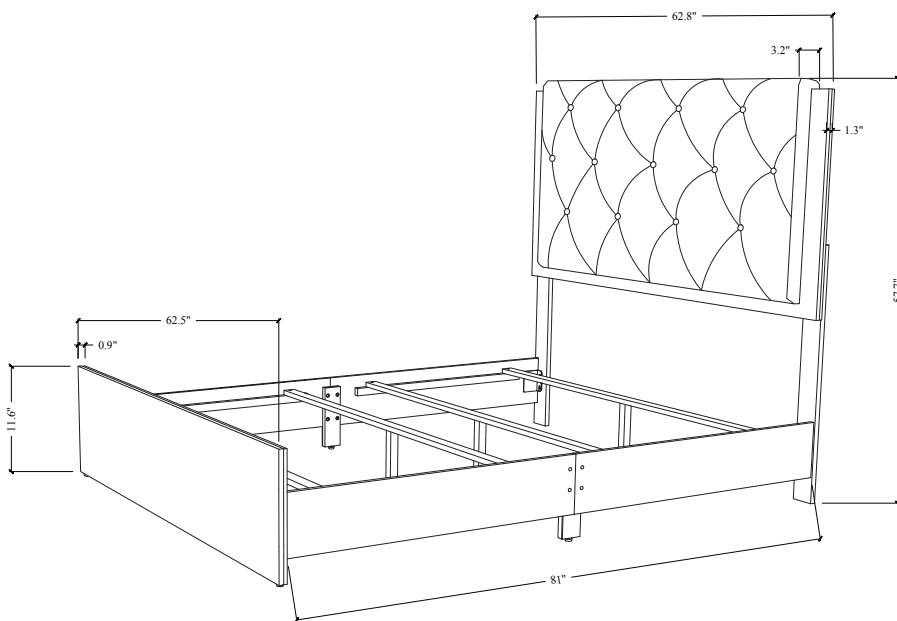

Limited Warranty

The products are warrantied against defects in material and workmanship while owned by the "Original Purchaser". The term "Original Purchaser" is defined as the party or entity which purchases this furniture from an authorized retailer as shown by the original sales receipt. This warranty does not apply to "as is" or previously owned products.

The warrants its products to be free from defects in materials and workmanship (normal wear and tear, fading and stretching excepted), for one year from the date of purchase, except as provided below under the limited warranty. The exceptions or exclusions to this warranty are as follows:

1. Any warranty claim that is submitted after the limited warranty period, or without proper proof of purchase will not include the cost of parts, labor, or delivery.
2. This warranty shall not apply to the products which have been subjected to misuse, neglect, alteration, modification, or attachments, either caused by the Original Purchaser, shipping, storage, accident, fire, flood, or acts of God.

In the event of a defect in material or workmanship covered by this warranty, We will repair or replace, at their discretion, without charge the warrantied parts within a reasonable amount of time. We reserve the right to require damaged parts be returned to us upon request. Natural markings such as scars, brands, grain variations, wrinkles, color variations, etc. will be considered normal characteristics and not construed as defects.

For claims or questions concerning this warranty, please contact customer service department. Be prepared to provide your name, address, daytime phone number, the model and purchase order number of the product, date of purchase, and the website where it was purchased. We requires that the original sales receipt be submitted with all requests to confirm that you are the Original Purchaser according to our written warranty.

This warranty gives you specific rights, and you may also have other rights, which vary from state to state (or country to country). All warranties are limited to the Original Purchaser for normal use.