

# Assembly Instructions for **Model 2201924633**



## Precautions Before Assembly:

Expansion Screw Installation Tutorial

# INSTRUCTIONS

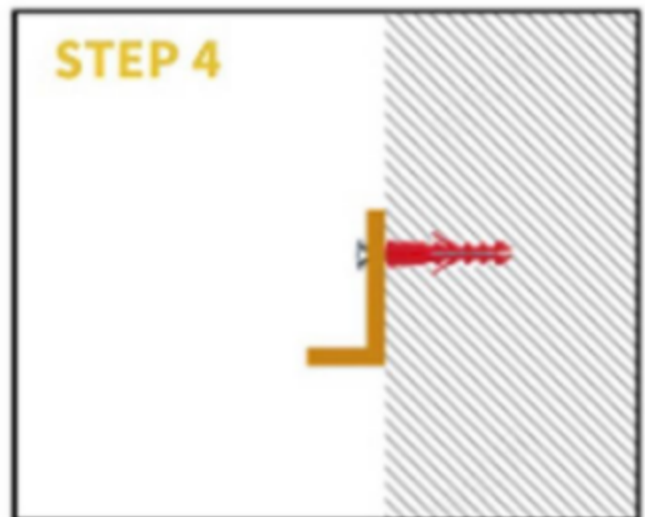
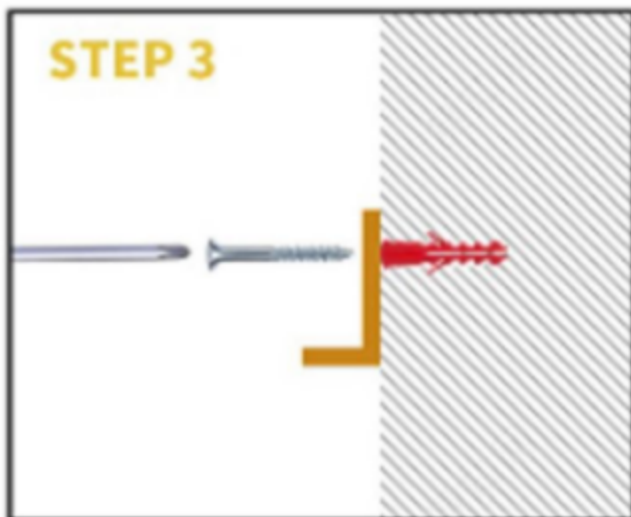
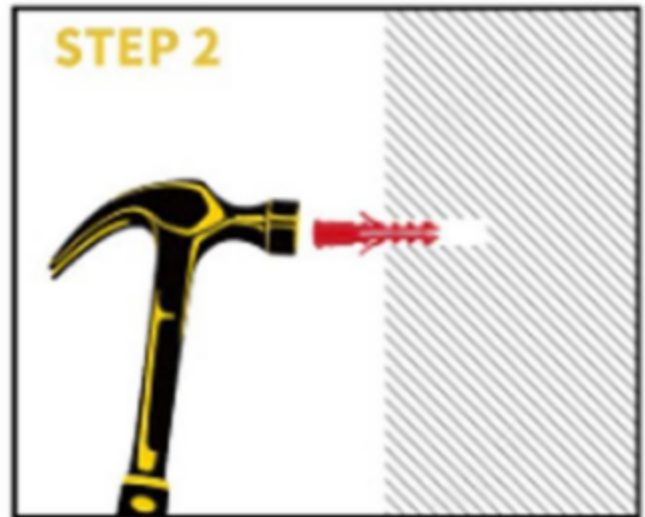

## Assembly Method

The following tutorial is for reference only.

1. Remove the Mounting Bracket from ceiling canopy of Fixture Body.

Mark the drilling position on ceiling with the help of the Mounting Bracket.

Drill holes on the marks and stick the expansion anchors into the holes.

Fix the Mounting Bracket to the expansion anchors with self-tapping screws.



2. Secure the lamp arm (with the lamp head) to the ceiling plate using the provided nuts.



3. Place the light fixture close to the wall.

Connect the hot wire to one of the two wires on the body of the light fixture.

Connect the neutral wire to the other wire on the body of the light fixture.

4. Install the Backplate onto the mounting brackets.



5. Unscrew the retaining ring from the lamp holder, mount the lampshade onto the holder, and then screw the ring back on to secure the lampshade.

The installation is complete.

Your fixture is now assembled and ready to use.