

Combo Shower System

INSTALLATION INSTRUCTIONS

What's in the package.



Handheld Shower Head x 1
Water Regulator x 1



Washer x 1
Water Regulator x 1
Fixed Showerhead x 1



Shower Hose x 1
Washer x 2



3-Way Diverter x 1



Teflon Tape x 1

① Remove old showerhead.



② Wrap Teflon tape clockwise a few rounds to cover the shower arm threads.

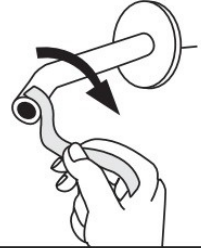

③ Attach 3-way diverter to the shower arm by rotating hex nut clockwise by hand.

Cover the hex nut with a cloth to avoid scratch.

Lightly snug the hex nut with a wrench to make sure

1. Hex nut is fully tightened.
2. 3-way diverter is firmly connected to the shower arm.

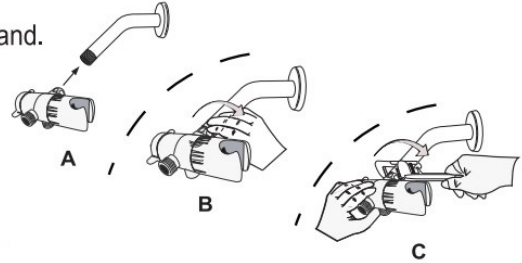

④ Ensure a washer is in the ball joint of the fixed showerhead.

Attach the fixed showerhead to the 3-way diverter by turning clockwise.

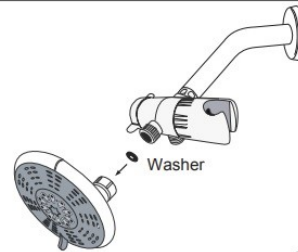

⑤ Ensure a washer is in the hose HEX NUT.

Connect HEX NUT to the DIVERTER.

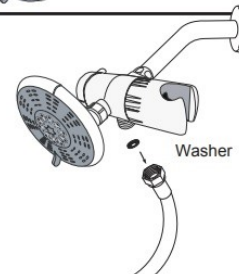

⑥ Ensure a washer is in the hose CONICAL NUT.

Connect CONICAL NUT to the HANDHELD SHOWER HEAD.

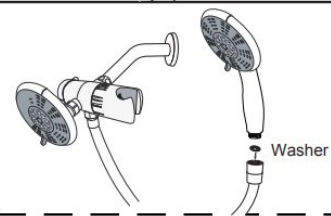

⚠ DO NOT apply BOTH the **water regulator and **washer** at the same time for handheld shower head.**