

# ASSEMBLY INSTRUCTIONS

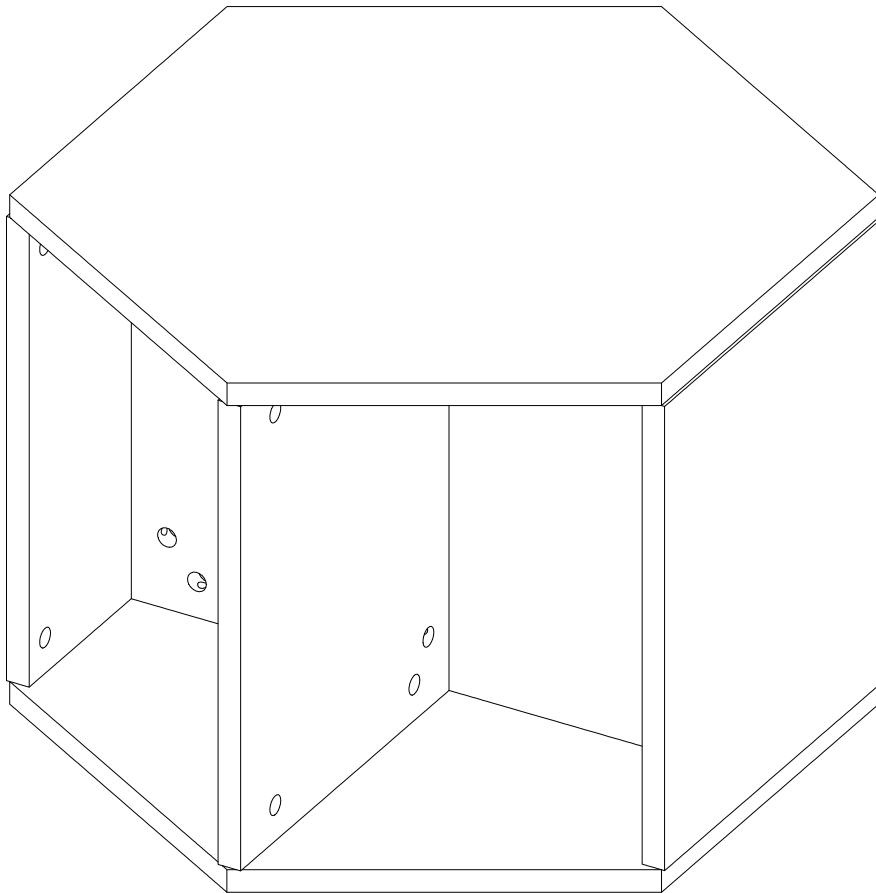

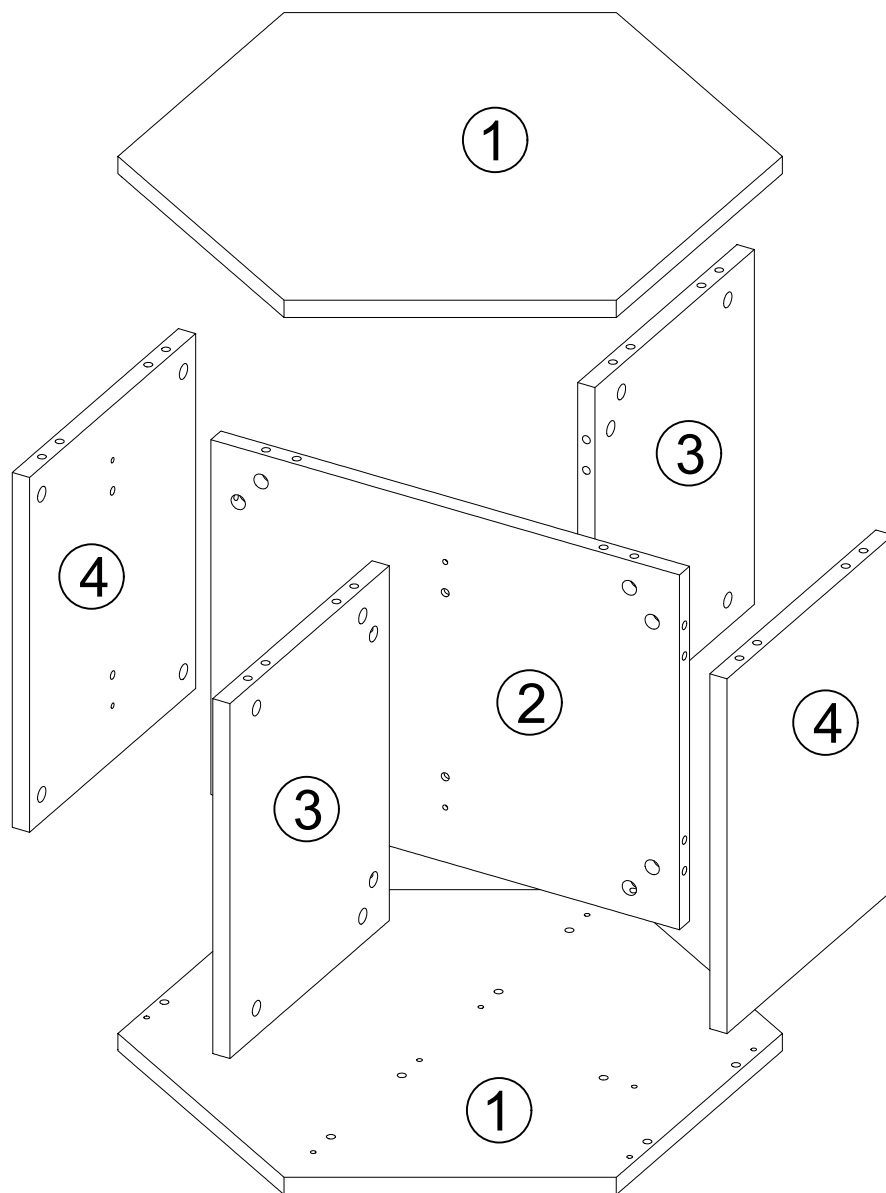

1

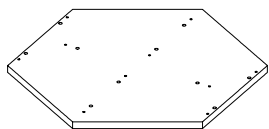

x2

2

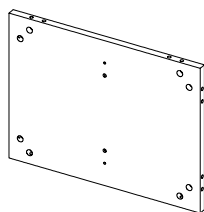

x1

3

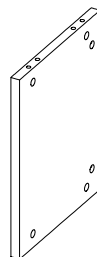

x2

4

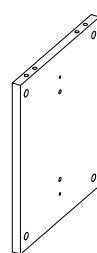

x2

A

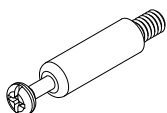

x28

B

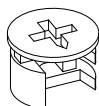

x28

C

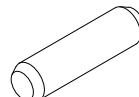

x24

D

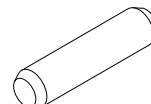

x2

# SPECIAL TIPS FOR FITTING CAM-LOCKS AND QUICKFIT

DON'T FULLY TIGHTEN THE SCREWS BEFORE FINISHING ASSEMBLY, ONLY TIGHTEN THEM 80% TO ENSURE THE CAM-LOCK DO NOT DROP OUT.

NOTE: AFTER ASSEMBLY, PLEASE MAKE SURE THAT ALL SCREWS ARE 100% LOCKED.

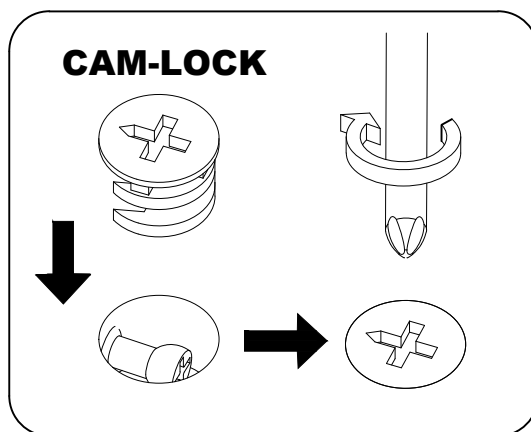
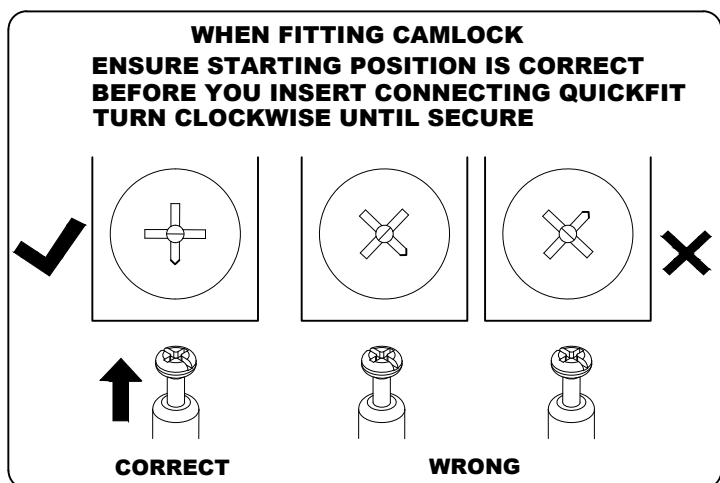

**Quickfit head needs to be in centre**

## QUICKFIT

**Tighten until shoulder is flush with panel. DO not overtighten or undertighten (see example below)**

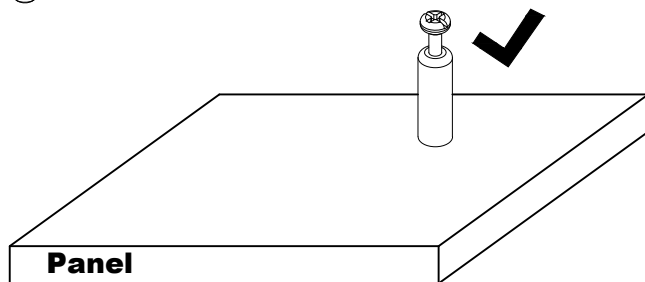
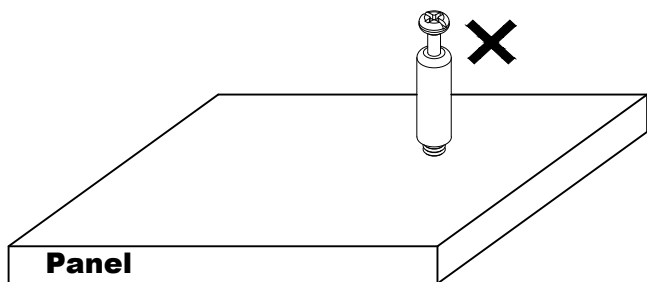
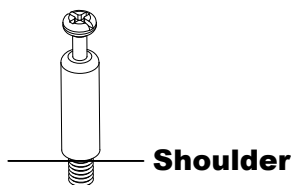

## ATTENTION

**When installing the screw, it should be kept perpendicular to the board surface and should not tilt to the left or right, otherwise it will affect subsequent installation.**

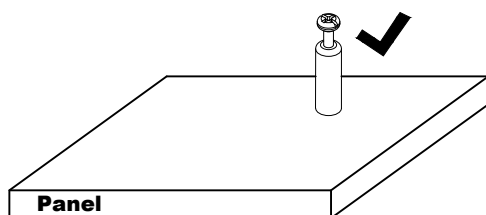
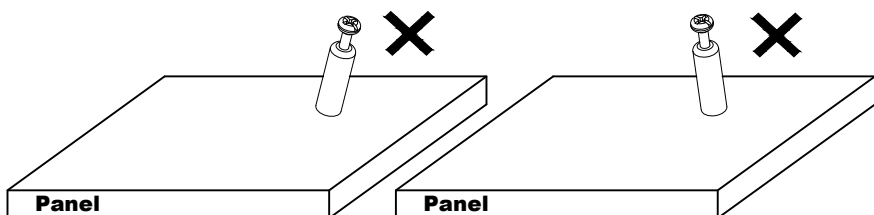

STEP:1

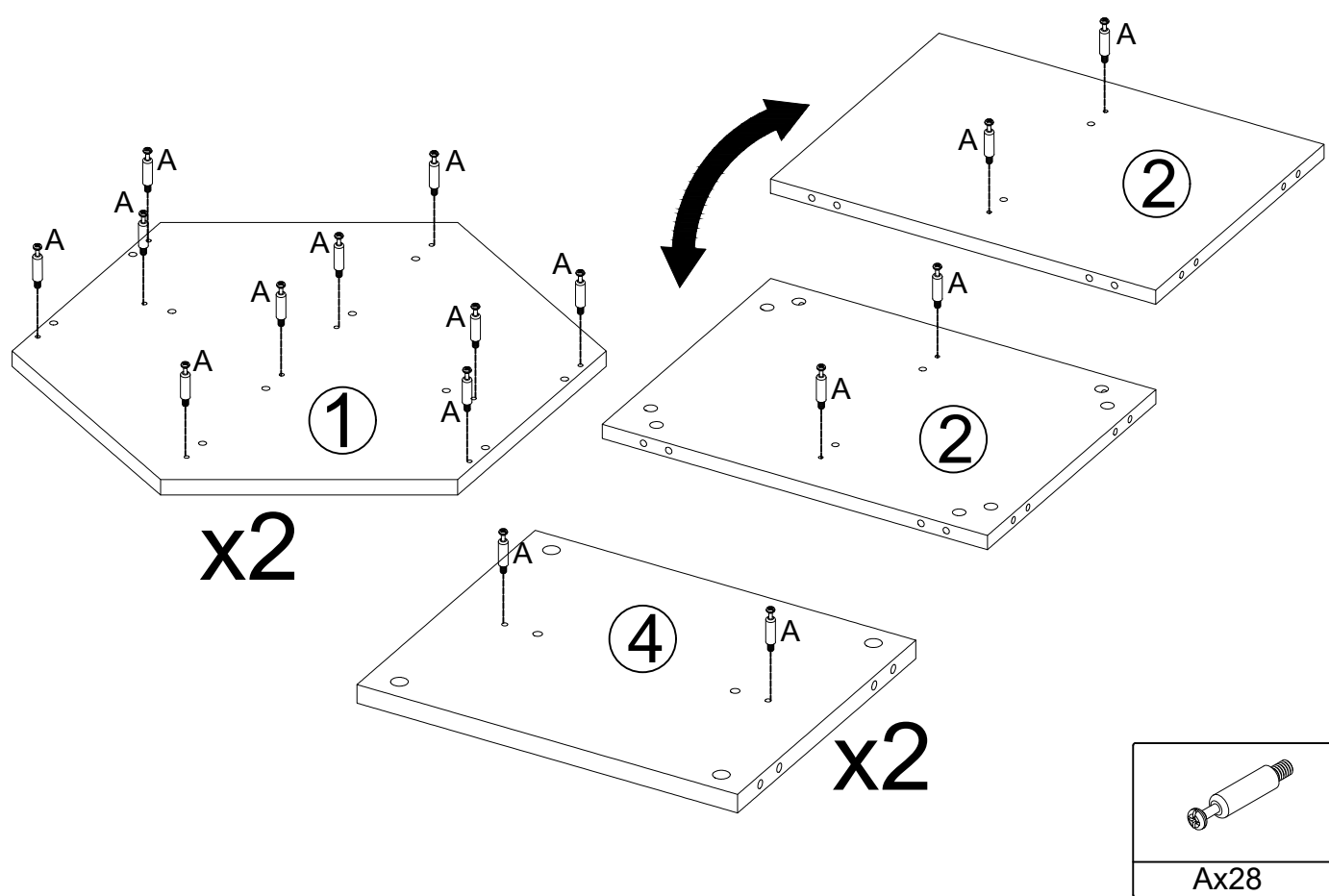

STEP:2

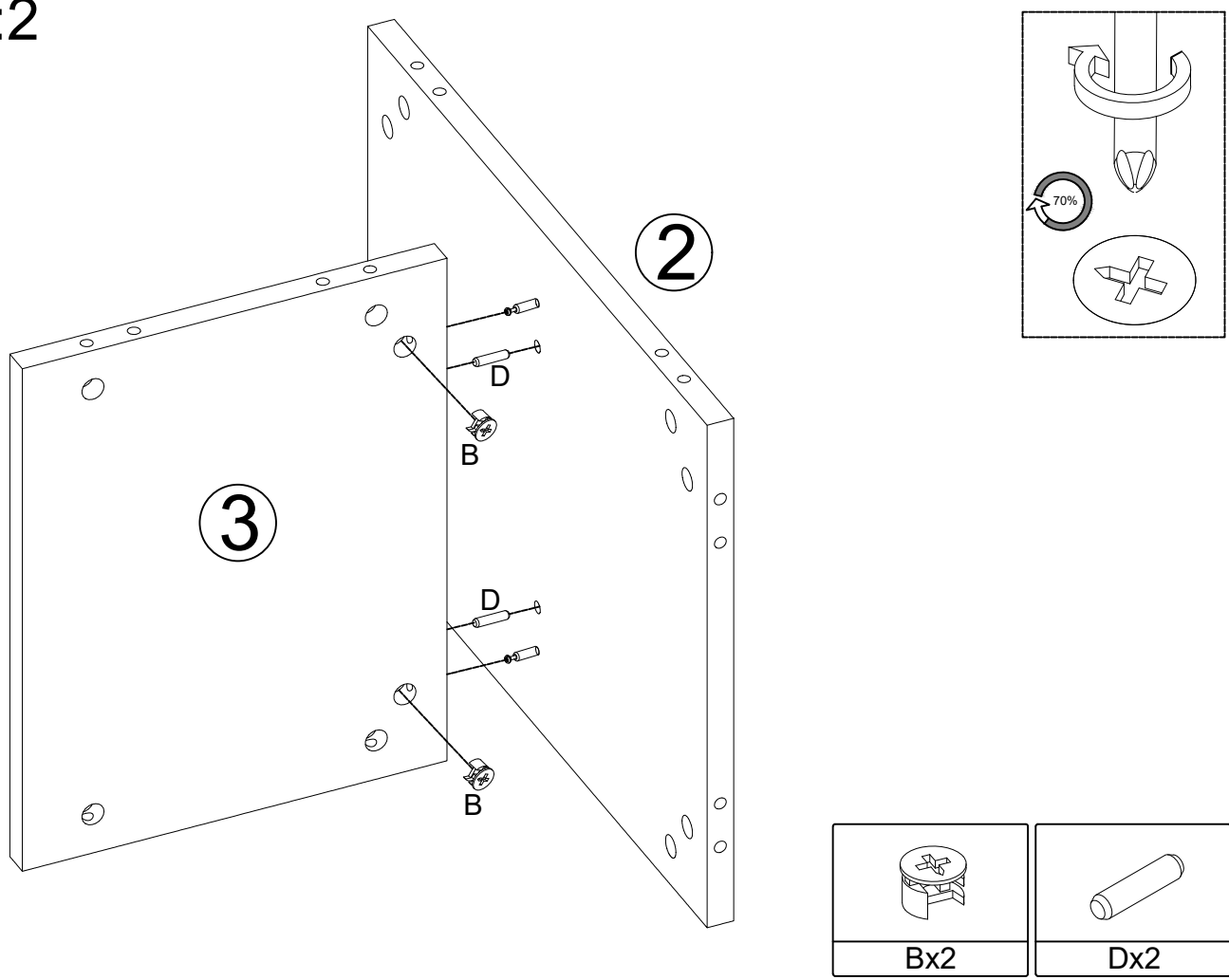

STEP:3

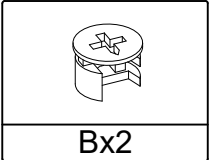
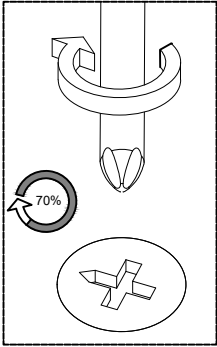
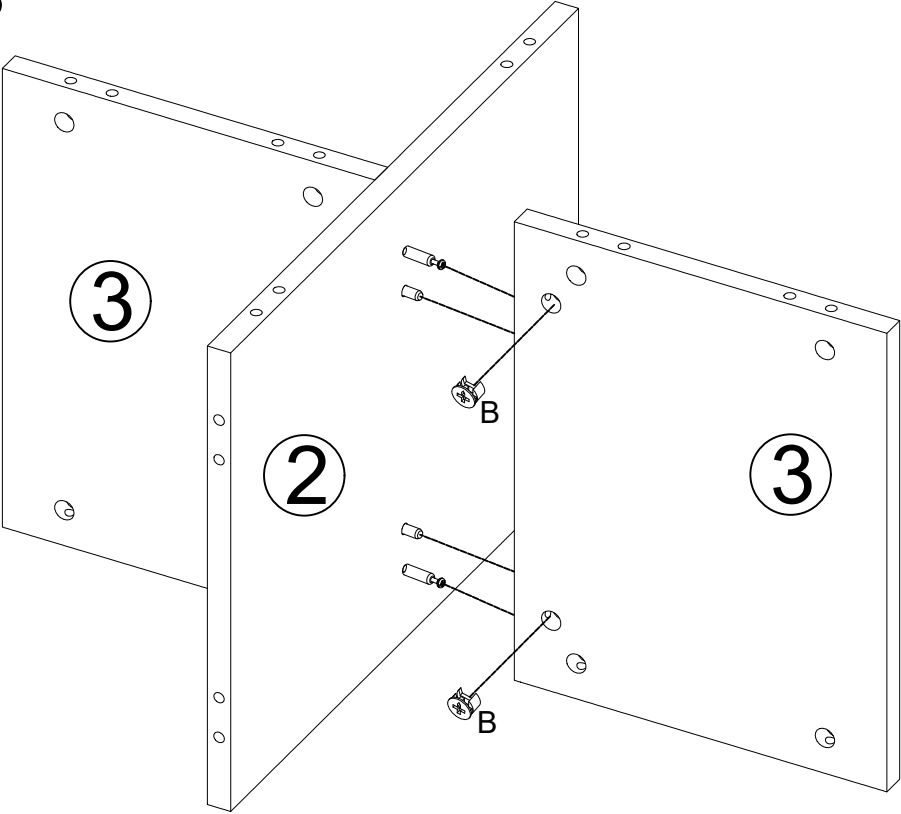

Bx2

STEP:4

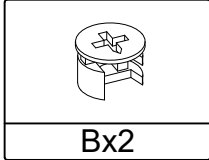
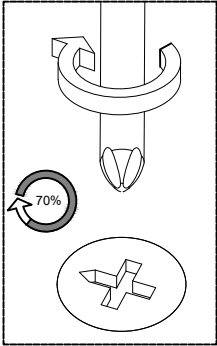
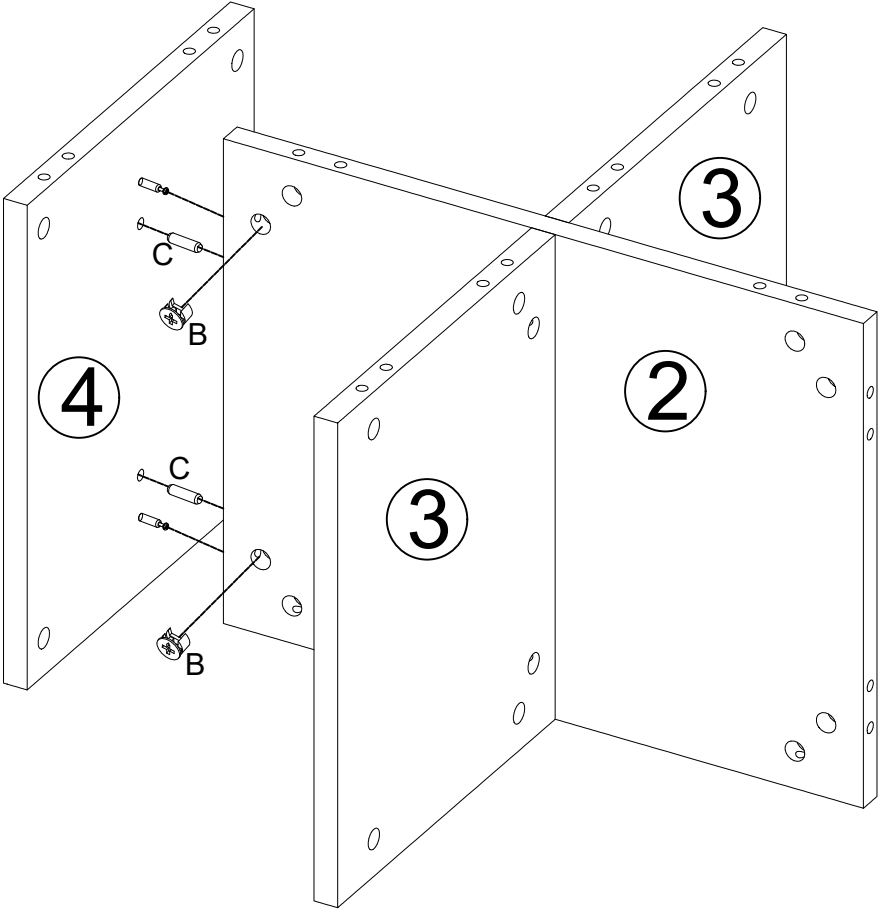

Bx2

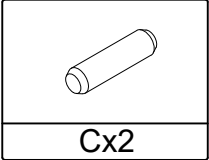

Cx2

STEP:5

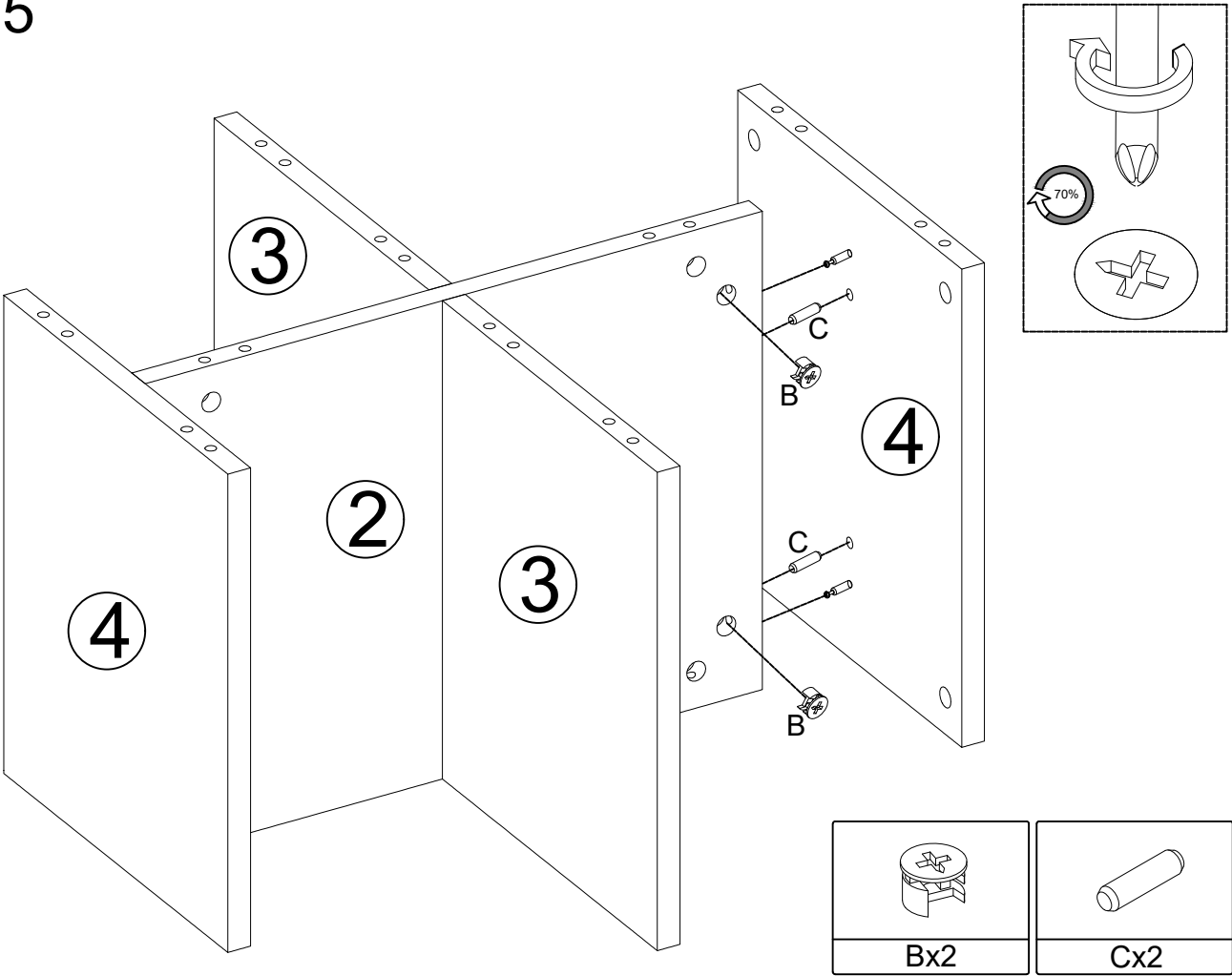

STEP:6

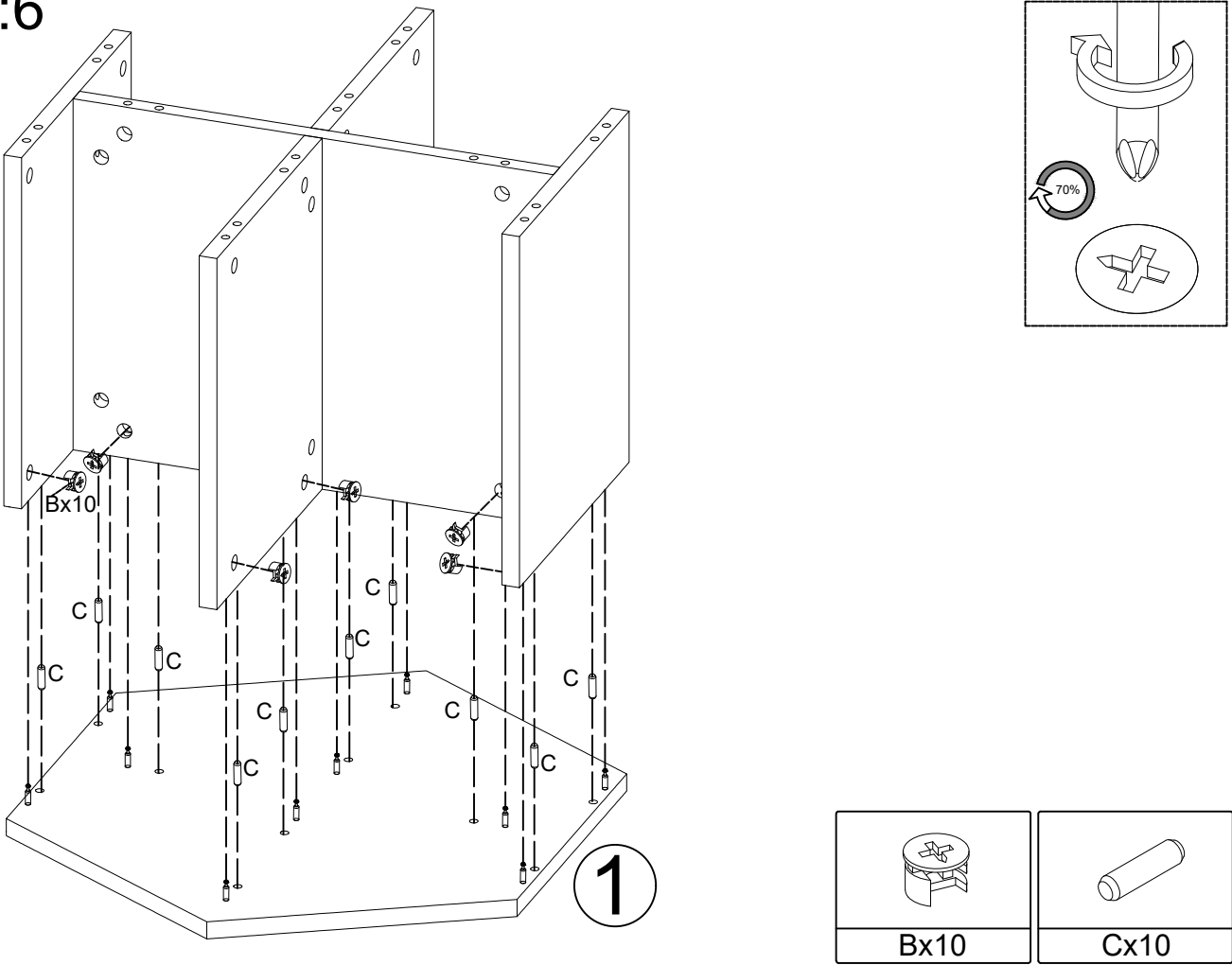

STEP:7

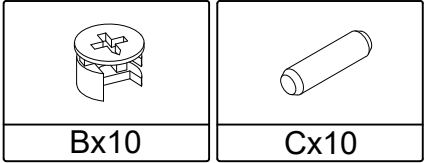
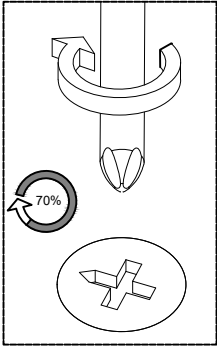
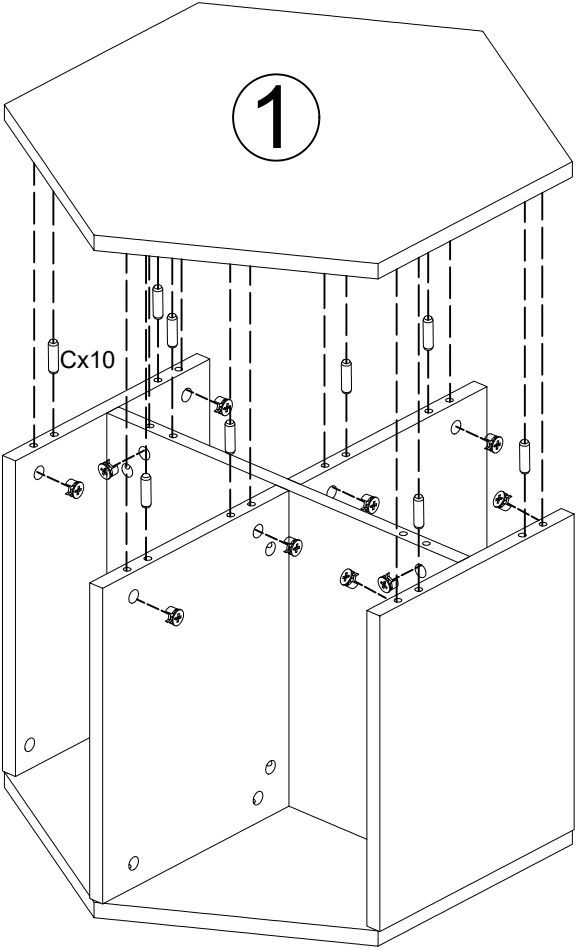

STEP:8

