

INSTRUCTION MANUAL

Punch-Free Windproof Door Stopper

QUIET AND LOW NOISE

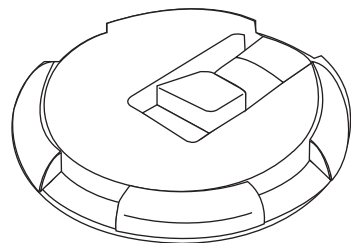

SCAN THE QR CODE ABOVE
FOR INSTALLATION VIDEO ▲

STARTING FROM QUALITY, NOT JUST SEEING

FUNCTIONS AND FEATURES

NON-MAGNETIC MECHANICAL DESIGN:

Relying on mechanical rotation to achieve locking function, non-magnetic design is quieter and more reliable.

① Push the door, the door suction lever on the door pushes the plastic buckle, the body circle rotates and becomes closed.

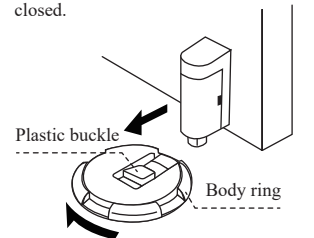

② Closed state.

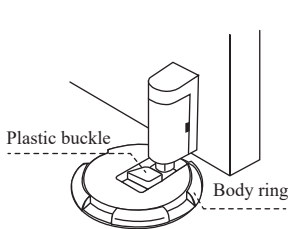

③ Push the door again, and the body ring will rotate and return to the unlocked state

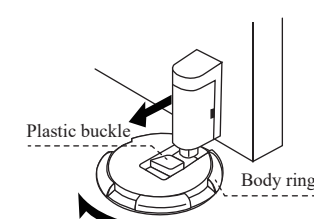

④ Release the locked state.

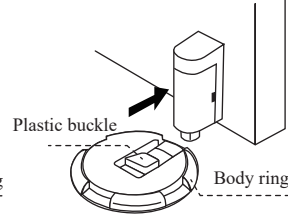

⚠ Note: When using the door suction, please hold the door handle or support the door with your hand. Do not push it lightly and then let go, allowing the door to hit the ground disc freely by inertia.

1

PARTS AND NAMES

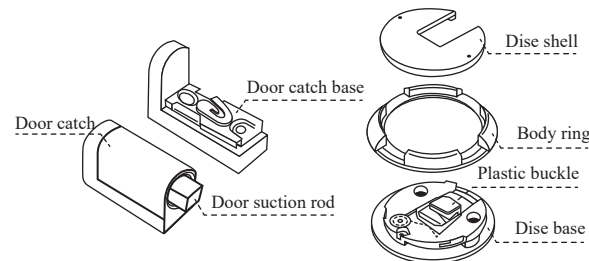

PUNCH-FREE INSTALLATION TUTORIAL

Tip: Using punching installation can extend the service life of the door stopper.

1. Disc Base Installation

① Measure the angle of door opening and closing to determine the installation position of the disc base on the floor, then stick the round 3M adhesive to the bottom of the disc base and stick the base on the floor.

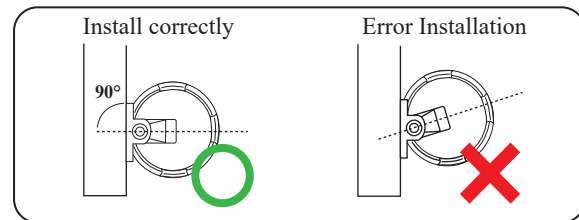

2

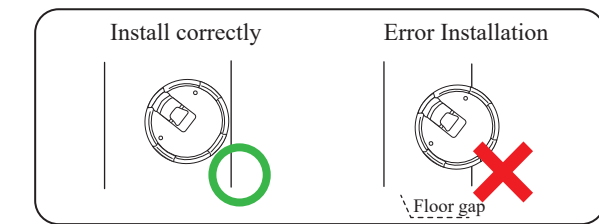

⚠ Note: The door catch and the disc base need to be installed perpendicular to the door, and the disc base should not be installed on the gap of the floor, otherwise it will not work properly.

2. DOOR STOPPER INSTALLATION

① Insert a flat-blade screwdriver into the groove and push it downward to remove the door catch.

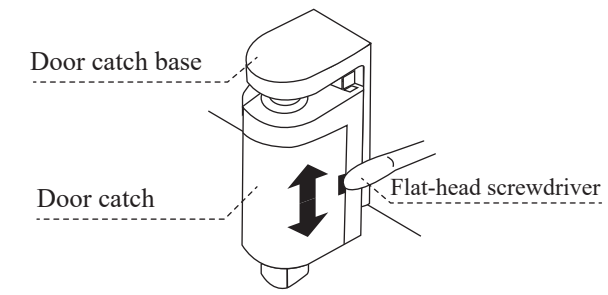

Insert a flat-blade screwdriver
(Please push downwards first to release the door catch, but do not pry!)

3

② Insert the original hexagonal wrench into the hole on the upper part of the door catch, and then rotate it clockwise to make the door suction rod extend from the bottom. The adjustable distance from the ground is between 3.5 ~ 5mm. After the adjustment is completed, install the door catch back.

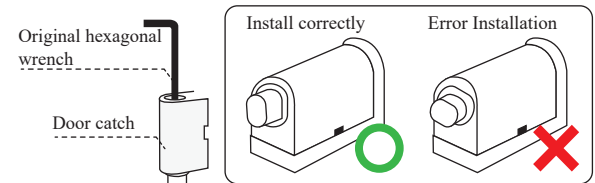

⚠ Note: Install the door suction rod vertically.

③ Stick the rectangular 3M adhesive to the back of the door catch base, remove the film, clamp the door catch on the ground disc, move the door in the direction of the door catch, and stick the door catch on the door.

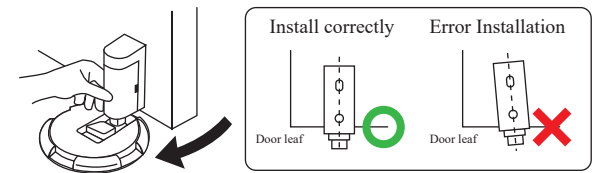

4

PUNCH HOLE INSTALLATION TUTORIAL

1. DOOR STOPPER INSTALLATION

- ① After determining the installation location, remove the door catch and install the screws.

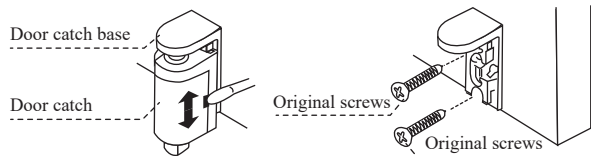

Insert a flat-blade screwdriver
(Please push downwards first to release
the door catch, but do not pry!)

Please adjust the installation
position first

- ⚠ Note: The door catch needs to be installed vertically to the door

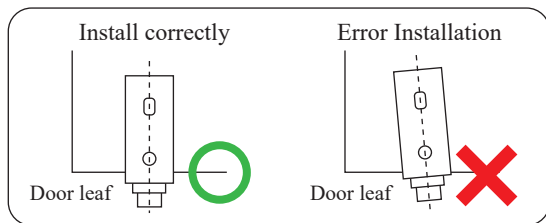

- ② Insert the original hexagonal wrench into the hole on the upper part of the door catch, and then rotate it clockwise to make the door suction rod extend from the bottom. The adjustable distance from the ground is between 3.5 ~ 5mm. After the adjustment is completed, install the door catch back.

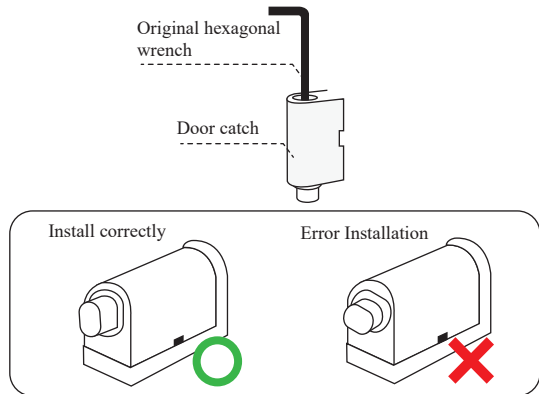

- ⚠ Note: Install the door suction rod vertically.

2. DISC BASE INSTALLATION

- ① First measure the door opening and closing angle to determine the installation position of the ground disc.

- ⚠ Note: The door catch and the base need to be installed vertically, and the base should not be installed on the gap of the floor, otherwise it will not work properly

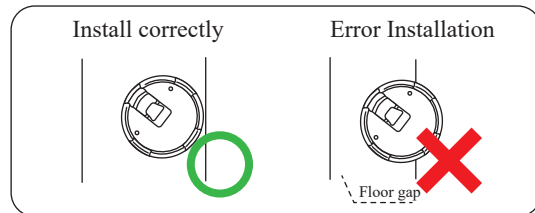
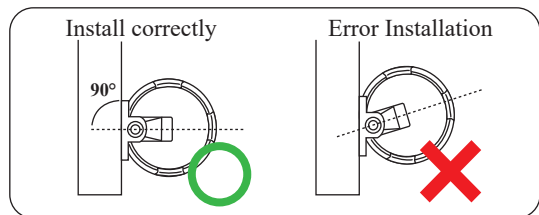

- ② Press your palm on the disc shell and rotate it counter-clockwise to remove the disc shell and install the screws.

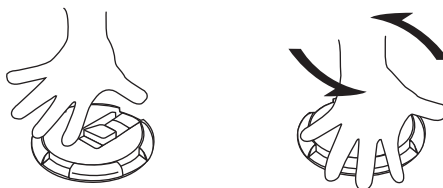

- ⚠ Note: When using an electric drill, do not tighten the screws to the deepest point. After all three screws are installed, tighten them gently with a screwdriver.

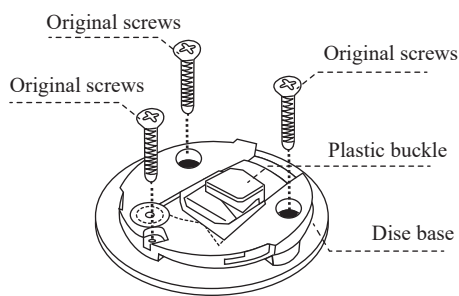

- ③ Place the disc shell in the position shown in the figure, and rotate it clockwise with your palm to fully embed it

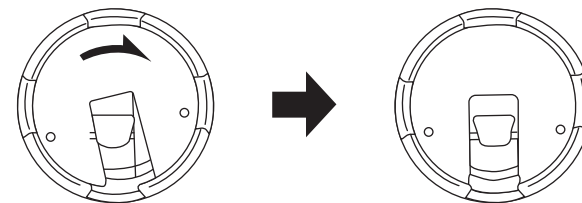

POST-INSTALLATION CONFIRMATION AND MAINTENANCE

After installation is complete, be sure to test and confirm

- ⚠ Note: After confirmation, please cover the disc with the original plastic protective shell for protection.

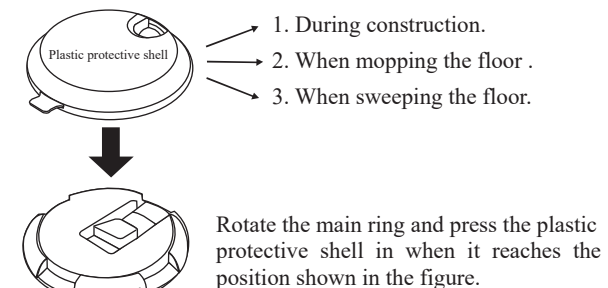

PRODUCT SPECIFICATIONS

