

Assembly Guide



If you're having any difficulty during assembly of this product, don't hesitate to call us

Our customer service experts are trained to provide step-by-step instruction and can easily replace any missing or damaged parts.

48W Wall Mounted Coat Rack w Doors

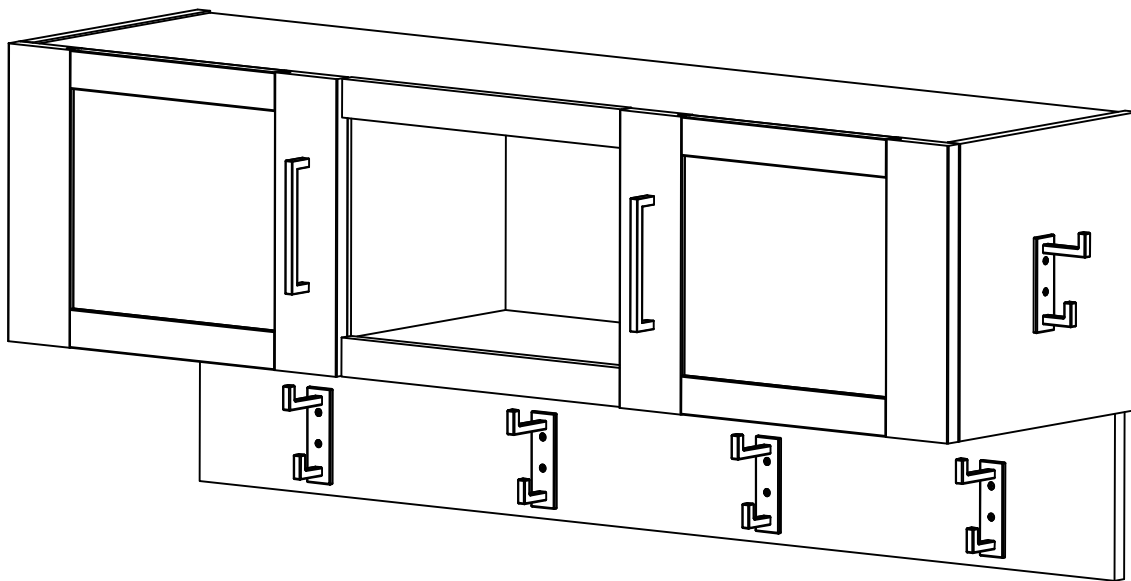

Get Ready to Assemble

For best results, keep these tips in mind:

- ① We know you want to finish this assembly as quickly as possible, but trust us: you'll have a better experience if you take it one step at a time.
- ② Give yourself some room to work near where you want the fully assembled product.
- ③ If your floor isn't carpeted, assemble this product on the empty carton to avoid scratching.
- ④ Do you have a friend who owes you a favor? Some steps may go a little easier with a second set of hands.

DOs

- ✔ Use a #2 Phillips head screwdriver (or other handheld tools as indicated)
- ✔ Wear safety glasses at all times during assembly
- ✔ Carefully follow the instructions in this guide and complete all steps in order
- ✔ Give us a call if you're having trouble with a particularly tricky step

DON'Ts

- ✘ We know power tools are quick and easy, but you shouldn't use them when assembling this product (unless otherwise specified)
- ✘ Never move your furniture with items inside or resting on the surface
- ✘ Do not attempt to use this product before all steps have been completed

IMPORTANT SAFETY INFORMATION



PLEASE READ WARNINGS

Improper use can cause safety hazards, or damage to your furniture and household items.

Warning	Do	Don't	Why it's important
DEATH or SERIOUS INJURY can occur	<ul style="list-style-type: none">Hutch MUST be securely attached to wall structure.ONLY attach directly to wood- or metal studs or masonry wall structure.	<ul style="list-style-type: none">NEVER attach hutch directly to drywall/sheetrock/ gypsum panel.NEVER use hollow wall anchors.Check that screws are tight and fully screwed into wall.Screws must not be loose or turn freely when the hutch is fully installed.	Failure to follow these steps may result in product falling of the wall and product collapse resulting in crushing injury.

Advertencia	Hacer	No	Por qué es importante
Puede ocurrir la MUERTE o LESIONES GRAVES	<ul style="list-style-type: none">La conejera DEBE estar firmemente sujeta a la estructura de la pared.ÚNICAMENTE sujete directamente a postes de madera o metal o estructura de pared de mampostería.	<ul style="list-style-type: none">NUNCA conecte la conejera directamente al panel de yeso / placa de yeso / panel de yeso.NUNCA use anclajes de pared huecos.Verifique que los tornillos estén apretados y completamente atornillados a la pared.Los tornillos no deben aflojarse ni girar libremente cuando la cabina está completamente instalada.	No seguir estos pasos puede resultar en la caída del producto de la pared y el colapso del producto resultando en una lesión por aplastamiento.

Attention	À faire	À ne pas faire	Pourquoi c'est important
LA MORT ou DES BLESSURES GRAVES	<ul style="list-style-type: none">La huche DOIT être fixée sécuritairement à la structure murale.Fixer DIRECTEMENT aux montants de bois ou de métal ou à la structure murale en maçonnerie.	<ul style="list-style-type: none">Ne JAMAIS fixer la huche directement sur une cloison sèche, un panneau de gypse ou de plâtre.Ne JAMAIS utiliser d'ancrages pour cloison sèche.Vérifier que les vis sont bien serrées et entièrement vissées dans le mur.Les vis ne doivent pas être mobiles ou pivoter quand la huche est complètement installée.	Le non-respect de ces étapes peut entraîner la chute et l'effondrement du produit résultant en blessures par écrasement.

Get to know your Boards

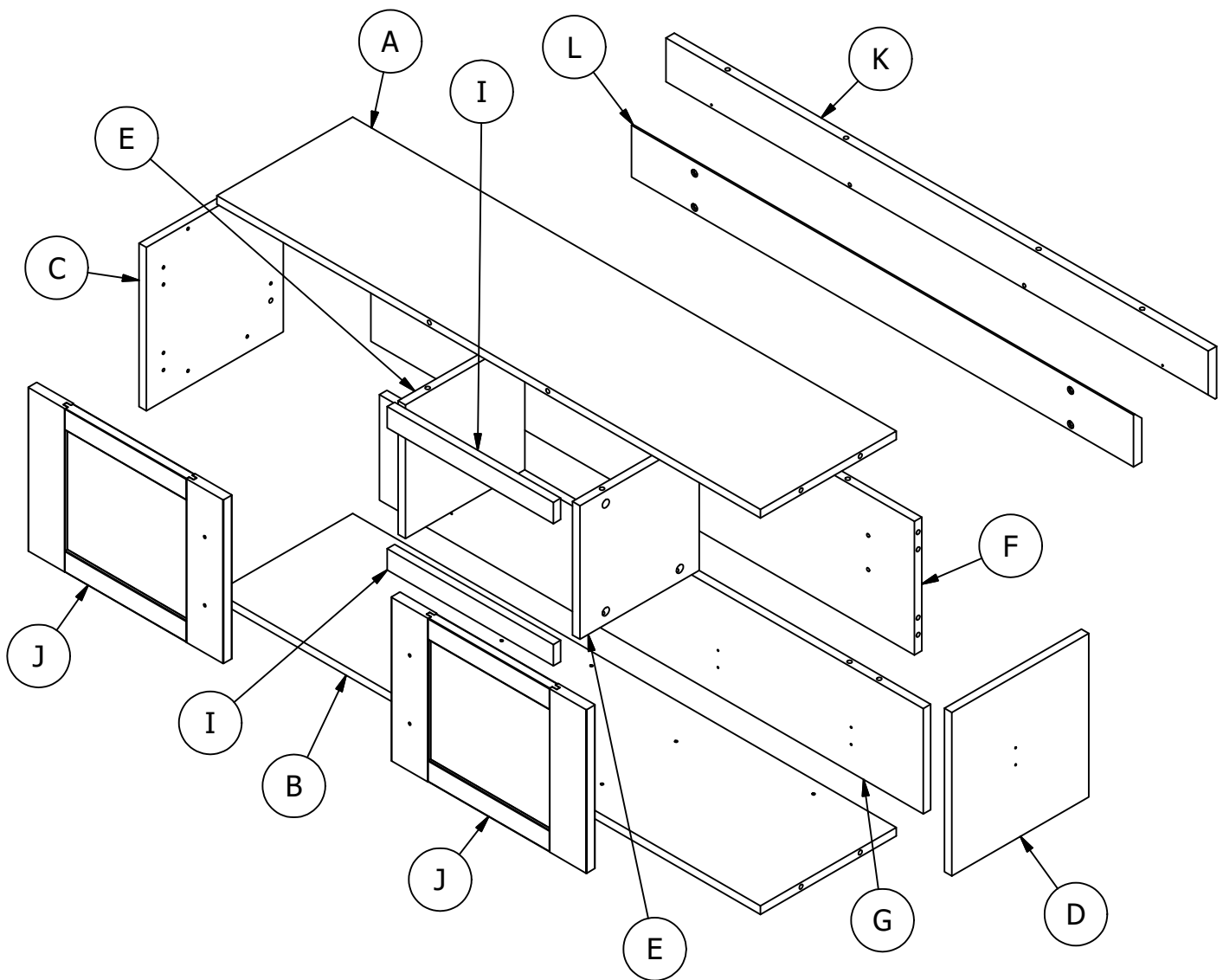
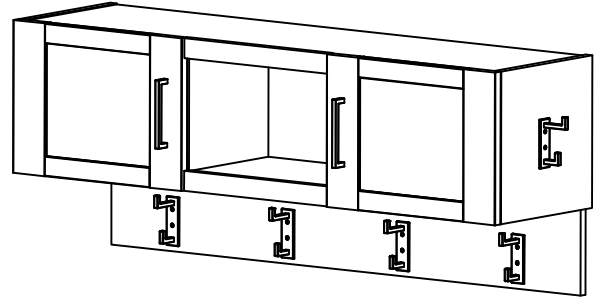

Get to know your Fasteners

Fasteners are shown actual size.

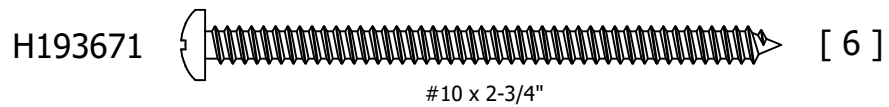
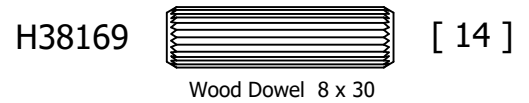
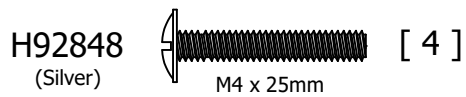
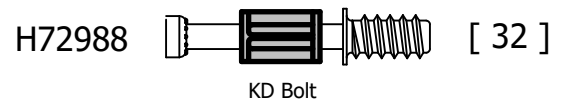
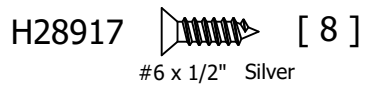
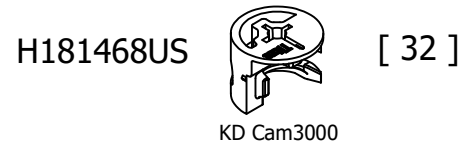
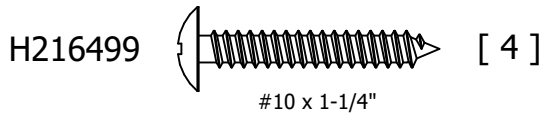

Get to know your Hardware

Hardware not to scale.

H126359

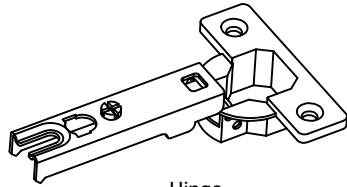

[4]

Hinge

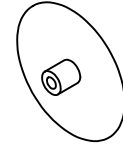

[20]

Cover Cap

H126758

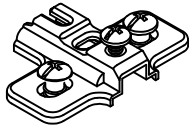

[4]

Mounting Plate

H215406

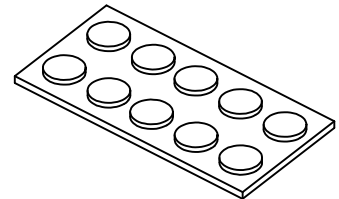

[1]

Bumper (10) per pack

Q215208

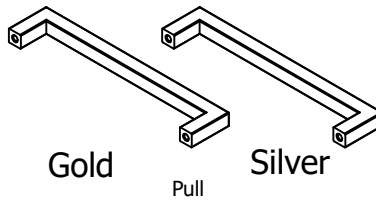

[2 Sets]

Gold

Pull

Silver

Q215563

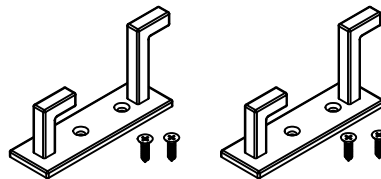

[6 Sets]

Silver

Coat Hook

Gold

STEP 1

Prepare Panels

H126359

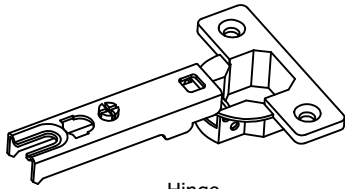

[4]

Hinge

H28917

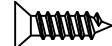

[8]

#6 x 1/2" Silver

H92848

(Silver)

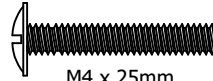

[4]

M4 x 25mm

Q215208

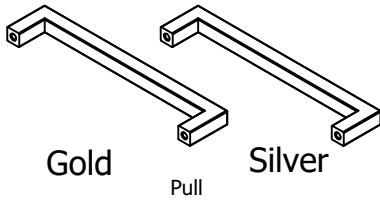

[2 Sets]

Gold

Pull

Silver

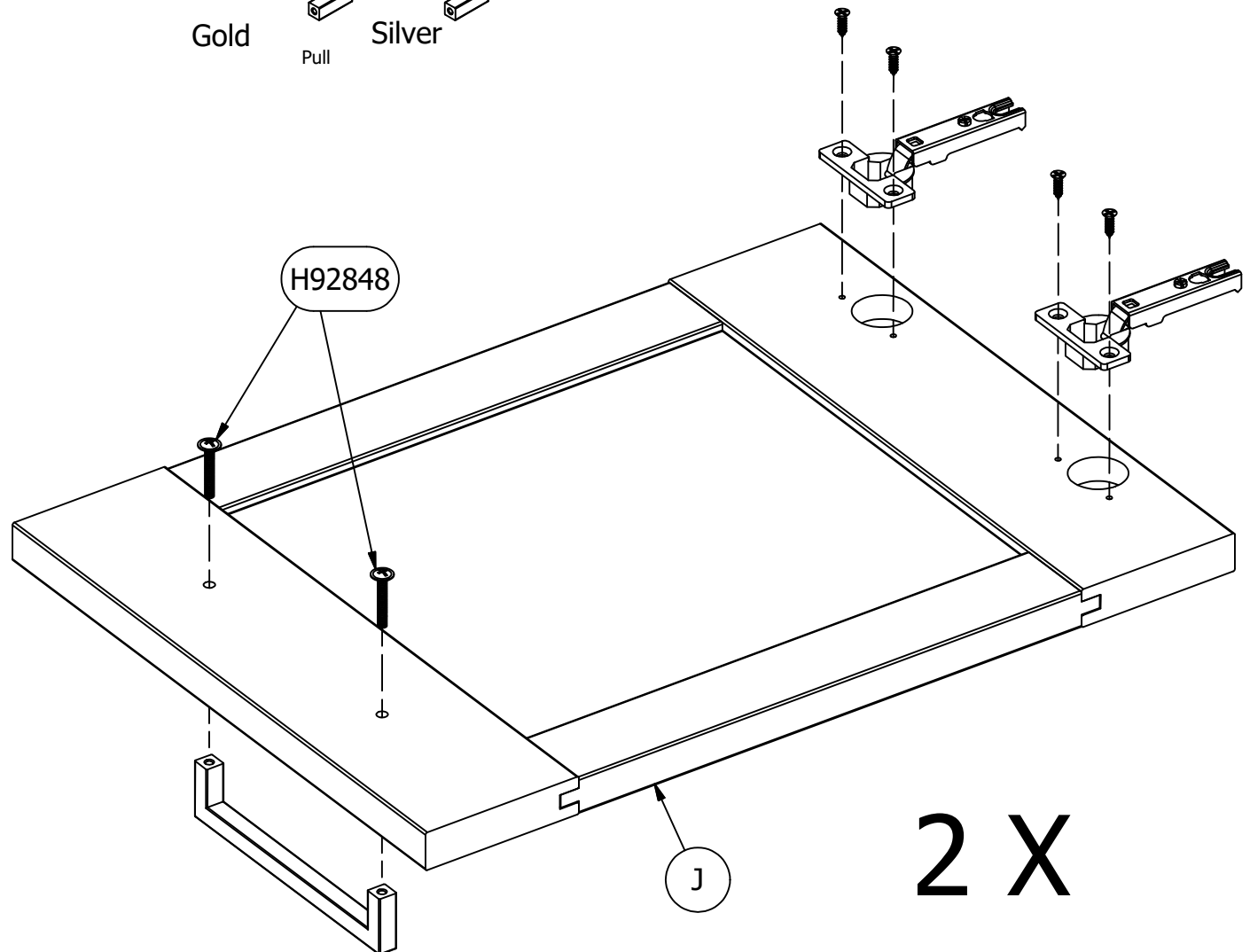

H92848

J

2 X

STEP 2

Prepare Panel

H72988

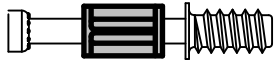

[6]

KD Bolt

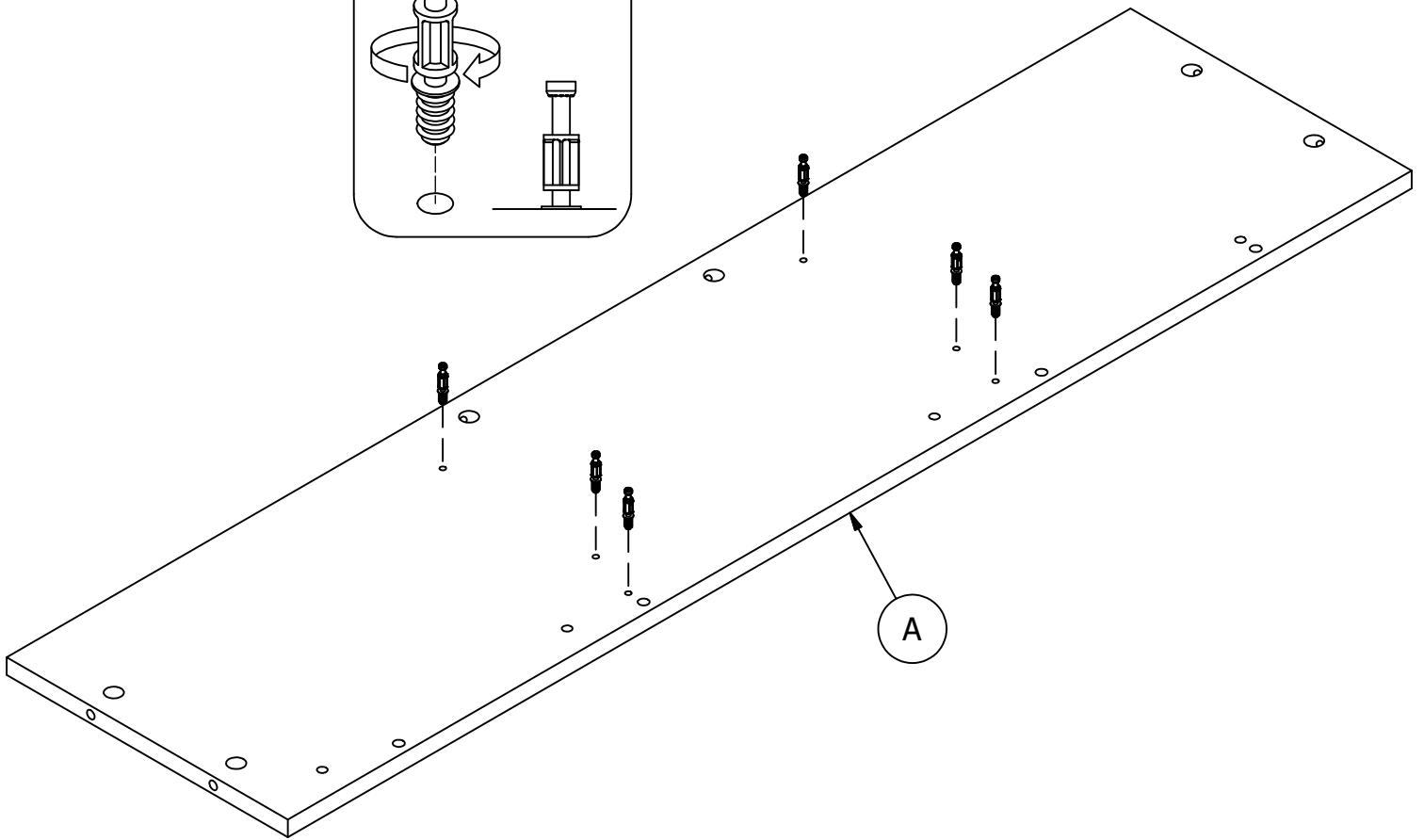
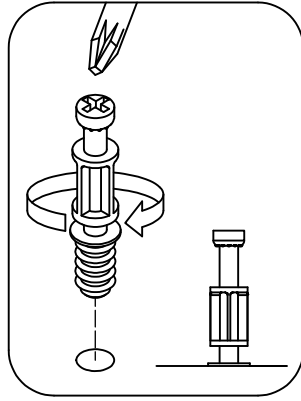

STEP 3

Prepare Panel

H72988

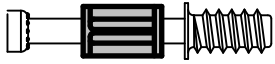

KD Bolt

[4]

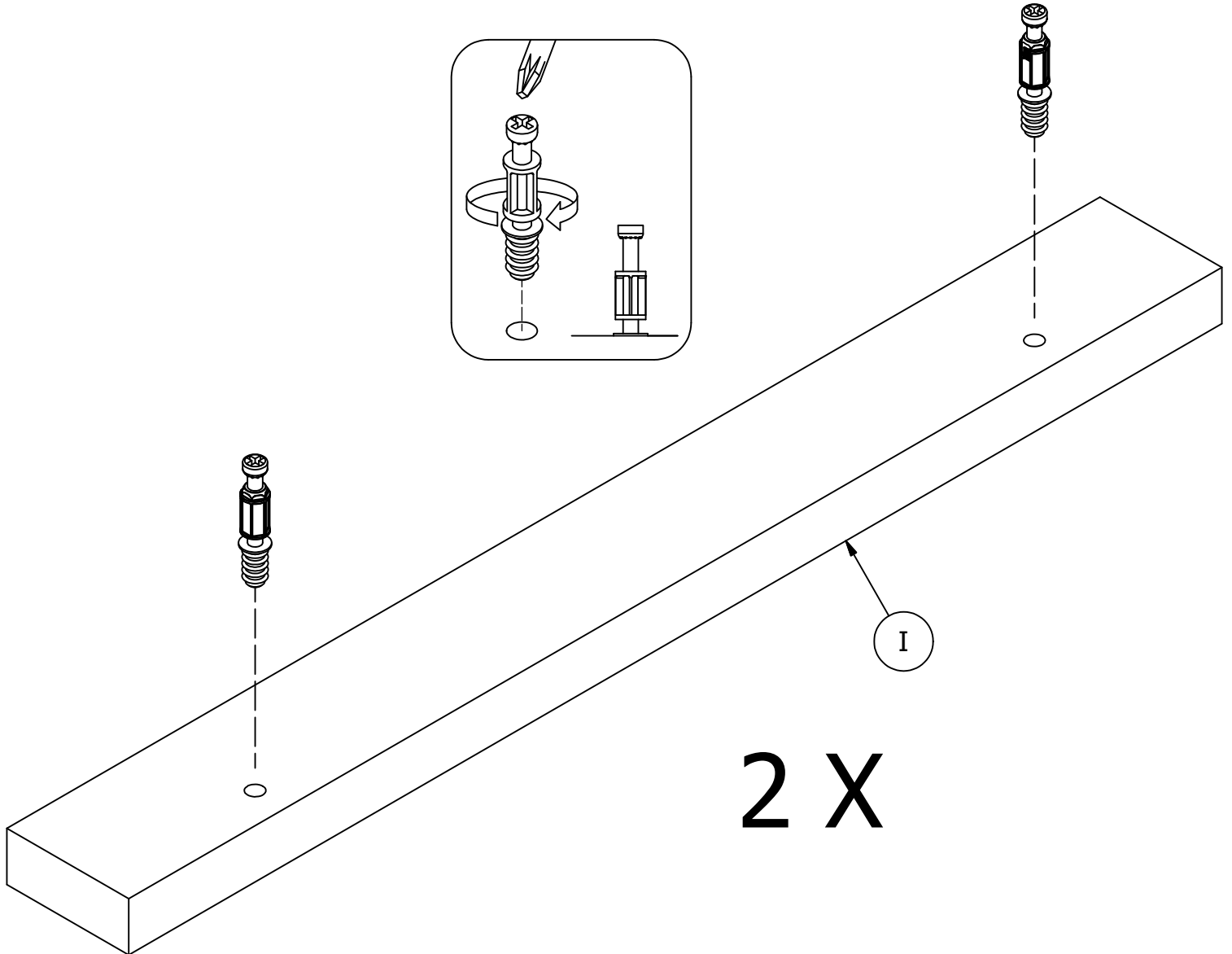
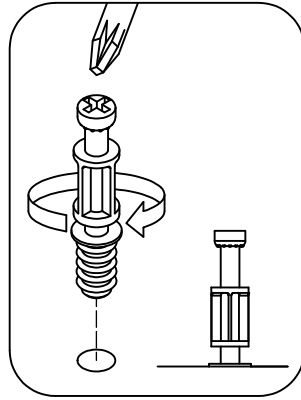

STEP 4

Assemble Panels

H181468US [2]
KD Cam3000

[2]
Cover Cap

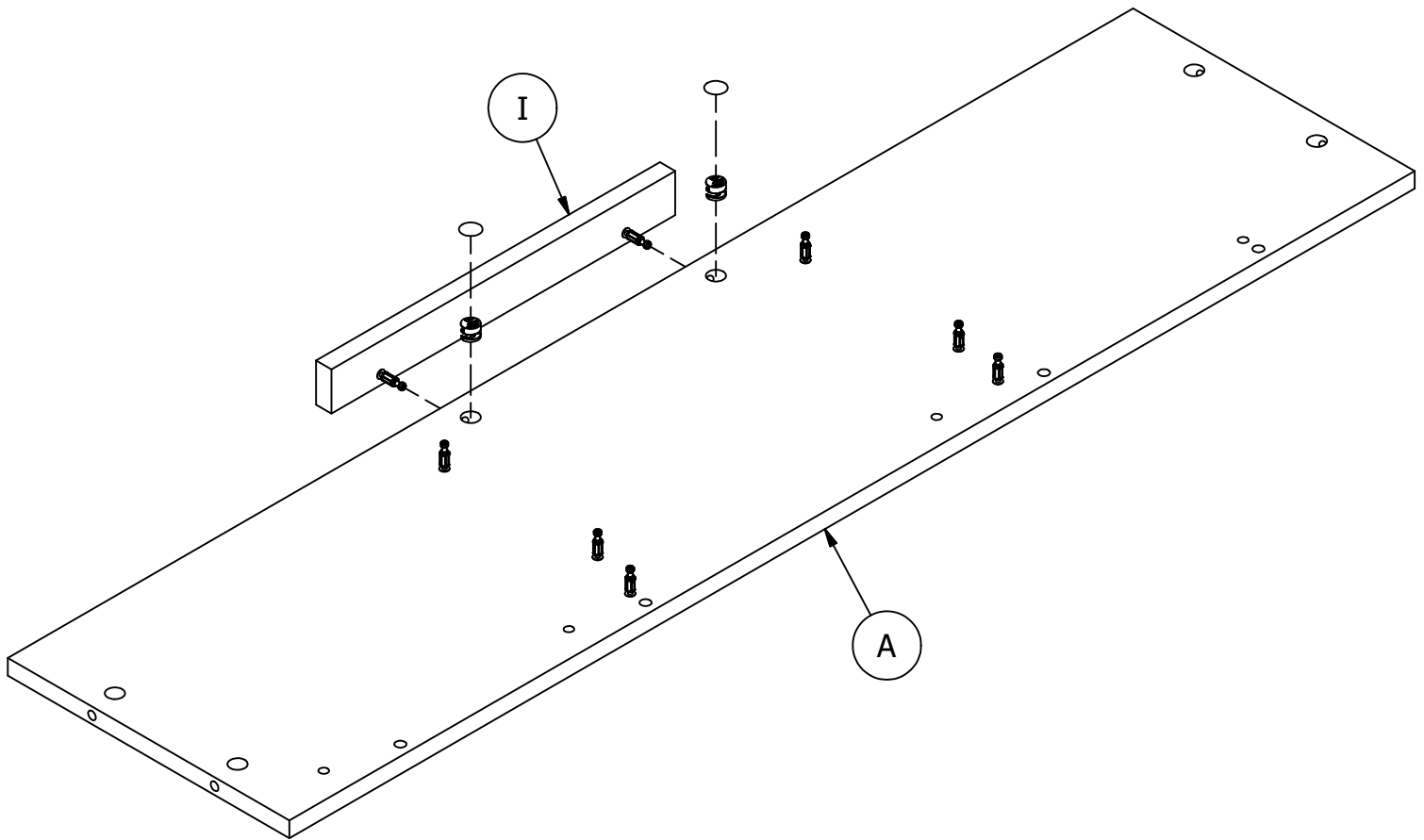
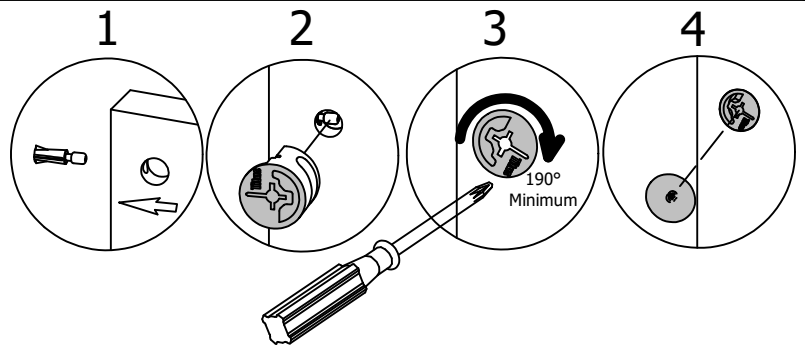

STEP 5

Assemble Panels

H181468US [2]
KD Cam3000

[2]
Cover Cap

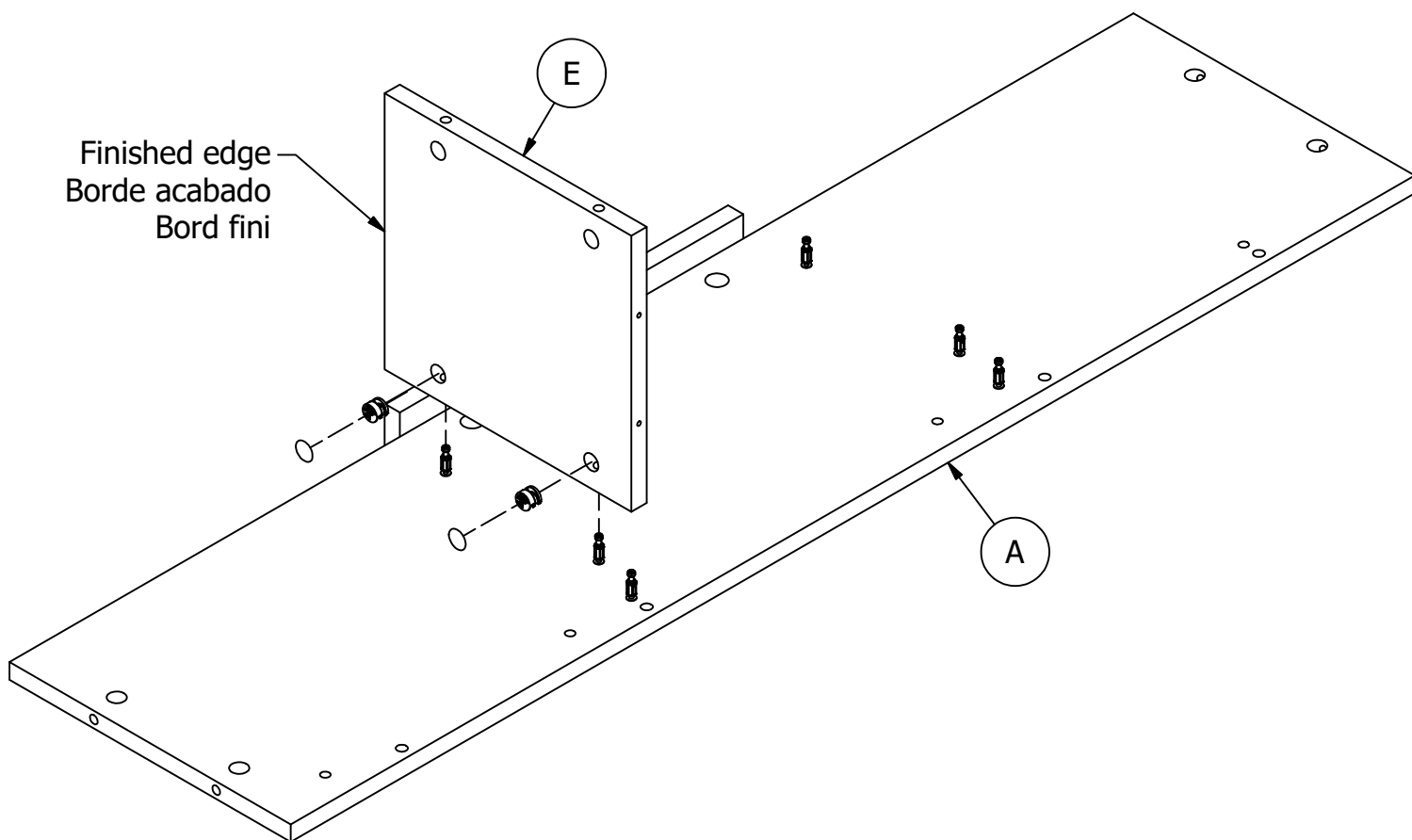
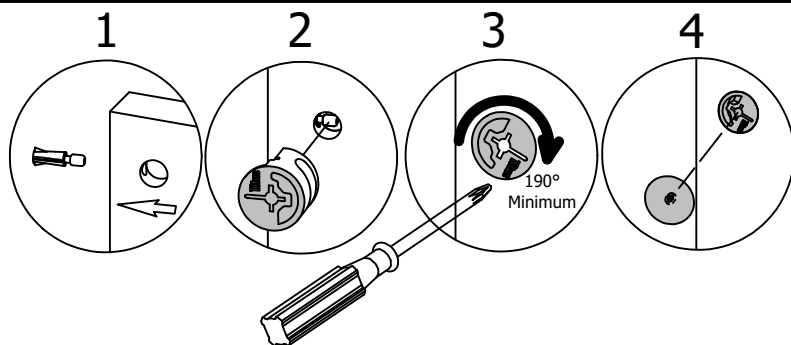

STEP 6

Assemble Panels

H181468US

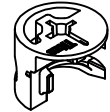

[2]

KD Cam3000

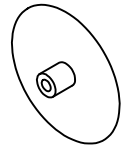

[2]

Cover Cap

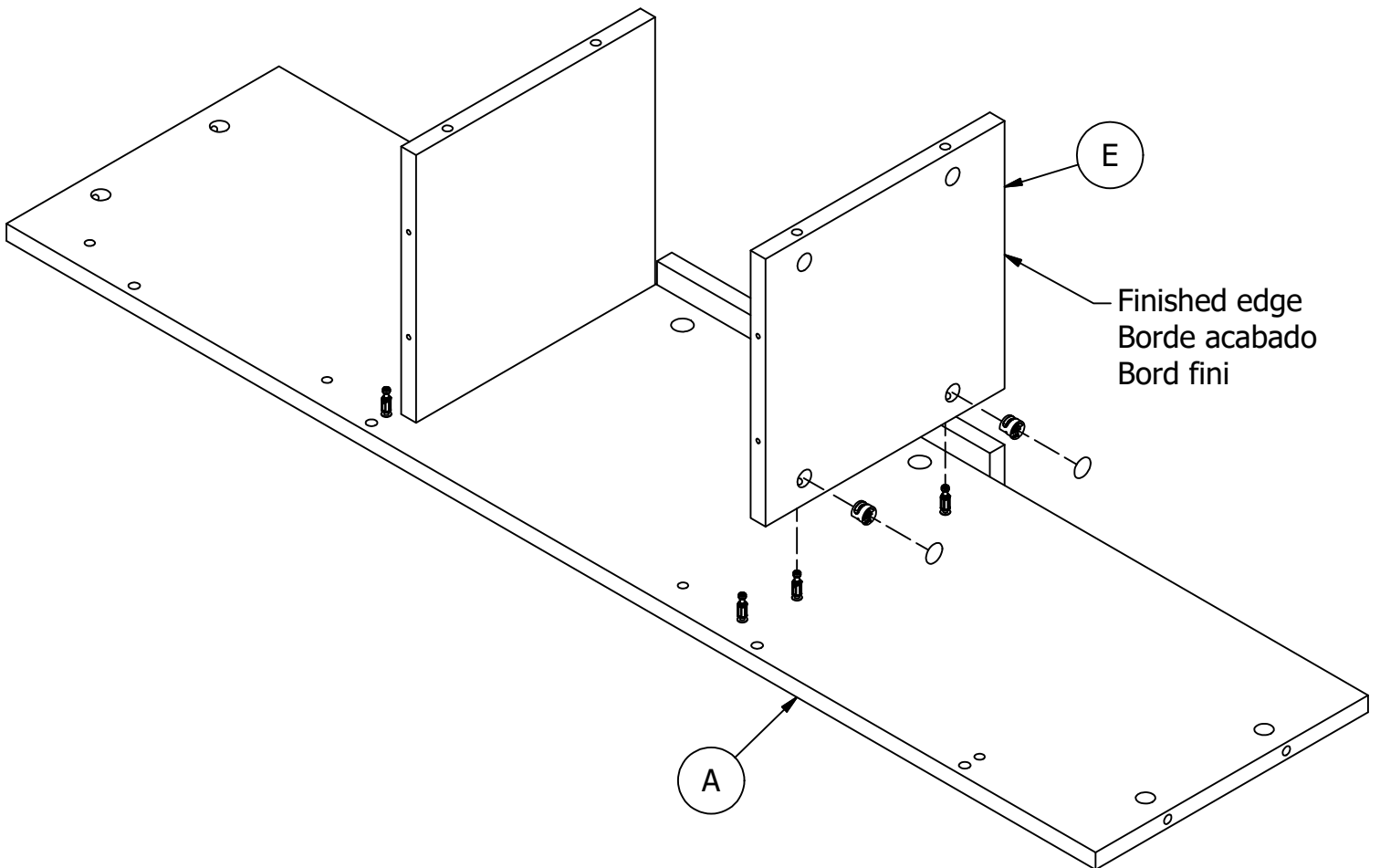
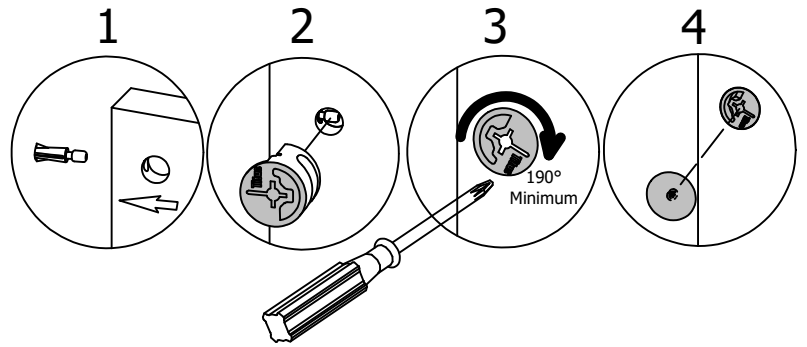

STEP 7

Prepare Panel

H38169

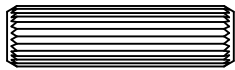

[8]

Wood Dowel 8 x 30

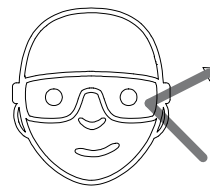
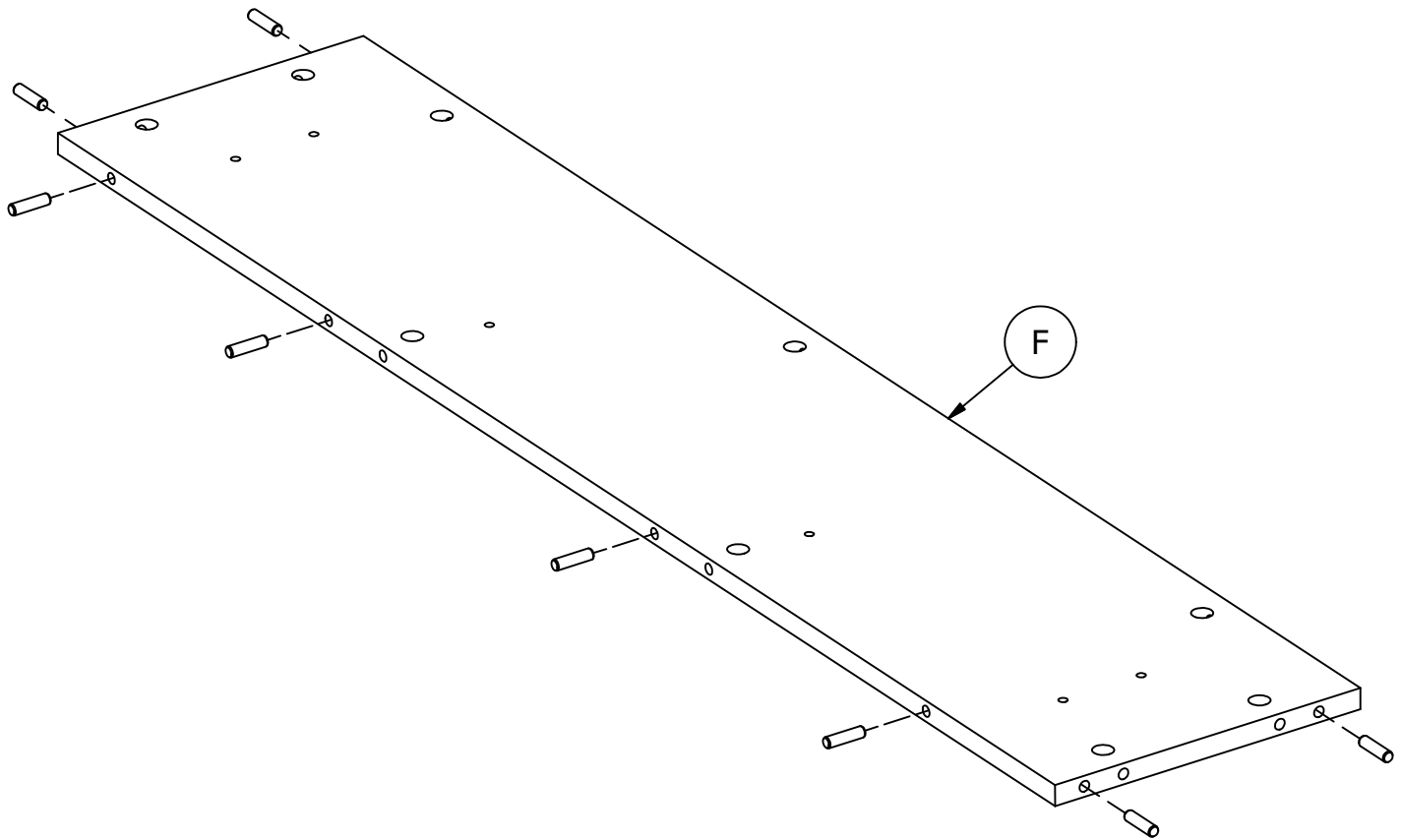

Safety glasses
Gafas de seguridad
Lunettes de protection

STEP 8

Assemble Panels

H181468US



[2]

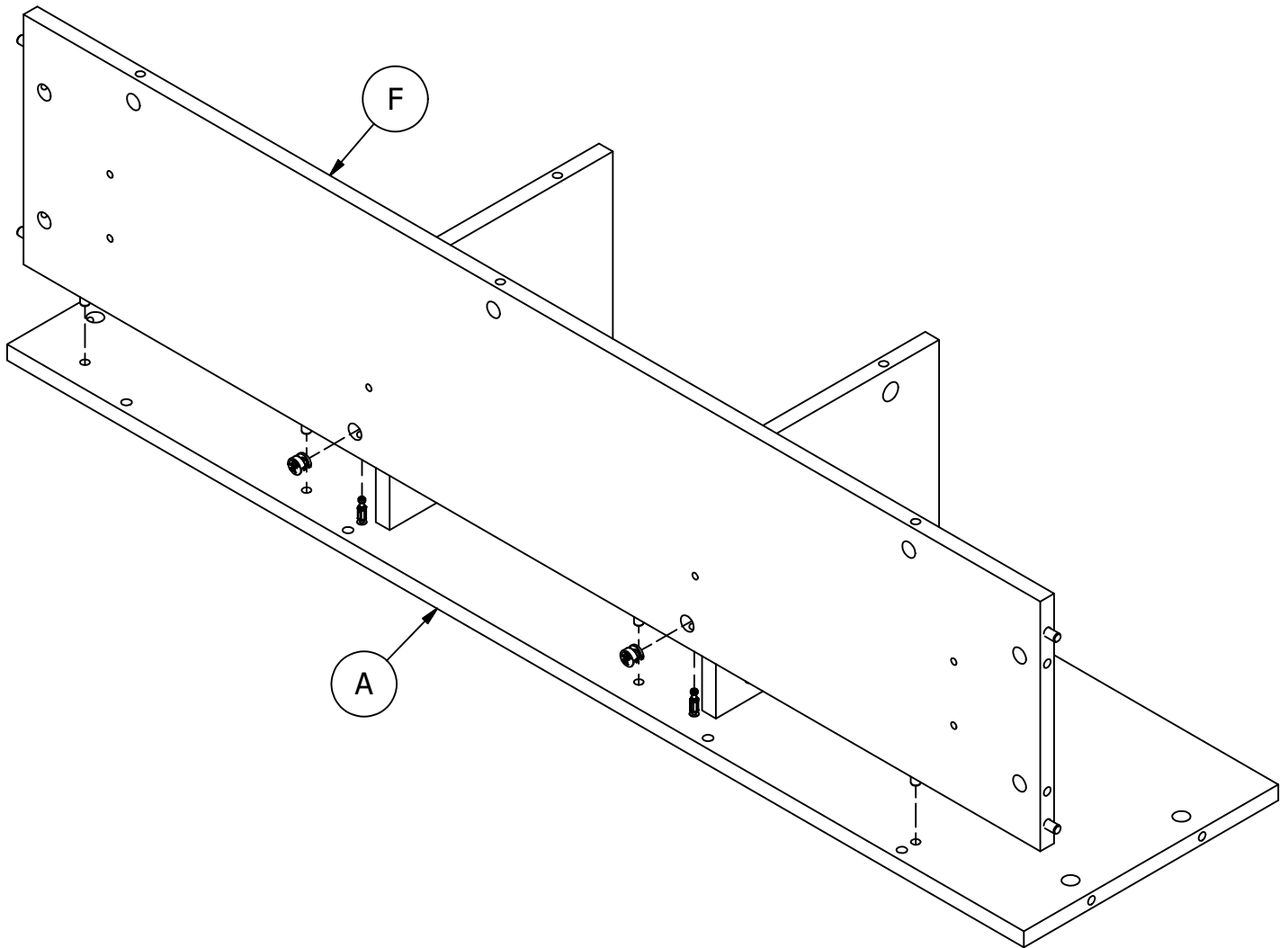
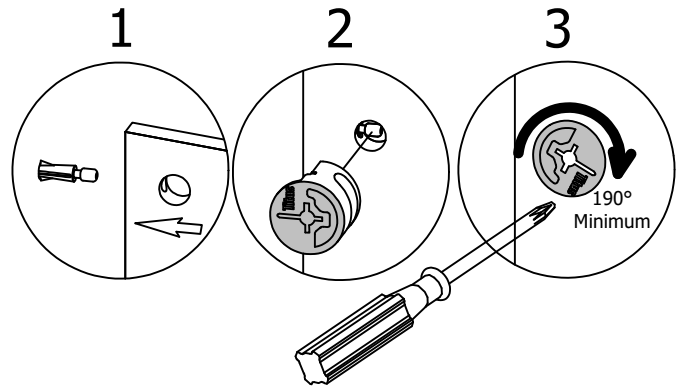

STEP 9

Prepare Panel

H72988 [10]

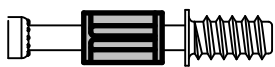

KD Bolt

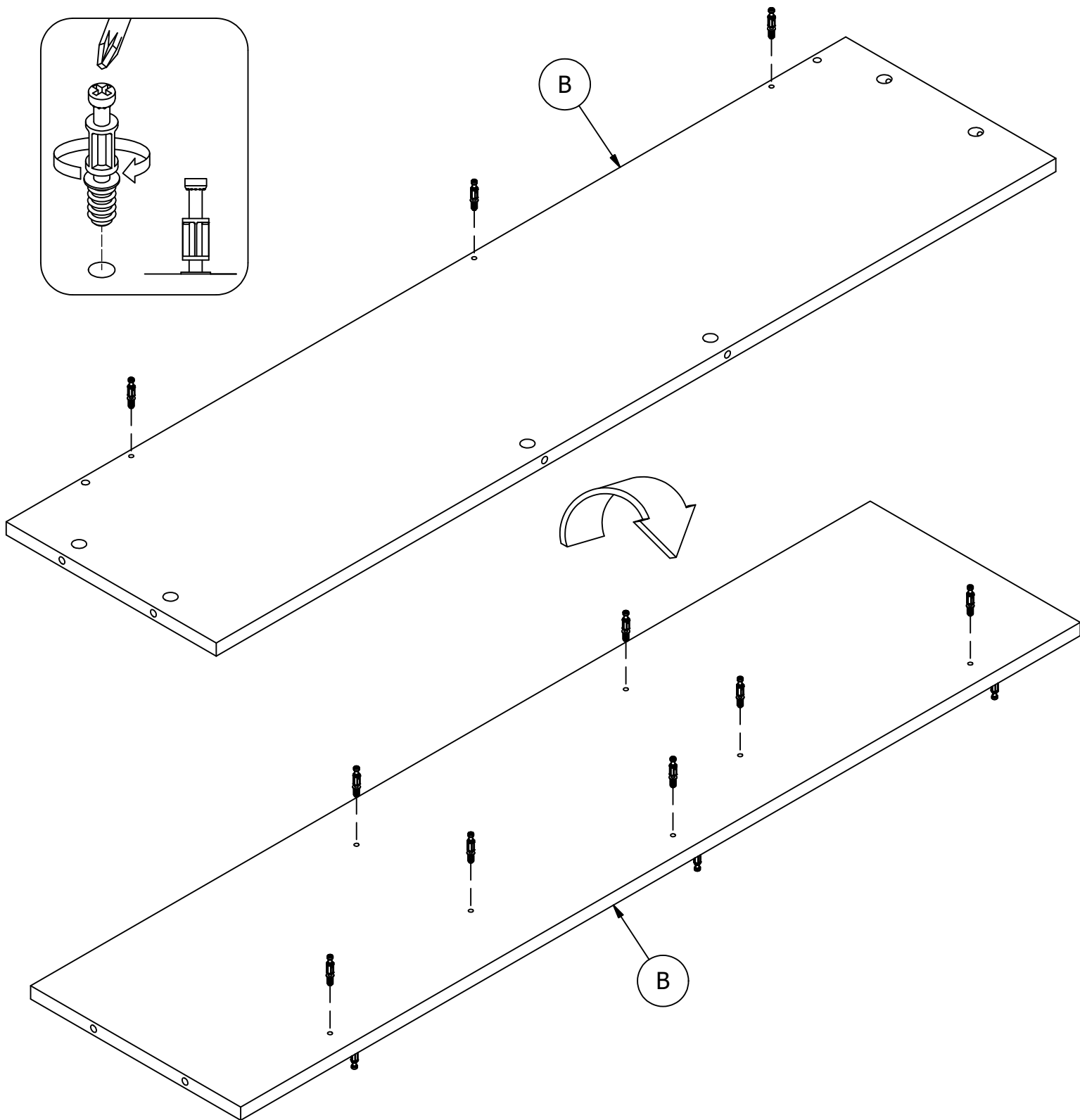
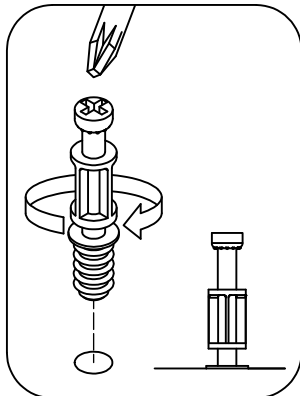

STEP 10

Assemble Panels

H181468US

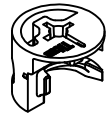

KD Cam3000

[2]

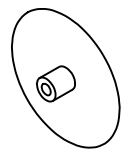

Cover Cap

[2]

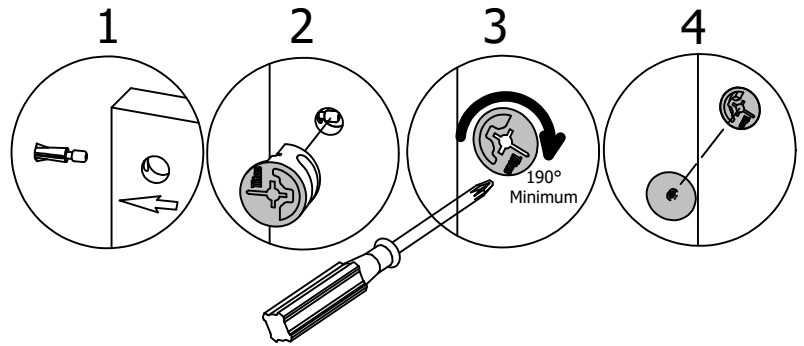

Finished edge
Borde acabado
Bord fini

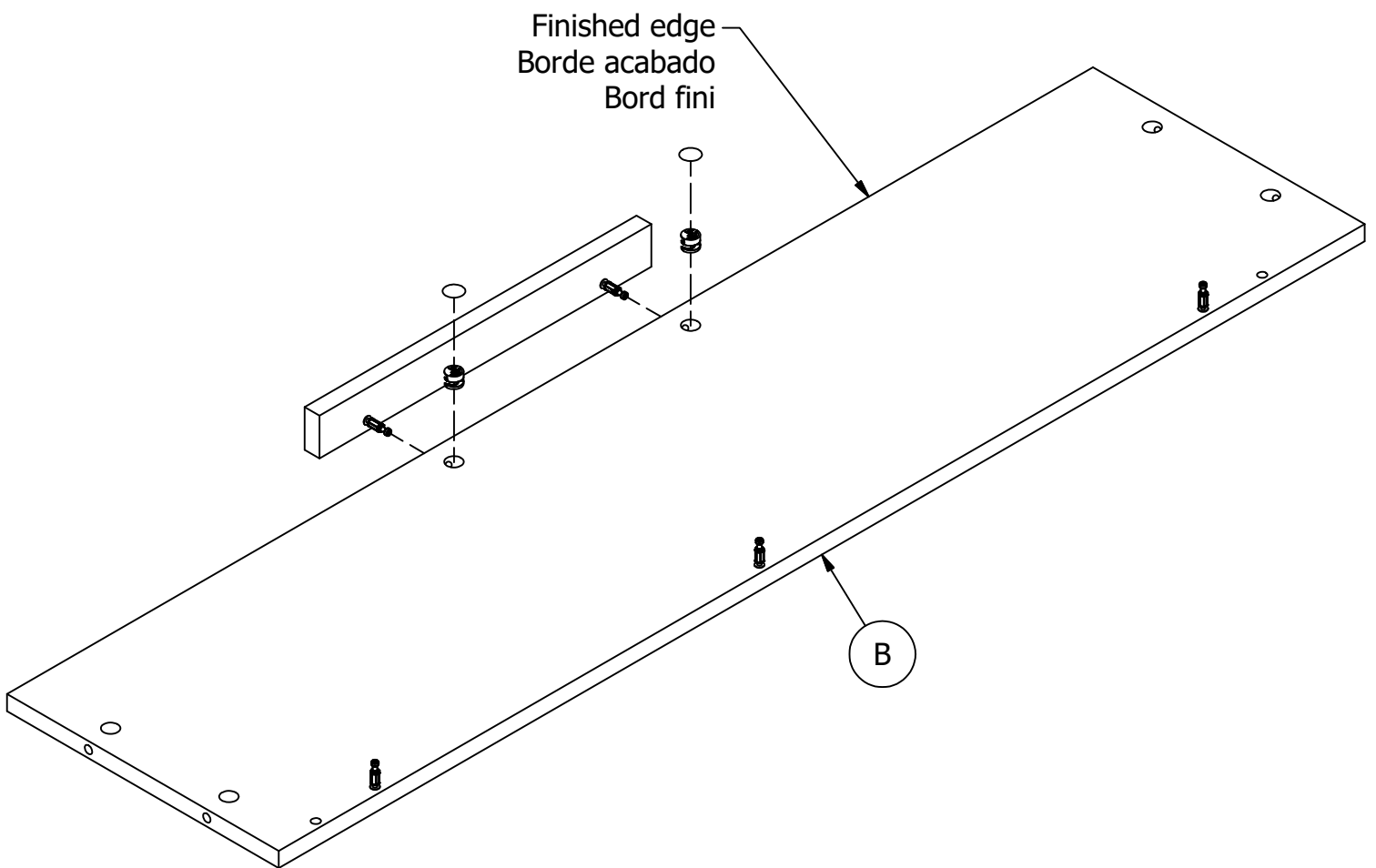

STEP 11

Assemble Panels

H181468US

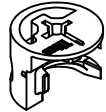

KD Cam3000

[7]

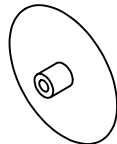

Cover Cap

[4]

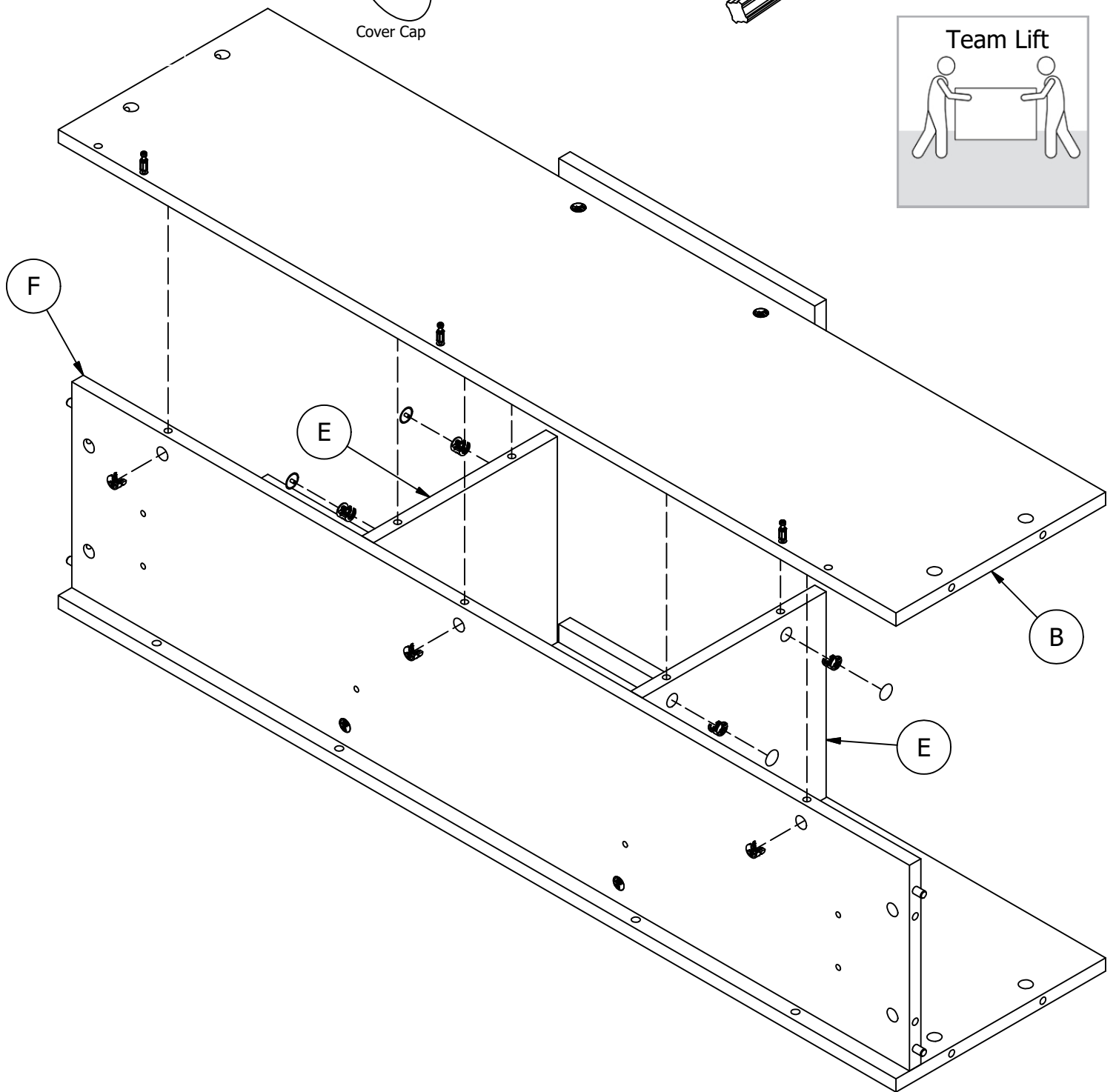
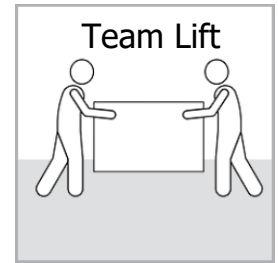
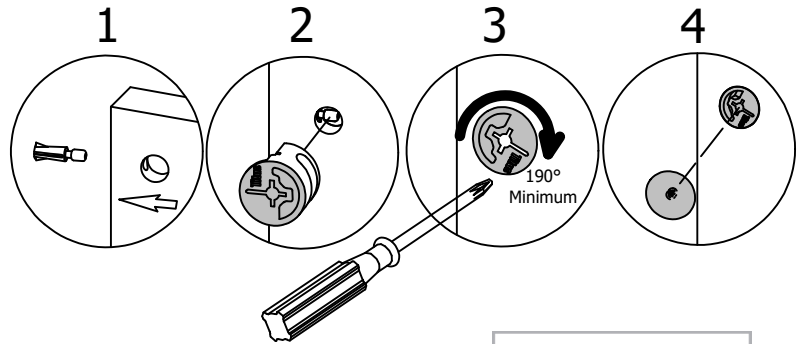

STEP 12

Prepare Panel

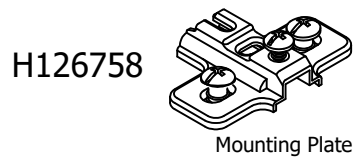

[2]

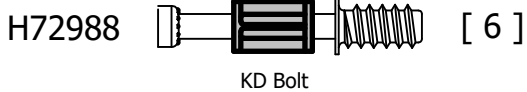

[6]

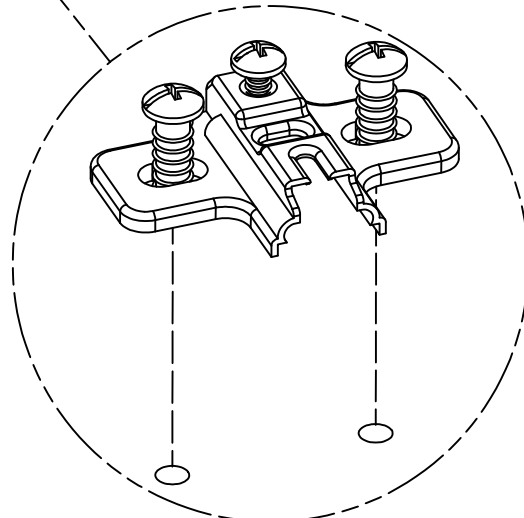
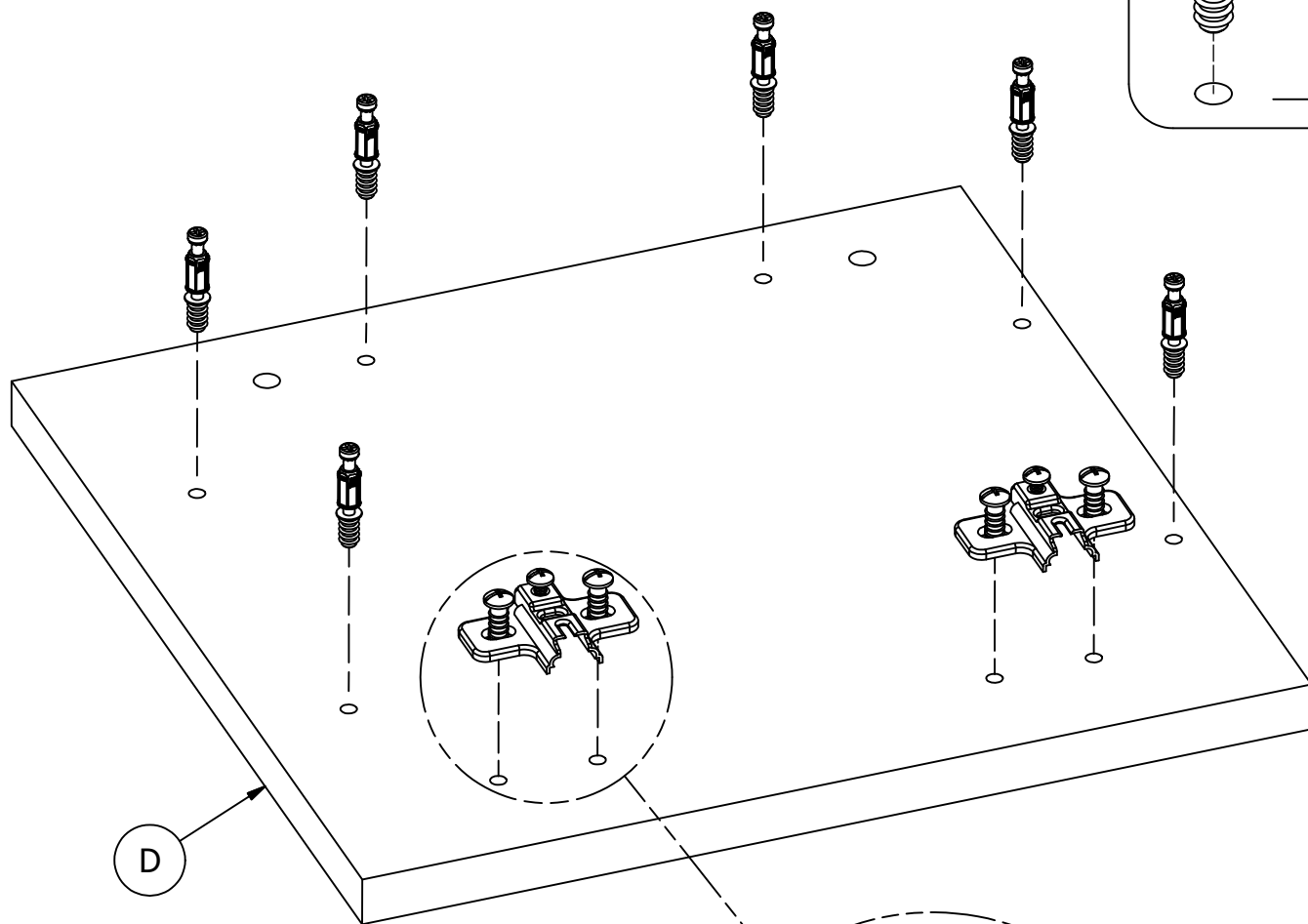
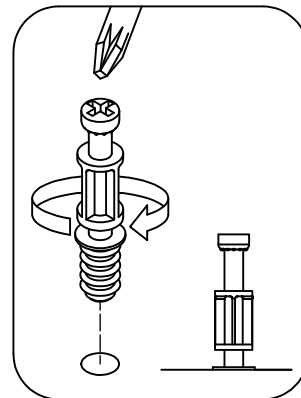

STEP 13

Assemble Panels

H181468US

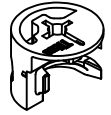

KD Cam3000

[4]

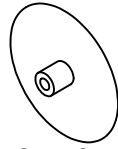

[4]

Cover Cap

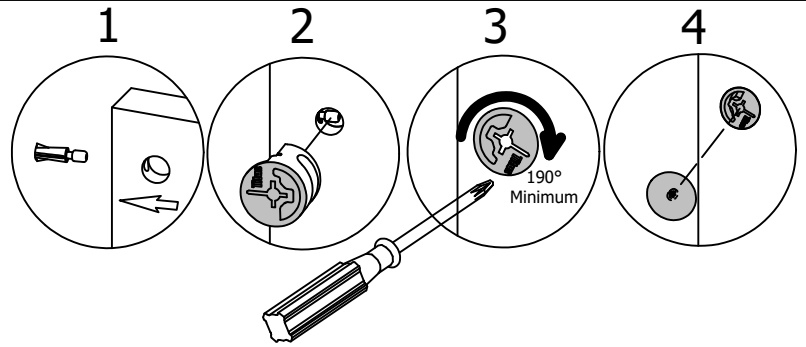

How to Tighten
KD Cams

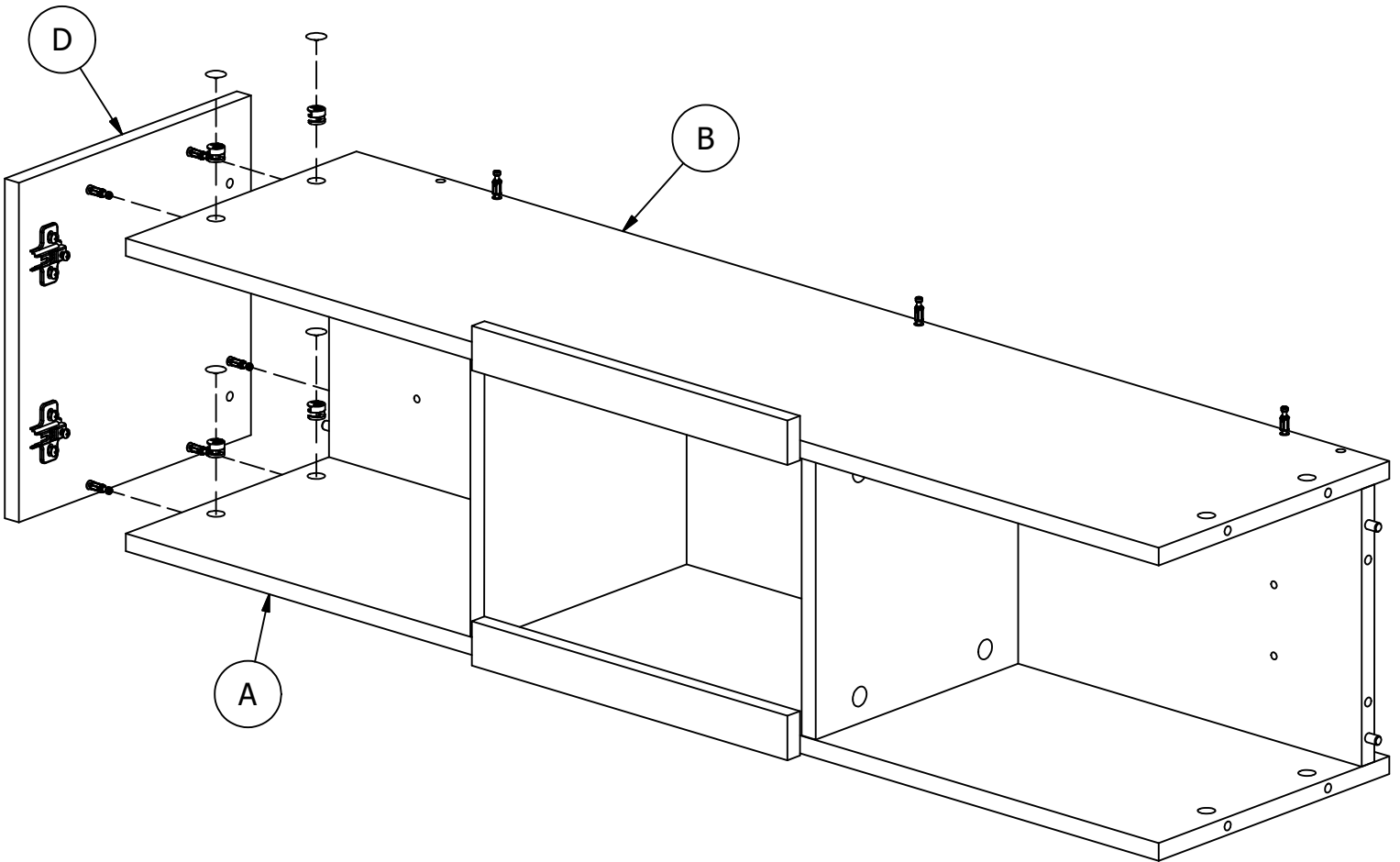
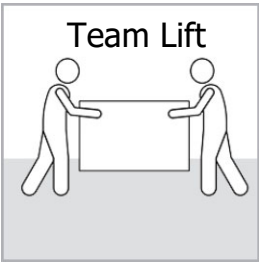

STEP 14

Prepare Panel

H72988 [6]
KD Bolt

H126758 [2]
Mounting Plate

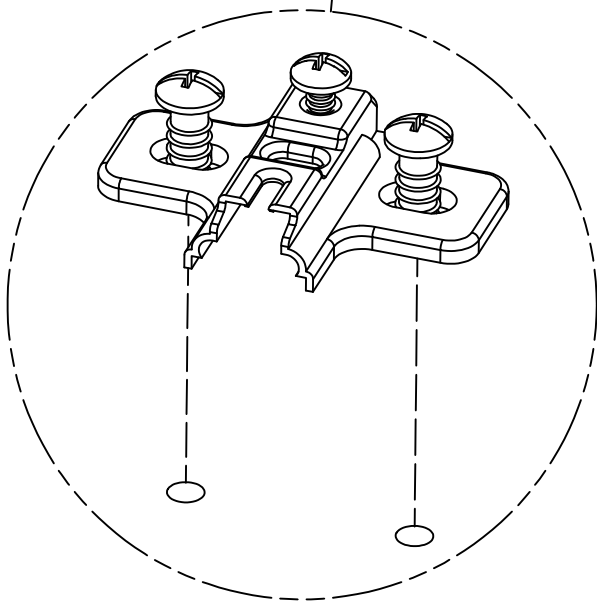
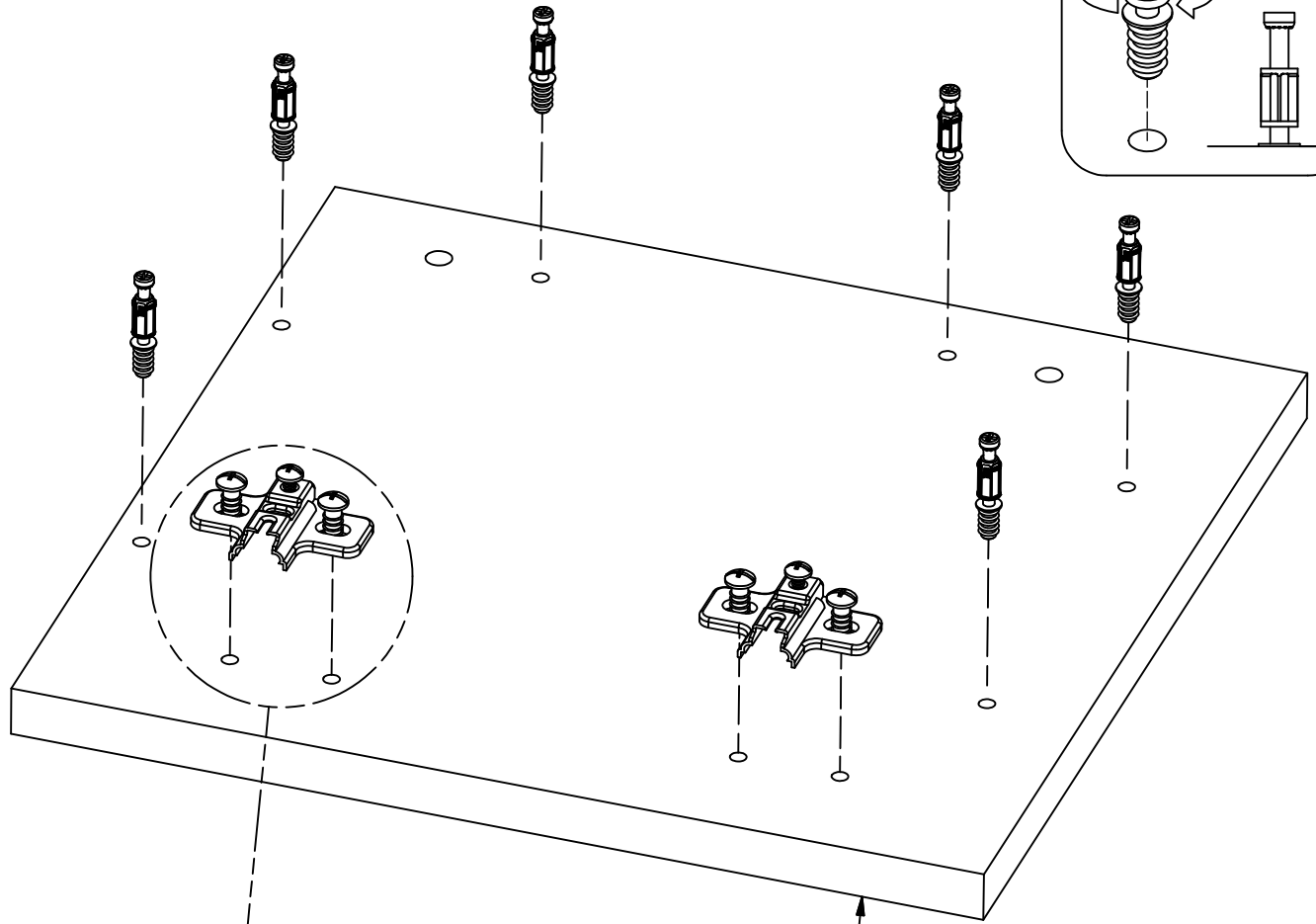
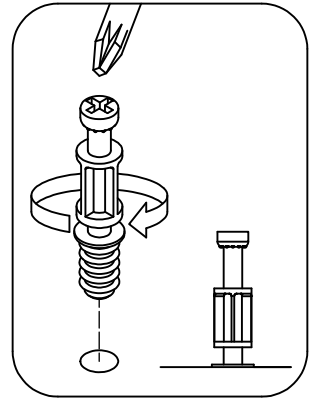

STEP 15

Assemble Panels

H181468US

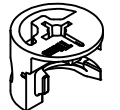

[4]

KD Cam3000

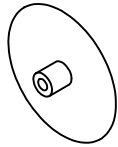
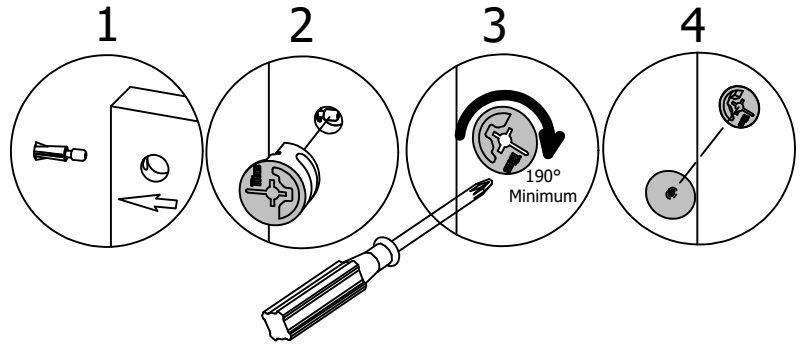

[4]

Cover Cap

How to Tighten
KD Cams

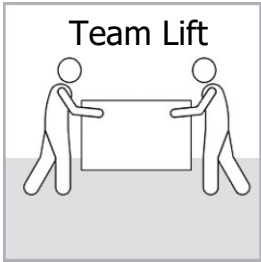

Team Lift

Q215563

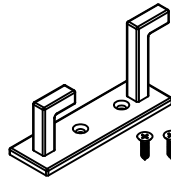

Silver

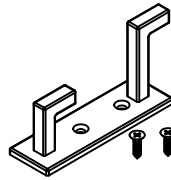

Gold

Coat Hook

[1 Set]

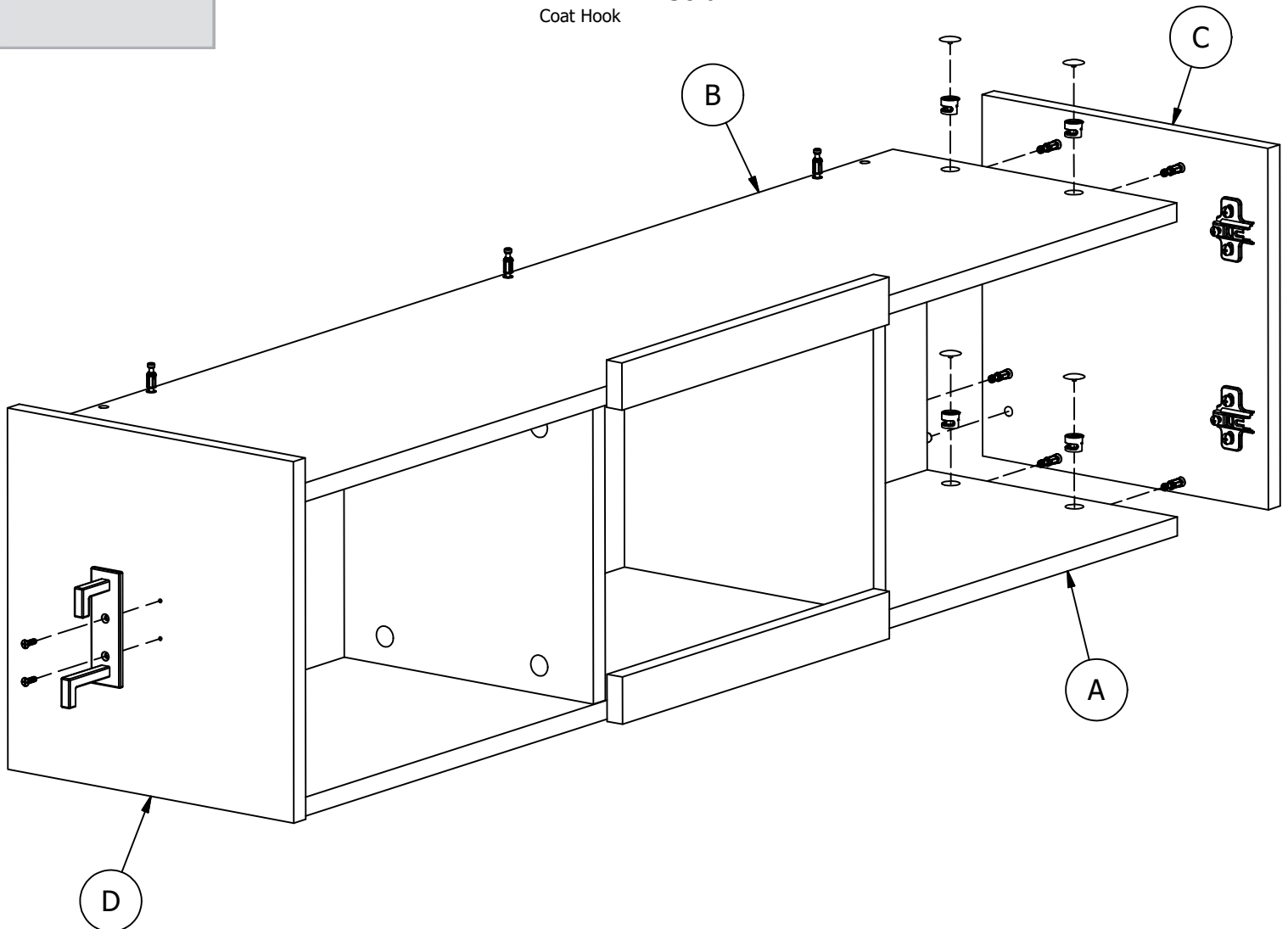

STEP 16

Prepare Panel

Q215563

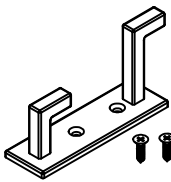

Silver

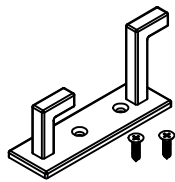

Gold

Coat Hook

[4 Sets]

H38169



Wood Dowel 8 x 30

[2]

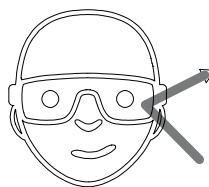
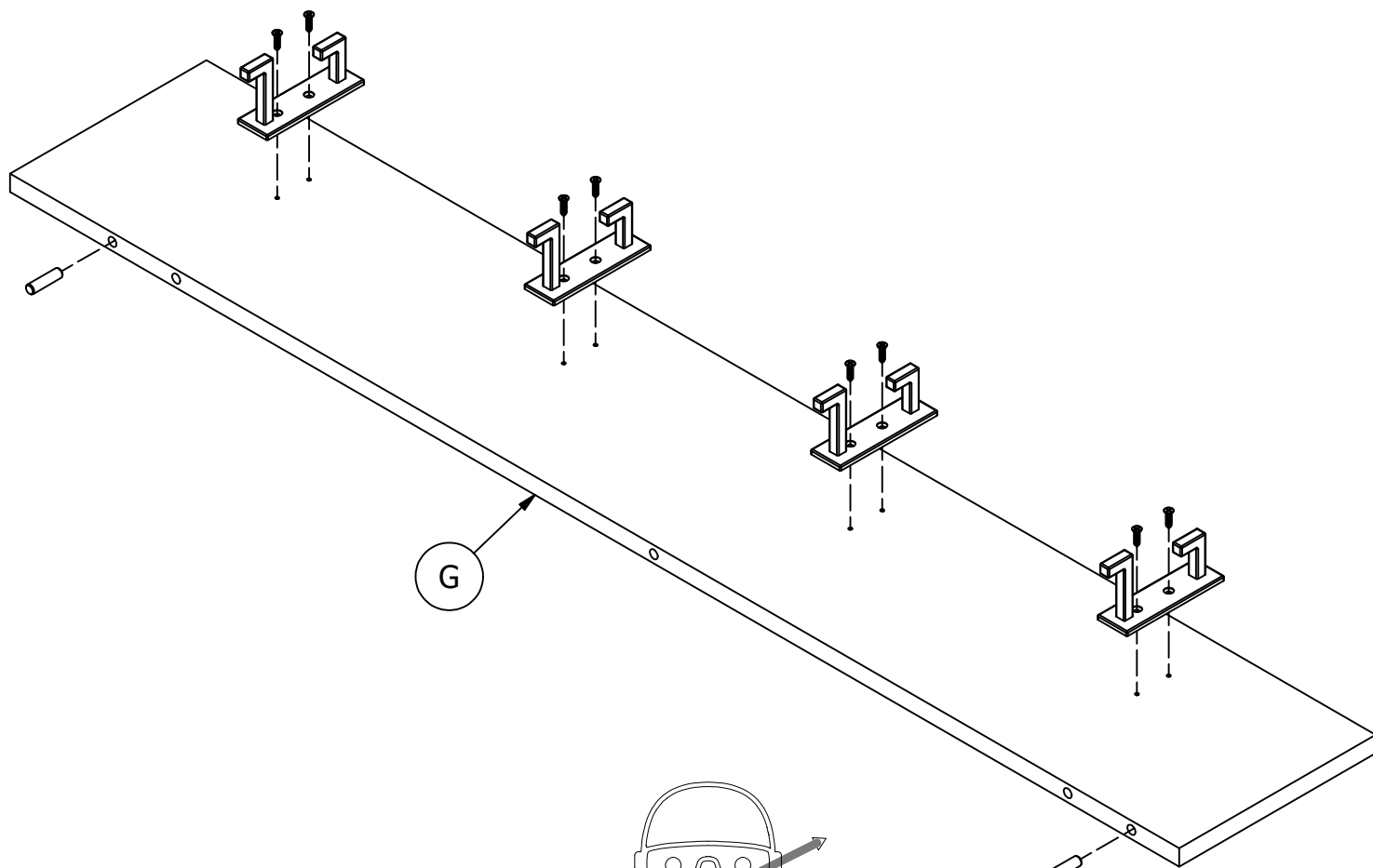

Safety glasses
Gafas de seguridad
Lunettes de protection



STEP 17

Assemble Panels

H181468US

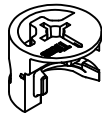

KD Cam3000

[7]

Q215563

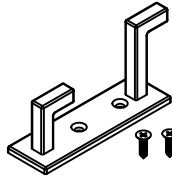

Silver

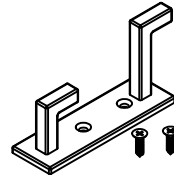

Gold

Coat Hook

[1 Set]

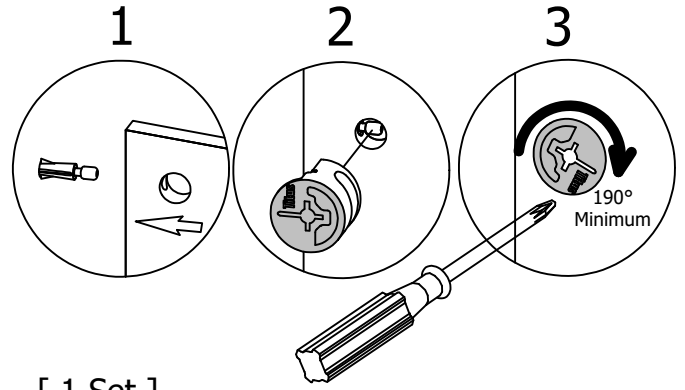

G

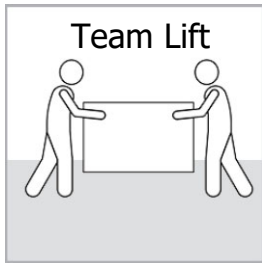

Team Lift

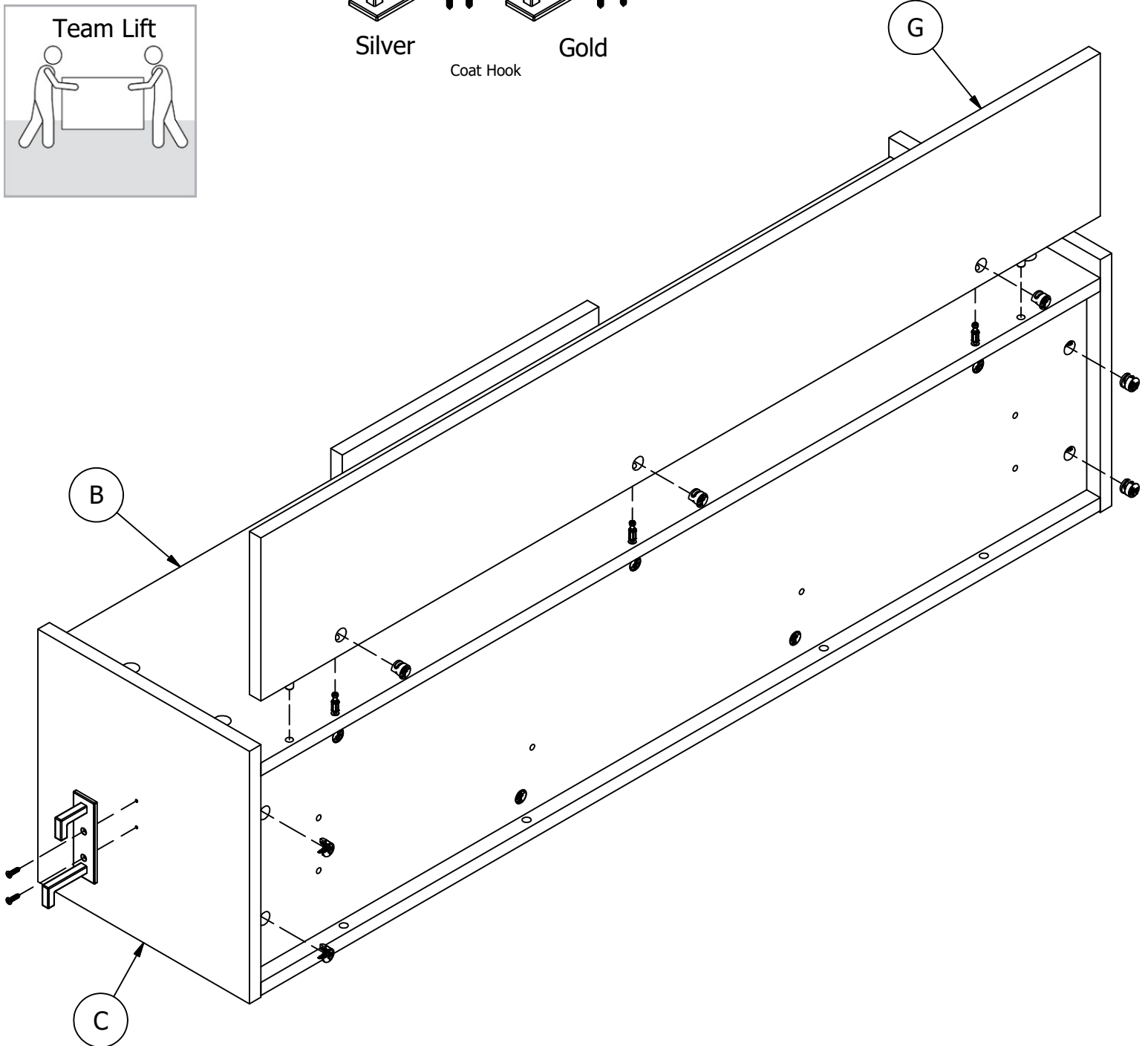

STEP 18

Prepare Panel

H38169



[4]

Wood Dowel 8 x 30

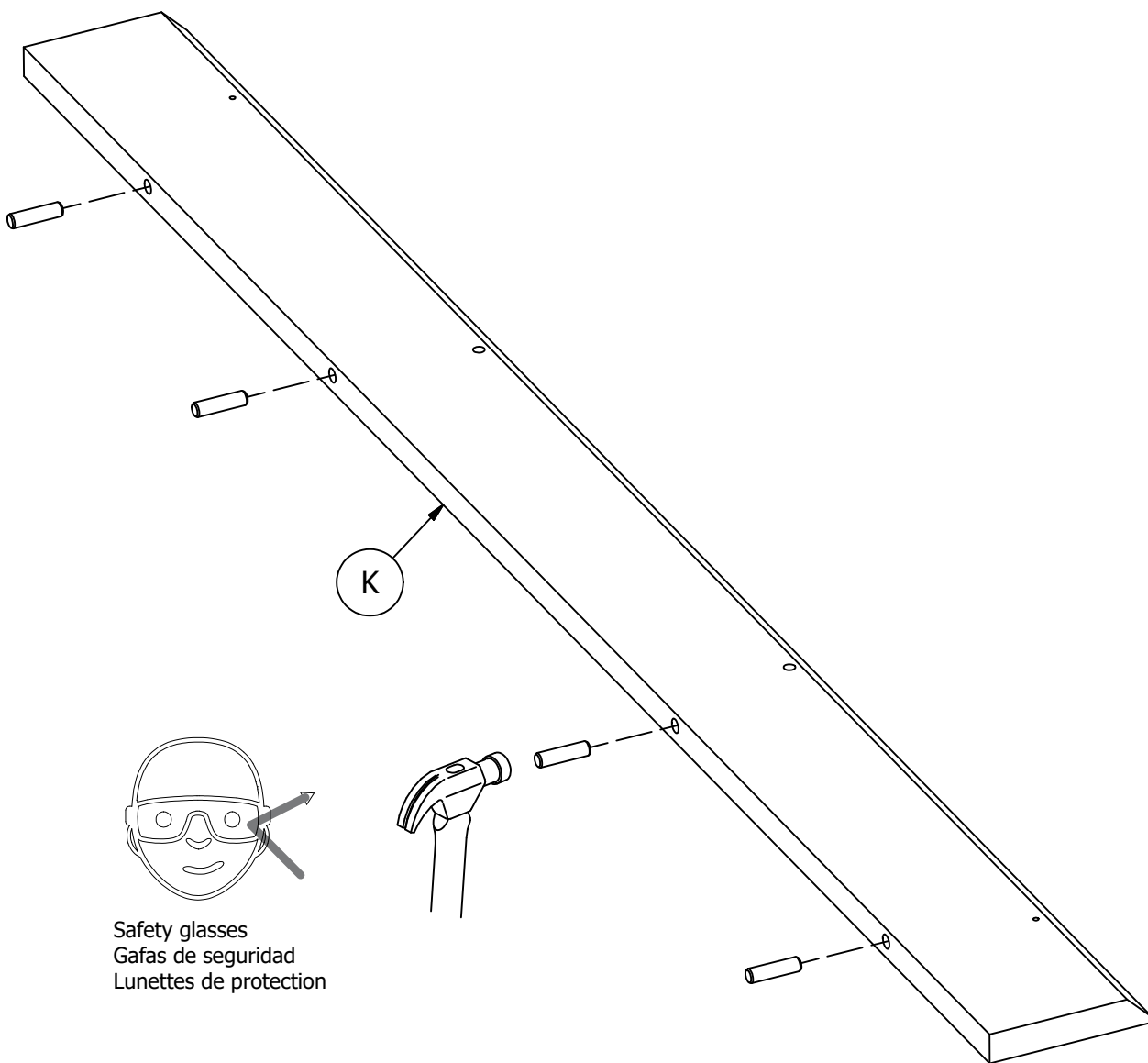

Safety glasses
Gafas de seguridad
Lunettes de protection

STEP 19

Assemble Panels

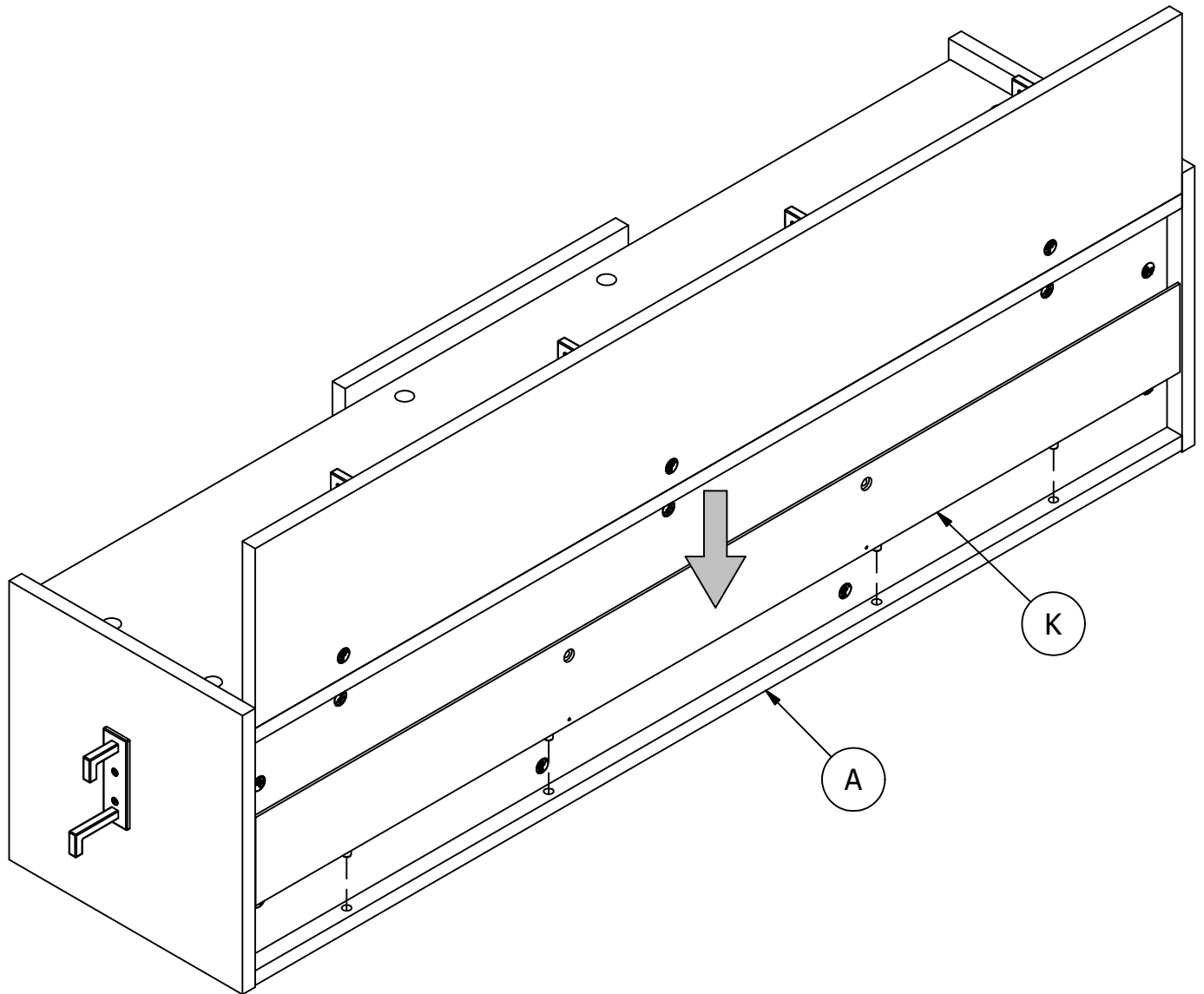

STEP 20

Install Hardware

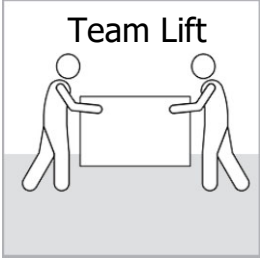

H193671 [2]
#10 x 2-3/4"

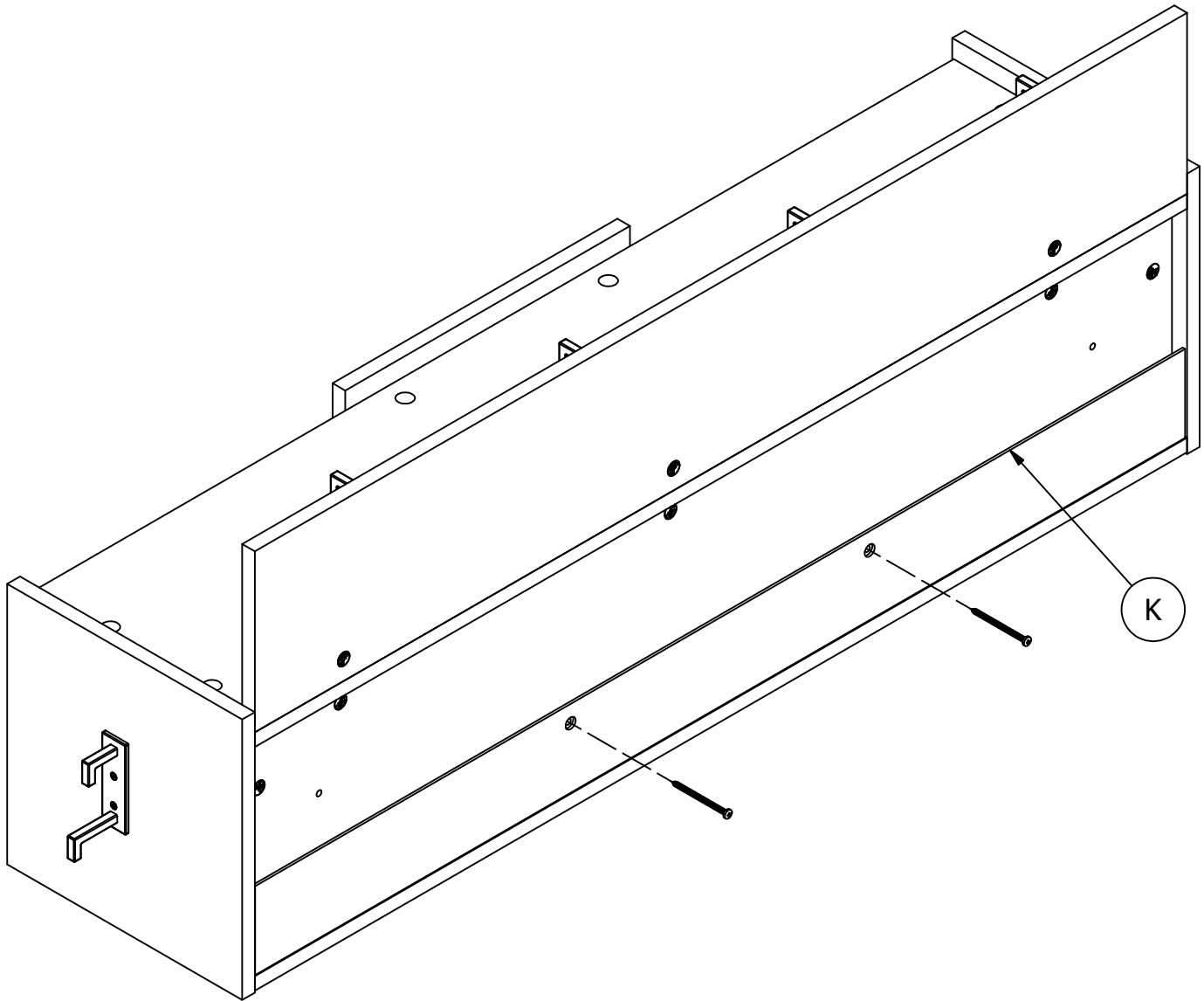
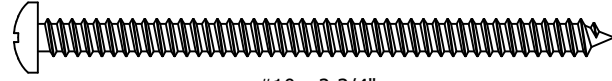

STEP 21

Install Hardware

H216499

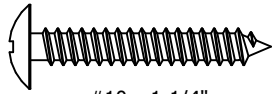

[2]

#10 x 1-1/4"

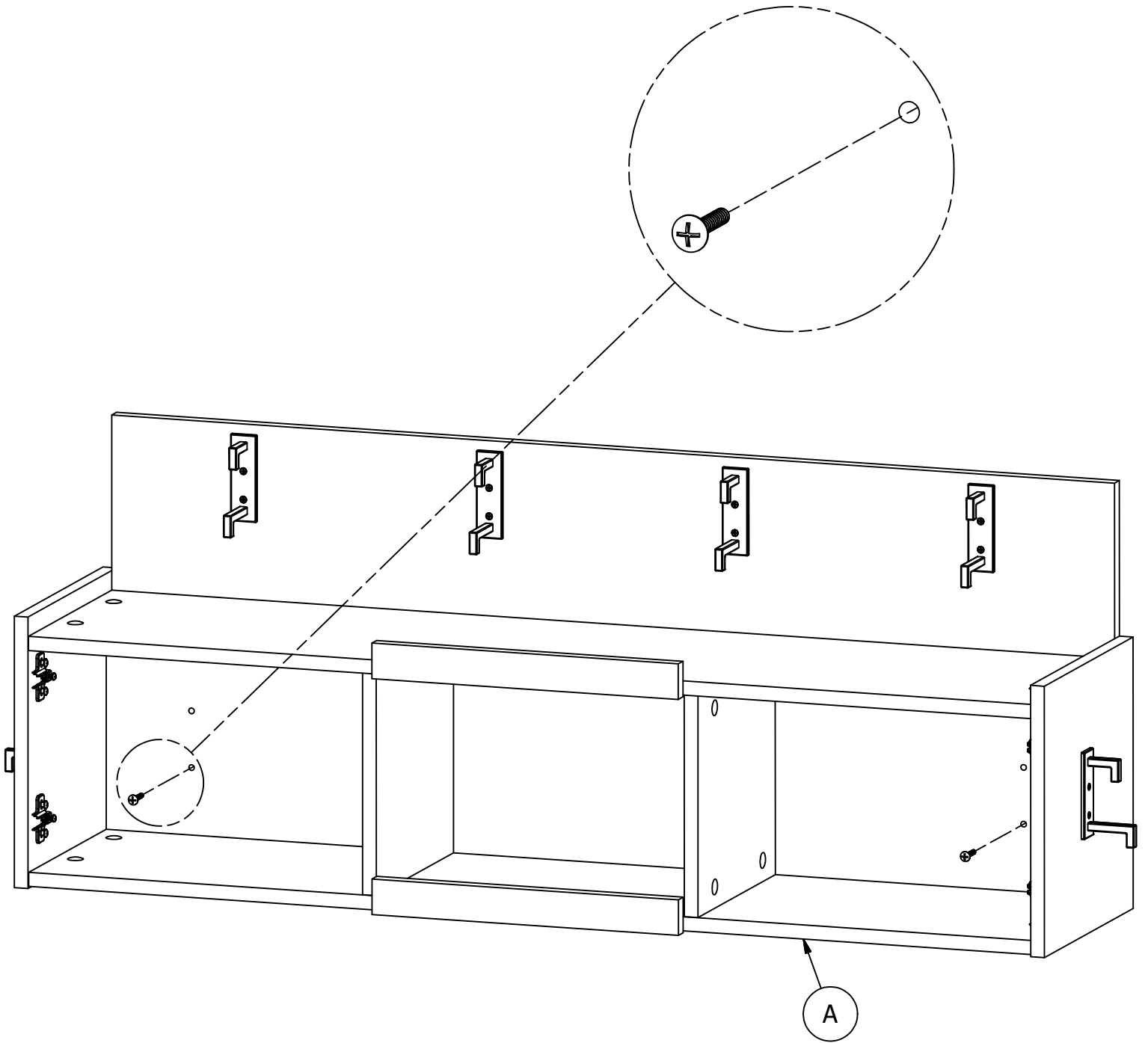

STEP 22

Wall Attachment

Secure unit to wall. Must be attached to 2 wall studs.

Cabinet is predrilled to attach to 2 wall studs 32" (813mm) apart. If this attachment method is not possible, please consult a professional installer.

Procedure:

1. Place unit in desired location.
2. Locate 2 wall studs 32" (813mm) apart nearest the center of cabinet.
3. Mark level line on wall where top shelf will be located.
4. Measure and mark 7-3/4" (198mm) down from top edge mark.
5. With an assistant align part L bottom edge with mark in step 4. Align holes with center of previously marked wall studs (step 2)
6. Insert H193671 screw into (4) mounting holes and push firmly or tap lightly with hammer to mark for drilling.
7. Set part L aside.

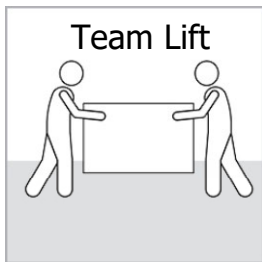

Stud Finder

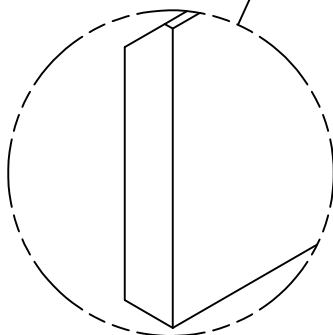

198mm
7-3/4"

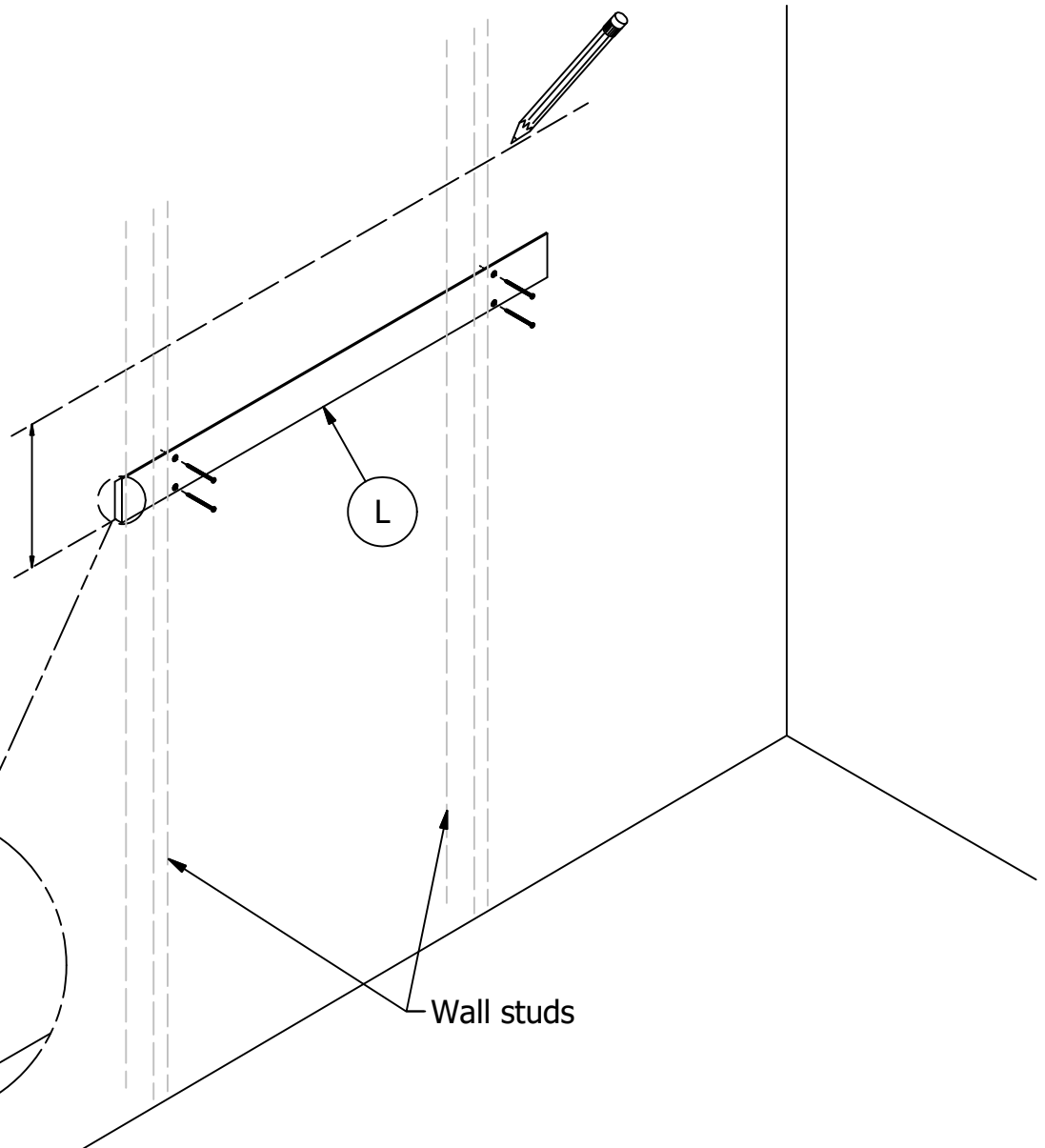

STEP 23

Wall Attachment

NOTE: There may be plumbing- or electrical lines in the wall of residential- and commercial buildings. Care must be taken when drilling into walls. If you are not confident in your installations abilities, please consult an installation professional.

8. Mark wall as shown in sketch below.
9. Drill 4x $\text{Ø}1/8''$ (3mm) holes 2" (50.8mm) deep at marked locations.

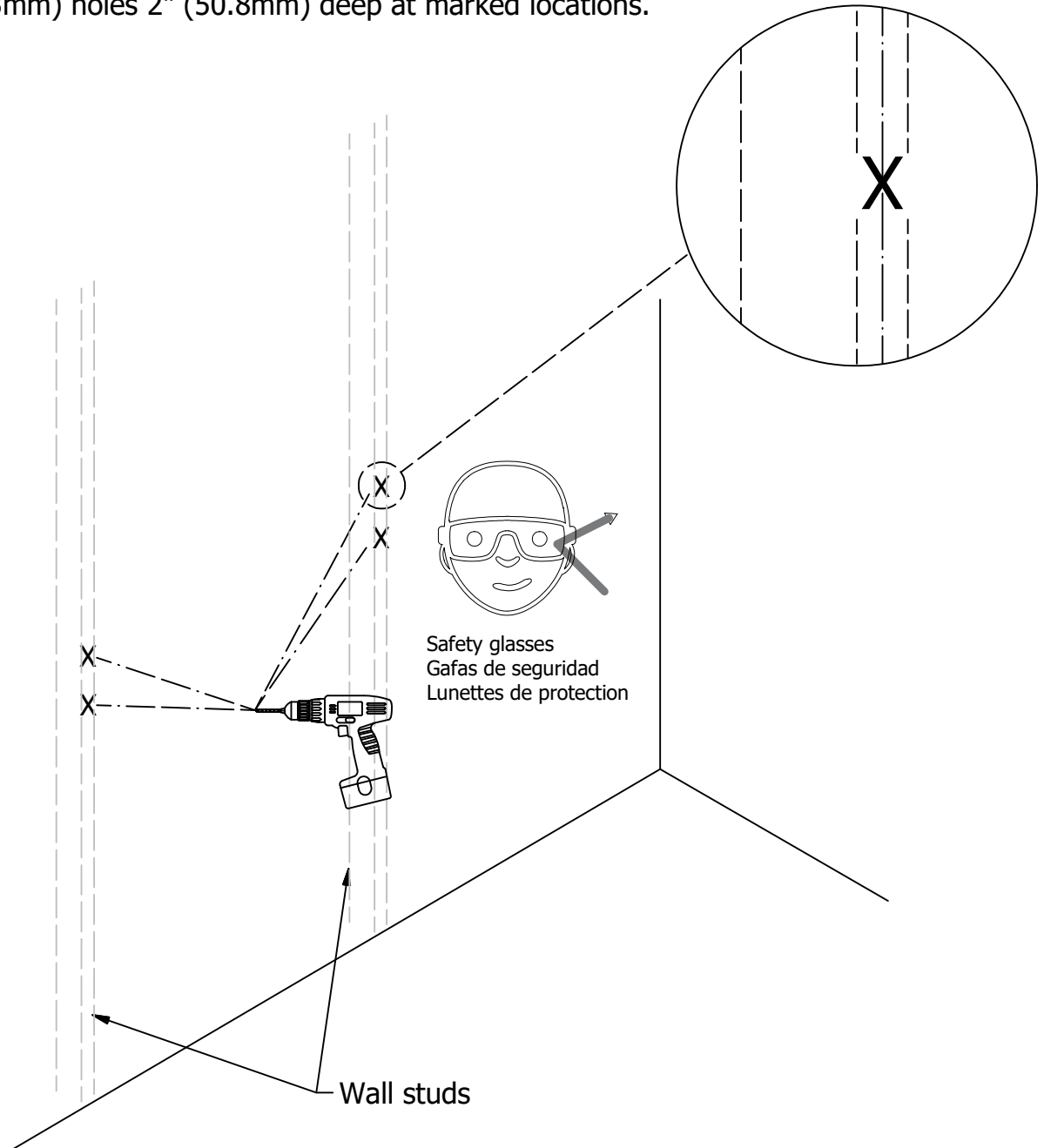

STEP 24

Wall Attachment

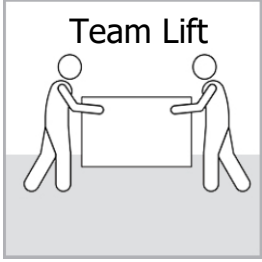

H193671

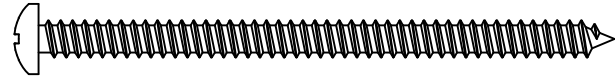

[4]

#10 x 2-3/4"

10. Align part L with previously drilled holes.
11. Attach part L using (4) H193671 screws.

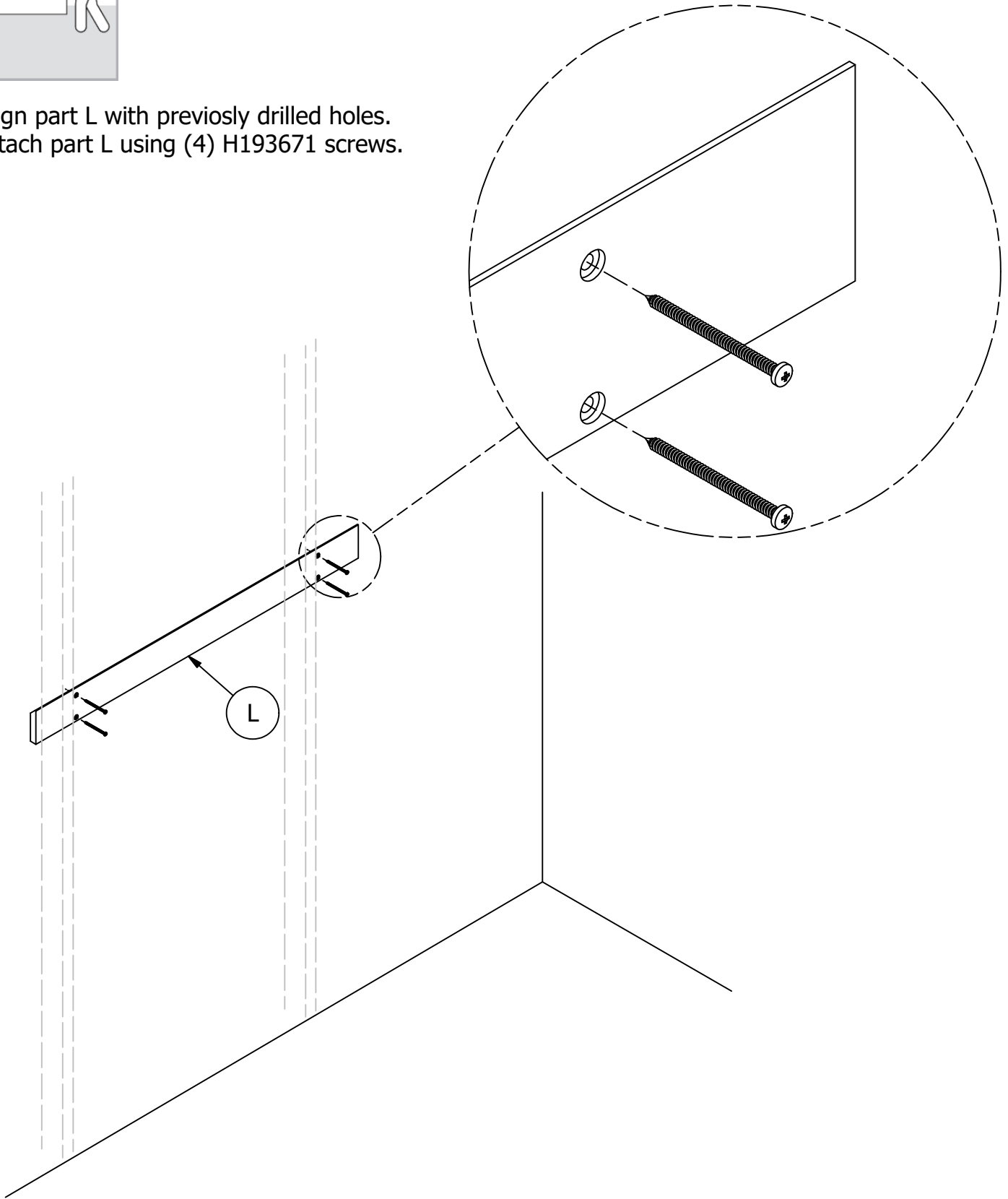

STEP 25

Wall Attachment

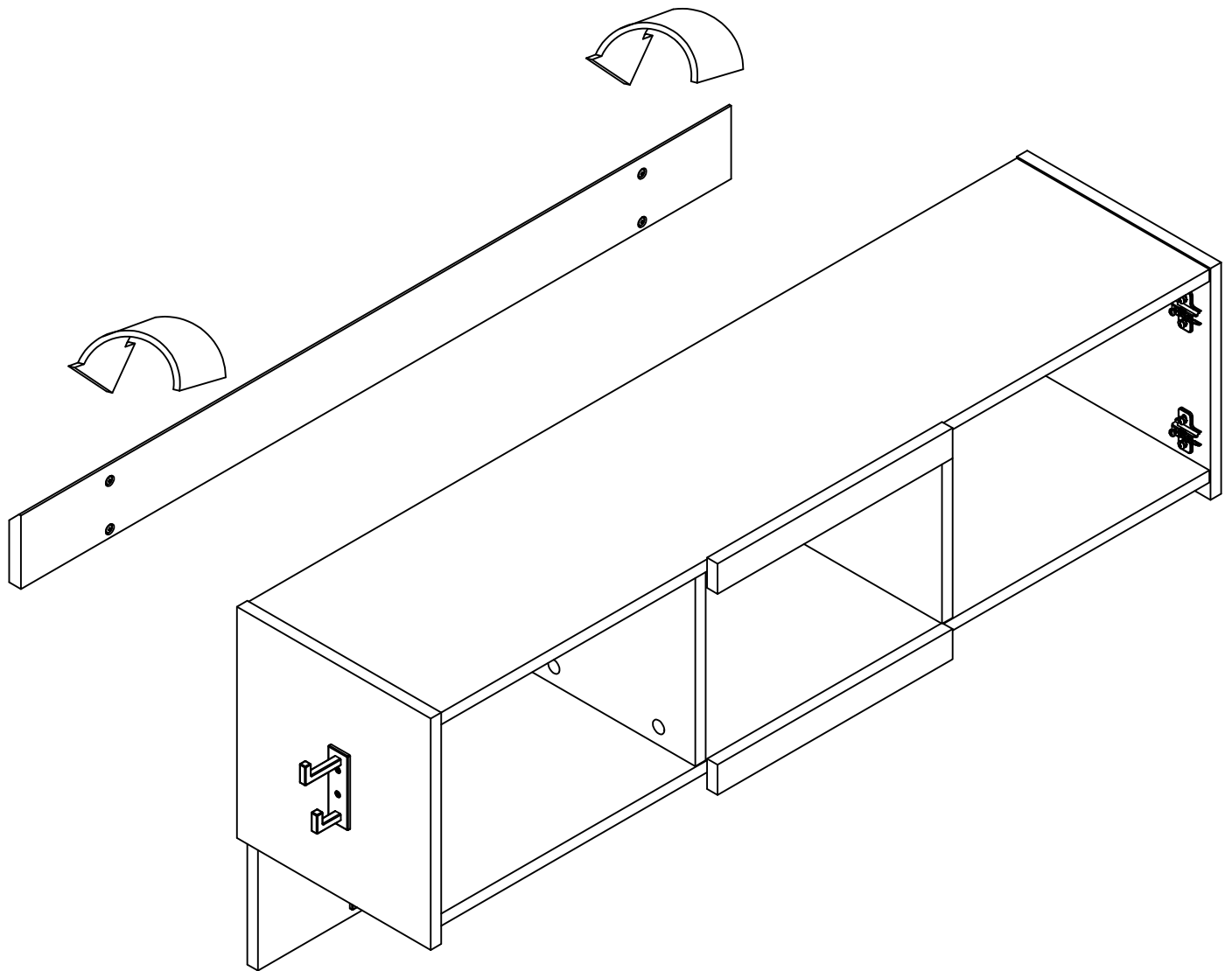
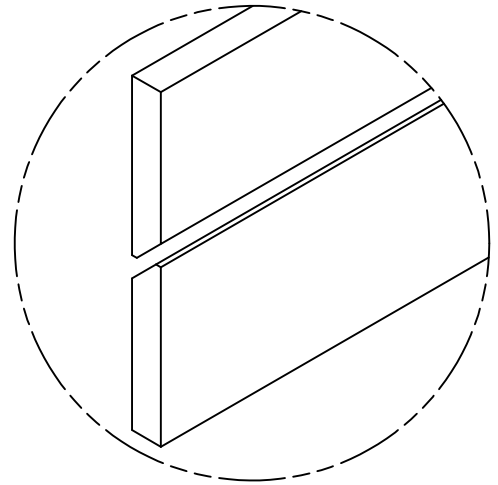
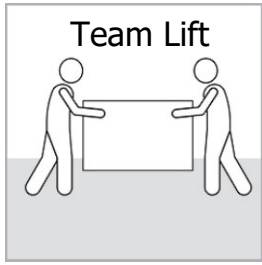

STEP 26

Install Hardware

H216499

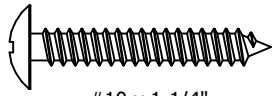

[2]

#10 x 1-1/4"

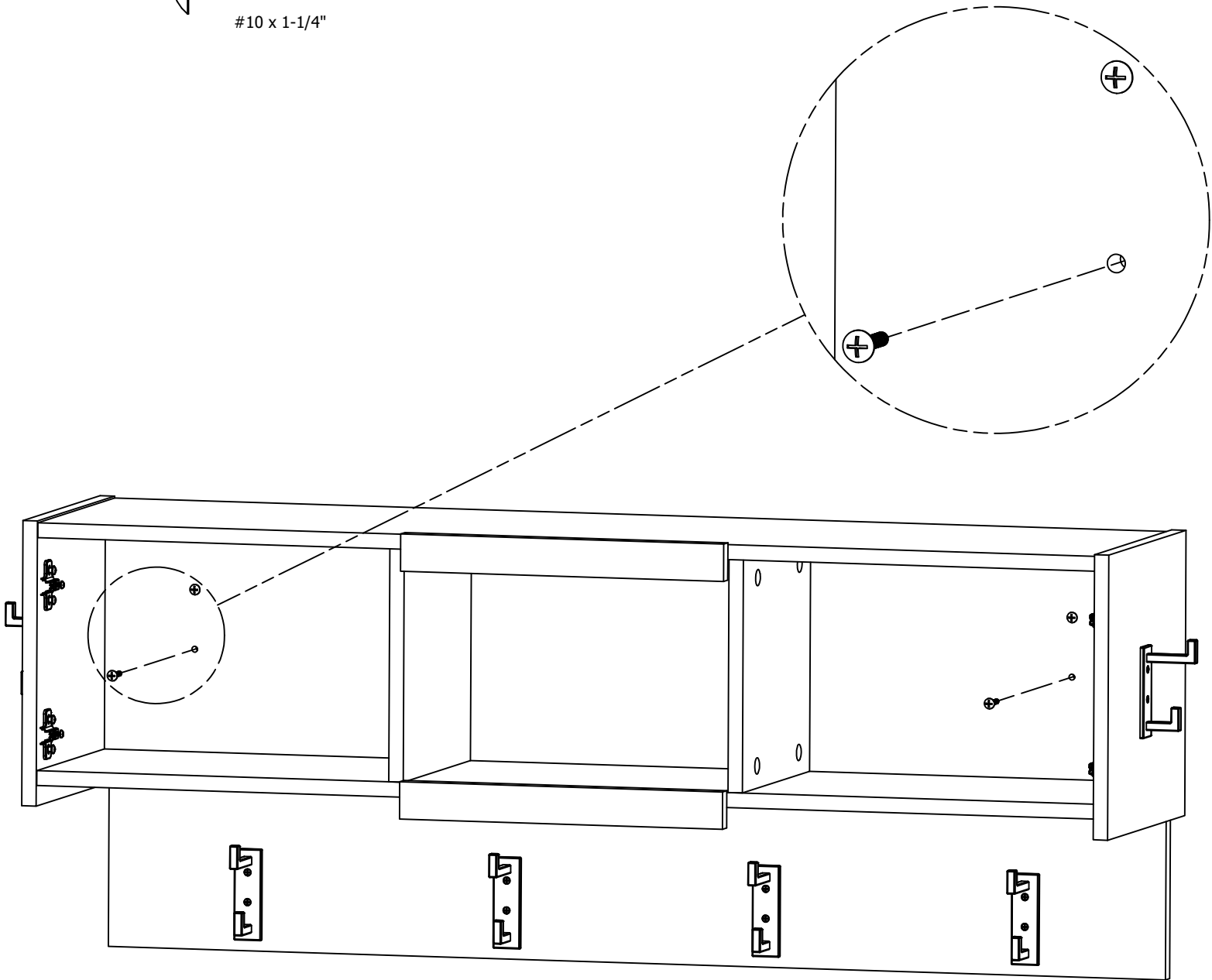

STEP 27

Install Panels

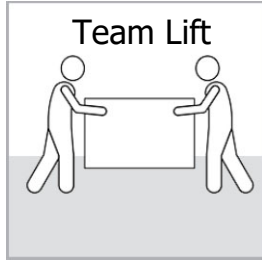

How to Adjust
Door Hinges

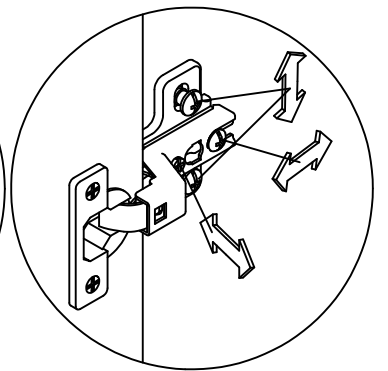
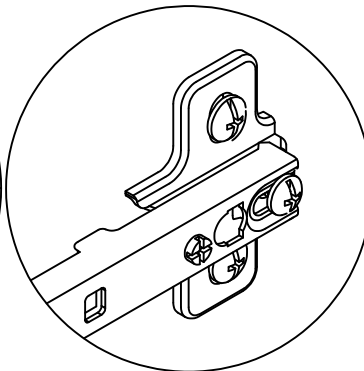
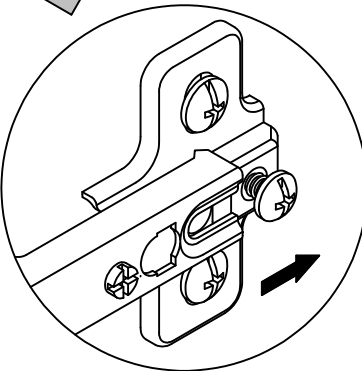
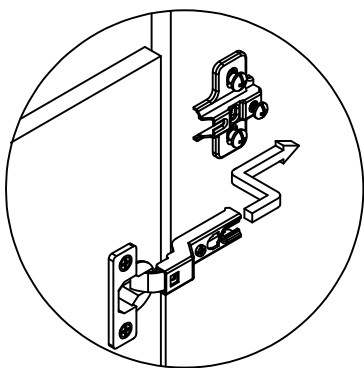
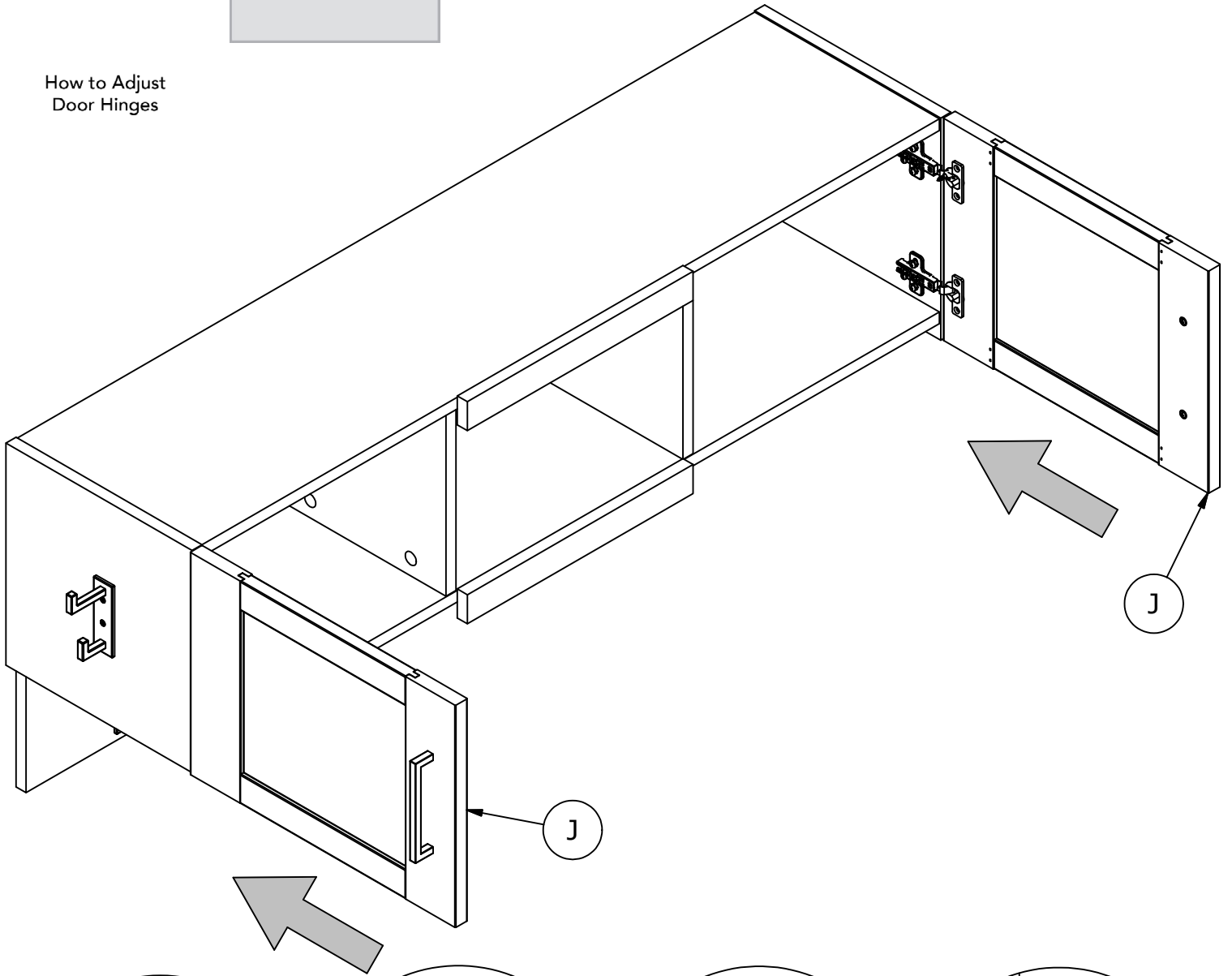

STEP 28

Maximum Loading and Cleaning

Gently clean surfaces
with a damp sponge eraser.

H215406

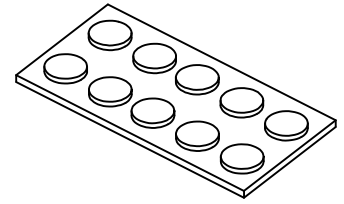

[1]

Bumper (10) per pack

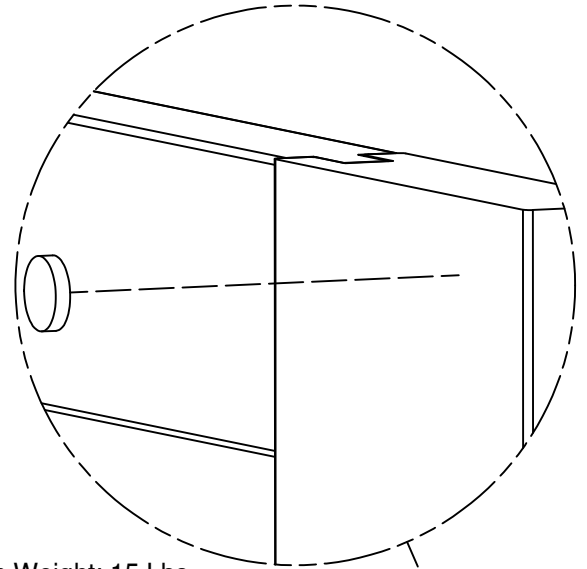

Maximum Weight: 0 Lbs.
Peso Máximo: 0 Libras
Poids Maximum: 0 kilogramme

Maximum Weight: 15 Lbs.
Peso Máximo: 15 Libras
Poids Maximum: 6.7 kilogramme

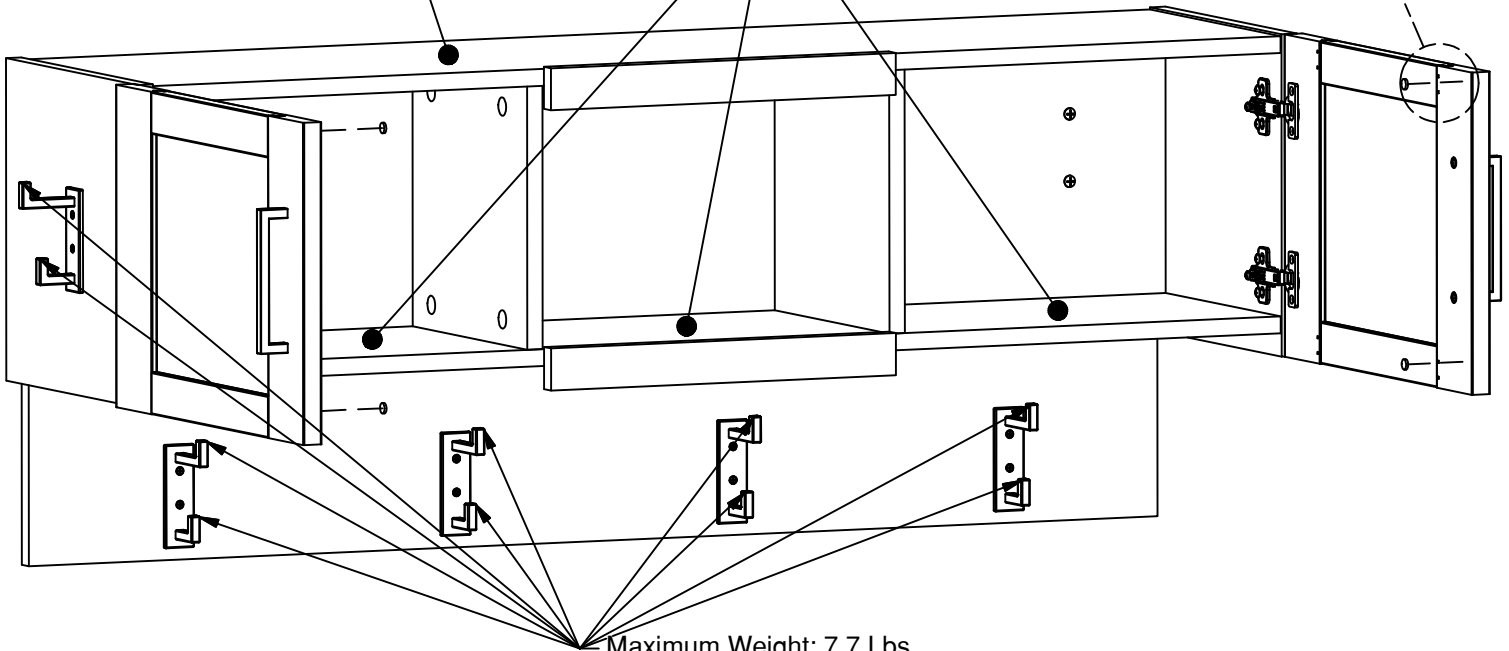

Maximum Weight: 7.7 Lbs.
Peso Máximo: 7.7 Libras
Poids Maximum: 3.4 kilogramme

Congratulations! You are all done. If
you have any questions or concerns,
please call.

PARTS LIST

HHH348WH		
LABEL	QTY	PART NUMBER
A	1	W215877
B	1	W215878
C	1	W215879
D	1	W215880
E	2	W215881
F	1	W215882
G	1	W215883
I	2	W215884
J	2	S215885
K	1	W216420
L	1	W216421

H73619

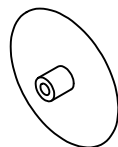

[20]

Cover Cap

El armario está pretaladrado para fijarse a 2 montantes de pared separados 32" (813mm).

Si este método de fijación no es posible, consulte a un instalador profesional.

Procedimiento:

1. Coloque la unidad en la ubicación deseada.
2. Ubique 2 montantes de pared a 32" (813mm) de distancia más cercanos al centro del gabinete.
3. Marque la línea de nivel en la pared donde se ubicará el estante superior.
4. Mida y marque 7-3/4" (198mm) hacia abajo desde la marca del borde superior.
5. Con un ayudante, alinee la parte L del borde inferior con la marca del paso 4. Alinee los agujeros con el centro de montantes de la pared previamente marcados (paso 2)
6. Inserte el tornillo H193671 en los (4) orificios de montaje y presione firmemente o golpee ligeramente con un martillo para marcar para taladrar.
7. Ponga la parte L a un lado.

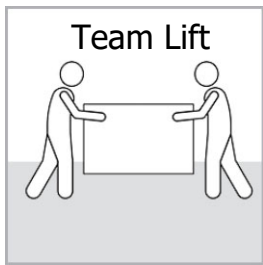

Elevación de equipo

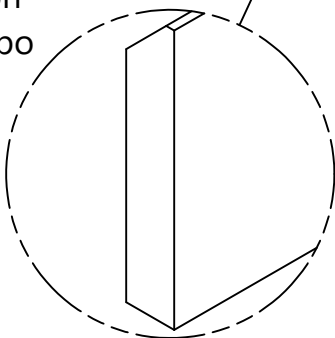

198mm
7-3/4"

L

Montantes de pared

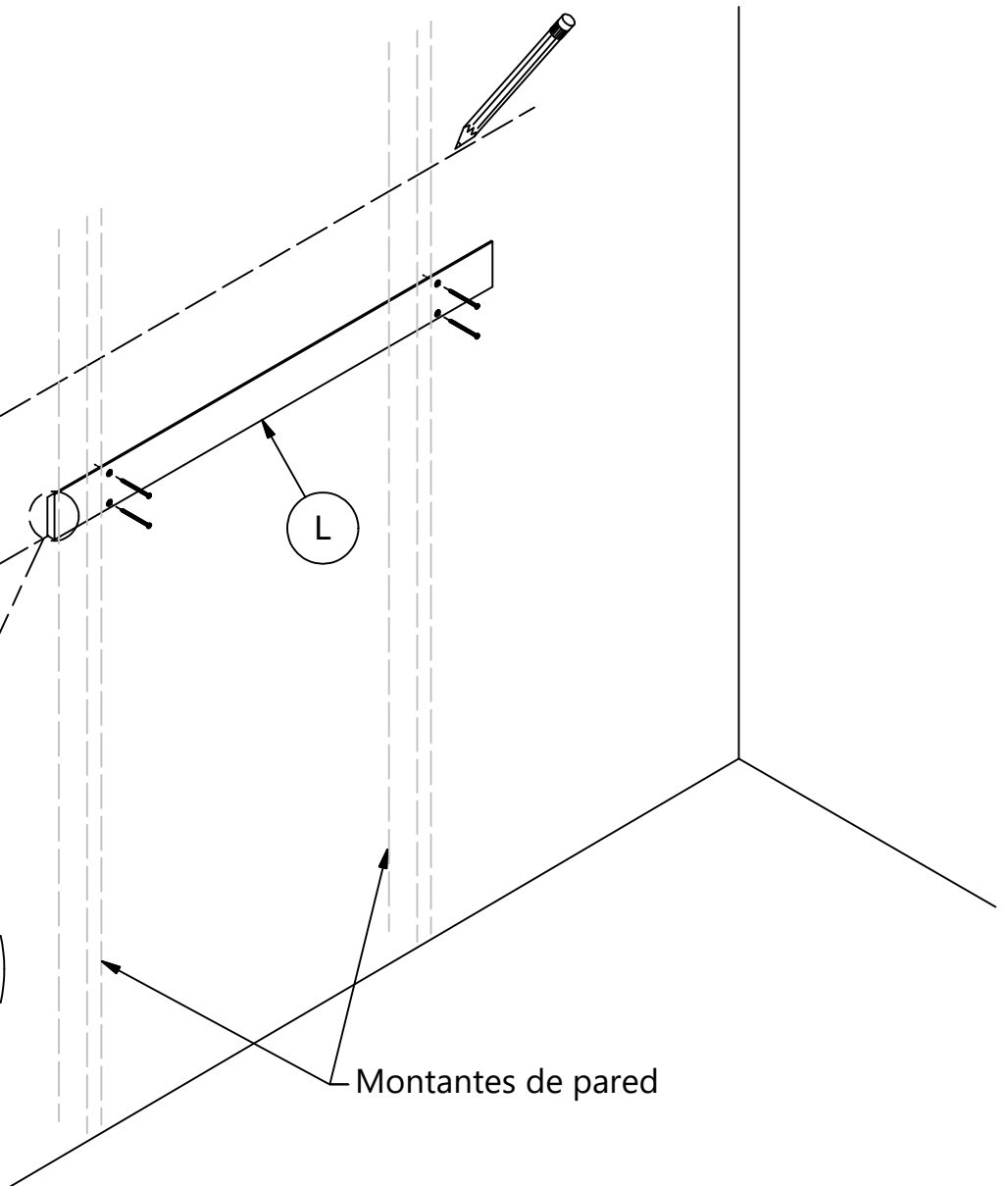

STEP 23 ES

Fijación a la pared

NOTA: En las paredes de edificios residenciales y comerciales puede haber conductos de fontanería o eléctricos. Se debe tener cuidado al taladrar en las paredes. Si no está seguro de sus habilidades de instalación, consulte a un instalador profesional.

8. Marque la pared como se muestra en el croquis de abajo.
9. Taladre 4 agujeros de $\text{Ø}1/8"$ (3 mm) y 2" 950.8mm) de profundidad en los puntos marcados.

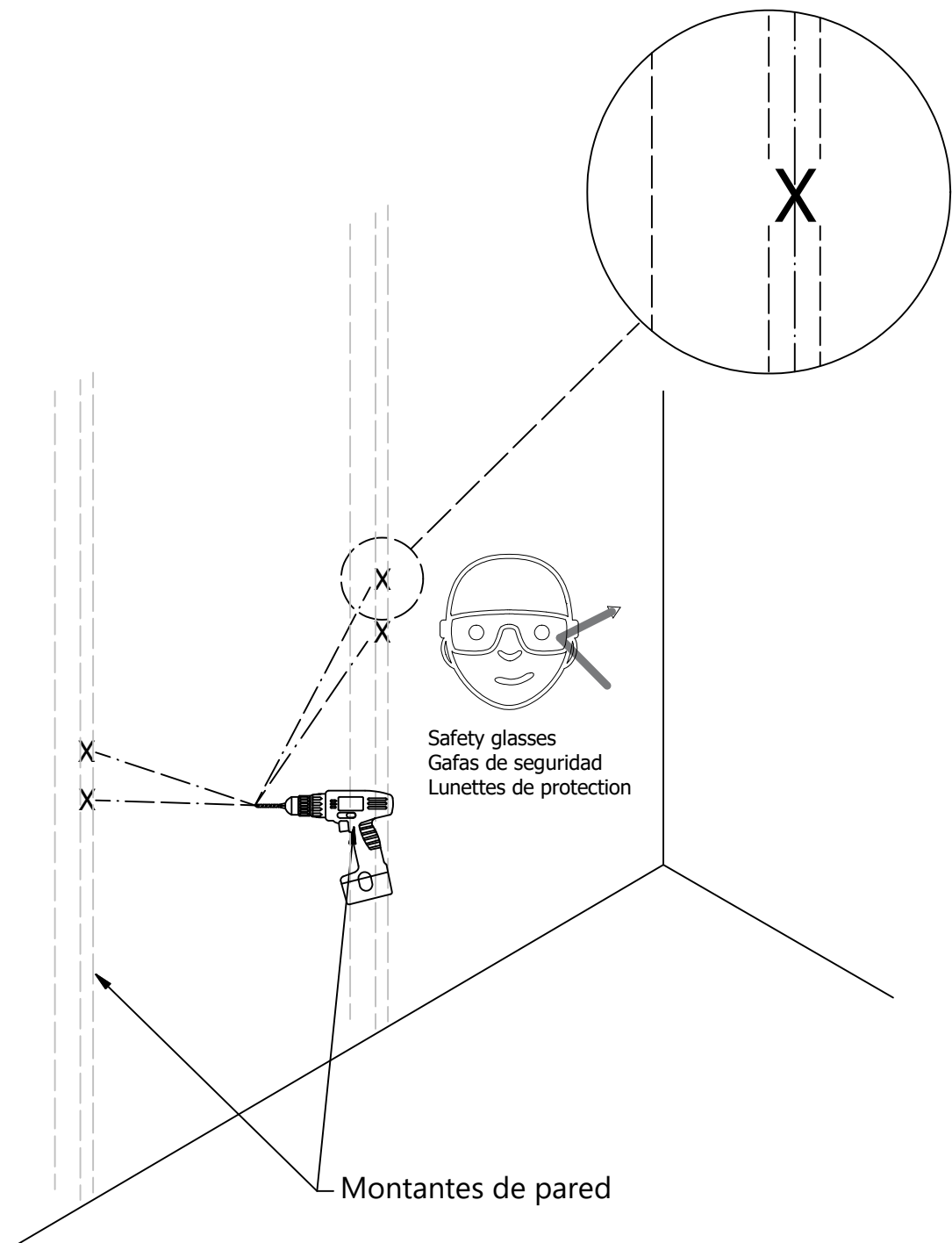

STEP 24 ES

Fijación a la pared

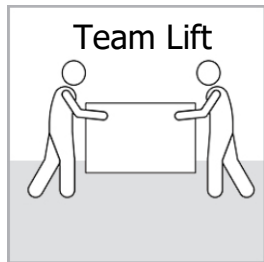

H193671  [4]
#10 x 2-3/4"

10. Alinee la pieza L con los orificios previamente taladrados.
11. Fije la parte L usando (4) tornillos H193671.

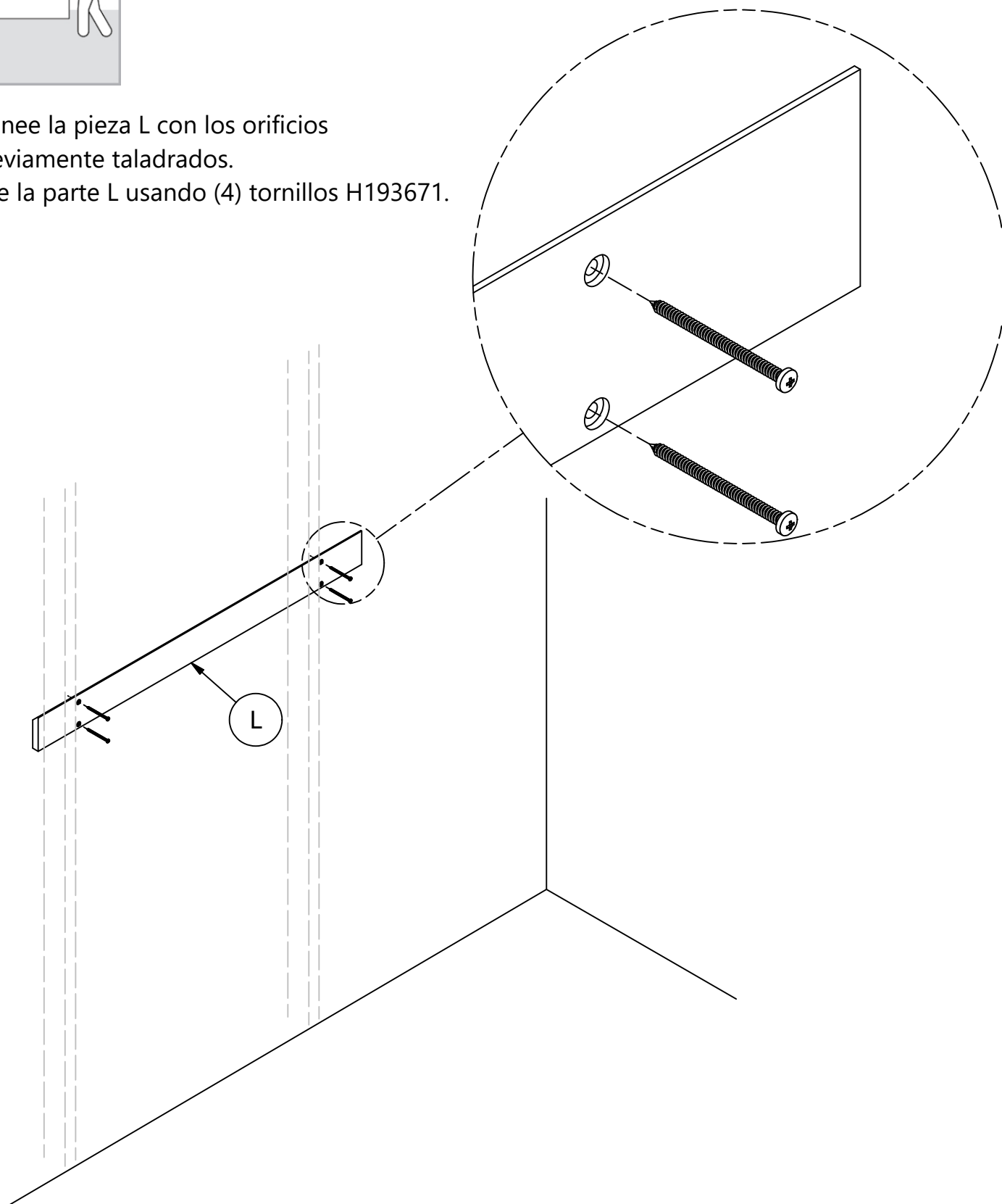

Fixation de l'armoire au mur. Elle doit être fixée à 2 montants muraux.

L'armoire est pré-percée pour être fixée à 2 montants muraux espacés de 32" (813 mm). Si cette méthode de fixation n'est pas possible, veuillez consulter un installateur professionnel.

Procédure à suivre :

1. Placez l'armoire à l'endroit souhaité.
2. Repérez 2 montants muraux à 32" (813 mm) de distance, le plus près possible du centre de l'armoire.
3. Tracez une ligne de niveau sur le mur à l'emplacement de l'étagère supérieure.
4. Mesurez et marquez 7-3/4" (198 mm) à partir de la marque du bord supérieur.
5. Avec l'aide d'un assistant, alignez la partie L du bord inférieur avec la marque de l'étape 4. Alignez les trous avec le centre des montants muraux marqués précédemment (étape 2)
6. Insérez la vis H193671 dans les (4) trous de montage et poussez fermement ou frappez légèrement avec un marteau pour marquer les trous pour le perçage.
7. Mettre la partie L de côté.

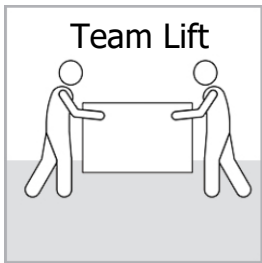

Levez en
équipe

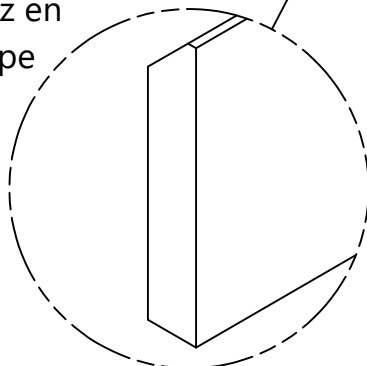

198mm
7-3/4"

L

Montants muraux

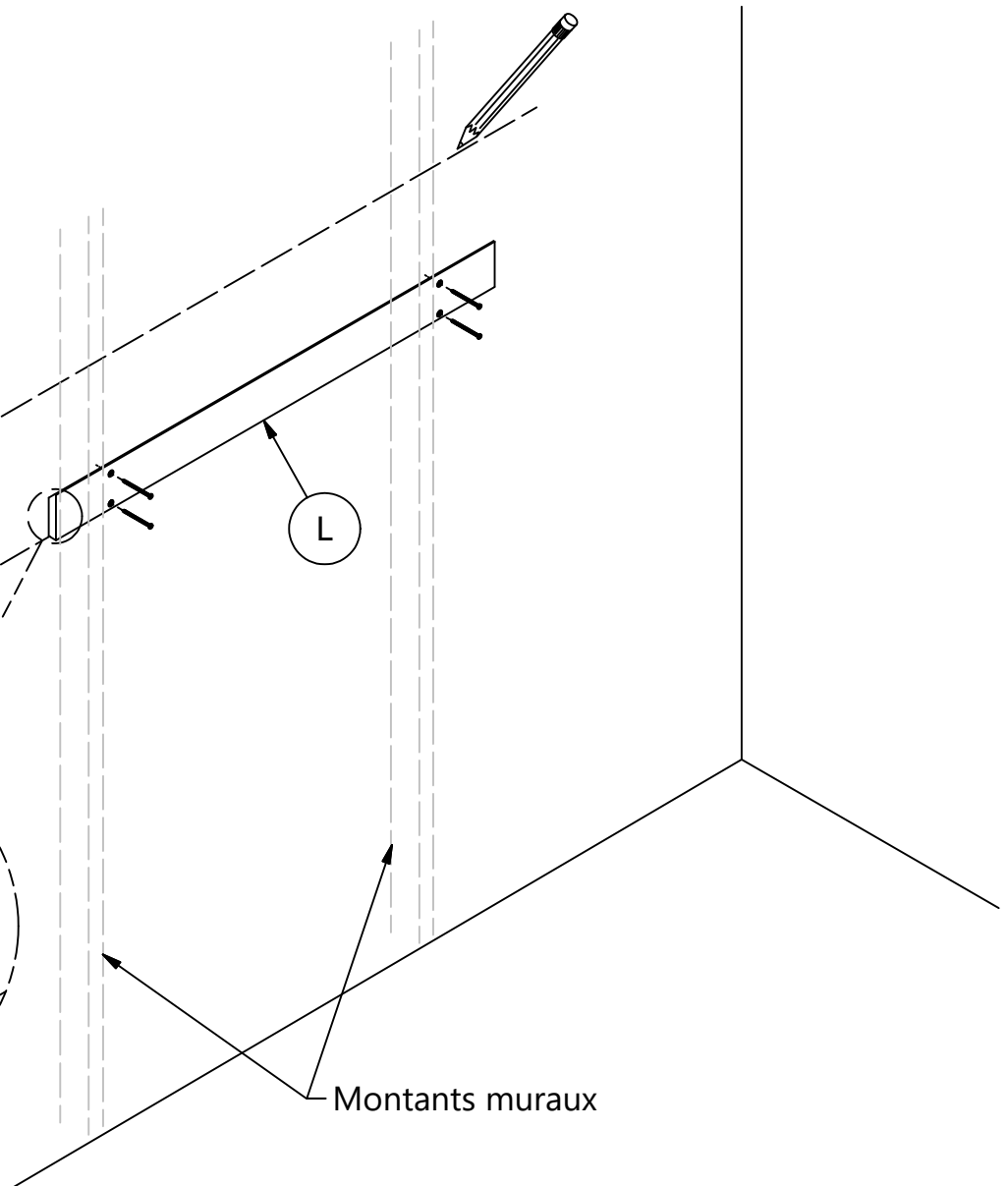

STEP 23 FR

Fixation au mur

Il peut y avoir des conduites de plomberie ou d'électricité dans les murs des bâtiments résidentiels et commerciaux. Des précautions doivent être prises lors du perçage des murs. Si vous n'êtes pas confiant de vos capacités d'installation, veuillez consulter un professionnel de l'installation.

8. Marquez le mur comme indiqué sur le croquis ci-dessous.

9. Percez 4x trous de $\text{Ø}1/8''$ (3mm) d'une profondeur de 2" (50.8mm) aux endroits marqués.

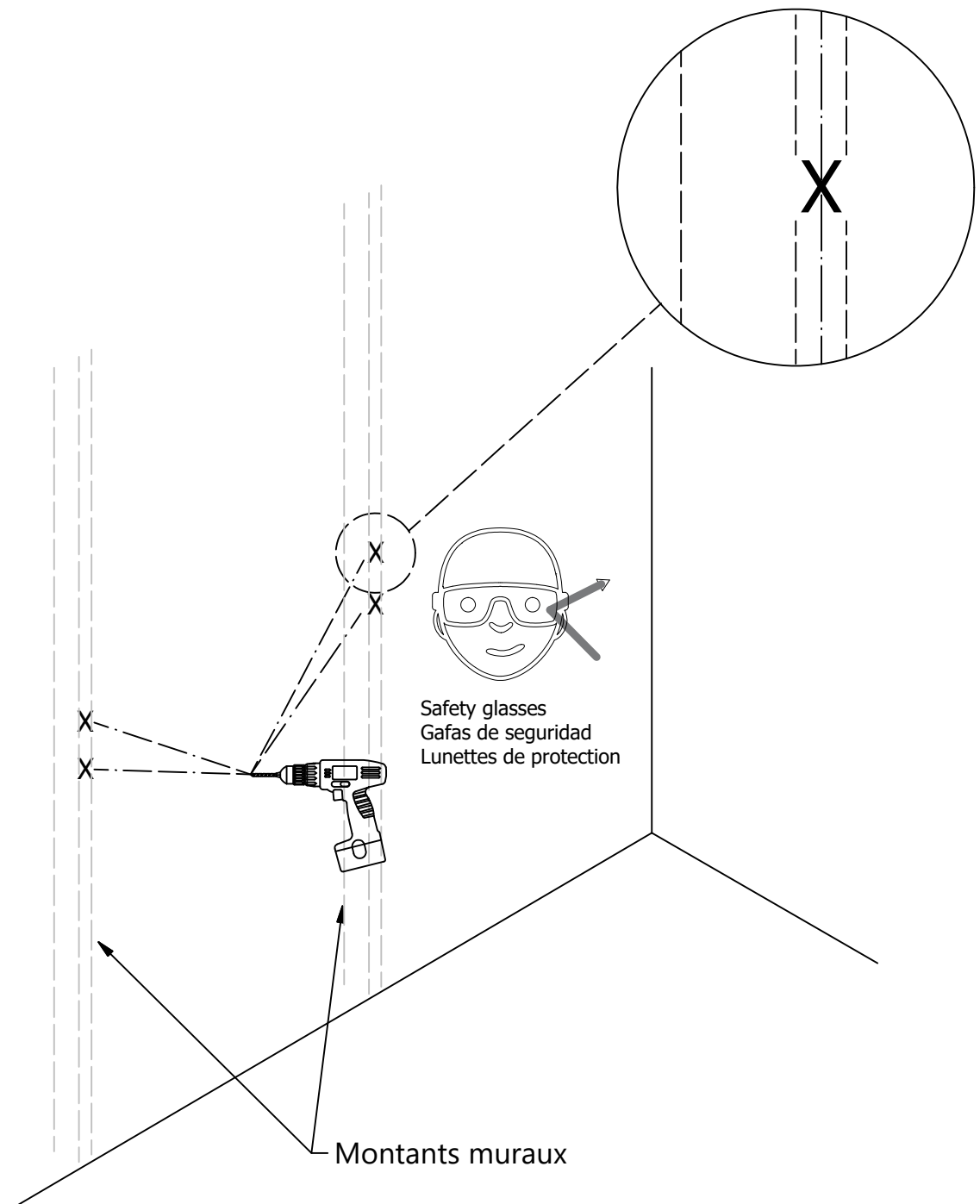

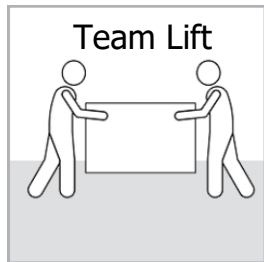

H193671



[4]

#10 x 2-3/4"

10. Alignez la pièce L avec les trous précédemment percés.

11. Fixez la partie L à l'aide de (4) vis H193671.

