

# BEFORE INSTALLATION

Thank you for choosing \_\_\_\_\_ products. To ensure the best possible experience, **please read carefully and follow the instructions provided below before assembling and installing the product.**

## ① Important Safety Instructions:

- Assemble the product by two or more adults to ensure proper installation.
- To connect the wires to the electrical junction box, consultation with a qualified technician or electrician is highly recommended.
- Disconnect power before installing, adding, or changing any components.
- Make sure that the fixing location can support the weight of the entire fixture (e.g. solid stone or brick walls).
- To prevent injury, the mirror must be installed according to the instructions provided.

## ② Pre-assembly:

- Inspect the product immediately upon receipt for any transit damage or missing parts.
- The voltage for your \_\_\_\_\_ product should be between 100V and 120V. If the voltage exceeds 120V, please use a transformer.
- You can connect the wires directly to your junction box or plug.
- Do not remove the transparent silicone protector until the installation is complete.

## ③ Before Installation:

Please check and make sure that the mirror is functioning properly.

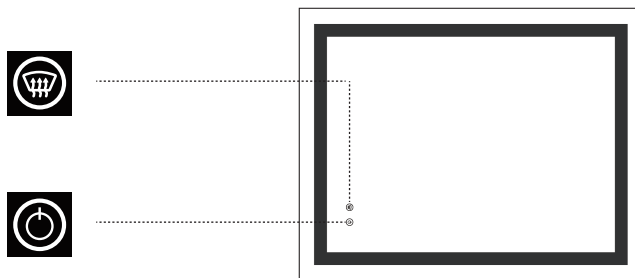

### • Power Check

After connecting the power, the two buttons will turn white, indicating that the LED and anti-fog functions are turned on. If you don't need to use any of them, touch the corresponding button to turn it off, and the button will dim.

### • Anti-fog



The anti-fog function helps resist the troubling fog and keep a clear reflection image. To save energy, it will automatically turn off after one hour.

### • Touch Switch



#### Mirror with tri-color temperatures

The button controls the light brightness and color temperature. Keep holding it and the brightness will change. You can adjust the color temperature as well: the first tap is white light, the second one is warm light, and the third one is natural light.

If no button is pressed within 15 seconds, the next tap will turn off the light immediately.

#### Mirror with single color temperature

The button controls the light brightness. Keep holding it and the brightness will change.

### • Memory Function

The current setting of the mirror will be saved. When you turn on the mirror next time, it will be in the same settings as it was.

## CONTACT US

After opening the package, please inspect the product immediately and see if there is any damage or missing parts. If there is, please **contact us**



## ACCESSORIES LIST

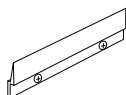

Bracket x 2

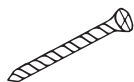

Screw x 6

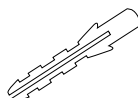

Wall Anchor-A x 6



Wall Anchor-B x 6

## TOOLS REQUIRED

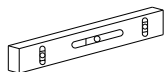

Level



Marker



Hammer



Tape Measure

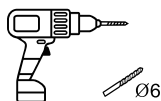

Electric Drill



Phillips Screwdriver



Safety Goggles

# INSTALLATION INSTRUCTIONS

**① Decide whether to hang the mirror vertically or horizontally. Confirm the locations of drill holes with the positioning ruler provided in the package, and use a marker to mark the spots ①②③④ on the wall.**

Vertical Installation

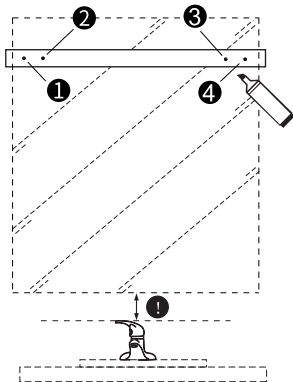

Horizontal Installation

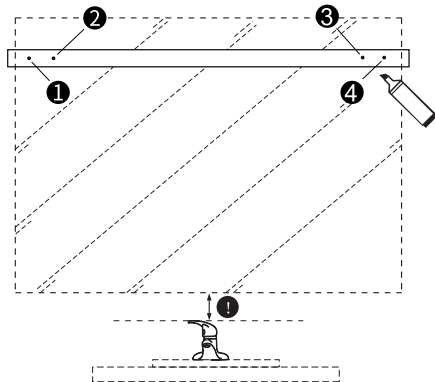

Note: Please hang the mirror a few inches above the highest part of the faucet.

**② Use an electric drill to punch holes at the marked spots, and then apply wall anchors with a hammer.**

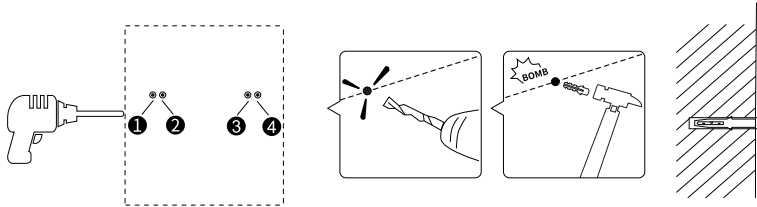

Thickness of Wall	Recommended Drill Bit	
> 16mm	1/4" (6mm) drill bit, drilling depth in 1 31/32" (50mm)	
8 ~ 16mm	25/64" (10mm) drill bit	
< 8mm	Unapplicable	

Note: Please wear goggles and pay attention to your safety while drilling.

### 3 Secure the two brackets to the wall with screws.

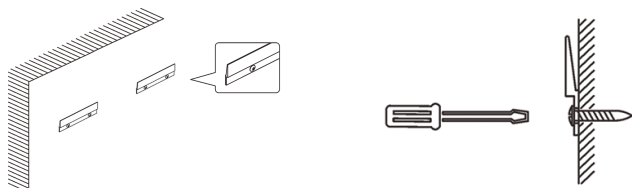

### 4 Connect the power by plugging into an outlet or hardwired to a standard circuit panel.

#### • Plug-in

After hanging the mirror securely, plug the power cable to a standard socket.

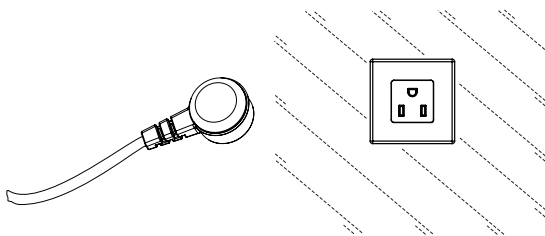

#### • Hardwired

Cut the head off the plug and hardwire it into an outlet.

Black wire --- power supply L (LIVE)

White wire --- power supply N (NEUTRAL)

Green wire --- power supply E (EARTH)

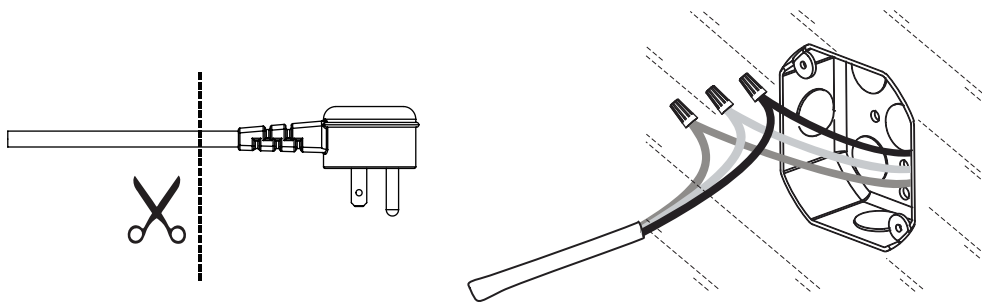

**WARNING:** This mirror must be earthed.



**REMINDER:** Please make sure the power is cut off before installation.

**5 Place the mirror against the wall, align the hook with the mounted bracket, slowly lower the mirror down, and make sure that it slots into the right position and hangs securely.**

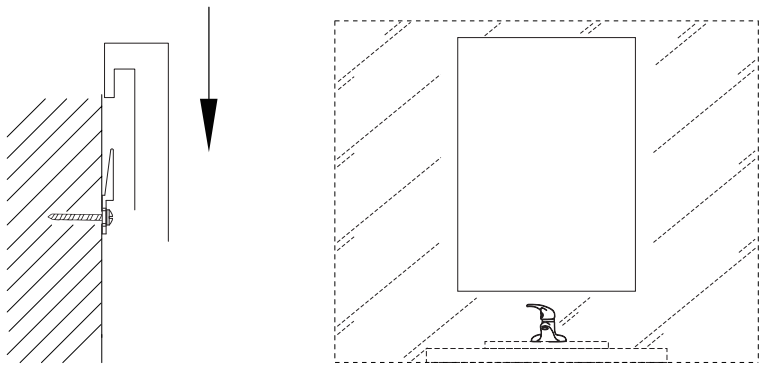

**SPECIFICATIONS**

PARAMETER	SPECIFICATION
Color Temperature (Triple color lights)	3000-6000K
Color Temperature (Single color light)	6000K
Input Voltage	AC100-120V
Output Voltage	24V DC
CRI	≥90 Ra
Working Temperature	-20~50℃
Life Span	≥20000 hours
Anti-fog	Yes
Safety Compliance	ETL
IP Rate	IP44
Mirror Glass	5 mm
Wiring Method	Hardwired / Plug in
Switch	Touch Sensor Switch
Installation Method	Wall-mounted