

10FT × 10FT Patio Canopy

Canopy (SKU # OB-GZ043)

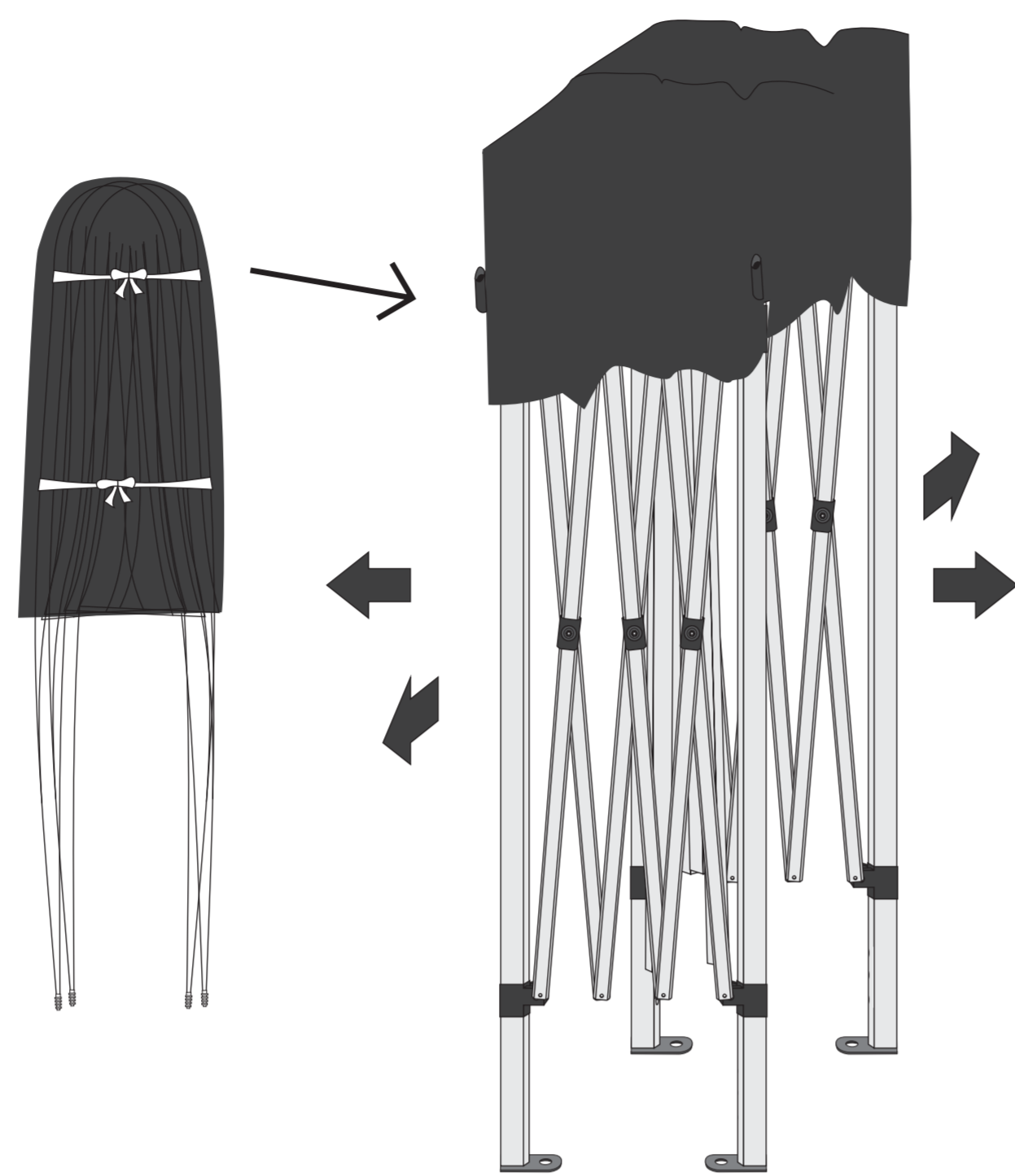

① Take the instant canopy frame from the carrying bag, then keep the steel frame stand



Page 2

②

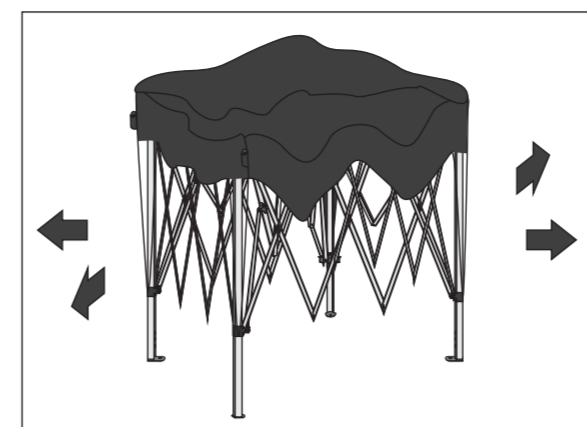

Make sure there is each corner of the canopy with one person, then pull gently at the same time, not forced open from diagonal line to prevent damage the canopy.

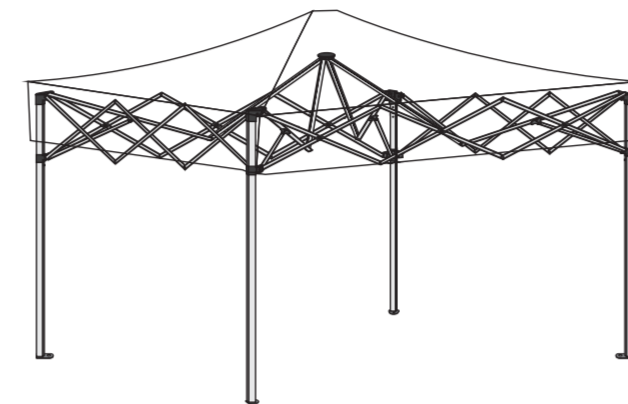

Page 3

③ Hook the plastic hanger to the steel frame.

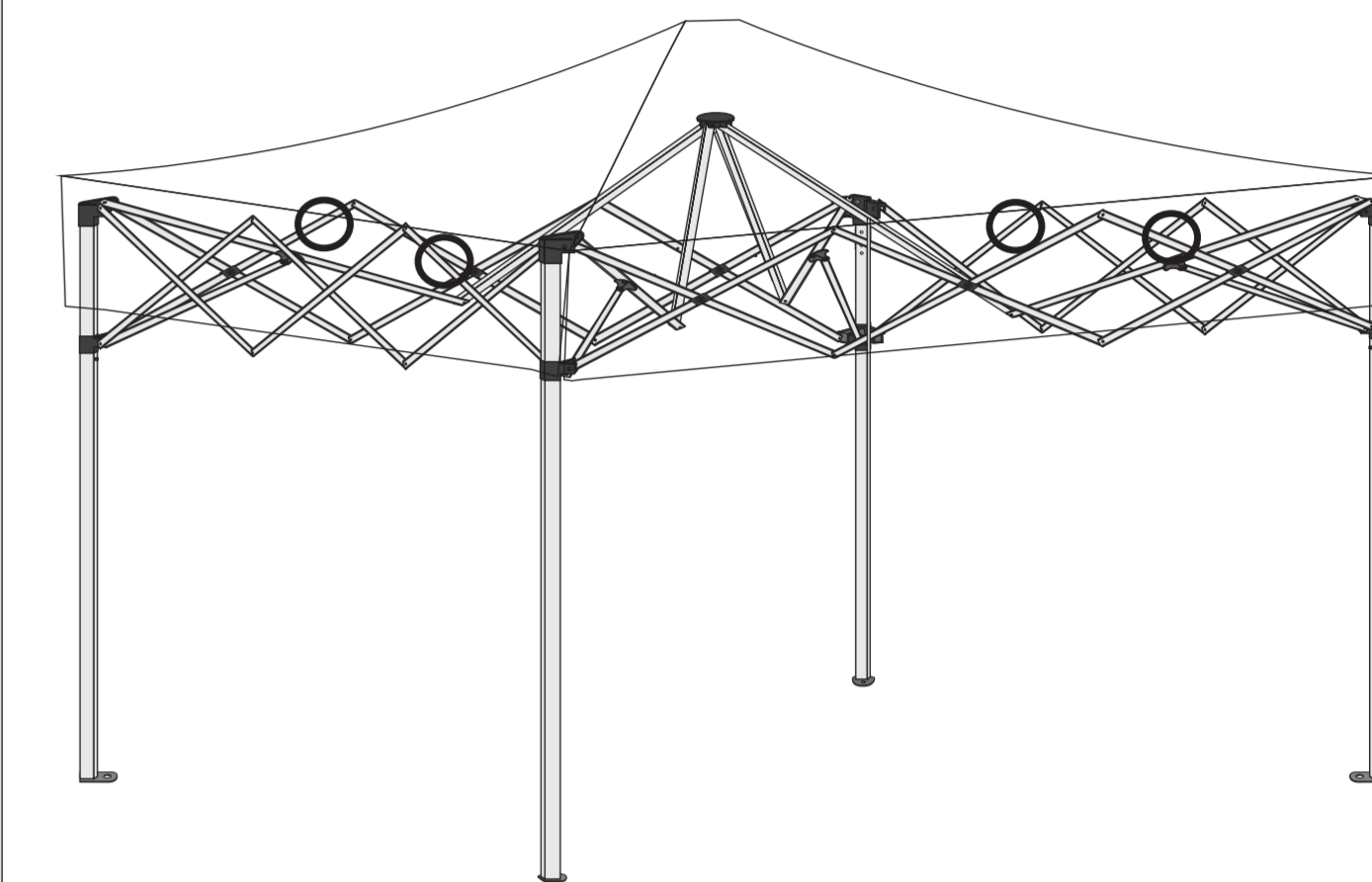
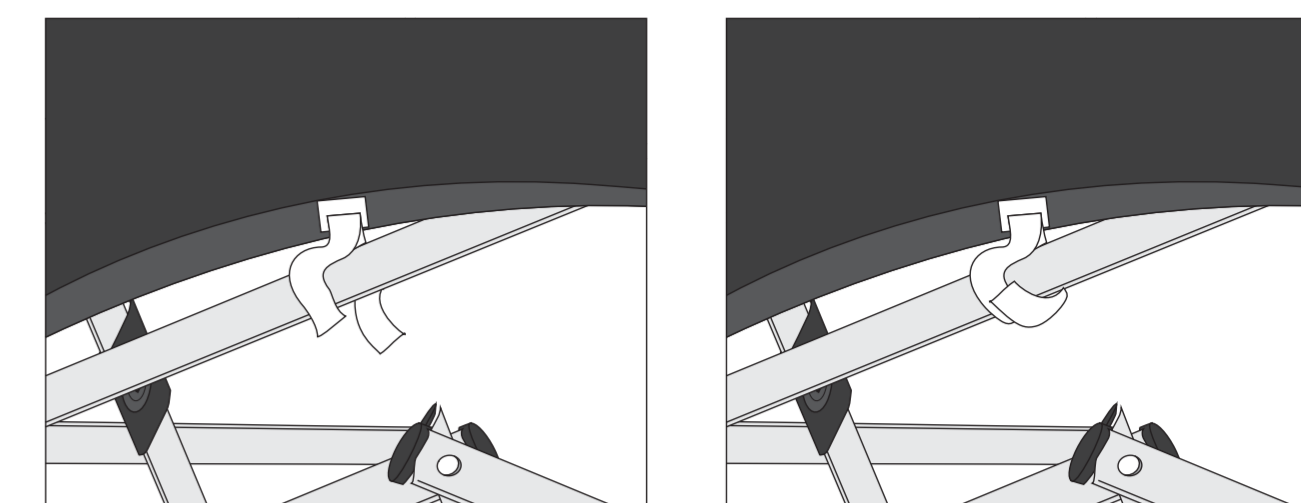

8 x Velcro straps

Page 4

④ Install the following parts - aa, bb, cc, dd as showed in pictures: make the ground-nail through the hole at the bottom of each steel main stand, and then push it into the ground.

For the following parts - A, B, C, D: Wrap the same rope around the top steel frame and ground nails while tying them tight and digging all ground nails into the ground. Please follow the above instructions to make your canopy stable enough to use.

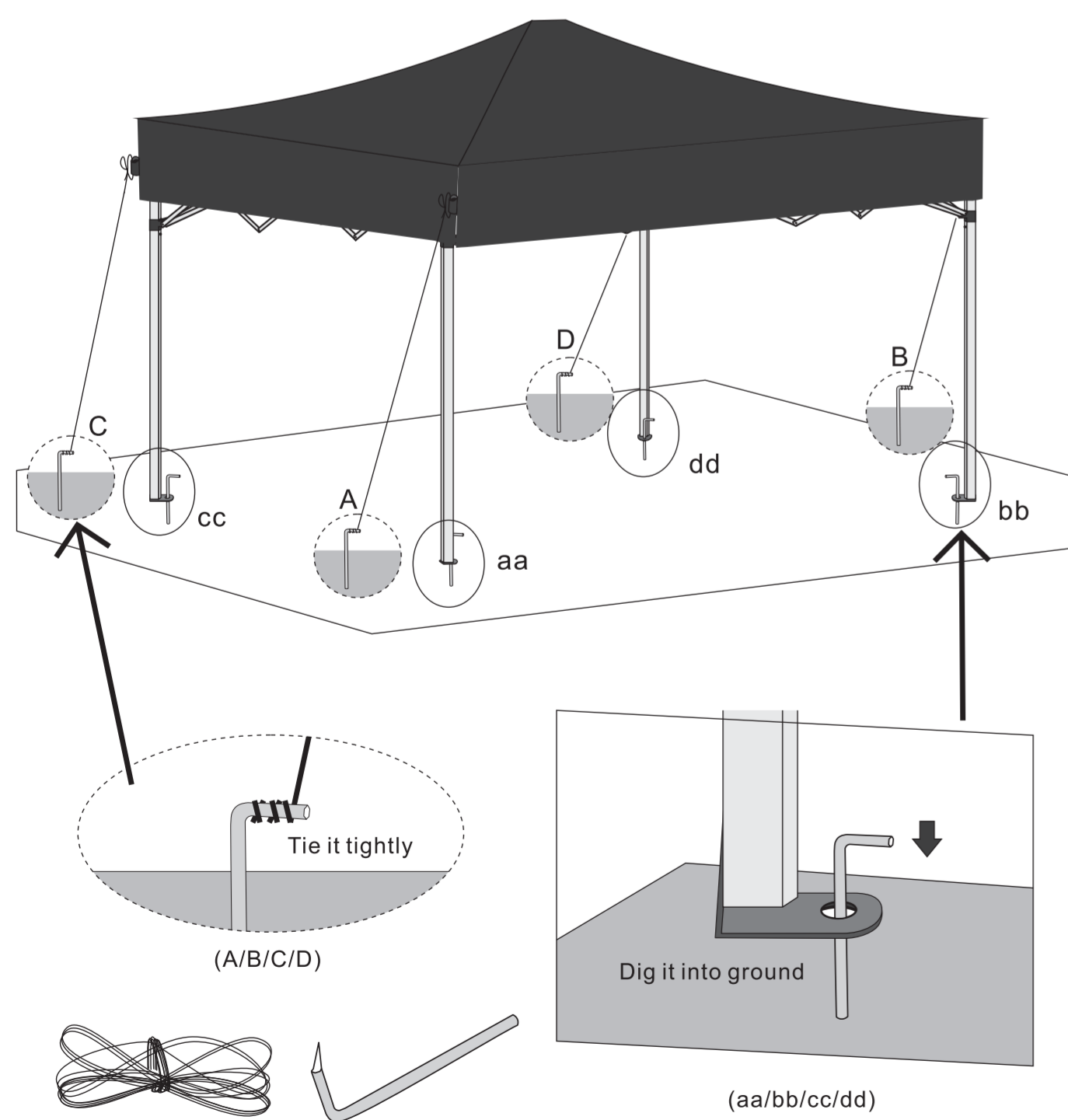

Page 5

⑤ How to turn back
Each main stand has two clips, one at the top and another in the middle, push them in and the canopy will be folded back as regularly.

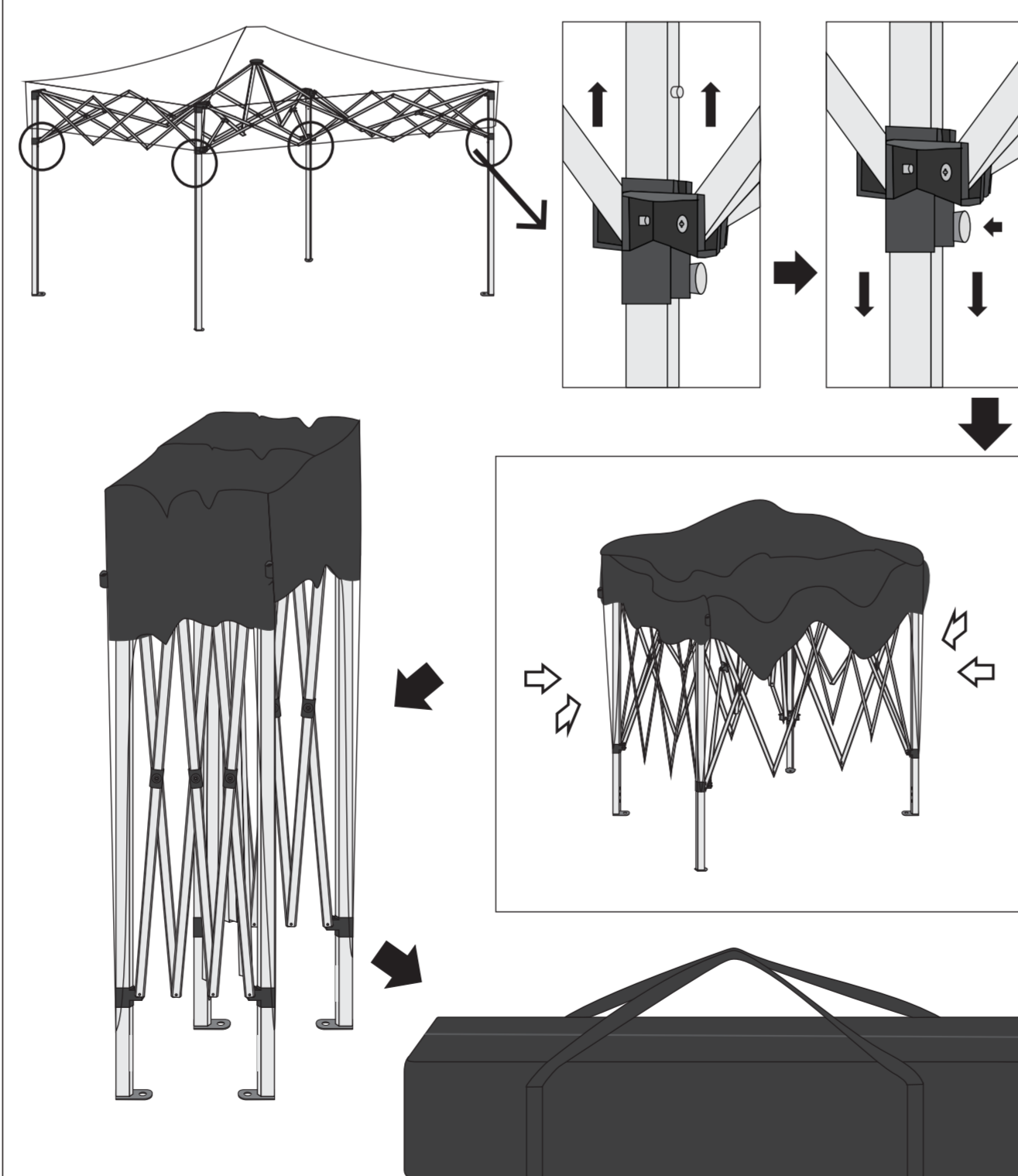

Page 6

Package Content

1 × Canopy Frame

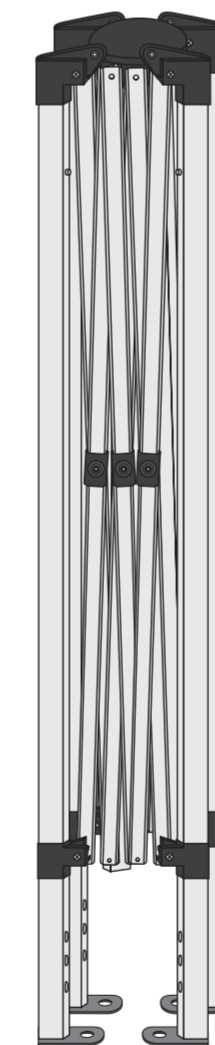

1 × Top Cover

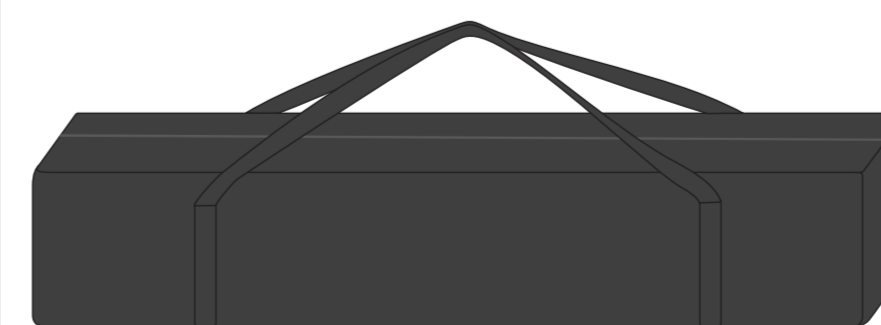

1 × Carrying Bag

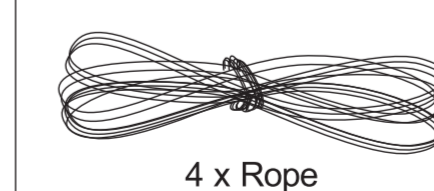

4 × Rope



8 × Ground Nail

Page 7

Customer Service

Warning: To extend the service life of the product, please do not use it in extreme weather conditions.

If any part is broken, please contact with us immediately, we will send the parts to you.

Thank you for choosing our canopy.

Contact email: service-outdoor@hotmail.com