

# FROME OTTOMAN BED ASSEMBLY INSTRUCTIONS

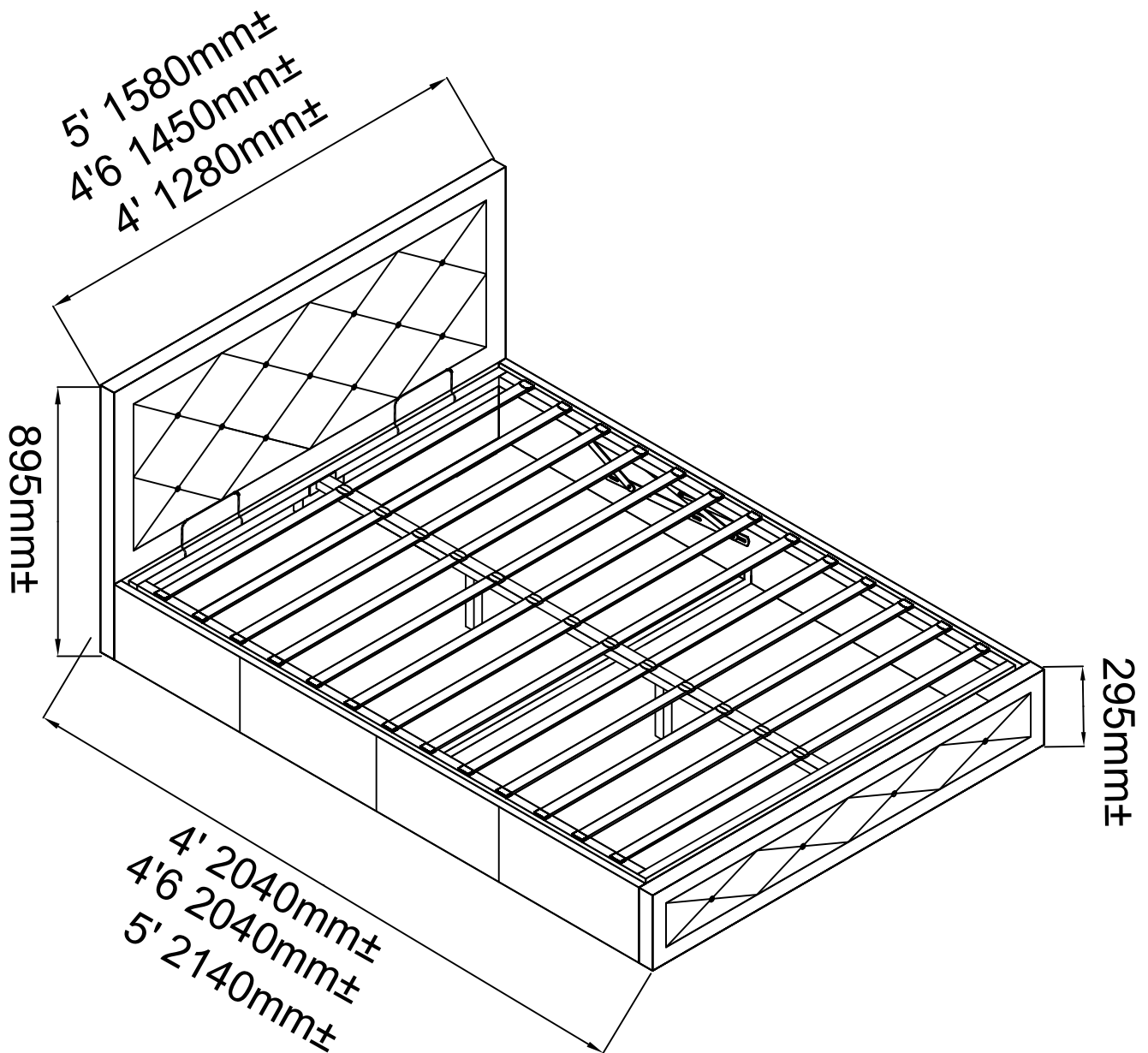

FROME OTTOMAN BED IS FOR DOMESTIC USE  
**AND STRICTLY NOT FOR CONTRACT USE.**

## PART LIST

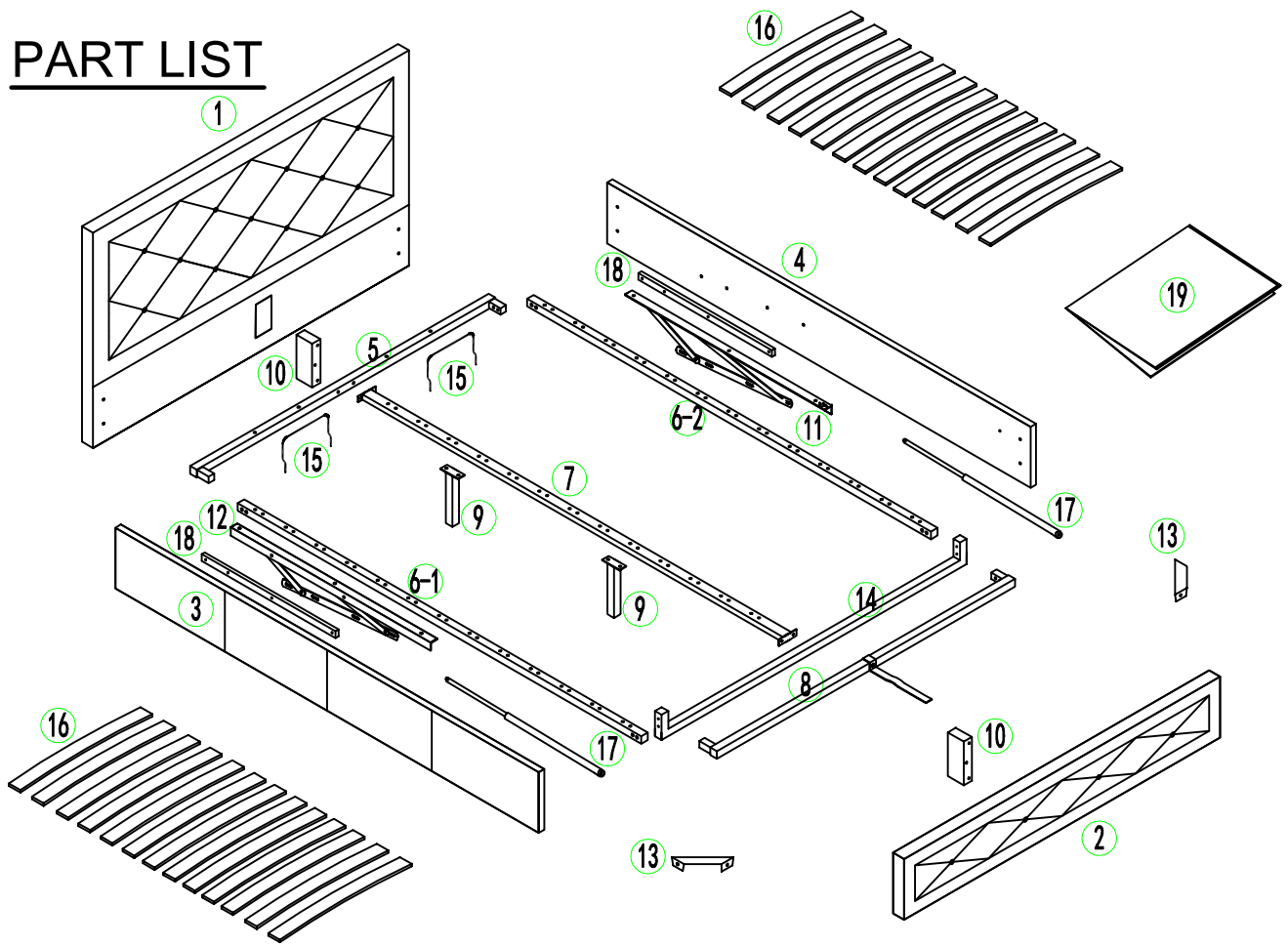

## HARDWARE LIST

Label	Picture	Description	Qty	Label	Picture	Description	Qty
A		Single Plastic Cap	26	I		Bolt M6x20	4
B		Double Plastic Cap	13	L		Connection Plate Left	2
D		Bolt M8x20	16	R		Connection Plate Right	2
E		Screw 4*35	4	M		Bolt M8x30	8
F		Washer M8	8	N		Bolt M8x15	22
G		Nut	4	K		Screw 4*80	6

## TOOL list

Label	Picture	Description	Qty
T-1		Screw driver(not provided)	1
T-2		Allen key M5	1
T-3		Allen key M4	1
T-4		Spanner	1

# Step 1

L		2pcs	R		2pcs
<b>Connection Plate Left</b>			<b>Connection Plate Right</b>		
D		16pcs	I		4pcs
Bolt M8x20			Bolt M6x20		
F		8pcs	T-2		1pc
Washer M8			Allen key 5#		
			T-3		1pc
			Allen key 4#		

# Step 2

K		6pcs	T-2		1pc
Screw 4*80			Allen key 5#		
E		4pcs	M		8pcs
Screw 4*35			Bolt M8x30		
			T-1		1pc
			Screw driver (not provided)		

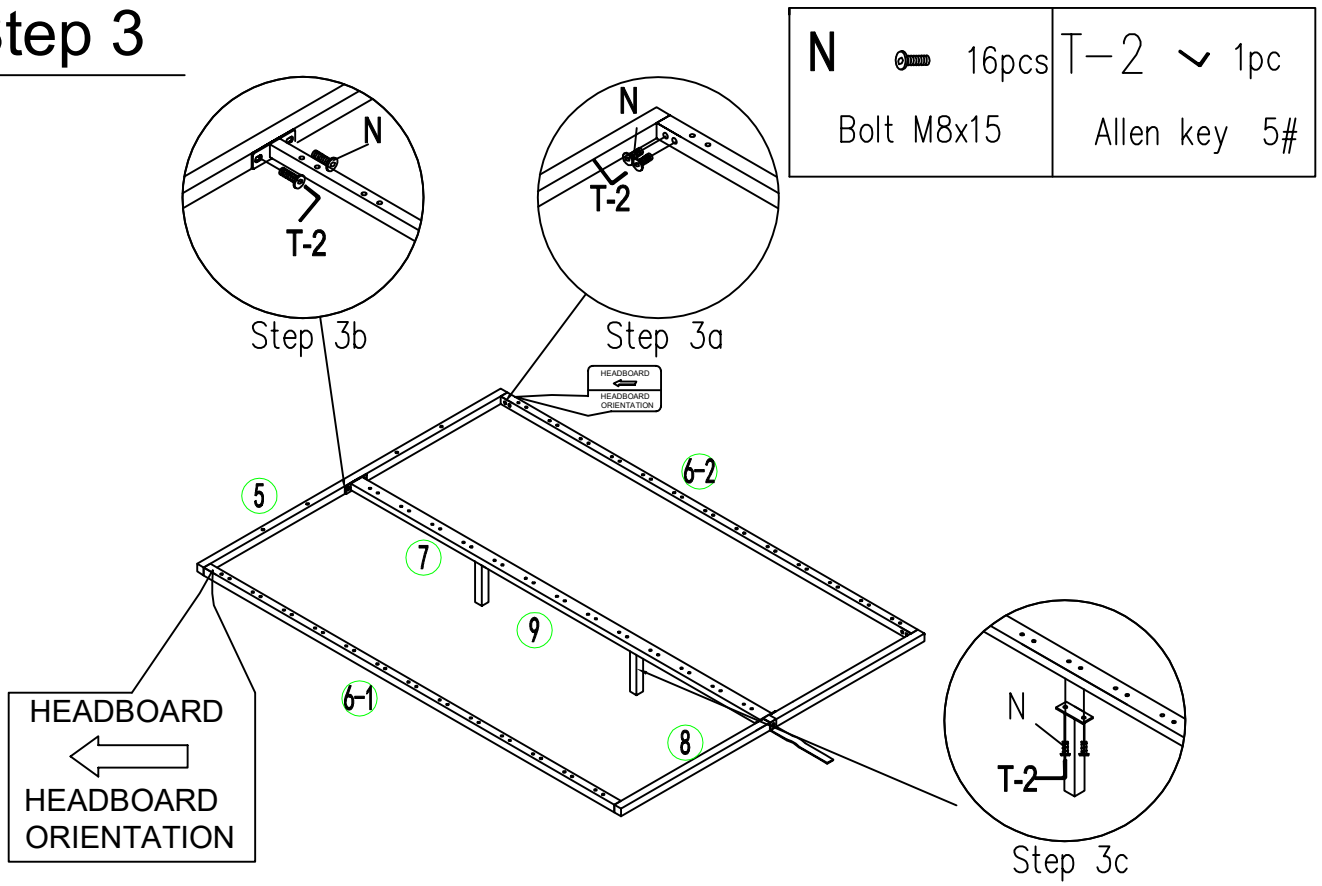

# Step 3

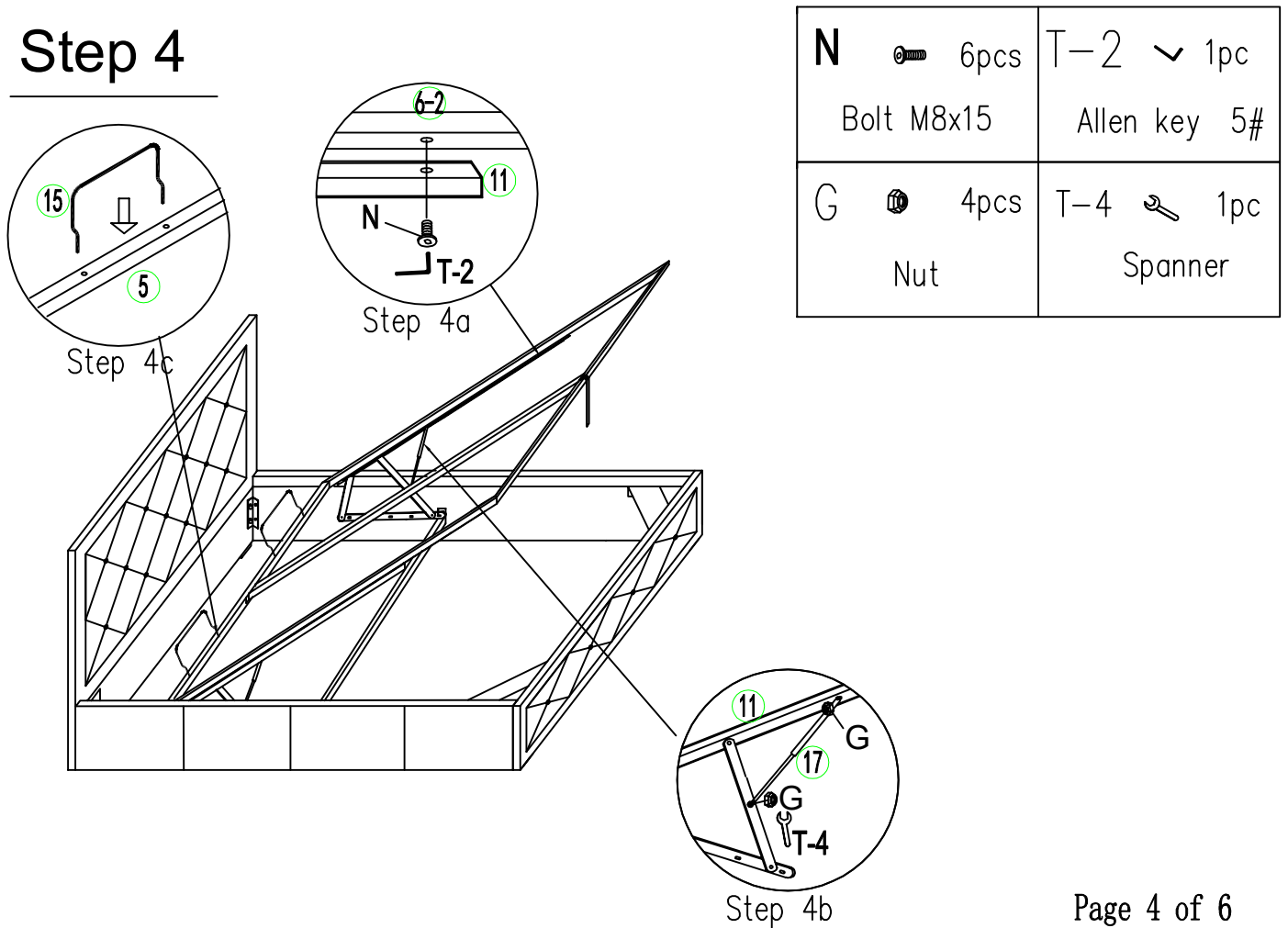

# Step 4



# Step 5

<b>A</b>  26pcs Single Plastic Cap	<b>B</b>  13pcs Double Plastic Cap
--	--

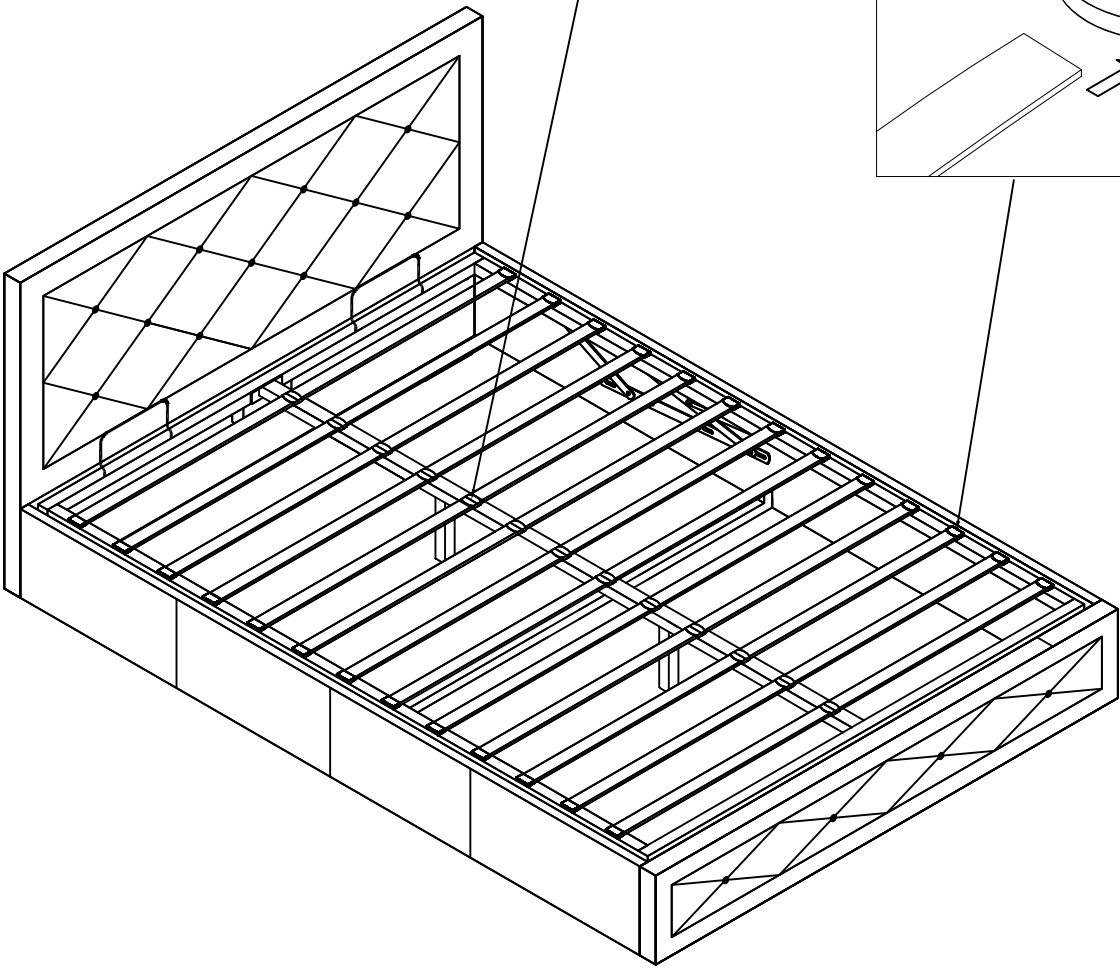
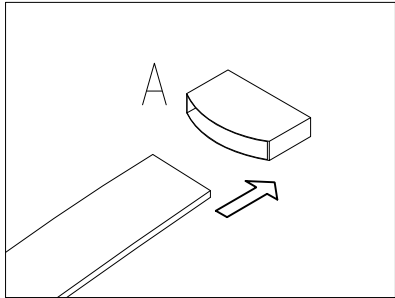
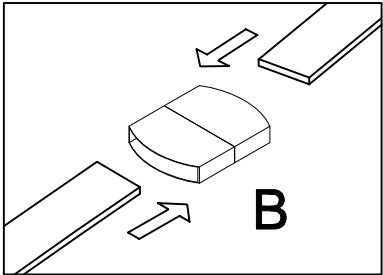

# Step 6

PASTE NON WOVEN FABRIC TO THE BOTTOM OF THE BED

