

Learn Nesting Trapezoid Desk

Model # 1226

Add function and versatility to your classroom or work area with the Learn Nesting Trapezoid Desk, available with a gray or dry erase laminate work surface. Easily configure activity tables or learning groups to support any teaching style. Handles on both sides of the desk make it easy to flip the top back for quick compact storage. Need space to spread out and work? The top provides 32.8" W of ample work surface or space to sketch ideas on the fly. Need to stow the desk? Roll it out of the way when it's no longer in use with 4 casters. This flexible active learning desk solution allows you to easily reconfigure your space by nesting additional desks together to create an eight-person circle.

COLORS

Model #	Color	List Price
1226DE	Dry Erase	\$480
1226GR	Gray	\$480

FEATURES

- Desks nest together to save space, with 5-1/4" between desk surfaces when nested.
- Easy-to-use, one-handed mechanism flips desk top up and down; handles are located on either side of the desk for easy access.
- Moves easily throughout a space with four locking casters.
- Create an eight-person learning circle with easy-to-nest trapezoid shaped tops.
- Designed for durability with powder-coated steel frame, high-pressure laminate top, and 2mm edge band.
- Available in Pebbled Grey or dry erase laminate.
- Provides ample space for working and learning.
- 200 lbs. weight capacity.
- Overall Dimensions: 33" W x 29.5" H x 22.25" D.
- Ships within 48 hours.

WEIGHTS & DIMENSIONS

- Depth: 22.25"
- Height: 29.5"
- Width: 32.83"
- Weight: 31lbs

SHIPPING

- Method: UPSable
- Assembly Required: Yes
- Quantity Per Unit: 1
- Quickship: Yes

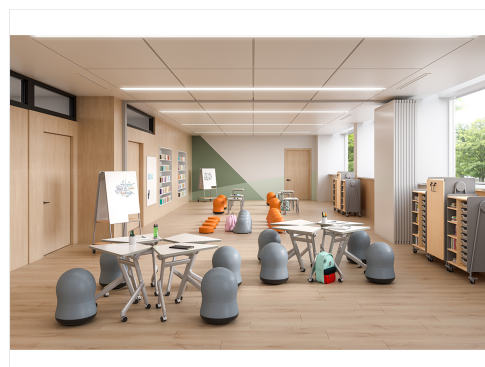

CERTIFICATIONS



**For more information see pricer.*

Date Created: 01/20/2021