

Assembly Instructions

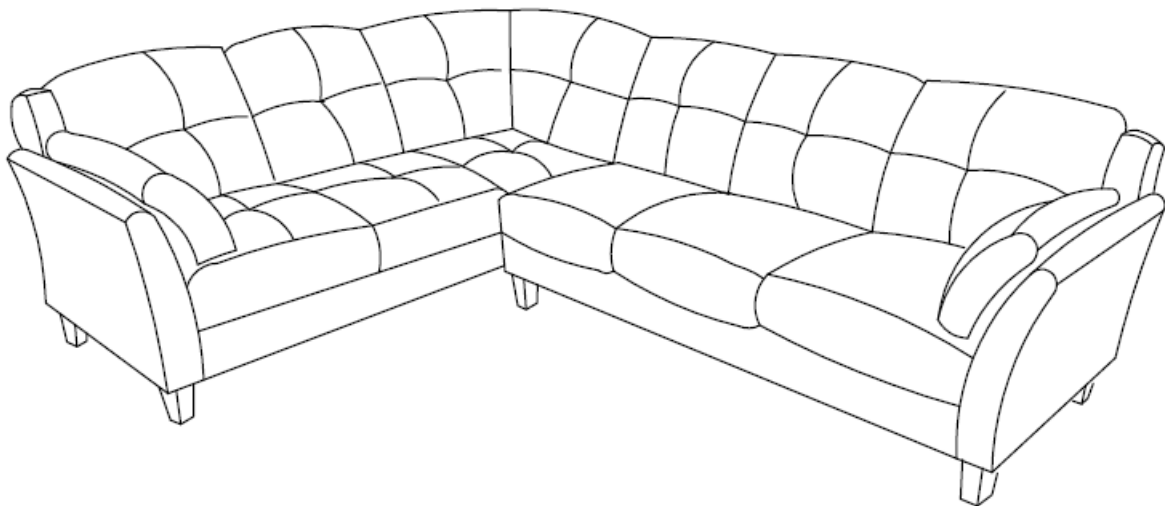

ASSEMBLY RATING

The Assembly Rating is a 5-point system that shows the degree of effort needed in assembling a specific product (with 1 being easy and 5 being difficult). For some products, two persons are recommended.

EASY  DIFFICULT

Tools Required for Assembly:

Allen Wrench



(Included)

Wrench

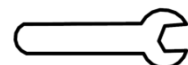

(Included)



2 PERSONS RECOMMENDED

ASSEMBLY & CARE ADVICE

FOR YOUR FURNITURE TO LAST, CORRECT ASSEMBLY AND PROPER MAINTENANCE ARE NECESSARY.
PLEASE FOLLOW THE INFORMATION PROVIDED BELOW TO FULLY ENJOY YOUR FURNITURE.

BASIC ASSEMBLY TECHNIQUES

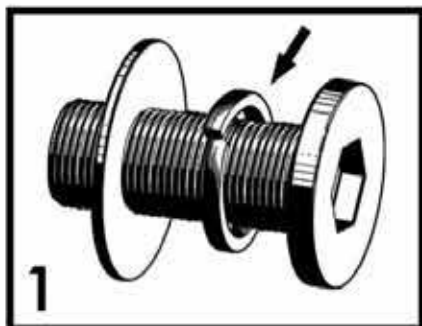

When lock or spring washer is used in an assembly, please make sure the lock or spring washer is placed between the larger flat washer and the head of the screw or bolt.

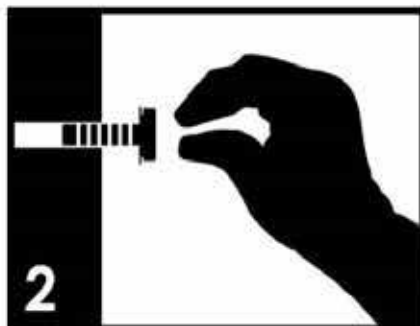

Position each part correctly and insert screws or bolts into their respective holes by hand tighten or using the proper hand tool. Only tighten when step is completed or when instructed to do so.

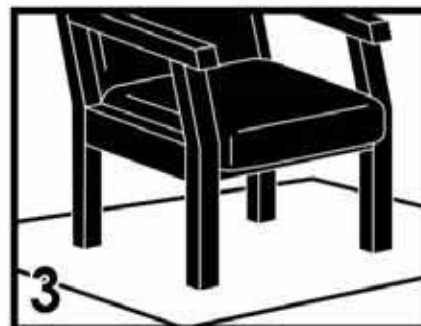

Use cardboard or carpet area when assembling furniture to prevent scratches. Make sure the furniture rests on a flat and level surface with each leg evenly touching the floor.

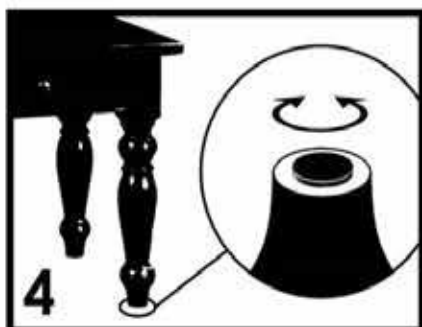

Some furniture comes with height adjustment knobs underneath each leg. To lower or to raise each leg, you need to turn clockwise or counterclockwise, respectively.

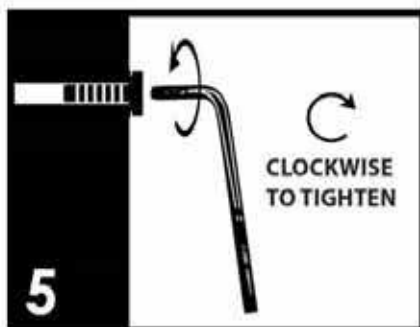

Make sure all parts are properly aligned, then use the appropriate hand tool to completely tighten the bolts or screws. Do not use power tools and do not overtighten.



Save the instructions and store the Allen wrench or any supplied tool for later maintenance. After two weeks, check and tighten any loose hardware and repeat again every six months thereafter.

IT IS THE USER'S RESPONSIBILITY TO MAINTAIN THE FURNITURE. THE HARDWARE MAY LOOSEN OVER TIME AND MAY CAUSE THE FURNITURE TO BE WOBBLY AND UNABLE TO SUPPORT ITS INTENDED WEIGHT CAPACITY. THIS MAY LEAD TO COLLAPSE AND MAY CAUSE SERIOUS INJURY.



FAILURE TO FOLLOW THE GUIDELINES ABOVE MAY
RESULT IN INJURY AND/OR PROPERTY DAMAGE.



Before you begin, please read Page 2 of "Assembly and Care Advice".

And remember, do not tighten until each step is completed or instructed.

MD

Parts List

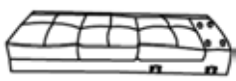

#1 x 1 pc
Right Sofa Seat



#2 x 1 pc
Left Sofa Seat



#3R x 1 pc
Right Armrest



#3L x 1 pc
Left Armrest



#4 x 2 pcs
Armrest Support

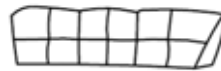

#5 x 1pc
Right Backrest

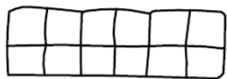

#6 x 1 pc
Left Backrest



#7 x 2 pcs
Armrest Cushion



#8 x 1 pc
Corner Backrest



#9 x 8 pcs
Leg



Due to the size and/or weight of this product, it is highly recommended that the assembly should be done near the area of its intended location. Make sure you have enough space to move around during the assembly. ALWAYS have at least two people to help with transporting and assembling the product to avoid any potential injury and/or damage.

Hardware List



#A x 2 pcs
Bolt 5/16"x4"



#B x 2 pcs
Bolt 5/16"x2-1/2"



#C x 23 pcs
Threaded Stud



#D x 27 pcs
Flat Washer



#E x 23 pcs
Hex Nut



#F x 1 pc
Allen Wrench

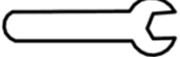

#G x 1 pc
Wrench

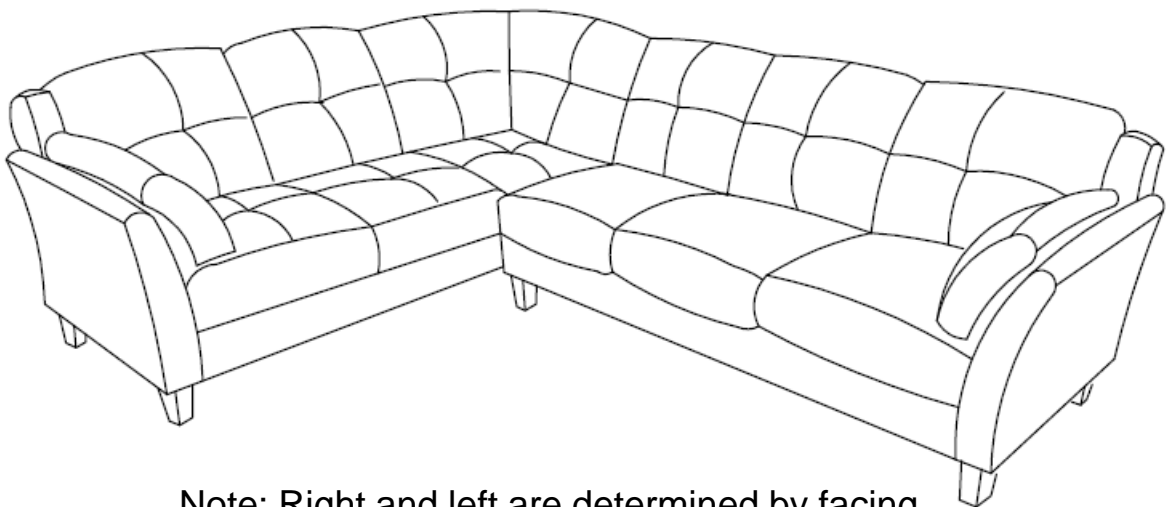

Note: Right and left are determined by facing the back of the sofa in upright position.



- I. Align the armrest support (#4) with the pre-drilled holes on the right armrest (#3R).
- II. Insert a flat washer (#D) onto the bolt (#A) and another onto bolt (#B). Insert the bolt assembly (#A) through the top hole of the armrest support (#4) and the other bolt assembly (#B) through the bottom hole of the armrest support (#4) using the Allen wrench (#F) to lock them with the right armrest (#3R).

#A x 1 pc
#B x 1 pc
#D x 2 pcs

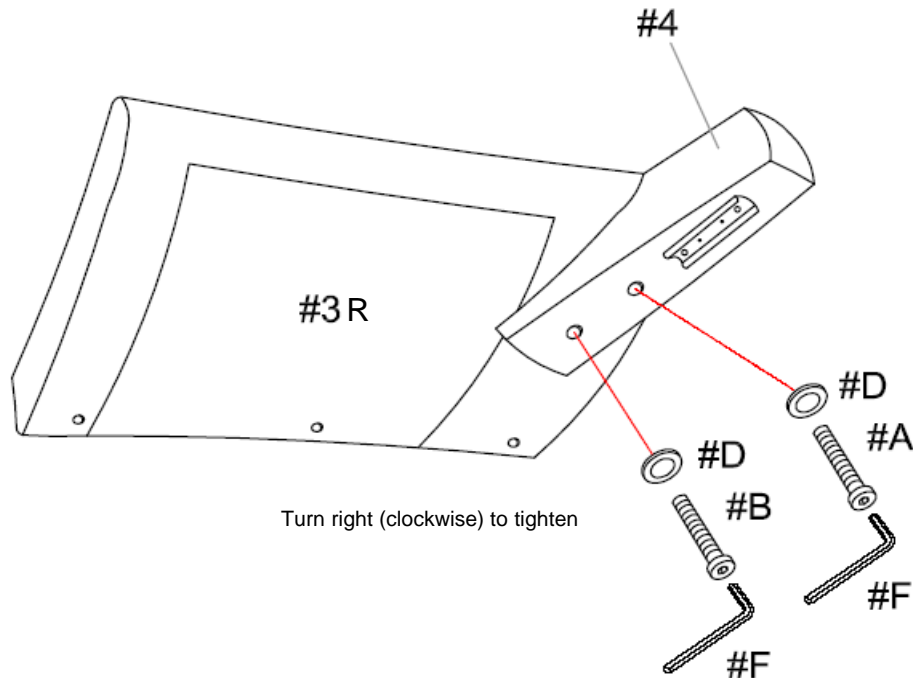

- I. Insert 3 threaded studs (#C) into the right armrest (#3R). Then insert those 3 threaded studs (#C) assembled onto the right sofa seat (#1).
- II. Place 3 flat washers (#D) over the threaded studs (#C).
- III. Secure 3 hex nuts (#E) onto the same threaded studs using the wrench (#G) to tighten the parts together.

#C x 3 pcs
#D x 3 pcs
#E x 3 pcs

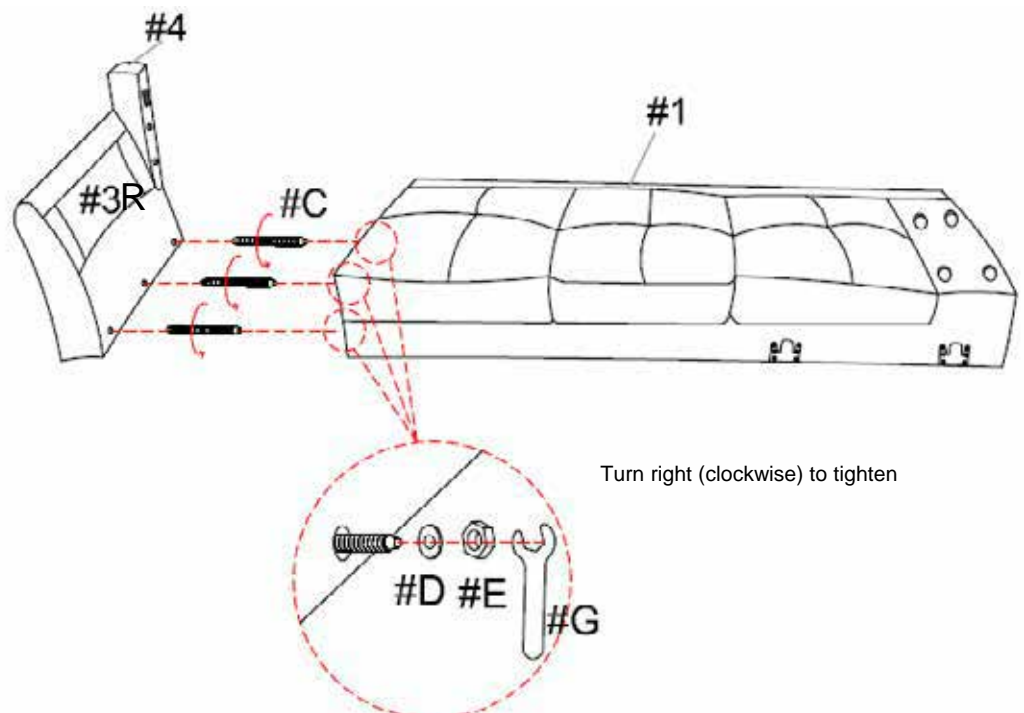



- I. Insert 4 threaded studs (#C) into the bottom of the corner backrest (#8). Then insert those 4 threaded studs (#C) assembled on the corner backrest (#8) into the right sofa seat (#1).
- II. Place 4 flat washers (#D) over the threaded studs (#C).
- III. Secure 4 hex nuts (#E) onto the same threaded studs using the wrench (#G) to tighten the parts together.

#C x 4 pcs
#D x 4 pcs
#E x 4 pcs

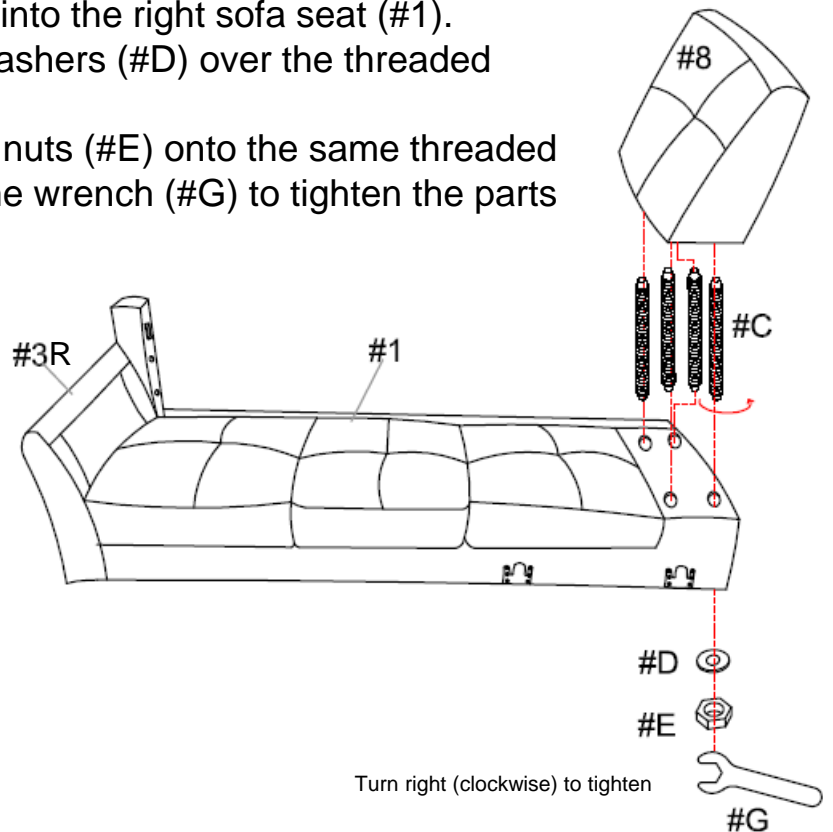

#C x 7 pcs
#D x 7 pcs
#E x 7 pcs

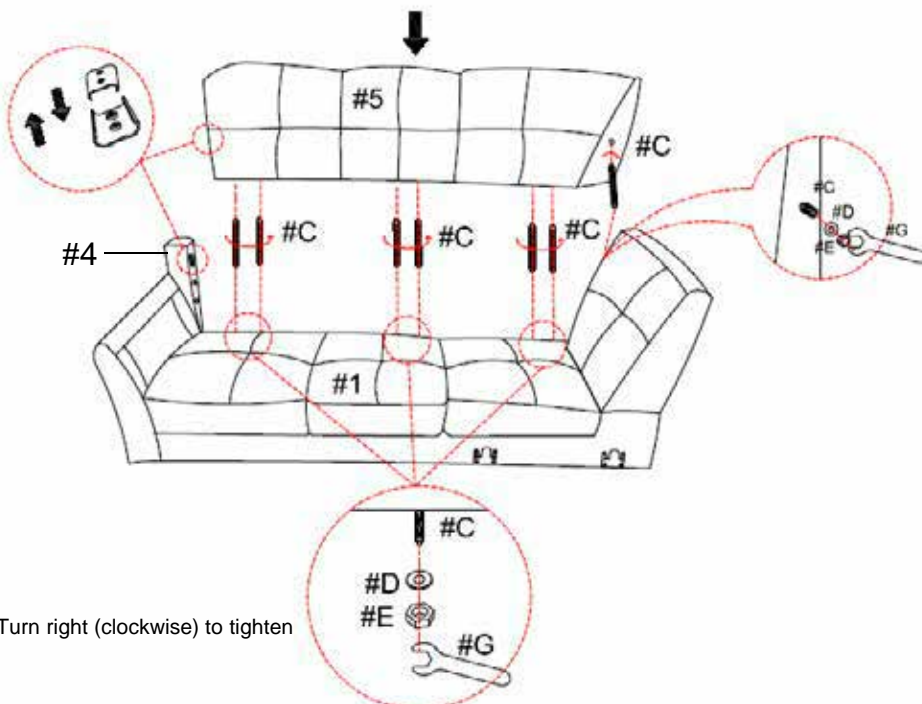

- I. Insert 6 threaded studs (#C) into the bottom of the right backrest (#5). Then insert a threaded stud (#C) into the left side of the right backrest (#5).
- II. Align the bracket of the right backrest (#5) and the assembled threaded studs (#C) with the bracket of the armrest support (#4) and pre-drilled holes of the right sofa seat (#1).
- III. Place 7 flat washers (#D) over the threaded studs (#C).
- IV. Secure 7 hex nuts (#E) onto the same threaded studs using the wrench (#G) to tighten the parts together.



Align the Velcro of the armrest cushion (#7) with the Velcro on the right armrest (#3R).

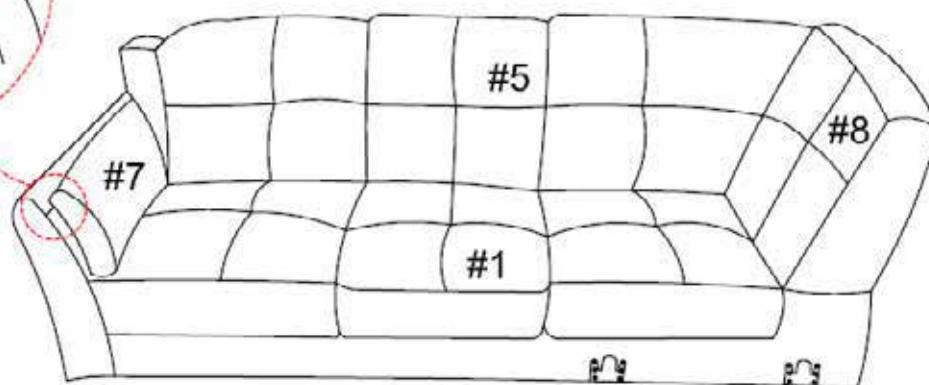

Carefully have the sofa rested on its back on a protective surface. Remove the legs from underneath the sofa. Then align the threaded end of the 4 legs (#9) with the pre-drilled holes on the bottom corners of the right sofa seat (#1) and tighten by hand until secured.

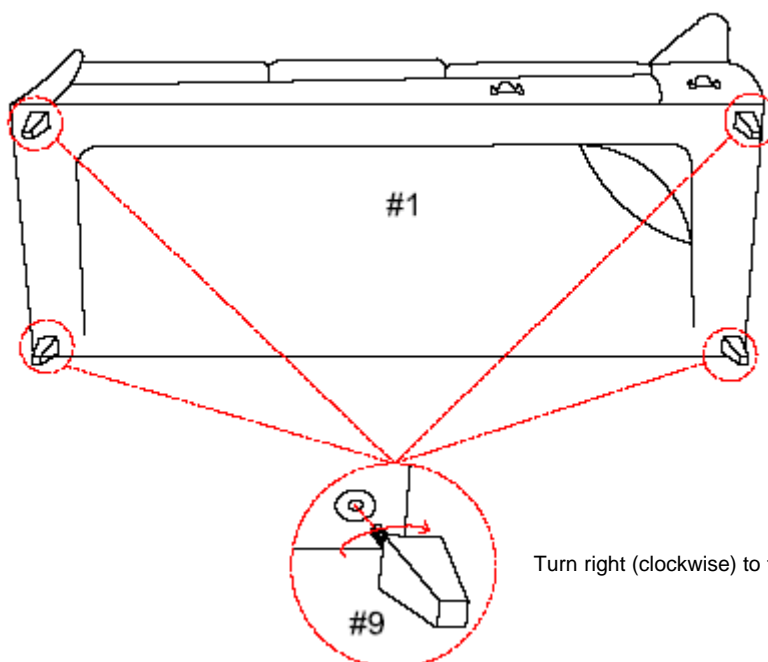

Turn right (clockwise) to tighten



#A x 1 pc
#B x 1 pc
#C x 3 pcs
#D x 5 pcs
#E x 3 pcs

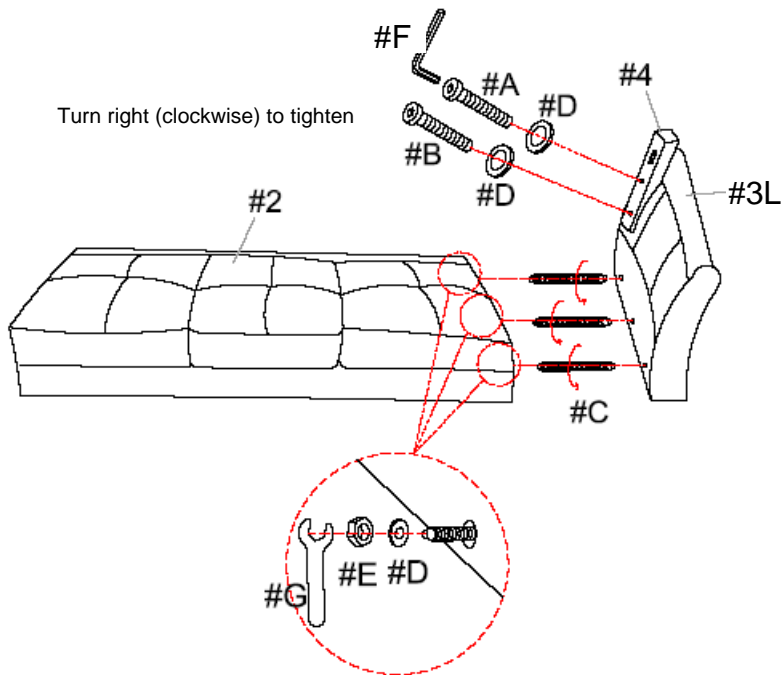

- I. Align the armrest support (#4) with the pre-drilled holes on the left armrest (#3L).
- II. Insert flat washer (#D) onto the bolt (#A) and another onto bolt (#B). Insert the bolt assembly (#A) through the top hole of the armrest support (#4) and the other bolt assembly (#B) through the bottom hole of the armrest support (#4) using the Allen wrench (#F) to lock them with the left armrest (#3L).
- III. Insert 3 threaded studs (#C) into the left armrest (#3L). Then insert those 3 threaded studs (#C) assembled on the left armrest (#3L) into the left sofa seat (#2).
- IV. Place 3 flat washers (#D) over the threaded studs (#C).
- V. Secure 3 hex nuts (#E) onto the same threaded studs (#C) using the wrench (#G) to tighten the parts together.



#C x 6 pcs
#D x 6 pcs
#E x 6 pcs

- I. Insert 6 threaded studs (#C) into the bottom of the left backrest (#6).
- II. Align the bracket of the left backrest (#6) and the assembled threaded studs (#C) with the bracket of the armrest support (#4) and pre-drilled holes of the left sofa seat (#2).
- III. Place 6 flat washers (#D) over the threaded studs (#C).
- IV. Secure 6 hex nuts (#E) onto the same threaded studs (#C) using the wrench (#G) to tighten the parts together.

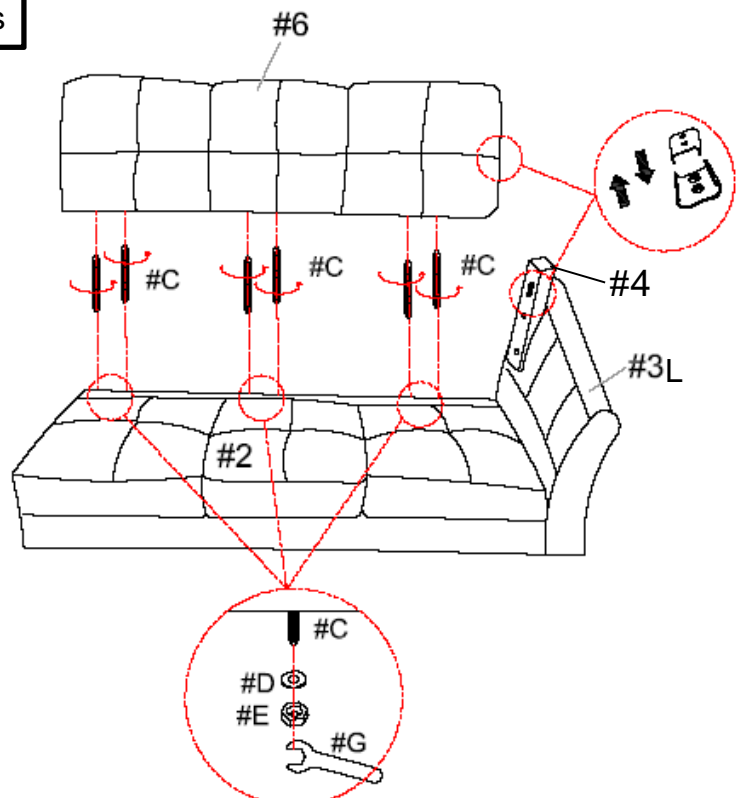

Turn right (clockwise) to tighten



Align the Velcro of the armrest cushion (#7) with the Velcro on the left armrest (#3L).

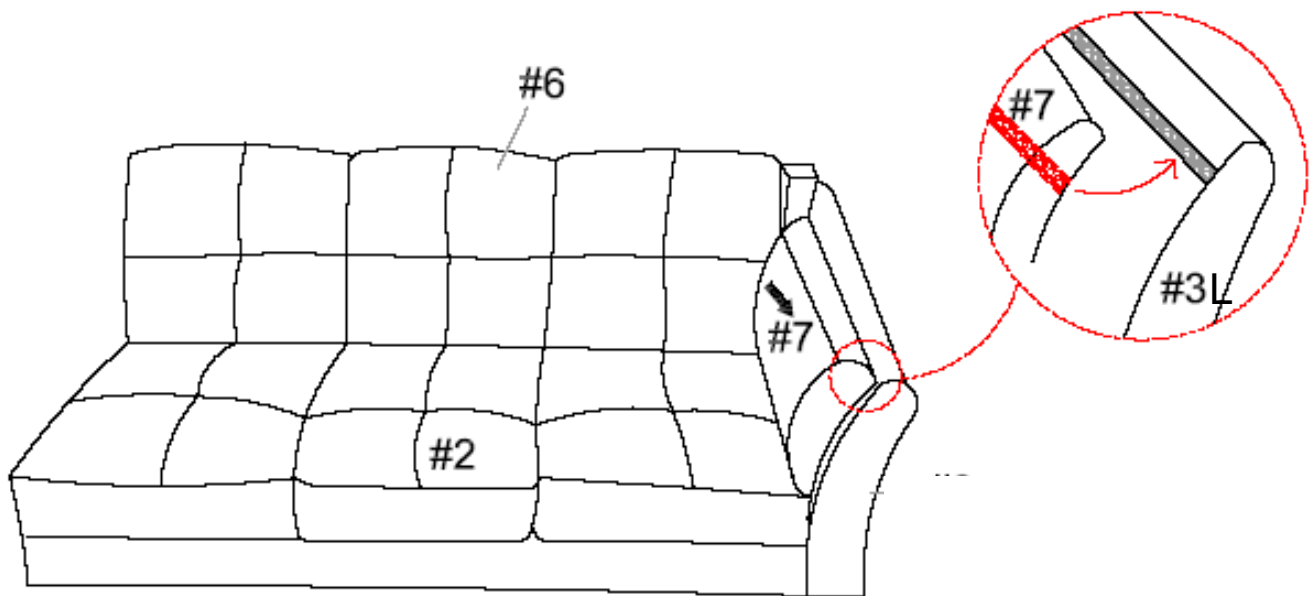

Carefully have the sofa rested on its back on a protective surface. Remove the legs from underneath the sofa. Then align the threaded end of the 4 legs (#9) with the pre-drilled holes on the bottom corners of the left sofa seat (#2) and tighten by hand until secured.

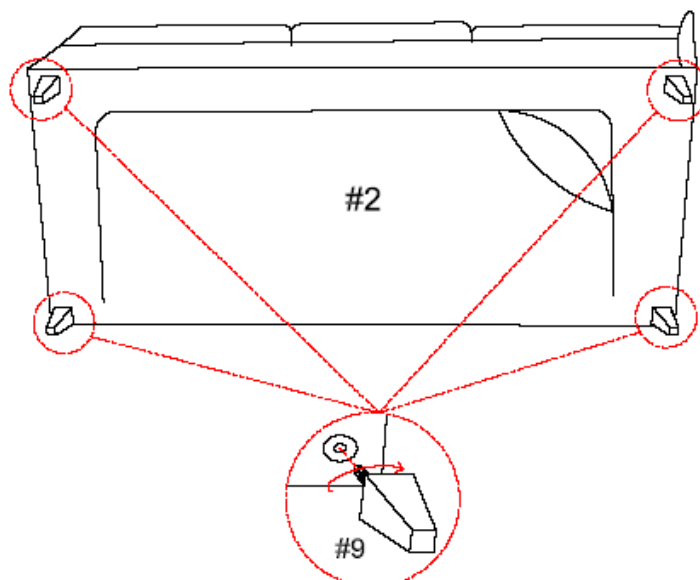

Turn right (clockwise) to tighten



Connect the two sofas together by aligning the brackets of the assembled right sofa seat (#1) with the brackets of the assembled left sofa seat (#2). Make sure the parts are firmly secured.

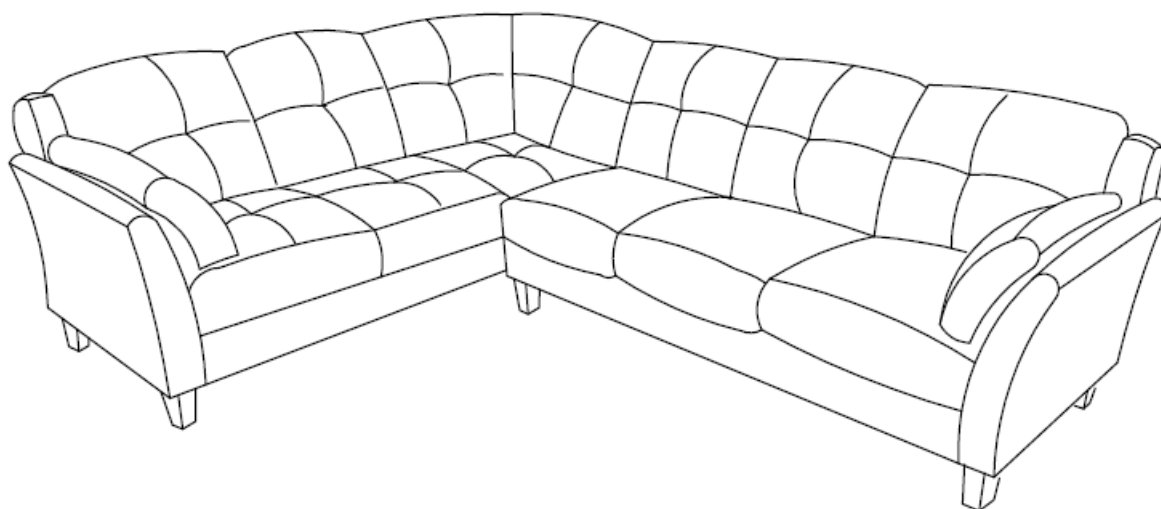
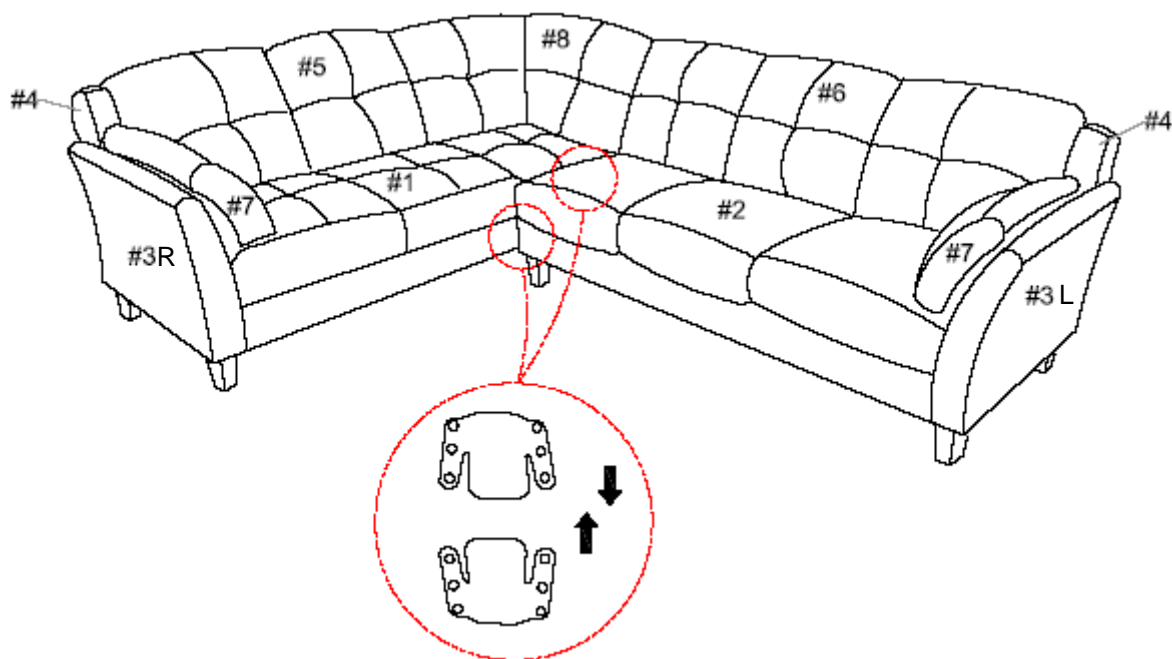

ASSEMBLY IS COMPLETED