

6Ft 240L LED Star Light Tree Instruction

Product introduction :

LED lighting tree is also called LED landscape lighting tree or LED artificial tree. It has the advantages of energy saving, high brightness, colorful, long service life, vivid model. As a kind of artificial plant light, it puts beautification, greening, lighting together. Its unique, elegant and magnificent modelling, beautiful gesture, and make it more adaptable to the place such as city-lighting project, scenic area, hotel, cultural square, community activities in public places, coastal landscape and so on. Tree lights will satisfy people's desire everywhere. During the daylight, it is the artificial plant trees, at night it will give people a totally different lighting beauty. Return to the nature, walk into nature, it not only beautifies the environment but also adds a beautiful scenery line. Now, more and more lighting trees are applied to city-lighting, landscape lighting, home decor and other places. In particular, when festival is coming, it will become an indispensable scenery line.

Direction for use:

1, Carefully remove product from package;



2, Unfold the tree base, connect the second half branch to the base and fix with screw;



3, Insert tree trunk into second half branch and fix with screw; Connect the cable with transformer and plug into the power outlet.

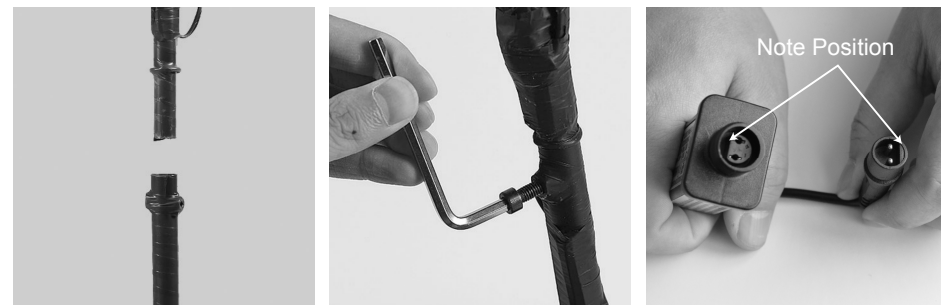

The tree can be shaped by bending and arranging the branches into desired position to give it a natural appearance!

- Power supply: 24V adaptor, IP44 rainproof
- Input: 120V AC 50/60Hz
- Output: 24V DC 6W

IMPORTANT SAFETY INSTRUCTIONS

When in use outdoors, install only to a covered GFCI electrical outlet that is weather proof. Make sure the outdoor adaptor and cord are assembled correctly and secured tightly to prevent water from entering the device

1. Please read and follow all instructions and warnings both on the instructions and on the product carefully before use.
2. Retain these instructions for future reference.
3. This product is to be used only as intended its use.
4. Safe for indoor or sheltered outdoor use, Not designed to withstand heavy winds or storm conditions
5. If used outdoors, connect the product to a Ground Fault Circuit Interrupting (GFCI) receptacle.
6. Do not mount or place near gas or electric heaters, fireplaces, candles or other similar sources of heat
7. Do not secure the wiring of this product with staples or nails, or place on sharp hooks, nails or in a manner that can cut or damage the wire or insulation.
8. This is an electric product and not a toy! To avoid risk of fire, burns, personal injury and electric shock it should not be played with or placed where small children can reach it.
9. Do not close doors or windows on the product or extension cords as this may damage the wire and insulation.