

- Models:**
 · 7001011
 · 7001021
 · 7001031
- Finish:**
 · Matte Black
 · Oil Rubbed Bronze
 · Brushed Nickel

Application Instruction

Gradually pull the handle, it will be more advantageous to protect the cartridge.

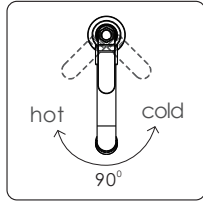
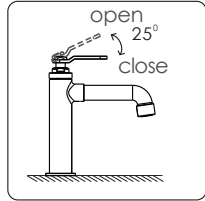

Standard Part List

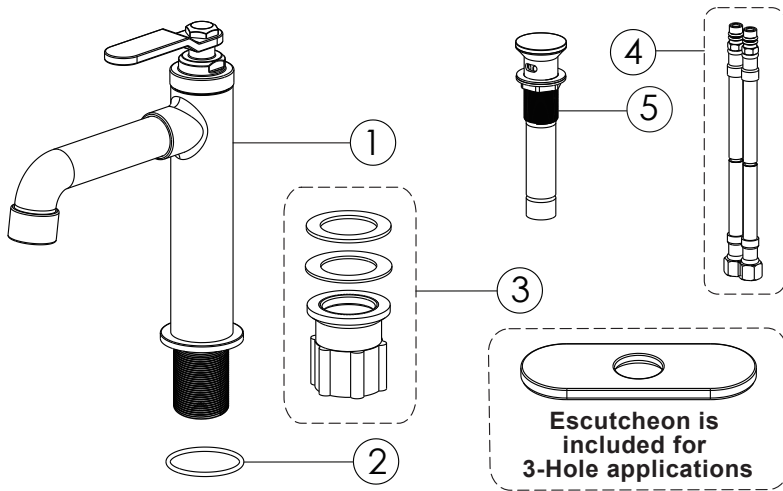

NO.	Part Name	Quantity
1	Body Assy	1
2	O-Ring	1
3	Fitting Assy	1
4	Hose	2
5	Pop-up	1

· Every once in a while, please rinse the faucet with lukewarm soapwater, and wipe it clean with a soft duster cloth.
 Please avoid any abrasive cleaners, steel wools, or corrosive chemicals.

BEFORE INSTALLATION

- To insure proper installation, please read the following instructions carefully.
- Please make sure that the water supply has been shut off at the stop valve.
- NEWATER reserves the right to update product without notice.

Installation Steps

1

1. Make sure there is a Ø35-Ø40 Hole on the basin before fix the mixer, Unscrew the ③ fitting ASSY from the bottom of the ① body, then get the ① body through the hole, don't forget to fix the ② o-ring between the bottom of the ① body and the basin.

2

2. According the remove step to screw up the fixing set to the mixer below the basin. Use hand to screw up the locknut, then use install tool for fixing strengthen.

3

3. Connect the ④ inlet hose from the ① body. "Red" for connecting to the hot water, and "Blue" for connecting to the cold water.

4

4. Install the ④ pop-up.