

Sinber Kitchen Sink Introduction

HU2318S-10-S

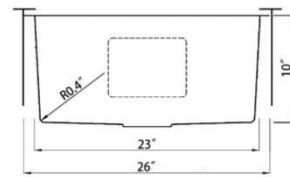
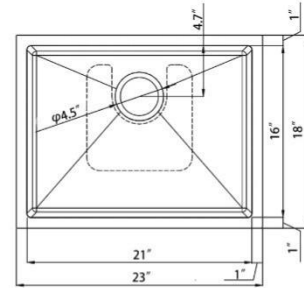
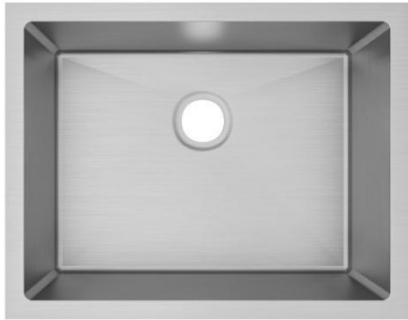

Minimum Base Cabinet: 26
Sink Net Weight: 13.7 lbs

| HU2318S-10-S 23" L x 18" W Undermount Kitchen Sink | | | |
|---|----------------------------------|---|--------------------------------------|
| Installation Type | Undermount | Sink Shape | Rectangular |
| Primary Material | 304 Stainless Steel | Stainless Steel Gauge | 18 |
| Resistance Type | Scratch; Stain; Rust; Heat; Fade | Sound Dampening | Yes |
| Finish | Satin | Craftsmanship Type | Handmade |
| Overall Dimensions | 23" L x 18" W | Basin | 16" W x 21" L x 10" D |
| Basin | 16" W x 21" L x 10" D | Drain Placement | Center |
| Number of Faucet Holes | 0 | Supplier Intended and Approved Use | Residential Use; Non Residential Use |
| cUPC Certificates | Yes | Warranty | Lifetime Limited |
| Installation Required | Yes | Cut Out Template Included | Yes |
| Package Includes: Undermount sink, mounting hardware and cut-out template. | | | |