

MADE IN CHINA

Dry Food Dispenser Assembly Instructions for GAT 100/101 Model

+ Assembling

1. Carefully remove all the parts from the packaging
2. Place the stand in the tray holder by pressing firmly downwards
3. Place the container in the stand

The dispenser is now ready for use!

+ Disassembly

1. Take the container out of the stand
2. Remove the lid
3. Pull the tap out
4. Remove the rubber blade by carefully pulling it through to the top

+ Cleaning

1. Wash the parts in warm water with a little soap – never use an abrasive sponge or cloth
2. Make sure that all parts are completely dry before reassembling
3. Insert the rubber blade
(Pay attention to "front" marked on the blade and the pin on the rear side of the blade)
4. Insert the tap into the rubber blade, pushing it all the way through and turning it until you feel a click
5. Place the lid back on the container

HOW TO USE

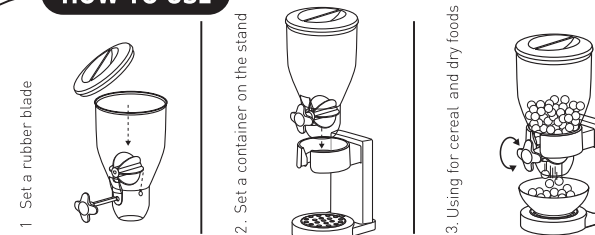

WARRANTY

The Zevro™ Easy Morning™ Countertop Dispenser is backed by our limited 30-day warranty against manufacturer defects. If your unit should fail due to a manufacturer defect within the warranty period, return it to Zevro in its original packaging along with the original receipt for a full refund or exchange.

zevro™

2340 West Touhy, Suite D, Chicago, Illinois 60645 | Tel: 1 800 313 8588 | www.zevro.com