



SPEC SHEET

KoolMore 71 in. Refrigerated Bakery Display Case for Cakes, Stainless Steel Frame, 30 cu. ft.

Model: RBD30C

FEATURES

- Four caster wheels
- Stain, rust, and odor resistant
- Built-in LED lighting
- 2 adjustable shelves
- Quick-Installation and Movability
- Clear, Wide, Curved Glass Front
- Maximum Visibility and Convenience
- Digital temperature controls and display.
- Auto defrost



CLOSE UP IMAGES



Technical Specs

Dimensions

Length	70.8
Width	28.7
Height	55.1
Interior Width	66.93
Interior Depth	24.8
Interior Height	31.5
Weight Lbs	510

Capacity

Gross Cubic Feet	30
------------------	----

Features & Materials

Installation Type	Freestanding
Indoor/Outdoor	Indoor
Cooling Unit Type	Automatic
Defrost Type	Automatic
Refrigerant Type	R-290
Horsepower	0.5
Temperature Range	35.6-42.6 F
Ambient Temperature Range	89 F
Control Type	Digital
Exterior Material	Stainless-Steel 430 and Tempered Glass
Interior Material	Stainless-Steel 304
Glass Type	Tempered
Color Finish	Stainless-Steel
Color Door Handles	Black
Door Style	Sliding
Number Of Doors	2
Number Of Shelves	3
Shelves Adjustable	yes
Shelf Material Type	GLASS
Interior Lights	LED
Interior Lights Location	Bottom of each shelf
Safety Lock	No
Number Of Feet	4
Legs Adjustable	Yes, 1.2 in.
Casters	4

Electric & Certification

Amps	11.04
Hertz	60
Phase	1
Voltage	115
Wattage	1148
Plug Type	NEMA 5-15P
Power Cord Length	98.43
Certifications	ETL Listed for Safety and Sanitation

Plan View

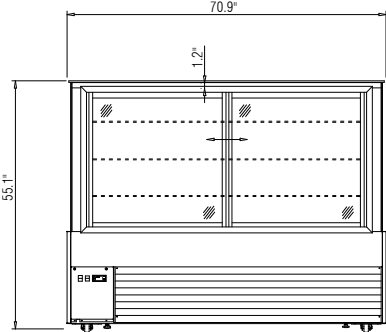

REAR VIEW

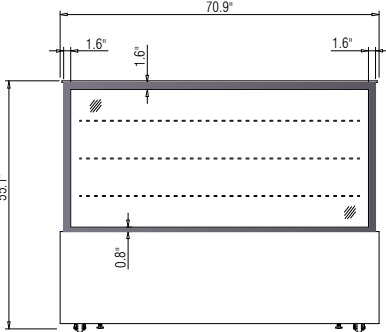

FRONT VIEW

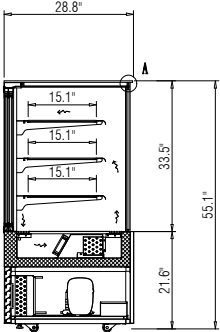

SECTION VIEW

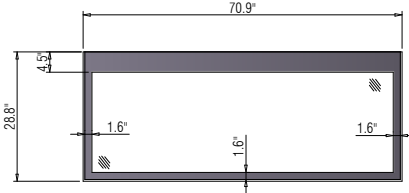

TOP VIEW

CERTIFICATIONS



Intertek



Intertek



718-576-6342
 info@koolmore.com