

ASSEMBLY INSTRUCTIONS

TOOLS REQUIRED

No Tools Required For Assembly

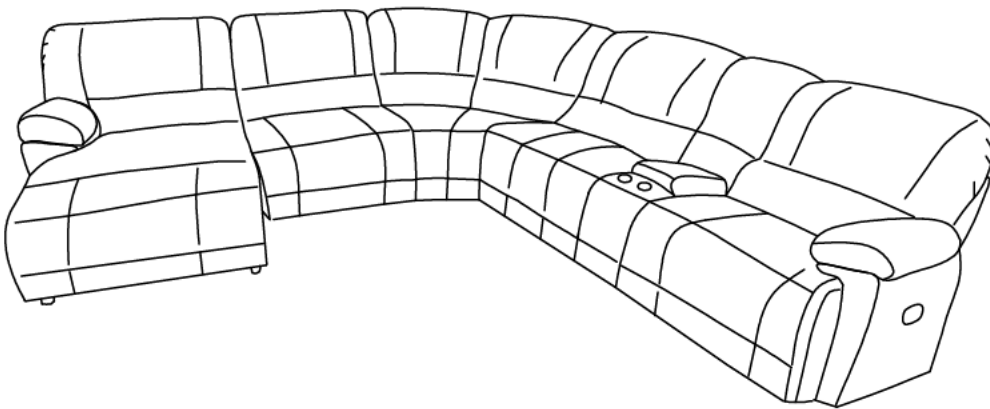

2 - Persons
Recommended

ASSEMBLY RATING



EASY ————— DIFFICULT

The Assembly Rating Is a 5-point system showing the level of effort needed to assemble a specific product.

Thank you for your purchase!

We hope you enjoy this new addition to your home for many years to come.

Our commitment to providing quality products does not simply end when you purchase our product. We fully stand behind our products from start to finish.



CHECK BEFORE STARTING



Are you missing anything?

Double-check all parts, hardware and accessories listed on Page 6 are accounted for.



Check out our Quick Tips!

We recommend reviewing the pre-assembly handouts. Even experts need a refresher now and then!



Prep Time!

Please review the assembly instructions and all diagrams prior to assembling. Arrange parts as recommended on Page 7 and group identical hardware together to make assembling easier.

PRE ASSEMBLY INTRODUCTION

We understand building ready-to-assemble furniture can be a challenging experience for some. To help avoid confusion, we have provided some helpful tips that may speed up the process.



Teamwork

ALWAYS have at least two people to help with transporting and assembling the product to avoid potential injury and/or damage.



Suitable Location

Assembling near the area of the intended location is highly recommended.



Sufficient Space

Make sure you have enough space to move around during the assembly.



Avoid Scratches

Use cardboard, blankets or a carpeted area while assembling furniture to prevent scratches.



Flat Surface

Make sure the furniture rests on a flat and level surface with each leg evenly touching the floor.

ASSEMBLY AND CARE ADVICE



**FAILURE TO FOLLOW THE GUIDELINES BELOW MAY
RESULT IN INJURY AND/OR PROPERTY DAMAGE.**



Position each part correctly
and insert screws or bolts into
their respective holes.

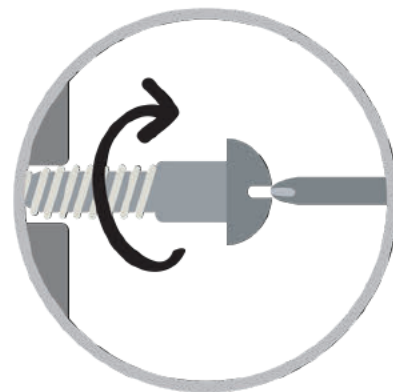

Turn clockwise to tighten and
only tighten when step is
completed or when instructed
to do so.



Use the appropriate hand tools
or power tools for assembly.
Select steps, such as tightening
screws and/or bolts, may require
hand tools to avoid causing
damage during assembly.



Save the instructions and store
any supplied tools for later
maintenance.

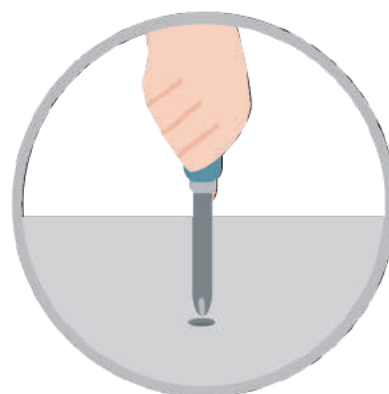

After two weeks, check and
tighten any loose hardware and
repeat again every six months
thereafter.

IT IS THE USER'S RESPONSIBILITY TO MAINTAIN THE FURNITURE. THE HARDWARE MAY LOOSEN OVER TIME AND MAY CAUSE THE FURNITURE TO BE WOBBLY AND UNABLE TO SUPPORT ITS INTENDED WEIGHT CAPACITY. THIS MAY LEAD TO COLLAPSE AND MAY CAUSE SERIOUS INJURY.

SOFA



- Please keep instructions for future reference.
- Check the quantity and irregularity of parts and hardware before you start.

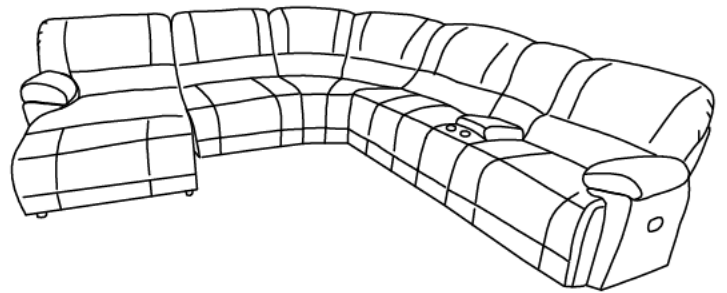

PARTS

#1 1pc



Sofa

#2 1pc



Corner Sofa

#3 1pc



Console

#4 1pc



Functional sofa

#5 1pc



Sofa Cushion (L / R)

#6 1pc



Corner Sofa
Cushion(L / R)

#7 1pc



Console Cushion

#8 1pc



Functional sofa
Cushion (L / R)

#9 17pcs

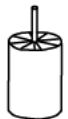

Leg

ASSEMBLY INSTRUCTIONS

- 1** Part #1 x 2 pcs
Part #2 x 1 pc
Part #3 x 1 pc
Part #9 x 17 pcs

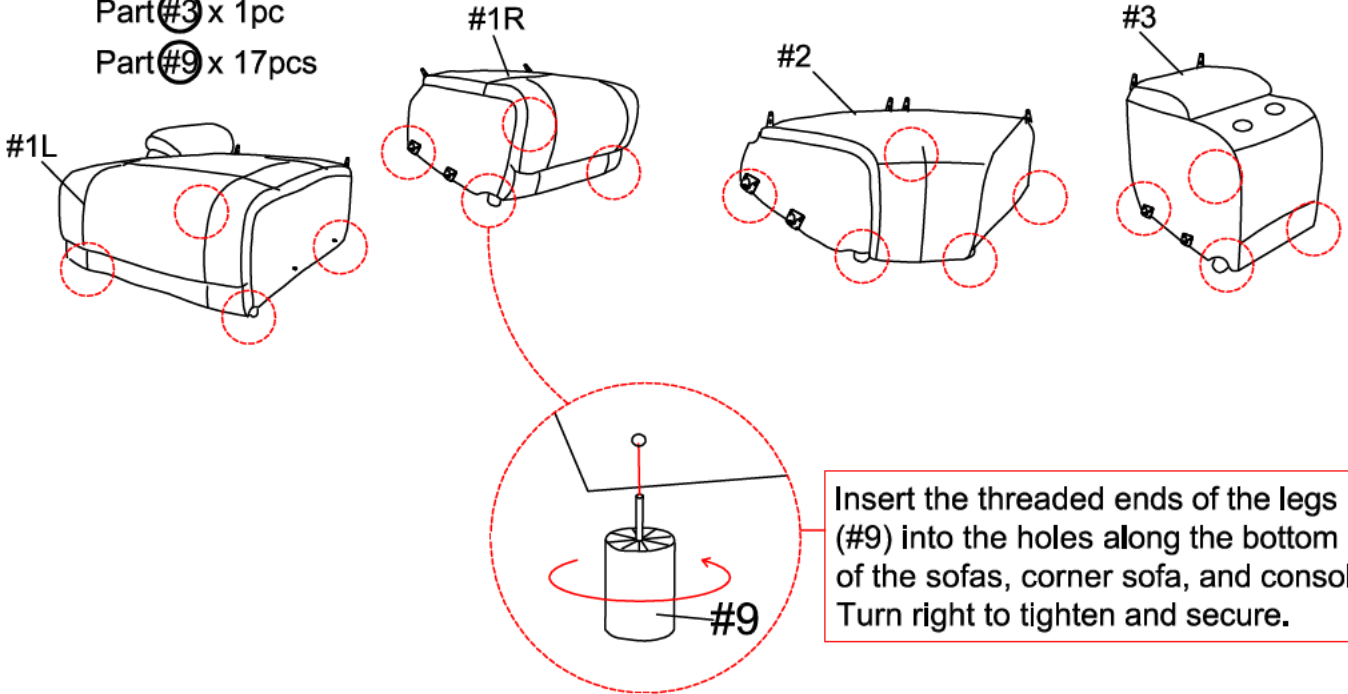

2

Align the brackets along the bottom of the sofa cushions (#5L/R) to the brackets along the sofas (#1L/R). Slide until the brackets are firmly secured.

Part #5 x 2 pcs

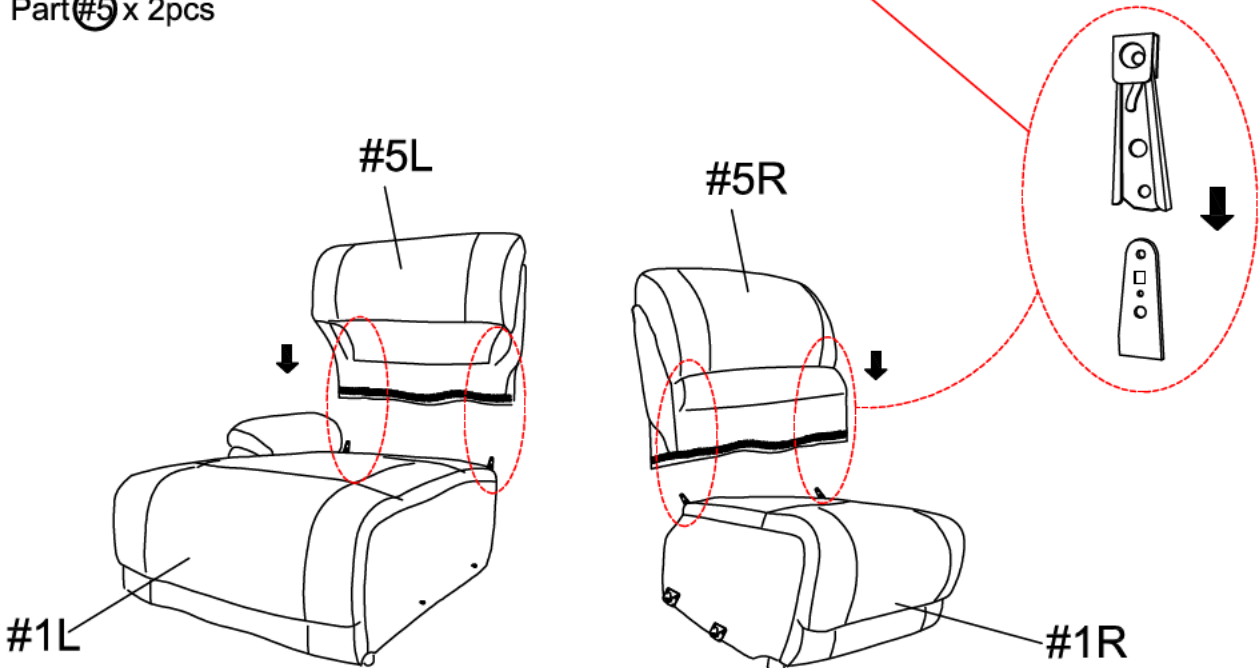

ASSEMBLY INSTRUCTIONS

Align the brackets along the bottom of the corner sofa cushions (#6L/R) to the brackets along the corner sofa (#2). Slide until the brackets are firmly secured.

3

Part #6 x 2pcs

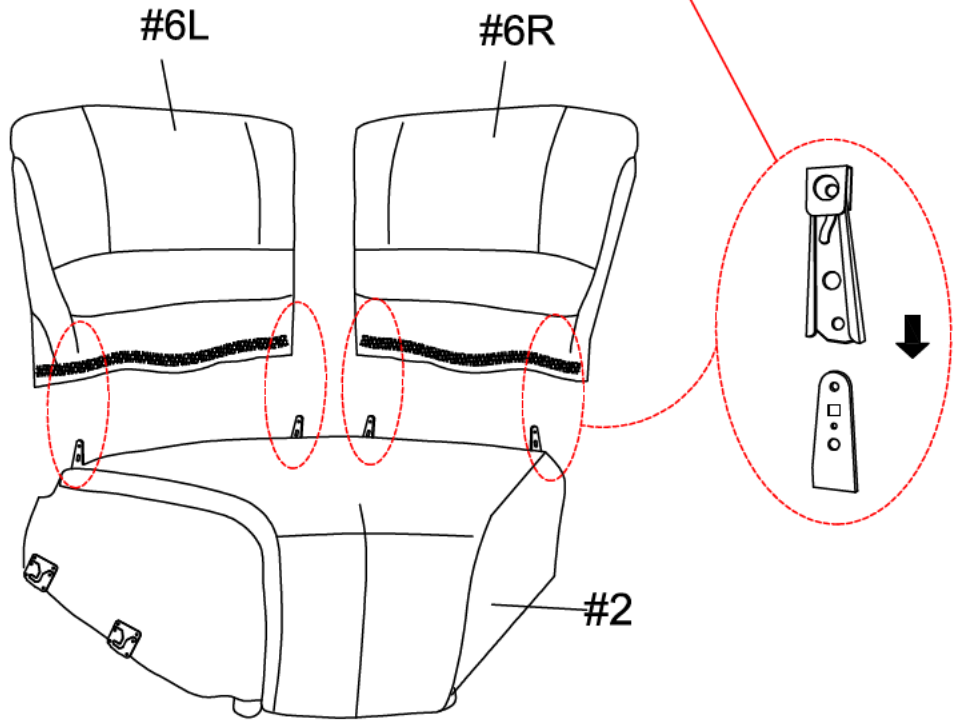

4

Part #4 x 2pcs

Part #7 x 1pc

Part #8 x 2pcs

Align the indicated cushions to the sofas and consoles. Slide the brackets until they are firmly secured.

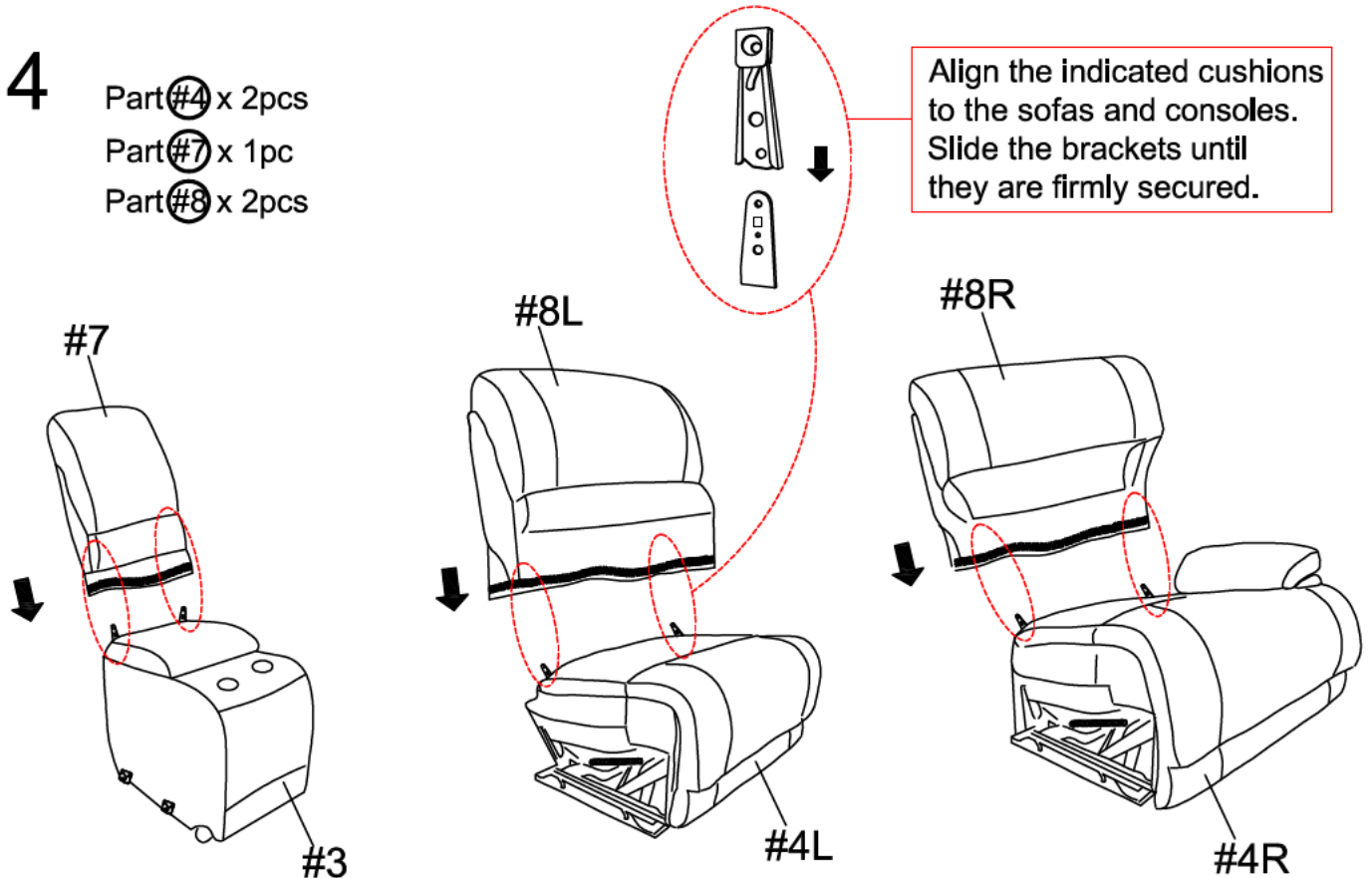

ASSEMBLY INSTRUCTIONS

5

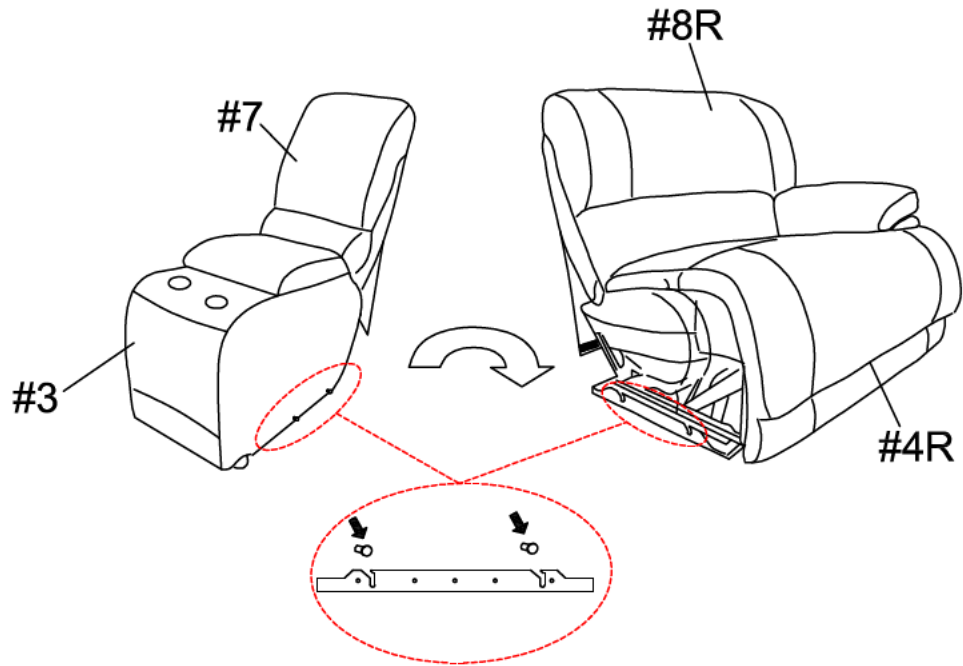

Place the pins along the bottom of the console (#3) into the ridges along the side of the functional sofa (#4R).

6

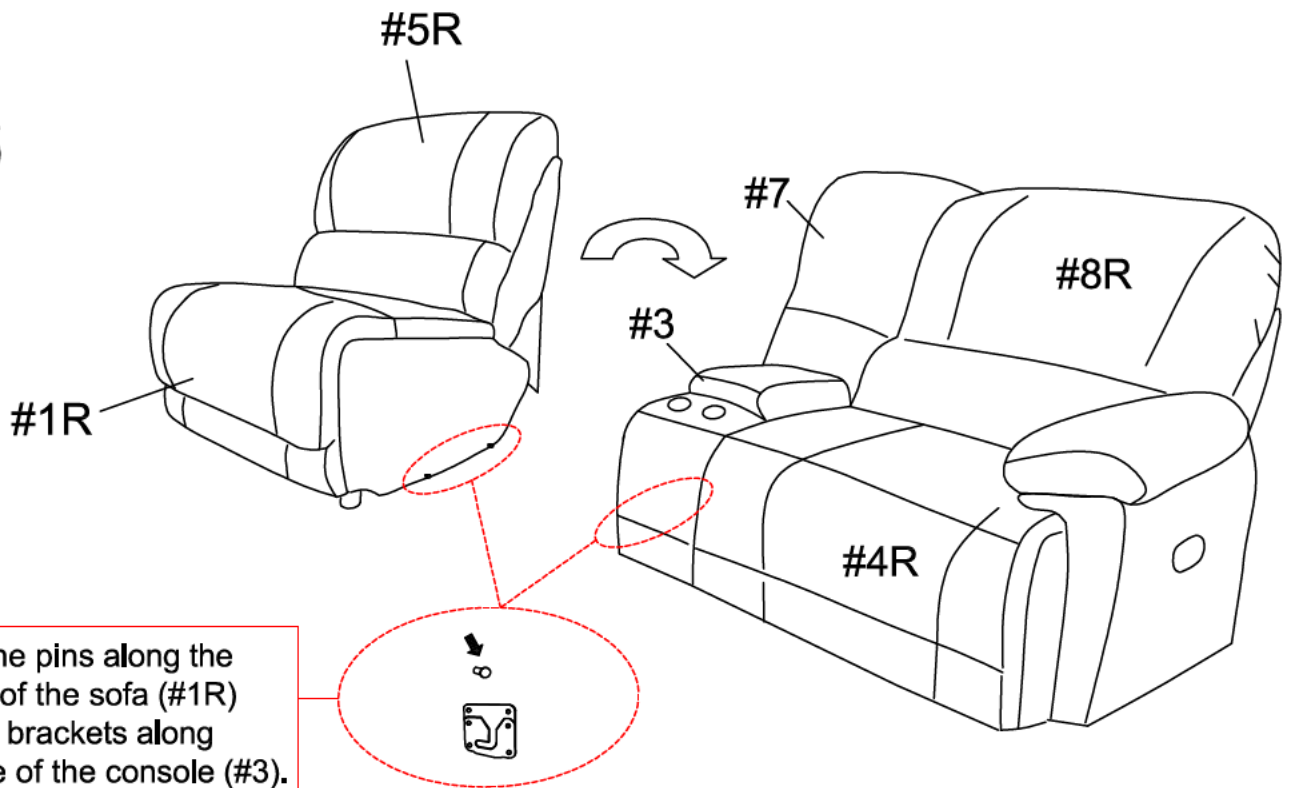

Place the pins along the bottom of the sofa (#1R) into the brackets along the side of the console (#3).

ASSEMBLY INSTRUCTIONS

7

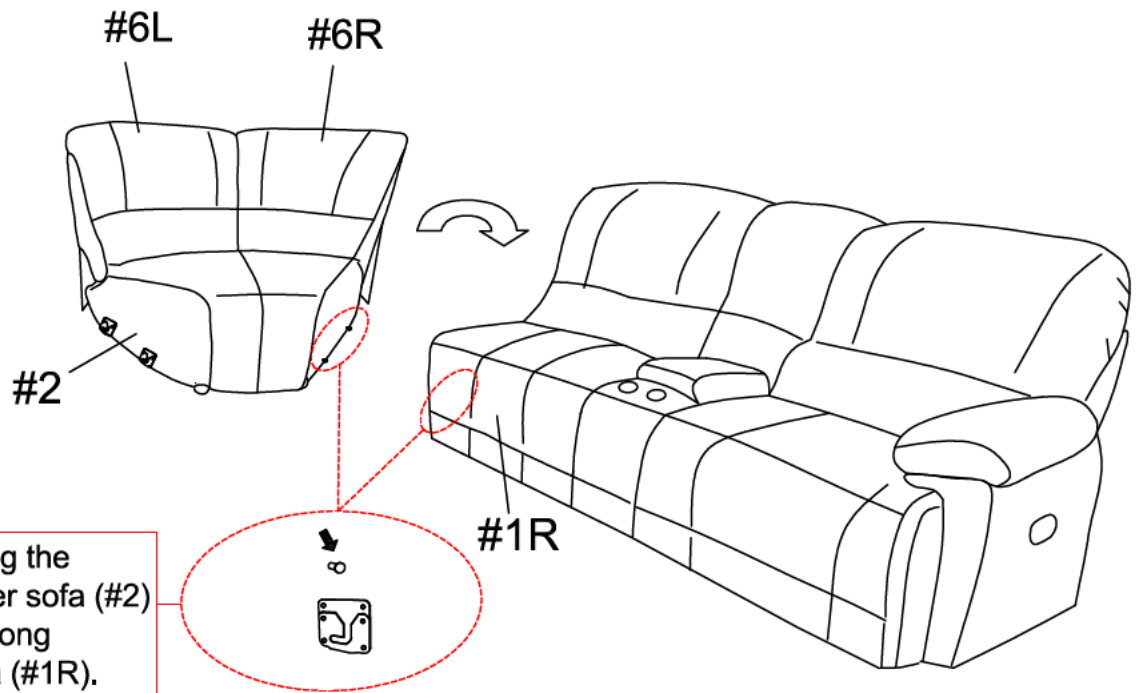

8

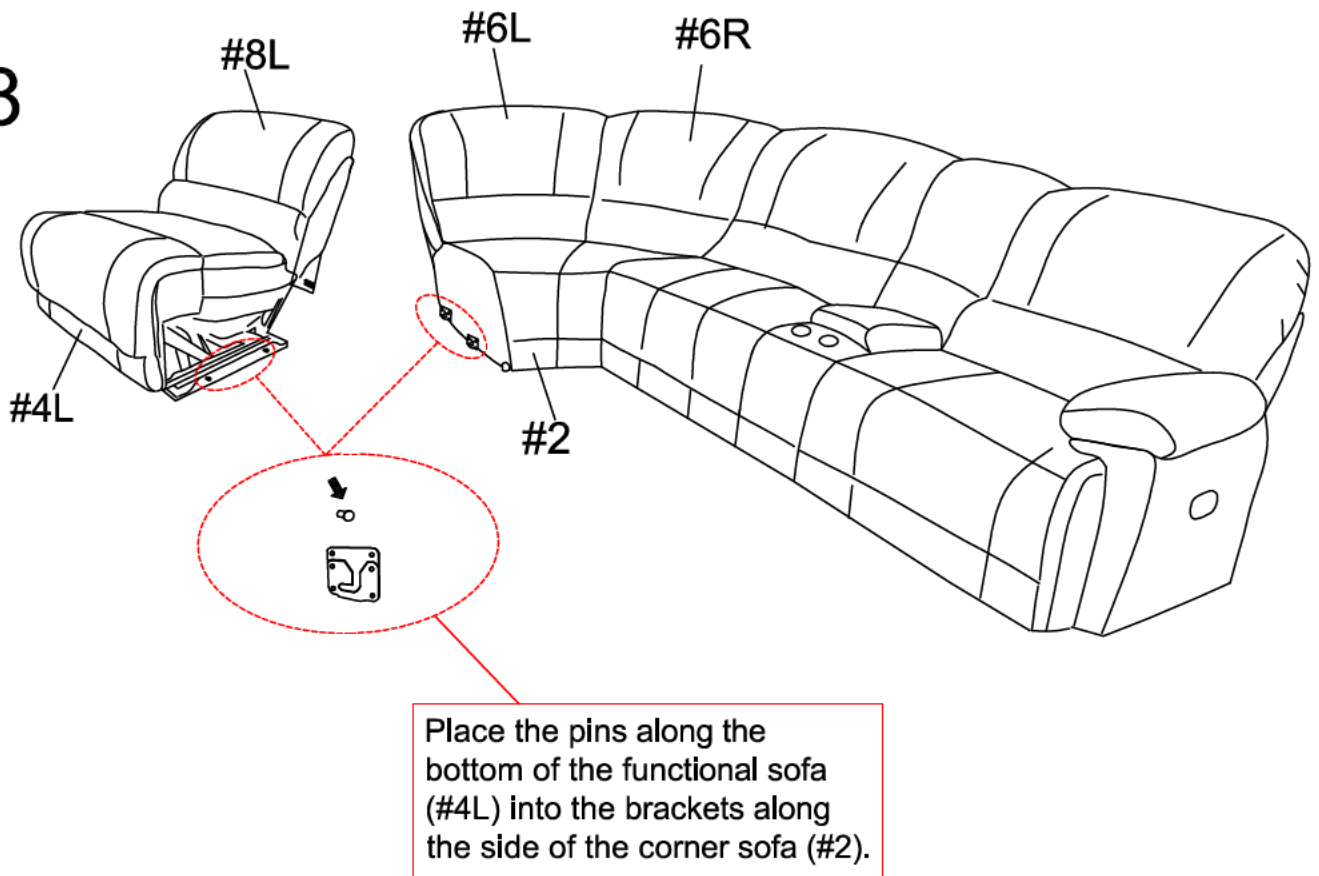

ASSEMBLY INSTRUCTIONS

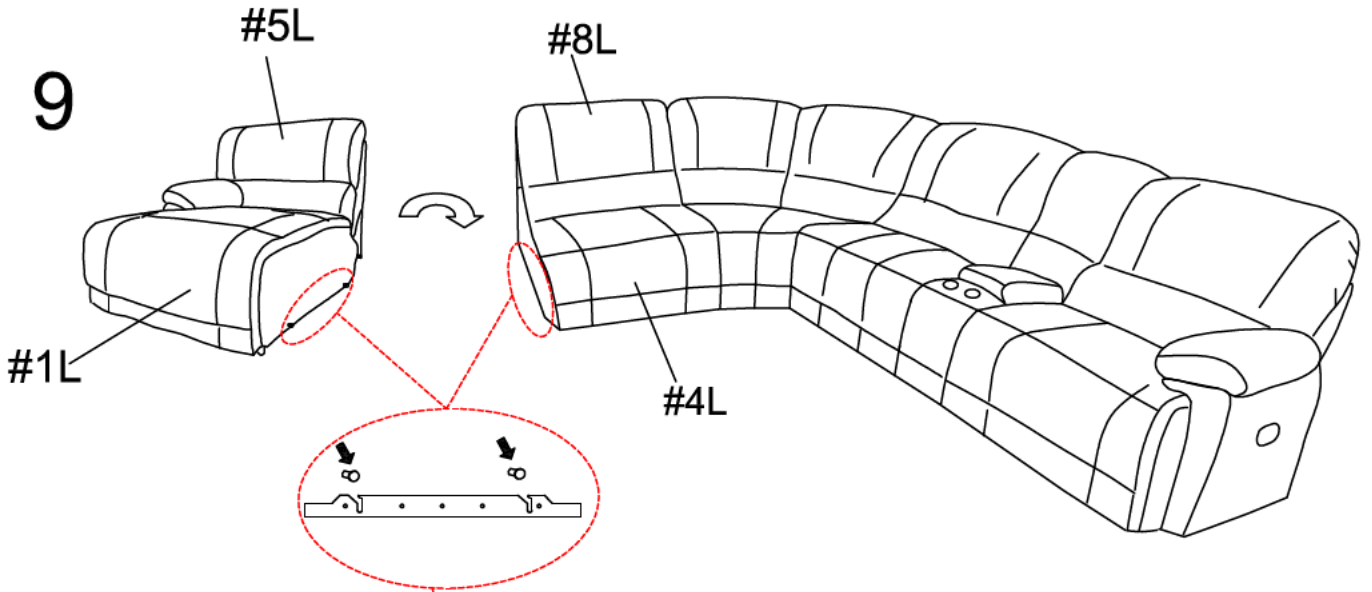

Place the pins along the bottom of the sofa (#1L) into the ridges along the side of the functional sofa (#4L).

ASSEMBLY COMPLETED



Please ensure the furniture rests on an even and flat surface. If the product wobbles or feels loose, double-check all bolts and/or screws are properly tightened and secured.

10

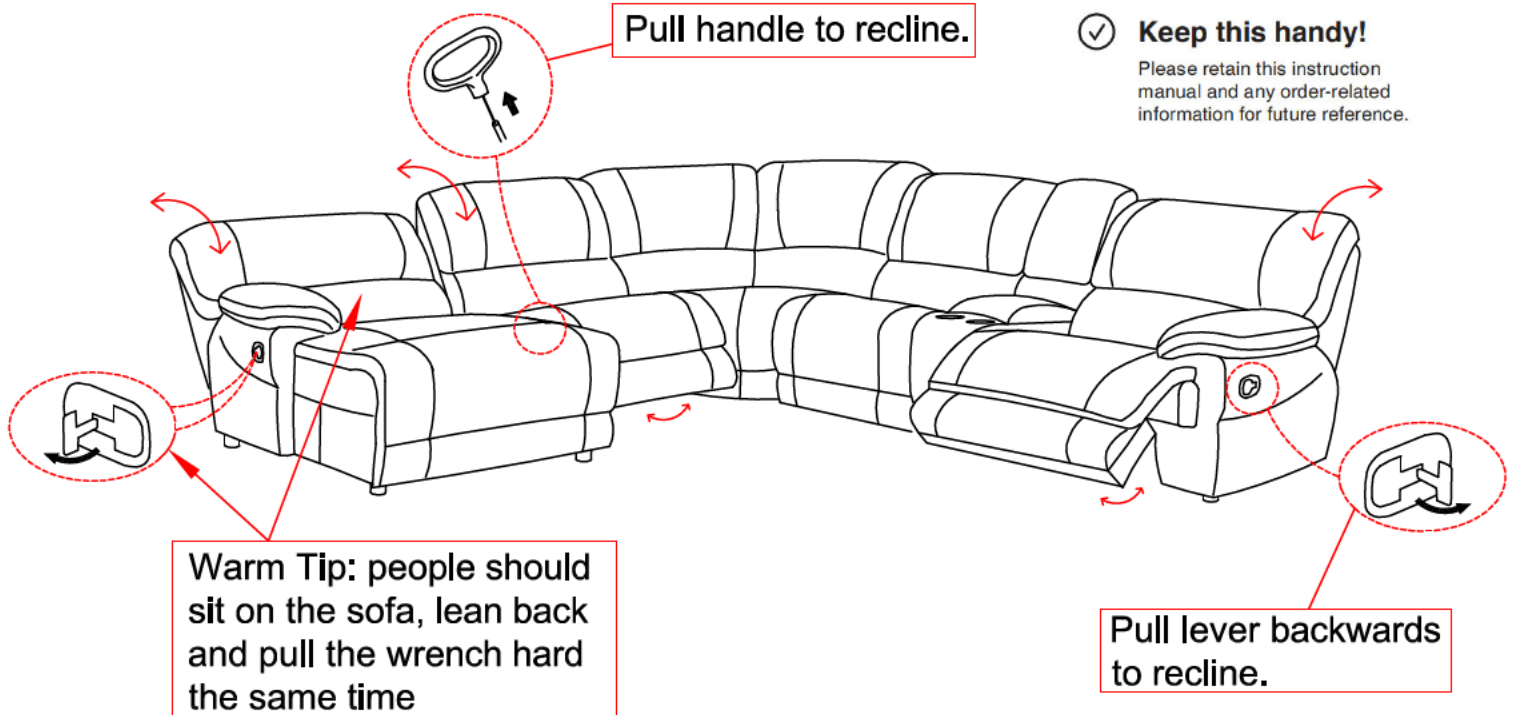

Keep this handy!

Please retain this instruction manual and any order-related information for future reference.